

SPORTSMEN CLASSIC SE & CLASSIC

ULTRA LIGHTWEIGHT TRAVEL TRAILERS



RECREATIONAL
VEHICLES

SPORTSMEN

Classic



SPORTSMEN CLASSIC SE & CLASSIC
ULTRA LIGHTWEIGHT TRAVEL TRAILERS

INTERIOR

CLASSIC SE

AFFORDABLE AND SMALL,
BUT **HAS IT ALL!**

Your journey begins with the all-new **CLASSIC SE** - KZ's most affordable model. Standards include 78-inch ceilings, maple cabinetry, roomy sleeping quarters, a full-size shower, cable hookup and USB outlets, an awning and plenty of storage. And with up to a 3,500-pound GVWR, you can tow it with your crossover.

Our Classic SE offers several versatile floorplans

- compact model
- tip-out bunk model featuring KZ's exclusive Aqualon Edge marine-grade fabric, which reduces heat buildup inside the tent.



WINDOW-VIEW DINETTE
converts to additional sleep space. Residential-grade linoleum resists cold cracking.

180BHSE



GENEROUS BATHROOM
includes full-size shower and foot-flush toilet.

BUNKHOUSE
with 28 x 75-inch bunks, lookout window and nearby outlets.
(180BHSE shown)



KITCHEN

- Amish-crafted rail-style maple cabinet doors
- two-burner range
- bright LED lighting
- 12V USB port and 110V receptacle

(180BHSE shown)

STANDARDS

- KZ Exclusive Tough Shield .030 Exterior Metal
- R-7 Insulation
- Front Diamond Plate
- Alum-a-Tough® Roofing w/12-Year Limited Warranty
- Tinted Windows
- Radial Tires
- Self-Adjust Electric Brakes
- Rear Bumper w/Sewer Hose Storage
- Digital TV Antenna
- Cable Hookup
- City Water Fill
- 12V Converter w/Charger
- LP Tank
- 2-Burner Range
- Electric Refrigerator
- Single-Bowl Sink
- 6-Gallon LP DSI Water Heater
- Rail-Style Cabinet Doors w/ Modern Handles
- Overhead Cabinets
- LED Interior Lights
- Shower & Toilet
- Tank Monitor Panel

OPTIONS

- Gas/Electric Refrigerator IPO Electric Refrigerator

OFF-ROAD PACKAGE

- Aluminum Rims w/15" Mud Tires
- Extra Ground Clearance
- Electronically-Controlled Heated Holding Tank
- Double Entry Step (select models)

KZ ADVANTAGE PACKAGE (MANDATORY OPTION)

EXTERIOR

- 5/8" T&G Plywood Floor
- 8,000 BTU A/C
- Power Awning
- Key-Alike Program for Baggage & Entry Doors
- Spare Tire & Carrier
- 2 - Scissor Style Stabilizer Jacks
- Solar Prep
- Backup Camera Prep

- Nitrogen-Filled Tires
- Leash Latch w/Bonus Beverage Opener

INTERIOR

- 20,000 BTU Furnace
- Plywood Bed Base
- Foot-Flush Toilet
- (2) 6.5" Interior Speakers
- Digital Media Stereo w/ Bluetooth & USB Port

KZ CONVENIENCE PACKAGE (MANDATORY OPTION)

EXTERIOR

- Friction-Hinge Entry Door
- Omnidirectional HDTV Antenna w/Wi-Fi Prep

INTERIOR

- Residential-Grade Linoleum
- Amish-Crafted Rail-Style Cabinet Doors
- Interior Control Switches on Overhead End Cabinet

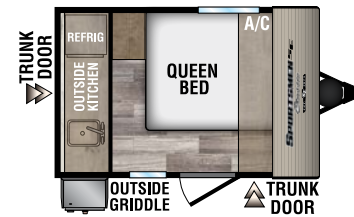

NEW 100RKSE UVW - 1,760 | Exterior Length - 13' | Sleeps 2

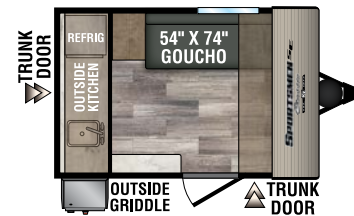

NEW 100SBSE UVW - 1,780 | Exterior Length - 13' | Sleeps 2

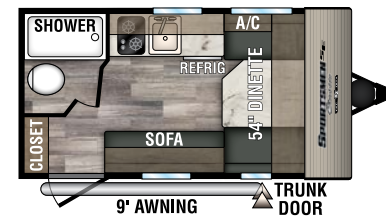

130RBSE UVW - 2,100 | Exterior Length - 16' 1" | Sleeps 2

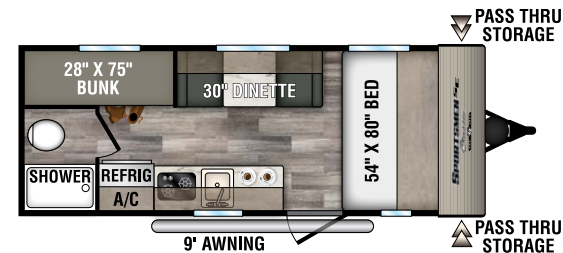

180BHSE UVW - 2,580 | Exterior Length - 20' 9" | Sleeps 4

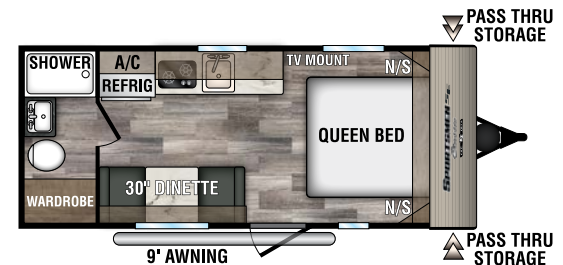

180QBSE UVW - 2,660 | Exterior Length - 21' 10" | Sleeps 3

Ultra Lightweight Travel Trailers	100RKSE	100SBSE	130RBSE	180BHSE	180QBSE
UVW (Unloaded Vehicle Weight)*	1,760	1,780	2,100	2,580	2,660
Dry Hitch Weight*	210	220	310	320	380
Dry Axle Weight*	1,550	1,560	1,790	2,260	2,280
NCC (Net Carrying Capacity)	1,040	1,020	700	920	840
GVWR	2,800	2,800	2,800	3,500	3,500
Interior Height	78"	78"	78"	78"	78"
Exterior Height w/o Roof A/C	107"	107"	107"	107"	107"
Exterior Width	84"	84"	84"	84"	90"
Exterior Length	13'	13'	16' 1"	20' 9"	21' 10"
Refrigerator (cu. feet)	3	3	3	4	4
Water Heater Cap. (gal. LP w/DSI)	6	6	6	6	6
Fresh Water Cap. (gal.)	20	20	20	20	20
Waste Water Cap. (gal.)	N/A	N/A	15	15	26
Gray Water Cap. (gal.)	26	24	15	15	32
LP Gas Cap. (lbs.)	20	20	20	20	20
Furnace BTUs (1,000s)	20	20	20	20	20
Tire Size	14"	14"	14"	14"	14"
Awning	N/A	N/A	9'	9'	9'

*This weight reflects the rolling average unit weight for each model. Your trailer weight will vary according to optional equipment.

INTERIOR

CLASSIC

NEVER A BETTER TIME TO SHARE OUTDOOR ADVENTURES!

A great RV at a great price – **SPORTSMEN CLASSIC** has been a KZ customer favorite for years. Loaded with standard features, this affordable RV tows with an SUV and is offered in many versatile floorplans, including two toy haulers, and two expandable bunk models built with KZ’s exclusive Aqualon Edge tent fabric.

There’s a **CLASSIC** for everyone, whatever their needs –

- spacious shower
- sleep space for eight
- walk-around queen bed (on select models)
- more closet space



KITCHEN

- deep kitchen sink, large enough for filling pots and pitchers
- microwave
- two-burner cooktop
- centralized cabinet-end control panel
- optional 7-cubic-foot refrigerator

181BH / Kona décor

Choose the **COMFY AND SPACIOUS** 54 x 80-inch bed (181BH shown), or the walk-around queen bed with built-in corner nightstand shelves (160QB & 190BH).

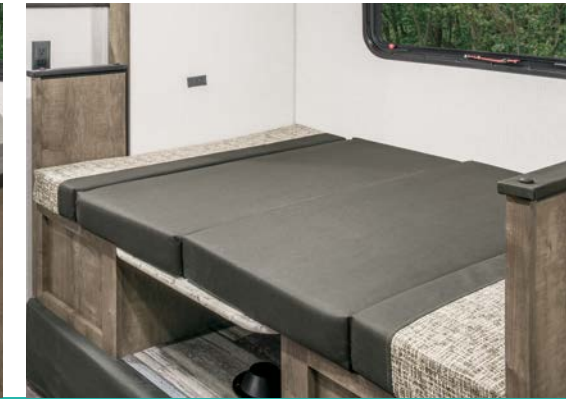

BENCH-SEAT DINETTE big enough for family meals, then folds down neatly for comfortable sleep space. (181BH shown)

STANDARDS

- KZ Exclusive Tough Shield .030 Exterior Metal
- R-7 Insulation
- Front Diamond Plate
- Alum-a-Tough® Roofing w/12-Year Limited Warranty
- Tinted Windows
- Radial Tires
- Self-Adjust Electric Brakes
- Rear Bumper w/Sewer Hose Storage
- Digital TV Antenna
- Cable Hookup
- City Water Fill
- 12V Converter w/Charger
- LP Tank
- 2-Burner Range
- Microwave
- LP/Electric Refrigerator
- Single-Bowl Sink
- 6-Gallon LP DSI Water Heater
- Rail-Style Cabinet Doors w/Modern Handles
- Overhead Cabinets
- LED Interior Lights

- Shower & Toilet
- Tank Monitor Panel

OPTIONS

- 13,500 A/C Low Pro (required on 180RBT, 181BH, 190TH)
- Round Bamboo Sink Cover
- 7 CF Refrigerator (required on 180RBT, 181BH, 190TH & must option roof air) (N/A 170RD)
- 24" TV w/Inside/Outside Bracket (160QB, 180TH, 190TH, 190BH only)
- Retractable Screen Wall (toy haulers only)
- Front Window (N/A on toy haulers, 160RBT, 180RBT)
- Wireless Backup Camera System - Observation

OFF-ROAD PACKAGE

- Aluminum Rims w/15" Mud Tires
- Extra Ground Clearance
- Electronically-Controlled Heated Holding Tank
- Double Entry Step (select models)

KZ ADVANTAGE PACKAGE (MANDATORY OPTION)

EXTERIOR

- 5/8" Tongue & Groove Plywood Floor
- 26" Entry Door w/Flip-Up Entry Steps
- 8,000 BTU A/C
- Power Awning w/LED Light Strip
- Key-Alike Program for Baggage & Entry Doors
- Aqualon Edge Tent Material
- Folding Grab Handle
- Exterior Speakers
- Spare Tire & Carrier
- (4) Scissor-Style Stabilizer Jacks
- Two-Toned Exterior Metal
- Solar Prep
- Backup Camera Prep
- Nitrogen-Filled Tires
- Leash Latch w/Bonus Beverage Opener

INTERIOR

- 20,000 BTU Furnace
- Plywood Bed Base
- Foot-Flush Toilet
- (2) 6.5" Interior Speakers
- Digital Media Stereo w/Bluetooth & USB Port
- Stainless Steel Round Kitchen Sink

KZ CONVENIENCE PACKAGE (MANDATORY OPTION)

EXTERIOR

- Friction-Hinge Entry Door w/Shade Prep
- Double Entry Steps (select models)
- Omnidirectional HDTV Antenna w/Wi-Fi Prep

INTERIOR

- Residential-Grade Linoleum
- Amish-Crafted Rail-Style Cabinet Doors
- Interior Control Switches on Overhead End Cabinet

Lightweight Travel Trailers	160QB	160RBT	170MB	170RD	180RBT	180TH	181BH	190BH	190TH
UVW (Unloaded Vehicle Weight)*	2,860	2,790	2,900	2,800	3,250	3,250	3,000	3,260	3,400
Dry Hitch Weight*	450	320	420	500	410	420	430	470	450
Dry Axle Weight*	2,410	2,470	2,480	2,300	2,840	2,830	2,570	2,790	2,950
NCC (Net Carrying Capacity)	640	710	600	700	1,250	1,750	500	1,740	1,600
GVWR	3,500	3,500	3,500	3,500	4,500	5,000	3,500	5,000	5,000
Interior Height	78"	78"	78"	78"	78"	78"	78"	78"	78"
Exterior Height w/o Roof A/C (unless noted)**	107"	107"	112"	112"	118"	107"	112"	112"	112"
Exterior Width	90"	90"	90"	90"	90"	90"	84"	90"	90"
Exterior Length	21' 10"	18' 11"	21' 10"	21' 10"	21' 6"	21' 6"	20' 9"	23' 2"	22' 4"
Refrigerator (cu. feet)	4	4	4	3	7	4	7	4	7
Water Heater Cap. (gal. LP w/DSI)	6	6	6	6	6	6	6	6	6
Fresh Water Cap. (gal.)	20	20	20	20	20	38	20	20	38
Waste Water Cap. (gal.)	32	24	26	30	24	30	15	30	30
Gray Water Cap. (gal.)	32	32	32	30	32	30	15	30	30
LP Gas Cap. (lbs.)	20	20	20	20	20	20	20	20	20
Furnace BTUs (1,000s)	20	20	20	20	20	20	20	20	20
Tire Size	14"	14"	14"	14"	14"	15"	14"	14"	14"
Awning	10'	12'	12'	13'	13'	13'	9'	14'	14'

*This weight reflects the rolling average unit weight for each model. Your trailer weight will vary according to optional equipment. **This exterior height is with roof A/C.

STANDARDS & OPTIONS

CLASSIC

2020 DÉCOR

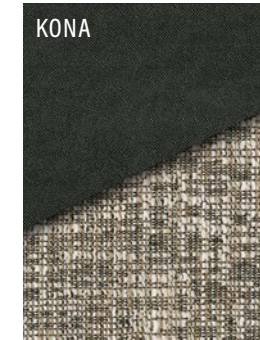

CONVENIENCE & SECURITY!

One lock for all applications, and standard industry keys can't open your storage compartments or entry doors.



includes 15-inch mud tires with aluminum rims, extra ground clearance, an electronically-controlled heated holding tank, and double entry step.

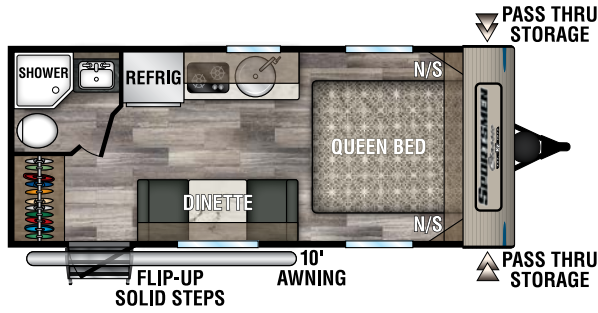

160QB UVW - 2,860 | Exterior Length - 21' 10" | Sleeps 3

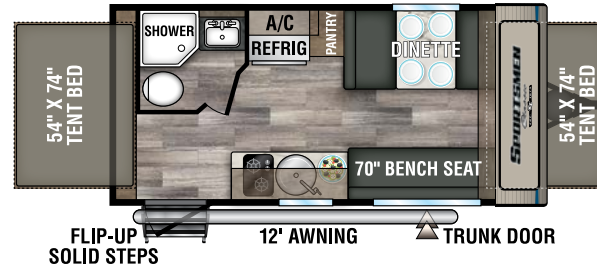

160RBT UVW - 2,790 | Exterior Length - 18' 11" | Sleeps 6

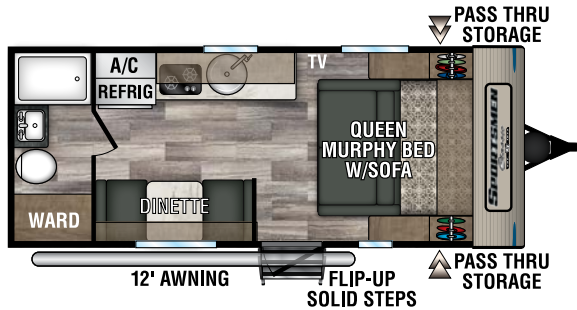

NEW 170MB UVW - 2,900 | Exterior Length - 21' 10" | Sleeps 3

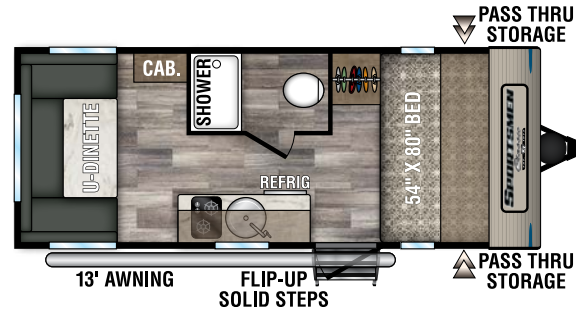

170RD UVW - 2,800 | Exterior Length - 21' 10" | Sleeps 4

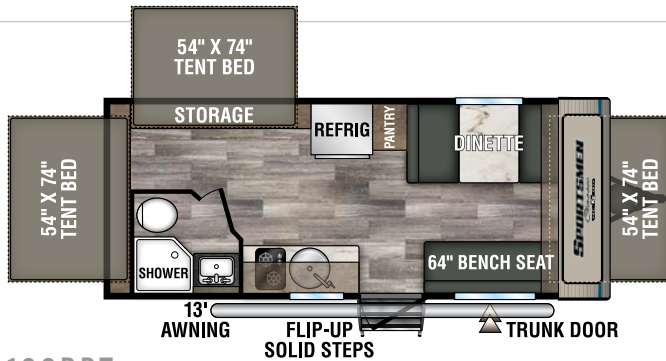

180RBT UVW - 3,250 | Exterior Length - 21' 6" | Sleeps 8

CLASSIC SE
& CLASSIC
EXTERIOR FEATURES

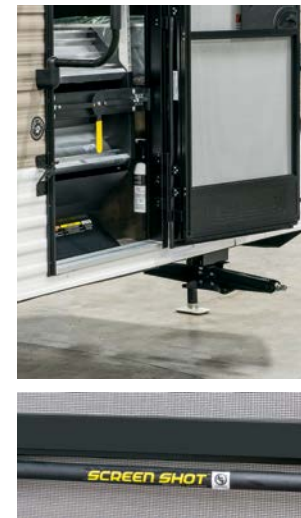

FLIP-UP ENTRY STEP and folding handrail provide solid footing and deploy effortlessly. Extra-wide 26-inch friction-hinge entry door. (Classic only)



SOLAR PREP



**BACKUP CAMERA
PRE-WIRE**

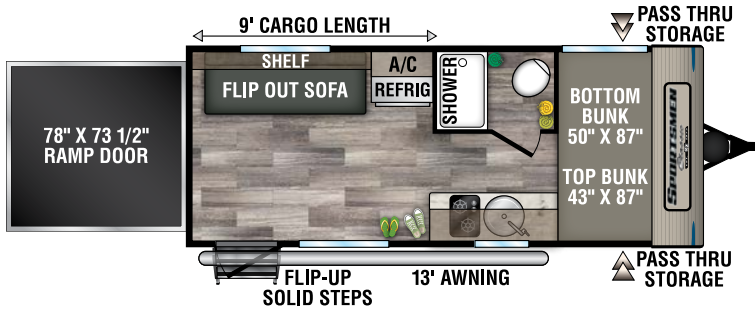

180TH UVW - 3,250 | Exterior Length - 21' 6" | Sleeps 4

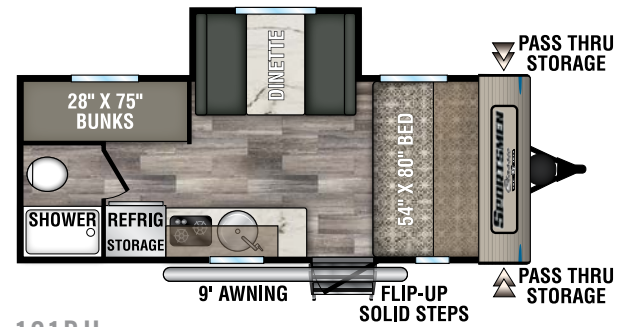

181BH UVW - 3,000 | Exterior Length - 20' 9" | Sleeps 5

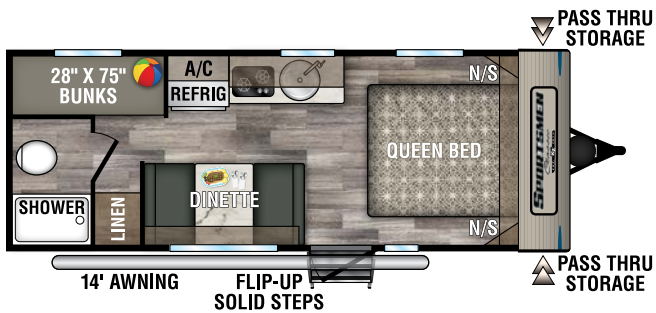

190BH UVW - 3,260 | Exterior Length - 23' 2" | Sleeps 5

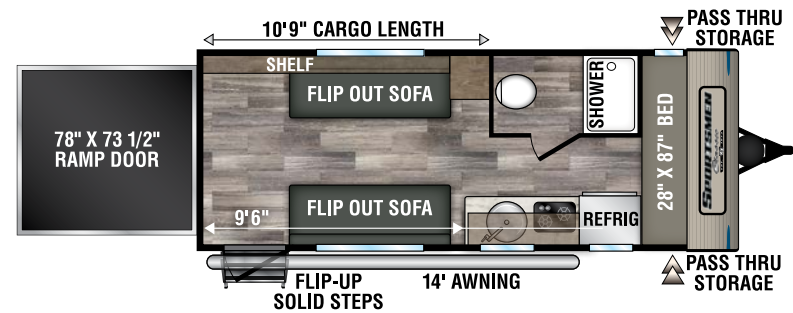

NEW 190TH UVW - 3,400 | Exterior Length - 22' 4" | Sleeps 3



POWER AWNING
extends and retracts in seconds,
with an LED light strip for added ambience.



SCISSOR JACKS keep CLASSIC level and
secure. Scissors are safe, with better stability
and weight distribution.



The exterior
wall-mount
BOTTLE OPENER
doubles as a
LEASH LATCH,
and helps prevent
your pet from
making a getaway
at the campsite.



MARINE-GRADE AQUALON EDGE MATERIAL reduces heat gain
by 33 percent and is permanently affixed to bunkend door.
Tents feature aluminum-latched knuckle hinges, and self-
supporting cable system rated to 1,100 pounds. Aqualon Edge
boasts a 7-year material warranty.



**TONGUE & GROOVE
PLYWOOD FLOORING**

**DOWNLOAD
YOUR FREE
KZ RV APP TODAY!**

Owning and operating an RV has
never been easier. Everything you need
is now in the palm of your hand.

- Track RV Maintenance
- Keep RV Service Close
- Set Custom Notifications
- Reference Checklists
for RV Trips

**DOWNLOAD
NOW!**

Available on the
App Store | GET IT ON
Google Play

KZ | **TOGO**

VISIT KZ-APP.COM TO LEARN MORE.



RECREATIONAL VEHICLES

HANDCRAFTED TO HIGH STANDARDS

In 1972, Sam King and Daryl Zook built a truck camper—and built a better way to camp. Since then we've built recreational vehicles with a focus on craftsmanship and quality, so you can spend more time adventuring and less time worrying.

When you hitch to a KZ Recreational Vehicle, you can expect adventure, good times, and old-world values. We care about your camping experience. Because your KZ is where the journey starts.

Go. Camp. Live.



Dealer:
Colton RV
North Tonawanda, NY 14120
(716) 694-0188
(800) 628-4889
www.ColtonRV.com

Colton RV
Orchard Park, NY 14127
(716) 957-3250
(800) 628-4889
www.Coltonrv.com

