



Section 8

Optional Equipment

Optional Equipment

Solar Battery Charger	8-5
Xantrex Pure Sine Wave Inverter	8-9
Cobra 800 Watt Inverter	8-13
Pioneer Radio / Backup Camera	8-15
Power Sofa/Bed	8-17
Dometic Legless Motorized Awning	8-19
Dometic Legless Motorized Awning Manual	8-21
Bose Surround Sound System	8-27
Heated Holding Tanks	8-29
Equalizer Systems Stabilizers	8-31
Safe-T-Plus Steering Control	8-33

Solar Battery Charger

The solar charger (95 Watt) will charge the auxiliary batteries with the master 12 Volt switch in the “on” or “off” position. A Charge Controller will optimize the charging rate and cut off the charging current when the batteries are fully charged. Optimal charging will be obtained in direct sunlight.



The charge controller panel is located just inside the entry door to the right. It will show the status of the charging system and the status of the “house” battery circuits. Refer to the Carmanah manual for instructions.





carmanah®
we put solar to work

MODEL

CTI-95

SOLAR MODULE

Reliable

The CTI-95 Solar Module from Carmanah is a high-efficiency monocrystalline solar module that provides outstanding performance and cost-effective solar power for high-end off-grid and mobile applications. Carmanah's CTI-95 Solar Module is built to last and features a 25-year limited power output warranty.

Durable

To ensure long life, the high-efficiency solar cells are encapsulated between a special tempered, low-iron solar glass and a Tedlar®/polyester backing material. The mounting frame, manufactured from anodized marine-grade aluminum, allows the CTI-95 to be installed in extreme conditions.

The CTI-95 is ideal for ...

- RV/Marine
- 12/24 Volt battery systems
- OEM
- Security Trailers
- Telecommunications
- Stand-alone or grid connected applications
- Signaling systems
- Remote telemetry
- Water pumping
- Other off-grid applications

Features:

- Compact and rugged design
- Plug and play junction box
- Lightweight anodized aluminum frame
- High transmissivity tempered glass
- MC4 cable connectors included

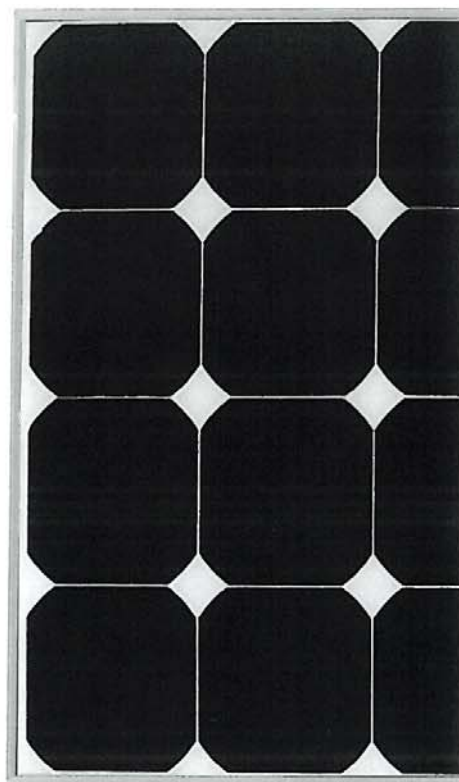

CTI-95 SOLAR MODULE



Carmanah is backed by a worldwide network of solar professionals

To find a representative in your region

- visit us at www.carmanah.com
- or call +1 250 380 0052 (toll-free US & Canada 1 877 722 8877)

REPRESENTED IN YOUR REGION BY:

Carmanah Technologies Corp. Web: carmanah.com Email: info@carmanah.com Telephone: 1.250.380.0052 Fax: 1.250.380.0062



CTI-95

SOLAR MODULE

MODEL

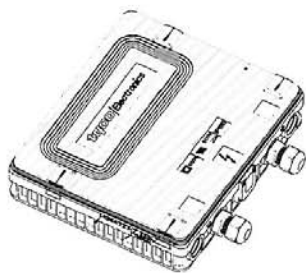

Tyco Junction Box features:

- Wire Specification: Copper; #14 AWG min.; 90 deg. C
- Min 5mm cable diameter to max 7 mm cable diameter
- Self-sealing lid
- MC4 cables included

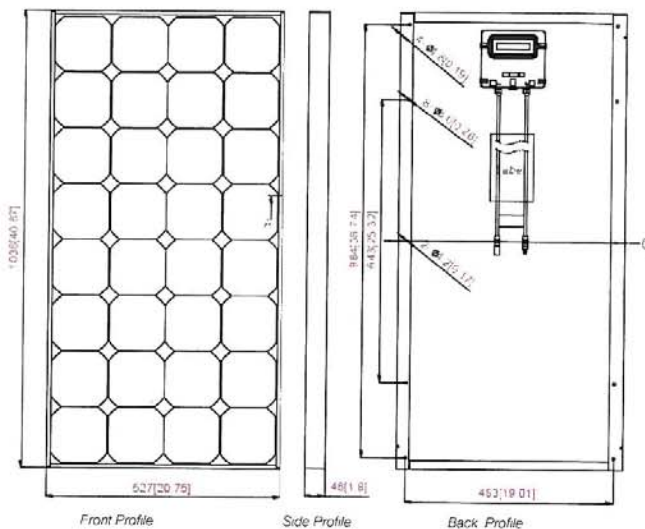
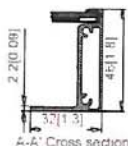

SPECIFICATIONS

Cell type	Monocrystalline
Rated power	95 W
Maximum power voltage	17.2 V
Maximum power current	5.53 A
Open circuit voltage	20.6 V
Short circuit current	6.19 A
Voltage coefficient	-60.8mV / °C
Power coefficient	-0.38% / °C
Module efficiency	18%
Cell efficiency	20%
Series fuse rating	15 A
Max system voltage	75 V
Weight	16.3 lb (7.4 kg)
Dimensions	40.8 x 20.8 x 1.8 inches 1037 x 527 x 46 mm
Frame type / material	>15µm clear anodized aluminum frame
Fire Rating	Class C
Design load	53.3 lbs / ft ²

IV CURVE PARAMETERS

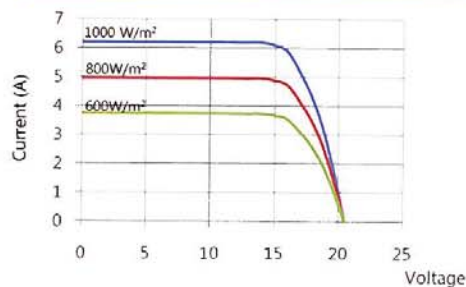

Solar Cells: High-efficiency monocrystalline cells, 32 cells in series
 Maximum power tolerance: +/- 5%
 Power Specifications calculated at:
 Irradiance: 1000 W/m²
 Cell Temperature: 77 °F (25 °C)
 Air Mass: 1.5G

Carmanah Technologies Corp. • Web: carmanah.com • Email: info@carmanah.com • Telephone: 1.250.380.0052 • Fax: 1.250.380.0062 •

Xantrex Pure Sine Wave Inverter

The 1800 Watt Xantrex Pure Sine Wave Inverter is recognized as industry leading in power source supply. It operates from the 12V auxiliary batteries and inverts 12V power DC to 120 AC power.

The inverter has a remote control located on the main control tower located behind the passenger seat. The remote control has operation and battery condition monitoring of DC volts. Detailed information on the inverter and the remote control are included in the Xantrex owner's manual.

***** The inverter shut-off is NOT automatic. The inverter may be ON which will result in running down the auxiliary batteries. *****



PROsine™ 1000/1800 Sine Wave Inverters

xantrex™

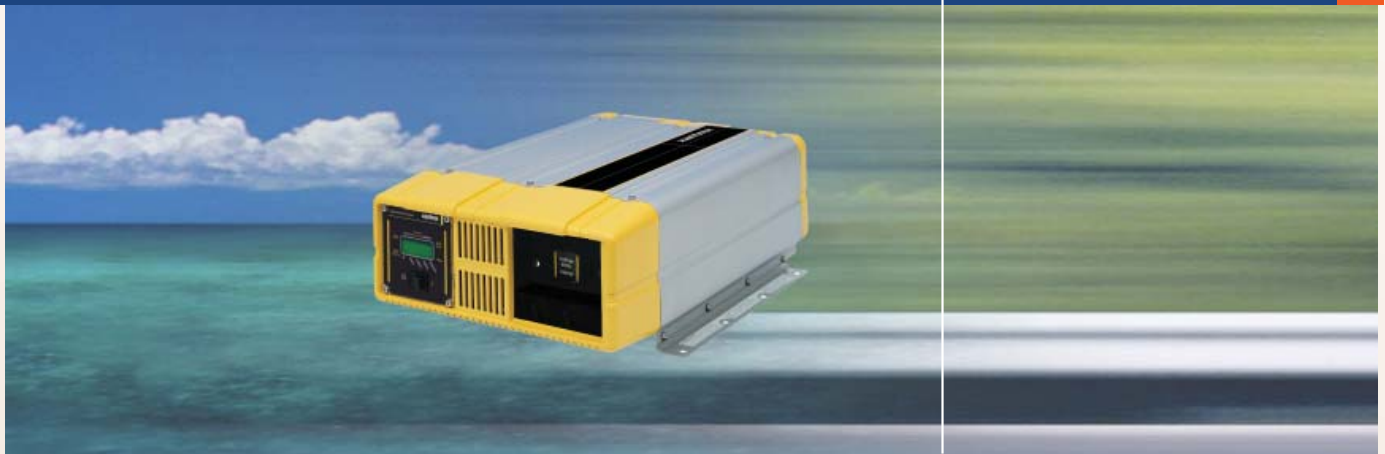

Provides 1000 and 1800 watts of sine wave AC power from a DC source

Offering superior quality true sine wave output, the PROsine™ 1000 and 1800 stand-alone inverters are ideally suited for electrical systems that already have a quality multistage battery charger. Designed for recreational and industrial applications, their 120-volt, 60 Hz AC power output is capable of handling both heavy duty and smaller, multiple AC loads. PROsine inverters include a backlit LCD display panel, which can be mounted remotely.

Product Features

- ▶ 1000 and 1800 watt inverters (1500 and 2900 watt surge capability)
- ▶ True sine wave AC output (crystal controlled)
- ▶ Removable LCD display can be mounted remotely for control and monitoring
- ▶ Unique DC terminals offer 180-degree connections for easy installation in tight places
- ▶ Powersave mode draws only 1.5 watts under no load
- ▶ Two year warranty

Protection Features

- ▶ Over temperature shutdown and automatic overload protection
- ▶ Over voltage and under voltage protection
- ▶ Short circuit and AC backfeed protection

Options

- ▶ Available in 12 and 24 volt models
- ▶ Models available with GFCI AC outlet or AC hardwire terminal strip for permanent installation into an electrical system (optional 15 A transfer switch available with hardwire option)
- ▶ Remote interface kit for remote mounting of display module

Ultra-clean true sine wave power

- ▶ With less than 3% total harmonic distortion, PROsine 1000 and 1800 inverters deliver true sine wave output that is identical to AC power supplied by your utility. This clean output makes PROsine inverters ideal for handling sensitive loads and improves AC equipment performance. Expect trouble-free true sine wave electricity for televisions, audio systems, variable speed tools, and more.

Light and compact

- ▶ PROsine inverters are lighter and more compact than other inverters with similar power ratings because they use high-frequency switching technology in the power conversion process.



CSA/NRTL certified to UL & CSA standards

Xantrex Technology Inc.

Headquarters
8999 Nelson Way
Burnaby, British Columbia
Canada V5A 4B5
800 670 0707 Toll Free
604 420 1591 Fax

541 Roske Drive, Suite A
Elkhart, Indiana
USA 46516
800 446 6180 Toll Free
574 294 5989 Fax

www.xantrex.com

© 2004 - 2008 Xantrex Technology Inc. All rights reserved. Xantrex, Smart choice for power and PROsine are trademarks of Xantrex International, registered in the U.S. and other countries.

Printed in Canada

PROsine 1000 Watt and 1800 Watt Sine Wave Inverters

Electrical Specifications

Models	PROsine 1000	PROsine 1800
Output power	1000 W	1800 W
Surge rating	1500 W	2900 W
Output current (peak)	25 A	45 A
Output voltage (at no load)	120 Vac \pm 3%	120 Vac \pm 3%
Output voltage (over full load and battery voltage range)	120 Vac RMS -10%/+4%	120 Vac RMS -10%/+4%
Output frequency	60 \pm 0.05 (crystal controlled)	60 \pm 0.05 (crystal controlled)
Output waveform	True sine wave (<3% THD)	True sine wave (<3% THD)
Peak efficiency (12 V/24 V)	89% / 90%	89% / 90%
No load power draw (search mode)	<1.5 W	<1.5 W
No load power draw (idle mode)	<22 W	<22 W
Input voltage range (12 V/24 V)	10 – 16 Vdc / 20 – 32 Vdc	10 – 16 Vdc / 20 – 32 Vdc
Transfer relay rating (hardwire/transfer relay models)	15 A	15 A
Transfer time AC to inverter and inverter to AC	Max 2 cycles (typically 1 cycle) <2.5 seconds with Powersave "ON"	Max 2 cycles (typically 1 cycle) <2.5 seconds with Powersave "ON"

General Specifications

Operating temperature range	32°F – 140°F (0°C – 60°C)	32°F – 140°F (0°C – 60°C)
Storage temperature range	-22°F – 158°F (-30°C – 70°C)	-22°F – 158°F (-30°C – 70°C)
AC output types	Dual GFCI receptacle	Dual GFCI receptacle
	Hardwire	Hardwire
	Hardwire with transfer relay	Hardwire with transfer relay
LCD display panel	Removable; can be mounted remotely (requires remote interface kit - see part number section)	Removable; can be mounted remotely (requires remote interface kit - see part number section)
	Displays DC volts, amps and output power	Displays DC volts, amps and output power
Recommended DC fuse	12 V: 150 A or 175 A* 24 V: 70 A or 90 A* *Depending on applicable installation codes	12 V: 225 A or 300 A* 24 V: 100 A or 150 A* *Depending on applicable installation codes
Dimensions (H x W x D)	4.5 x 11.0 x 15.4" (115 x 280 x 390 mm)	4.5 x 11.0 x 15.4" (115 x 280 x 390 mm)
Weight	14.5 lb (6.5 kg)	16.5 lb (7.5 kg)
Warranty	Two year	Two year
Part Numbers		
12-volt		
GFCI outlet	806-1000	806-1800
Hardwire with transfer relay	806-1002	806-1802
24-volt		
GFCI outlet	806-1050	806-1850
Hardwire with transfer releay	806-1052	806-1852
Remote interface panel	808-1800	808-1800
Wiring cover	808-1801	808-1801

Regulatory Approvals

CSA/NRTL certified to CSA 107.1, UL 458 (including Marine supplement)

KKK-A-1822D: Federal specification for use on ambulances

Designed to meet ABYC E8, E9, A25 for marine applications

Note: Specifications subject to change without notice.

Cobra 800 Watt Inverter

The Cobra CPI 880 - 800 Watt inverter is available on Coach House Platinum models.

It operates from the 12V auxiliary batteries and inverts 12V power DC to 120 AC power.

The inverter is located in the overhead cabinet above the driver's seat. The on/off switch is located on the front of the unit.

***** The inverter shut-off is NOT automatic. The inverter may be ON which will result in running down the auxiliary batteries. *****



Back-Up Camera / Radio



The AVH-P4400BH DVD multimedia receiver features a 7" motorized touchscreen display, built-in Bluetooth® for hands-free calling and audio streaming, and an HD Radio™ tuner. The newly updated and innovative user interface makes direct operation of the unit stress-free by eliminating complicated layered selection displays, so access to desired functions is smoother and simpler than ever. A variety of multimedia options ensures that you will be properly entertained. Customizable audio and video functions make it easy to suit your mood.

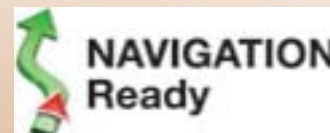

Power Sofa/Bed

Optional Equipment. Power Sofa/Beds are made by Kustom Fit, a division of Villa Industries. The fabric used matches the driver and passenger chairs and has a durability rating to last a long life in your motorhome.

The power sofa/bed has 4 functions:

- 1) Move sofa away from outer wall.
- 2) Convert sofa to bed.
- 3) Move bed toward outside wall to adjoin stationary cushion.
- 4) Convert bed to sofa & move toward outside wall.

You may operate the power sofa/bed with slide-out room extended or with room not extended.

Do NOT Continue to hold the button down once the sofa has extended or retracted. You can cause damage to the gears with prolonged use.



Dometic Legless Motorized Awning



Your Coach House Platinum has been equipped with the Dometic 9500 series legless motorized awning. Electrical power comes through an 800 watt power inverter which allows the unit to automatically retract using power from the “house” batteries in the event of unforeseen inclement weather.

Make sure your Battery Cutoff Switch is in the ON position and the Inverter is turned ON any time the Electric Awning is deployed. Damage to your Awning or Motorhome may occur if power is not available in the event of inclement weather.

There is a motion sensor attached to the lead rail of the awning which will force the awning to retract if the motion becomes violent enough to cause damage to the unit.

The main control for the awning is located just inside the main motorhome door on the “Tower of Power”.

Clean your awning with mild soap and water only.

Insert Dometic Awning Manual Here



RECORD THIS INFORMATION FOR FUTURE
REFERENCE:

Model Number _____

Serial Number _____

Date Purchased _____

Retailer / Qualified Installer _____

USA
SERVICE OFFICE
Dometic, LLC
2320 Industrial Parkway
Elkhart, IN 46516
574-294-2511

CANADA
Dometic, LLC
46 Zatonski, Unit 3
Brantford, ON N3T 5L8
CANADA
519-720-9578

**For Service Center
Assistance Call:**
800-544-4881

**3313943.000
REMOTE WALL
CONTROL KIT**

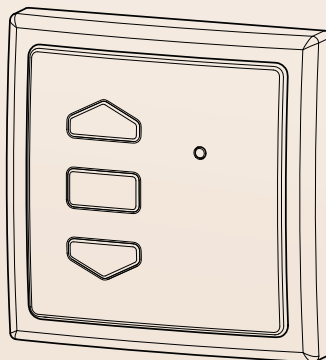

**INSTALLATION & OPERATING
INSTRUCTIONS**

**3313943.000
REMOTE WALL
CONTROL KIT**

3314042.000

Form No. 3314042.000 02/11
(French 3314043.000)
©2011 Dometic, LLC
LaGrange, IN 46761

**Important: These Instructions must
stay with unit. Owner read carefully.**

GENERAL INSTRUCTIONS

These instructions apply to:

202(XX)(XX).000(#) 9500E Cassette Awnings
203(XX)(XX).000(#) DA20(XX) Cassette Awnings

This kit consists of:

- (1) Installation & Operating Instructions
- (1) Awning Remote Wall Control Unit with Base

Dometic, LLC reserves the right to modify appearances and specifications without notice.

2. On back of remote wall control unit, place and slide battery into battery clip until fully engaged. See FIG. 2.

Note: Make sure battery has positive side up.

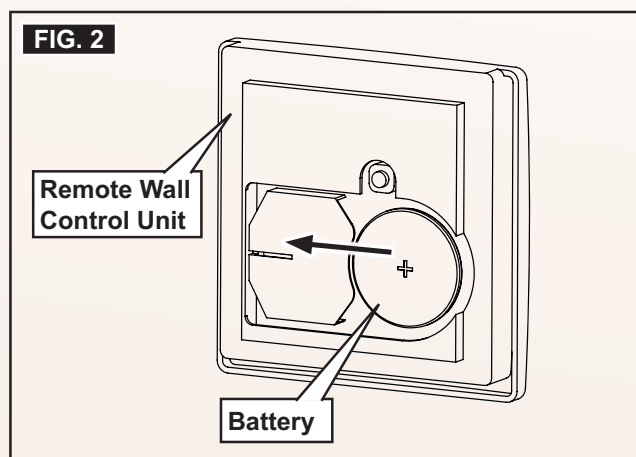

PROCEDURE

A. Install Remote Wall Control Unit

NOTICE

Do not expose remote and remote holster to weather, extreme temperatures, or long hours in direct sunlight. Failure to obey this notice could result in property damage.

1. Locate a suitable location for remote wall control base that's protected from weather and other adverse conditions, and install with two screws. See FIG. 1.

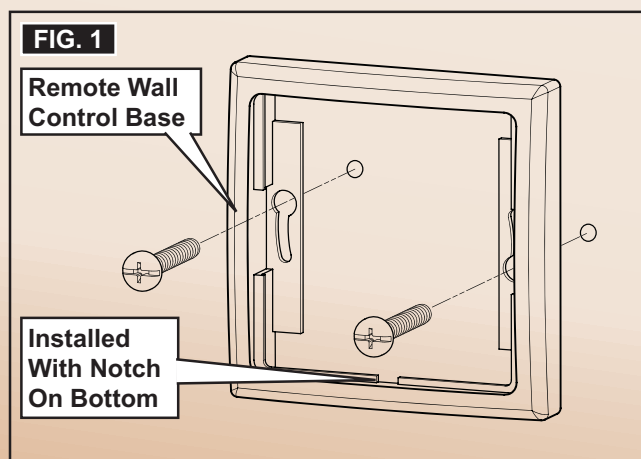

B. Activate Remote Wall Control Unit

More than one remote may be added to operate the awning if desired.

Note: Refer to the operating instructions that came with your awning if this remote is a replacement, and no other remote is programmed to the awning.

1. Make sure power is supplied to awning motor.

Note: There should already be at least one remote programmed to the awning motor at this stage.

2. Using a remote that already controls the awning motor, press and hold the program button on back for approximately (3) seconds. Awning motor should jog momentarily. See FIG. 3.

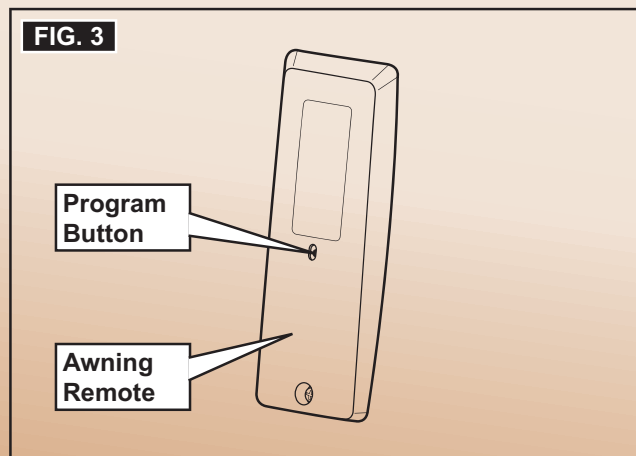

3. Press and hold the program button on back of remote wall control unit for approximately (3) seconds. Awning motor should jog momentarily. See FIG. 4.

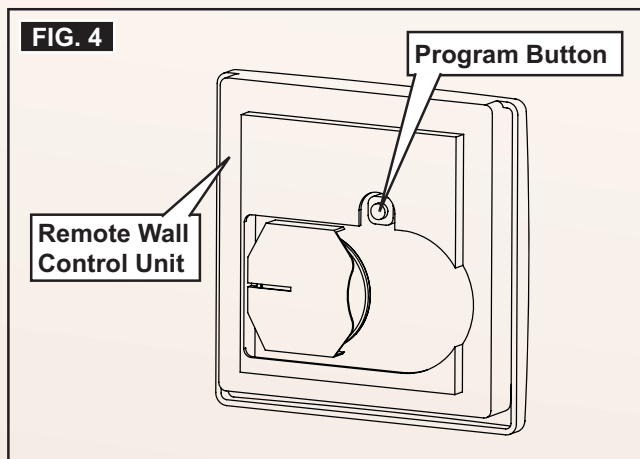

5. Install the remote wall control unit onto remote wall control base by snapping it in place. See FIG. 6.

Note: To remove remote wall control unit from base, use flat bladed screw driver to disengage tab at bottom notch. See FIG. 1.

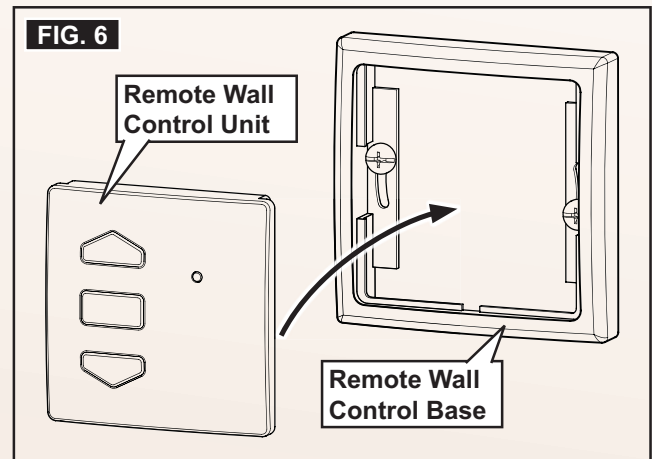

4. Verify awning motor and remote functionality.
 - a. Press the open button (down arrow) briefly on awning remote wall control unit. Awning should extend to its out limit. See FIG. 5.

Note: If awning does not respond, verify LED lights momentarily (on remote wall control unit) when button is pressed. If LED does not light, install new batteries.

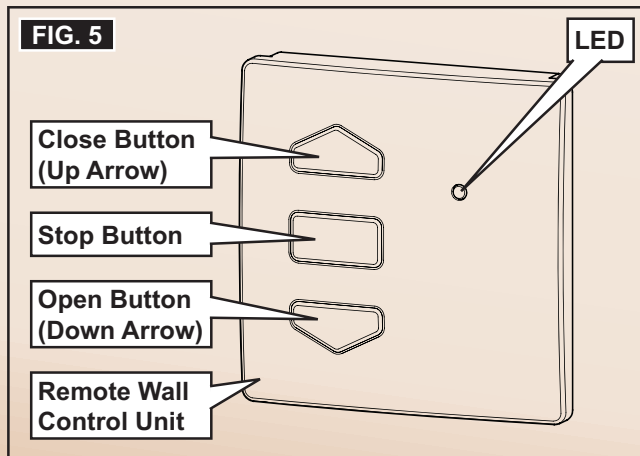

C. Operate Remote

1. See "Procedure" under awning Operating Instructions for specific operating information.

Bose Surround Sound System



CineMate® Series II digital home theater speaker system

- A 2.1-channel speaker system with compact speakers and improved digital acoustic performance
- Designed to enhance the audio from your TV and existing video sources
- Available with Gemstone speakers and universal remote or Articulated Array speakers and simplified, four-button remote.
- 3D-compatible with 3D TVs, Blu-ray Disc™ players, gaming consoles and other 3D sources
- Simplified setup, with only a few connections to make

The Bose® CineMate II speaker system is the easiest way to enjoy Bose 2.1-channel home theater performance and bring out the full audio potential of your HDTV. Proprietary TrueSpace® technology enables two compact speakers and an Acoustimass® module to deliver compelling sound for movies, games, sports and more. The system easily connects directly to your TV, avoiding the need to disconnect other sources. And with no rear speakers, there's no wiring to the back of your room.

Heated Holding Tanks

Heated Holding tanks are installed as optional equipment on your Coach House Platinum.

Manufactured by ULTRA HEAT INDUSTRIES, the tank heaters come in four sizes.

The larger tank heaters are equipped with a thermal sensor which will prevent the heaters from being activated unless the ambient air temperature is below 46 degrees Fahrenheit. This protection is to make sure your heaters do not come on inadvertently and “cook” the contents of your holding tanks.

ULTRA HEAT INDUSTRIES warrants tank heaters for a period of one year from the time of purchase and any failures should be reported directly to them at their factory.



UHI Worldwide, Inc.
1314 Perkins St.
P.O. Box 1454
Elkhart, IN 46515-1454
USA



Product Insert

ONE-YEAR LIMITED WARRANTY

All UHI stock items carry a one (1) year warranty under normal use against manufacturing defects in UHI materials and/or workmanship. The warranty coverage starts on the date of the original purchase. This Limited Warranty covers only those defects which occur or exist within the one (1) year period referenced above. Any modification of UHI products, from original design and/or intended use, or improper installation shall **VOID** all warranties.

All of UHI's obligations pursuant to this Limited Warranty are limited to replacing the product at no additional cost or issuing an account credit memo for the product's cost.

WARRANTY EXCLUSIONS

UHI MAKES NO OTHER WARRANTIES, EXPRESS OR IMPLIED, including any IMPLIED WARRANTY OF MERCHANTABILITY, FITNESS FOR A PARTICULAR PURPOSE, or NONINFRINGEMENT. In no event shall UHI be liable for special, indirect, or consequential damages arising out of the limited warranty.

To the extent that applicable state and/or federal law prohibits the exclusion of any remedy permitted under state or federal law, any such remedy, including, but not limited to, implied warranties of merchantability, fitness, use, or purpose, is limited to **one (1) year** from the date of the original purchase.

PROPER USE OF TRADEMARKS

UHI Worldwide, Inc., Ultra Heat, Inc., UltraHeat®, and Ultra-Heat™ and all individual product trademarks, service marks, logotypes, commercial symbols, insignias, and designs pertaining thereto, as they appear in any advertising medium, are proprietary marks of UHI Worldwide, Inc., and UHI owns all right, title, and interest in and to these proprietary marks. Trademarks and trade names may not be used in connection with any product or service that is not provided by UHI, in any manner that is likely to cause confusion among customers, or in any manner that disparages or discredits UHI. Purchaser shall not remove, alter, or otherwise modify any identification marks or trademarks affixed by UHI to products.

REPACKAGING

UHI products shall not be repackaged without the express, written approval of UHI. Under no circumstances shall UHI product labeling be removed, obstructed, or altered.

www.uhiworldwide.com

Equalizer Systems Stabilizers



Straighten Up With Stabi-Lite®

Equalizer Systems has introduced a new stabilizing system designed for Class C motorhomes. If you are tired of your coach leaning when the slide room is extended, or fed up with the constant swaying when you walk around in your coach, let STABI-LITE® stabilize your RV. It's an easy way to keep you walking straight.



- Eliminates coach lean when slide is extended
- Clamp style mount requires no welding or drilling to install
- Convenient, one-touch automatic operation
- Eliminates nearly all sway resulting from coach movement
- Low profile design decreases height required by traditional systems
- Complete system weight of less than 80 lbs.
- Chassis specific design reduces installation time

Safe-T-Plus Steering Control



STEERING CONTROL (Silver)

Safe-T-Plus high-performance steering controls are designed to reduce over-steering your vehicle making it easier to drive to your destination. Safe-T-Plus is perfect for Class C [Motorhomes](#), towing/hauling trucks, SUV's, Vans, and large passenger vehicles.

FEATURES

- Positive Centering Capabilities
- Hydraulic Shock Absorption
- Long lasting metallic plating
- Maintenance-Free
- Simple Bolt-On [Installation](#)
- 2 Year Warranty

BENEFITS

- Reduce Driver Fatigue from Oversteering
- Protects against front-tire blowouts
- Keeps vehicle centered against side winds, passing Semi's
- No more "white-knuckle" driving
- More relaxed driving
- Decreased wear-and-tear on front end
- Protects your family and investment

Ensuring the highest safety engineering and quality manufacturing into each unit for your safety is our first priority. We start with only the best available materials from the most trusted names in the raw materials industry. Each Safe-T-Plus steering control is cut to precision with our state-of-the art production systems.

Each unit is then measured with caliper precision readings to ensure they meet our strict tolerances.

Safe-T-Plus' heavy-duty mechanical coils are an integral part of our "positive centering-point tracking" capabilities which are set specifically for each model to accommodate virtually every chassis type on the road today. To further protect the quality performance of Safe-T-Plus, several metallic plating processes is used on the internal and external components of the unit to prevent corrosion from various harsh climate conditions.

Each Safe-T-Plus unit is equipped with specialized heavy-duty hydraulic capabilities that are designed to maintain performance standards in most extreme hot and cold temperatures. North, south, east, west, it does not matter, Safe-T-Plus can manage any of your road travels.

