

PLATINUM[®]

OWNER'S MANUAL

SECTION 2

SAFETY GUIDELINES, WEIGHTS & TOWING

Section 2 - Safety Guidelines, Weights & Towing:

R.V.I.A.	2-2
Safety Labels	2-3
General Safety	2-4
L.P. Gas Detector	2-5
Carbon Monoxide Detector	2-7
Smoke Detector	2-9
Fire Extinguisher	2-11
Specifications & Floor Plans	2-13
Certification Labels	2-17
Vehicle Weight Distribution	2-18
Weight & Towing	2-19
Towing Guidelines	2-20
Recommended Tire Pressures	2-21

RECREATIONAL VEHICLE INDUSTRY ASSOCIATION



Coach House RV is a proud member of the RVIA (Recreational Vehicle Industry Association).

The RV Industry Association's standards inspection program is one of the organization's signature industry initiatives and its greatest member benefit. The standards department maintains a professional team of full-time inspectors that promote the enhancement of safety by monitoring adherence to the standards adopted by the Board of Directors for the construction of RVs and Park Model RVs. The team conducts more than 2,000 unannounced inspections of member company RV manufacturing plants annually and is committed to providing educational resources, and hands-on training to manufacturer members to support their commitment to comply with these adopted codes and standards.

SAFETY

Safety, comfort, and ease of operation are key considerations during the design and manufacture of all Coach House Rvs.

It is the responsibility of the owner and operator to read, understand, and follow all instructions in this manual, all appliance/equipment system manuals located in the packet at the back of this manual and be familiar with all labels or signs in the motorhome. Specific items, procedures or instructions are identified with the key words “DANGER”, WARNING, and “CAUTION” which emphasize areas of special concern. These key words are defined as follows:



DANGER - Indicates a hazardous situation which, if not avoided, **WILL** result in serious injury or death.



WARNING - Indicates a hazardous situation which, if not avoided, **COULD** result in serious personal injury or death.



CAUTION - Indicates a hazardous situation which, if not avoided, **COULD** result in minor or moderate personal injury and/or damage to the motorhome.



NOTICE - Identifies hazards not related to personal injury.

The safety symbol,  used in conjunction with the DANGER, WARNING, and CAUTION labels identifies an area that involves the personal safety of the operator, passengers, or bystanders. Read, understand and follow the instructions and information in the safety label, sign or manual. Do not take chances with safety. Most accidents are preventable.

Follow the safety precautions outlined in this manual, but keep in mind that the manual may not cover all situations. Every person who occupies the motorhome or operates any of its components, devices or sub-assemblies must be familiar with this manual and the manuals in the “Packet” at the back. Every operator and occupant is responsible for following all safety items covered in this and other manuals.

GENERAL SAFETY

- The most important safety feature on your motorhome is a safe and knowledgeable operator. It is the operator's responsibility to read, understand and follow all the safety and operating instructions in the operator's, chassis, appliance and system manuals. Most accidents that involve motorhomes are preventable.
- An operator who has not read and understood all operating and safety instructions is not qualified to operate the motorhome.
- Untrained or uninformed operators and occupants expose themselves, passengers and other drivers to possible injury or death, and they subject the motorhome, other vehicles and property to potential damage.
- Do not modify the motorhome in any way. Unauthorized modifications may impair the function and/or safety of the motorhome.
- All driver and passenger seats are equipped with seat belts. Occupied seats must be locked in the forward facing direction when the motorhome is moving, and passengers may occupy only approved seats with the seat belt securely fastened. Do not allow any passengers to travel in the motorhome unless they are in an approved seat with the seat belt secured. Motorhome seats with seat belts installed by the manufacturer are the only seats approved and safe for travel.
- Always fasten the seat belt low on the torso and keep it snug to transmit the force from the belt into the hip/pelvic region of the body. Pregnant women should wear a lap/shoulder belt whenever possible. Wear the belt snug and low throughout the pregnancy.
- Establish a monthly fire extinguisher inspection program to ensure the extinguisher is fully charged and in proper working condition. Inspect the extinguisher prior to each time you operate or occupy the motorhome.

ALARMS

All models are equipped with LP gas, carbon monoxide and smoke alarms as standard safety equipment.



Recurring alarms indicate the slow accumulation of LP gas, carbon monoxide or smoke and may warn of low battery levels. Have an authorized service center check the system and identify the source of the alarm. Correct the problem before using the motorhome. Keep all alarms in good working order. For detailed information, refer to the alarm manuals provided in the package at the back of this manual.

LP GAS DETECTOR

The L.P. Gas detector is mounted at the base of the galley.

L.P. Gas is heavier than air and will fall. It also has an odor additive which smells like rotten eggs so that it is readily detected when a leak is present. Check the operation of your detector on a regular basis to ensure it is working properly.

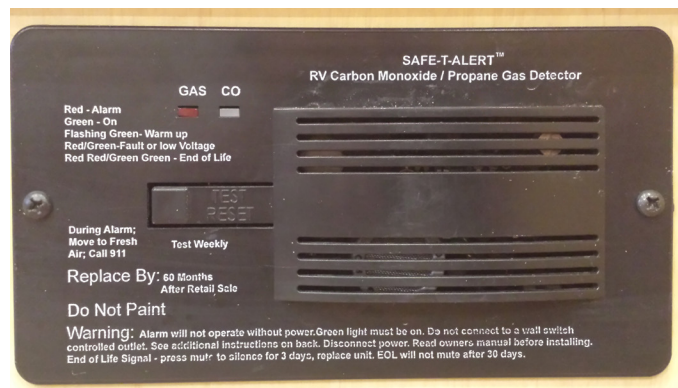

The L.P. alarm sounds whenever there is an unsafe amount of L.P. Gas in the motorhome. If the L.P. monitor sounds an alarm, follow these steps:

1. Follow instructions on the safety label and air out the vehicle, Press the “Reset” button to silence the alarm.
2. Have a qualified service center find the leak and correct the problem before using the motorhome.
3. Refer to the “LPG System” section in this manual and L.P. Gas Alarm owner’s manual.
4. Test the CO/L.P. gas alarm after removing the motorhome from storage, before each trip and weekly thereafter.

IMPORTANT: This unit must be replaced within five (5) years of its production date. Record the manufacture date in the section of the manual named Owner’s Replacement Record. The replacement date indicates the date beyond which the device may no longer detect carbon monoxide.

PARKER SOLENOID VALVE

5. Your L.P. Detector is installed with an electric Solenoid Valve which will shut off the flow of L.P. Gas to your motorhome in the event that the L.P. Detector senses gas. This automatic valve will help deter the harmful effects of unwanted L.P. Gas inside your motorhome. In the event that your L.P. Detector trips, open all windows and doors to immediately “FLUSH” the air inside your motorhome.



WARNING

If you smell gas, immediately follow these steps:

1. Extinguish open flames, pilot lights and all smoking material.
2. Do not touch any electrical switches.
3. Shut off L.P. Gas tank valve.
4. Open doors, windows, and roof vents after making sure the roof vent fans are “OFF”.
5. Leave the motorhome and it's immediate vicinity until odor is gone.
6. Have a qualified service technician check the system for leaks and make any necessary corrections and repairs.

NOTE: Do NOT remove label.

CARBON MONOXIDE DETECTOR

A carbon monoxide detector is mounted on the Passenger Side Overhead Cabinet above the bed.

The coach battery powers the detector and 3 amp fuses located behind the panel on which the detector is mounted, protect the unit. A green light on the detector front indicates that it is operating and any failure in the light should be investigated and remedied immediately. The detector should be tested on a regular basis as per the manufacturers instructions.

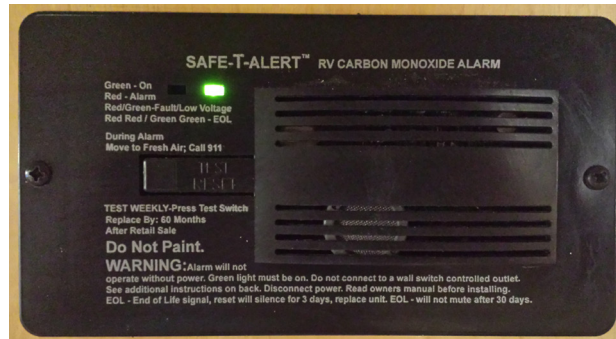

IMPORTANT: This unit must be replaced within five (5) years of its production date. Record the manufacture date in the section of the manual named Owner's Replacement Record. The replacement date indicates the date beyond which the device may no longer detect carbon monoxide.



DANGER

Carbon Monoxide is a colorless and odorless gas that is lethal to humans and pets. Do not breathe heating or cooking fumes or engine exhaust to prevent asphyxiation.



WARNING

Use of the motorhome is not recommended without a working LP and CO gas detector installed..



WARNING

Test these alarm operations after each storage period, before each trip and at least once a week during use.

FUEL AND PROPANE SAFETY



DANGER

Turn off all pilot lights, appliances and appliance igniters before refueling motorhome fuel or propane tanks. Failure to comply could result in death or serious injury.



WARNING

Do NOT place or store flammable liquids on board the motorhome, because fire or explosion may result. Failure to comply could result in serious injury or death.

Propane containers are equipped with safety valves that relieve excess pressure by discharging explosive gas into the atmosphere.

SMOKE DETECTOR

A smoke detector is mounted near the ceiling, behind the driver's front seat. The detector is battery (9 volt) operated and should be tested on a regular basis. Refer to the manufacturers instruction sheet, enclosed in this section, for the proper testing procedure and battery replacement. The smoke detector should be tested after each time the motor home has been in storage, before each use and at least once each week during use of the motor home. Smoke detectors should be replaced periodically as per the manufacturer's instructions.

The smoke detector sounds whenever there is an unsafe amount of smoke in the motorhome. Always open the roof vent before cooking.



**Have an escape plan and test it before using the motorhome!
Identify the emergency exits.**

If alarm sounds:

- Locate the source of smoke - if in doubt, evacuate immediately.
 - Open doors windows and roof vents to air out the motorhome and silence the alarm.
 - Eliminate the source of the smoke.
 - Replace the battery at least once a year, and test the smoke detector after battery replacement.
-
- Test the smoke alarm after removing the motorhome from storage and before each trip by depressing the test button, and weekly thereafter.
 - Test the smoke alarm sensor by blowing smoke from a safe source past the sensor. If the alarm does not sound identify and correct the problem or replace the smoke detector.
 - Make sure the wires are correctly connected to the battery. Position and close cover.
 - If you suspect the smoke alarm is not functioning properly, replace the alarm. DO NOT ATTEMPT TO REPAIR IT.

Regardless whether the Smoke Detector appears to be functioning correctly, it should be replaced in 10 years with a new unit specified for RV use.

SMOKE DETECTOR CONT'D



WARNING

Do NOT remove the battery to silence the alarm. If alarm “beeps” every minute, the battery is weak and requires replacement. Do not allow the battery to go dead. Use only recommended replacement batteries (see Smoke Detector operator’s manual.)



NOTICE

Smoke alarms are not perfect and do not respond in all situations. The best safeguard is fire prevention.

FIRE PREVENTION

Fires can start in a variety of ways including, but not limited to: smoking, malfunctioning appliances or equipment, placing flammable materials on hot surfaces, etc. It is best to prevent fires, but be prepared to extinguish a fire if necessary. Review the following sections with all operators and occupants on a regular basis.



CAUTION

Any exterior heat source (BBQs, space heaters, etc.) must be positioned away from the sidewall and directed away from the motorhome.

FIRE SAFETY TIPS:

1. Establish and maintain good housekeeping practices. Never allow combustible materials to accumulate in or around the motorhome.
2. Do NOT place or store flammable liquids on board the motorhome, because fire or explosion may result. Failure to comply could result in serious injury or death.
3. Have fully charged fire extinguishers readily available.
4. Avoid using flammable products in the motorhome.
5. Never smoke in bed or when relaxing on the couch.
6. Do not overload electrical outlets.
7. Do not leave food unattended when cooking.
8. Keep children away from electrical outlets and L.P. gas controls.
9. If there is a fire, evacuate everyone immediately. Use your fire extinguisher if safe to do so and close all L.P. gas valves if possible. Call the fire department and stay a safe distance away from the motorhome until the fire officials declare it safe.

FIRE EXTINGUISHER

A fire extinguisher is located in your Coach House PLATINUM III just inside the passenger door to the left. The gauge on the unit should be checked periodically for pressure level. If the indicator is in the red, the unit should either be re-charged or replaced.



WARNING

Stay a safe distance from the fire and near an exit. Stay close to the floor to avoid heat and fumes. The chemical from the fire extinguisher will shoot at least 10 feet.

OPERATION:

1. Pull the safety pin and grasp the fire extinguisher firmly while holding it in an upright position.
2. Aim the fire extinguisher nozzle at the base of the fire. Do not spray the smoke or flames.
3. Squeeze the handle to release the extinguishing agent.
4. Sweep the extinguisher from side to side until the fire appears to be out.



WARNING

After the fire is out, beware of flashback. Flashback occurs when flammable vapors from combustible liquids spread back to the ignition source and reignite the fire.

5. Once the fire is completely extinguished, discharge the fire extinguisher entirely and get it recharged, or replaced, immediately. (See detailed instructions in the manual in the INFORMATION KIT.

FIRE EXTINGUISHER CONT'D



WARNING

Use of the motorhome is not recommended without a working fire extinguisher installed.

FUNCTION:

Fire extinguishers are designed to put out fires in its initial stages. Once you cannot get within 10 feet of the fire, it is out of control and too big to fight with your extinguisher.

Do not discharge your fire extinguisher to test it. Once it is discharged, even for a few seconds, it will lose pressure and become useless.

Periodically check the pressure gauge on your fire extinguisher. If it loses pressure, the dry chemical will not effectively discharge. Do not operate or occupy the motorhome without a fully charged fire extinguisher.

Establish a monthly fire extinguisher inspection program to ensure the extinguisher is fully charged and in proper working condition. Inspect the extinguisher prior to each time you operate or occupy the motorhome.



NOTICE

If the pointer on the pressure gauge is not in the operating range, immediately replace the extinguisher. Record the inspection date on the tag provided.

SPECIFICATIONS & FLOOR PLANS

PLATINUM SPECIFICATIONS

	<u>220</u>	<u>261XI</u>	<u>271XL</u>	<u>272XL</u>
Wheelbase	158"	176"	176"	176"
Overall Length	23'-2"	26'-10"	26'-10"	26'-10"
Overall Width	8'-0"	8'-0"	8'-0"	8'-0"
Overall Width w/Slides Extended	NA	10'-4"/10'-9"	10'-4"	12'-5"
Overall Height including AC	10'-5"	10'-5"	10'-5"	10'-5"
Interior Headroom	6'-3"	6'-3"	6'-3"	6'-3"
GVWR (max weight of loaded vehicle)	14,500	14,500	14,500	14,500
GCWR (max weight of loaded vehicle plus tow)	22,000	22,000	22,000	22,000
Rear axle ratio	4.56:1	4.56:1	4.56:1	4.56:1
Interior Storage (cu.ft.)	48	71	61	62
Exterior Storage (cu.ft.)	13.5	18	16.5	16.5
Fuel tank (gal)	55	55	55	55
Fresh water (gal)	24	24	31	31
Grey water (gal)	27	27	27	27
Black water (gal)	26	26	27	27
Propane tank (pounds/gal)	68/15	68/15	68/15	68/15

1. The height of the motorhome is measured from the ground to the top of the highest standard component and is based on the UVW of a typically equipped motorhome. The actual height of your may vary depending on chassis, equipment, build variations or tire pressures. It is important that you know the actual height of your motorhome.

2. The load capacity of your motorhome is designated by weight, not by volume, so you cannot necessarily use all available space when loading your motorhome.

3. Tank capacities are based on measurements prior to tank installation. Slight variations may occur due to tank shrinkage or expansion.

4. Actual filled propane tank capacity is 80% of listed capacity due to overfilling prevention device on tank.

220 TB Twin Bed (no slideout)

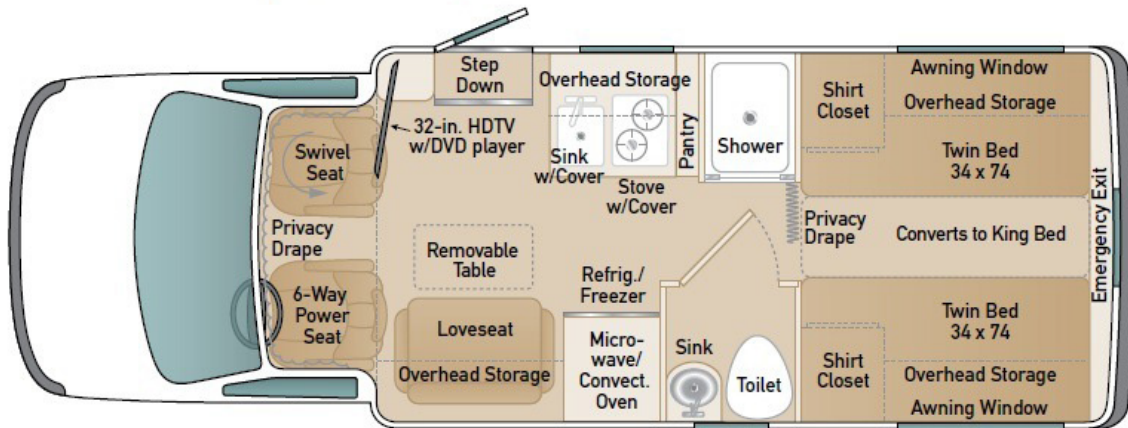

261XL QD Queen Dinette with slideout

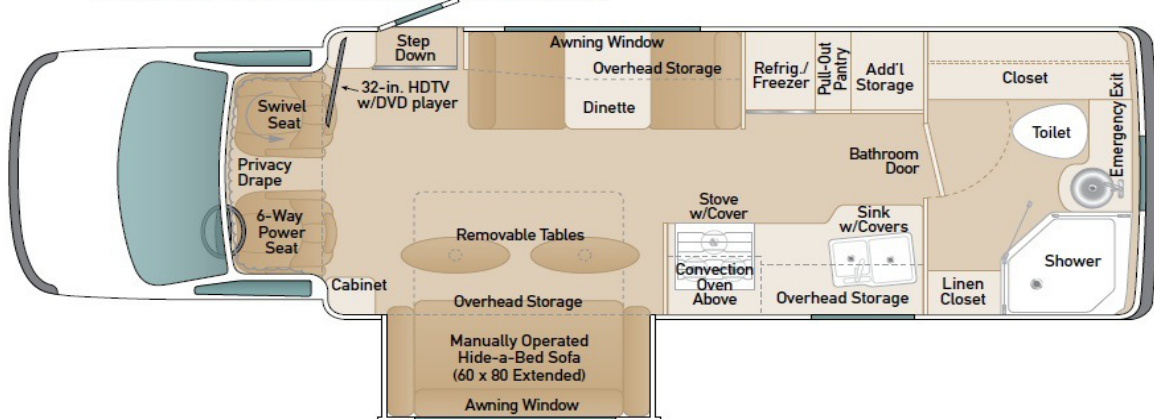

261XL DT Dinette Twin with slideout

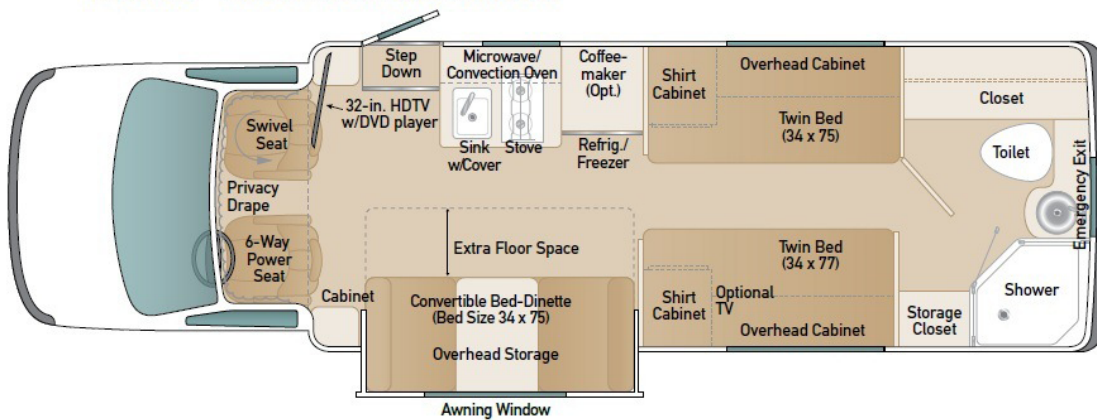

The floor plan of the 2014 Jayco Jay Flight 34BH motorhome is shown. The layout includes a front living area with a 32-inch HDTV w/DVD player, a swivel seat, a privacy drape, and a 6-way power seat. The kitchen area features a sink w/covers, drawers below, a stove w/cover, a convection oven above, a coffee maker above, a refrigerator/freezer, and a pantry. The sleeping area has two twin beds (34 x 80 and 34 x 77), a nightstand, and optional TV overhead cabinets. A shower and a folding shelf are also shown. The plan includes awning windows, an emergency exit, and various storage options like overhead cabinets and a convertible bed-dinette (34 x 72).



The floor plan of the 2012 Jayco Jay Flight 28 includes the following features:

- Front Cab:** 32-in. HDTV w/DVD player, Swivel Seat, Privacy Drape, 6-Way Power Seat, Cabinet.
- Living Area:** Swivel Recliner, Removable Tables, Power Sofa-Bed (54' x 72' Extended) or Dual Recliner, Overhead Storage.
- Kitchen:** Sink w/Covers, Drawers Below, Stove w/Cover, Convection Oven Above, Coffee Maker Above, Refrig./Freezer, Pantry.
- Bedroom:** Twin Bed (34" x 80"), Nightstand, Privacy Drape, Twin Bed (34" x 77"), Optional TV, Overhead Cabinet, Shirt Cabinet.
- Bathroom:** Shower, Folding Shelf.
- Windows:** Awning Window (Front and Rear).
- Emergency Exit:** Located at the rear.

272XL FD Front Dinette with two slideouts

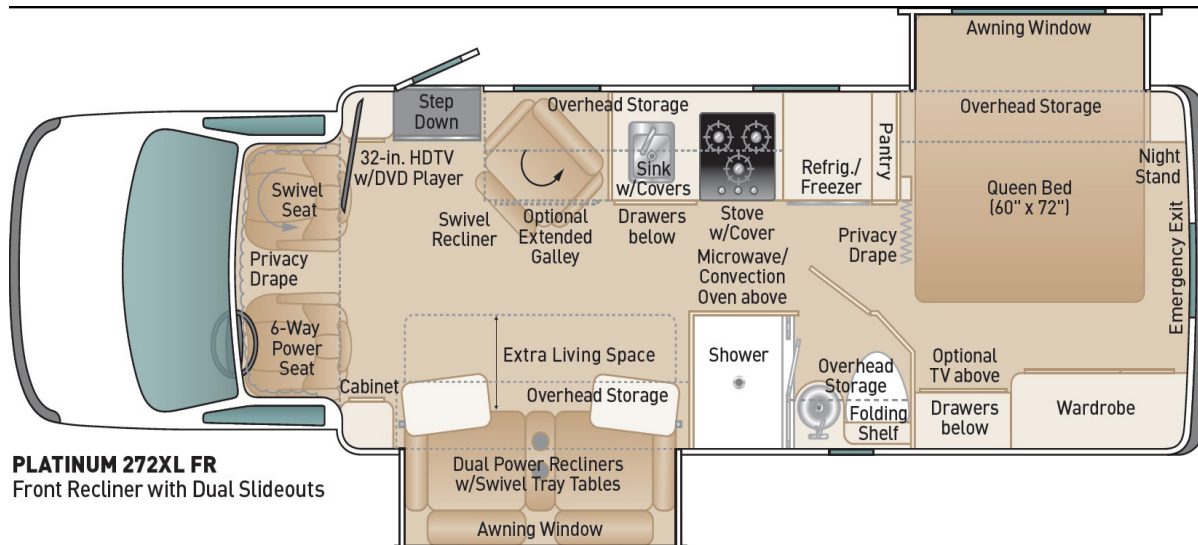
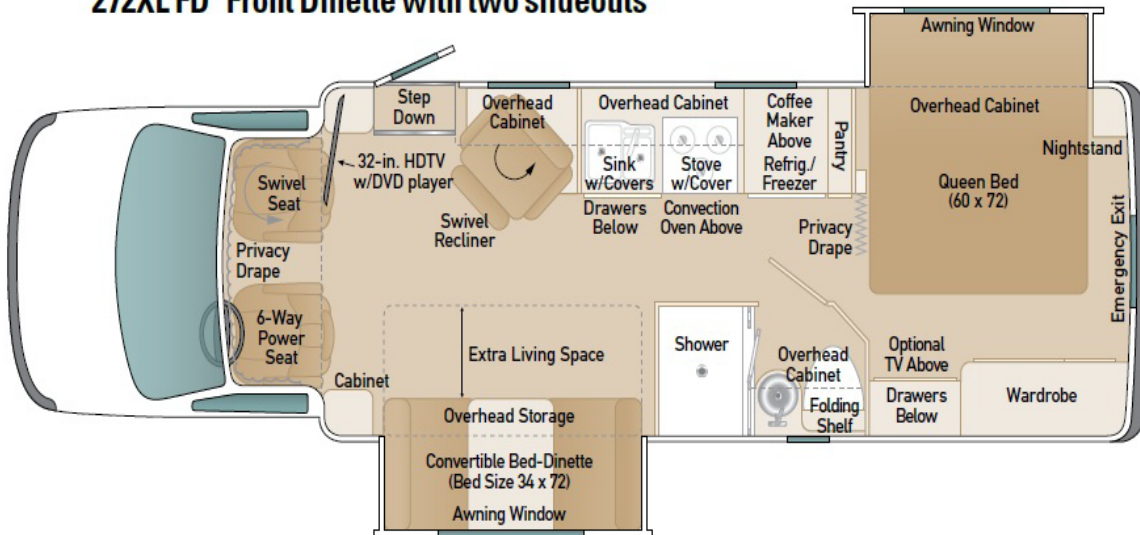

PLATINUM 272XL FR
Front Recliner with Dual Slideouts

272XL FS Front Sofa with two slideouts

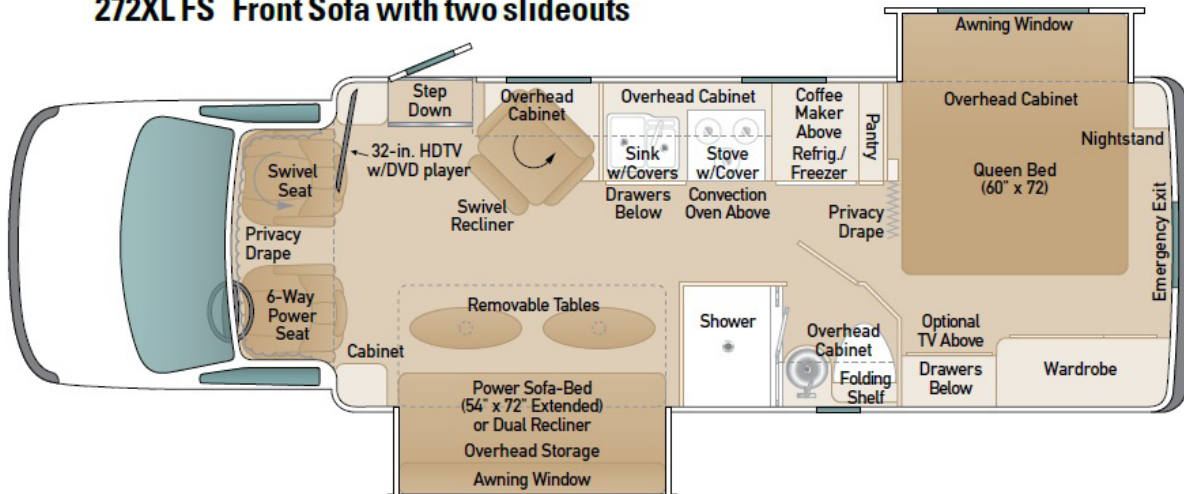

VEHICLE CERTIFICATION LABELS

The vehicle certification labels affixed to your motorhome contain identification and other important reference information. Never remove or destroy these labels. The labels are located on the driver door frame.

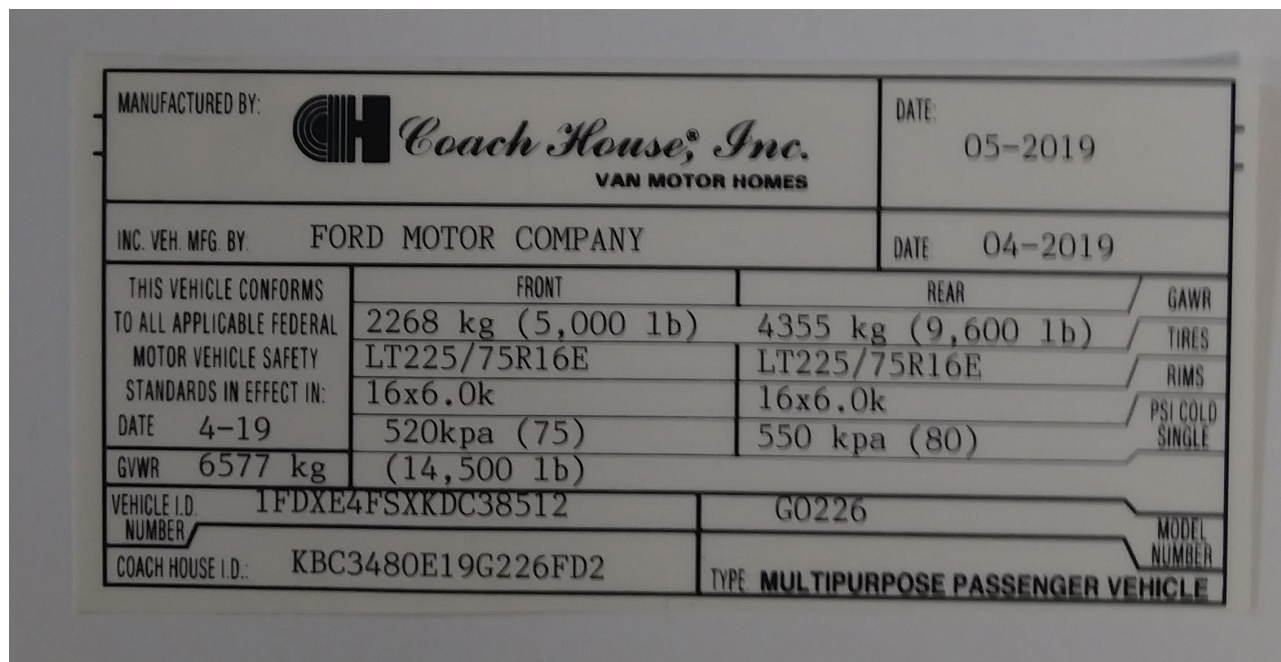
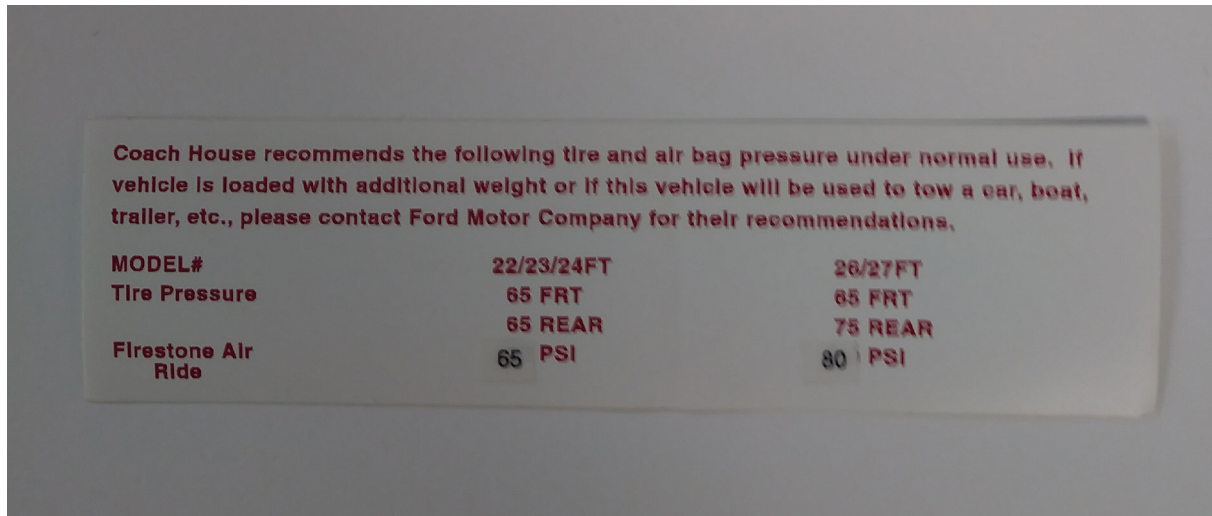

Vehicle Weight Distribution

To properly load your vehicle, first determine its empty weight axle by axle and compare this with the GROSS AXLE WEIGHT RATING (**GAWR**), which can be found on the FMVSS sticker located on the driver's door column.

Try to load your vehicle in a manner that proportionally loads the axles according to their available loading capacity. Make sure that your total weight does not exceed the GROSS VEHICLE WEIGHT RATING (**GVWR**) for your vehicle. Be aware that the total of the axle ratings (GAWR) can add up to more than the GVWR. Side to side weight distribution should be considered when loading your vehicle and adjustments made as deemed suitable.

It is recommended that you weigh your vehicle axle by axle when fully loaded especially if the load is close to the OCCUPANT & CARGO CARRYING CAPACITY (OCCC) indicated on the Motorhome Weight Information label for your vehicle. Ensure that none of the stipulated weight capacities have been exceeded. After weighing, make any load adjustments necessary to insure proper vehicle handling and performance.

Towing and Combined Weight

The GROSS COMBINED WEIGHT RATING (**GCWR**) is defined as the maximum permissible gross weight of the vehicle and trailer. See the following page for information about towing.



Quick Facts

<u>Gross Vehicle Weight Rating</u>	G.V.W.R.	14,500 lbs.
<u>Gross Axle Weight Rating (Front)</u>	F.A.W.R.	5,000 lbs.
<u>Gross Axle Weight Rating (Rear)</u>	R.A.W.R.	9,600 lbs.
<u>Gross Combined Weight Rating</u>	G.C.W.R.	22,000 lbs.



CAUTION

Total vehicle load must NOT exceed the maximum GVWR/GAWR/GCWR of the chassis

WEIGHT AND TOWING

Labels similar to the samples shown below have been placed on the inside of the passenger side door with weight information for your vehicle. If “CALC” appears after the UVW part of the label, this indicates that the UNLOADED VEHICLE WEIGHT has been calculated by using typical completed model actual weights and making adjustments for certain options.

MOTOR HOME OCCUPANT AND CARGO CARRYING CAPACITY VIN: XXXXXXXXXXXXXXXX
THE COMBINED WEIGHT OF OCCUPANTS AND CARGO SHOULD NEVER EXCEED
XXXX kg OR XXXX lbs..

SAFETY BELT EQUIPPED SEATING CAPACITY: 2

CAUTION:

A FULL LOAD OF WATER EQUALS XXX kg OR XXX lbs.. OF CARGO @ 1kg/L (8.3 lb/gal)
AND THE TONGUE WEIGHT OF A TOWED TRAILER COUNTS AS CARGO

CAUTION:

LOAD CARRYING CAPACITY REDUCED
MODIFICATIONS TO THIS VEHICLE HAVE REDUCED THE ORIGINAL LOAD CARRYING CAPACITY BY

_____ kg OR _____ lbs..

TOWING GUIDELINES

To determine the towing capability of your vehicle, first refer to the chassis manufacturers Owners Manual and/or manufacturers literature that covers your vehicle. Information on your vehicle you need to know is the GROSS COMBINATION WEIGHT RATING (**GCWR**), maximum trailer weight, maximum tongue weight, and the weight of your vehicle fully loaded. After determining the above information, you can calculate the maximum size trailer you can tow by subtracting your loaded vehicle weight from the GCWR and compare the answer with the maximum trailer weight for your vehicle. Whichever figure is **SMALLER** will determine the maximum towing capacity (Loaded Trailer Weight) for your vehicle.

It is important to make sure that the tongue weight for your loaded trailer does not exceed the chassis manufacturers rating. Also check the capacity of the hitch installed to make sure you have not exceeded its rating.



Universal Motor Home Hitch

Maximum Trailer Weight (Class III Hitch)	3500 lbs...
Maximum Tongue Weight	200 lbs...

* NOTE: This maximum trailer weight only applies if the trailer has a separate braking system. Refer to the Ford "Operating Instructions" for more detailed information.

GCWR (Gross Combined Weight Rating) minus loaded vehicle weight (including tongue weight) = Maximum allowable trailer weight.

Example:	GCWR	22,000 lbs..
	Loaded vehicle weight (including tongue weight)	<u>14,500 lbs..</u>
	Maximum trailer weight	3,500 lbs..

RECOMMENDED TIRE PRESSURES

Maintaining the correct air pressure in your tires is vital to the smooth operation and safety of your vehicle. Please refer to the chart below for the recommended air pressure in the front and rear tires.

ALL MODELS

FRONT (PSI)

REAR (PSI)

75

80

Look for tire pressure label on driver's side door jamb.