



*Coach House*

**PLATINUM III**

## **Section 8**

### **Optional Equipment**

*Ford Motor Company*

Rev: 082319

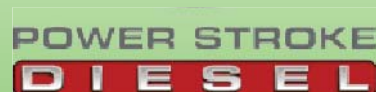



# Optional Equipment

Solar Battery Charger	.....	8-5
Radio / Backup Camera	.....	8-9
Power Sofa/Bed	.....	8-11
Legless Motorized Awning	.....	8-13
Legless Motorized Awning Manual	.....	8-15
Bose Soundbar System	.....	8-21
Heated Holding Tanks	.....	8-23



# Solar Battery Charger

The solar charger will charge the auxiliary batteries with the master 12 Volt switch in the “on” or “off” position. A Charge Controller will optimize the charging rate and cut off the charging current when the batteries are fully charged. Optimal charging will be obtained in direct sunlight.



The charge controller panel is located just inside the entry door to the right. It will show the status of the charging system and the status of the “house” battery circuits. Refer to the Carmanah manual for instructions.







## **Solar Module and Controller**

<b>Solar cell type</b>	<b>Monocrystalline</b>
<b>Output power</b>	<b>190 W</b>
<b>Rated current</b>	<b>8.84 A</b>
<b>Rated DC voltage</b>	<b>18.42 V</b>
<b>Open-circuit voltage</b>	<b>22.77 V</b>
<b>Module efficiency</b>	<b>16.4%</b>
<b>Connectivity</b>	<b>MC4 connectors</b>
<b>Solar controller</b>	<b>30 A PWM, multi battery option, 4 stage charging, digital display and flush mount</b>
<b>Frame type</b>	<b>Clear anodized aluminum frame</b>
<b>Certifications</b>	<b>CE</b>
<b>Dimensions</b>	<b>59.1 x 26.3 x 1.57 in / 1500 x 668 x 40 mm</b>
<b>Weight</b>	<b>32 lbs / 14.5 kg</b>
<b>Warranty</b>	<b>25 years power output (module) 5 years (controller)</b>



### Digital Solar Controller SPECIFICATIONS

<b>GP-PWM-30</b>	
<b>Nominal System Voltage</b>	<b>12V</b>
<b>Max Solar Array Current</b>	<b>30A</b>
<b>Battery Voltage Range</b>	<b>6V -- 15.5V</b>
<b>Max. Solar panel input voltage</b>	<b>28V</b>
<b>Operating Consumption</b>	<b>6mA</b>
<b>Display Consumption</b>	<b>10mA</b>
<b>Temp. Compensation</b>	<b>-13mV/°F (- 24mV/°C)</b>
<b>Operating Temperature</b>	<b>- 40 to 185°F (-40 to 85°C)</b>
<b>Humidity</b>	<b>99% N.C.</b>
<b>Dimensions (H x W x D)</b>	<b>4.25 x 7.48 x 1.38 in (108 x 190 x 35 mm)</b>
<b>Weight</b>	<b>10.6 oz (300 g)</b>
<b>Maximum Wire Gauge</b>	<b>#4 AWG</b>
<b>Warranty</b>	<b>5 years</b>
<b>Protection</b>	<b>Battery Reverse Polarity, Solar Array Reverse Polarity, Over temperature, Over Current</b>



# Back-Up Camera / Radio

The FORD Trasit Chassis comes with Factory Equipped SYNC III entertainment system with Navigation.

An integrated Back-Up Camera has been installed and will come on automatically when the vehicle is shifted into "Reverse".

Please refer to the FORD owner's manual for instructions.



# Power Sofa/Bed

Optional Equipment. Power Sofa/Beds are made by Kustom Fit, a division of Villa Industries. The fabric used matches the driver and passenger chairs and has a durability rating to last a long life in your motorhome.

The power sofa/bed has 4 functions:

- 1) Move sofa away from outer wall.
- 2) Convert sofa to bed.
- 3) Move bed toward outside wall to adjoin stationary cushion.
- 4) Convert bed to sofa & move toward outside wall.

You may operate the power sofa/bed with slide-out room extended or with room not extended.

Do NOT Continue to hold the button down once the sofa has extended or retracted. You can cause damage to the gears with prolonged use.





# Dometic Legless Motorized Awning



Your Coach House Platinum III has been equipped with the Dometic 9500 series legless motorized awning. 12 volt electrical power will allow the unit to automatically retract using the “house” batteries in the event of unforeseen inclement weather.

**Make sure your Battery Cutoff Switch is in the ON position  
any time the Electric Awning is deployed.  
Damage to your Awning or Motorhome may  
occur if power is not available in the event of  
inclement weather.**

There is a motion sensor attached to the lead rail of the awning which will force the awning to retract if the motion becomes violent enough to cause damage to the unit.

The remote control for the awning is located just inside the main motorhome door on the “Tower of Power”.

Clean your awning with mild soap and water only.



# Insert Dometic Awning Manual Here







RECORD THIS INFORMATION FOR FUTURE  
REFERENCE:

Model Number \_\_\_\_\_  
Serial Number \_\_\_\_\_  
Date Purchased \_\_\_\_\_  
Retailer / Qualified Installer \_\_\_\_\_

**USA**  
SERVICE OFFICE  
Dometic, LLC  
2320 Industrial Parkway  
Elkhart, IN 46516  
574-294-2511

**CANADA**  
Dometic, LLC  
46 Zatonski, Unit 3  
Brantford, ON N3T 5L8  
CANADA  
519-720-9578

**For Service Center  
Assistance Call:**  
800-544-4881

**3313943.000  
REMOTE WALL  
CONTROL KIT**

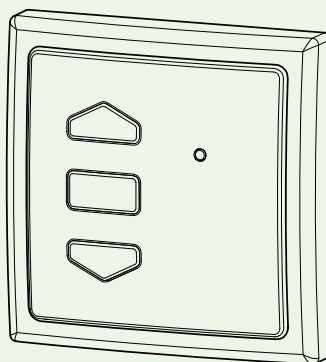

**INSTALLATION & OPERATING  
INSTRUCTIONS**

**3313943.000  
REMOTE WALL  
CONTROL KIT**

**3314042.000**

Form No. 3314042.000 02/11  
(French 3314043.000)  
©2011 Dometic, LLC  
LaGrange, IN 46761

**Important: These Instructions must  
stay with unit. Owner read carefully.**

**PLATINUM III**  
Rev: 082319

3480 Technology Drive • Nokomis • Florida  
(800) 235-0984 • (941) 485-0984 • (941) 488-4095 FAX  
[www.coachhouseserv.com](http://www.coachhouseserv.com)

8-17

## GENERAL INSTRUCTIONS

These instructions apply to:

202(XX)(XX).000(#) 9500E Cassette Awnings  
203(XX)(XX).000(#) DA20(XX) Cassette Awnings

This kit consists of:

- (1) Installation & Operating Instructions
- (1) Awning Remote Wall Control Unit with Base

Dometic, LLC reserves the right to modify appearances and specifications without notice.

2. On back of remote wall control unit, place and slide battery into battery clip until fully engaged. See FIG. 2.

**Note:** Make sure battery has positive side up.

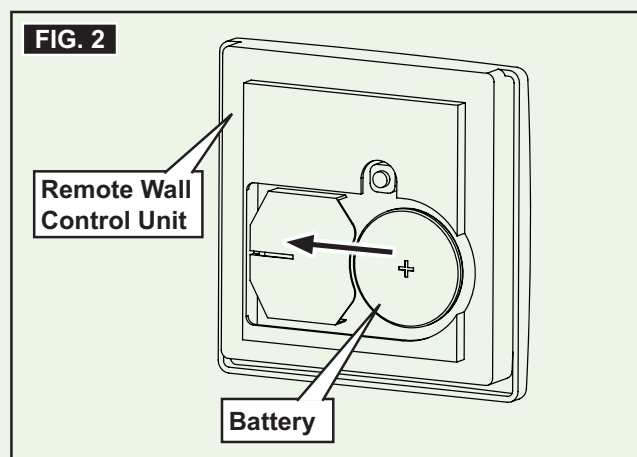

## PROCEDURE

### A. Install Remote Wall Control Unit

#### NOTICE

Do not expose remote and remote holster to weather, extreme temperatures, or long hours in direct sunlight. Failure to obey this notice could result in property damage.

1. Locate a suitable location for remote wall control base that's protected from weather and other adverse conditions, and install with two screws. See FIG. 1.

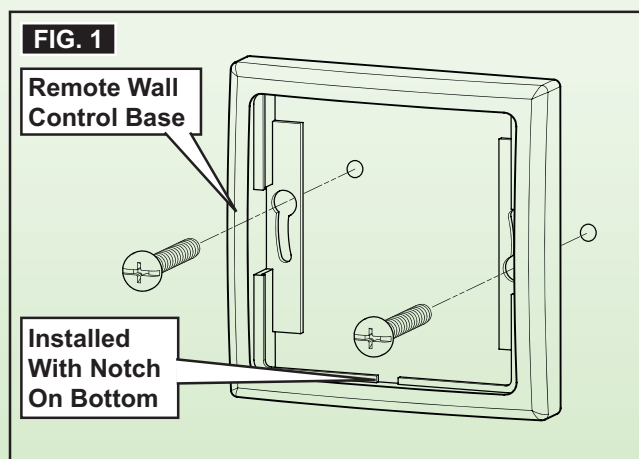

### B. Activate Remote Wall Control Unit

More than one remote may be added to operate the awning if desired.

**Note:** Refer to the operating instructions that came with your awning if this remote is a replacement, and no other remote is programmed to the awning.

1. Make sure power is supplied to awning motor.

**Note:** There should already be at least one remote programmed to the awning motor at this stage.

2. Using a remote that already controls the awning motor, press and hold the program button on back for approximately (3) seconds. Awning motor should jog momentarily. See FIG. 3.

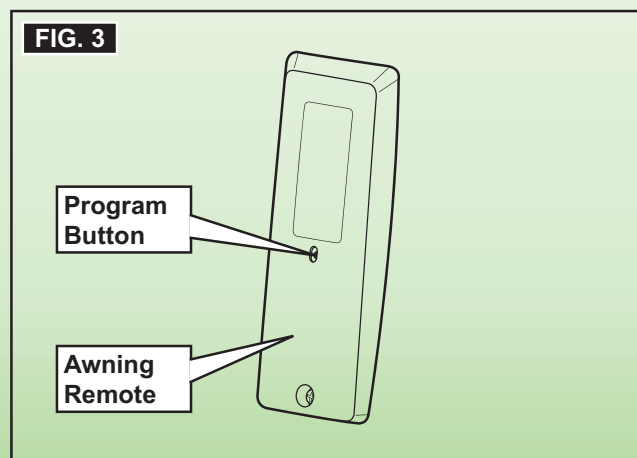

3. Press and hold the program button on back of remote wall control unit for approximately (3) seconds. Awning motor should jog momentarily. See FIG. 4.

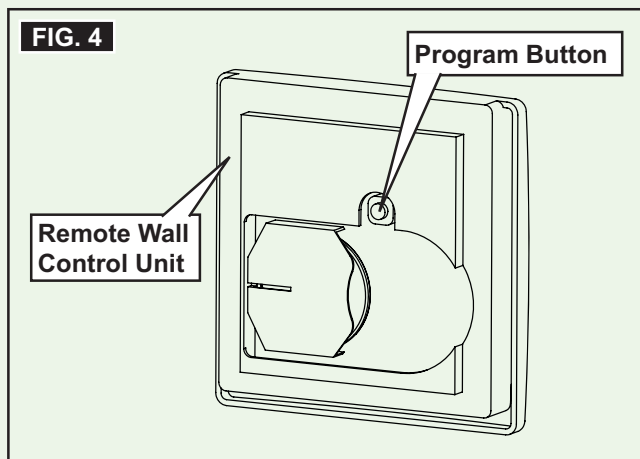

5. Install the remote wall control unit onto remote wall control base by snapping it in place. See FIG. 6.

**Note:** To remove remote wall control unit from base, use flat bladed screw driver to disengage tab at bottom notch. See FIG. 1.

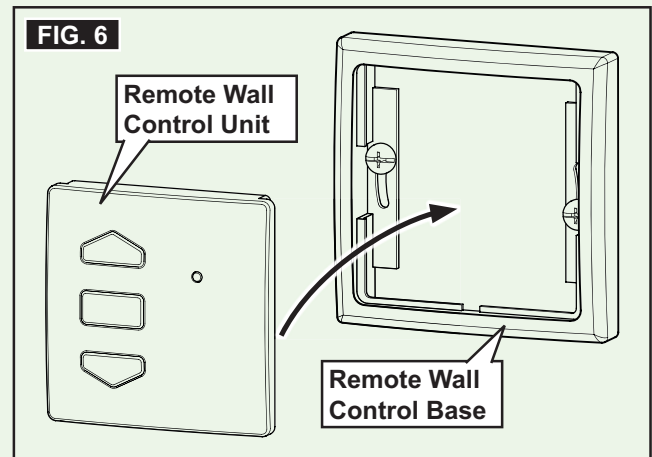

4. Verify awning motor and remote functionality.
  - a. Press the open button (down arrow) briefly on awning remote wall control unit. Awning should extend to its out limit. See FIG. 5.

**Note:** If awning does not respond, verify LED lights momentarily (on remote wall control unit) when button is pressed. If LED does not light, install new batteries.

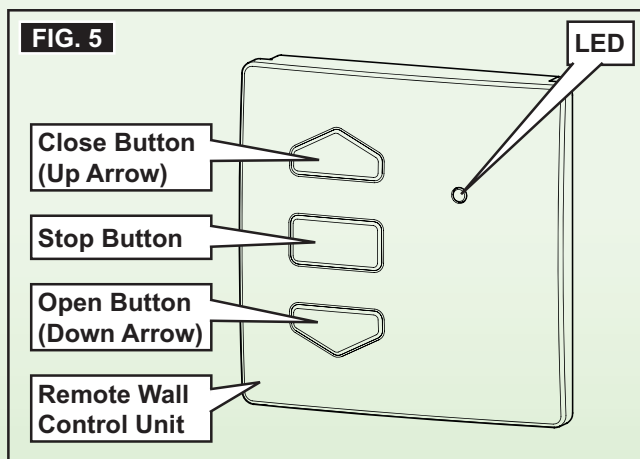

### C. Operate Remote

1. See "Procedure" under awning Operating Instructions for specific operating information.



# Bose Soundbar System



The Bose Solo 5 TV sound system is a one-piece soundbar that brings noticeably better sound to all your favorite TV programs. It's engineered to help clearly reproduce everything from dialogue to details. And for even more clarity, its dialogue mode makes every word easier to hear.

This soundbar is so versatile you can place it almost anywhere. And with Bluetooth® connectivity, you can play your favorite music wirelessly through the speaker, too.

One-piece soundbar delivers noticeably better sound than your TV alone

Dialogue mode to hear each word and detail clearly

Bluetooth technology built in for streaming music wirelessly from your phone or tablet

One connection to your TV

Universal remote controls TV, bass, Bluetooth connections and more



# Heated Holding Tanks

Heated Holding tanks are installed as optional equipment on your Coach House Platinum.

Manufactured by ULTRA HEAT INDUSTRIES, the tank heaters come in four sizes.

The larger tank heaters are equipped with a thermal sensor which will prevent the heaters from being activated unless the ambient air temperature is below 46 degrees fairenheim. This protection is to make sure your heaters do not come on inadvertently and “cook” the contents of your holding tanks.

ULTRA HEAT INDUSTRIES warrants tank heaters for a period of one year from the time of purchase and any failures should be reported directly to them at their factory.



**UHI Worldwide, Inc.**  
1314 Perkins St.  
P.O. Box 1454  
Elkhart, IN 46515-1454  
USA



## **Product Insert**

### **ONE-YEAR LIMITED WARRANTY**

All UHI stock items carry a one (1) year warranty under normal use against manufacturing defects in UHI materials and/or workmanship. The warranty coverage starts on the date of the original purchase. This Limited Warranty covers only those defects which occur or exist within the one (1) year period referenced above. Any modification of UHI products, from original design and/or intended use, or improper installation shall **VOID** all warranties.

All of UHI's obligations pursuant to this Limited Warranty are limited to replacing the product at no additional cost or issuing an account credit memo for the product's cost.

### **WARRANTY EXCLUSIONS**

**UHI MAKES NO OTHER WARRANTIES, EXPRESS OR IMPLIED, including any IMPLIED WARRANTY OF MERCHANTABILITY, FITNESS FOR A PARTICULAR PURPOSE, or NONINFRINGEMENT. In no event shall UHI be liable for special, indirect, or consequential damages arising out of the limited warranty.**

To the extent that applicable state and/or federal law prohibits the exclusion of any remedy permitted under state or federal law, any such remedy, including, but not limited to, implied warranties of merchantability, fitness, use, or purpose, is limited to **one (1) year** from the date of the original purchase.

### **PROPER USE OF TRADEMARKS**

UHI Worldwide, Inc., Ultra Heat, Inc., UltraHeat®, and Ultra-Heat™ and all individual product trademarks, service marks, logotypes, commercial symbols, insignias, and designs pertaining thereto, as they appear in any advertising medium, are proprietary marks of UHI Worldwide, Inc., and UHI owns all right, title, and interest in and to these proprietary marks. Trademarks and trade names may not be used in connection with any product or service that is not provided by UHI, in any manner that is likely to cause confusion among customers, or in any manner that disparages or discredits UHI. Purchaser shall not remove, alter, or otherwise modify any identification marks or trademarks affixed by UHI to products.

### **REPACKAGING**

UHI products shall not be repackaged without the express, written approval of UHI. Under no circumstances shall UHI product labeling be removed, obstructed, or altered.

[www.uhiworldwide.com](http://www.uhiworldwide.com)