

Coach House

PLATINUM II®

Section 8

Optional Equipment

Mercedes-Benz



3500 SPRINTER CHASSIS

Rev: 110315

Optional Equipment

Solar Battery Charger	8-5
Xantrex Pure Sine Wave Inverter	8-9
Cobra 800 Watt Inverter	8-13
Pioneer Radio / Backup Camera	8-15
Power Sofa/Bed	8-17
Motorized Awning	8-19
Motorized Awning Manual	8-21
Bose Surround Sound System	8-27
Heated Holding Tanks	8-29
Equalizer Systems Stabilizers	8-31
Hydraulic Room Extension	8-33
HWH Room Extension Manual	8-35
Dometic Slide Topper	8-37
Dometic Slide Topper Manual	8-39

Solar Battery Charger

The solar charger (95 Watt) will charge the auxiliary batteries with the master 12 Volt switch in the “on” or “off” position. A Charge Controller will optimize the charging rate and cut off the charging current when the batteries are fully charged. Optimal charging will be obtained in direct sunlight.



The charge controller panel is located just inside the entry door to the right. It will show the status of the charging system and the status of the “house” battery circuits. Refer to the Carmanah manual for instructions.





carmanah®
we put solar to work

MODEL

CTI-95

SOLAR MODULE

Reliable

The CTI-95 Solar Module from Carmanah is a high-efficiency monocrystalline solar module that provides outstanding performance and cost-effective solar power for high-end off-grid and mobile applications. Carmanah's CTI-95 Solar Module is built to last and features a 25-year limited power output warranty.

Durable

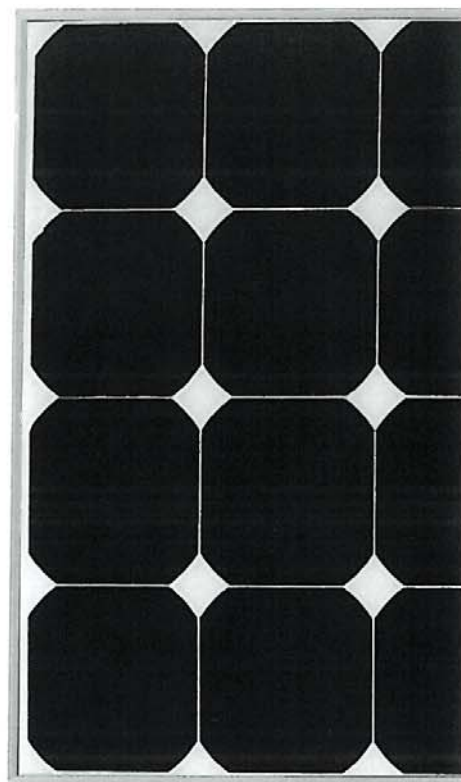
To ensure long life, the high-efficiency solar cells are encapsulated between a special tempered, low-iron solar glass and a Tedlar®/polyester backing material. The mounting frame, manufactured from anodized marine-grade aluminum, allows the CTI-95 to be installed in extreme conditions.

The CTI-95 is ideal for ...

- RV/Marine
- 12/24 Volt battery systems
- OEM
- Security Trailers
- Telecommunications
- Stand-alone or grid connected applications
- Signaling systems
- Remote telemetry
- Water pumping
- Other off-grid applications

Features:

- Compact and rugged design
- Plug and play junction box
- Lightweight anodized aluminum frame
- High transmissivity tempered glass
- MC4 cable connectors included



CTI-95 SOLAR MODULE



Carmanah is backed by a worldwide network of solar professionals.
To find a representative in your region:

- visit us at www.carmanah.com
- or call +1 250 380 0052 (toll-free US & Canada 1 877 722 8877)

REPRESENTED IN YOUR REGION BY:

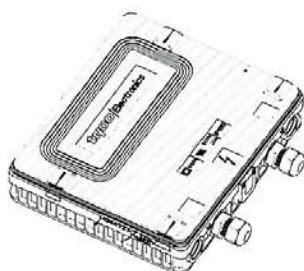
Carmanah Technologies Corp. Web: carmanah.com Email: info@carmanah.com Telephone: 1.250.380.0052 Fax: 1.250.380.0062



CTI-95

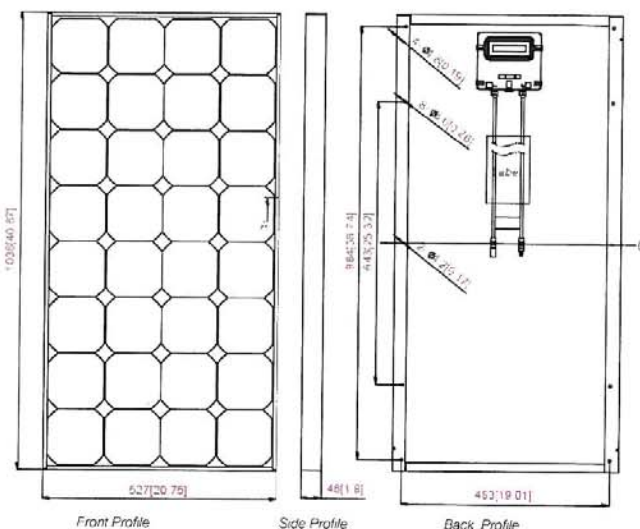
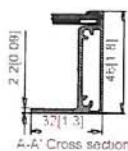
SOLAR MODULE

MODEL



Tyco Junction Box features:

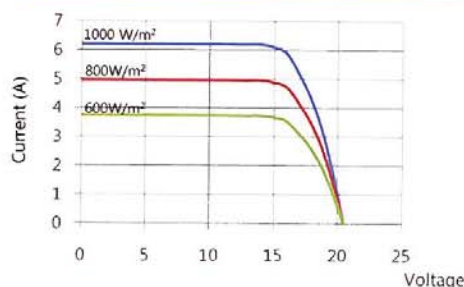
- Wire Specification: Copper; #14 AWG min.; 90 deg. C
- Min 5mm cable diameter to max 7 mm cable diameter
- Self-sealing lid
- MC4 cables included



SPECIFICATIONS

Cell type	Monocrystalline
Rated power	95 W
Maximum power voltage	17.2 V
Maximum power current	5.53 A
Open circuit voltage	20.6 V
Short circuit current	6.19 A
Voltage coefficient	-60.8mV / °C
Power coefficient	-0.38% / °C
Module efficiency	18%
Cell efficiency	20%
Series fuse rating	15 A
Max system voltage	75 V
Weight	16.3 lb (7.4 kg)
Dimensions	40.8 x 20.8 x 1.8 inches 1037 x 527 x 46 mm
Frame type / material	>15µm clear anodized aluminum frame
Fire Rating	Class C
Design load	53.3 lbs / ft ²

IV CURVE PARAMETERS



Solar Cells: High-efficiency monocrystalline cells, 32 cells in series

Maximum power tolerance: +/- 5%

Power Specifications calculated at:

Irradiance: 1000 W/m²
Cell Temperature: 77 °F (25 °C)
Air Mass: 1.5G

Carmanah Technologies Corp. • Web: carmanah.com • Email: info@carmanah.com • Telephone: 1.250.380.0052 • Fax: 1.250.380.0062

Xantrex Pure Sine Wave Inverter

The 1800 Watt Xantrex Pure Sine Wave Inverter is recognized as industry leading in power source supply. It operates from the 12V auxiliary batteries and inverts 12V power DC to 120 AC power.

The inverter has a remote control located on the main control tower located behind the passenger seat. The remote control has operation and battery condition monitoring of DC volts. Detailed information on the inverter and the remote control are included in the Xantrex owner's manual.

***** The inverter shut-off is NOT automatic. The inverter may be ON which will result in running down the auxiliary batteries. *****



PROsine™ 1000/1800 Sine Wave Inverters

xantrex™



Provides 1000 and 1800 watts of sine wave AC power from a DC source

Offering superior quality true sine wave output, the PROsine™ 1000 and 1800 stand-alone inverters are ideally suited for electrical systems that already have a quality multistage battery charger. Designed for recreational and industrial applications, their 120-volt, 60 Hz AC power output is capable of handling both heavy duty and smaller, multiple AC loads. PROsine inverters include a backlit LCD display panel, which can be mounted remotely.

Product Features

- ▶ 1000 and 1800 watt inverters (1500 and 2900 watt surge capability)
- ▶ True sine wave AC output (crystal controlled)
- ▶ Removable LCD display can be mounted remotely for control and monitoring
- ▶ Unique DC terminals offer 180-degree connections for easy installation in tight places
- ▶ Powersave mode draws only 1.5 watts under no load
- ▶ Two year warranty

Protection Features

- ▶ Over temperature shutdown and automatic overload protection
- ▶ Over voltage and under voltage protection
- ▶ Short circuit and AC backfeed protection

Options

- ▶ Available in 12 and 24 volt models
- ▶ Models available with GFCI AC outlet or AC hardwire terminal strip for permanent installation into an electrical system (optional 15 A transfer switch available with hardwire option)
- ▶ Remote interface kit for remote mounting of display module

Ultra-clean true sine wave power

- ▶ With less than 3% total harmonic distortion, PROsine 1000 and 1800 inverters deliver true sine wave output that is identical to AC power supplied by your utility. This clean output makes PROsine inverters ideal for handling sensitive loads and improves AC equipment performance. Expect trouble-free true sine wave electricity for televisions, audio systems, variable speed tools, and more.

Light and compact

- ▶ PROsine inverters are lighter and more compact than other inverters with similar power ratings because they use high-frequency switching technology in the power conversion process.



CSA/NRTL certified to UL & CSA standards

Xantrex Technology Inc.

Headquarters
8999 Nelson Way
Burnaby, British Columbia
Canada V5A 4B5
800 670 0707 Toll Free
604 420 1591 Fax

541 Roske Drive, Suite A
Elkhart, Indiana
USA 46516
800 446 6180 Toll Free
574 294 5989 Fax

www.xantrex.com

© 2004 - 2008 Xantrex Technology Inc. All rights reserved. Xantrex, Smart choice for power and PROsine are trademarks of Xantrex International, registered in the U.S. and other countries.

Printed in Canada

PROsine 1000 Watt and 1800 Watt Sine Wave Inverters

Electrical Specifications

Models	PROsine 1000	PROsine 1800
Output power	1000 W	1800 W
Surge rating	1500 W	2900 W
Output current (peak)	25 A	45 A
Output voltage (at no load)	120 Vac \pm 3%	120 Vac \pm 3%
Output voltage (over full load and battery voltage range)	120 Vac RMS -10%/+4%	120 Vac RMS -10%/+4%
Output frequency	60 \pm 0.05 (crystal controlled)	60 \pm 0.05 (crystal controlled)
Output waveform	True sine wave (<3% THD)	True sine wave (<3% THD)
Peak efficiency (12 V/24 V)	89% / 90%	89% / 90%
No load power draw (search mode)	<1.5 W	<1.5 W
No load power draw (idle mode)	<22 W	<22 W
Input voltage range (12 V/24 V)	10 – 16 Vdc / 20 – 32 Vdc	10 – 16 Vdc / 20 – 32 Vdc
Transfer relay rating (hardwire/transfer relay models)	15 A	15 A
Transfer time AC to inverter and inverter to AC	Max 2 cycles (typically 1 cycle) <2.5 seconds with Powersave "ON"	Max 2 cycles (typically 1 cycle) <2.5 seconds with Powersave "ON"

General Specifications

Operating temperature range	32°F – 140°F (0°C – 60°C)	32°F – 140°F (0°C – 60°C)
Storage temperature range	-22°F – 158°F (-30°C – 70°C)	-22°F – 158°F (-30°C – 70°C)
AC output types	Dual GFCI receptacle	Dual GFCI receptacle
	Hardwire	Hardwire
	Hardwire with transfer relay	Hardwire with transfer relay
LCD display panel	Removable; can be mounted remotely (requires remote interface kit - see part number section)	Removable; can be mounted remotely (requires remote interface kit - see part number section)
	Displays DC volts, amps and output power	Displays DC volts, amps and output power
Recommended DC fuse	12 V: 150 A or 175 A* 24 V: 70 A or 90 A* *Depending on applicable installation codes	12 V: 225 A or 300 A* 24 V: 100 A or 150 A* *Depending on applicable installation codes
Dimensions (H x W x D)	4.5 x 11.0 x 15.4" (115 x 280 x 390 mm)	4.5 x 11.0 x 15.4" (115 x 280 x 390 mm)
Weight	14.5 lb (6.5 kg)	16.5 lb (7.5 kg)
Warranty	Two year	Two year
Part Numbers		
12-volt		
GFCI outlet	806-1000	806-1800
Hardwire with transfer relay	806-1002	806-1802
24-volt		
GFCI outlet	806-1050	806-1850
Hardwire with transfer relay	806-1052	806-1852
Remote interface panel	808-1800	808-1800
Wiring cover	808-1801	808-1801

Regulatory Approvals

CSA/NRTL certified to CSA 107.1, UL 458 (including Marine supplement)

KKK-A-1822D: Federal specification for use on ambulances

Designed to meet ABYC E8, E9, A25 for marine applications

Note: Specifications subject to change without notice.

Cobra 800 Watt Inverter

The Cobra CPI 880 - 800 Watt inverter is available on Coach House Platinum II models.

It operates from the 12V auxiliary batteries and inverts 12V power DC to 120 AC power.

The inverter is located in the overhead cabinet above the driver's seat. The on/off switch is located on the front of the unit.

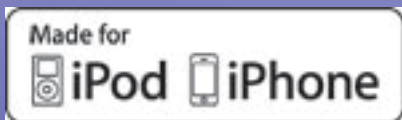
***** The inverter shut-off is NOT automatic. The inverter may be ON which will result in running down the auxiliary batteries. *****



Back-Up Camera / Radio



The AVH-P4400BH DVD multimedia receiver features a 7" motorized touchscreen display, built-in Bluetooth® for hands-free calling and audio streaming, and an HD Radio™ tuner. The newly updated and innovative user interface makes direct operation of the unit stress-free by eliminating complicated layered selection displays, so access to desired functions is smoother and simpler than ever. A variety of multimedia options ensures that you will be properly entertained. Customizable audio and video functions make it easy to suit your mood.



Power Sofa/Bed

Optional Equipment. Power Sofa/Beds are made by Kustom Fit, a division of Villa Industries. The fabric used matches the driver and passenger chairs and has a durability rating to last a long life in your motorhome.

The power sofa/bed has 4 functions:

- 1) Move sofa away from outer wall.
- 2) Convert sofa to bed.
- 3) Move bed toward outside wall to adjoin stationary cushion.
- 4) Convert bed to sofa & move toward outside wall.

You may operate the power sofa/bed with slide-out room extended or with room not extended.

Do NOT Continue to hold the button down once the sofa has extended or retracted. You can cause damage to the gears with prolonged use.



Motorized Awning



Your Coach House **PLATINUM II** has been equipped with the Dometic 9500E Series legless motorized awning.

Make sure your Battery Cutoff Switch is in the ON position and the Inverter is turned ON any time the Electric Awning is deployed. Damage to your Awning or Motorhome may occur if power is not available in the event of inclement weather.

There is a motion sensor attached to the lead rail of the awning which will force the awning to retract if the motion becomes violent enough to cause damage to the unit.

The remote control for the awning is located just inside the main motorhome door on the "Tower of Power".

Clean your awning with mild soap and water only.

Insert Dometic Awning Manual Here



RECORD THIS INFORMATION FOR FUTURE
REFERENCE:

Model Number _____

Serial Number _____

Date Purchased _____

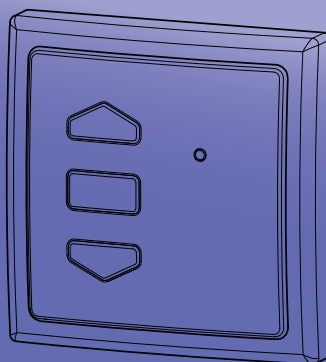
Retailer / Qualified Installer _____

USA
SERVICE OFFICE
Dometic, LLC
2320 Industrial Parkway
Elkhart, IN 46516
574-294-2511

CANADA
Dometic, LLC
46 Zatonski, Unit 3
Brantford, ON N3T 5L8
CANADA
519-720-9578

**For Service Center
Assistance Call:**
800-544-4881

**3313943.000
REMOTE WALL
CONTROL KIT**



**INSTALLATION & OPERATING
INSTRUCTIONS**

**3313943.000
REMOTE WALL
CONTROL KIT**

3314042.000

Form No. 3314042.000 02/11
(French 3314043.000)
©2011 Dometic, LLC
LaGrange, IN 46761

Important: These Instructions must
stay with unit. Owner read carefully.

PLATINUM II
Rev: 110315

3480 Technology Drive • Nokomis • Florida
(800) 235-0984 • (941) 485-0984 • (941) 488-4095 FAX
www.coachhouseserv.com

8-23

GENERAL INSTRUCTIONS

These instructions apply to:

202(XX)(XX).000(#) 9500E Cassette Awnings
203(XX)(XX).000(#) DA20(XX) Cassette Awnings

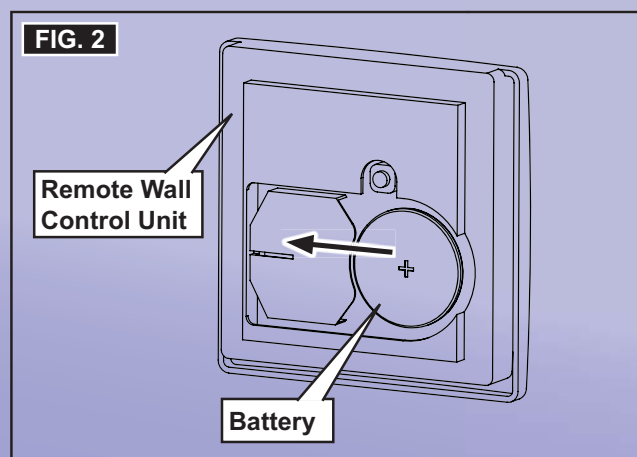
This kit consists of:

- (1) Installation & Operating Instructions
- (1) Awning Remote Wall Control Unit with Base

Dometic, LLC reserves the right to modify appearances and specifications without notice.

- 2. On back of remote wall control unit, place and slide battery into battery clip until fully engaged. See FIG. 2.

Note: Make sure battery has positive side up.



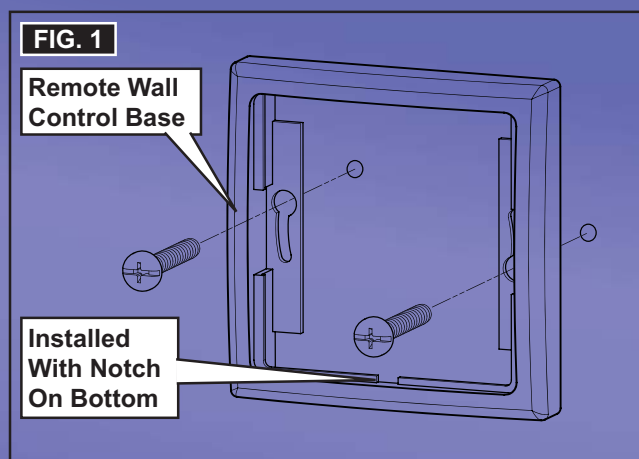
PROCEDURE

A. Install Remote Wall Control Unit

NOTICE

Do not expose remote and remote holster to weather, extreme temperatures, or long hours in direct sunlight. Failure to obey this notice could result in property damage.

- 1. Locate a suitable location for remote wall control base that's protected from weather and other adverse conditions, and install with two screws. See FIG. 1.



B. Activate Remote Wall Control Unit

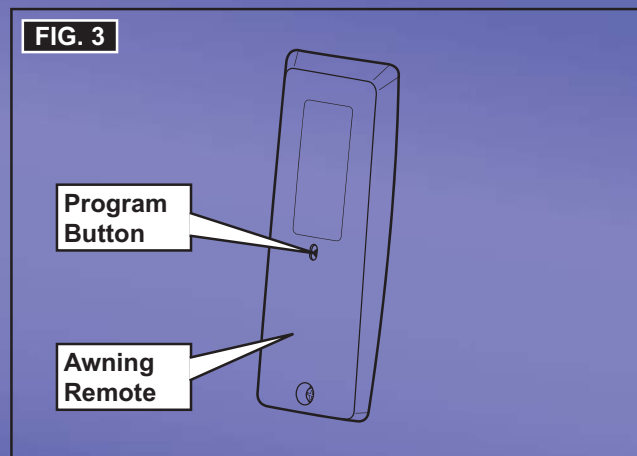
More than one remote may be added to operate the awning if desired.

Note: Refer to the operating instructions that came with your awning if this remote is a replacement, and no other remote is programmed to the awning.

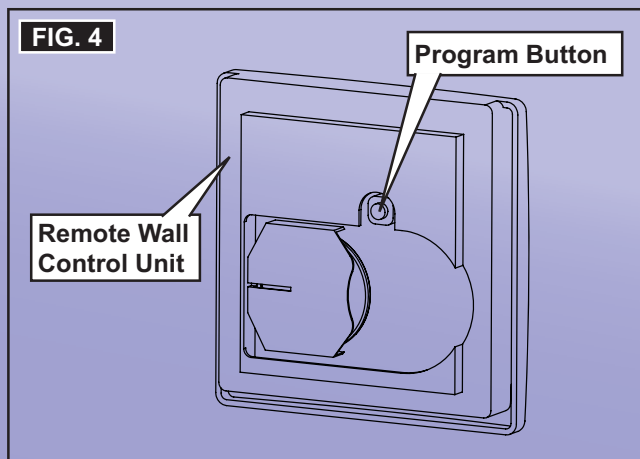
- 1. Make sure power is supplied to awning motor.

Note: There should already be at least one remote programmed to the awning motor at this stage.

- 2. Using a remote that already controls the awning motor, press and hold the program button on back for approximately (3) seconds. Awning motor should jog momentarily. See FIG. 3.

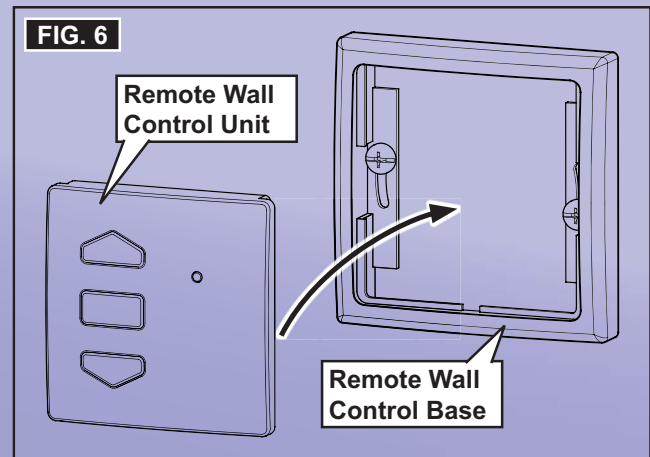


3. Press and hold the program button on back of remote wall control unit for approximately (3) seconds. Awning motor should jog momentarily. See FIG. 4.



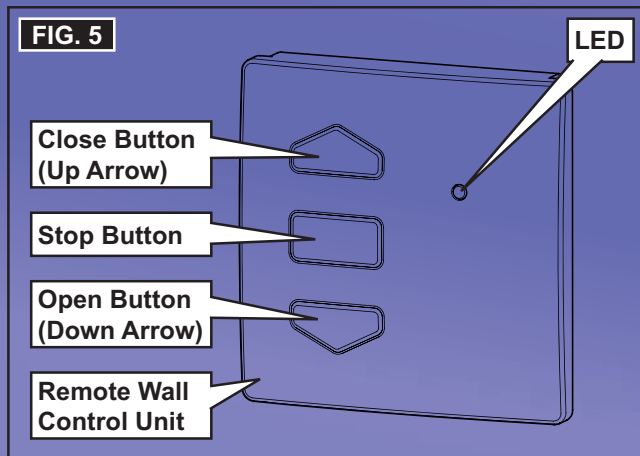
5. Install the remote wall control unit onto remote wall control base by snapping it in place. See FIG. 6.

Note: To remove remote wall control unit from base, use flat bladed screw driver to disengage tab at bottom notch. See FIG. 1.



4. Verify awning motor and remote functionality.
 - a. Press the open button (down arrow) briefly on awning remote wall control unit. Awning should extend to its out limit. See FIG. 5.

Note: If awning does not respond, verify LED lights momentarily (on remote wall control unit) when button is pressed. If LED does not light, install new batteries.



C. Operate Remote

1. See "Procedure" under awning Operating Instructions for specific operating information.

Bose Surround Sound System



BOSE

CineMate® Series II digital home theater speaker system

- A 2.1-channel speaker system with compact speakers and improved digital acoustic performance
- Designed to enhance the audio from your TV and existing video sources
- Available with Gemstone speakers and universal remote or Articulated Array speakers and simplified, four-button remote.
- 3D-compatible with 3D TVs, Blu-ray Disc™ players, gaming consoles and other 3D sources
- Simplified setup, with only a few connections to make

The Bose® CineMate II speaker system is the easiest way to enjoy Bose 2.1-channel home theater performance and bring out the full audio potential of your HDTV. Proprietary TrueSpace® technology enables two compact speakers and an Acoustimass® module to deliver compelling sound for movies, games, sports and more. The system easily connects directly to your TV, avoiding the need to disconnect other sources. And with no rear speakers, there's no wiring to the back of your room.

Heated Holding Tanks

Heated Holding tanks are installed as optional equipment on your Coach House Platinum.

Manufactured by ULTRA HEAT INDUSTRIES, the tank heaters come in four sizes.

The larger tank heaters are equipped with a thermal sensor which will prevent the heaters from being activated unless the ambient air temperature is below 46 degrees fairenheim. This protection is to make sure your heaters do not come on inadvertently and “cook” the contents of your holding tanks.

ULTRA HEAT INDUSTRIES warrants tank heaters for a period of one year from the time of purchase and any failures should be reported directly to them at their factory.



UHI Worldwide, Inc.
1314 Perkins St.
P.O. Box 1454
Elkhart, IN 46515-1454
USA



Product Insert

ONE-YEAR LIMITED WARRANTY

All UHI stock items carry a one (1) year warranty under normal use against manufacturing defects in UHI materials and/or workmanship. The warranty coverage starts on the date of the original purchase. This Limited Warranty covers only those defects which occur or exist within the one (1) year period referenced above. Any modification of UHI products, from original design and/or intended use, or improper installation shall **VOID** all warranties.

All of UHI's obligations pursuant to this Limited Warranty are limited to replacing the product at no additional cost or issuing an account credit memo for the product's cost.

WARRANTY EXCLUSIONS

UHI MAKES NO OTHER WARRANTIES, EXPRESS OR IMPLIED, including any IMPLIED WARRANTY OF MERCHANTABILITY, FITNESS FOR A PARTICULAR PURPOSE, or NONINFRINGEMENT. In no event shall UHI be liable for special, indirect, or consequential damages arising out of the limited warranty.

To the extent that applicable state and/or federal law prohibits the exclusion of any remedy permitted under state or federal law, any such remedy, including, but not limited to, implied warranties of merchantability, fitness, use, or purpose, is limited to **one (1) year** from the date of the original purchase.

PROPER USE OF TRADEMARKS

UHI Worldwide, Inc., Ultra Heat, Inc., UltraHeat®, and Ultra-Heat™ and all individual product trademarks, service marks, logotypes, commercial symbols, insignias, and designs pertaining thereto, as they appear in any advertising medium, are proprietary marks of UHI Worldwide, Inc., and UHI owns all right, title, and interest in and to these proprietary marks. Trademarks and trade names may not be used in connection with any product or service that is not provided by UHI, in any manner that is likely to cause confusion among customers, or in any manner that disparages or discredits UHI. Purchaser shall not remove, alter, or otherwise modify any identification marks or trademarks affixed by UHI to products.

REPACKAGING

UHI products shall not be repackaged without the express, written approval of UHI. Under no circumstances shall UHI product labeling be removed, obstructed, or altered.

www.uhiworldwide.com

Equalizer Systems Stabilizers



Straighten Up With Stabi-Lite®

Equalizer Systems has introduced a new stabilizing system designed for Class C motorhomes. If you are tired of your coach leaning when the slide room is extended, or fed up with the constant swaying when you walk around in your coach, let STABI-LITE® stabilize your RV. It's an easy way to keep you walking straight.



- Eliminates coach lean when slide is extended
- Clamp style mount requires no welding or drilling to install
- Convenient, one-touch automatic operation
- Eliminates nearly all sway resulting from coach movement
- Low profile design decreases height required by traditional systems
- Complete system weight of less than 80 lbs.
- Chassis specific design reduces installation time

Hydraulic Room Extension



HWH Hydraulic Room Extensions (Slide Outs) are Optional on Mercedes Benz Chassis.

Read Owner's manual for room extension system before operating.

To Extend:

Level motor home and set parking brake before extending slide-out portion.

Turn ignition key to accessory position, turn control panel key to ON position and push switch to extend.

Turn off control panel and ignition switch and remove keys.

To Retract:

Set parking brake, turn ignition to accessory position, turn control panel key to ON and push switch to retract.

Turn off control panel and ignition switch and remove keys.



Insert HWH Slide Out Manual
Here

Dometic Slide Topper

Your **PLATINUM II** has been equipped with a Dometic Slide Topper if you have a hydraulic room extension (slide-out) installed on your motorhome.



The Slide Topper will extend or retract automatically when the slide out is in operation. The slide topper helps to keep debris and water away from the top of your slide-out.

 **Dometic**





RECORD THIS UNIT INFORMATION FOR
FUTURE REFERENCE:

Model Number _____
Serial Number _____
Date Purchased _____



SLIDE TOPPER™

ELITE SLIDE TOPPER MODEL with FULL COVER

86196(XX).(XXX)-(X)

86200(XX).(XXX)-(X)

86202(XX).(XXX)-(X)

86300(XX).(XXX)-(X)

USA

SERVICE OFFICE
Dometic Corporation
2320 Industrial Parkway
Elkhart, IN 46516
574-294-2511

CANADA

Dometic Corporation
46 Zatonski, Unit 3
Brantford, ON N3T 5L8
CANADA
519-720-9578

For Service Center
Assistance Call:
800-544-4881

WARNING

This manual must be read and understood before installation, adjustment, service, or maintenance is performed. This unit must be installed by a qualified service technician. Modification of this product can be extremely hazardous and could result in personal injury or property damage.

AVERTISSEMENT

Lire et comprendre ce manuel avant de procéder à l'installation, à des réglages, de l'entretien ou des réparations. L'installation de cet appareil doit être effectuée par un réparateur qualifié. Toute modification de cet appareil peut être extrêmement dangereuse et entraîner des blessures ou dommages matériels.

INSTALLATION & OPERATING INSTRUCTIONS

MODELS

86196 Elite FC

86200 Elite FC

86202 Elite FC

86300 Elite FC

REVISION

Form No. 3308250.0207/05
(Replaces 3308250.012)
(French 3308310.022)
©2005 Dometic Corporation
LaGrange, IN 46761

Important: These instructions must
stay with unit.
Owner read carefully.

APPLICATION GUIDE

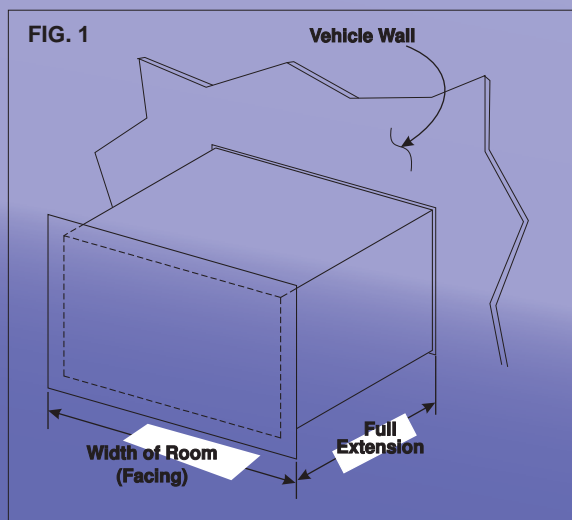
Models: 86196, 86200, 86202 and 86300 Elite FC

The A&E Slide Topper is designed to protect the top of an RV's slide-out-room from weather and debris. It is not waterproof, some drips, condensation, or wind blown precipitation can be present under the canopy.

1. DETERMINE SLIDE TOPPER LENGTH:

To determine the size of Slide Topper you require, measure your room according to the picture below and then use the chart supplied.

The Slide Topper will **NOT** work on rooms with a full extension greater than 44 inches.



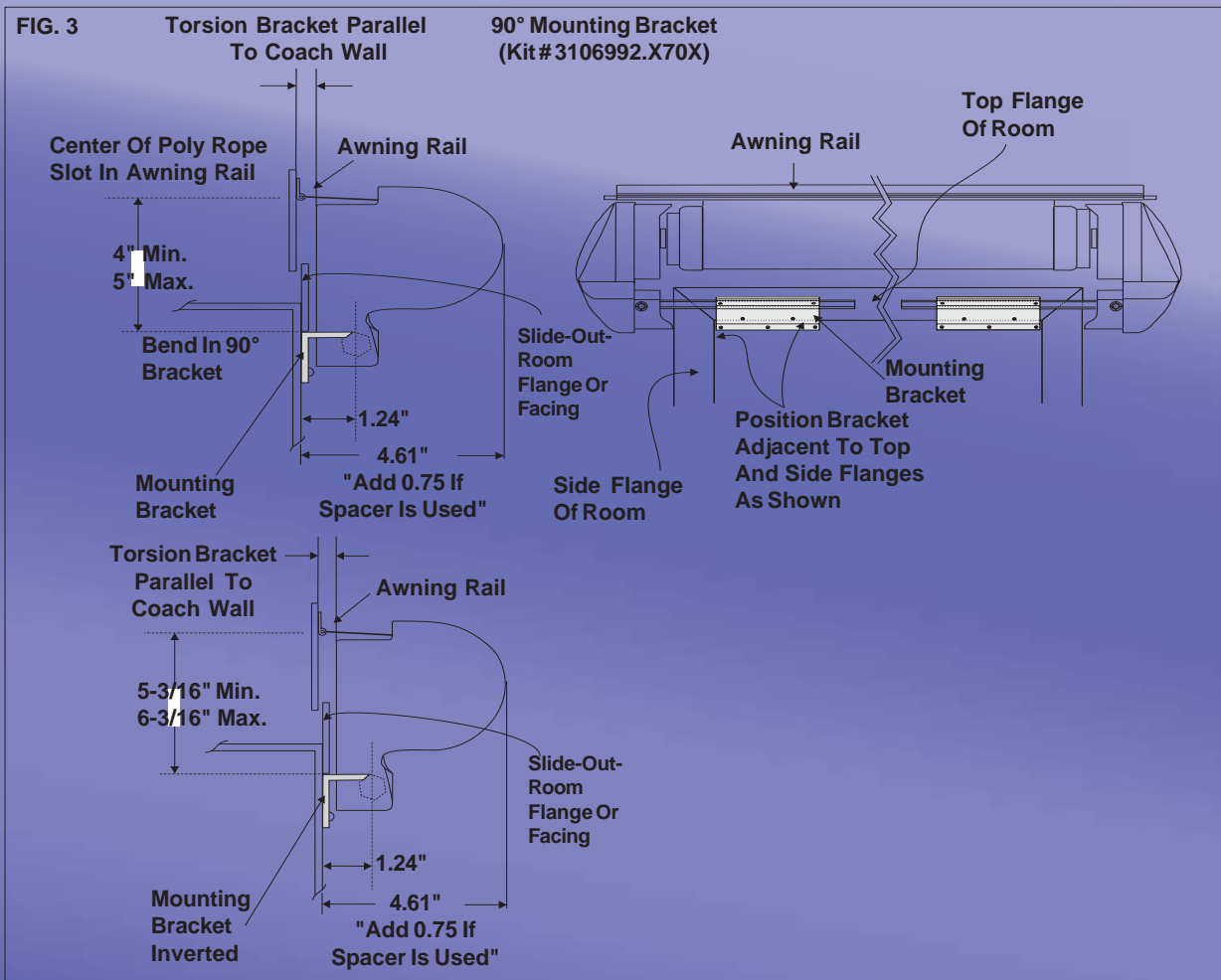
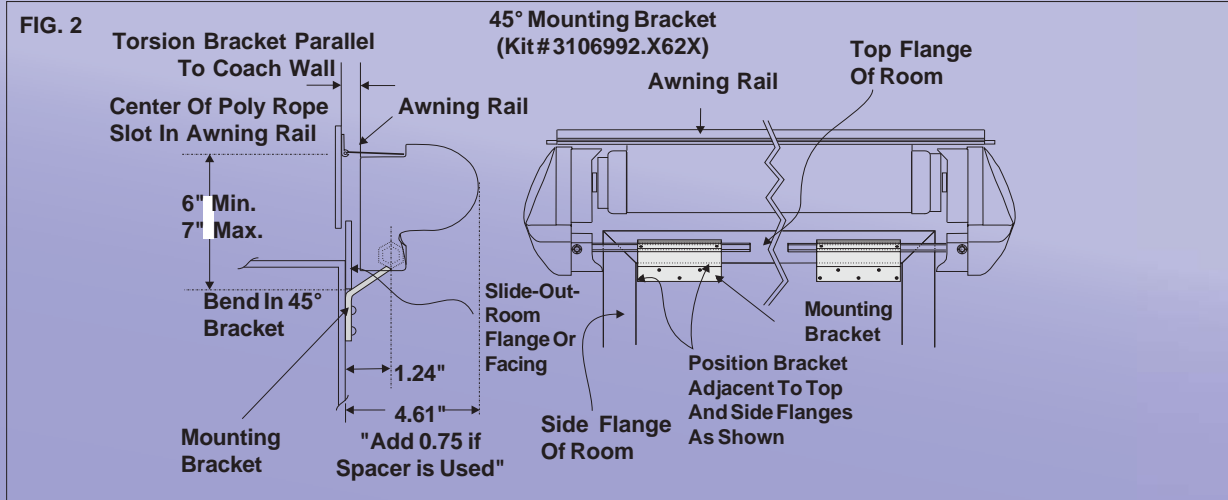
2. DETERMINE BRACKETS REQUIRED FOR THE SLIDE OUT:

- 3106992.062(X) Bracket Kit
- 3106992.162(X) Bracket Kit (See Note)
- 3106992.070(X) Bracket Kit
- 3106992.170(X) Bracket Kit (See Note)

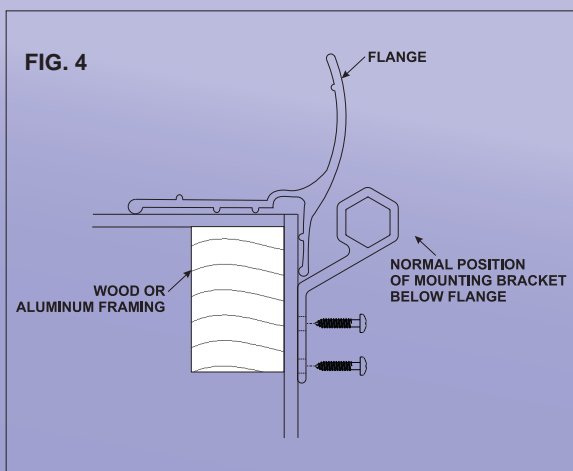
Note: Use **ONLY** with 86(XXX)(XX).060 Models.

Width Of Room	Recommended Awning Length
50" to 55-3/4"	(See Note)
56" to 61-3/4"	66"
62" to 67-3/4"	72"
68" to 73-3/4"	78"
74" to 79-3/4"	84"
80" to 85-3/4"	90"
86" to 91-3/4"	96"
92" to 97-3/4"	102"
98" to 103-3/4"	108"
104" to 109-3/4"	114"
110" to 115-3/4"	120"
116" to 121-3/4"	126"
122" to 127-3/4"	132"
128" to 133-3/4"	138"
134" to 139-3/4"	144"
140" to 145-3/4"	150"
146" to 151-3/4"	156"
152" to 157-3/4"	162"
158" to 163-3/4"	168"
164" to 169-3/4"	174"
170" to 175-3/4"	180"
176" to 181-3/4"	186"
182" to 187-3/4"	192"

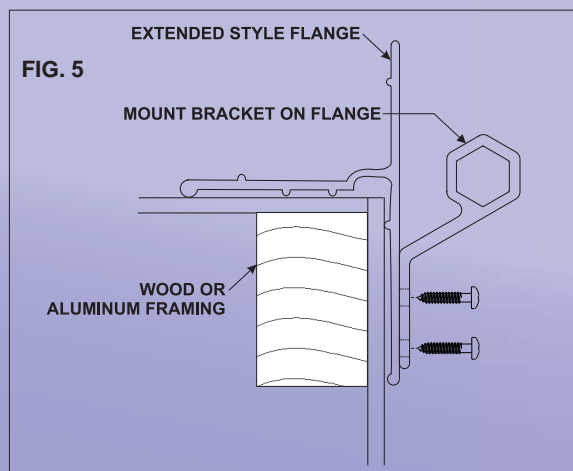
Note: The greater the distance between the awning rail and the mounting bracket, the better water and debris will run off, however, **DO NOT** exceed maximum distances shown. Exceeding these recommended distances will result in the wind deflector interfering with drip/gutter rails.



When installing the A&E Slide Topper on vehicles with extra large slide-out-room flanges, it may be necessary to install the mounting bracket directly on the flange. See FIG. 5.

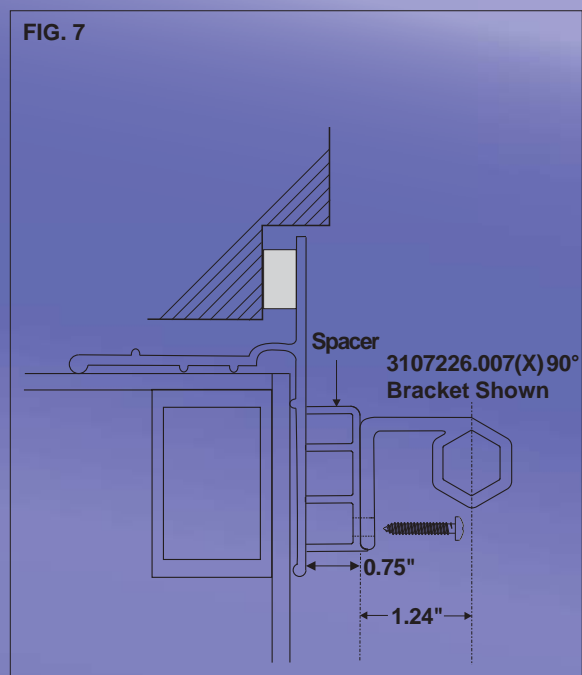
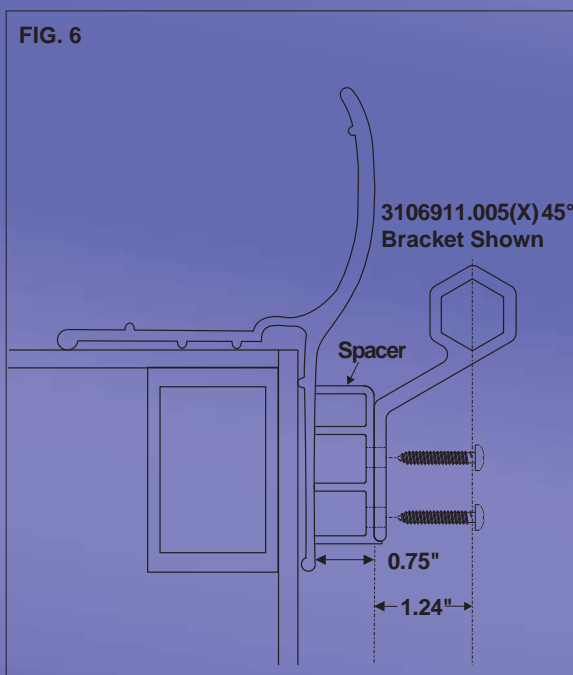


Important: The bracket must only be mounted on the flange where there is sufficient backing material or framing behind the flange.



3107940.003 SPACER KIT

Important: Spacer Kit can be installed when additional clearance is required between the slide topper and the outside wall of the RV which is the case with recessed rooms. When 3107940.003 Spacer Kit is used, the center support bracket will also need to be spaced properly. Use 3308393.002 Center Support Bracket Spacer Kit.



SAFETY INSTRUCTIONS

This manual has safety information and instructions to help users eliminate or reduce the risk of accidents and injuries.

RECOGNIZE SAFETY INFORMATION



This is the safety-alert symbol. When you see this symbol in this manual, be alert to the potential for personal injury.

Follow recommended precautions and safe operating instructions.

UNDERSTAND SIGNAL WORDS

A signal word, **WARNING** OR **CAUTION** is used with the safety-alert symbol. They give the level of risk for potential injury.

⚠ WARNING: Indicates a potential hazardous situation which, if not avoided, could result in death or serious injury.

⚠ CAUTION: Indicates a potentially hazardous situation which, if not avoided, may result in minor or moderate injury.

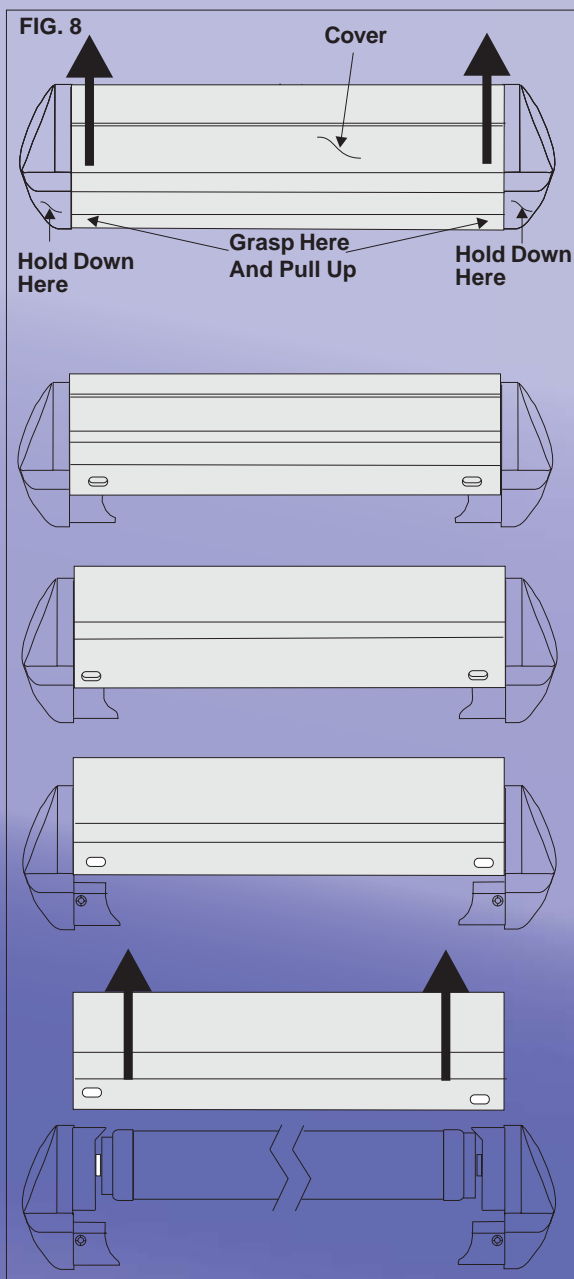
CAUTION: Used without the safety alert symbol indicates a potentially hazardous situation which, if not avoided, may result in property damage.

Read and follow all safety information and instructions.

Learn how to operate the awning properly.

GENERAL INFORMATION INSTALLATION PREPARATION

1. Remove slide topper from the shipping tube.
2. Remove plastic bag from around slide topper.
3. Lay slide topper on a clean flat surface.
4. Grasp the cover at the bottom edge near one end of the torsion brackets and pry the cover up approximately 1-2" with one hand while holding the torsion bracket with the other hand. Repeat the same process at the other end and continue lifting the cover until it can be fully removed. See FIG. 8. Lay cover aside.



5. Roll slide topper over and remove all mounting hardware, literature and hex extension bars if they have been included with the slide topper.

⚠ WARNING

Do not remove the cotter pins located on each end of the FRTA until instructed to do so. The FRTA is pre-wound and under tension. Rapid spin-off will occur if the cotter pin is removed.

6. Check installation hardware against the following list.

		86196	86200	86202	86300
	730099-(X) Awning Rail	X	—	—	—
(1)	3308241.003(X) Kit, Center Support	X	X	X	X
(1)	3308091.002(X) Bracket	X	X	X	X
(2)	3105445.013 Screw, #10-12 x 1.0 PHCR	X	X	X	X
(4)	312300.041 Screw, 1/4"-20 x 5/8" PH	X	X	X	X
(2)	3307879.002 Screw, #10-32 x .50"	X	X	X	X
(1)	3106806.049 Kit, Hardware	—	X	—	X
(10)	3105445.013 Screw, #10-12 x 1.0"	—	X	—	X
(2)	310359.012 Screw, #6-20 x .44 HHW	—	X	—	X
(4)	3103855.023 Screw, 10-16 x .63"	—	X	—	X
(2)	3106792.041Q 15" Hex Extension Bar	—	*X	—	*X
(2)	3106911.005(X) 45° Wall Bracket	—	X	—	—
(2)	3107226.007(X) 90° Wall Bracket	—	—	—	X
(1)	3307879.002 Screw, 10-32 x .50	X	X	X	X
(1)	3308276.009(X) Kit, Z-Clip	—	—	—	X
(4)	3105445.006 Screw, 10-12 x 0.75	—	—	—	X
** (1)	3106992.(XXX)-(X) Kit, Wall Bracket	X	—	X	—

* Except 86(XXX)(XX).060-(X) Use 3106792.058Q 18" Hex Extension Bar

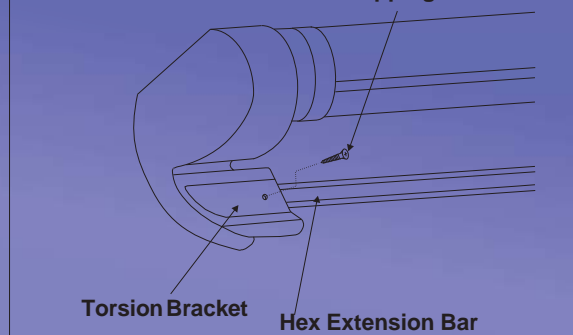
** Wall Bracket Kit is ordered separately. It does not come with the Slide Topper Fabric Roller Tube Assembly. The kit numbers are: 3106992.062(X) 45° Wall Bracket Kit w/15" Hex Extension Bar
3106992.070(X) 90° Wall Bracket Kit w/15" Hex Extension Bar
3106992.170(X) 90° Wall Bracket Kit w/18" Hex Extension Bar

NOTE: Replace (X) with color letter code
B = Polar White H = Mende
S = Satin R = Champagne
U = Black V = Gold

INSTALLATION INSTRUCTIONS

1. Install awning rail. Some slide topper models are not furnished with awning rail. If not supplied with slide topper, installer will need to furnish. See figure 2 and 3 to determine the correct location for the awning rail. Apply a sealant to the back edge of the awning rail to prevent leaks, and install the awning rail using #6-20 x 1/2" screws. The rail must be FIRMLY mounted to the vehicle.
Remove any drip shields or flashings which conflict with the awning.
2. Install one (1) hex extension bar in the torsion bracket hexslot. Press into hole until hexrod bottoms out. See FIG. 9. (Some applications will have one hex extension bar already secured to the torsion bracket when received from Dometic.)

FIG. 9 #10-32 x 1/2" Self-Tapping Screw

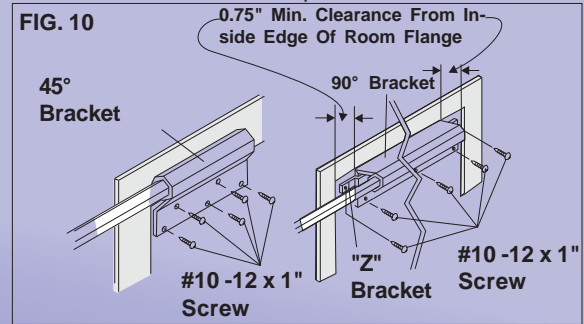


3. Locate and install slide topper wall mounting brackets on the slide-out-room wall with ten (10) #10-12 x 1" PHCR screws provided. See FIG. 10. Position bracket as shown in FIG. 2 & 3. Install "Z" clips at the top of the bracket as shown in FIG. 10. Pre drill the hole with a 1/8" drill bit and install screw.

Note: If the vehicle has a laminated wall, mark and drill hole

locations with a 3/16" drill bit and use expanding rivets to secure the bracket and "Z" clips.

FIG. 10



4. Unroll **ONE** wrap of fabric from the fabric roller tube. See FIG. 11A.
5. Move slide topper awning and remaining hex extension bar to RV and install fabric into the awning rail. See FIG. 11A & 11B. Slip the pre-mounted hex extension bar into one previously mounted wall mounting bracket on the slide room as the fabric is installed into the awning rail. See FIG. 11A & 11B.

FIG.11A

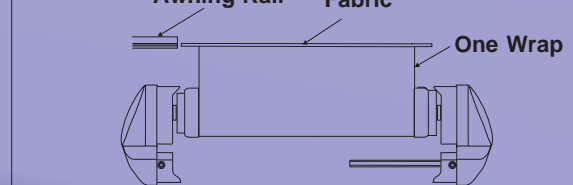
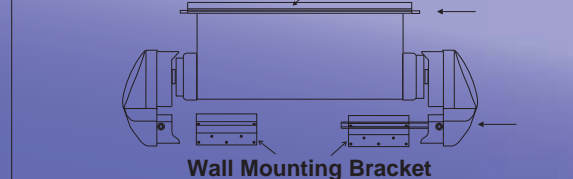
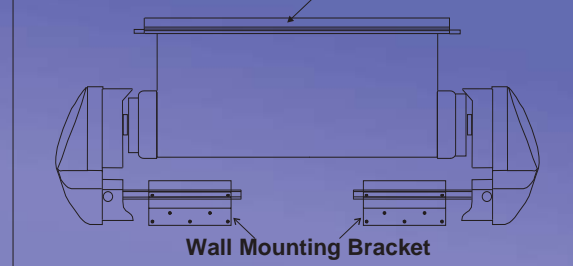


FIG.11B



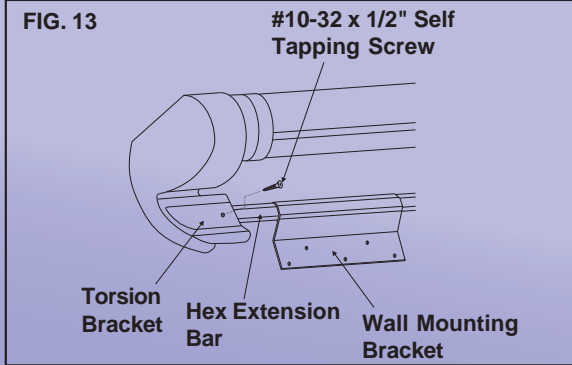
6. Install the second hex extension bar through the previously mounted wall mounting bracket and into the torsion bracket. Again, press into hex hole until hexrod bottoms out. See FIG 12.

FIG.12



Important: Do not secure either hex extension bar to the wall mounting brackets at this time.

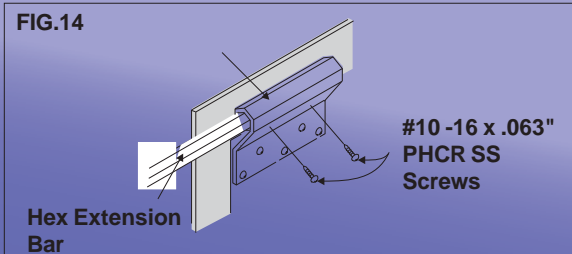
FIG. 13



7. Position the slider topper appropriately (center between wall mounting brackets)

Important: Do not secure the hex extension bars to the wall mounting brackets at this time.

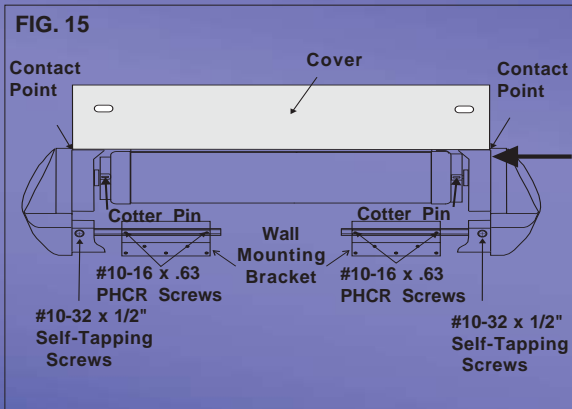
FIG. 14



8. Retrieve the cover and slide the center mounting bracket to the center of the cover. See FIG. 18. Now place it upside down on top of the torsion brackets, allowing it to rest on the inside flange of the torsion brackets. See FIG. 15.

Important: Care must be taken to keep the cover from inadvertently falling off the torsion brackets while performing the next step.

FIG. 15

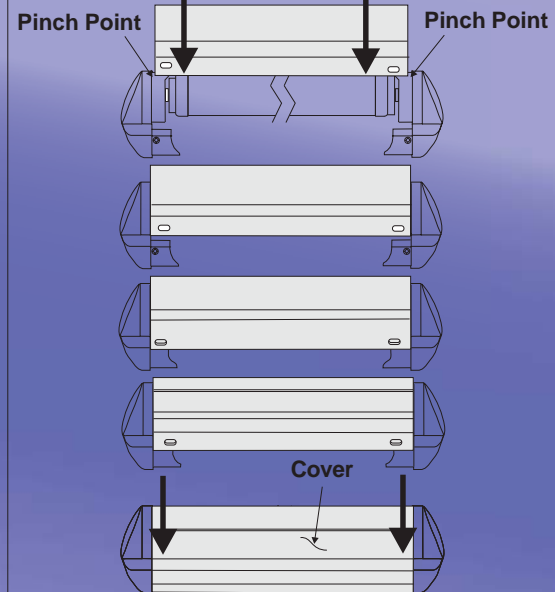


9. Move one torsion bracket until cover touches both contact points. See FIG. 15.
 10. Remove the cotter pin by pulling it straight out. See FIG. 15.
 11. Now secure the hex extension bars to the wall mounting bracket using 4 #10-16 x .63" PHCR SS self drilling screws. Predrill hexrod through holes (dim. 11/64") in torsion bracket. Secure torsion brackets to hexrod using 10-32 x 1/2" self tapping flathead screws provided. Take care not to change torsion bracket position during this step; torsion bracket should have back edge parallel to coach wall before, during, and after this step. See FIG. 2,3,14, and 15.
 12. Roll cover downward and push it straight onto the torsion brackets until it "snaps" into place. See Fig. 16. To avoid being pinched, keep fingers and hands away from the area between the cover and torsion brackets.

CAUTION

Pinch point. Keep fingers and hands away from the area between the cover and the torsion brackets.

FIG. 16

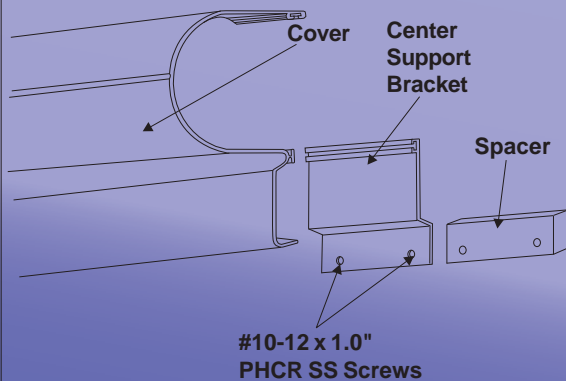


13. Initial Awning Adjustment-Cycle the slide-out-room four or five times to align fabric. When satisfied with the alignment, secure fabric by driving a #6-20 x .44" Tek screw through the rail and into the fabric rope. See FIG. 17 for screw location. Repeat at opposite end.

FIG. 17

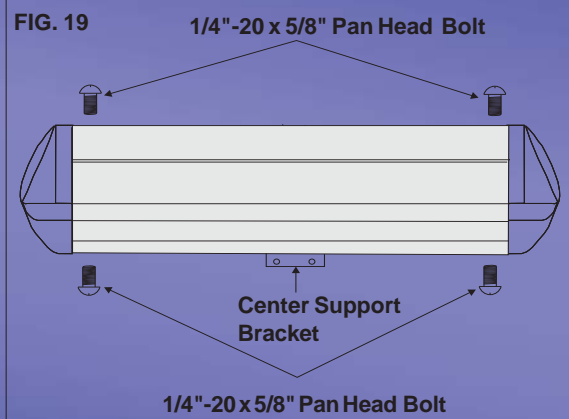


FIG. 18



14. Adjust cover from side to side if necessary. Equally space the distance between the cover and the torsion bracket on both ends.
15. Secure cover to torsion brackets using one (1) 1/4"-20 x 5/8" pan head bolt provided in each corner of the cover. See FIG. 19.

FIG. 19

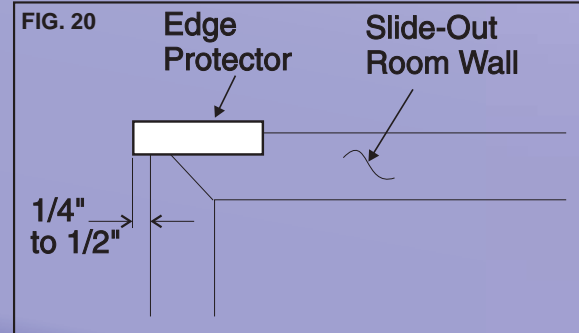


16. Attach center support bracket to slide-out-room wall using two (2) #10-12 x 1.0" PHCR SS screws provided. See FIG 18 & 19. If 3107940.003 Spacer Kit was used to space the wall mounting bracket the center support bracket will need to be spaced as well. Use 3308393.002 Center Support Spacer Kit. If there is no spacer behind the center support bracket, oscar rivets (not supplied) may be used if there is no backing behind the outside skin of the RV.

17. Install (not supplied) edge protector on each end of slide-out-room molding. See FIG. 20. Allow protector to extend beyond edge of molding by 1/4" to 1/2".

Note: Not all installations will be able to use a Dometic edge protector. If a Dometic edge protector is not used, a similar type **MUST** be used. Units which are damaged by the slide-out-room will **NOT** be covered under warranty.

FIG. 20



Note: Oscar rivets and edge protectors are available as separate items.

113008P10 Oscar Rivet=Package of 10

113008P100 Oscar Rivet=Package of 100

3308176.001 Edge Protector=Package of 10

3308176.019 Edge Protector=Package of 100

OPERATING INSTRUCTIONS

The slide topper will automatically open and close as your slide-out-room opens and closes.

Because the awning is level, water may puddle on top of the canopy. As the slide out room is closed and the awning rolls up, these puddles will spill over the sides of the awning.

CAUTION

Do not use the slide topper in snowing or freezing-rain conditions. Such use will prevent the awning from retracting with the slide room and damage the awning and the slide-out-room.

HELPFUL HINTS FOR AWNING CARE

- If the awning is wet when rolled up, as soon as conditions allow, roll it out and let it dry before rolling it up again. This will help prevent mildew and staining.
- **WHEN TO GET MORE HELP:**
If malfunctions occur that cannot be corrected by reviewing this installation and operating instructions manual, contact a Dometic Service Center or qualified service technician for assistance. For Service Center Assistance Call 800-544-4881.



LIMITED ONE (1) YEAR WARRANTY

THE SELLER NAMED BELOW MAKES THE FOLLOWING WARRANTY WITH
RESPECT TO THE DOMETIC PRODUCT:

1. This Warranty is made only to the first purchaser (hereinafter referred to as the "Original Purchaser") who acquires the product for his own use and is installed and operated within the continental United States and Canada.
2. This Warranty will be in effect for one (1) year from the date of purchase by the original purchaser. It is suggested that the original purchaser retain a copy of the dated bill of sale as evidence of the date of purchase.
3. This Warranty covers only specified parts which shall be free from defects in material and workmanship under normal use. This warranty does NOT cover conditions unrelated to the material and workmanship of the product. Such unrelated conditions include, but are not limited to: (a) damage not reported within seven (7) days of ownership; (b) failure or damage caused by storms, rain, water pooling, or any acts of God; (c) faulty installation and any damage resulting from such; (d) the need for normal maintenance and any damage resulting from the failure to provide such maintenance; (e) failure to follow Sellers instructions for use of this product; (f) any accident to or misuse of any part of this product and any alteration by anyone other than the Seller or its authorized representative; (g) damage or failure caused by installation of accessories not manufactured and marketed by the Seller; and (h) normal wear and product abuse.
4. The specified parts covered by this warranty, where applicable, are as follows: (a) Roller tube against rust, corrosion and extrusion defects; (b) Fabric free from quality defects (normal wear is not covered); (c) Screen assemblies free from quality defects (normal wear is not covered); (d) Torsion assemblies, including motor-driven assemblies, against extrusion defects, electrical faults, or breakage; and (d) Hardware against extrusion defects.
5. In order to obtain the benefits of this warranty, you should return the product which you find defective to the Seller named below or to a Dometic Authorized Service Center during the period that this warranty is in effect. The original owner is responsible for all charges incurred in delivery of the product to the Seller, or Dometic Authorized Service Center, and in pick up after the warranty service has been completed. To obtain the location of the nearest Authorized Service Center, please call 1-800-544-4881. In Canada, call 1-519-653-4390.
6. Any item returned in the manner described in paragraph 5 will be examined by the Seller or the Authorized Dometic Service Center. If it is found that the returned item was defective in material and workmanship, the Seller or the Authorized Dometic Service Center will repair the product per the terms of this one (1) year limited warranty without charge for material or labor during the first year of ownership by the original purchaser. CONFIRM THE SERVICE AGENCY IS AN AUTHORIZED DOMETIC SERVICE CENTER. DO NOT PAY THE SERVICE AGENCY FOR WARRANTY REPAIRS. SUCH PAYMENTS WILL NOT BE REIMBURSED.
7. Dometic Corporation will pay freight on replacement parts during the first ninety (90) days of ownership by the original purchaser.
8. The Seller does not authorize any person or company to create any warranty obligations or liability on their behalf. This warranty is not extended by the length of time which you are deprived of the use of the product. Repairs and replacement parts provided under the terms of this warranty shall carry only the non-expired portion of this warranty.
9. In no event shall either Seller be liable for incidental or consequential damages. This includes any damage to another product or products resulting from such a defect. Some states do not allow the exclusion or limitation of incidental or consequential damages, so the above limitations may not apply.
10. Any implied warranty, including the implied warranty of merchantability and fitness for any purpose, is limited to the duration of this limited warranty. Some states do not allow limitations on how long an implied warranty can last, so the above limitation may not apply.
11. THIS WARRANTY GIVES YOU SPECIFIC LEGAL RIGHTS, YOU MAY ALSO HAVE OTHER RIGHTS WHICH VARY FROM STATE TO STATE. No action to enforce this warranty shall be commenced later than ninety (90) days after the expiration of the warranty period. Claims must be submitted in writing to the Dometic Warranty Department for arbitration.
12. All products (except those specifically built for commercial use) are warranted only when installed on vehicles built to R.V.I.A. and C.R.V.A., Z-240 Standards.
13. The Seller reserves the right to change the design of any product without notice and with no obligation to make corresponding changes in products previously manufactured.

REVISION

Form No. 3104715.044 6/05
(Replaces 3104715.036)
(French 3108128.038)
©2005 Dometic Corporation
LaGrange, IN 46761 U.S.A.

DOMETIC CORPORATION

Warranty Department
2320 Industrial Parkway
Elkhart, Indiana 46515
Phone: 574-294-2511
Fax: 574-389-3975

