

FIREFLY



INTEGRATIONS

# VEGATOUCH SPECKTRUM

## Coach House V2 User's Manual

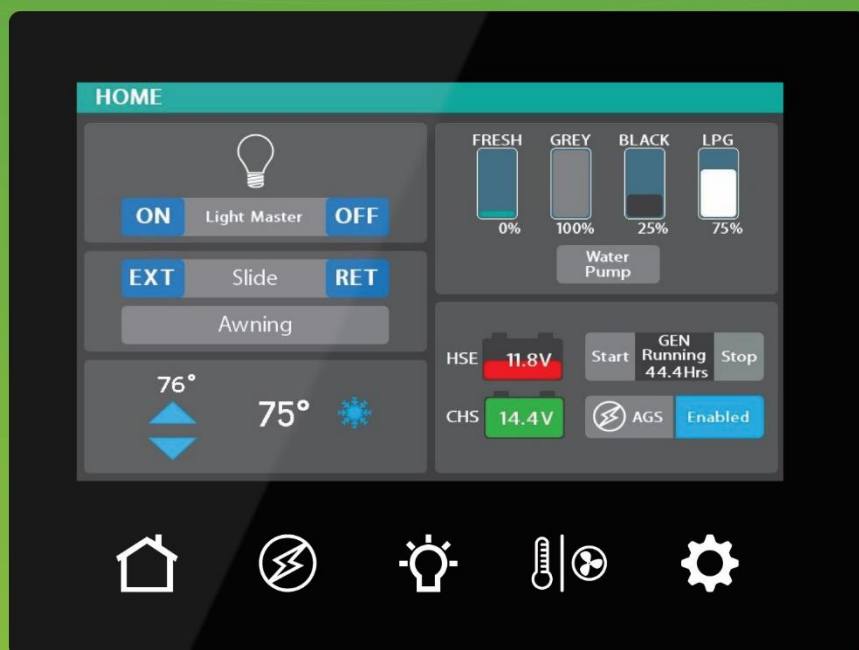

## Coach House Spectrum V2

1	Table of Contents
2	Screen Navigation
3	Home
6	AGS (Auto Gen Start)
7	Lights
8	Climate Control/Fans
9	Settings
10	Settings/Switch Panel Info
11	Settings/Mobile App
14	Multiplex Hardware



---

## Spectrum Screen Navigation

---

Tap any icon from the navigation bar to select the desired page. The currently selected page will always be listed in the top corner of the screen

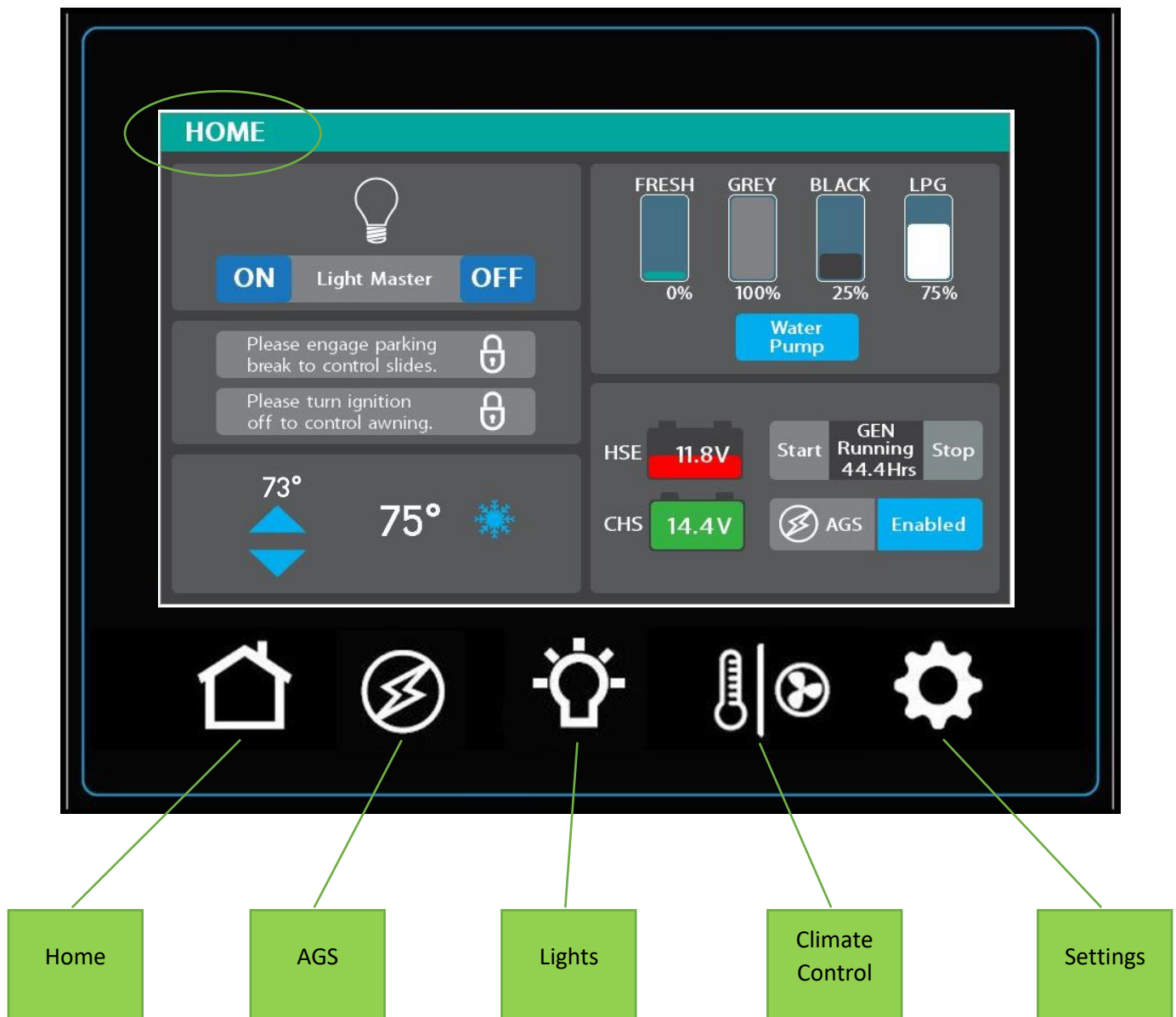

---

## Home

---

- 1 The Light Master controls all interior lights at once. When Light Master Off is pressed, it will remember which lights were on. Then, when Light Master On is pressed, it will only turn on the lights that are in memory. To turn on all lights again, press and hold Light Master On for at least one second.  
\*Troubleshooting – Memory is rewritten each time Light Master Off is pressed. In the case that it is pressed twice in a row, it will remember that no lights were on and just touching Light Master On won't turn on any lights. Press and hold Light Master On to turn the lights back on.
- 2 Press and hold EXT or RET to move the slide in or out. Remove your finger when the slide has finished traveling. Note: these buttons will appear locked out until the parking brake has been engaged.
- 3 Tap to Extend or Retract the Awning. Note: this button will appear locked out until the ignition has been turned off.

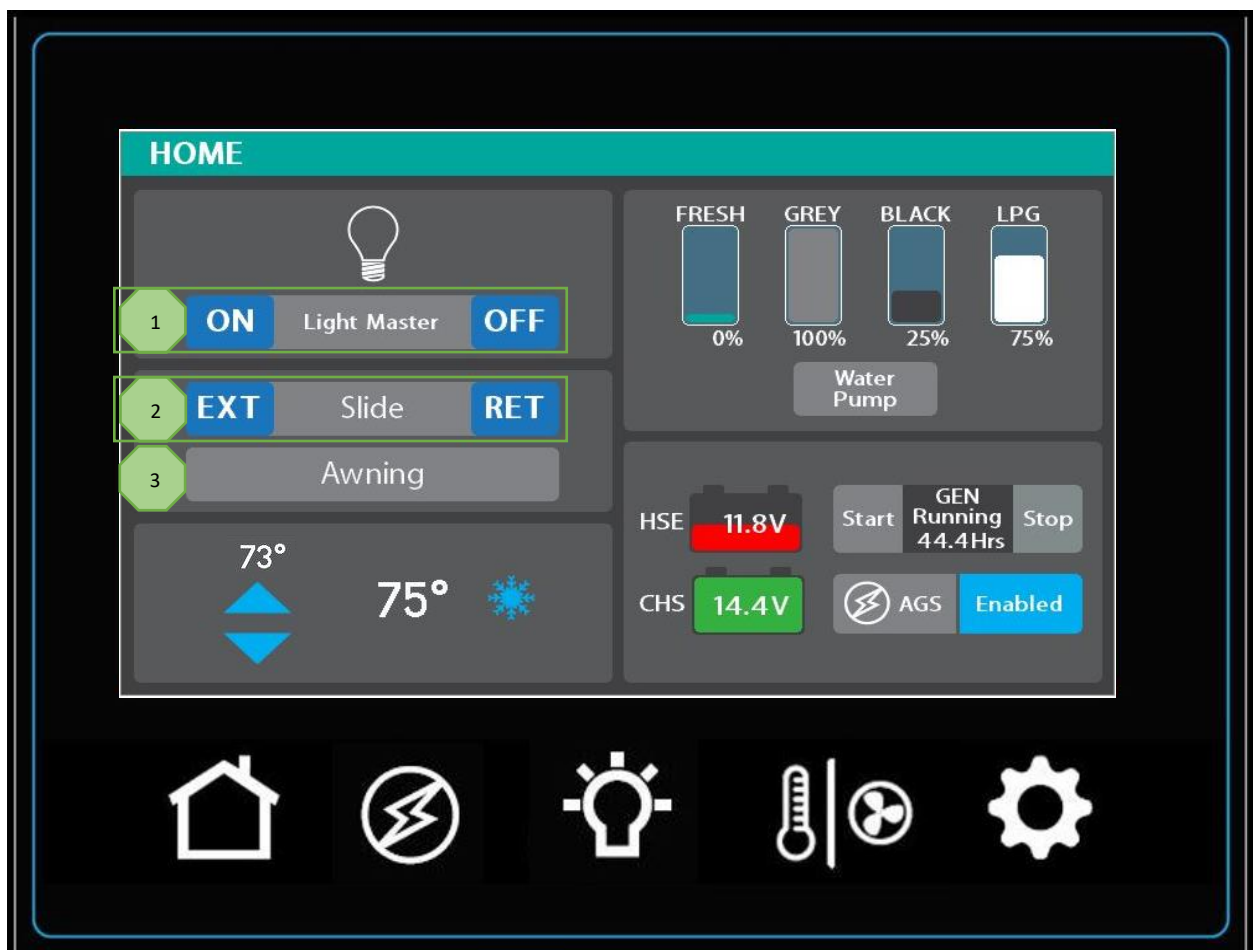

These graphics represent the holding tanks filled status.

Propane % remaining.

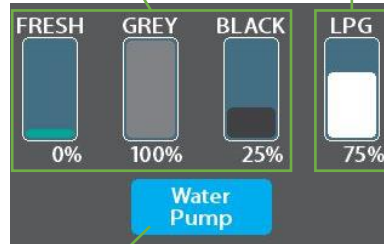

Water Pump – Tap to toggle On/Off.

Button status – buttons will turn light blue when on and gray when off.

Use the Arrows to select your desired temperature.

Current temperature.

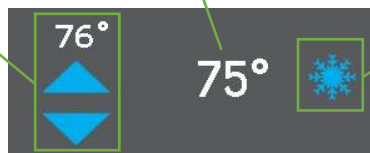

Current Climate Control Mode.

A Snowflake will be displayed for Cool mode and a Flame for heat mode.

Auto mode will display both icons regardless of what mode is currently running.

House Voltage – the voltage coming from your house batteries. Voltage icons will turn red if below 12v.

Chassis Voltage – the voltage coming from your engine battery.

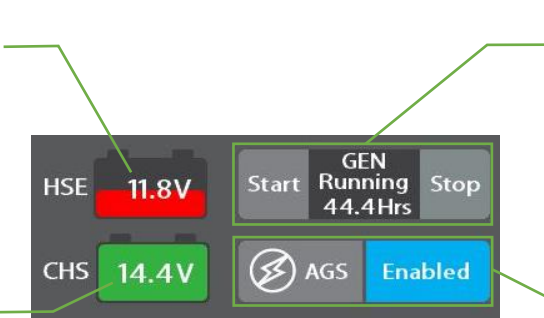

Generator Start - hold Start to start the generator (1 second delay).  
Generator Stop – Hold Stop to stop the generator.

Tap to Enable/Disable AGS.

1

AGS WARNING – to ensure safety, AGS will not be activated until you hold the Enable button (from the Warning screen) for at least 3 seconds.

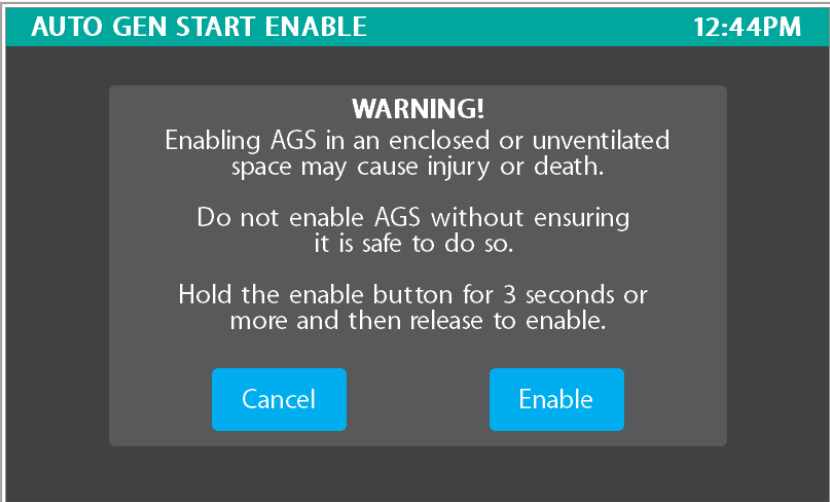

## AGS (Auto Gen Start)

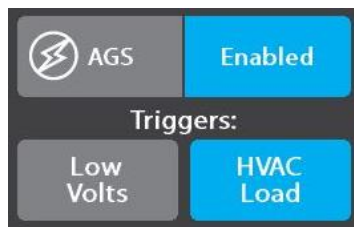

Tap to Enable/Disable AGS (as described on page 5).

Trigger Options – Automatically start the generator using specified voltage settings (Low Volts) or when A/C or Heat Pump start (HVAC). Select one or both triggers. If no triggers are selected, AGS will not run. Disable HVAC Load while connected to shore power to keep the generator from starting.

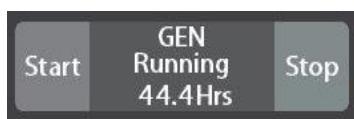

Generator – Press and hold Start to start the generator. Press Stop to stop the generator. The system will display how many hours the generator has been used. These hours are saved to the system, not the generator itself.

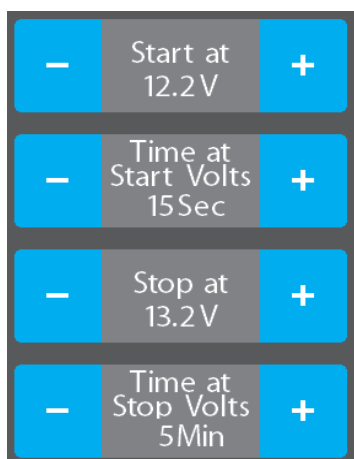

Start at Volts - The generator will start when the voltage drops to this set point depending on "Time a Volts" setting below. (Range 10.5v – 12.5v)

Time at Volts - The generator will start when the voltage drops to the Start at Voltage for this specific amount of time. (Range 5 seconds – 1 minute)

Stop at Volts - The generator will shut off when the voltage reaches this set point depending on "Time at Stop Volts" setting below. (Range 13.2v – 14.5v)

Time at Stop Volts - The amount of time required for the voltage to remain at "Stop at Volts" level before the generator shuts off. (Range 5min – 120min)

Minimum Gen Run Time - Use the + and – keys to set the minimum amount of time that your generator will run once it has started. (Range 10min – 30min)

Maximum Gen Run Time - Use the + and – keys to set the maximum amount of time that your generator will run once it has started. (Range 120min – 240min)

---

## Lights

---

This screen will control the lighting for the entire coach, including the exterior. Tap any button to turn the desired light On/Off.



Lights with up/down arrows are dimmable. Press and hold these buttons to ramp the brightness up or down. Tap the buttons to toggle On/Off.

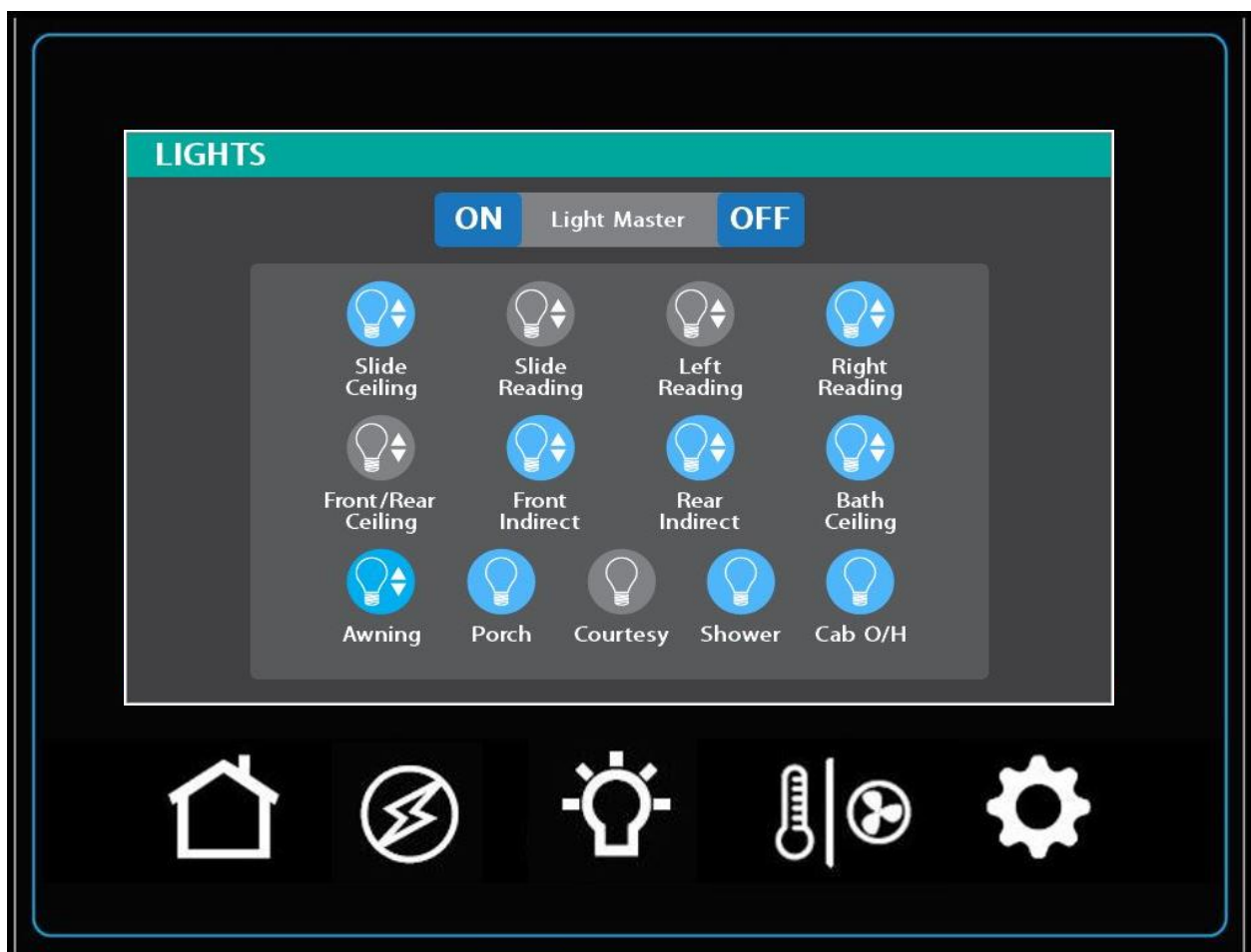



---

## Climate Control/Fans

---

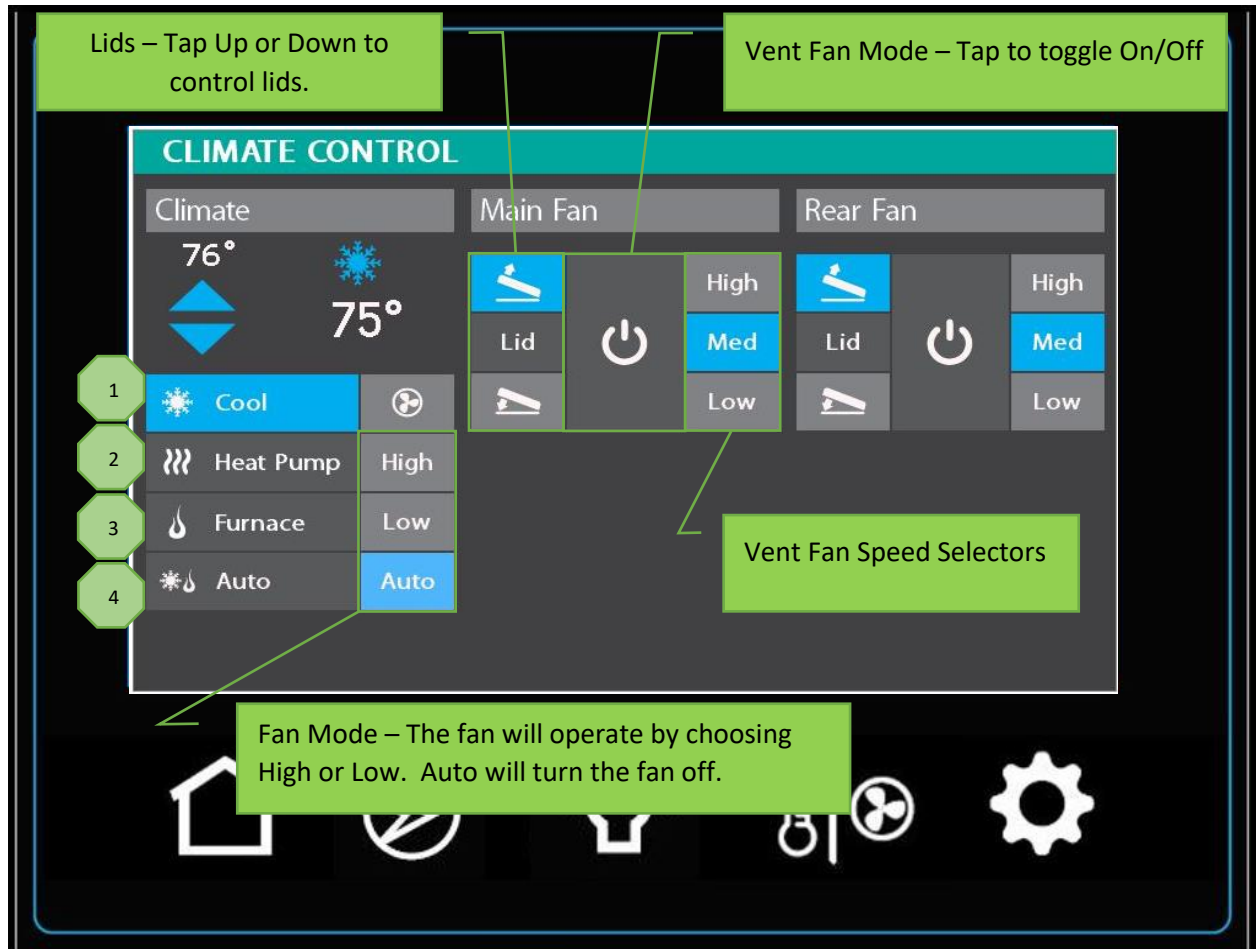

- 1 Cool – Tap to operate the air conditioning. The A/C will run until the current temp reaches your desired temp and then shut off.
- 2 Heat Pump – Tap to operate the heat pump. The heat pump will run until the current temp reaches your desired temp and then shut off.
- 3 Furnace – Tap to operate the furnace. The furnace will run until the current temp reaches your desired temp and then shut off.
- 4 Auto – Tap to put the system into Auto mode. The A/C or Heat will automatically run to keep your desired temperature consistent.

---

## Settings

---

Use the +/- buttons to select between 10 levels of screen brightness or screen sleep mode. Tapping the screen after it has been asleep will bring it back to previous brightness.

Tap to enter the Vegatouch Mira pairing screen.

Tap to enter the Switch Panel Info screen.

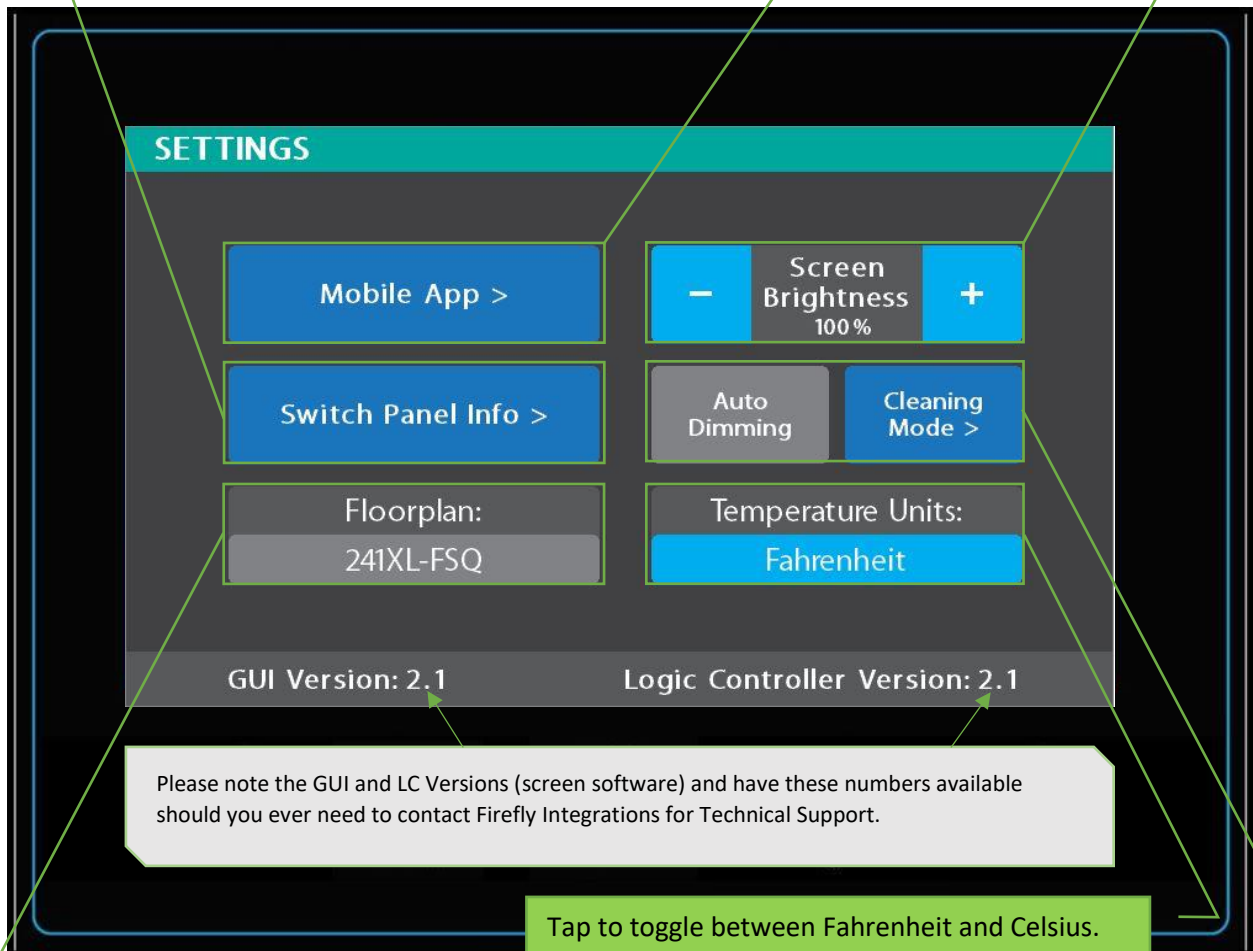

Please note the GUI and LC Versions (screen software) and have these numbers available should you ever need to contact Firefly Integrations for Technical Support.

Tap to toggle between Fahrenheit and Celsius.

Floorplan display.

Auto Dimming- when enabled the screen will enter sleep mode after 60 seconds of inactivity. Tap anywhere on the screen to wake it up.

Clean Mode- Disables the touchscreen functionality for the purpose of cleaning. Tap any navigation button to exit Clean Mode.

---

## Settings/Switch Panel Info

---

This screen will display the current status and battery level of each wireless switch panel in the coach. If “status unknown” appears, it is likely that you need to replace the coin cell battery behind the switch. Please see the Multiplex Hardware section of this manual for installation assistance.

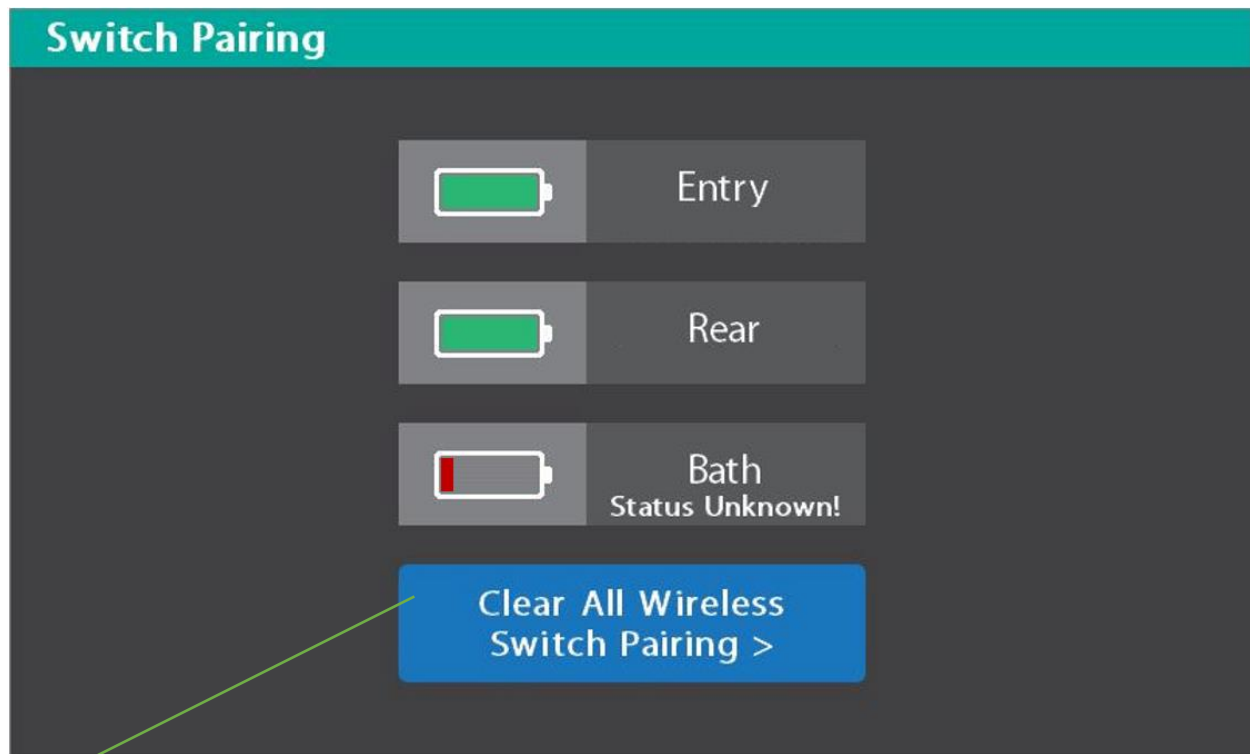

This button will remove the wireless connectivity between the touchscreen and your switch panels. This feature should not be used without first consulting Firefly Integrations.

---

## Settings/Mobile App (Vegatouch Mira)

---

Notice: Make sure that Bluetooth is turned ON in your smart device settings before proceeding.

### Locate the Login Information:

The login information can be found by clicking on the settings page of the color touchscreen or from the Mira module's label.



### Download:

Download Vegatouch Mira from the Google Play store or the App Store. Once the download has finished, install the app and open it.



### Setup:

Tap SCAN to find the Mira Module's signal. After scanning, any Mira Module in your area will appear on the screen. Tap the ID # that matches the one on your Mira label. Enter the PIN number from the Mira label and press AUTHENTICATE to connect to the system.

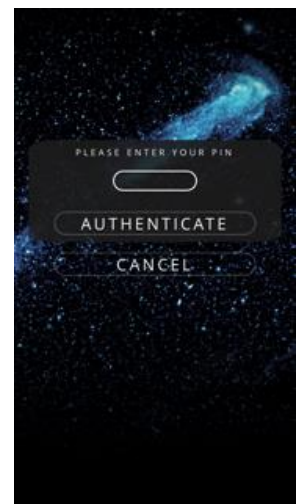

## Notice: iOS Setup Tips

### Turn on Bluetooth to allow Vegatouch Mira to connect to Accessories.

If you do not have Bluetooth turned ON in your iOS settings you will see this screen. Do not click OK, you must click SETTINGS. Your Bluetooth Settings page will now appear and you should turn Bluetooth ON.

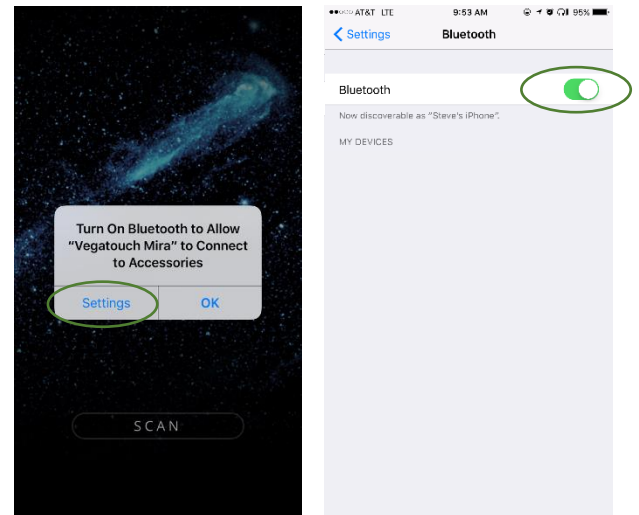

## Notice: Android Setup Tips

### Allow Vegatouch Mira to access this device's location.

Mira will need to be allowed access to your location. Click ALLOW when you see this screen.

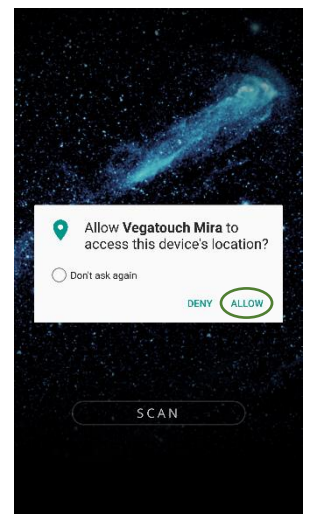

## App Settings:

Access the App Settings page by pressing the Gear icon on the App Navigation Bar.

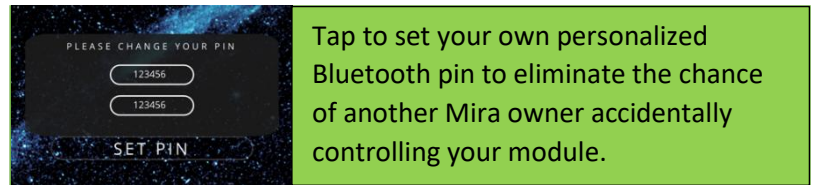
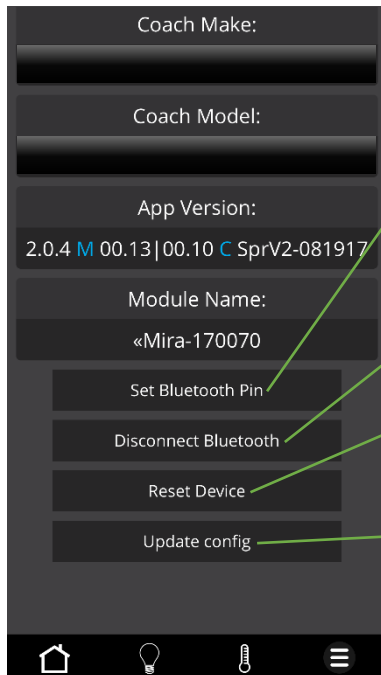

Tap to set your own personalized Bluetooth pin to eliminate the chance of another Mira owner accidentally controlling your module.

Tap to disconnect your device from Mira.

Tapping Reset Device will completely restart the Module and reconnect once it has powered back up.

Tapping Update Config will force a download of the config from the cloud.

---

## Multiplex Hardware

---

This coach uses SSP17 wireless switch panels to conveniently control lighting and other functions with the touch of a button.

Note: if the green LED at the bottom of the switch fails to illuminate when a button is pressed you will need to change the battery. Simply pry the switch from the wall at each corner to expose the battery compartment on the rear of the switch and replace the 2032 coin cell battery. Once it has been changed, simply line up the switch on the wall plate and snap the switch back into place.

You can check battery status for all panels by clicking on the settings screen on the spectrum screen.

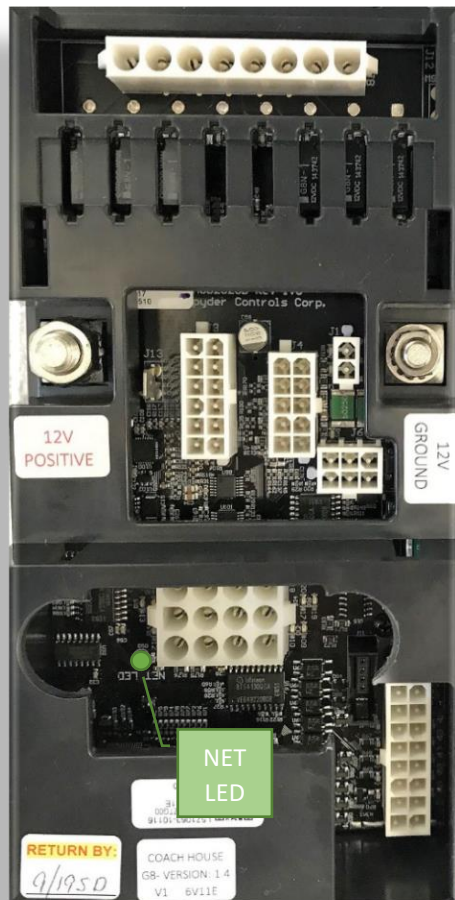

Your G8 panel is the power distribution center for the coach. This panel receives the signals sent from your Spectrum screen/switch panels and performs the actions that have been requested by activating and deactivating the required circuits.

Your G8 panel, Spectrum screen and switch panels are connected via your coach's RV-C network. The G8 has a NET LED that is used to show network status. If the NET LED is displaying anything other than solid green and some of the panel's functions are not working, please contact Firefly Integrations for technical support.