



FULLHOUSE

2018 LUXURY ASSET HAULER



LX455

Shown in Mocha Cherry

2 | Full House



FROM THE MOST RESPECTED NAME IN FULL-TIME RVS...

Full House is built on the foundation of a Mobile Suite, it is built to be used, traveled with, and lived in! So gather your assets, start your adventure, and enjoy true luxurious full-time living with our new Full House.

People want to bring their toys with them on their travels. The Full House brings well thought out floor plans and upgraded construction to the toy hauler market.

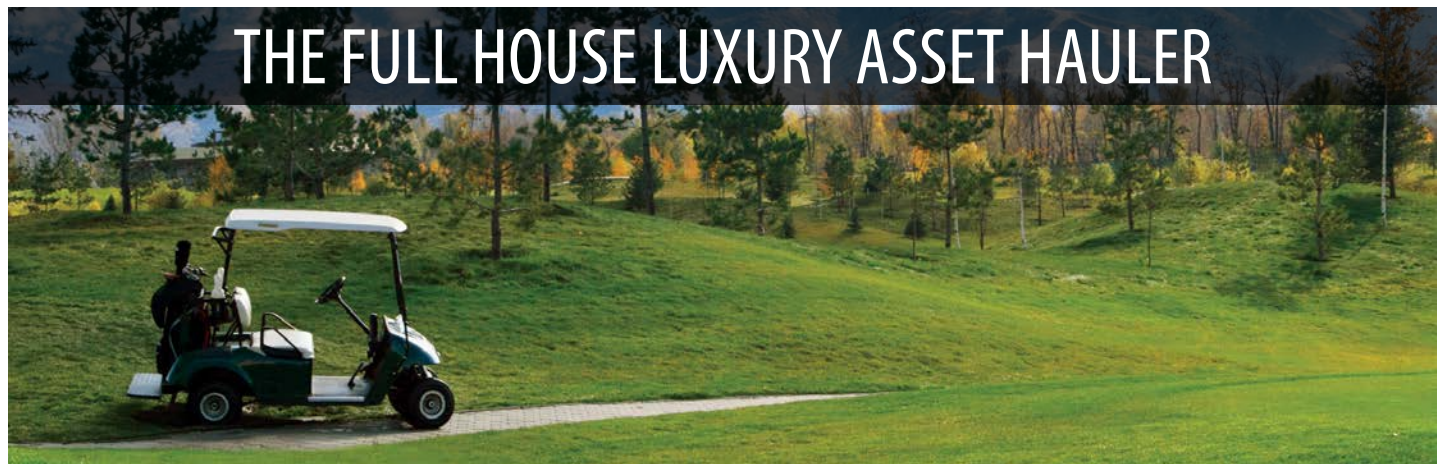
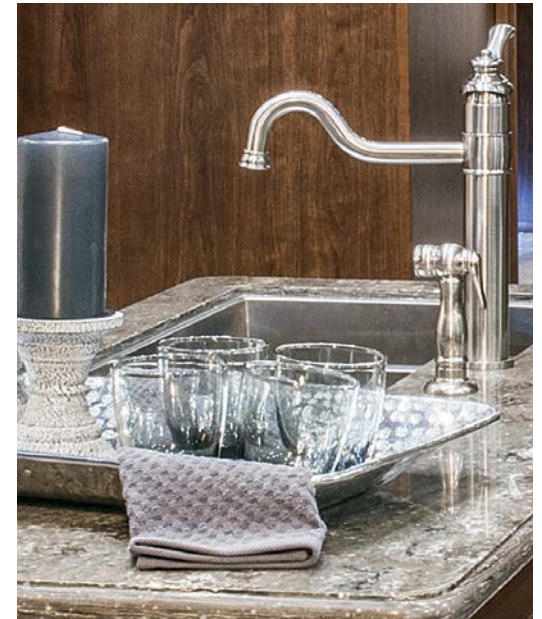

THE FULL HOUSE LUXURY ASSET HAULER



LX455

Shown in Mocha Cherry

4 | Full House

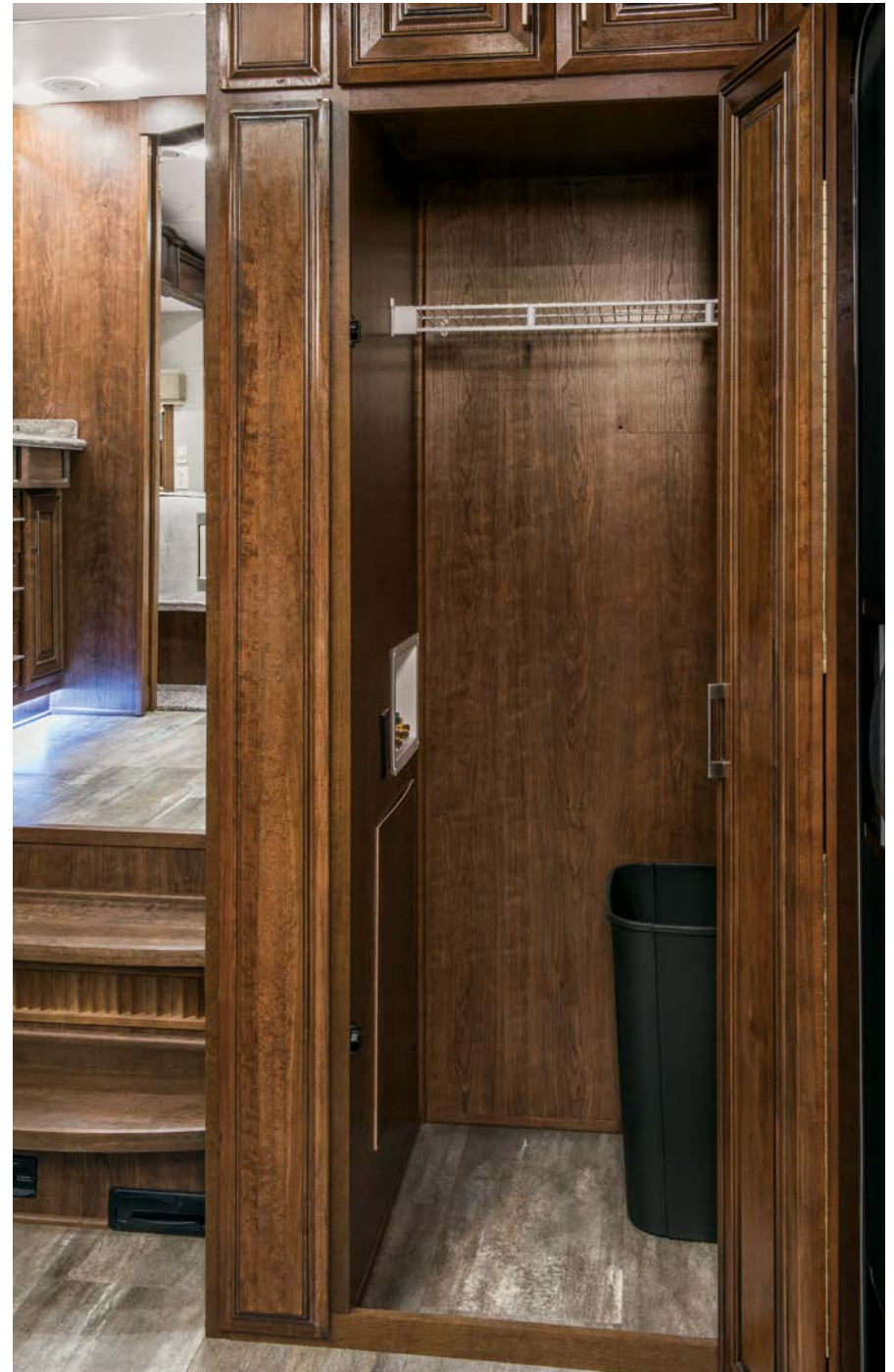

Full-time living requires several items most toy haulers tend to ignore, but with Full House we put an emphasis on ensuring each floor plan offers a spacious kitchen with residential appliances, and functional storage.



LX455

Shown in Mocha Cherry

6 | Full House



All Full House models feature a standard vanity slide providing more room in front of the bed. Each master suite offers excellent storage capabilities that include a walk-in closet with cedar lining and full underbed storage.



Our master bathroom provides a full fiberglass shower, custom medicine cabinets, and built-in indirect lighting. Every corner of the Full House is utilized to ensure maximum comfort for all seasons of travel.



LX455

Shown in Mocha Cherry



The Full House takes the typical toy hauler garage to the next level. Every model comes standard with custom metal cabinetry, a 49" LG TV, and diamond plate accents throughout.

The optional patio enclosure is a popular choice. You can also add electric drop down beds, jack knife sofas, and a three season patio enclosure.

STANDARDS

Frame/Running Gear:

- Goodyear® 17 1/2" H-Rated Re-Groovable Tires
- Heavy Duty Grease Bolt Shackles with Bronze Bushing
- Automotive Style Disc Brakes
- Heavy Duty 8,000 Lb. Rated Axles
- Commercial Grade EZ Lube Hubs
- 15" Triple Stacked Box Tube Frame
- 101" Wide Body
- Industrial Hydraulic System for Jacks and Lower Level Slides
- Electric Bedroom Slide
- Slide Outs with Select Push Button Controls
- Pinless, Industrial Hydraulic Front Landing Jacks at 5 Degree Outboard Angle

Construction: Floor

- 3" Thick Floor
- 14" O.C. Floor Aluminum Floor Joists
- Screwed and Glued Joist Construction
- 5/8" Tongue and Groove Plywood Flooring
- Four Season Perimeter Heat Ducting in Floor
- Residential Rated R29 Formaldehyde Free Wool Insulation

Construction: Walls/Slides

- 3 1/4" Thick Walls/Slides
- 16" O.C. Stud Spacing
- Screwed and Glued Aluminum Stud Construction
- 1/4" Monsanto® Fome-Cor Vapor Barrier (Eliminates Condensation)
- 1/4" Thick High Gloss Gelcoat Fiberglass with Wood Backer
- Residential Rated R16 Formaldehyde Free Wool Insulation

Construction: Roof

- 16" O.C. Rafter Spacing
- Residential Rated R25 Formaldehyde Free Wool Insulation
- 1/2" Plywood Roof Overlayment
- Seamless, 1-Piece Rubber Roof
- Soft-Touch Vinyl Ceiling, Including Interior Slide-Out Ceilings

Exterior:

- Straight Roof Line with 8' Tall Interior Slide Out Height
- Subzero Thermo-Pack High Density Wool Insulation
- High Gloss Gelcoat Fiberglass
- High Gloss Gelcoat Fiberglass Molded Caps
- Custom Painted Exterior with Clear Coat
- Frameless Tinted Safety Glass Windows
- Back-Up Lights with 50 Watt Halogen Lights
- Commercial LED Exterior Clearance Lights
- Mid-Ship Turn Signal
- LED Docking Lights
- Dual 78" Entry Door
- Removable Storm Door Panels
- Metal Slam Door Compartment Latches
- Extra Thick Compartment Doors with Gas Struts
- Easy Access Light Switches for Basement
- Custom Enlarged Control Center with LED Lighting
- Lend-a-Hand Exterior Grab Handle
- Power Awning with Aluminum Weather Shield (Over Both Entry Doors)
- Water Pump Switch at Outside Hookup Center

Systems/Tanks:

- 50 Amp Service with Detachable Cord
- 80 Amp 12 VDC Converter
- 100 Gal. Fresh Water Tank
- 75 Gal. Grey Water Tank with Power Flush
- 50 Gal. Black Water Tank with Power Flush
- SeeLevel Tank Monitoring System on All Tanks
- Residential Type 1/2" Water Lines
- Exclusive Copper Water Manifold with Individual Shut-Off Valves
- Whole House Water Filtration System
- Anderson Multi-Switch Water Bypass System
- Slide Out Propane Tray with Dual 40 Lb. Tanks
- 12VDC Battery on Pull Out Tray

- 12 Gal. Gas/Electric DSI Water Heater
- 40,000 BTU Furnace with Custom Plenum
- Residential 5 Duct Heating System with 6" Ducting
- Forced Heat Ducting to Tanks/Water System
- Fully Ducted A/C System with Cold Air Return
- Triple 15,000 BTU Low-Profile A/Cs
- Solar Prep
- HD Roof Satellite Prep for Dual DVR Receivers
- HD Ground Satellite and Cable Prep
- HD TV Antenna

Interior: Luxury Living Room/Dinette

- Hand Laid Vinyl Floor Tile
- Residential Rebound Carpet Pad
- Plush Residential High Durability Nylon Carpet
- Hazelnut/Mocha Cherry Solid Hardwood Cabinetry
- Solid Hardwood Fascia Trim Around Slide Outs
- Solid Hardwood Cabinet Stiles (Pocket Drilled/Screwed)
- Concealed Cabinet Door Hinges
- Raised Panel Cabinetry
- Soft-Close Full Extension Metal Drawer Guides
- LED Interior Ceiling Lighting on Dimmer Switches
- Utility Closet with Coat Storage and Centralized Control Station
- Interior Ceiling Fan
- Custom Hardwood Dinette Buffet with Solid Surface Top (Most Models)
- Dinette Table with Hidden Leaf Extension (Most Models)
- (2) Hardwood Dinette Chairs with Fabric Accent (Most Models)
- Crown Molding Throughout
- HD Wiring Throughout

Interior: Gourmet Kitchen

- 20 Cu. Ft. Residential Stainless Steel French Door Refrigerator
- Pull-Out 13 Gal. Garbage Can
- Stainless Steel Convection/Microwave

- Deep Double Bowl Stainless Steel Sink with Sink Covers
- Residential Kitchen Faucet with Separate Sprayer
- High Polished Solid Surface Countertops
- Sealed 3 Burner Cooktop with Hinged Countertop Lift
- Custom Appliance Garage with Pull-Out Tray (Most Models)
- Lighted Pantries and Kitchen/Bathroom Toe Kicks

Interior: Master Bath/Hallway

- Hardwood Steps
- Hand Laid Vinyl Tile in Hallway/Bathroom
- No Carpet in Hallway
- Washer/Dryer Prep
- Heat and A/C Ducting in Bathroom
- Maxxair® Fan in Bathroom
- 1-Piece Fiberglass Shower with Molded Seat
- Sky-Light Over Shower with LED Pot Light
- Porcelain Toilet with Water Saver Spray
- Macerator Toilet (Some Models)

Interior: Master Bedroom

- Custom Walk-in Front Closet with Built in Dresser (Most Models)
- Real Cedar Lined Front Closet
- Custom Hardwood Wardrobe Doors
- King Bed Suite 72" x 80" with Innerspring Mattress (Most Models)
- Full Storage Under Bed Base
- Separate Bedroom Ceiling Speakers
- Over the Bed Reading Lights on Separate Switches
- Vanity Slide

Garage:

- Industrial Metal Overhead Cabinetry
- LED Lighting
- 49" LED HD TV
- Touch Screen/Blue Tooth Garage Audio/Entertainment System
- Dual 30 Gal. Fuel Tanks with Fuel Pump and Fill Station

Full House Package (Forced Option):

- 55" LG® LED TV and Home Theatre Package
- 32" LG® LED Bedroom TV Package
- 49" LG® LED TV Garage
- Whole House Central Vacuum
- Garage Entertainment System with Touch Screen
- Goodyear® 17 1/2" H-Rated Spare Tire
- Side Mounted Fold-Out Ladder
- Frameless Thermopane Windows
- Dual Door 4-Step Entry

Executive Package (Forced Option):

- MCD Day/Night Roller Shades
- Built-In Fireplace
- Magnum 1000W Inverter with Dual 6V Batteries
- Maxxair® Fan with Rain Sensor - Bathroom
- Maxxair® Fan with Rain Sensor - Kitchen
- Power Management System
- Six Point Hydraulic Leveling System
- One Touch Auto Leveling
- Keyless Entry Door (Both Doors)
- Onan 5.5 Gasoline Generator with Auto Gen. Start

OPTIONS

Cabinetry (Standards):

- Hazelnut
- Mocha Cherry

Décor (Standards):

- Gettysburg
- Mica
- Regency

Flooring (Standards):

- High Ounce Nylon Carpet
- Hand Laid Vinyl 12" x 24" Floor Tiles

Countertop (Standard):

- High Polished Solid Surface

Interior:

- Power Recliner Theatre Seating/Recliners

- Hazelnut Folding Chair
- Mocha Cherry Folding Chair

Entertainment:

- 32" Samsung® LED HDTV Outdoor Entertainment (Some Models)
- Winegard® Trav'ler HD Auto Satellite
- WiFi Ranger Wireless Router

Kitchen:

- 3 Burner Range/Oven IPO
- 3 Burner Cooktop

Bedroom:

- Built in Front Wardrobe Safe with Keyless Entry
- Queen Bed Suite

Garage:

- Electric Drop Down Sofa/Bed
- Electric Drop Down Bed
- Fold-Up Outdoor Patio
- 3 Season Patio Door
- Removable Table

Systems/Vents/Fans:

- Heat Pump
- Maxxair® with Switch Control – Garage
- Splendide® Front Load 2 piece
- Splendide® XC 2,100 Combo

Construction/Running Gear:

- Power Cord Reel (Some Models)
- HBA Brake Cam (To be Ordered Special for Customers with GM Trucks)

Exterior/Awnings:

- Slide Toppers
- Power Dinette Slide Awning with Weathershield
- Slide Out Storage Tray (36" x 90")
- Audible Wireless Backup Camera System
- CSA

Exterior Options:

- Biltmore Breeze (Full Body)
- Lyndhorst Shore (Full Body)
- Monticello Mountaintop (Standard)



Biltmore Breeze Full Body Paint (Option)

décor



Gettysburg

Sofa Pillows

Dinette Chairs



Mica

Sofa Pillows

Dinette Chairs

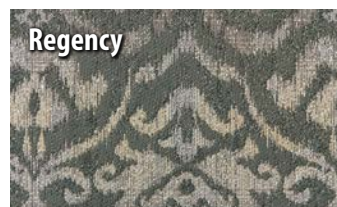

Regency

Sofa Pillows & Dinette Chairs

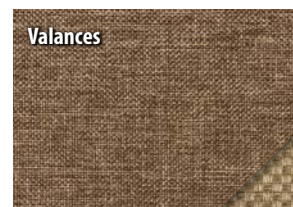

Valances



Café Sofas



Cocoa Sofas



Monticello Mountaintop Partial Body Paint (Standard)



Linen Sofas



Hazelnut

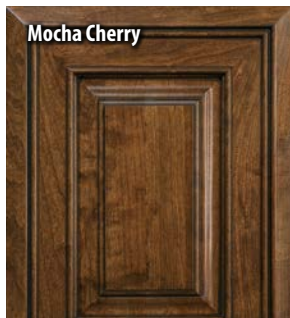

Mocha Cherry

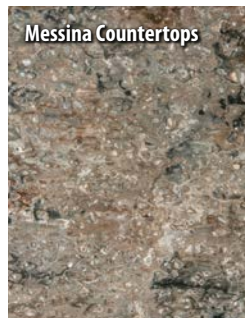

Messina Countertops



Jasmine Tile



High Ounce Nylon Carpet

FULL HOUSE FLOOR PLANS

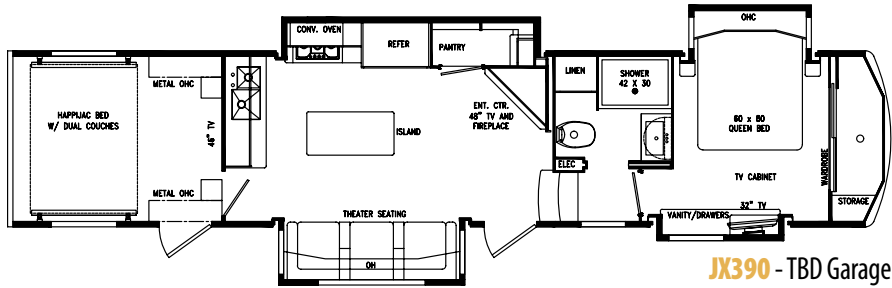

JX390 - TBD Garage

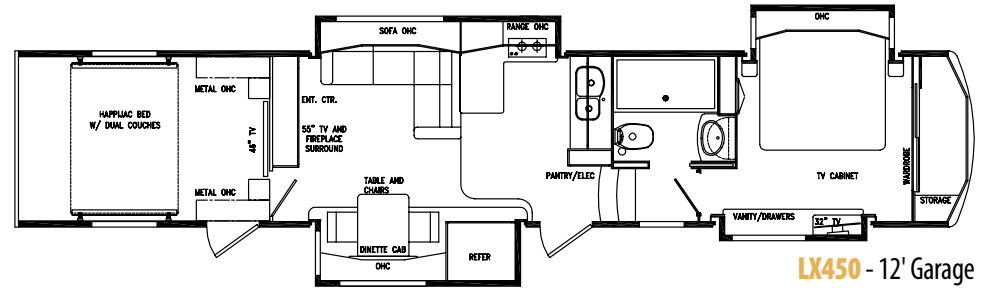

LX450 - 12' Garage

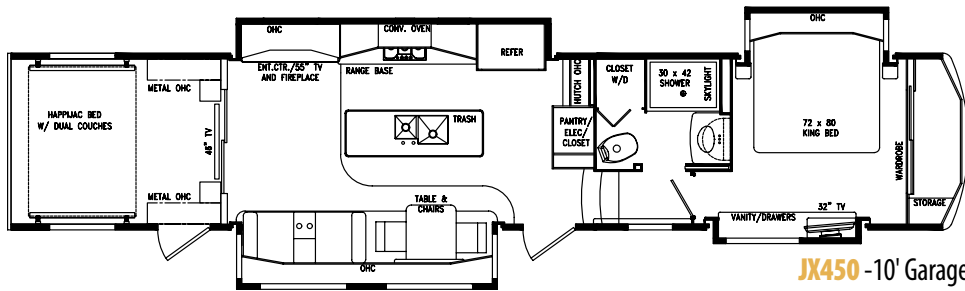

JX450 - 10' Garage

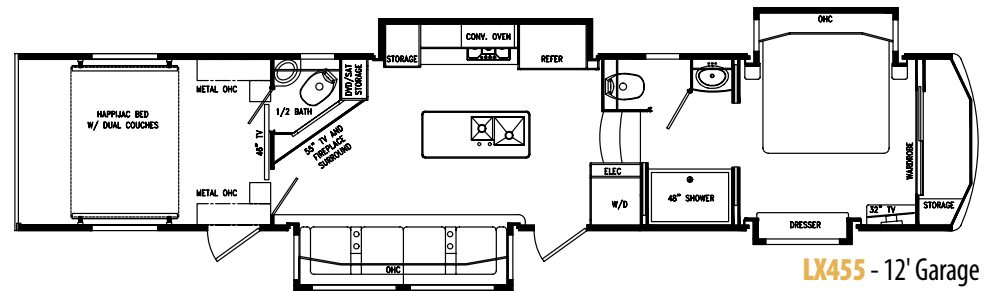

LX455 - 12' Garage

- Est. Dry Weight - 18,800 lbs
- GVWR - 24,000 lbs.

- Fresh Tank - 100 gal.
- Black Tank - 50 gal.

- Gray Tank - 75 gal.
- Hot Water Heater - 12 gal.

- Automotive Disc Brakes
- 8,000 lb. Rated Axles

- Goodyear 17 1/2\"/>

Please Note: All dry weights are estimates depending on options.



0160 W 750 N • PO Box 235
Howe, IN 46746

Factory tours by appointment,
please call for specifics 260-562-1075

www.drvsuites.com



This brochure is based upon the latest product information available at the time of printing. DRV reserves the right to make changes at any time to prices, colors, materials, equipment, specifications and models, and to discontinue models without notice or obligation. Color representations are as close as photographic/print reproduction will allow. All specifications are approximate and dimensions nominal. Text and/or photos may represent equipment or décor items which may not be included as a standard item in your model of choice.