

Jayco | 2024 Jay Feather Travel Trailer



JAY FEATHER

ADVENTURE IS CALLING



2+3
YEAR | YEAR
WARRANTY

INTERIOR DESIGN



VINTAGE FARMHOUSE



Main Wood



Accent Wood



Floor



Countertop



Main Fabric



Accent Fabric

19MRK



21MBH OPTION: B



21MML

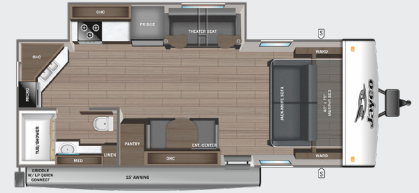

22BH



22RB OPTION: B

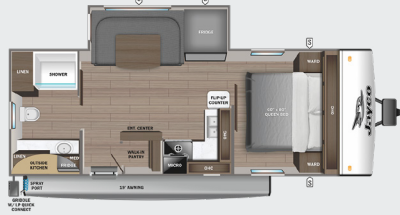

23RK OPTION: A



24BH OPTION: B



24RL OPTIONS: A, B

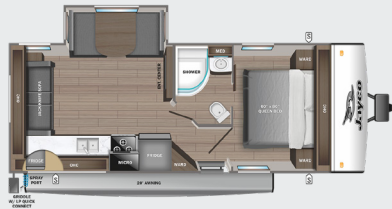

25RB OPTIONS: A, B





26RL OPTION: A



27BHB OPTIONS: A, B



-  STORAGE
-  MICRO MICROWAVE
-  OHC OVERHEAD CABINETS
-  FRIDGE REFRIGERATOR
-  WARD WARDROBE

29QBH OPTIONS: A, B

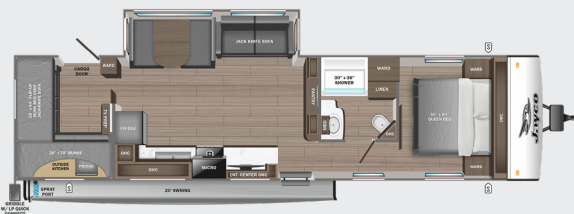

OPTIONS

A



Tri-Fold Sofa

B



Theater Seat

STANDARDS & OPTIONS

EXTERIOR

- 1.5 in. fresh water drain valve
- 2 in. Stronghold VBL™ floor with 2 lb. density foam
- Aerodynamic, rounded front profile with aluminum framing
- American-made Norco Z-frame with integrated A-frame
- Automotive-style aluminum rims
- Battery quick-disconnect
- Bumper-mount bracket for 17 in. griddle
- Dark-tinted safety-glass windows
- Exterior TV bracket with 120V and cable hook-ups
- Factory installed rear roof ladder
- Front molded decorative cap (select models)
- Galvanized steel and impact resistant wheel wells
- Keyed-Alike™ locking system
- Magnum Truss™ Roof System with limited lifetime warranty
- Marine grade exterior speakers with blue LED accent lighting
- Mounted camera bracket for pre-wired side and rear back-up prep
- Outdoor camp kitchen with galvanized steel bases (select models)
- Stronghold VBL™ walls with double-sided Azdel composite (sidewalls, rear walls and slide out boxes)
- Swing-out entry door assist handle

INTERIOR

- 4 in. high-density dinette cushions with vinyl backing
- 4 in. Teddy Bear soft-touch bunk mats (select models)
- 60 x 80 in. residential queen beds (60 x 76 in. in Murphy bed models)
- 75 lb. full extension drawer guides
- Bathroom skylight
- Decorative backsplash
- Decorative roller shades with reflective barrier

- Directional and closeable A/C vents
- Gas-strutted under bed storage (most models)
- Handcrafted, hardwood door/drawer fronts
- Hidden-hinged cabinet doors
- High output auto-ignition propane gas furnace
- LED lighting throughout
- Plywood dinette, bed, bunk and shower/tub bases
- Powered roof vents in bathroom and main bedroom (most models)
- Residential style kitchen countertops
- Residential vinyl flooring throughout
- Screwed and glued cabinet stiles
- USB charging ports (multiple locations throughout)

CUSTOMER VALUE PACKAGE (MANDATORY)

- 13,500 BTU roof-mounted A/C
- 20 lb. propane gas bottles with auto-regulator and ABS cover
- 55 gallon fresh water tank
- AM/FM/Bluetooth stereo with roof-mounted speakers
- American-made nitro-filled Goodyear® radial tires with self-adjusting electric brakes
- Automotive-style aluminum rims
- Black tank flush
- Detachable power cord
- Inverter pre-wire (2 bedroom nightstand outlets, main TV and outlet for outside kitchen fridge)
- Max-length power awning with LED light
- On-demand water heater 60,000 BTU water heater
- Outside shower
- Power tongue jack
- Rock Solid Stabilizer System
- Side and rear back-up camera prep
- Spare tire

SPORT PACKAGE (MANDATORY)

- 32 or 39 in. LED Smart TV
- Climate Shield (zero to 100 degree tested weather insulation package)
- Drying rack/sink cover
- Dual-hinge 10 cu. ft. 12V fridge
- LCI Solid Step fold-down aluminum tread steps on main entry door
- MAXXAIR® power roof vent (main living area)
- Modern graphics package with dual-colored sidewall
- Overlander 1 Solar Package: (1) 200W solar panel and 30-amp digital controller

OPTIONS

- 120V heated tank pads
- 15,000 BTU A/C in place of 13,500 BTU A/C
- 17 in. outside griddle (select models)
- 30 lb. propane gas bottles with auto-regulator and ABS cover
- 50-amp service with 2nd A/C prep
- Electric fireplace (select models)
- JAYCOMMAND® Smart RV System with TPMS
- Overlander 2 Solar Package: (2) 200W solar panels, 30-amp digital controller and 1,800W inverter
- Second 15,000 BTU A/C (select models, must have 50-amp service)

*Indicates split tanks

FLOORPLAN	TOTAL EXTERIOR LENGTH	EXTERIOR WIDTH	EXTERIOR HEIGHT (WITH A/C)	INTERIOR HEIGHT	UNLOADED VEHICLE WEIGHT	DRY HITCH WEIGHT	GVWR	CARGO CARRYING CAPACITY	FRESH WATER CAPACITY	GRAY WASTE WATER CAPACITY	BLACK WASTE WATER CAPACITY	SLEEPING CAPACITY
19MRK	24' 0"	8' 0"	10' 9"	6' 6"	4,775	485	6,250	1,475	55	30.5	30.5	2-4
21MBH	27' 1"	8' 0"	TBD	6' 6"	TBD	TBD	TBD	TBD	55	30.5	30.5	6-8
21MML	26' 0"	8' 0"	10' 8"	6' 6"	5,110	535	6,500	1,390	55	30.5	30.5	2-3
22BH	28' 9"	8' 0"	10' 9"	6' 6"	5,520	590	7,000	1,480	55	61*	30.5	5-7
22RB	27' 10"	8' 0"	10' 8"	6' 6"	5,455	595	7,000	1,545	55	61*	34	2-3
23RK	29' 0"	8' 0"	10' 8"	6' 6"	5,785	530	7,200	1,414	55	30.5	30.5	2-4
24BH	30' 2"	8' 0"	10' 8"	6' 6"	5,900	670	7,500	1,600	55	61*	30.5	5-7
24RL	28' 7"	8' 0"	10' 9"	6' 6"	5,305	640	6,750	1,445	55	30.5	30.5	3-5
25RB	30' 8"	8' 0"	10' 9"	6' 6"	5,735	700	7,250	1,515	55	61*	34	3-5
26RL	31' 11"	8' 0"	10' 8"	6' 6"	6,120	665	7,500	1,380	55	30.5	30.5	2-3
27BHB	33' 2"	8' 0"	10' 9"	6' 6"	6,210	710	7,600	1,390	55	30.5	30.5	7-9
29QBH	36' 1"	8' 0"	10' 11"	6' 6"	6,970	785	8,500	1,530	55	61*	30.5	8-10

Meet your Jayco Dealer



Scan QR code for specification definitions

Some specs at the time of print may include estimates. For the most updated information, please visit Jayco.com

Jayco, Inc. | P.O. Box 460 | Middlebury, IN 46540

See dealer for further information and prices. All information in this brochure and on www.jayco.com is the latest available at the time of publication approval. Jayco reserves the right to make changes and to discontinue models without notice or obligation. Photography may show optional equipment or props used for decoration purposes only. RVs built for sale in Canada may differ to conform to Canadian codes. JAYCO and the JAYCO BIRD IN FLIGHT are registered trademarks of Jayco, Inc. Printed in USA 10/23 ©2023 Jayco, Inc.



Jayco - Part of Jayco Family of Companies