



Generations of family fun.

JAY FEATHER



TRAVEL TRAILER

JAY FEATHER



LIGHTWEIGHT FEATURE-FRIENDLY SERIES

2+3
YEAR | YEAR
WARRANTY

JAY FEATHER HYBRID



X23B Shown in Modern Farmhouse Interior Design



X23B Kitchen with Standard 3-Burner Cooktop and Glass Cover

FLOORPLANS

Scan QR code to view 360° tours



LEGEND

- STORAGE
- MICRO MICROWAVE
- OHC OVERHEAD CABINETS
- FRIDGE REFRIGERATOR
- WARD WARDROBE

SPECS

| FLOORPLAN | EXTERIOR TRAVEL LENGTH | EXTERIOR WIDTH | EXTERIOR HEIGHT (WITH A/C) | INTERIOR HEIGHT | UNLOADED VEHICLE WEIGHT | DRY HITCH WEIGHT | GVWR | CARGO CARRYING CAPACITY | FRESH WATER CAPACITY (INCLUDING WATER HEATER) | GRAY WASTE WATER CAPACITY | BLACK WASTE WATER CAPACITY | SLEEPING CAPACITY |
|-------------|------------------------|----------------|----------------------------|-----------------|-------------------------|------------------|-------|-------------------------|---|---------------------------|----------------------------|-------------------|
| X17Z | TBD | TBD | TBD | TBD | TBD | TBD | TBD | TBD | TBD | TBD | TBD | 6-7 |
| X19H | 20' 10" | 8' 0" | 10' 4" | 6' 6" | 3,910 | 375 | 4,950 | 1,040 | 48 | 30.5 | 22.5 | 6-7 |
| X23B | 24' 7" | 8' 0" | 10' 4" | 6' 6" | 4,490 | 490 | 5,500 | 1,010 | 48 | 30.5 | 22.5 | 6-7 |
| X23E | 26' 10" | 8' 0" | 10' 9" | 6' 6" | 5,235 | 620 | 6,150 | 915 | 48 | 30.5 | 30.5 | 8-9 |

Some specs at the time of print may include estimates. For the most updated information, please visit Jayco.com.

JAY FEATHER MICRO



166FBS Shown in Vintage Washed Gray Interior Design



12SRK Exterior Kitchen with Blackstone® Griddle

FLOORPLANS

Scan QR code to view 360° tours



12SRK



166FBS



171BH



173MRB



199MBS



Ext. Lgth: 13' 4"
Weight: 1,585 lbs.
Hitch: 180 lbs.



Ext. Lgth: 19' 8"
Weight: 4,035 lbs.
Hitch: 480 lbs.



Ext. Lgth: 20' 2"
Weight: 3,865 lbs.
Hitch: 405 lbs.



Ext. Lgth: TBD
Weight: TBD
Hitch: TBD



Ext. Lgth: TBD
Weight: TBD
Hitch: TBD

SPECS

Scan QR code for specification definitions



| FLOORPLAN | EXTERIOR TRAVEL LENGTH | EXTERIOR WIDTH | EXTERIOR HEIGHT (WITH A/C) | INTERIOR HEIGHT | UNLOADED VEHICLE WEIGHT | DRY HITCH WEIGHT | GVWR | CARGO CARRYING CAPACITY | FRESH WATER CAPACITY (INCLUDING WATER HEATER) | GRAY WASTE WATER CAPACITY | BLACK WASTE WATER CAPACITY | SLEEPING CAPACITY |
|-----------|------------------------|----------------|----------------------------|-----------------|-------------------------|------------------|-------|-------------------------|---|---------------------------|----------------------------|-------------------|
| 12SRK | 13' 4" | 6' 8" | 7' 10" | 4' 7" | 1,585 | 180 | 2,795 | 1,210 | 25.5 | N/A | N/A | 2 |
| 166FBS | 19' 8" | 8' 4" | 10' 4" | 6' 6" | 4,035 | 480 | 4,995 | 960 | 61 | 30 | 30 | 3-4 |
| 171BH | 20' 2" | 8' 4" | 10' 4" | 6' 6" | 3,865 | 405 | 4,995 | 1,130 | 61 | 30.5 | 30.5 | 4-5 |
| 173MRB | TBD | TBD | TBD | TBD | TBD | TBD | TBD | TBD | TBD | TBD | TBD | 2-4 |
| 199MBS | TBD | TBD | TBD | TBD | TBD | TBD | TBD | TBD | TBD | TBD | TBD | 5-8 |

Some specs at the time of print may include estimates. For the most updated information, please visit Jayco.com.

STANDARDS & OPTIONS

STANDARD EXTERIOR EQUIPMENT

| | Hybrid | Micro | 12SRK | TT |
|---|--------|-------|-------|----|
| Aerodynamic, rounded front profile with diamond plate | X | X | X | X |
| Modern retro graphics package with two-colored sidewall | X | X | X | X |
| Stronghold VBL™ vacuum-bonded, laminated floor & walls | X | | | X |
| Stronghold VBL™ vacuum-bonded, laminated composite floor & walls | | X | | |
| Vacuum-bonded, laminated bed platforms with reverse-cambered support (1,100 lb. capacity) (all hybrids) | X | | | |
| Keyed-Alike™ lock system (includes all tent latches) | X | X | X | X |
| Magnum Truss™ Roof System with one-piece seamless DiFlex II material | X | X | | X |
| American-made Norco® frame with integrated A-frame | X | X | X | X |
| American-made Dexter® E-Z Lube® axles (rubber torsion on the Micro series) | X | X | X | X |
| Single axle (X17Z hybrid & Micro series) | X | X | X | |
| Dual axles (N/A X17Z hybrid) | X | | | X |
| G20 tinted safety-glass windows | X | X | X | X |
| Marine-grade exterior speakers with blue LED accent lighting (2) | X | X | | X |
| Galvanized steel and impact-resistant wheel wells | X | X | X | X |
| 30-amp service | X | X | X | X |
| Outside grill propane quick-connect port | X | X | X | X |
| Water-repellent, scratch resistant Jayco DuraTek™ vinyl tent material with zipper windows (all hybrids) | X | | | |
| Permanently attached tent-to-bed base design (all hybrids) | X | | | |
| Aluminum tread entry steps | X | X | X | X |
| Outside camp kitchen (standard on select models) | | | X | X |
| Battery quick disconnect | | X | X | X |
| Slide topper prep (select models with slide rooms) | X | X | | X |
| Exterior TV prep with 120V electric and cable outlets | X | X | | X |

STANDARD INTERIOR EQUIPMENT

| | Hybrid | Micro | 12SRK | TT |
|--|--------|-------|-------|----|
| Choice of two interior design packages - Modern Farmhouse or Vintage Washed Gray | X | X | X | X |
| Retractable futon sofa | | | X | |
| LED lighting throughout | X | X | X | X |
| Smoked glass decorative inserts (select overhead cabinets) | X | X | | X |
| Screwed and glued cabinetry | X | X | X | X |
| Residential vinyl flooring with cold crack resistance | X | X | X | X |
| Decorative wall clock (select models) | X | | | X |
| Plywood dinette, bunk and bed bases (applicable models) | X | X | | X |
| Ball-bearing drawer guides with 75 lb. capacity | X | X | | X |
| 6 cu. ft. gas/electric refrigerator | X | X | | X |
| Residential oven with 3-burner recessed cooktop and glass cover | X | | | X |
| 3-burner recessed cooktop with glass cover | | X | | |
| Residential-style kitchen countertops | X | X | | X |
| Microwave | X | X | | X |
| Decorative backslash | X | X | | X |
| 4 in. high-density dinette cushions with vinyl backing | X | X | | X |
| Jayco exclusive Teddy Bear "soft-touch" residential-style bed mats (select models) | X | X | | X |
| 120V outlet and corner shelf in fixed bunks (bunk models only) | | X | | X |
| Plastic foot flush toilet | X | X | | X |
| Bathroom skylight and roof vent | X | X | | X |

CUSTOMER VALUE PACKAGE (MANDATORY)

| | Hybrid | Micro | 12SRK | TT |
|---|--------|-------|-------|-----|
| American-made nitro-filled Goodyear® radial tires | CVP | | CVP | CVP |
| Self-adjusting electric brakes | CVP | | CVP | CVP |
| Rubber torsion axle | | | CVP | |
| Aluminum rims | CVP | CVP | CVP | CVP |
| 2 - 20 lb. propane bottles with auto regulator | CVP | CVP | | CVP |
| 1 - 20 lb. propane bottle with auto regulator | | | CVP | |
| 13,500 BTU A/C | CVP | CVP | | CVP |
| Spare tire | CVP | CVP | CVP | CVP |
| Detachable power cord | CVP | CVP | CVP | CVP |
| Power awning with LED lights | CVP | CVP | | CVP |
| Power tongue jack | CVP | CVP | CVP | CVP |
| Black tank flush | CVP | CVP | | CVP |
| Outside shower | CVP | CVP | | CVP |
| Outside spray port | | | CVP | |
| Manual stabilizer jacks (4) | CVP | CVP | | CVP |
| 6 gal. gas/electric DSI water heater | CVP | CVP | | CVP |
| 32" 12V LED TV w/built-in soundbar with AM/FM/Bluetooth® | | | CVP | |
| AM/FM/Bluetooth® stereo | CVP | | | CVP |
| Side-marker camera prep | CVP | CVP | CVP | CVP |
| Rear camera backup prep | CVP | CVP | CVP | CVP |
| 360° Siphon® roof vent cap | CVP | CVP | | CVP |
| Enclosed underbelly | CVP | | | |
| Enclosed underbelly with insulation | | | CVP | |
| Power roof vent (in main living area) | CVP | CVP | | CVP |
| Roof-mount solar prep | CVP | | CVP | |
| Inverter pre-wire | CVP | | CVP | CVP |
| JaySMART™ (Safety Markers And Reverse Travel) LED lighting (patent-pending) | CVP | | CVP | |
| Drying rack - sink cover combo for dual bowl sink | CVP | | | |
| 12V/120V Dometic® cooler | | | CVP | |
| 17 in. Blackstone® griddle | | CVP | CVP | |
| 25 gal. fresh water tank | | | CVP | |

SPORT PACKAGE (MANDATORY)

| | Hybrid | Micro | 12SRK | TT |
|---|--------|-------|-------|----|
| Roof ladder | | | | SP |
| Aluminum tread entry steps | | | | SP |
| Enhanced graphics package | | | | SP |
| Front molded fiberglass cap | | | | SP |
| JaySMART™ (Safety Markers And Reverse Travel) LED lighting (patent-pending) | | | | SP |
| Roof-mount solar prep | | | | SP |
| Glacier Package includes enclosed underbelly | | | | SP |
| 24 in. , 32 in. or 40 in. LED TV | | | | SP |
| Drying rack/ sink cover | | | | SP |
| Power roof vent (main living area) | | | | SP |

JAY PRO PACKAGE (MANDATORY - (JAY FEATHER MICRO SERIES ONLY) (N/A 12SRK))

| | Hybrid | Micro | 12SRK | TT |
|---|--------|-------|-------|----|
| 16 in. Goodyear® off-road tires | | | JP | |
| Rubber torsion axle | | | JP | |
| Glacier Package includes enclosed underbelly | | | JP | |
| Roof-mount solar prep | | | JP | |
| Inverter pre-wire | | | JP | |
| JaySMART™ (Safety Markers And Reverse Travel) LED lighting (patent-pending) | | | JP | |
| 6 cu. ft. gas/electric refrigerator | | | JP | |
| 12V LED TV | | | JP | |

OPTIONS

| | Hybrid | Micro | 12SRK | TT |
|---|--------|-------|-------|----|
| 12V heated tank pads | 0 | 0 | | 0 |
| 15,000 BTU roof-mounted A/C | 0 | 0 | | 0 |
| 50-amp service with 2nd A/C prep (select models) | | | | 0 |
| 2 - 30 lb. propane bottles with auto regulator (select models) | | 0 | | 0 |
| 1 - 30 lb. propane bottle with auto regulator (select models) | | | 0 | |
| MORryde® StepAbove™ aluminum entry steps on main door (standard 16RK, 22RB, 24BH and all Micro series models) | | | | 0 |
| Accessory roof rack system | | 0 | 0 | |
| 8 cu. ft. 12V refrigerator | 0 | 0 | | 0 |
| 24 in. LED TV (select models) | 0 | | | |
| 32 in. LED TV (select models) | 0 | | | |
| New JAYCOMMAND® "Smart RV" system (includes TPMS) | | 0 | | 0 |
| Tri-fold sofa with table trays (select models) | | | | 0 |
| Heated bunk mats (2 for X17Z, X19H, X23B; 3 for X23E) | 0 | | | |
| Theater seating (select models) | | | | 0 |
| U-dinette in place of theater seating (16RK) | | | | 0 |
| L-lounger sofa in place of U-dinette (22RB, 24BH & 30QB) | | | | 0 |
| Booth dinette in place of theater seating (22RK) | | | | 0 |
| Convection microwave | | 0 | | |
| Solar Power Package | 0 | 0 | | 0 |
| 17" Blackstone® griddle | 0 | | | 0 |
| 2-bike storage rack | | 0 | | 0 |
| Side-mount 8,000 BTU A/C | | | | 0 |
| Thule® awning | | | | 0 |

X - Standard 0 - Optional CVP - Customer Value Package
 SP - Sport Package JP - Jay Pro Package

JAY FEATHER



27BHB Shown in Modern Farmhouse Interior Design



22RB Shown in Vintage Washed Gray Interior Design



Jayco's exclusive laminated wall construction process



MADE IN USA

Featuring Durawall® Technology - ENGINEERED to help you tow with confidence



50 percent Stronger
4,500 lbs. on a Jayco roof vs. other roofs



Jayco's roof **vs.** other roofs



JaySMART™ Lighting
LED light system, which provides 360 degrees of driver intentionality



Jayco's exclusive, patent-pending JaySMART lighting system more clearly indicates braking, reverse travel and turn signals to others on the road or at camp.

FLOORPLANS

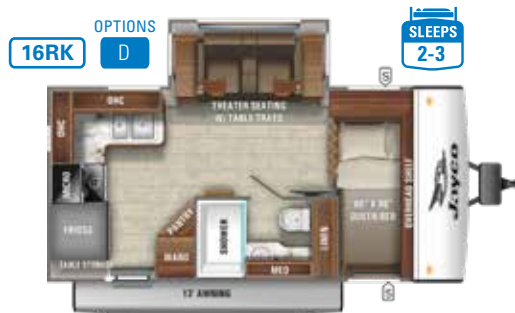

Ext. Lgth: **22' 4"** Weight: **4,755 lbs.** Hitch: **465 lbs.**



Ext. Lgth: **24' 2"** Weight: **4,625 lbs.** Hitch: **495 lbs.**



Ext. Lgth: **27' 9"** Weight: **5,655 lbs.** Hitch: **660 lbs.**



Ext. Lgth: **27' 10"** Weight: **5,490 lbs.** Hitch: **530 lbs.**



Ext. Lgth: **28' 7"** Weight: **5,360 lbs.** Hitch: **650 lbs.**



Ext. Lgth: **30' 2"** Weight: **6,220 lbs.** Hitch: **660 lbs.**



Ext. Lgth: **30' 7"** Weight: **5,850 lbs.** Hitch: **630 lbs.**



Ext. Lgth: **31' 8"** Weight: **6,030 lbs.** Hitch: **730 lbs.**



Ext. Lgth: **33' 1"** Weight: **6,300 lbs.** Hitch: **695 lbs.**



Ext. Lgth: **36' 11"** Weight: **7,295 lbs.** Hitch: **835 lbs.**

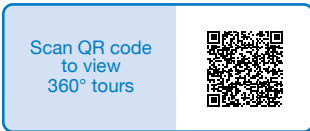

LEGEND

- STORAGE
- MICRO MICROWAVE
- OHC OVERHEAD CABINETS
- FRIDGE REFRIGERATOR
- WARD WARDROBE

OPTIONS

SPECS

Scan QR code for specification definitions



| FLOORPLAN | EXTERIOR TRAVEL LENGTH | EXTERIOR WIDTH | EXTERIOR HEIGHT (WITH A/C) | INTERIOR HEIGHT | UNLOADED VEHICLE WEIGHT | DRY HITCH WEIGHT | GVWR | CARGO CARRYING CAPACITY | FRESH WATER CAPACITY (INCLUDING WATER HEATER) | GRAY WASTE WATER CAPACITY | BLACK WASTE WATER CAPACITY | SLEEPING CAPACITY |
|--------------|------------------------|----------------|----------------------------|-----------------|-------------------------|------------------|-------|-------------------------|---|---------------------------|----------------------------|-------------------|
| 16RK | 22' 4" | 8' 0" | 10' 8" | 6' 6" | 4,755 | 465 | 6,000 | 1,245 | 48 | 30.5 | 30.5 | 2-3 |
| X213 | 24' 2" | 8' 0" | 10' 8" | 6' 6" | 4,625 | 495 | 5,500 | 875 | 48 | 30.5 | 22.5 | 6-9 |
| 22RB | 27' 9" | 8' 0" | 10' 8" | 6' 6" | 5,655 | 660 | 6,750 | 1,095 | 48 | 61* | 22.5 | 2-3 |
| 22RK | 27' 10" | 8' 0" | 10' 8" | 6' 6" | 5,490 | 530 | 6,750 | 1,260 | 48 | 61* | 30.5 | 2 |
| 24RL | 28' 7" | 8' 0" | 10' 8" | 6' 6" | 5,360 | 650 | 6,500 | 1,140 | 48 | 30.5 | 30.5 | 4-6 |
| 24BH | 30' 2" | 8' 0" | 10' 8" | 6' 6" | 6,220 | 660 | 7,250 | 1,030 | 48 | 61* | 30.5 | 7-8 |
| 25RB | 30' 7" | 8' 0" | 10' 8" | 6' 6" | 5,850 | 630 | 7,000 | 1,150 | 48 | 61* | 30.5 | 4-6 |
| 27RL | 31' 8" | 8' 0" | 10' 8" | 6' 6" | 6,030 | 730 | 7,000 | 970 | 48 | 30.5 | 30.5 | 4-6 |
| 27BHB | 33' 1" | 8' 0" | 10' 8" | 6' 6" | 6,300 | 695 | 7,600 | 1,300 | 48 | 61* | 30.5 | 8-9 |
| 30QB | 36' 11" | 8' 0" | 10' 8" | 6' 6" | 7,295 | 835 | 8,500 | 1,205 | 48 | 61* | 30.5 | 8-9 |

Some specs at the time of print may include estimates. For the most updated information, please visit Jayco.com.

*Indicates split tanks

Two **Unique & Beautiful** Concepts



Scan QR code to view Interior Design

True interior design. More choice. Mindful craftsmanship.

Every fixture, fabric and feature has been carefully selected and expertly installed. The result is an aesthetic that's extraordinary — with Jayco's famous high level of livability. Designer-selected patterns and fabrics enhance the overall look and feel, while unique furniture designs and contrasting hand-picked hardware and lighting enhance each exclusive decor package.

MODERN FARMHOUSE



WOOD



MAIN FABRIC



ACCENT FABRIC



FLOOR



COUNTERTOP

VINTAGE WASHED GRAY

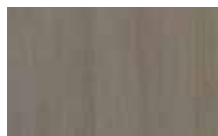

WOOD



MAIN FABRIC



ACCENT FABRIC



FLOOR



COUNTERTOP



Jayco, Inc. | P.O. Box 460 | Middlebury, IN 46540

See dealer for further information and prices. All information in this brochure and on www.jayco.com is the latest available at the time of publication approval. Jayco reserves the right to make changes and to discontinue models without notice or obligation. Photography may show optional equipment or props used for decoration purposes only. RVs built for sale in Canada may differ to conform to Canadian codes. JAYCO and the JAYCO BIRD IN FLIGHT are registered trademarks of Jayco, Inc. Printed in USA 11/20 ©2020 Jayco, Inc.

2+3

YEAR LIMITED | YEAR STRUCTURAL
WARRANTY

Travel With Confidence

NO ONE OFFERS A BETTER WARRANTY

At Jayco, we build our RVs to handle every adventure, then back them with our industry-leading 2+3 limited warranty. Our 2-year limited warranty has you covered for 2 camping seasons. That's 730 days. In addition, our 3-year structural limited warranty has you covered for 3 camping seasons or 1,095 days. You won't find a better limited warranty in the business, because the only strings that we attach are those that deliver the ultimate in reliability. That's the Jayco difference. So go explore. For a copy of our 2-year limited + 3-year structural limited warranty with complete terms and conditions, please contact your local Jayco dealer.

JAYCOMMAND[®]

The JAYCOMMAND[®] system puts RVers in full control of their unit.

The system was custom-built by our product development teams so that owners can monitor and control key RV operations from a phone or a tablet. (JAYCOMMAND[®] is optional on select Jay Feather products).

From the sales experience to service after the sale, we consider our dealers to be an important part of the Jayco family. Establishing a solid relationship with your local Jayco dealer is a key component in the enjoyment of your new Jayco. By purchasing from a local dealer, you will have a convenient location for sales, parts and service support. We hope you consider them a part of your camping family.

Meet your Jayco Dealer _____

Follow Jayco
#LetsJayco

