

ALPINE

ALPINE & AVALANCHE EDITION FIFTH WHEELS



KEYSTONE
RV COMPANY

CAMPBETTER
KINDNESS · COMMUNITY · PLANET



VISIT OUR WEBSITE FOR PHOTOS,
360° TOURS, AND FULL PRODUCT DETAILS



ALPINE THE EVOLUTION OF LUXURY TRAVEL

Step into the future of RVing with the 2024 Alpine fifth wheel – an embodiment of contemporary design and unparalleled innovation. Explore a new horizon of travel, where luxury meets cutting-edge technology to create an experience that is as fresh as it is unforgettable. With its sleek lines, smart features, and commitment to including luxury amenities in the standard build, 2024 Alpine models promise a lifestyle that seamlessly reflects your unique combination of adventure and sophistication.

Get ready to embrace the road ahead like never before, as you discover the essence of modern exploration in every corner of these exceptional RVs.

ALPINE EXCEPTIONAL FEATURES

- Drop-Frame Chassis
- 100" Wide Body Construction
- Dramatic High Ceilings w/ 6' 10" Tall Summit Slides
- High Gloss Exterior Sidewalls
- Panoramic Frameless Windows
- **NEW** Norco G 5.5 Slideout Mechanism
- **NEW** Flush Floor Kitchen Slides
- **NEW** Lippert Titan Hydraulic Auto-Leveling System w/ Digital Touchscreen & Under Frame Led Lighting
- Hitch Vision™ Technology in Fully Painted, Molded Front Cap
- Road Armor™ Suspension w/ 1/2" Shackle Plates
- Road Armor™ Rubberized Hitch Pin
- **NEW** Sailun G-rated Tires with 8-year manufacturer warranty, 1-year replacement warranty and 3 years roadside assistance
- Exclusive Four-Season RV Polar Pack™ Climate Protection
- Thermashield 37 Insulation
- **NEW** Dual Coleman-Mach Powersaver Quiet Series 15K BTU Air Conditioners
- Blade Pure™ High-Performance Air Flow System w/ Merv 9 Filtration
- iN-Command® Generation 3 w/Global Connect Smart RV Control System
- **NEW** 75-Gallon Fresh Water Tank w/ Quick Dump
- **NEW** Girard® On-Demand Tankless Water Heater
- 35K BTU Gas Furnace + 16.5K BTU Electric Heat Pump
- Attic Vents in All Models
- Day and Night Roller Shades
- Atwood and Easton Decor Options
(SEE KEYSTONERV.COM FOR DETAILS)
- Hardwood Cabinet Doors, Drawers, and Stiles
- LG Solid Surface Counters
- Insignia® Range w/ 3.73 Cu. Ft. Oven & 30" Convection Microwave
- 18 Cu. Ft. Residential or 20 Cu. Ft. 12V High-Efficiency Refrigerator
- Stackable Washer/Dryer Prep
- Back-Up and Side Camera Prep
- Large, Insulated Slam-Latch Baggage Doors
- 12V Electric Power Cord Reel
- SolarFlex™ Protect 220 and Discover 440i Packages w/ Optional Dragonfly Energy Lithium-Ion Batteries
- 1-Year Limited Base Warranty & 3-Year Limited Structural Warranty (SEE KEYSTONERV.COM FOR DETAILS)



Our home on wheels is the Alpine 3910RK. After traveling in this unit for over 1.5 years I can honestly say this is the ultimate RV for two. From having a huge master suite equipped with a king size bed, double sinks and a closet to fit a king it makes traveling feel luxurious. This unit also has a half bath, and a residential style kitchen that makes cooking a breeze. On days I don't want to cook inside, the outside entertainment center with a cooktop makes sitting outside and cooking enjoyable. After traveling and living in RVs for the past 9 years I can say Keystone knocked it out of the park with this layout we call our home on wheels.



@THATTRAVELINGWIFE — ALPINE 3910RK OWNERS

ALPINE FIFTH WHEELS

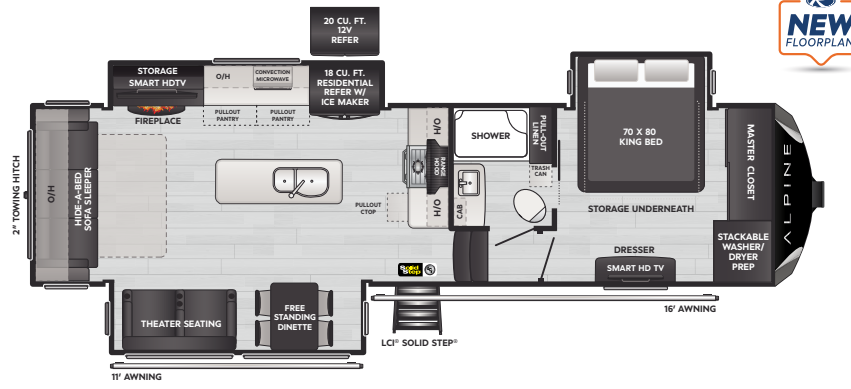

3011CK | WEIGHT 12490 | LENGTH 34' 11"

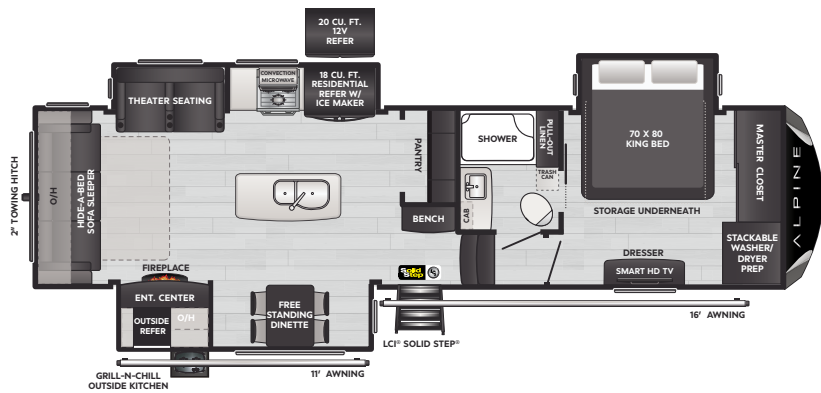

3102RL | WEIGHT 12370 | LENGTH 35' 9"

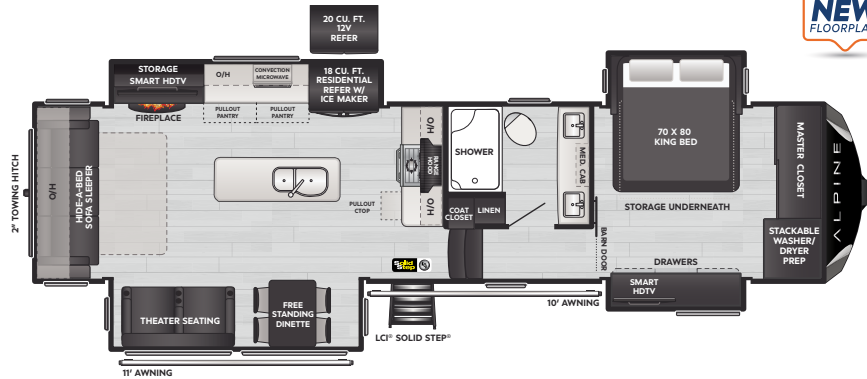

3303CK | WEIGHT 13060 | LENGTH 37' 3"

ALPINE SPECIFICATIONS

MODEL	WEIGHT	CARRYING CAPACITY	HITCH WEIGHT	FRESH WATER**	WASTE WATER	GRAY WATER	LPG	LENGTH*	WIDTH	HEIGHT	AWNING
3011CK	12490	2510	2345	75	49	83	60	34' 11"	8' 4"	13' 4"	16'/11'
3102RL	12370	2630	2485	75	49	83	60	35' 9"	8' 4"	13' 4"	16'/11'
3303CK	13060	3440	2560	75	49	83	60	37' 3"	8' 4"	13' 4"	10'/11'
3700FL	14065	2435	3080	75	78	78	60	41' 5"	8' 4"	13' 4"	14'/14'
3712KB	14165	2335	3055	75	44	78	60	41' 5"	8' 4"	13' 4"	14'/14'
3910RK	13895	2605	2915	75	83	83	60	42' 11"	8' 4"	13' 4"	20'/11'
3912DS	14400	2100	2625	75	98	132	60	43' 2"	8' 4"	13' 4"	16'/11'

ALPINE FIFTH WHEELS

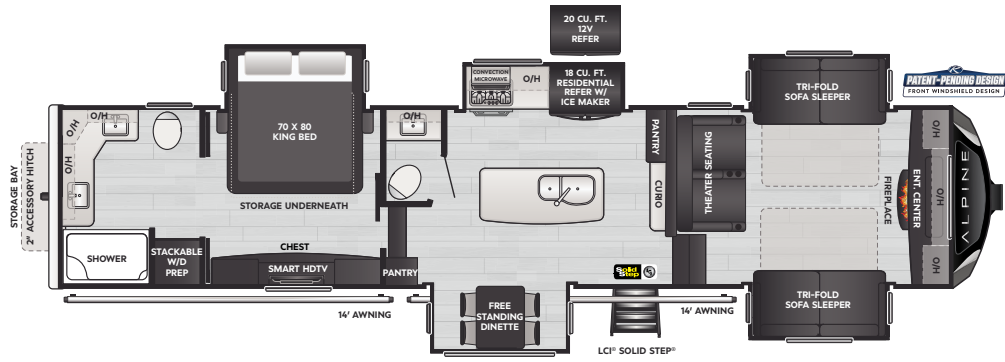

3700FL | WEIGHT 14065 | LENGTH 41' 5"

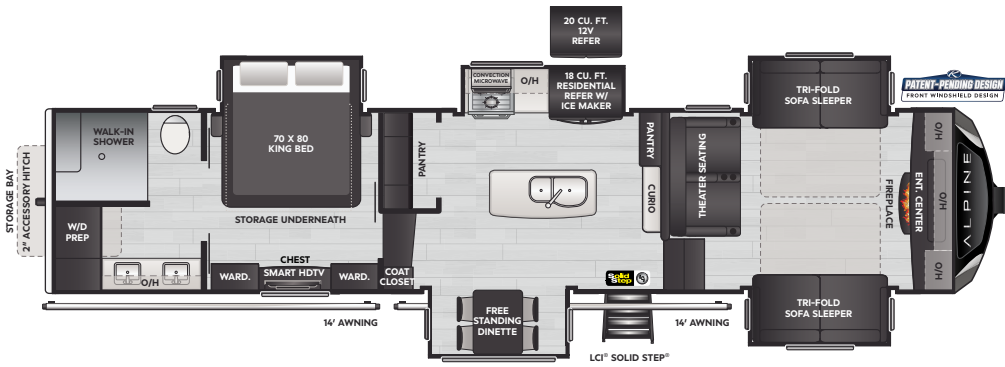

3712KB | WEIGHT 14165 | LENGTH 41' 5"

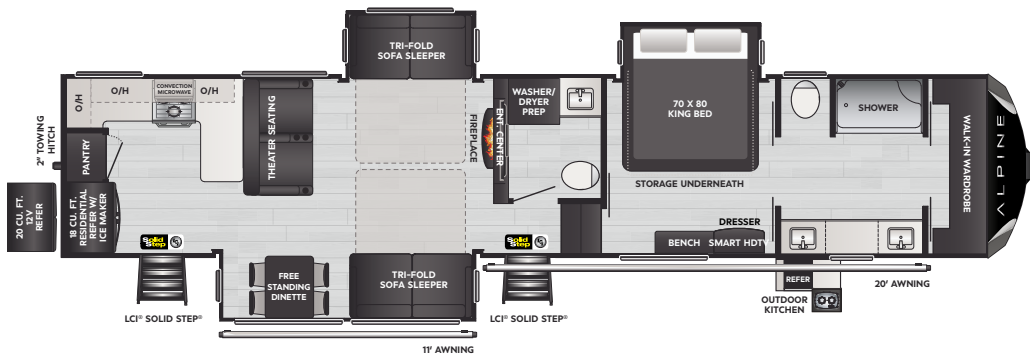

3910RK | WEIGHT 13895 | LENGTH 42' 11"

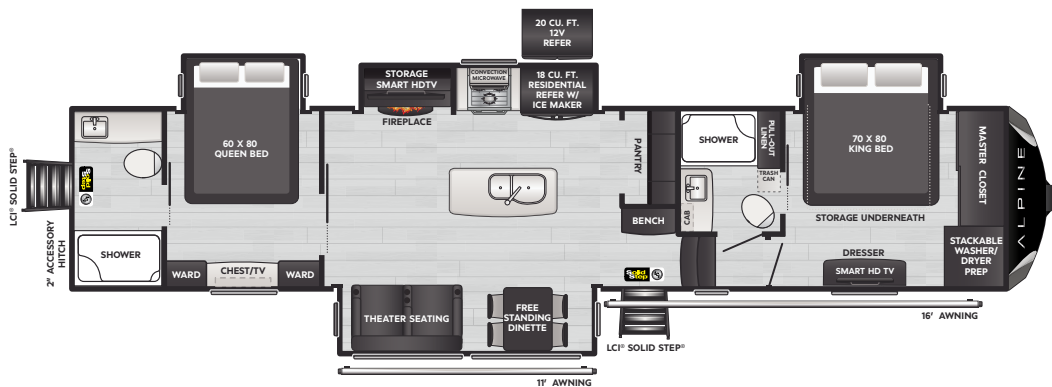

3912DS | WEIGHT 14400 | LENGTH 43' 2"

ALPINE AVALANCHE EDITION ELEVATED ADVENTURE FOR COUPLES & FAMILIES

Alpine's Avalanche Edition models strike the perfect balance between contemporary luxury and functional layouts, ensuring that every moment spent on the road is infused with comfort, convenience, and style. With a keen focus on slightly shorter floorplans that accommodate couples and families, the 2024 Alpine Avalanche Edition brings together innovative features and spacious interiors, setting the stage for unforgettable adventures that cater to both the spirit of exploration and the joy of quality family time.

ALPINE AVALANCHE EDITION EXCEPTIONAL FEATURES

- 100" Wide Body Construction
- Dramatic High Ceilings w/ 6'10" Tall Summit Slides
- **NEW** Norco G 5.5 Slideout Mechanism
- **NEW** Flush Floor Kitchen Slides
- **NEW** Lippert Titan Hydraulic Auto-Leveling System w/ Digital Touchscreen & Under Frame Led Lighting
- Hitch Vision™ Technology in Fully Painted, Molded Front Cap
- Road Armor™ Suspension w/ 1/2" Shackle Plates
- Road Armor™ Rubberized Hitch Pin
- **NEW** Sailun G-rated Tires with 8-year manufacturer warranty, 1-year replacement warranty and 3 years roadside assistance
- 2" Hitch Receiver w/ 4-Pin Towing Harness (SELECT MODELS)
- Backup Camera and Side Mount Camera Prep
- Exclusive Four-Season RV Polar Pack™ Climate Protection
- **NEW** Dual Coleman-Mach Quiet Series Powersaver 15K BTU Air Conditioners
- Blade Pure™ High-Performance Air Flow System w/ MERV 9 Air Filtration
- Suburban 35K BTU Gas Furnace
- Attic Vents in All Models
- **NEW** 75-Gallon Fresh Water Tank w/ Quick Dump
- **NEW** Girard® On-Demand Tankless Water Heater
- Atwood and Easton Decor Options (SEE KEYSTONERV.COM FOR DETAILS)
- Solid Surface Kitchen Countertops
- Furrion® Kitchen Appliances
- 18 Cu. Ft. Residential or 20 Cu. Ft. 12V High-Efficiency Refrigerator
- Stackable Washer & Dryer Prep
- 48" or 42" Fiberglass Shower w/ Seat
- King Sized Beds
- **NEW** JBL Sound System w/ MyZone®
- SolarFlex™ Protect 220 and Discover 440i Packages w/ Optional Dragonfly Energy Lithium-Ion Batteries

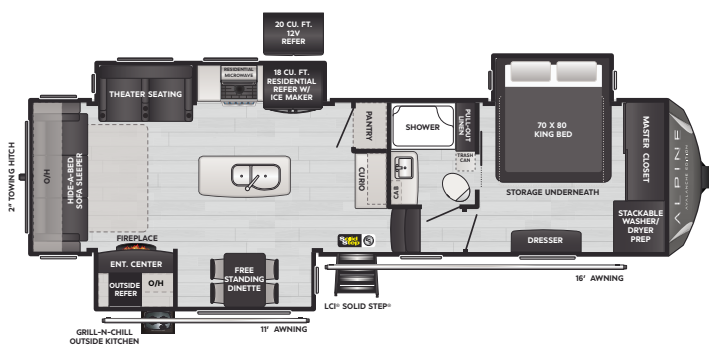

302RS | WEIGHT 11845 | LENGTH 34' 9"

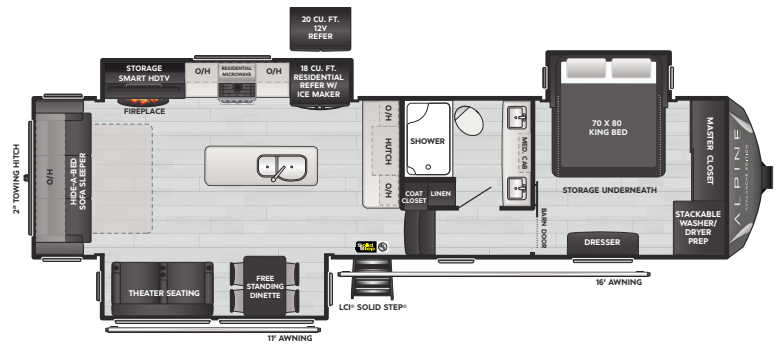

321RL | WEIGHT 12030 | LENGTH 36' 6"

ALPINE AVALANCHE EDITION SPECIFICATIONS

MODEL	WEIGHT	CARRYING CAPACITY	HITCH WEIGHT	FRESH WATER**	WASTE WATER	GRAY WATER	LPG	LENGTH*	WIDTH	HEIGHT	AWNING
302RS	11845	3155	2385	75	49	83	60	34' 9"	8' 4"	13' 2"	16'/11'
321RL	12030	2970	2420	75	49	83	60	36' 6"	8' 4"	13' 2"	16'/11'
338GK	12685	2815	2790	75	49	83	60	37' 11"	8' 4"	13' 2"	19'/11'
346FL	13050	3450	2595	75	49	83	60	38' 11"	8' 4"	13' 4"	16'/10'
378BH	13820	2680	3085	75	83	117	60	40' 7"	8' 4"	13' 4"	16'/10'
390DS	14258	2242	2740	75	98	132	60	42' 11"	8' 4"	13' 4"	16'/11'

ALPINE AVALANCHE EDITION FIFTH WHEELS

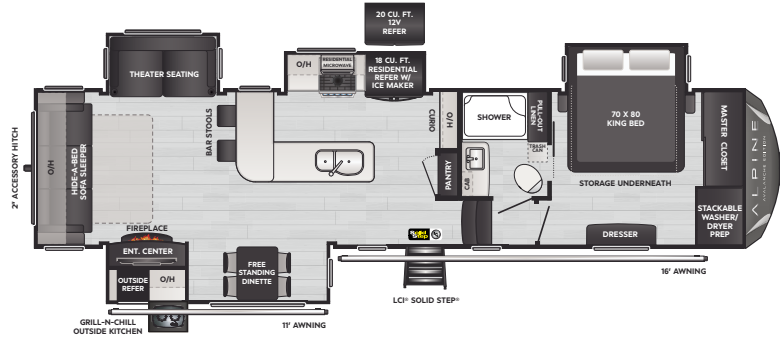

338GK | WEIGHT 12685 | LENGTH 37' 11"

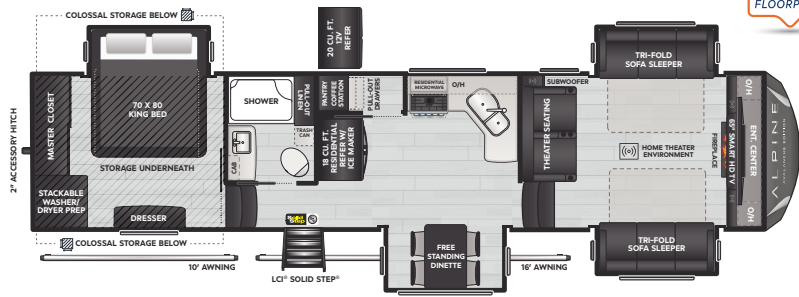

346FL | WEIGHT 13050 | LENGTH 38' 11"

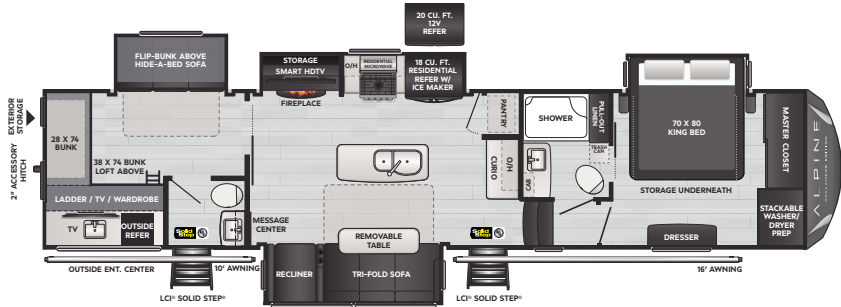

378BH | WEIGHT 13820 | LENGTH 40' 7"

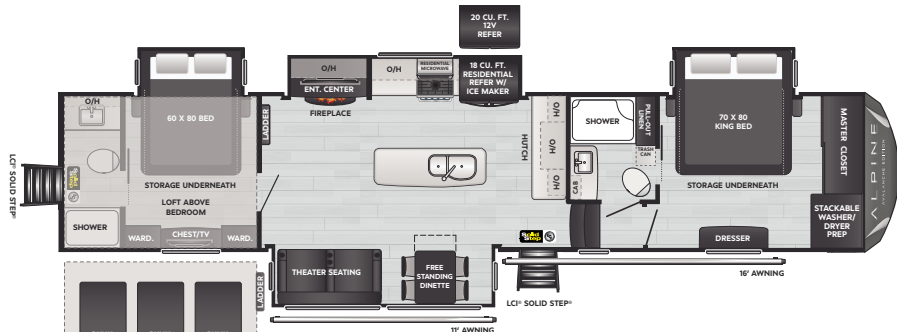

390DS | WEIGHT 14258 | LENGTH 42' 11"

SOLARTM FLEX



NEW 2024 PACKAGE UPDATES

For more information scan the QR code
or visit keystonerv.com.

TAKE *CHARGE* OF HOW YOU CAMP

EXCEPTIONAL QUALITY, IMPOSSIBLY VERSATILE, SolarFlexTM
IS SHATTERING CUSTOMER'S EXPECTATIONS OF FACTORY-INSTALLED SOLAR POWER.
EXCLUSIVELY AVAILABLE ON ALL KEYSTONE RV MODELS.



Keystone RV is proud to partner with Dragonfly Energy to offer their legendary heated Lithium-ion batteries exclusively on all Keystone models.



FOLLOW US FOR THE LATEST!



DISCLAIMER: Product information is as accurate as possible as of the date of publication of this brochure. All features, floor plans, and specifications in this brochure are subject to change without notice. Please also consult Keystone's web site at www.keystonerv.com for more current product information and specifications. Tow Vehicle Disclaimer. CAUTION: Owners of Keystone recreational vehicles are solely responsible for the selection and proper use of tow vehicles. All customers should consult with a motor vehicle manufacturer or their dealer concerning the purchase and use of suitable tow vehicles for Keystone products. Keystone disclaims any liability or damages suffered as a result of the selection, operation, use or misuse of a tow vehicle. KEYSTONE'S LIMITED WARRANTY DOES NOT COVER DAMAGE TO THE RECREATIONAL VEHICLE OR THE TOW VEHICLE AS A RESULT OF THE SELECTION, OPERATION, USE OR MISUSE OF THE TOW VEHICLE. *Length is defined as the distance from the centerline of hitch pin/coupler to rear bumper of trailer. ** Fresh water capacity includes water heater. Please review owner's manual prior to purchase for more information on service warranties, extended use, towing and maintenance. Owner's manuals can be found at keystonerv.com.

PRINT 10.2023