

QWEST SE

2025 DIESEL CLASS C MOTORHOME



2025 ENTEGRA COACH QWEST SE



ENTEGRA
COACH



2025 QWEST SE

Diesel Class C Motorhome

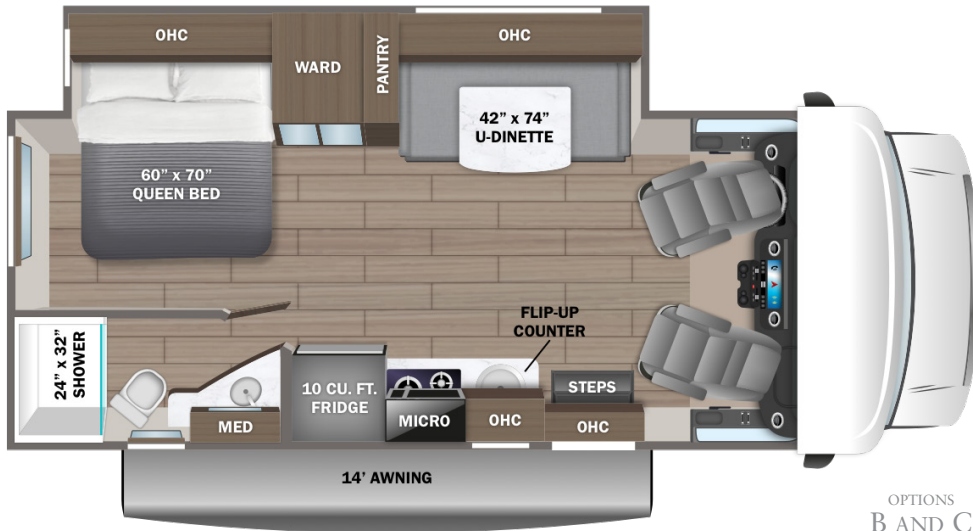
24L



OPTIONS
B AND C

24R

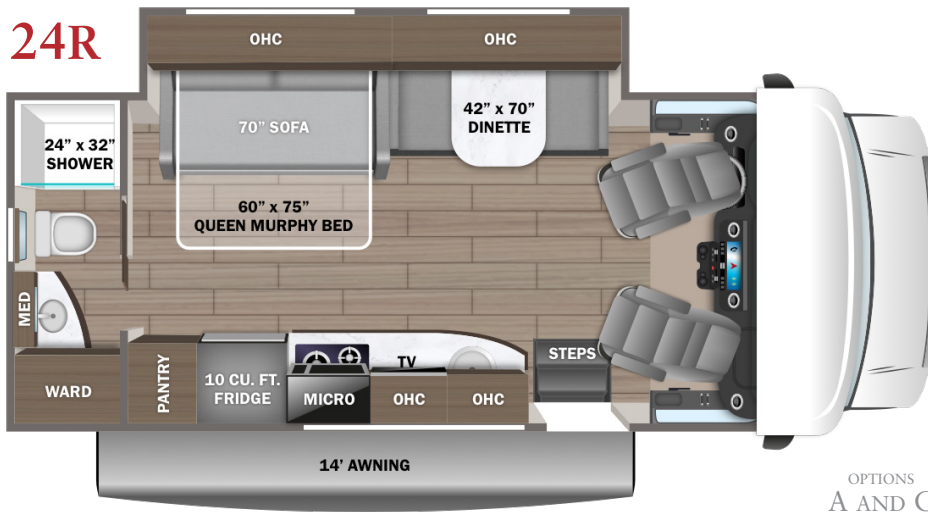

OPTIONS
A AND C

EXTERIOR SELECTIONS



Standard Graphics



Optional Partial Paint

OPTIONS

A

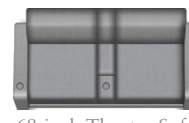

68-inch Theater Sofa

B



72-inch Theater Sofa

C



Entertainment Center with
Overhead Storage Option

CUSTOMER VALUE PACKAGE

One-piece, seamless, fiberglass front cap
Frameless windows
Heated holding tanks (12V pads)
Heated, remote-controlled, side-view mirrors
Electric patio awning with LED lights
Backup and side-view cameras
Keyless cab entry
7 in. integrated Mercedes-Benz® MBUX infotainment center with Apple® CarPlay™ and Android Auto™
Swivel driver and passenger seats

STANDARD CHASSIS EQUIPMENT

Mercedes-Benz® 3500 chassis with 170 in. wheelbase
GVWR- 11,030 lb.
GCWR- 15,250 lb.
2L V4 Twin Turbo 211HP diesel engine with electronic fuel injection with 332 ft.-lb. torque
9-speed automatic transmission
220-amp alternator
E-rated highway tires- 215/85R16
Front and rear disc, 4-wheel anti-lock brakes
5,000 lb. rear hitch receiver with dual connector 7-pin plug
12V chassis battery
26.4 gal. fuel tank
5.8 gal. DEF tank

STANDARD EXTERIOR EQUIPMENT

TuffShell™ vacuum-bond laminated roof, floor and sidewalls
Bead-foam insulation (R-24 max roof, R-9 max floor, R-5 max walls)
Tufflex™ PVC laminated roof
Fiberglass running boards
Fiberglass exterior walls with vinyl graphics
Electric stabilizer jacks
Slideout awning(s)
Entrance door with industry's largest travel-view window
Electric-powered entrance step with integrated house battery compartment
Third brake light
4 in. bumper tube with sewer hose storage
Prep for satellite dish
Cable TV hookup with RG-6 coax
Digital antenna with signal booster
3,600W LP generator (4,000W on select models)
Solar prep
12V house battery
Transfer switch with reverse polarity protection
30-amp electrical service

12.2 gal. propane tank (41 lb.)
LP quick-connect hookup
Exterior utility center
Winterization drain system
Black tank flush
Outside shower
12V demand water pump
Water filtration system

STANDARD COCKPIT EQUIPMENT

Heated, remote-controlled, side-view mirrors
Leather tilt steering wheel
Smartphone tray with wireless charging
Active Distance Assist DISTRONIC®
Active lane keeping assist
Crosswind assist
Hill start assist
Brake assist plus
Traffic sign assist
Attention assist
Breakdown management
Emergency call system
Rain-sensing windshield wipers
LED high performance headlights
Headlight assistant
Driver and passenger airbags
Power windows and door locks
Auxiliary start switch

STANDARD INTERIOR EQUIPMENT

Custom-molded ABS surround in cab-over area
Overhead bunk with 750 lb. capacity
Privacy curtain for cab area
Firefly Multiplex system - wall-mounted touchscreen and mobile app for total coach control
80 in. interior ceiling height with padded vinyl ceiling
High-intensity LED ceiling lights
Tecnoform® high-gloss cabinetry and countertops
Ball-bearing drawer guides
Integrated day/night cassette shades
15,000 BTU A/C
30,000 BTU auto-ignition ducted furnace
Powered roof vent in living area with wall switch
Entegra-exclusive, easy-operation legless dinette table (24R)
U-shaped dinette with stow-away pedestal legs (24L)
12V USB charging station in dinette area
2-point lap safety belts in all designated seating locations
Car seat tethers (select floorplans)

LED HD TV in living area
JBL® audio system
Smoke alarm
Carbon monoxide detector
Fire extinguisher
8 cu. ft. 12V refrigerator
2-burner, drop-in cooktop with flush cover
Stainless convection microwave
Stainless steel sink with wooden cover/cutting board
Decorative kitchen backsplash
Queen-size bed with bedspread (24L)
Queen-size power Murphy bed (24R)
USB port(s) in bedroom
Under-bed storage (select models)
Bedroom TV prep (24L)
Large wardrobes
Shower with decorative surround and skylight
Stainless steel bathroom sink
Porcelain toilet with foot flush
Powered roof vent in bathroom with wall switch

OPTIONS

Premium Mercedes chassis - includes active brake assist, chrome grill package, adaptive cruise control, heated captain's seats, smartphone tray with wireless charging, upgraded lighting package, rain-sensing wiper system, leather steering wheel, lane-keeping assist and traffic sign assist.
Front entertainment center with 32 in. LED HD Smart TV
Folding windshield sun shade
4-point hydraulic leveling jacks
Theater seating ILO dinette
200W solar panel with dual controller and second house battery

2+3
LIMITED STRUCTURAL
WARRANTY

NO ONE OFFERS A BETTER WARRANTY

At Entegra Coach, we build our RVs to handle every adventure, then back them with our industry-leading 2+3 limited warranty. Our 2-year limited warranty has you covered for 2 camping seasons. That's 730 days. In addition, our 3-year structural limited warranty has you covered for 3 camping seasons or 1,095 days. You won't

find a better limited warranty in the business, because the only strings we attach are those that deliver the ultimate in reliability. For a copy of our 2-year limited + 3-year structural limited warranty with complete terms and conditions, please contact your local Entegra Coach dealer.

It is important for your safety and enjoyment that you are aware of the weights and tow ratings of the RV you select. Consult a competent advisor for questions or advice. Whether you are new to RVing or a veteran, get a feel for the performance of your RV before heading out on the roadways. When you tow a vehicle with your RV, you must drive differently than when you drive a single vehicle. Practice hooking up, driving, backing up and braking in a safe environment or seek out professional instruction. Jayco affixes a weight label to each RV which lists weight information for that vehicle. Refer to that label to verify the vehicle will meet your requirements. Gross Vehicle Weight Rating (GVWR): The maximum permissible weight of the motorhome, including the Unloaded Vehicle Weight (UVW) plus passengers, personal items, all cargo, fluids, options and dealer-installed accessories. The GVWR is equal to or greater than the sum of the UVW and the Cargo Carrying Capacity. Gross Combined Weight Rating (GCWR): The maximum allowable combined weight of the motorhome used as a tow vehicle and the attached towed vehicle.

| Floorplan | GVWR (lbs.) | GCWR (lbs.) | Wheel Base | Overall Length | Exterior Height w/ A/C & Satellite | Exterior Width | Interior Height | Fresh Water Capacity (gal.) | Grey Waste Water Capacity (gal.) | Black Waste Water Capacity (gal.) |
|-----------|-------------|-------------|------------|----------------|------------------------------------|----------------|-----------------|-----------------------------|----------------------------------|-----------------------------------|
| 24L | 11,030 | 15,250 | 170.3 | 25' 0" | 11' 5" | 96 | 83 | 43 | 31 | 31 |
| 24R | 11,030 | 15,250 | 170.3 | 25' 0" | 11' 5" | 96 | 83 | 35 | 31 | 31 |



ENTEGRA
COACH®

Part of Jayco Family of Companies

Entegra Coach, Inc., P.O. Box 460, Middlebury, IN 46540, www.entegracoach.com. See dealer for further information and prices. All information in this brochure is the latest available at the time of publication approval. Entegra Coach reserves the right to make changes and to discontinue models without notice or obligation. Photos in this brochure may show optional equipment and props for photography purposes. RVs built for sale in Canada may differ to conform to Canadian codes. ©2025 Entegra Coach, Inc. Printed in U.S.A. 2032940



entegracoach.com/qwest-se

LEGACY ISN'T LEFT.
IT'S LIVED.