

FLAGSTAFF
MAC, LTD, SE, HARD SIDE
& HIGH WALL TENT CAMPERS

Flagstaff

MAC, LTD, SE, HARD SIDE & HIGH WALL TENT CAMPERS

PROVIDING OUTDOOR FUN SINCE 1974.





176LTD

LIMITED

FLAGSTAFF UVW: 1465 CCC: 793 AXLE: 1284 HITCH: 162
 OPEN LENGTH: 17' 2" CLOSED HEIGHT: 5' 4" CLOSED LENGTH W/ HITCH: 12' 4"
 BOX SIZE: 8' FRESH: 10 GRAY: N/A BLACK: N/A



206LTD

LIMITED

FLAGSTAFF UVW: 1608 CCC: 683 AXLE: 1394 HITCH: 195
 OPEN LENGTH: 20' 2" CLOSED HEIGHT: 5' 4" CLOSED LENGTH W/ HITCH: 14' 4"
 BOX SIZE: 10' FRESH: 10 GRAY: N/A BLACK: N/A

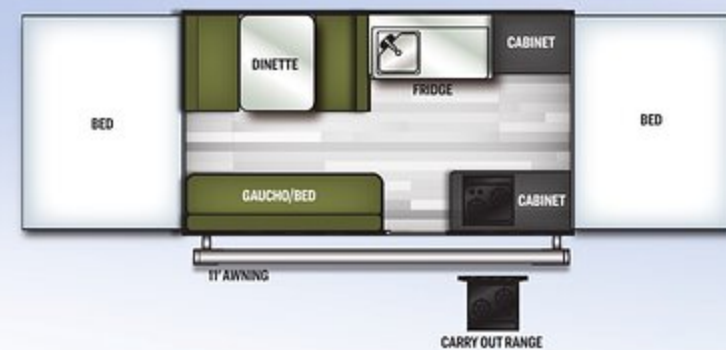

228LTD

LIMITED

FLAGSTAFF UVW: 2049 CCC: 1176 AXLE: 1805 HITCH: 225
 OPEN LENGTH: 23' 1" CLOSED HEIGHT: 5' 6" CLOSED LENGTH W/ HITCH: 16' 5"
 BOX SIZE: 12' FRESH: 10 GRAY: N/A BLACK: N/A

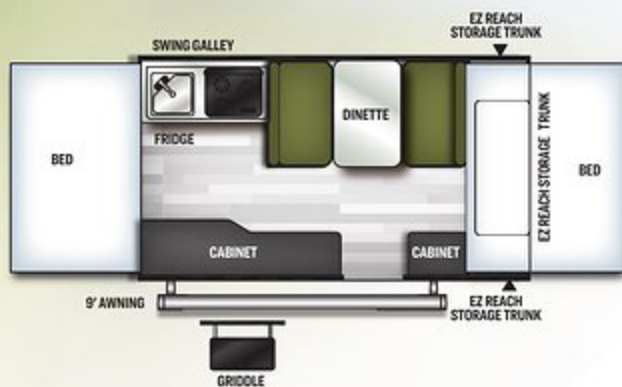

206M

MAC

FLAGSTAFF UVW: 2204 CCC: 1036 AXLE: 1945 HITCH: 240
 OPEN LENGTH: 20' 2" CLOSED HEIGHT: 5' 6" CLOSED LENGTH W/ HITCH: 17' 3"
 BOX SIZE: 12' FRESH: 20 GRAY: N/A BLACK: N/A

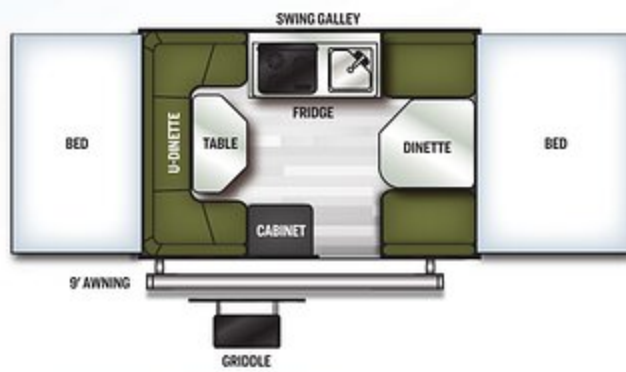

208

MAC

FLAGSTAFF UVW: 1896 CCC: 1359 AXLE: 1622 HITCH: 255
 OPEN LENGTH: 20' 2" CLOSED HEIGHT: 5' 6" CLOSED LENGTH W/ HITCH: 15' 7"
 BOX SIZE: 10' FRESH: 20 GRAY: N/A BLACK: N/A

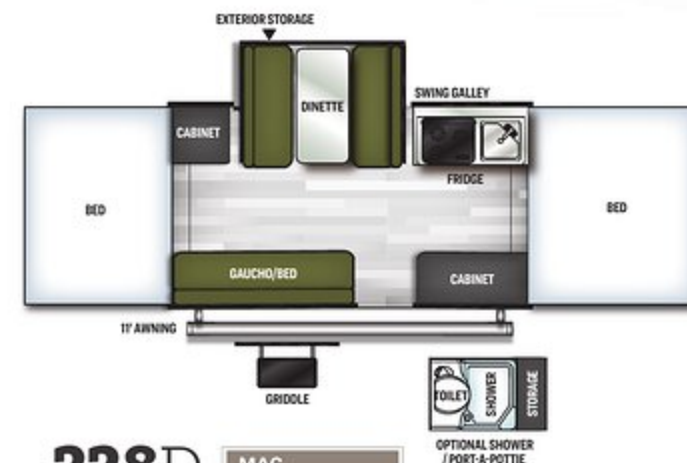

228D

MAC

FLAGSTAFF UVW: 2439 CCC: 824 AXLE: 2157 HITCH: 263
 OPEN LENGTH: 23' 11" CLOSED HEIGHT: 5' 6" CLOSED LENGTH W/ HITCH: 17' 6"
 BOX SIZE: 12' FRESH: 20 GRAY: N/A BLACK: N/A

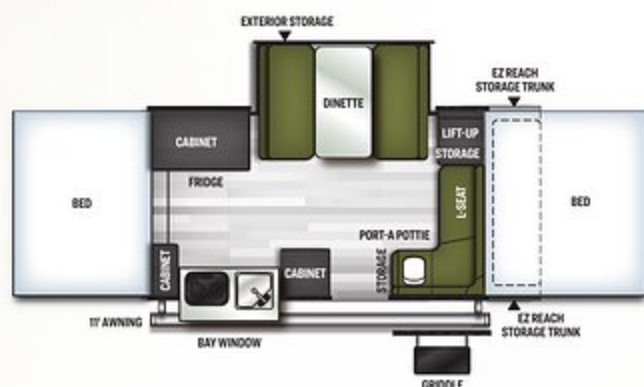

425M

MAC

FLAGSTAFF UVW: 2654 CCC: 641 AXLE: 2340 HITCH: 295
 OPEN LENGTH: 23' 9" CLOSED HEIGHT: 6' CLOSED LENGTH W/ HITCH: 19' 1"
 BOX SIZE: 12' FRESH: 20 GRAY: N/A BLACK: N/A

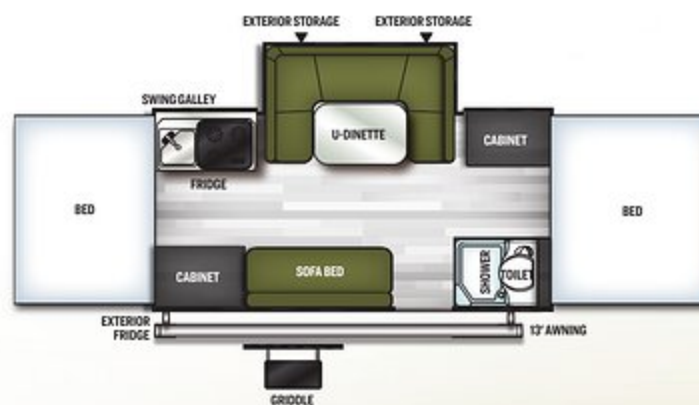

627M

MAC

FLAGSTAFF UVW: 2854 CCC: 506 AXLE: 2475 HITCH: 360
 OPEN LENGTH: 25' 9" CLOSED HEIGHT: 6' CLOSED LENGTH W/ HITCH: 19' 4"
 BOX SIZE: 14' FRESH: 20 GRAY: N/A BLACK: N/A

MAC

MAKING YOUR INVESTMENT GO A LONG WAY.
 Flagstaff takes pride in packing the most value possible into our MAC series. Finding the perfect fit for the specific needs of your active family is made easier by the wide variety of floor plans available. While each model comes standard with many features, you still have flexibility to incorporate as many options as you choose to fit your camping preferences.

LTD PACKAGE

| |
|-------------------------------------|
| Battery Box & Wire |
| Awning |
| Step |
| Heated Mattress on Bunk Ends |
| CO Detector |
| Inside/Outside Two-Burner Stove |
| Spare Tire w/ Carrier & Cover |
| Interior LED Lights |
| Solar Prep On Frame |
| Nitrogen Filled Tires |
| Exterior Recep (206LTD & 228D only) |

LTD STANDARD FEATURES

| |
|-----------------------------------|
| Gray Exterior |
| Slatewood Interior |
| Wood Look Flooring |
| Electric Water Pump |
| Antifreeze Inlet Bypass |
| 1.9 Cubic Foot 3 Way Refrigerator |

| |
|--|
| 20K BTU Furnace |
| Residential Style Cabinet Doors |
| Wood Drawers w/ Full Extension |
| Metal Guides |
| One Piece Door |
| Flip Down Galley w/ Storage |
| 25 AMP Converter w/ Built In Battery Charger |
| Roof Vent |
| Privacy Curtains |
| 2 Rear Stabilizer Jacks w/ Sand Pads |
| Quilted Top Bed Mattress |
| 12" Radial Tires |
| 13" Radial Tires (228LTD Only) |
| 20 lb. LP Bottle |
| Patio Light (206LTD/228LTD) |
| Leaf Spring Axles |

LTD OPTIONS

| |
|---------------------------------------|
| Power Lift System (factory installed) |
| LP Bottle Cover |
| 2-20# LP Bottles w/ Covers |
| 3-Way Refrigerator (forced) |
| Electric Brakes (Std. 2280LTD) |
| 20K BTU Furnace (forced) |
| 7' Screen Room w/ Privacy Panels |
| 9' Screen Room w/ Privacy Panels |
| 11' Screen Room w/ Privacy Panels |
| Outside Griddle |
| 40 Amp Portable Solar Panel |
| 13500 BTU Low Profile Roof Air |
| 15000 BTU Low Profile Roof Air |

Limited

TIME TO RETIRE THE FAMILY TENT? When it is time to retire the trusty family tent because you are tired of sleeping on the hard ground, look no further than the Flagstaff LTD Tent Camper. Light on frills but an emphasis on quality and construction. The LTD is our entry-level line of tent campers that come with a limited lifetime warranty on the lift system and a 5 year tent warranty. Oh, and don't forget the standard heated mattresses that will keep you warm and comfortable on those chilly Fall nights.



MAC OUTDOORS PACKAGE

| |
|---|
| Create-A-Breeze Roof Vent Fan |
| 3-Way Refrigerator |
| 20K BTU Furnace |
| Heated Mattress Bunk Ends |
| Awning w/ LED Lighting |
| Water Filtration System |
| Spare Tire w/ Carrier & Cover |
| ProRac Permanent Crossbars (150lb rating) |
| CO Detector |
| Outside Griddle |
| Power Roof Lift |

MAC STANDARD FEATURES

| |
|---|
| Gray Exterior |
| Slatewood Interior |
| Wood Plank Flooring |
| 12V Electric Water Pump |
| Hot Water Package (425M/627M/228D) |
| Shower/Cassette (STD 2716F) |
| Antifreeze Inlet Bypass |
| Permanently Mounted 3-Burner Range w/ Cover |
| Residential Style Cabinet Doors & Drawers w/ Metal Glides |
| USB Charging Ports |
| Roof A/C Bracing |
| 30 AMP detachable Power Cord |

| |
|--|
| 35 AMP Converter w/ Built In Power Lift System |
| Storage Net Over Bunks |
| Leaf-Spring Axles |
| Easy Lube Axles |
| Electric Brake |
| 13" Radial Tires |
| Aluminum Wheel |
| Double Battery Box & Wiring Kit |
| 4 Stabilizer Jacks w/ Sand Pads |
| Solar Panel Prep On Frame |
| LED Ceiling Lights |
| Patio Light |
| 110V Exterior Outlet |
| Single Entry Step |
| One Piece Screen Door |

| |
|--------------------------------------|
| Large Entry Door Folding Grab Handle |
| 85" Wide Body w/ 80" Beds |
| 4" Cushions & Covers |
| TV outlet w/ Cable & Satellite |
| Vinolon Supreme Tenting |

MAC OPTIONS

| |
|---|
| A/C Wiring Kit |
| LP Bottle Cover |
| 2-20# LP Bottles w/ Cover |
| Overhead Kitchen Cabinet |
| Shower/Cassette Pack (228D) |
| Hot Water Pkg. w/ Outside Shower (206M/208) |
| 9' Screen Room w/ Privacy Panels |
| 11' Screen Room w/ Privacy Panels |

| |
|-----------------------------------|
| 13' Screen Room w/ Privacy Panels |
| Pro Rac Upright Bike Carrier |
| Pro Rac Kayak Carrier |
| Pro Rac Load Stops |
| Pro Rac Tie Downs |
| 40 Amp Portable Solar Panel |
| 13,500 BTU Low Profile Roof Air |
| 15,000 BTU Low Profile Roof Air |

Sports Enthusiast Package

WELCOME TO THE FLAGSTAFF SPORTS ENTHUSIAST PACKAGE (SE), a camper designed for active couples and families. Whatever the preference; mountain biking, canoeing, paddle boarding or surfing, the SE camping trailers are designed to allow you to make the most of your outdoor experience.

Built for 21st century camping. The SE package includes a AM/FM stereo with Bluetooth technology, USB auxiliary ports for streaming and recharging, LED lighting, a WIFI Ranger WIFI booster and a 100W solar panel with 1000W inverter to supply renewable energy to your batteries while camping "off the grid."

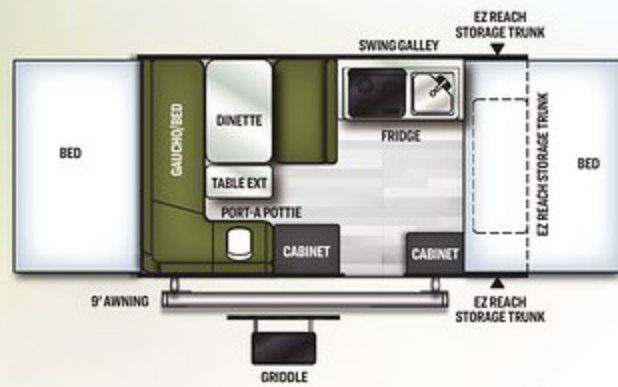

206STSE SE

FLAGSTAFF UVW: 2180 CCC: 724 AXLE: 1907 HITCH: 254
 OPEN LENGTH: 20' 4" CLOSED HEIGHT: 5' 11" CLOSED LENGTH W/ HITCH: 17' 6"
 BOX SIZE: 10' FRESH: 20 GRAY: N/A BLACK: N/A

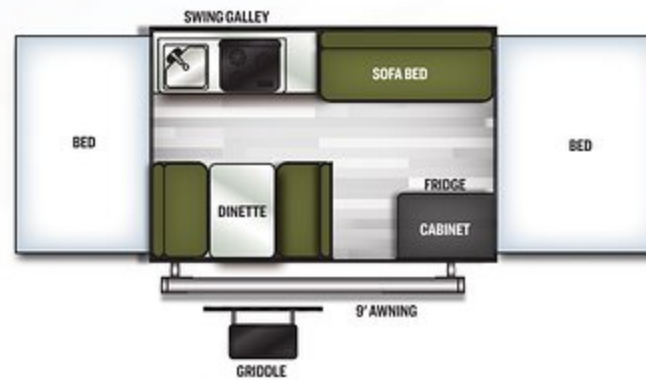

207SE SE

FLAGSTAFF UVW: 2076 CCC: 808 AXLE: 1823 HITCH: 234
 OPEN LENGTH: 20' 1" CLOSED HEIGHT: 5' 11" CLOSED LENGTH W/ HITCH: 15' 8"
 BOX SIZE: 10' FRESH: 20 GRAY: N/A BLACK: N/A

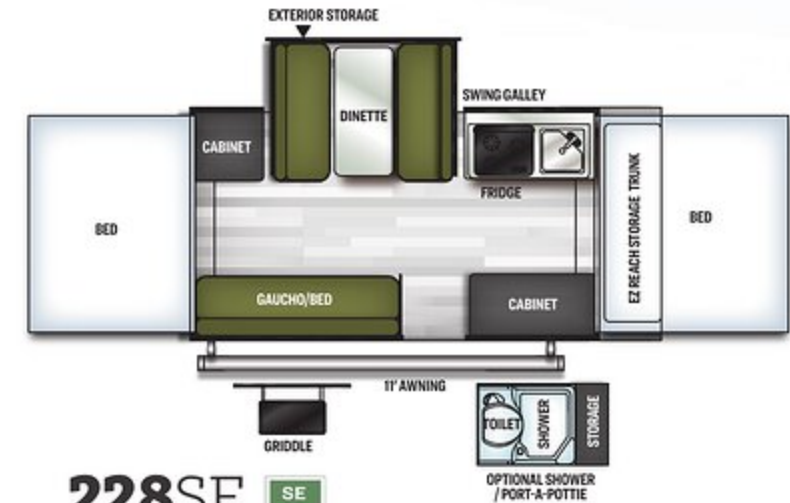

228SE SE

FLAGSTAFF UVW: 2849 CCC: 1026 AXLE: 2455 HITCH: 375
 OPEN LENGTH: 23' 11" CLOSED HEIGHT: 6' 2" CLOSED LENGTH W/ HITCH: 19' 4"
 BOX SIZE: 12' FRESH: 20 GRAY: N/A BLACK: N/A

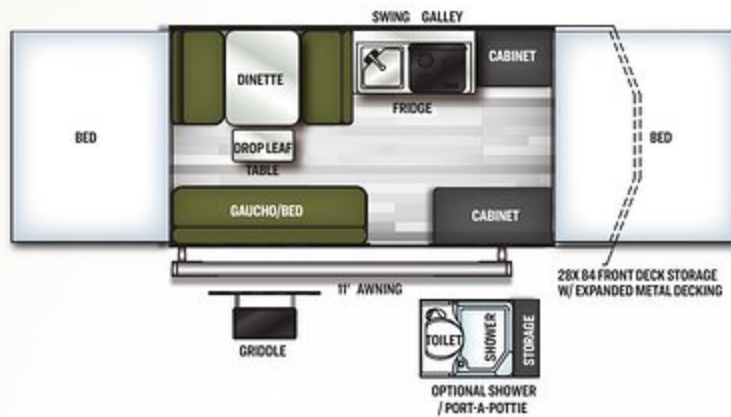

228BHSE SE

FLAGSTAFF UVW: 2559 CCC: 1279 AXLE: 2202 HITCH: 338
 OPEN LENGTH: 23' 11" CLOSED HEIGHT: 6' 2" CLOSED LENGTH W/ HITCH: 19' 4"
 BOX SIZE: 12' FRESH: 20 GRAY: N/A BLACK: N/A

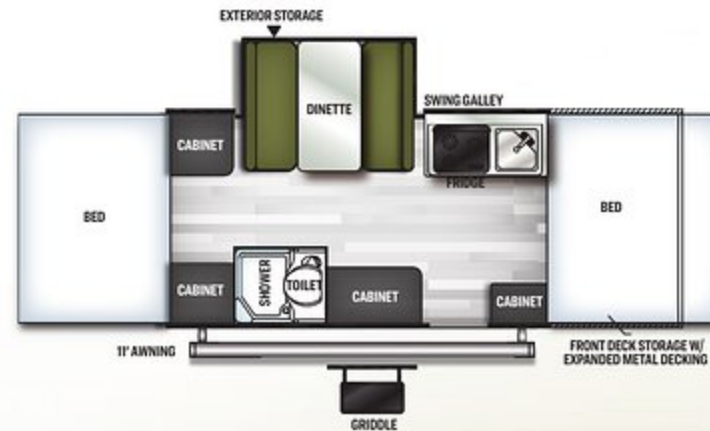

23SCSE SE

FLAGSTAFF UVW: 2933 CCC: 861 AXLE: 2620 HITCH: 294
 OPEN LENGTH: 26' 5" CLOSED HEIGHT: 6' 2" CLOSED LENGTH W/ HITCH: 22' 3"
 BOX SIZE: 12' FRESH: 20 GRAY: N/A BLACK: N/A

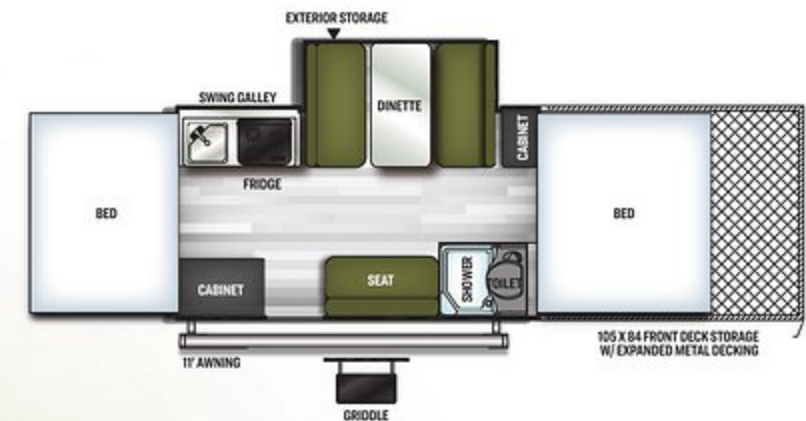

28TSCSE SE

FLAGSTAFF UVW: 3377 CCC: 1844 AXLE: 3118 HITCH: 221
 OPEN LENGTH: 30' 8" CLOSED HEIGHT: 6' 2" CLOSED LENGTH W/ HITCH: 26' 5"
 BOX SIZE: 12' FRESH: 20 GRAY: N/A BLACK: N/A



| SE PACKAGE |
|---|
| Aluminum Wheels w/ 15" Mud Rover Tires |
| 100W Roof Mount Solar Panel w/ 1000W Inverter |
| Create-A-Breeze Roof Vent Fan |
| 3-Way Refrigerator |
| 20K BTU Furnace |
| Heated Mattress Bunk Ends |
| Awning w/ LED Lighting |
| Spare Tire w/ Carrier & Cover |
| Outside Griddle |
| Power Roof Lift |
| Bluetooth Stereo w/ Outside Speakers |
| Diamond Plate Accents |
| Spray Away Utility Hose |
| ProRac Permanent Crossbars (150lb Rating) |
| CO Detector |

| SE STANDARD FEATURES |
|--|
| Gray Sport Exterior |
| Slatewood Interior |
| Wood Plank Flooring |
| 12 Volt Electric Water Pump |
| Hot Water Pkg. w/ Outside Shower (STD on 228BHSE/228SE/23SCSE/28TSCSE) |
| Shower/Cassette Pack (std 228SE/23CSE/28TSCSE ONLY) |
| Double 20# Bottles (228SE/228BHSE/23CSE/28TSCSE) |
| 20# LP Bottle |
| 3-Burner Range w/Cover |
| Large Entry Door Grab Handle |
| Residential Style Cabinet Doors |
| Full Extension Metal Drawer Guides |
| A/C Roof Bracing |
| USB Charging Ports |

| |
|---|
| TV Outlet w/Cable & Satellite Hook ups |
| 35 amp Converter |
| 30 Amp Detachable Power Cord |
| LED Ceiling Lights |
| Window Curtains w/ Valances |
| Double Step |
| 100W Roof Mount Solar Panel w/ Prep For Addtl. Solar Panels |
| Solar Prep On Frame |
| Patio light |
| Outside Recep |
| Storage Net Over Bunk |
| Vinolon Supreme Tent |
| Smoked Vinyl Windows |
| Double Battery Box & Wiring |
| Sliding Storage Tray in trunk models |
| Electric Brakes |
| 4 Stabilizer Jack w/ Sand Pads |

| E Z Lube Axles |
|--|
| Black Diamond Plate |
| 54" Front Deck Storage 23CSE |
| 96" Front Deck Storage 28TSCSE |
| 20 Gallon Fresh Water Tank |
| SE OPTIONS |
| A/C Wiring Kit |
| 2-20# LP Bottles w/Cover (std 228BHSE/228SE/23CSE/28TSCSE) |
| Overhead Kitchen Cabinet |
| Shower/Cassette Pack (228BHSE/228SE) |
| Hot Water (Std 228BHSE/228SE/23CSE/28TSCSE) |
| 9' Screen Room w/Privacy Panels |
| 11' Screen Room w/Privacy Panels |
| Pro Rac Upright Bike Carrier |

| |
|---------------------------------|
| Pro Rac Kayak Carrier |
| Pro Rac Load Stops |
| Pro Rac Tie Downs |
| 40 Amp Portable Solar Panel |
| 13,500 BTU Low Profile Roof Air |
| 15,000 BTU Low Profile Roof Air |



HW27KS

High Wall

WE MAKE CAMPING COMFORTABLE. We have designed this series for the camping family who wants the refinement of larger vacationing units in a light-weight camper. Ample counterspace, upgraded appliances, convenient pull-up curtains providing a wide view of the surroundings and tasteful interiors make this camper a gorgeous option to experience.



Popular High Wall Features

- A Shower curtain
- B ProRac Roof Mounted Cross Bars w/ Opt. Bike and Kayak Carrier attachments.

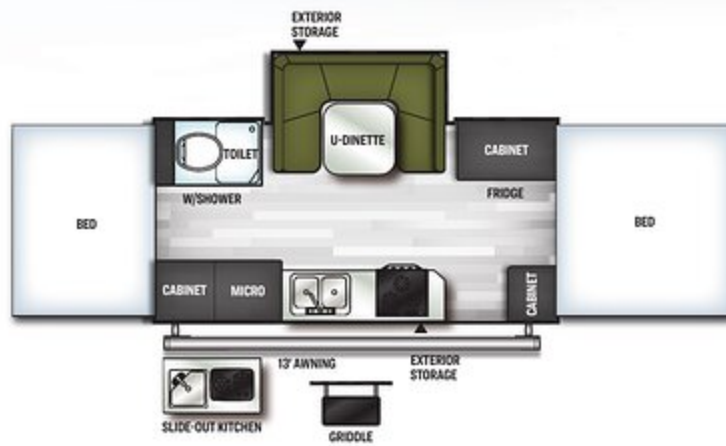

HW27KS HIGH WALL

FLAGSTAFF U/VW: 3334 CCC: 546 AXLE: 2916 HITCH: 380
 OPEN LENGTH: 25' 9" CLOSED HEIGHT: 6' 7" CLOSED LENGTH W/ HITCH: 19' 6"
 BOX SIZE: 14' FRESH: 20 GRAY: 12 BLACK: 12

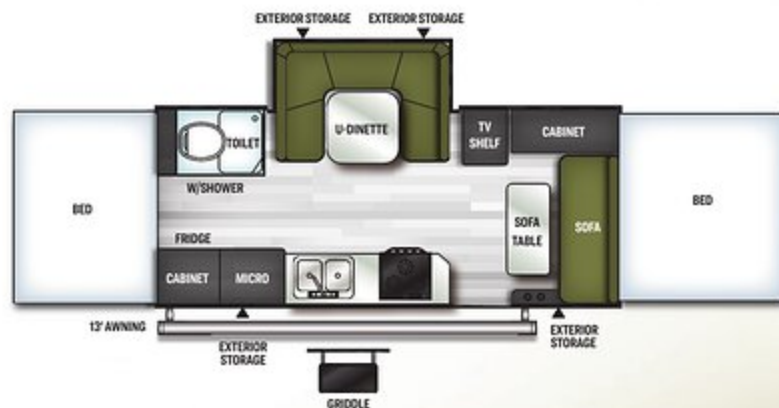

HW29SC HIGH WALL

FLAGSTAFF U/VW: 3721 CCC: 1278 AXLE: 3312 HITCH: 371
 OPEN LENGTH: 27' 9" CLOSED HEIGHT: 6' 9" CLOSED LENGTH W/ HITCH: 21' 6"
 BOX SIZE: 16' FRESH: 20 GRAY: 12 BLACK: 12

HIGH WALL PACKAGE

- Create-A-Breeze Roof Vent Fan
- 3-Way Refrigerator
- 20K BTU Furnace
- Heated Mattress on Bunk Ends
- Awning w/ LED Lighting
- Power Roof Lift
- Spare Tire w/ Carrier & Cover
- Water Filtration System
- Aluminum Wheels
- Bloothooth Stereo w/ Outside Speakers
- ProRac Roof Mounting System
- CO Detector

HIGH WALL STANDARD FEATURES

- Slatewood Interior
- White Fiberglass w/ Gray Band Exterior
- Torsion EZ Lube Axles
- Raised Panel Cabinet Doors
- 4 Stabilizer Jacks with Sand Pads
- 1 Piece Floor
- 2 - Bed End Lights with Fan
- Wood Drawers with Full Extension Drawer Guides
- Positive Latches & Catches on Door & Drawers

14" Radial Tires

- 12 Volt Water Pump
- Double Battery Box & Wiring
- Large Entry Door Grab Handle
- 30 Amp Detachable Power Cord
- Solar Prep On Frame
- WiFi Extender w/ LTE capabilities
- Electric Brakes
- LED Ceiling Lights
- Outside Griddle
- 80" Beds
- Vinylon Supreme Tenting
- Privacy Curtains w/ Valances
- Hot Water pkg w/ Outside Shower
- Cable TV Ready

Oven

- Microwave
- Automatic Gas Regulator
- Double 20# Gas Bottles w/ Molded Cover
- Shower/Cassette Toilet
- 35 Amp Converter
- Monitor Panel
- Storage Nets On Both Bunks
- MORryde Step

HIGH WALL OPTIONS

- A/C Wiring Kit
- Overhead Kitchen Cabinet
- Hanging Wardrobe
- 13' Screen Room w/ Privacy Panels
- 13,500 BTU Roof A/C - Low Profile (a/c wiring kit included)
- 15,000 BTU A/C - Low Profile (a/c wiring kit included)
- Power Front Jack
- Pro Rac Upright Bike Carrier
- Pro Rac Kayak Carrier
- Pro Rac Load Stops
- Pro Rac Tie Downs
- 40 Amp Portable Solar Panel

Hard Sides

QUITE POSSIBLY THE BEST OF BOTH WORLDS. When you combine the solid exterior of a travel trailer with a tent camper, you get the Flagstaff Hard Side Series, giving your camping experience the best of both worlds. Bringing a smooth fiberglass vacuum bonded exterior with a quick, easy set up, while retaining the towing and storage advantages of a tent camper, the Hard Side camper is the perfect blend.

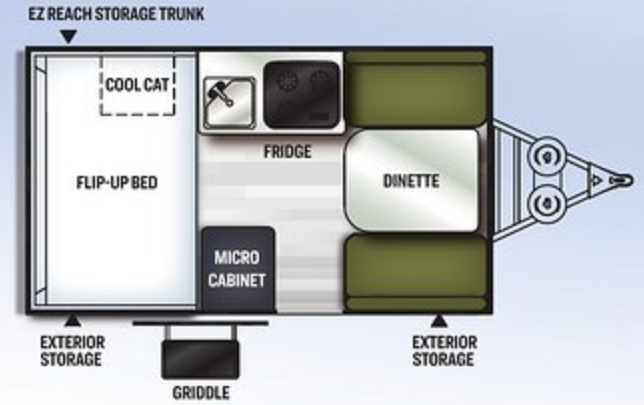

T12RB HARD SIDE
FLAGSTAFF UVW: 2014 CCC: 1208 AXLE: 1754 HITCH: 222
 CLOSED HEIGHT: 5'1" CLOSED LENGTH W/ HITCH: 17'5" BOX SIZE: 12'
 FRESH: 20 GRAY: N/A BLACK: N/A

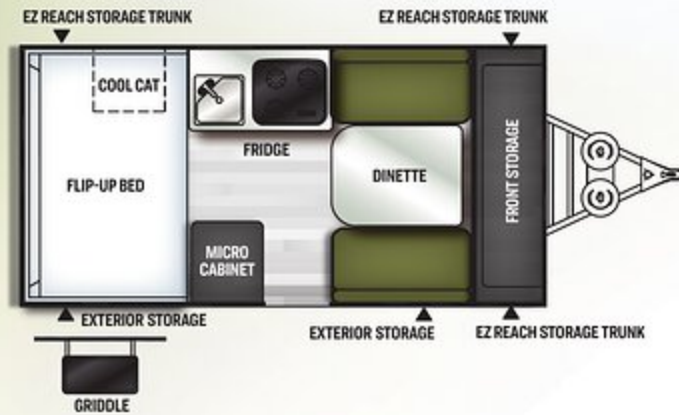

T12RBST HARD SIDE
FLAGSTAFF UVW: 2120 CCC: 1164 AXLE: 1798 HITCH: 284
 CLOSED HEIGHT: 5'1" CLOSED LENGTH W/ HITCH: 19'2" BOX SIZE: 12'
 FRESH: 20 GRAY: N/A BLACK: N/A

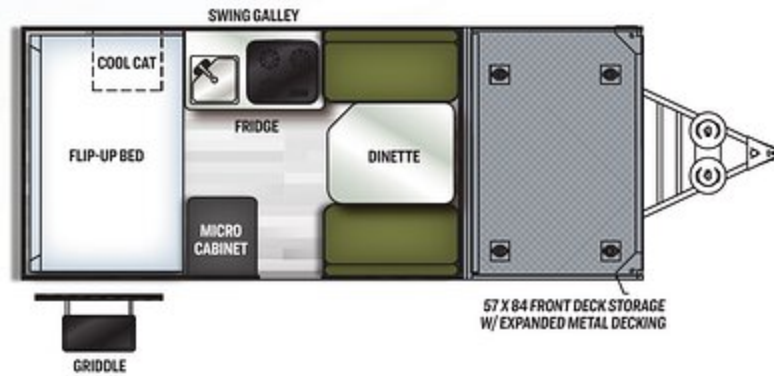

T12RBTH HARD SIDE
FLAGSTAFF UVW: 2408 CCC: 1387 AXLE: 2075 HITCH: 295
 CLOSED HEIGHT: 5'8" CLOSED LENGTH W/ HITCH: 22'3" BOX SIZE: 12'
 FRESH: 20 GRAY: N/A BLACK: N/A

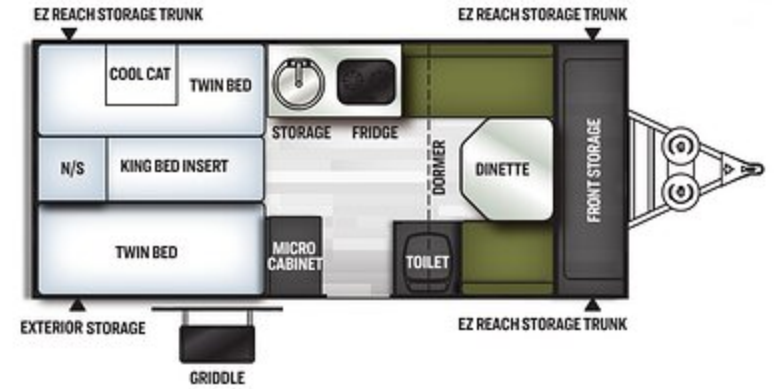

T21TBHW HARD SIDE
FLAGSTAFF UVW: 2670 CCC: 702 AXLE: 2260 HITCH: 372
 CLOSED HEIGHT: 5'8" CLOSED LENGTH W/ HITCH: 21'2" BOX SIZE: 14'
 FRESH: 20 GRAY: N/A BLACK: N/A

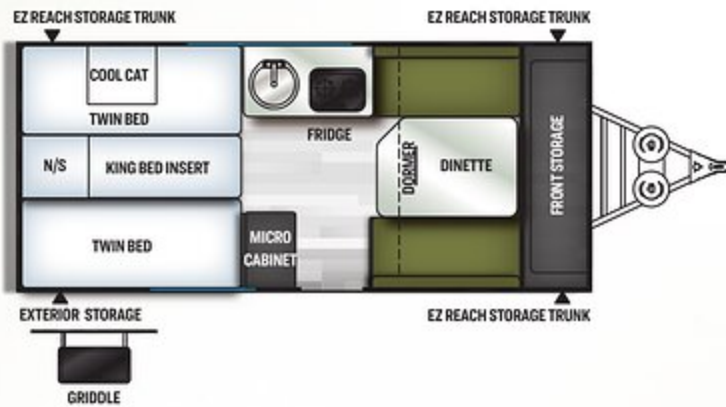

T21BHWOR HARD SIDE
FLAGSTAFF UVW: 2698 CCC: 1107 AXLE: 2355 HITCH: 305
 CLOSED HEIGHT: 6'1" CLOSED LENGTH W/ HITCH: 21'2" BOX SIZE: 14'
 FRESH: 20 GRAY: N/A BLACK: N/A

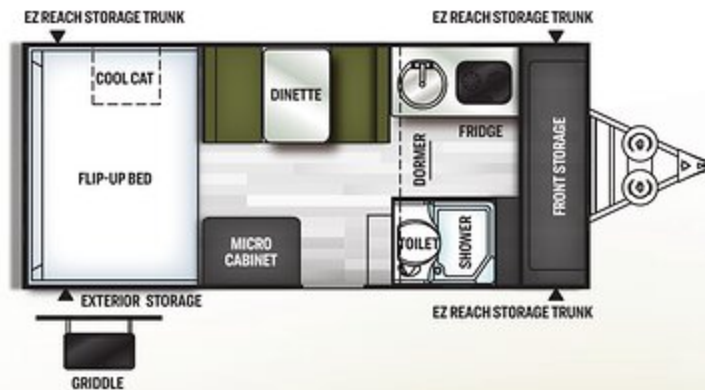

T21DMHW HARD SIDE
FLAGSTAFF UVW: 2700 CCC: 653 AXLE: 2309 HITCH: 353
 CLOSED HEIGHT: 5'8" CLOSED LENGTH W/ HITCH: 21'2" BOX SIZE: 14'
 FRESH: 20 GRAY: N/A BLACK: N/A

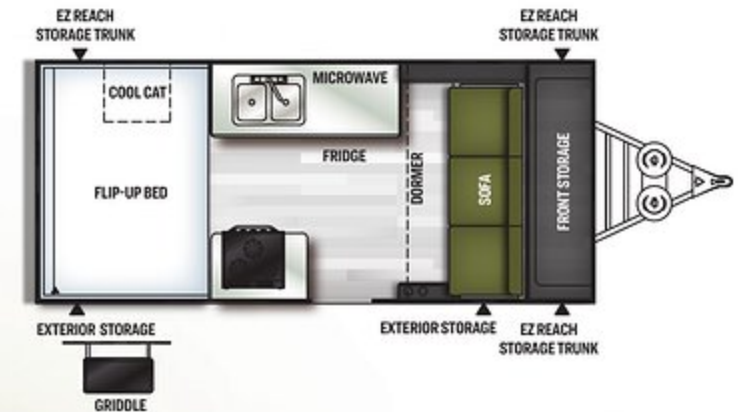

T21FSHW HARD SIDE
FLAGSTAFF UVW: 2648 CCC: 667 AXLE: 2295 HITCH: 315
 CLOSED HEIGHT: 5'8" CLOSED LENGTH W/ HITCH: 21'2" BOX SIZE: 14'
 FRESH: 20 GRAY: N/A BLACK: N/A



Hard Side High Wall Model Features

- A Power Roof Lift Assist**
(Hard Side High Wall only)
- B Gas Strut Lift Assist**
(Std. Hard Side Models w/
Manual Lift Roof Only)
- C Molded LP Bottle Covers**
(Std. Hard Side & Hard
Side High Wall)

| HARD SIDE PACKAGE | HARD SIDE STANDARD FEATURES | | | HARD SIDE OPTIONS |
|--|---|--|---|---|
| 10K BTU Cool Cat Heat Pump (A/C & Heater) | White Fiberglass | 2.5 Cubic Foot 3 Way Refrigerator | 13" Radial Tires (T12RBST/T12RB) | Power Front Jack |
| Create-A-Breeze Roof Vent Fan | Slatewood Interior | Extra Large 3 Way Refrigerator (T21TBHWOR/T21TBHW/T21DMHW) | 14" Radial Tires (T21 models) | 12' Awning/Screen Room w/ Privacy Panels (T12 Models) |
| 3-Way Refrigerator | 12 Volt Water Pump | Solar Prep On Frame | Aluminum Wheels w/ 15" Mud Rover Tires with Aluminum Rims (T12RBTH/T21TBHWOR) | 14' Awning/Screen Room w/ Privacy Panels |
| Heated Mattress on Master Bed (N/A T21TBHW & T21TBHWOR) | Power Roof Lift (T21TBHWOR/T21TBHW/T21DMHW/T21FSHW) | Battery Box & Wiring | Electric Brakes | Hanging Wardrobe w/ 2 Shelves |
| Aluminum Wheels w/ 15" Mud Rover Tires (T21TBHWOR & T12RBTH) | Torsion EZ Lube Axles | 30 Amp Detachable Power Cord | 4 Stabilizer Jacks w/ Sand Pads | Pro Rac Upright Bike Carrier |
| Spare Tire w/ Carrier & Cover | Hot Water Pkg w/ Outside Shower | 35 Amp Converter | Installed Door Step | Pro Rac Kayak Carrier |
| CO Detector | Port-A-Potty (T12RBST/T12RB) | 1/2 Sliding Storage Tray in Rear (Queen Bed Models Only) | Double Step (T21HW Models) | Pro Rac Load Stops |
| Water Filtration System | Shower/Cassette Toilet (T21DMHW) | LED Ceiling Lights | Large Folding Entry Door Grab Handle | Pro Rac Tie Downs |
| Stereo w/ Outside Speakers | Residential Flush Toilet In Cabinet (T21DMHW only) | Raised Panel Cabinet Doors | Courtesy Light on Front | 40 Amp Portable Solar Panel |
| WiFi Booster w/ LTE Prep | 3 Burner Indoor Range w/Cover | Positive Latches & Catches On Doors & Drawers | Outside Griddle | |
| ProRac Permanent Crossbars (150lb rating) | 3 Burner Glass Top Stove w/Oven (T21FSHW) | Wood Drawers with Full Extension Metal Guides | Cable TV Ready | |
| Power Roof Lift (T21DMHW, T21FSHW, T21TBHW, T21TBHWOR) | 2 Burner Indoor Glass Top (T21TBHW/T21TBHWOR/T21DMHW) | Interior Floor Lights | Double 20# Gas Bottles w/Molded Cover | |
| | Microwave | Durable Diamond Plate Front | Automatic Gas Regulator | |
| | | Fiberglass Laminated Roof | | |



TORFLEX
RUBBER TORSION SUSPENSION AXLES

Dexter Torflex Axles

(STANDARD ON HIGH WALL AND HARD SIDE MODELS)

- Independent wheel suspension and self-damping action
- Rubber cushioning eliminates metal-to-metal contact.
- Forged torsion arm for maximum strength

Most models are also equipped with E-Z Lube® System and Nev-R-Adjust® Brakes.

Tent Camper Construction

THE FLAGSTAFF DIFFERENCE



- A** Three Stage Double Arm Lifter Posts (NA Hard Sides)
- B** Fiberglass Vacuum Bonded Radius Roof w/ No Center Seam (NA Hard Sides)
- C** Five-Piece Vinolon Supreme Tenting (NA Hard Sides)
- D** E-Z Crank Down Stabilizer Jacks w/ Sand Pads
- E** Full Perimeter Aluminum Bed Frames (NA Hard Sides)

- F** Plywood Bunk Ends (NA Hard Sides)
- G** Seven-Way Pigtail Wiring
- H** Under Floor 20 Gallon Fresh Water Tank (LTDs 10 Gallon Above Floor)
- I** Powder Coated Tubular Steel Frame
- J** Powder Coated Rafter Poles and Bed Bows (NA Hard Sides)

- K** Air Conditioner Reinforcing Laminated Into Roof (NA Hard Side)
- L** Nitrogen Filled Steel Belted Radial Tires
- M** Easy Lube Axle System (Except LTDs)
- N** Smooth Fiberglass Vacuum Bonded Exterior (NA on MACs & SEs)
- O** One-Piece Door (Except Hard Sides)
- P** Under Awning LED Lighting (Except LTD's & Hard Sides)



- 1** Easy Glide Scissorpole Bed Supports (Except LTDs)
- 2** Heated Mattress (Std. Opt. NA T21DMHW)
- 3** EZ Reach Storage Trunk (Some Models)

- 4** Solar Panel Prep (Std. all models) The Zamp 40 amp. portable solar panel shown is sold separately.
- 5** WIFI Ranger Sky 4 WIFI Booster, with internet connectivity available. (NA on MAC, LTD's)

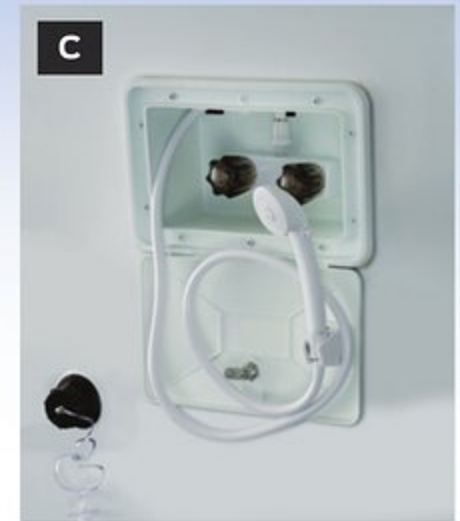

Tent Camper Popular Features

JUST A FEW FEATURES THAT PROVE OUR WORTH.

- A** Add-a-Room with Privacy Panels (Opt. all Models Except Hard Side)

- B** One-Piece Door (Except Hard Side) and Large Entry Assist Handle (Except LTDs)

- C** Outside Shower (Incl. w/ Hot Water Pkg: Std: Hard Side, High Wall and Opt: MAC)

- D** Outside Grill with Work Table (Std. MAC, SE, Hard Side, High Wall)

- E** Power Lift (Std. High Wall, SE, MAC. Opt. LTD)

- F** Under Awning LED Light (All Models Except LTDs and Hard Sides)

- G** ProRac Roof Mounted Cross Bars w/ Opt. Bike and Kayak Carrier attachments. (NA on LTDs)

- H** Black Water Hose Storage (Std. High Wall)

- I** Three Speed Ventilation Fan (Except LTDs)

- J** LED Bunk Light (Std. High Wall)

- K** Metal Full Extension Drawer Guides (Std.)

- L** AM/FM Stereo with Bluetooth and USB ports. (NA LTD & MAC)

- M** Swing Down Galley (Except LTDs, Hard Side, High Wall)



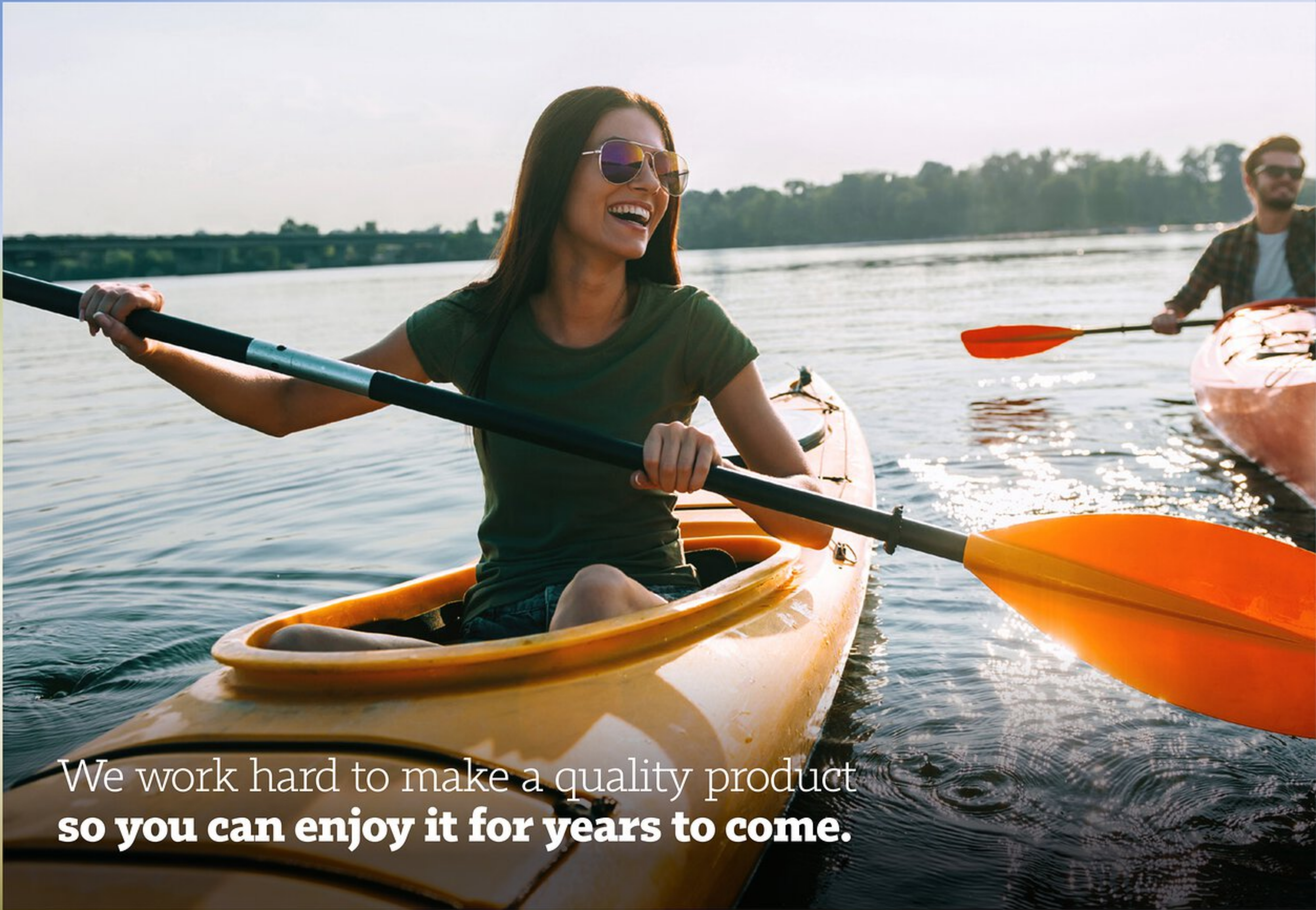

We work hard to make a quality product
so you can enjoy it for years to come.



Flagstaff Warranty. Our Promise.

FOR DETAILS ON FLAGSTAFF'S COMPLETE WARRANTY PROGRAM, SEE YOUR FLAGSTAFF DEALER.
When it comes to backing products with the same quality and commitment it does when it begins the manufacturing process, the only name you have to remember when you're looking for a recreational vehicle is Flagstaff. Flagstaff offers the following additional limited warranties to the original purchasers. Consult written warranty for details.

1. Five-year roof warranty (Excludes Hard Sides).
2. Twenty-five-year floor warranty.
3. Five-year frame warranty.
4. Five-year tent warranty.
5. Ten-year torsion axle warranty.
6. Limited lifetime warranty of lifter system (Excludes Hard Sides).



www.ForestRiverBuyLocal.com



24/7 EMERGENCY ROADSIDE ASSISTANCE WITH VEHICLE PURCHASE*

- | | |
|----------------|-----------------|
| TOWING | WINCH-OUT |
| JUMP-STARTS | MOBILE MECHANIC |
| TIRE CHANGES | TECHNICAL |
| FLUID DELIVERY | SUPPORT |
| LOCKOUT | DEALER LOCATOR |
| SERVICE | SERVICES |



*VALID FOR 1 YEAR FROM DATE OF PURCHASE



PRE-DELIVERY INSPECTION FACILITY

20,000 square feet of quality assurance. The bare essentials for a premium product. This state-of-the-art facility gives immediate daily feedback to production for quality assurance in every unit built.

Specification Definitions :: GVWR (Gross Vehicle Weight Rating) - is the maximum permissible weight of the unit when fully loaded. It includes all weights, inclusive of all fluids, cargo, optional equipment and accessories. For safety and product performance do NOT exceed the GVWR. // **GAWR (Gross Axle Weight Rating)** - is the maximum permissible weight, including cargo, fluids, optional equipment and accessories that can be safely supported by a combination of all axles. // **UVW (Unloaded Vehicle Weight)** - is the typical weight of the unit as manufactured at the factory. It includes all weight at the unit's axle(s) and tongue or pin and LP Gas. The UVW does not include cargo, fresh potable water, additional optional equipment or dealer installed accessories. *Estimated average based on standard build optional equipment. // **CCC (Cargo Carrying Capacity)**** - is the amount of weight available for fresh potable water, cargo, additional optional equipment and accessories. CCC is equal to GVWR minus UVW. Available CCC should accommodate fresh potable water (8.3 lbs per gallon). Before filling the fresh water tank, empty the black and gray tanks to provide for more cargo capacity. ** Estimated average based on standard build optional equipment. // Each Forest River RV is weighed at the manufacturing facility prior to shipping. A label identifying the unloaded vehicle weight of the actual unit and the cargo carrying capacity is applied to every Forest River RV prior to leaving our facilities. The load capacity of your unit is designated by weight, not by volume, so you cannot necessarily use all available space when loading your unit. // All information contained in this brochure is believed to be accurate at the time of publication. However, during the model year, it may be necessary to make revisions and Forest River, Inc., reserves the right to make all such changes without notice, including prices, colors, materials, equipment and specifications as well as the addition of new models and the discontinuance of models shown in this brochure. Therefore, please consult with your Forest River dealer and confirm the existence of any materials, design or specifications that are material to your purchase decision. Litho. U.S.A. FOR 1766 P8W-2021.01.26

Look for our other popular lines of Flagstaff trailers.

YOUR **FLAGSTAFF** DEALER



FLAGSTAFF E-PROS



FLAGSTAFF FIFTH WHEELS



FLAGSTAFF TRAVEL TRAILERS



Learn More
Scan this barcode using
a QR Reader on your
smart phone to learn
more about Forest River.



A Berkshire Hathaway company.

