

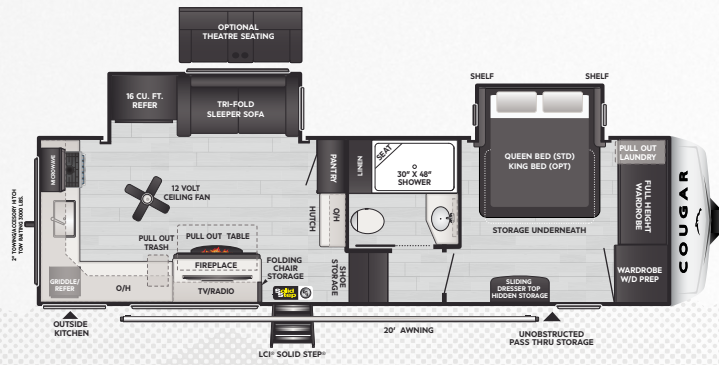

KEYSTONE
RV COMPANY

COUGAR

2025 | FIFTH WHEELS



260MLE | WEIGHT 9665 | LENGTH 30' 11"

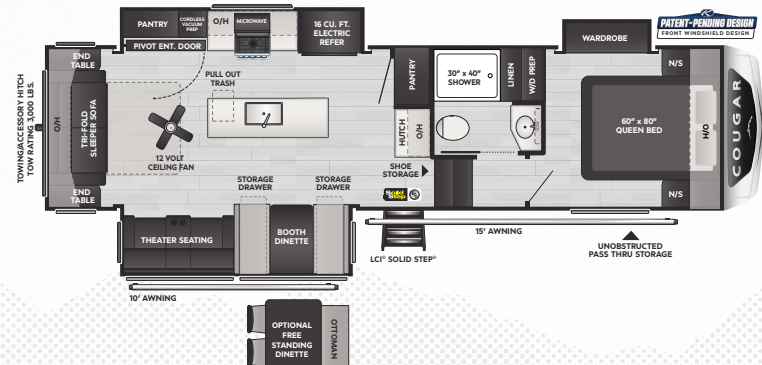

290RLS | WEIGHT 10560 | LENGTH 33' 8"

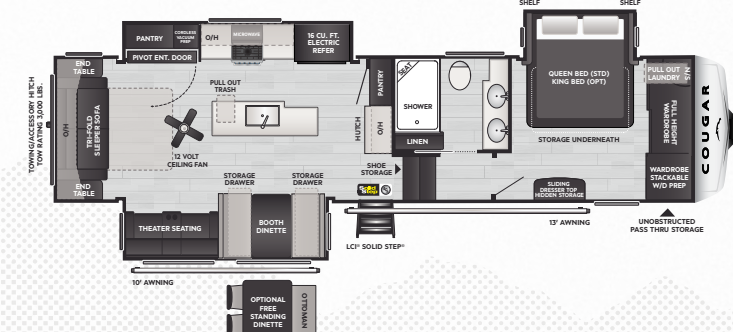

316RLS | WEIGHT TBD | LENGTH 35' 8"

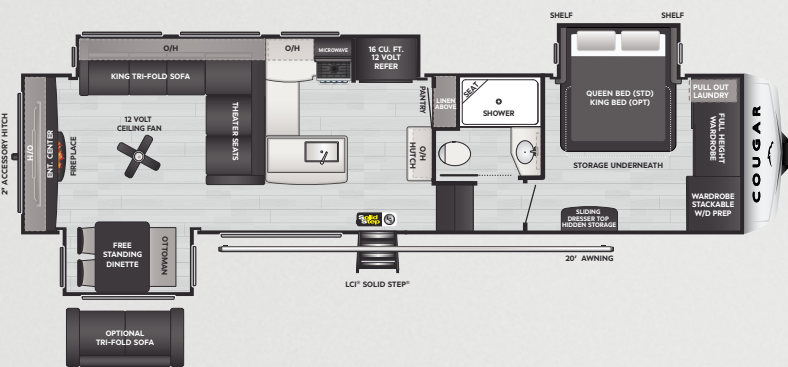

320RDS | WEIGHT 11133 | LENGTH 36' 10"

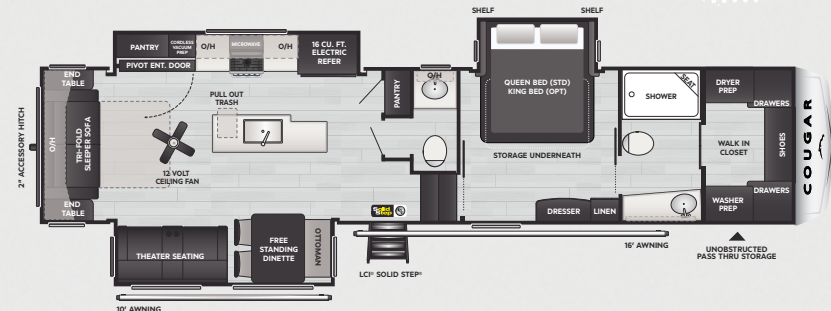

355FBS | WEIGHT 11589 | LENGTH 39' 3"

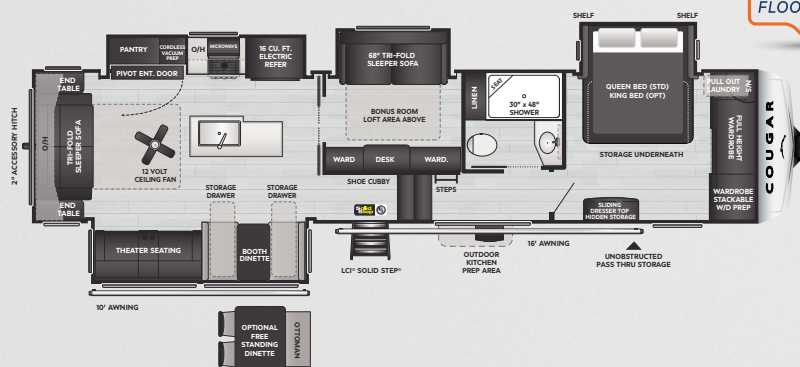

360MBI | WEIGHT TBD | LENGTH 39' 3"

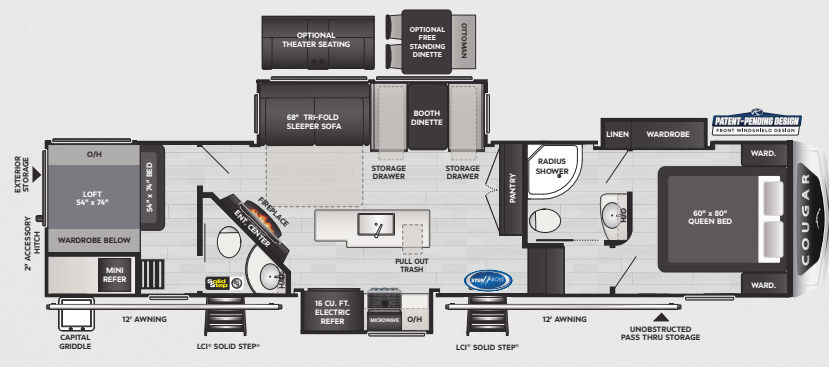

364BHL | WEIGHT TBD | LENGTH 39' 0"



HERO EDITION™

INDUSTRY EXCLUSIVE MATTE HERO EDITION PAINT FINISH
FRAMELESS WINDOWS · GLASS ENTRY DOOR · BLACKOUT RIMS
GREEN LED EXTERIOR ACCENT LIGHTING

DISCLAIMER: Product information is as accurate as possible as of the date of this publication. All features, floor plans, and specifications are subject to change without notice. Pre-production estimated weights & lengths may be listed; visit Keystonerv.com for the most current product information and specifications.

CAMP BETTER
KINDNESS · COMMUNITY · PLANET





KEYSTONE
RV COMPANY

COUGAR

2025 | FIFTH WHEELS

PROFESSIONAL GRADE CAMPING

- » 75 Gallon Fresh Water Tank
- » Washer/Dryer Prep (N/A 364BHL)
- » Hidden Dresser Storage
- » Lippert® Solid Step®
- » Entry Door Privacy Shade
- » Vent-All Window System
- » Girard® On-Demand Water Heater
- » 5-Sided Aluminum Superstructure
- » AlphaPly 30 TPO Roofing W/Lifetime Warranty
- » Fully Walkable Roof And Slide-Out Roof
- » (2) 30 LBS. LP Tanks
- » LP Quick Disconnect For Grilling
- » Detachable 50amp Power Cord W/ Reverse Polarity Indicator
- » Dedicated Sewer Hose Storage
- » Dimmable Lights In Main Slide, Living Room & Bedroom*
- » Heat & Massage Theater Seats (364bhl Optional)
- » 50" High Definition Smart TV
- » Bluetooth Radio W/ Dual Zone Speakers
- » Winegard 360+ W/ WiFi Prep
- » 12V Charging Stations Throughout
- » Power Vent W/ Rain Sensor In Kitchen
- » 30" Residential Microwave W/Outside Vent
- » Furrion 21" Oven W/3-Burner Cooktop & Oven Drawer
- » Solid Surface Kitchen Countertops
- » (2) Pull-Out Trash Cans W/Paper Towel Holder
- » Exterior Awning Switch In Pass-Thru*
- » Soft Close Hardwood Cabinet Doors W/ Hidden Hinges
- » Keyed Alike*
- » Lighted Termination Points
- » MORryde Safe-T-Rail Entry Handle
- » Booth Dinette W/Led Lights And Drawers*
- » Slide Topper Prep

TOWING WITH CONFIDENCE

- » Lippert® Axles w/ Anti-Lock Braking System
- » Rainier "H" Rated 16 Ply Tires w/ 8 Year Warranty
- » Lippert® Road Armor™ Shock Absorbing Pin Box & Equalizer
- » 16" 6 Lug Wheels & H Rated Full Size Spare Tire
- » 2" Accessory Hitch (3K LBS. Towing Cap 260MLE, 290RLS, 316RLS)
- » MaxTurn™ Technology w/ Patented Front Radius Frame
- » Keystone Exclusive HitchVision
- » Rear Camera Prep & Tire Linc® TPMS Prep
- » Reverse Tail Lights

MIDNIGHT EDITION FULL BODY PAINT



EXTREME HIGH GLOSS SIDEWALLS • FRAMELESS WINDOWS
BLACKOUT RIMS • BLUE LED EXTERIOR ACCENT LIGHTING

COUGAR INNOVATIONS

- » HyperCore™ Composite Sidewalls*
- » 12V Color-Coded Wiring
- » Giggly Box-Industry's 1st Organized 12V Wiring Box
- » Spacesaver Fifth Wheel Chassis*
- » Tru-Fit™ Slide Construction
- » Painted Front Cap W/ Automotive Clear Coat
- » Automotive Windshield (Select Floor Plans)
- » Tank Guardian High Tensile Strength Strap System
- » Double Welded Aluminum Frame Construction
- » Prewired For Roof Mount Satellite Dish
- » Decorative Snap-In Ceiling Treatments*
- » KeyTV™

CLIMATE GUARD PROTECTION

- » 18K Furrion High Efficiency Chill Cube A/C*
- » 30K BTU Furnace
- » Tinted Windows w/ Black-Out Roller Shades
- » Astro-Foil™ Insulated Underbelly
- » 12V Heat Pads on Holding Tanks
- » Forced-Air Heated & Enclosed Underbelly
- » Heated Basement Storage & Convenience Center
- » Reflective Foil in Roof, Front Cap, Slide Floors
- » 3rd A/C Prep*
- » 12V Ceiling Fan
- » Dual Attic Vents
- » PEX Plumbing Lines
- » Insulated Gooseneck & Bulkhead Divider
- » Sealed Pin Box
- » Electric Fireplace

STANDARD FEATURES & OPTIONS



*New for 2025

DISCLAIMER: Product information is as accurate as possible as of the date of this publication. All features, floor plans, and specifications are subject to change without notice. Pre-production estimated weights & lengths may be listed; visit Keystonerv.com for the most current product information and specifications.

CAMP BETTER
KINDNESS · COMMUNITY · PLANET





KEYSTONE
RV COMPANY

COUGAR

2025 | HALF-TON FIFTH WHEELS

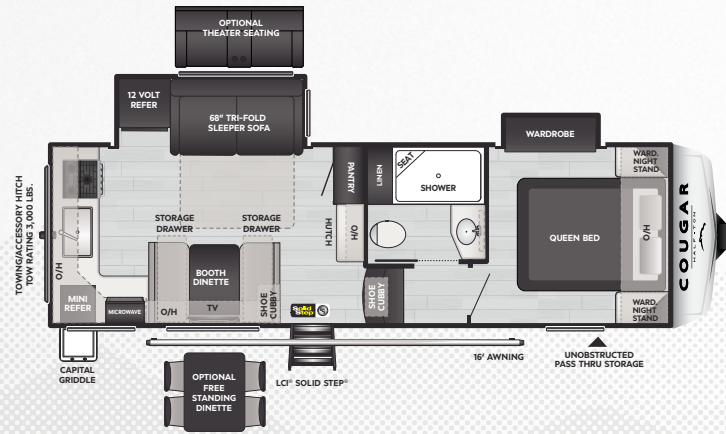

23MLE | WEIGHT 7778 | LENGTH 27' 11"

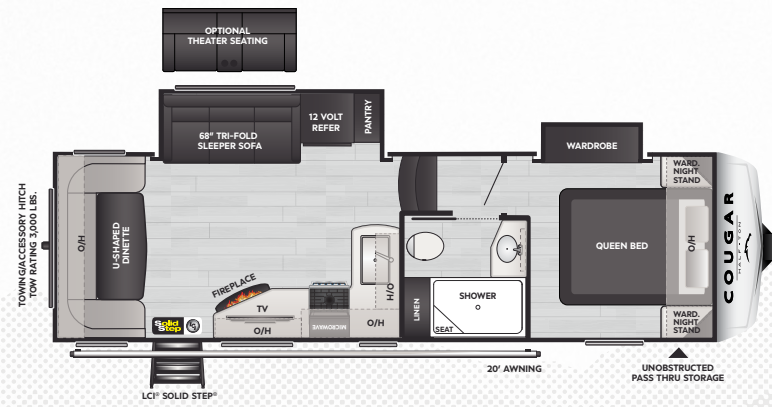

24RDS | WEIGHT 7612 | LENGTH 28' 10"

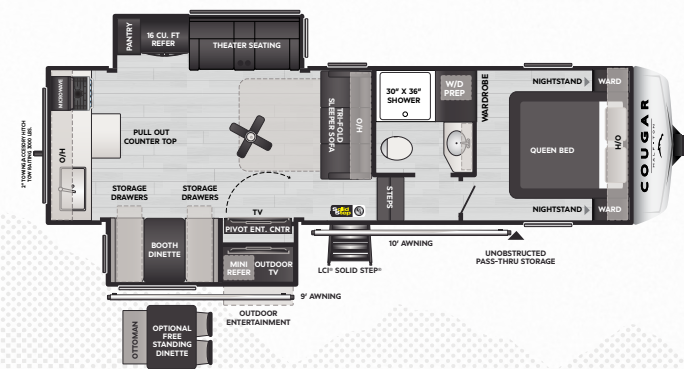

26RKE | WEIGHT TBD | LENGTH 30' 10"

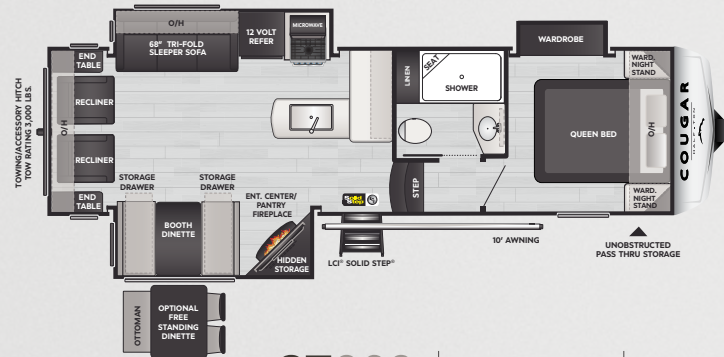

27SGS | WEIGHT 8343 | LENGTH 30' 6"

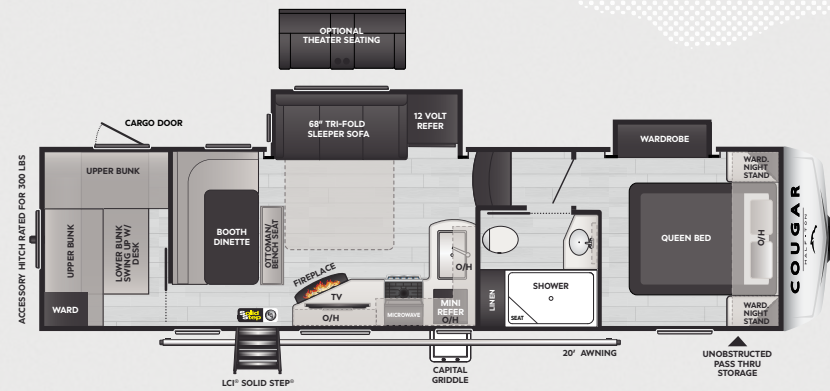

29BHL | WEIGHT 8345 | LENGTH 33' 4"

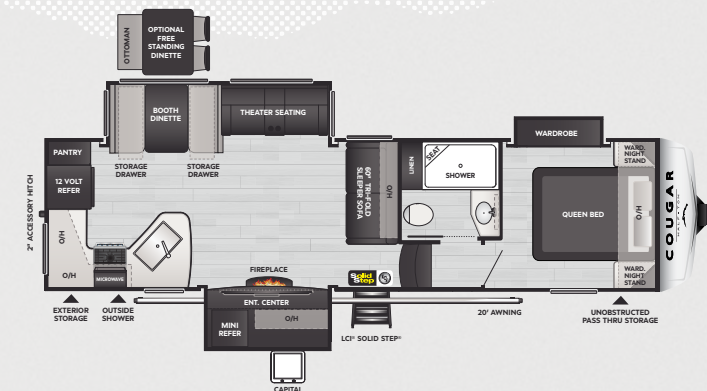

29RKS | WEIGHT 8958 | LENGTH 32' 9"

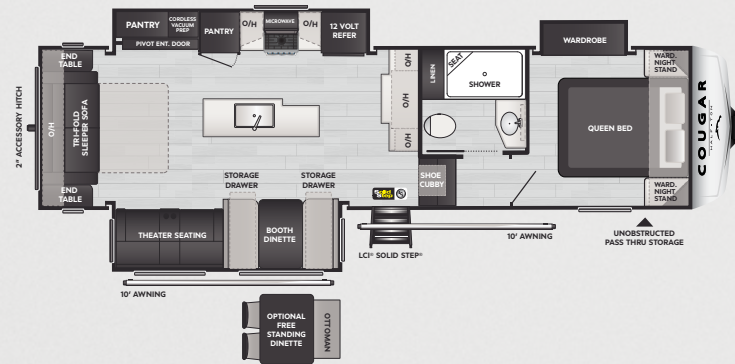

29RLI | WEIGHT 8893 | LENGTH 32' 9"

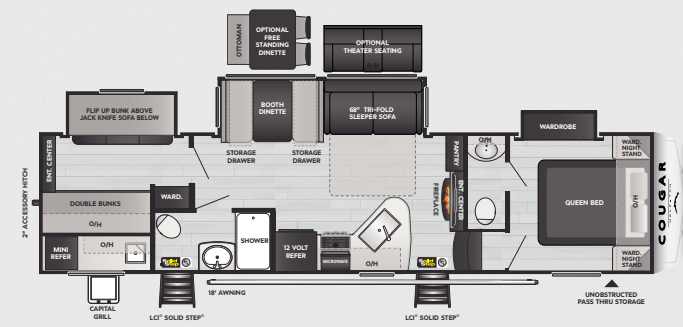

32BHS | WEIGHT 9428 | LENGTH 35' 8"

DISCLAIMER: Product information is as accurate as possible as of the date of this publication. All features, floor plans, and specifications are subject to change without notice. Pre-production estimated weights & lengths may be listed; visit Keystonerv.com for the most current product information and specifications.

CAMP BETTER
KINDNESS · COMMUNITY · PLANET





KEYSTONE
RV COMPANY

COUGAR

2025 | HALF-TON FIFTH WHEELS

PROFESSIONAL GRADE

- » Girard® On-Demand Water Heater
- » 55 Gallon Fresh Water Tank
- » Best In Class Unobstructed Exterior Pass Through Storage
- » Universal Docking Station - Easy Winterization
- » Lippert® Solid Step®
- » Entry Door Privacy Shade
- » Slide Topper Prep
- » 5-Sided Aluminum Superstructure
- » Alpha Ply 30 TPO Roofing w/Lifetime Warranty
- » Fully Walkable Roof and Slide-out Roof
- » (2) 30 LBS. LP Tanks
- » LP Quick Disconnect for Grilling
- » Detachable 50amp Power Cord w/ Reverse Polarity Indicator
- » Linoleum Slideout Flooring
- » Dimmable Lights in Main Slideout, Living Room & Bedroom*
- » Blackout Rollershades Throughout
- » High Definition Smart TV
- » Bluetooth Radio w/ Dual Zone Speakers
- » Winegard 360+ W/ WiFi Prep
- » Furrion 17" Oven w/3-Burner Cooktop
- » Single Bowl Stainless Steel Kitchen Sink w/ Sink Covers
- » High Rise Kitchen Faucet w/ Pullout Sprayer
- » Soft Close Hardwood Cabinet Doors w/ Hidden Hinges
- » Memory Foam Mattress w/ Washable Cover
- » Under Bed Storage w/ Strut Assist
- » Nightstands W/ 110 Outlets and USB Ports
- » 12V USB Outlets Throughout
- » MORryde Safe-T-Rail Entry Handle
- » Vent-All Window System
- » Keyed Alike*
- » Power Tank Fill*
- » Water Pump Access Panel*
- » Exterior Awning Switches*

*New for 2025

CLIMATE GUARD PROTECTION

- » 15K BTU Furrion A/C
- » 30K BTU Furnance
- » Tinted Windows w/ Safety Glass
- » Astro-Foil™ Insulated Underbelly
- » 12V Heat Pads on Holding Tanks
- » Forced-Air Heated & Enclosed Underbelly
- » Reflective Foil in Front Cap & Slide Floors
- » Heated/Enclosed Dump Valves
- » Heated/Enclosed Convenience Center
- » Dual Attic Vents
- » PEX Plumbing Lines
- » Insulated Gooseneck & Bulkhead Divider
- » Sealed Pin Box

COUGAR INNOVATIONS

- » HyperCore™ Composite Sidewalls*
- » HyperDeck™ Water Resistant Flooring
- » Blade™ Air Flow System
- » Giggy Box-Industry's 1st Organized 12V Wiring Box
- » 12V Color-Coded
- » KeyTV™
- » Keystone's Innovated Fifth Wheel Chassis
- » Tru-Fit™ Slide Construction
- » Painted Front Cap w/ Automotive Clear Coat
- » Decorative Snap-In Ceiling Treatments*

TOWING WITH CONFIDENCE

- » Goodyear® Endurance® Tires
- » Tire Linc® TPMS Prep
- » Lippert® Road Armor™ Shock Absorbing Equalizer & Pin Box
- » Lippert® Axles w/ Anti-Lock Braking System
- » Full Size Spare Tire
- » Rear Camera Prep
- » Reverse Tail Lights
- » 2" Accessory Hitch (3K LBS. Tow Capacity 23MLE,24RDS,26RKE,27SGS)
- » MaxTurn™ Technology w/ Patented Front Radius Frame
- » Keystone Exclusive HitchVision

STANDARD FEATURES & OPTIONS



DISCLAIMER: Product information is as accurate as possible as of the date of this publication. All features, floor plans, and specifications are subject to change without notice. Pre-production estimated weights & lengths may be listed; visit Keystonerv.com for the most current product information and specifications.

CAMP BETTER
KINDNESS · COMMUNITY · PLANET





KEYSTONE
RV COMPANY

COUGAR

2025 | HALF-TON TRAVEL TRAILERS

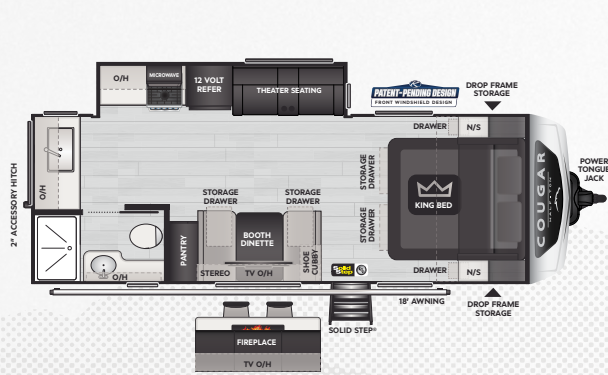

22MLS | WEIGHT 6110 | LENGTH 26' 10"

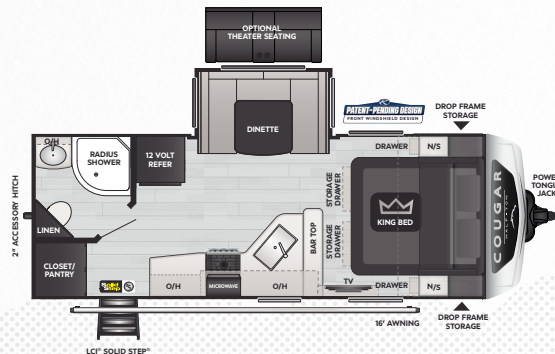

22RBS | WEIGHT 5785 | LENGTH 25' 11"

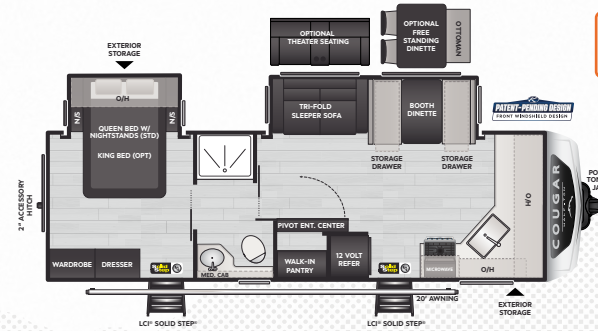

25FKD | WEIGHT 7040 | LENGTH 29' 11"

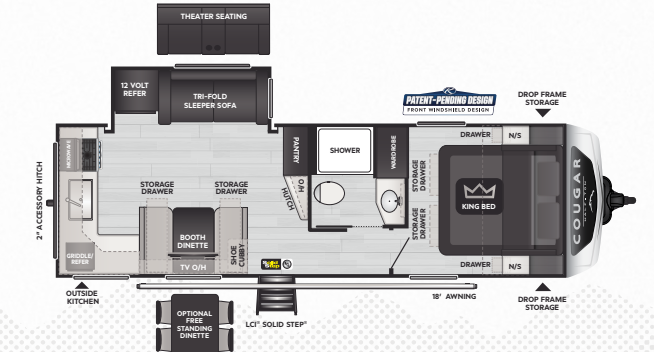

25MLE | WEIGHT 6676 | LENGTH 29' 11"

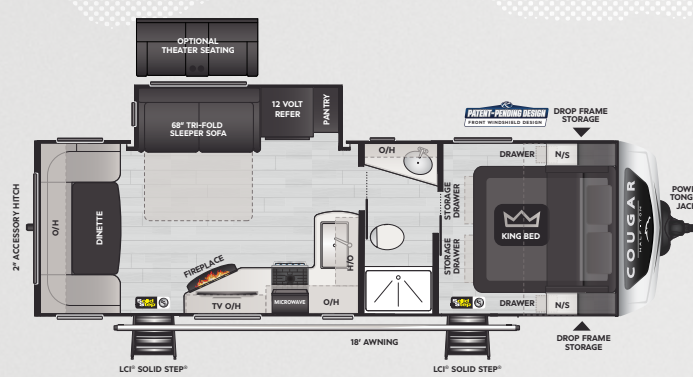

25RDS | WEIGHT 6640 | LENGTH 29' 10"

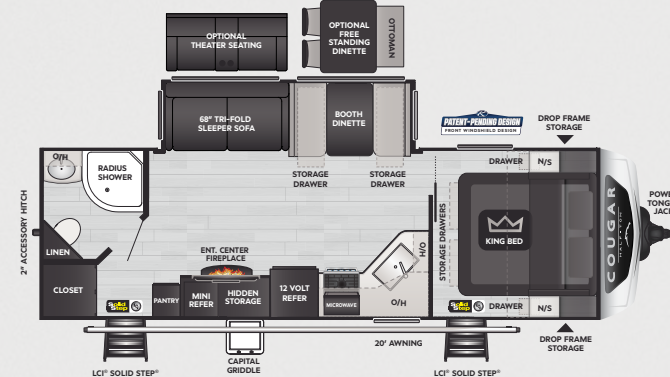

26RBS | WEIGHT 6640 | LENGTH 31' 11"



28BHS | WEIGHT TBD | LENGTH 32' 11"

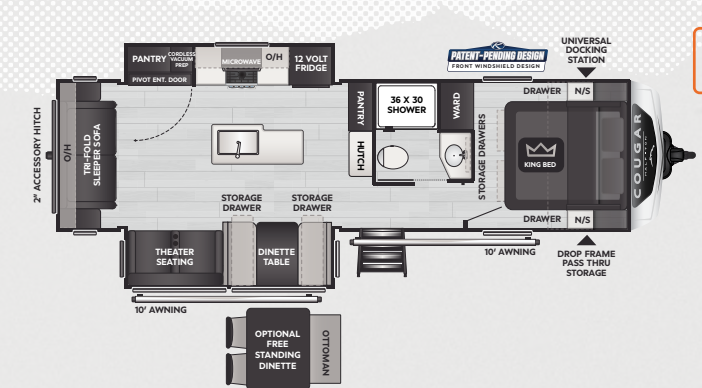

29RLP | WEIGHT 8210 | LENGTH 33' 7"

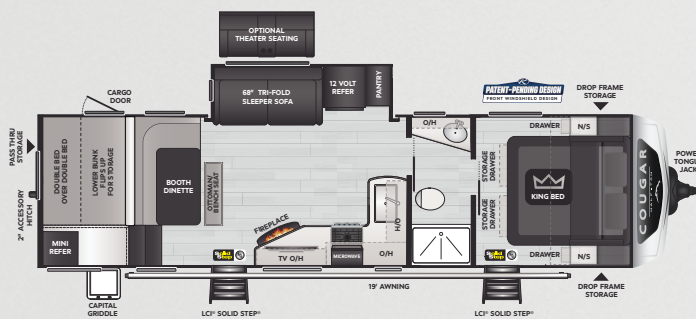

30BHS | WEIGHT 7210 | LENGTH 34' 5"

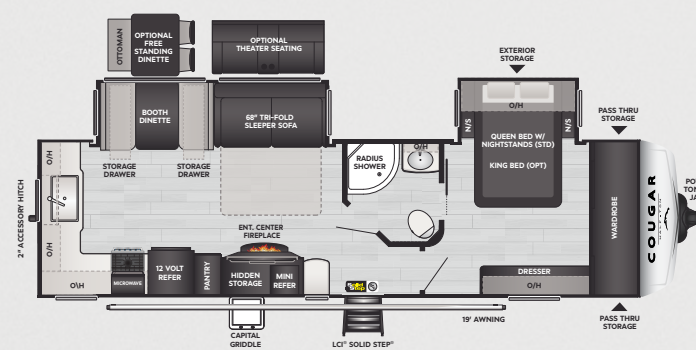

30RKD | WEIGHT 7715 | LENGTH 34' 9"

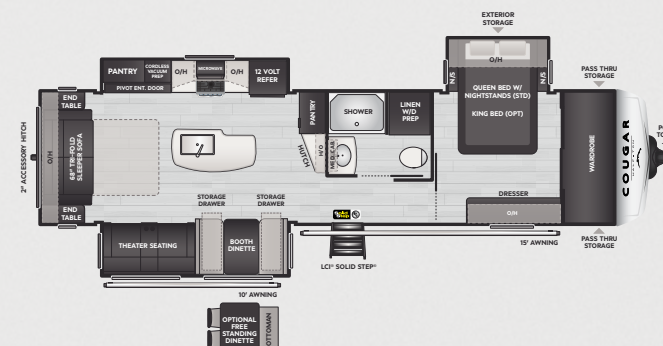

33RLI | WEIGHT 8490 | LENGTH 37' 5"

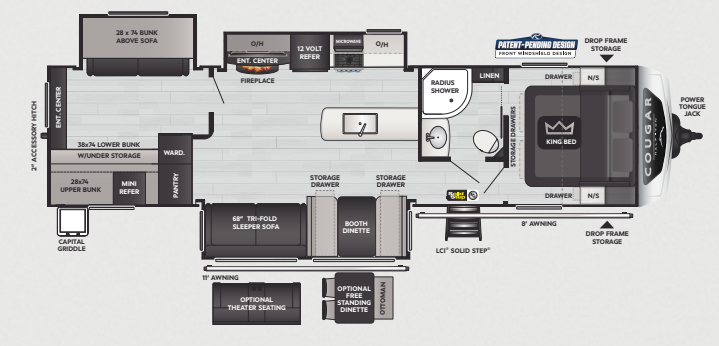

34TSB | WEIGHT 8715 | LENGTH 37' 5"

DISCLAIMER: Product information is as accurate as possible as of the date of this publication. All features, floor plans, and specifications are subject to change without notice. Pre-production estimated weights & lengths may be listed; visit Keystonerv.com for the most current product information and specifications.

CAMP BETTER
KINDNESS · COMMUNITY · PLANET





KEYSTONE
RV COMPANY

COUGAR

2025 | HALF-TON TRAVEL TRAILERS

PROFESSIONAL GRADE

- » Girard® On-Demand Water Heater
- » 55 Gallon Fresh Water Tank
- » Universal Docking Station - Easy Winterization
- » Lippert® Solid Step® W/ Entry Door Privacy Shade
- » Slide Topper Prep
- » 5-Sided Aluminum Superstructure
- » Alpha Ply 30 TPO Roofing w/Lifetime Warranty
- » Fully Walkable Roof and Slide-out Roof
- » (2) 20 LBS. LP Tanks
- » LP Quick Disconnect for Grilling
- » Detachable Power Cord w/ Reverse Polarity Indicator
- » Linoleum Slideout Flooring
- » Dimmable Lights in Main Slideout, Living Room & Bedroom*
- » Blackout Rollershades Throughout
- » HD Smart TV & Furrion Bluetooth Radio w/ Dual Zone Speakers
- » Winegard 360+ W/ WiFi Prep
- » Furrion 17" Oven w/3-Burner Cooktop
- » Single Bowl Stainless Steel Kitchen Sink w/ Sink Covers
- » High Rise Kitchen Faucet w/ Pullout Sprayer
- » Soft Close Cabinet Doors w/ Hidden Hinges
- » Booth Dinette w/Drawers & Accent Lighting*
- » Under Bed Storage w/ Strut Assist
- » Nightstands w/ 110 Outlets & USB Ports
- » 12V USB Outlets Throughout
- » Washer/Dryer Prep (33RLI Only)
- » Memory Foam Mattress w/ Washable Cover
- » Drop-Frame w/Increased Storage* (Select Floorplans)
- » Vent-All Window System
- » Keyed Alike*
- » Power Tank Fill*
- » Water Pump Access Panel*
- » Heat Duct in Pass-Through Storage*
- » Exterior Awning Switches*

CLIMATE GUARD PROTECTION

- » 15K BTU Furrion A/C
- » 30K BTU Furnace
- » Tinted Windows w/ Safety Glass
- » Astro-Foil™ Insulated Underbelly
- » 12V Heat Pads on Holding Tanks
- » Forced-Air Heated & Enclosed Underbelly
- » Reflective Foil Insulated Front Cap & Slide Floors
- » Dual Attic Vents
- » PEX Plumbing Line

COUGAR INNOVATIONS

- » HyperCore™ Composite Sidewalls*
- » HyperDeck™ Water Resistant Flooring
- » Blade™ Air Flow System
- » Giggly Box-Industry's 1st Organized 12V Wiring Box
- » 12V Color-Coded Wiring
- » KeyTV™
- » Tru-Fit™ Slide Construction
- » Painted Front Cap w/ Automotive Clear Coat
- » Automotive Windshield (Select Floor Plans)
- » Decorative Snap-In Ceiling Treatments*

TOWING WITH CONFIDENCE

- » Lippert® Axles w/ Anti-Lock Braking System
- » Goodyear® Endurance® Tires
- » Lippert® Road Armor™ Shock Absorbing Equalizer*
- » Tire Linc® TPMS Prep
- » Full Size Spare Tire
- » Rear Camera Prep
- » Reverse Tail Lights
- » 2" Accessory Hitch

*New for 2025

STANDARD FEATURES & OPTIONS



DISCLAIMER: Product information is as accurate as possible as of the date of this publication. All features, floor plans, and specifications are subject to change without notice. Pre-production estimated weights & lengths may be listed; visit Keystonerv.com for the most current product information and specifications.

CAMP BETTER
KINDNESS · COMMUNITY · PLANET





KEYSTONE
RV COMPANY

COUGAR

2025 | SPORT FIFTH WHEELS

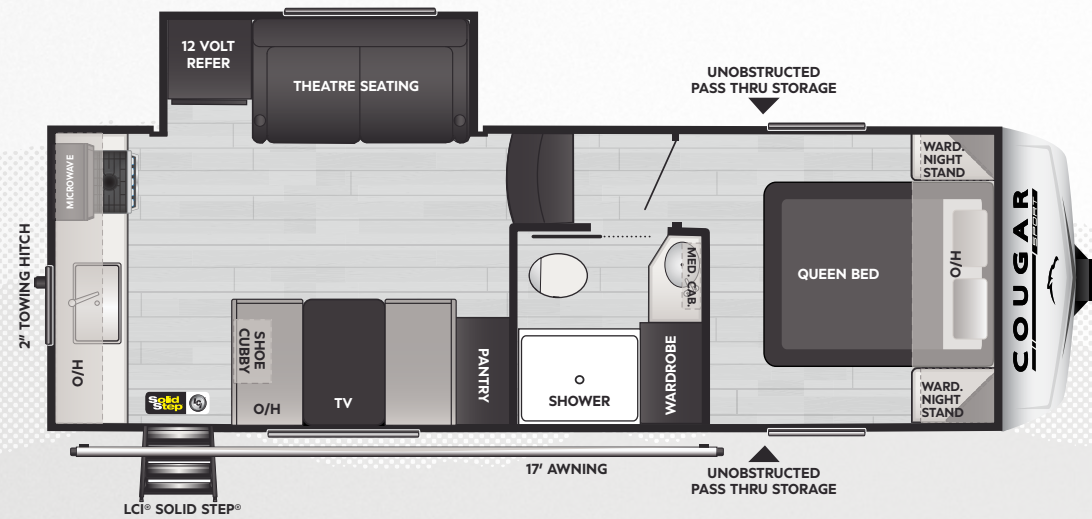

2100RK | WEIGHT 6815 | LENGTH 26' 3"

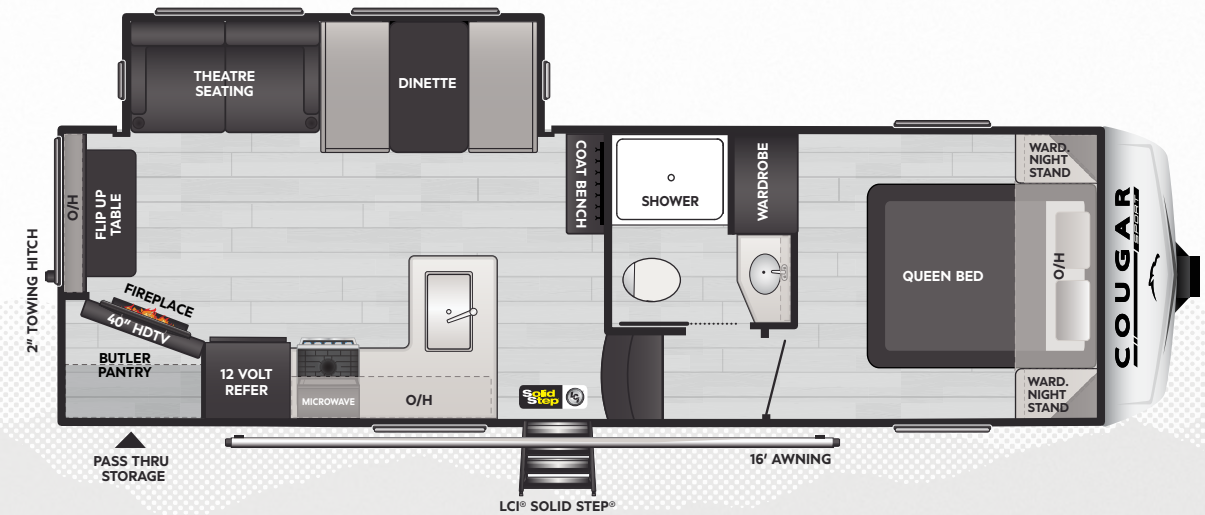

2400RE | WEIGHT 7635 | LENGTH 29' 4"

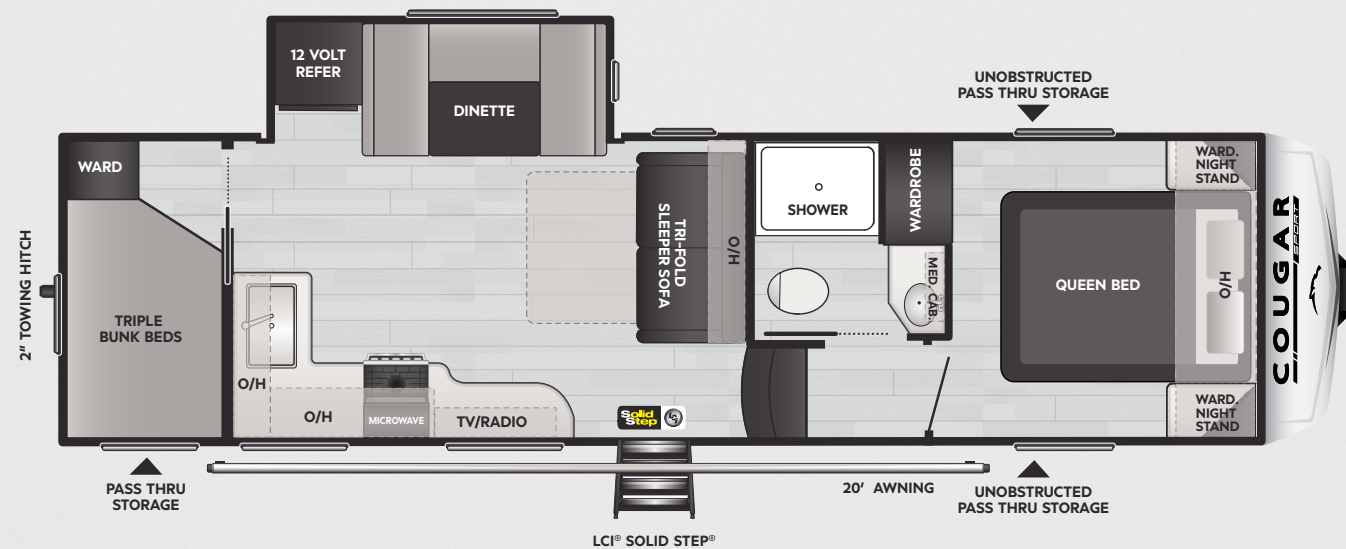

2700BH | WEIGHT 7580 | LENGTH 32' 3"

DISCLAIMER: Product information is as accurate as possible as of the date of this publication. All features, floor plans, and specifications are subject to change without notice. Pre-production estimated weights & lengths may be listed; visit Keystonerv.com for the most current product information and specifications.

CAMP BETTER
KINDNESS · COMMUNITY · PLANET





KEYSTONE
RV COMPANY

COUGAR

2025 | SPORT FIFTH WHEELS

25TH ANNIVERSARY SPORT PACKAGE

- » HyperCore™ Composite Sidewalls*
- » Decorative Snap-In Ceiling Treatments*
- » Girard® Tankless Water Heater
- » 40" TV
- » Heated Enclosed Underbelly
- » Standard Tri-Fold Sleeper Sofa (2700BH)
- » Standard Theater Seating (2100RK & 2400RE)
- » Lippert® Roto-Flex™ Pin Box
- » HitchVision
- » MaxTurn™ Technology
- » 12V Color-Coded Wiring
- » Blade™ Air Flow System
- » HyperDeck™ Flooring
- » Backup Camera Prep
- » Towing Receiver with 4-way wiring
- » KeyTV™
- » Giggly Box-Industry's 1st Organized 12V wiring Box
- » Fiberglass Front Cap
- » (2) Attic Vents
- » PEX Plumbing Lines
- » Sealed Pin Box
- » High Rise Kitchen Faucet
- » Residential Hard Wood Cabinet Doors
- » Carpetless Interior
- » Nightstands w/ 110 Outlets & USB Ports
- » Under Bed Storage w/ Strut Assist
- » (2) 30 LBS. LP Tanks
- » Full Size Spare Tire

*New for 2025



SPORT APPEARANCE PACKAGE

- » Frameless Windows
- » Glass Entry Door
- » Sport Graphics and Wheel Package

FURRION ELECTRONICS SUITE

- » 10.4 Cu. Ft. 12V Refrigerator
- » .9 Cu. Ft. Microwave
- » 17" Oven
- » 15K Furrion A/C
- » Detachable 50Amp Shore Cord
- » Dual Zone Bluetooth Radio w/DVD Player

STANDARD FEATURES & OPTIONS



DISCLAIMER: Product information is as accurate as possible as of the date of this publication. All features, floor plans, and specifications are subject to change without notice. Pre-production estimated weights & lengths may be listed; visit Keystonerv.com for the most current product information and specifications.

CAMP BETTER
KINDNESS · COMMUNITY · PLANET

