

Passport

ULTRA LITE
by Keystone



EXPRESS



GRAND TOURING



GO ANYWHERE

ELITE



Keystone RV
Company

Passport ULTRA LITE

by Keystone



MORE CAMPING FOR LESS

Welcome to Passport Ultra Lite by Keystone. Developed by the industry leader in travel trailers and fifth wheels, Keystone set out to develop a true, full line, ultra lite product that brings best in class features and value to the market. Once again, Keystone delivers with the Passport Ultra Lite!

With customer demand for lightweight fuel efficient travel trailers at an all time high, the Passport from Keystone is sure to be the pick of families who want to maximize fuel efficiency, but still maintain all the conveniences of a well appointed, feature packed RV. Passport identified the four most important priorities for our customers: floor plan, weight, eye appeal and price; then designed the Passport to be the perfect combination of all four. Creative engineering has enabled Passport to include high-end amenities without adding pointless weight. Its sleek aerodynamic front-end design and enclosed underbelly reduces wind resistance and increases fuel efficiency. In addition, the "Load Equalization", spread-axle system assists in lowering hitch weight and makes towing easier. The Passport family can be easily towed with a half-ton pickup or SUV and the Passport Express can be towed by some smaller SUVs, crossovers or vans.

Sure, towability led you to the Passport, but when you need a travel trailer for those fun weekends or the extended cross country excursion you realize Passport has a full array of features and conveniences built into every model! You know you have arrived at the pinnacle of lite weights when you roll in with a Passport.

GO ANYWHERE.



Express Super Lite



Grand Touring



Elite

What looks small but packs a big punch when it comes to living space? The Passport Express Super Lite! Whether it's the feel of sleeping in the open air with our expandable models or the need for a trailer that can be towed by most small SUV's, the Passport **Express** Super Lite is the Passport way of making camping easy.

One word describes the Passport Grand Touring. Amazing! The Passport Grand Touring didn't get the memo that it was suppose to act like the other lite weights. With size and features of a full size camper, this Passport is still made for today's SUV's and half ton vehicles. So go ahead live large and go lite, and get more with a Passport **Grand Touring**.

Taking camping to the next level, Passport has created the ultimate in lightweight luxury! Once inside, you will see why the wide open spaces, all the amenities and high end finishes make this ultra-lite travel trailer **Elite** indeed.



PAGE 4



PAGE 5



PAGE 6



Pantry Can Also Be Used As Wardrobe



Queen Size Bed



Booth Dinette with Entertainment Center

EXPRESS SUPER LITE

EXPRESS SUPER LITE



Let's say you need a camper that is easy to tow, has models under 3500 lbs. and has everything from a large kitchen sink to outside speakers. Look no further, you have arrived at the Passport Express Super Lite. With floorplans starting around 3500 lbs. and including every feature the experienced camper needs, this is the Passport you want. With up to 30 foot bunkhouses, you'll have more than enough room to go anywhere in a Passport Express Super Lite.



Large Pass Through Storage Area



Entertainment Center with Swivel TV



Plenty of Space for the Kids to Sleep



Portable Outside Grill

GRAND TOURING



Live large and go light with the Passport Grand Touring. The long standing myth of not being able to have a full 36" deep slide and still be an ultra lite has been solved. The first and only true ultra lite weight travel trailer with a deep slide that gives you all the room you want but doesn't have unnecessary weight like the others. The spectacular Grand Touring 3220BH gives you sleeping for up to 10, an outside kitchen with water, a fridge, and cooktop all under it's own awning is a flagship in its self. Want something made for two? Then step into a 2510RB which rolls in under 4900 lbs, has room to roam inside, and 2 full wardrobes/pantries to fill for a fun weekend or a cross country outing.

Passport ULTRA LITE

by Keystone

32FB SHOWN IN RATTAN DECOR



Perfect Play Place
for the Kids



Spacious Kitchen



Full 60" x 80" Queen Bed

PASSPORT ELITE

PASSPORT ELITE



Wow! Passport has done it again! The all new Passport Elite represents the ultimate in "true" ultra-lightweight luxury. Includes spacious wide open layouts, residential sized leather sofas, solid surface countertops, stainless steel appliances and so much more. If you're looking for the ultimate in lightweight luxury, look no further than the Elite.

STANDARDS & OPTIONS

EXPRESS
GT
ELITE

CHASSIS

Engineered specifically for each floor plan	●	●	●
Tube style bumper w/ sewer hose storage	●	●	●
Fully welded outriggers	●	●	●
Cambered for added structural support	●	●	●
Extra support cross members	●	●	●
Electric slide out system	●	●	●
Enclosed and heated underbelly	●	●	●

CONSTRUCTION

Welded aluminum framed sidewalls	●	●	●
Laminated gel-coated filon exterior walls	●	●	●
High density bead foam insulation in sidewalls (R-7 insulation)	●	●	●
Laminated aluminum framed floor 2" thick	●	●	●
One piece breathable Darco protective wrap	●	●	●
R-11 floor insulation	●	●	●
Stamped galvanized 5" thick crowned rafters	●	●	●
One piece seamless Rubber roof	●	●	●
R-11 ceiling insulation	●	●	●

EXTERIOR FEATURES

Insulated lockable radius baggage doors with hold backs	●	●	●
Insulated radius entrance door with screen door	●	●	●
Double entry steps at main door	●	●	●
Triple entry steps at main door	●	●	●
Heavy duty front mechanical jack	●	●	●
4 scissor style stabilizer jacks	●	●	●
2-20lb. Propane bottles with flip top cover	●	●	●
Dual battery rack over A-frame	●	●	●
Rain gutters with extended downspouts	●	●	●
Electric adjustable awning	●	●	●
Lighted exterior pass thru storage compartment	●	●	●
Portable outside grill (most models)	●	●	●
Patio entrance light	●	●	●
Exterior shower w/ hot & cold	●	●	●
Fold away exterior grab handle (main door)	●	●	●
Front diamond plate	●	●	●
Load Equalization (spread axle design)	●	●	●
EZ lube axles	●	●	●
Exterior speakers	●	●	●
Exterior light at dump valves	●	●	●
Aluminum Wheels (OPTIONAL)	●	●	●
Upgraded graphics	●	●	●
Frameless windows	●	●	●
15 inch tires	●	●	●
Front Filon colored	●	●	●
Rear Filon colored	●	●	●
Slide wall color	●	●	●

INTERIOR FEATURES

Residential style furniture with high grade fabric	●	●	●
Convenience center with slide, lights, awning, water system controls, and 110V receptacle	●	●	●
13.5 BTU ducted A/C	●	●	●
Forced air furnace	●	●	●
Ducted in floor heating	●	●	●
6 gallon gas/electric DSI water heater	●	●	●
Water system winterization ready	●	●	●
Residential durable Beauflor® linoleum	●	●	●
Digital TV system	●	●	●
12 volt DVD/CD/AM/FM stereo with aux input and quality sound speakers	●	●	●

INTERIOR FEATURES CONT.

LCD flat screen HD TV	●	●	●
2 tone wood accents	●	●	●
Residential light fixtures in slide room	●	●	●
King u-shaped dinette	●	●	●
Radius walls	●	●	●
4-panel shaker style interior doors	●	●	●
Upgraded furniture (hide-a-bed)	●	●	●
High-end window treatments (wood valence leather accent)	●	●	●
Residential style entertainment center	●	●	●
Wood mini blinds	●	●	●
Optional free-standing dinette and chairs	●	●	●

KITCHEN

Extra large double door refrigerator	●	●	●
Oversized 60/40 residential sink	●	●	●
Metal high-rise faucet	●	●	●
Microwave with carousel	●	●	●
3-burner high output range	●	●	●
Range hood	●	●	●
Residential hardwood cabinet doors	●	●	●
Coordinated wall paper border	●	●	●
Gas Oven	●	●	●
Solid surface countertop	●	●	●
Stainless steel sink	●	●	●
Stainless steel appliances	●	●	●
Wood panel refrigerator cabinets instead of wall board (side of cabinet)	●	●	●
Pendant lighting above kitchen countertops	●	●	●

BATHROOM

Solid wood custom built medicine cabinet with mirror	●	●	●
Tub surround with built-in shelves	●	●	●
Radius shower curtain	●	●	●
Pedestal foot flush toilet	●	●	●
Skylight over tub (most floorplans)	●	●	●
12 volt power exhaust fan	●	●	●

BEDROOM MAIN

60"x80" Queen Size Mattress	●	●	●
Quilted bedspread	●	●	●
Oversized wardrobes	●	●	●
Nighttime reading lights	●	●	●
Upgraded quilted bed spread	●	●	●
Throw pillows	●	●	●

SAFETY PACKAGE

4 wheel electric brakes	●	●	●
Break-away switch	●	●	●
Heavy duty safety chains with clasp	●	●	●
Tinted safety glass windows	●	●	●
Multiple emergency egress windows	●	●	●
GFI recepticals	●	●	●
Carbon monoxide detector	●	●	●
Smoke alarm	●	●	●
Fire extinguisher	●	●	●
Propane gas leak detector	●	●	●
Dead-bolt lock on entrance doors	●	●	●
Manual override on slide system	●	●	●
Spare tire kit	●	●	●

STANDARDS AND OPTIONS

EXPRESS
GT
ELITE

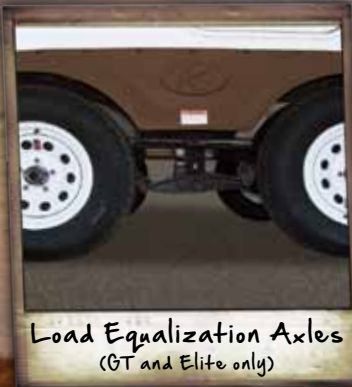

Load Equalization Axles
(GT and Elite only)



Lighted Pass-Thru
Storage



Wood Mini Blinds
(Elite only)



Deep Sink with
High-Rise Faucet
(Elite-Stainless Steel)



- | | | |
|--|-------------------------------------|--------------------------------------|
| 1 Gel Coated Filon Exterior | 10 Aluminum Floor Studs | 20 Diamond Plate |
| 2 Luan Layer | 11 3rd Layer Floor Decking | 21 Dual Battery Tray |
| 3 Hi-Density Block Foam Insulation | 12 Moisture Barrier Wrap | 22 Sloped Slide Roof |
| 4 Interior Wallboard | 13 Enclosed Underbelly (GT & Elite) | 23 Wiper Seals |
| 5 Total Aluminum Frame | 14 PACO I-Beam Frame | 24 Bulb Seal in T-Track |
| 6 Residential Grade Linoleum | 15 One Piece Rubber Roof | 25 Aerodynamic Front Wall |
| 7 1st Layer Floor Decking | 16 Roof Decking | 26 Easy Lube Axles |
| 8 2nd Layer Floor Decking with Staggered Seams | 17 R-11 Insulation | 27 Load Equalization Axles (GT only) |
| 9 Hi-Density Block Foam Insulation | 18 5" Crowned/Stamped Roof Trusses | 28 Radial Tires |
| | 19 Hurricane Straps | 29 Radius Entry Steps |

Folding Entry Assist Handle
(GT and Elite)



Stabilizer Jacks



Foot Flush Toilet



Easy Open
LP Tank Cover



Solid Surface
Countertops
(Elite only)



Outside Speakers
and Power Awning

Passport ULTRA LITE

by Keystone

195RBWE

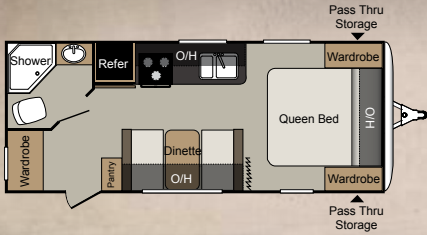

234QBWE

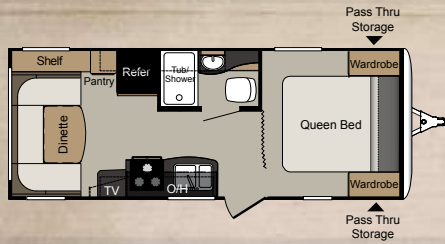

238MLWE

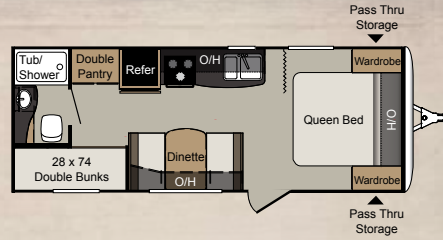

2100RBWE

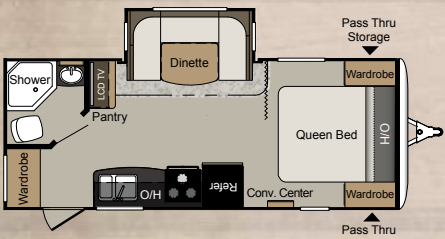

2300BWE

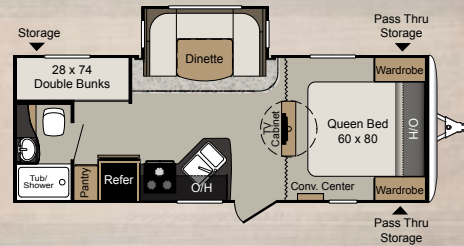

2510RBWE

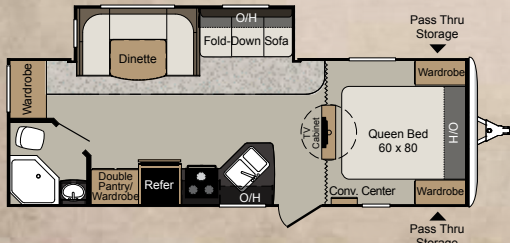

2650BWE

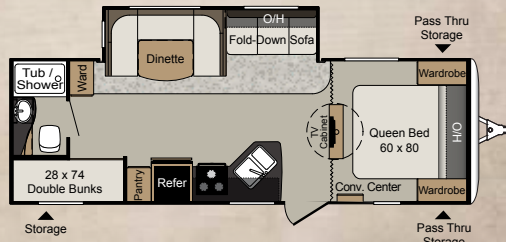

2810BWE

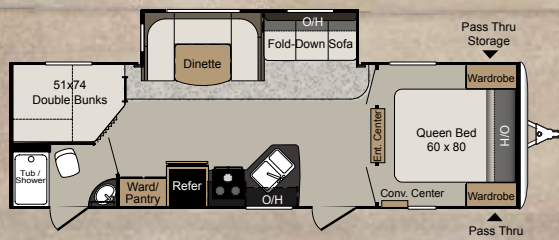

2890RLWE

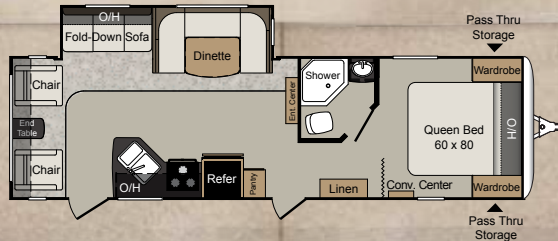

2920BWE

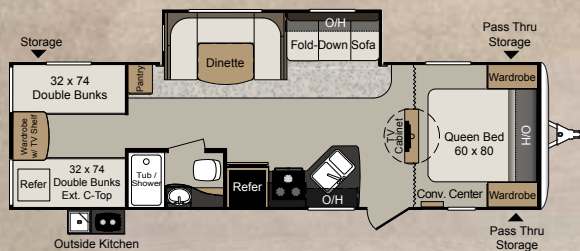

3220BWE



WEST COAST

Floorplan	Shipping Weight	Carrying Capacity	Hitch	Length	Height	Fresh Water	Waste Water	Gray Water	LPG	AWNING
195RBWE	3792	2138	260	24' 5"	10' 1"	43	30	30	40	14'
234QBWE	4020	2380	420	25' 4"	10' 1"	43	30	30	40	15'
238MLWE	3923	1477	410	25' 6"	10' 2"	43	30	30	40	15'
2100RBWE	4320	2180	530	24' 10"	10' 7"	43	30	30	40	15'
2300BWE	4441	2359	490	26' 6"	10' 7"	43	30	30	40	15'
2510RBWE	4815	2185	510	28' 10"	10' 7"	43	30	30	40	19'
2650BWE	4938	2262	470	29' 4"	10' 7"	43	30	30	40	15'
2810BWE	5190	2010	550	31' 10"	10' 7"	43	30	30	40	19'
2890RLWE	5498	1702	610	32' 9"	10' 7"	43	30	60	40	19'
2920BWE	5640	1560	660	32' 10"	10' 9"	43	30	30	40	15'
3220BWE	6210	1290	580	35' 5"	10' 9"	43	30	30	40	15' & 10'

WEST COAST FLOORPLANS

SPECIFICATIONS

EXPRESS SL FLOORPLANS

ELITE FLOORPLANS

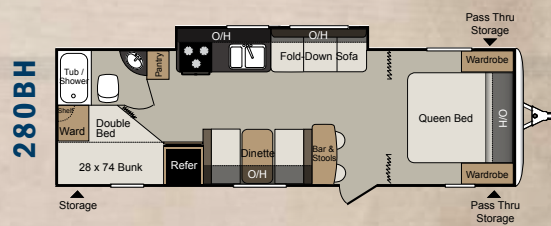
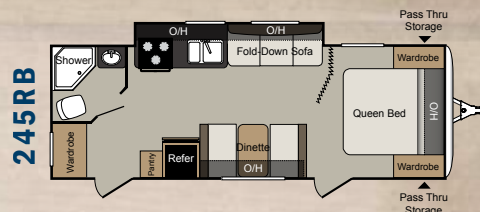
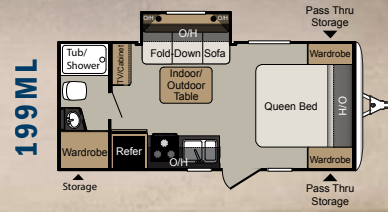
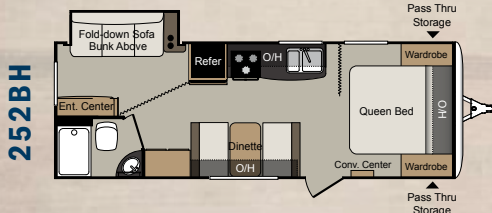
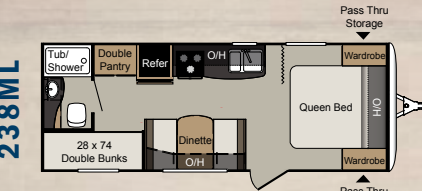
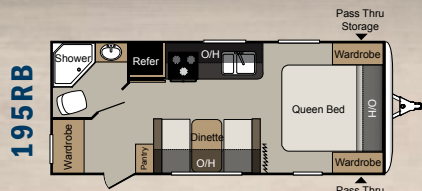

	Floorplan	Shipping Weight	Carrying Capacity	Hitch	Length	Height	Fresh Water	Waste Water	Gray Water	LPG	AWNING
EXPRESS SL	195RB	3651	1549	350	23' 4"	10' 1"	30	30	30	40	15'
	199ML	3505	1695	335	21' 9"	10' 1"	30	30	30	40	10'
	238ML	3711	1689	495	24' 11"	10' 2"	30	30	30	40	15'
	245RB	4242	1758	460	26' 9"	10' 2"	30	30	30	40	17'
	252BH	4269	1731	450	26' 9"	10' 2"	30	30	30	40	17'
	280BH	4590	1410	485	30' 1"	10' 2"	30	30	30	40	17'

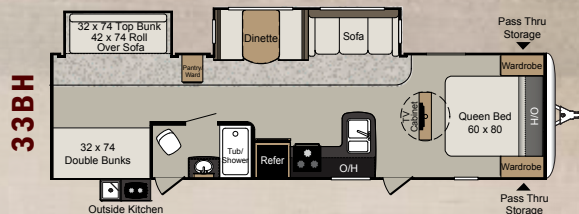
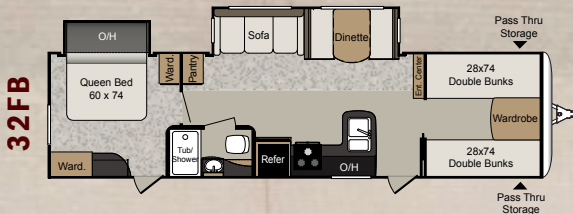
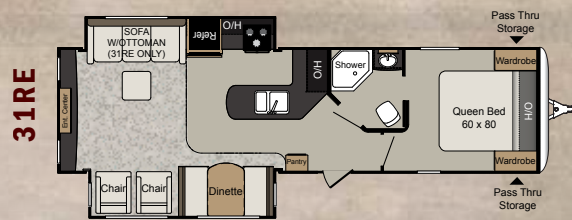
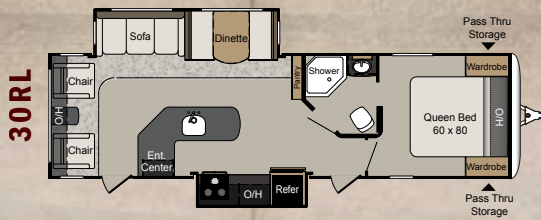
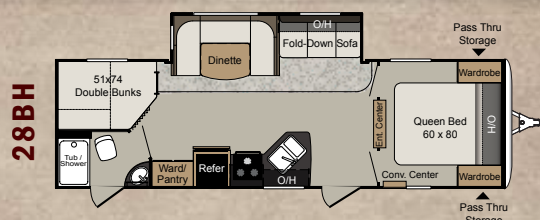
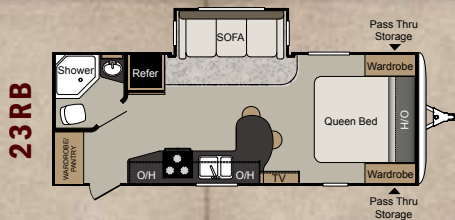

	Floorplan	Shipping Weight	Carrying Capacity	Hitch	Length	Height	Fresh Water	Waste Water	Gray Water	LPG	AWNING
ELITE	23RB	4560	2240	500	25' 11"	10' 9"	30	30	30	40	15'
	28BH	5505	1995	610	31' 10"	10' 9"	30	30	30	40	15'
	30RL	6170	1630	660	33' 8"	10' 8"	30	30	60	40	19'
	31RE	6307	1693	690	34' 8"	10' 9"	30	30	30	40	12'
	32FB	6418	1782	885	35' 4"	10' 9"	30	30	30	40	19'
	33BH	6450	1750	780	35' 4"	10' 9"	30	30	30	40	15'



OPTIONAL FREE-STANDING DINETTE AND CHAIRS (ELITE ONLY)

Passport ULTRA LITE

by Keystone

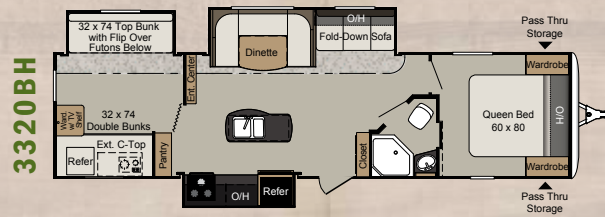
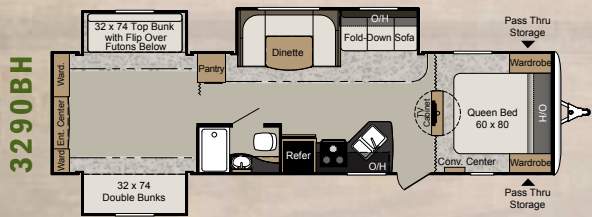
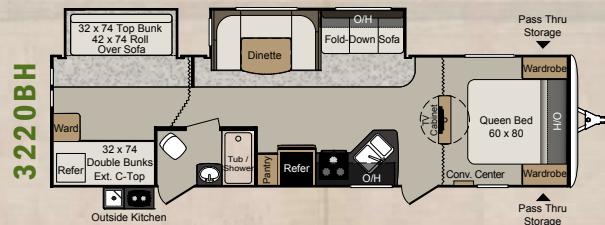
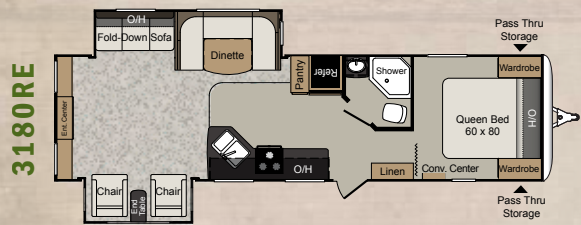
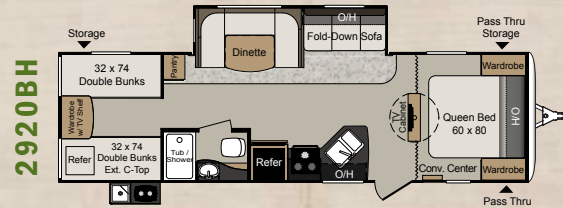
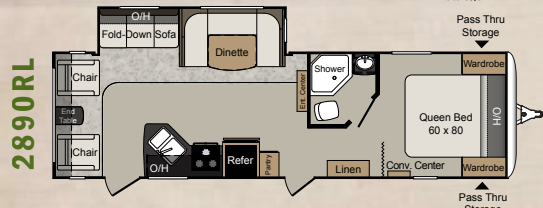
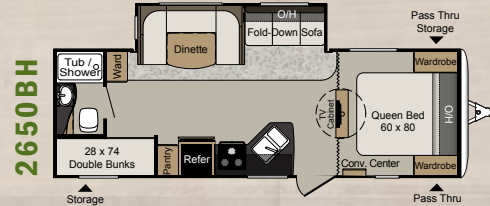
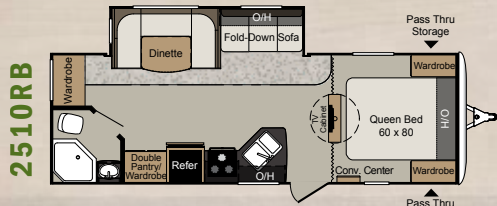
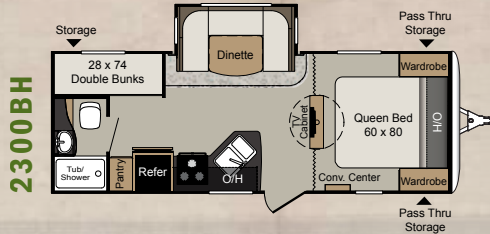
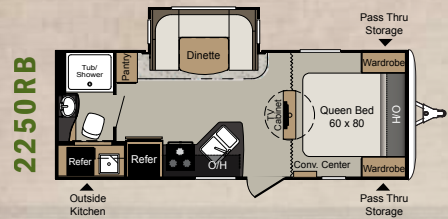
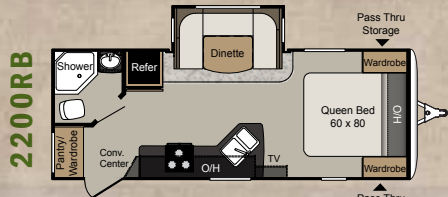

	Floorplan	Shipping Weight	Carrying Capacity	Hitch	Length	Height	Fresh Water	Waste Water	Gray Water	LPG	AWNING
GRAND TOURING	2200RB	4265	2235	420	25' 10"	10' 7"	30	30	30	40	15'
	2250RB	TBD	TBD	TBD	25' 10"	10' 7"	30	30	30	40	12'
	2300BH	4390	2410	460	26' 6"	10' 7"	30	30	30	40	15'
	2510RB	4795	2205	495	28' 10"	10' 7"	30	30	30	40	19'
	2650BH	4819	2381	540	29' 4"	10' 7"	30	30	30	40	19'
	2890RL	5390	1810	590	32' 9"	10' 9"	30	30	60	40	19'
	2920BH	5385	1815	625	32' 10"	10' 9"	30	30	30	40	15'
	3180RE	5897	1603	720	34' 11"	10' 9"	30	30	30	40	15'
	3220BH	6040	1460	600	35' 5"	10' 9"	30	30	30	40	15' & 10'
	3290BH	6285	1715	830	36' 8"	10' 11"	30	30	30	40	15'
	3320BH	6615	1385	615	36' 10"	10' 11"	30	30	60	40	19'

GRAND TOURING FLOORPLANS

DECOR OPTIONS



Parsley



Bayside



Rattan



GO ANYWHERE | WWW.KEYSTONERV.COM/PASSPORT

YOUR LOCAL DEALER IS:



September 2013

Product information is as accurate as possible at the date of publication of this brochure. Features, floor plans, and specifications are subject to change without notice. Please also consult Keystone's web site at keystonerv.com for more current product information and specifications. Tow Vehicle Disclaimer. CAUTION: Owners of Keystone recreational vehicles are solely responsible for the selection and proper use of tow vehicles. All customers should consult with a motor vehicle manufacturer or their dealer concerning the purchase and use of suitable tow vehicles for Keystone products. Keystone disclaims any liability or damages suffered as a result of the selection, operation, use or misuse of a tow vehicle. KEYSTONE'S LIMITED WARRANTY DOES NOT COVER DAMAGE TO THE RECREATIONAL VEHICLE OR THE TOW VEHICLE AS A RESULT OF THE SELECTION, OPERATION, USE OR MISUSE OF THE TOW VEHICLE. 9/2013



2642 Hackberry Drive | PO Box 2000
Goshen, IN 46527-2000
(574) 535-2100



Keystone RV Company

www.keystonerv.com

LEARN MORE



Download the free Tag app at <http://gettag.mobi> and scan this Tag.