

# TRANSCEND™



**QUALITY DRIVEN. CUSTOMER FOCUSED. BUILT TO LAST.**



**GRAND DESIGN**  
RECREATIONAL VEHICLES

# TRANSCEND™

**TRANSCEND™**  
**XPLÖR**

**TRANSCEND™**  
**ONE**

Choosing a Transcend travel trailer means embracing a journey with a brand committed to quality, innovation, and value. Our lineup features three distinct series, each designed to cater to your unique travel needs. The Transcend One is our single-axle, entry-level base model, perfect for those new to RVing who seek simplicity and reliability. Stepping up, the Transcend Xplor offers an evolution of the original Xplor, providing enhanced features and rugged capabilities for the adventurous spirit. At the pinnacle, the Transcend series represents our premium segment, delivering luxurious amenities and spacious interiors. By choosing Transcend, you're investing in a travel trailer that guarantees dependability, cutting-edge design, and exceptional value, ensuring every trip is packed with unforgettable experiences and lasting memories.

## TOP FEATURES



### Interior/Exterior Table

*Entertain both indoors or outdoors*



### Exterior Quad Seal Technology

*Reliable, convenient power*



### Interior & Exterior Magnetic Door Catches

*Ensure doors stay securely closed*



### Built-In Paper Towel Holder

*Make clean-up a breeze*



### Heated & Enclosed Underbelly w/ Direct Ducting

*Stay warm and protected in any weather*



### Pet Friendly

*Enjoyable travel for both you and your furry companions*



### Industry Leading Solar Connectivity w/ Inverter Prep

*Enjoy off-grid adventures with sustainable energy*



### Minimum 60x80 Residential Queen Bed

*(King Available on some Transcend floorplans)*

*Sleep like royalty*

## PROUD PARTNERS



### TIRE AND WHEEL BALANCING

*Improve fuel efficiency  
and reduce tire wear*



### JBL SPEAKER SYSTEM

*Crystal-clear audio  
and powerful bass*



### GOPOWER!® SOLAR PACKAGE

*Enjoy off-grid  
adventures with  
sustainable energy*



### FURRION APPLIANCE PACKAGE

*Sleek design meets top-  
notch performance*

# TRANSCEND™ ONE

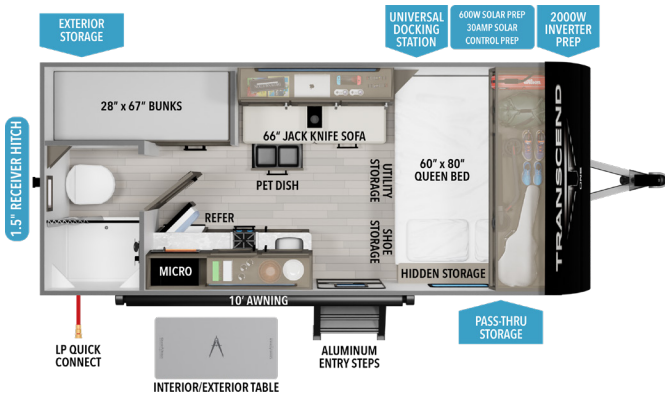

151BH

UVW<sup>1</sup> 3,550 HITCH<sup>1</sup> 490 LENGTH<sup>2</sup> 19' 8" HEIGHT 10' 3" CAPACITY 37 37 37

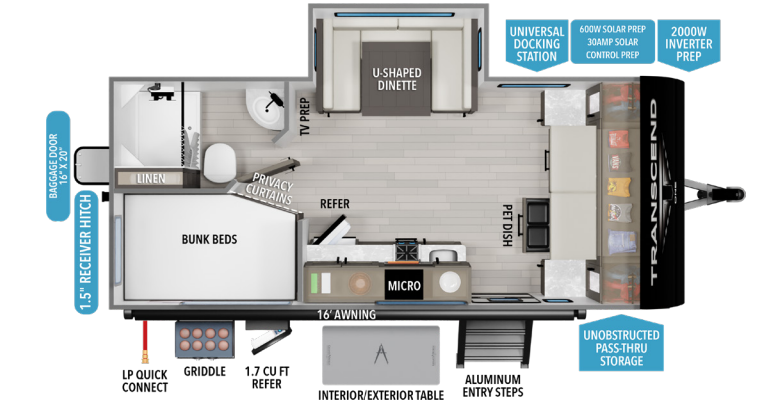

161BH

UVW<sup>1</sup> 4,784 HITCH<sup>1</sup> 524 LENGTH<sup>2</sup> 23' HEIGHT 10' 6" CAPACITY 37 74 37

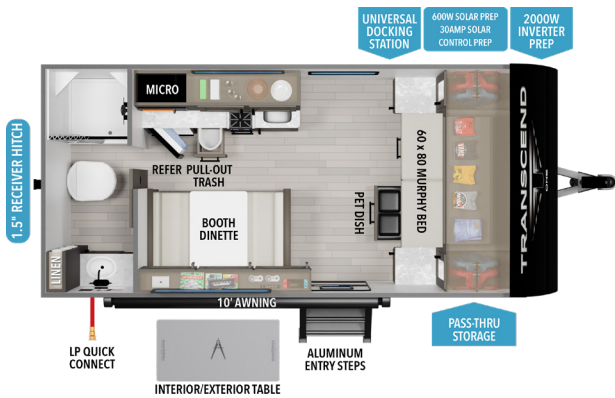

151RB

UVW<sup>1</sup> 3,600 HITCH<sup>1</sup> 490 LENGTH<sup>2</sup> 19' 8" HEIGHT 10' 3" CAPACITY 37 37 37

171RB

SPECS COMING SOON



**FOR MORE INFORMATION**  
SCAN THE QR CODE USING YOUR  
MOBILE PHONE CAMERA APP



<sup>1</sup> Based on average weight of the standard build. <sup>2</sup> Hitch to rear

Because of our commitment to continuous product improvement, Grand Design Recreational Vehicles reserves the right to change components, standards, options, specifications, and materials without notice and at any time. Photos may show optional equipment which may not be included in the standard purchase price of the featured unit. Be sure to review current product details with your local dealer before purchasing.

# TRANSCEND™ XPLÖR

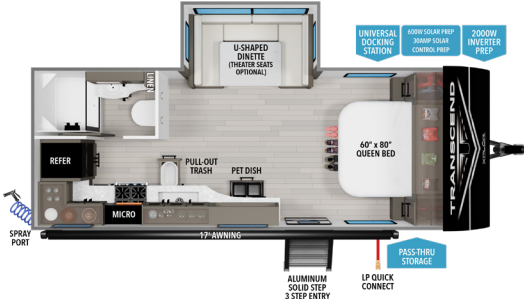

**20MKX**      UVW'<sup>1</sup>    HITCH'<sup>1</sup>    LENGTH'<sup>2</sup>    HEIGHT    CAPACITY  
**5,397**    **517**      **24' 11"**    **11'**      **56 39 39**

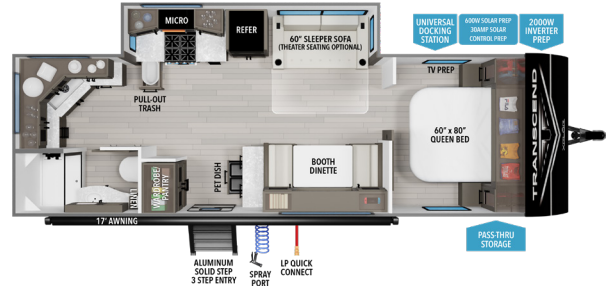

**25MLX**      UVW'<sup>1</sup>    HITCH'<sup>1</sup>    LENGTH'<sup>2</sup>    HEIGHT    CAPACITY  
**6,335**    **630**      **29' 9"**    **11'**      **56 57 39**

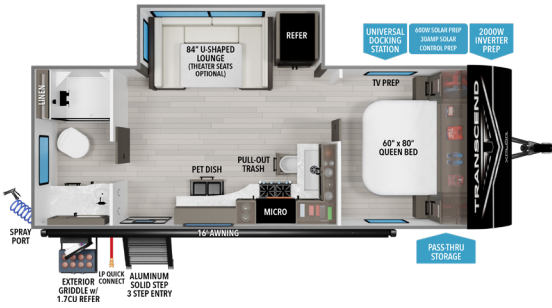

**22RBX**      UVW'<sup>1</sup>    HITCH'<sup>1</sup>    LENGTH'<sup>2</sup>    HEIGHT    CAPACITY  
**5,749**    **573**      **26' 10"**    **11'**      **56 68 39**

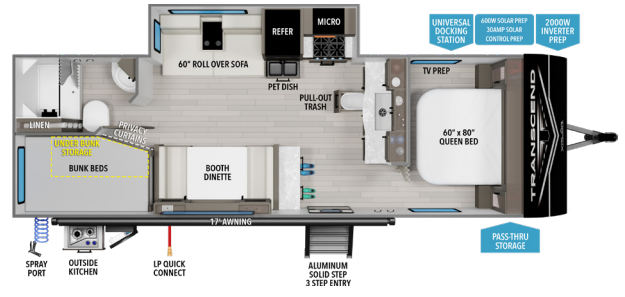

**26BHX**      UVW'<sup>1</sup>    HITCH'<sup>1</sup>    LENGTH'<sup>2</sup>    HEIGHT    CAPACITY  
**6,505**    **635**      **30' 11"**    **11'**      **56 78 39**

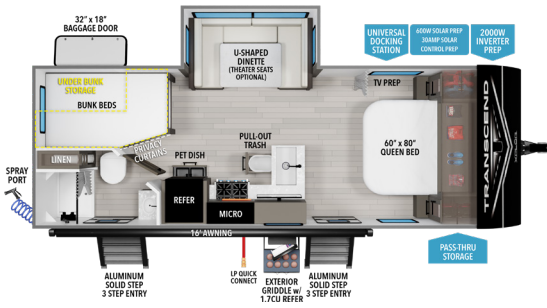

**23BHX**      UVW'<sup>1</sup>    HITCH'<sup>1</sup>    LENGTH'<sup>2</sup>    HEIGHT    CAPACITY  
**TBD**      **TBD**      **26' 11"**    **11'**      **56 78 39**

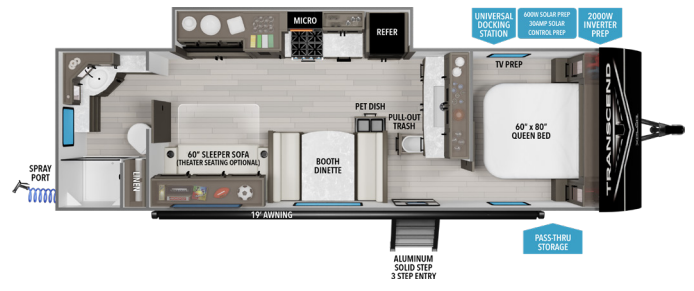

**26RBX**      UVW'<sup>1</sup>    HITCH'<sup>1</sup>    LENGTH'<sup>2</sup>    HEIGHT    CAPACITY  
**TBD**      **TBD**      **31' 6"**    **11'**      **56 78 39**

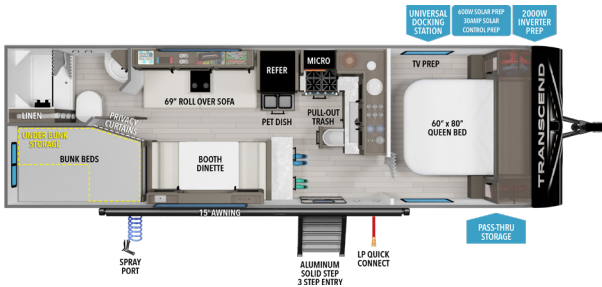

**24BHX**      UVW'<sup>1</sup>    HITCH'<sup>1</sup>    LENGTH'<sup>2</sup>    HEIGHT    CAPACITY  
**5,756**    **583**      **29' 11"**    **11'**      **56 78 39**

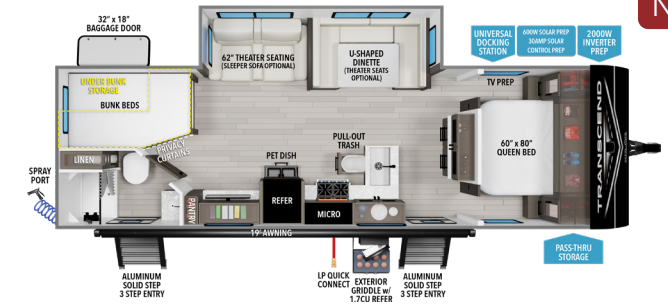

**27DBX**      UVW'<sup>1</sup>    HITCH'<sup>1</sup>    LENGTH'<sup>2</sup>    HEIGHT    CAPACITY  
**TBD**      **TBD**      **26' 11"**    **11'**      **56 78 39**

**NEW**



**FOR MORE INFORMATION  
 SCAN THE QR CODE USING YOUR  
 MOBILE PHONE CAMERA APP**



<sup>1</sup> Based on average weight of the standard build. <sup>2</sup> Hitch to rear

# TRANSCEND™

**NEW**

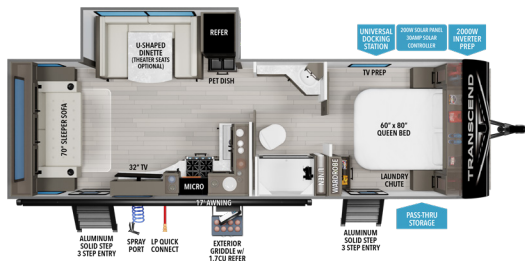

**245RLT**      UVW'<sup>1</sup> **6,456**    HITCH'<sup>2</sup> **668**    LENGTH'<sup>2</sup> **30' 8"**    HEIGHT **11'**    CAPACITY **56 78 39**



**315RKT**      UVW'<sup>1</sup> **8,400**    HITCH'<sup>2</sup> **1,070**    LENGTH'<sup>2</sup> **36' 9"**    HEIGHT **11'**    CAPACITY **56 117 39**

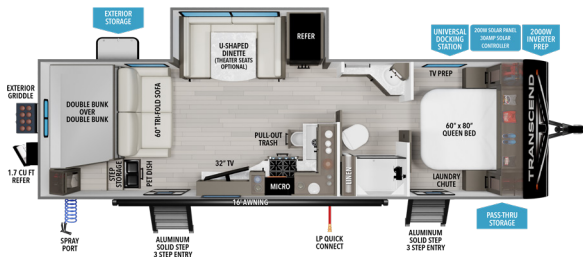

**265BHT**      UVW'<sup>1</sup> **6,327**    HITCH'<sup>2</sup> **658**    LENGTH'<sup>2</sup> **32' 9"**    HEIGHT **11'**    CAPACITY **56 78 39**

**NEW**



**325BHT**      SPECS COMING SOON



**285RKT**      SPECS COMING SOON

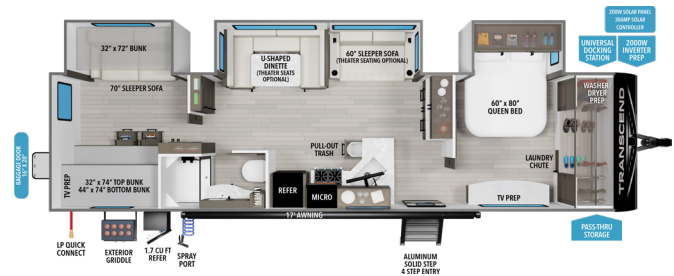

**335BHT**      UVW'<sup>1</sup> **9,400**    HITCH'<sup>2</sup> **1,046**    LENGTH'<sup>2</sup> **37' 3"**    HEIGHT **11' 4"**    CAPACITY **56 117 39**

**NEW**

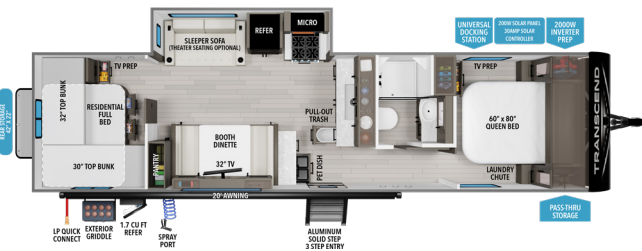

**295QBT**      UVW'<sup>1</sup> **7,383**    HITCH'<sup>2</sup> **803**    LENGTH'<sup>2</sup> **35' 11"**    HEIGHT **11'**    CAPACITY **56 78 39**



**335DQT**      SPECS COMING SOON

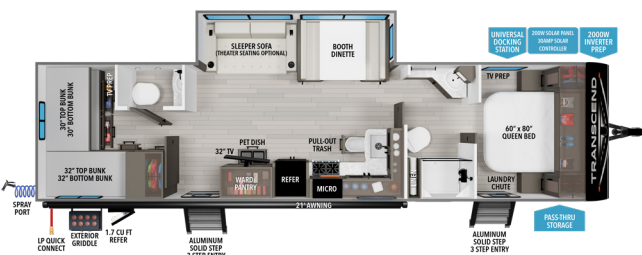

**305BHT**      UVW'<sup>1</sup> **7,735**    HITCH'<sup>2</sup> **776**    LENGTH'<sup>2</sup> **36' 11"**    HEIGHT **11'**    CAPACITY **56 78 78**



**FOR MORE INFORMATION**  
SCAN THE QR CODE USING YOUR  
MOBILE PHONE CAMERA APP



<sup>1</sup> Based on average weight of the standard build. <sup>2</sup> Hitch to rear

Because of our commitment to continuous product improvement, Grand Design Recreational Vehicles reserves the right to change components, standards, options, specifications, and materials without notice and at any time. Photos may show optional equipment which may not be included in the standard purchase price of the featured unit. Be sure to review current product details with your local dealer before purchasing.

# GRAND DESIGN™

RECREATIONAL VEHICLES

You'll find that your experience with GDRV is different.

With quality at the foundation of everything we do, we do more. We pay attention to detail, we focus more on our customers, we perform more rigorous inspections, we have better coverage with our warranties and we hire more experienced craftsmen.

When it comes down to it, we do more of what matters so that you can have the experience of a lifetime, every time.

Go beyond just camping. Have an adventure. Take that trip of a lifetime. We'll be there with you every step of the way.

**MORE OF WHAT MATTERS**



## QUALITY

Quality checkpoints during manufacturing

Final finish inspection

Pre-Delivery Inspection (PDI) area where all coaches are put through a rigorous 300+ point inspection checklist before shipping to a dealer

## SERVICE

State of the art service center

A Service Response Team (SRT) in the field

Expansive dealer network

The best warranty coverage in the industry



## COMMUNITY

38 Rallies a year across the US and Canada. Each rally has opportunities to volunteer in the community, learn at seminars, have work done on your coach and have fun with the GDRV family!

**TO SCHEDULE A FACTORY TOUR VISIT OUR WEBSITE!**

REV 11.18.24

[www.GrandDesignRV.com](http://www.GrandDesignRV.com)