

# SOLITUDE

GRAND DESIGN  
RECREATIONAL VEHICLES

*Extended Stay • Extended Space • Extended Lifestyle*



2013 / 2014

*Welcome to a brand new era in extended-stay living!*

GRAND DESIGN  
RECREATIONAL VEHICLES





# SOLITUDE

GRAND DESIGN  
RECREATIONAL VEHICLES

*Affordable Luxury Fifth Wheel*

*Extended Stay Approved!™*



If more room is what you desire, Solitude is the most spacious Extended Stay Fifth Wheel ever built! Solitude delivers taller ceilings, deeper cabinets, larger scenic window areas, a full 6' 8" tall slide-out and an exterior width that measures a full 101 inches! You may be looking for an extended stay fifth wheel to live in for months at a time... but you may want to live in this one for the rest of your life!







TALLER

369RL



Awesome Entertainment Center!  
 369RL  
 LED HD TV, AM, FM Stereo,  
 DVD, Bluetooth, fireplace  
 and Slide out computer desk!

Now this is Living!!!



We just LOVE elegant touches like this free-standing bathroom sink!



Multi-Room and Master Bedroom Thermostat



It's the fine details that separate luxury from the status quo. We go out of our way to appoint our Solitude with amenities that make you feel safe, secure and pampered... more like home. But this isn't just a "home away from home" this IS home!





# The Grand Theatre™

379FL

There is nothing like the 379FL's groundbreaking new Grand Theatre™. Two hide-a-bed sofas transform this spacious living room into the ultimate bunking area!



**DURA-CLEAN  
STEPS**  
**ULTRA DURABLE!**  
**EASY TO CLEAN!**

379FL



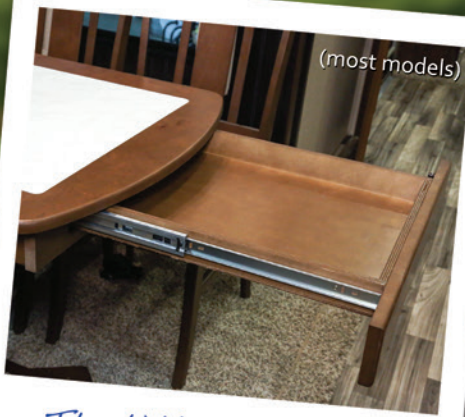

(most models)

The hidden dining table drawer - very useful!



Tread Lite Aluminum steps: Ultra lightweight, super sturdy, won't rust!



(most models)

Our Rota-Flex pin box is so easy to use!



AM, FM, DVD, Bluetooth & Multiple Speaker Selections!



369RL

Stainless steel appliances bring the kitchen to life!



369RL

Cooking with class is the name of the game in this kitchen!



369RL



18 cu. Gas/Electric Residential-Size Refrigerator! (Optional)

369RL





368RD

Grand Design's Solitude line of Fifth Wheels offer huge countertop space and residential-size pantry storage.



Optional Dinette

368RD









Our new 375RE provides a generous, wide-open space to entertain, converse, relax and rest. The addition of a sliding glass patio door truly opens the space up and provides plenty of warm, natural lighting.







379FL

Our Master Suite's are gorgeous and spacious. They feature roomy closets, mirrored sliding doors and are prepped for a washer and dryer.



The under-bed storage compartment is completely finished inside and contains a jewelry tray plus a base-mounted lock box. The retractable ottoman is the perfect height to sit and comfortably dress.



\*320X Bath configured differently (See P.9)



The Solitude Storage Bays and Utility Center are well lit and easily to access via our unique split cargo door system. This is the "cleanest" exterior storage bay in the industry.

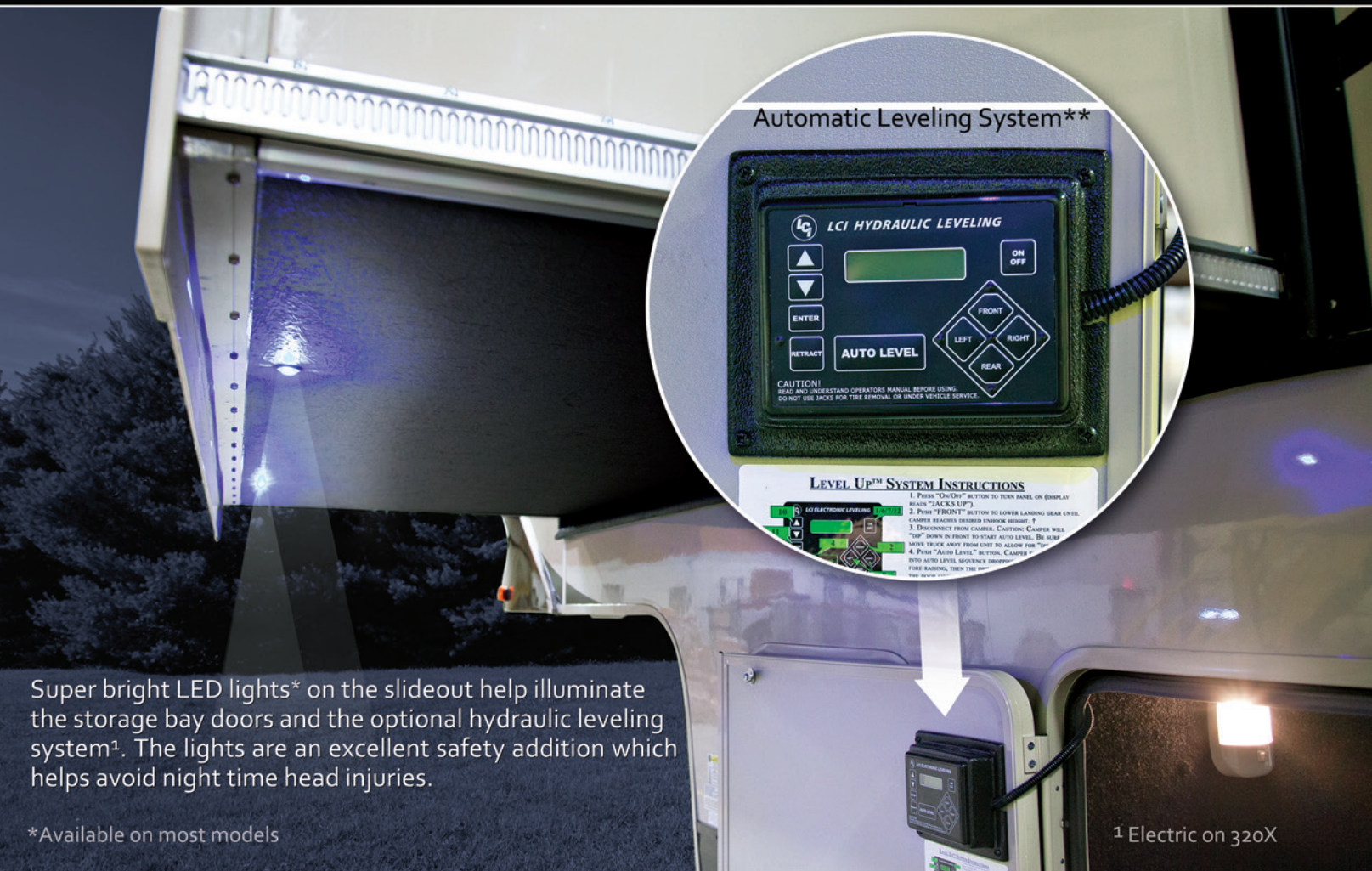

### Automatic Leveling System\*\*



#### LEVEL UP™ SYSTEM INSTRUCTIONS

1. Press "On/Off" button to turn panel on (display reads "JACKS UP").
2. Push "FRONT" button to lower landing gear until camper reaches desired unhook height.
3. Disconnect from chocks. Caution: Camper will "tip" down in front to seat auto level. Be sure to move chocks away from unit to allow for "tip".
4. Push "Auto Level" button. Camper's auto level sequence (display shows "LEVELING") will begin. When the "level" message appears, the leveling is complete.

Super bright LED lights\* on the slideout help illuminate the storage bay doors and the optional hydraulic leveling system<sup>1</sup>. The lights are an excellent safety addition which helps avoid night time head injuries.

\*Available on most models

<sup>1</sup> Electric on 320X



# FIFTH WHEELS

305RE

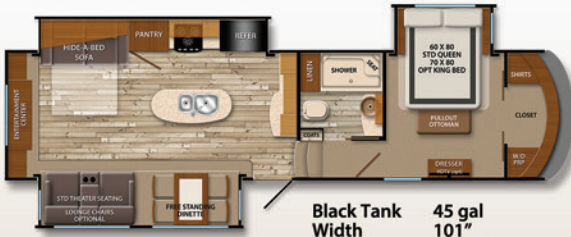

**GVWR\*** 16,000 lbs.  
**Dry Weight** 12,200 lbs. \*\*  
**Hitch Weight** 2,500 lbs. \*\*  
**Axle Rating** 7,000 lbs. (x2)  
**Fresh Tank** 54 gal.  
**Gray Tank** 90 gal.

**Black Tank** 45 gal  
**Width** 101"  
**Height** 12' 11" \*\*\*  
**Length** 35' 11" \*\*\*\*  
**Water Heater** 12 gal.  
**Furnace** 35k BTU  
**A/C (main)** 15k BTU



375RE

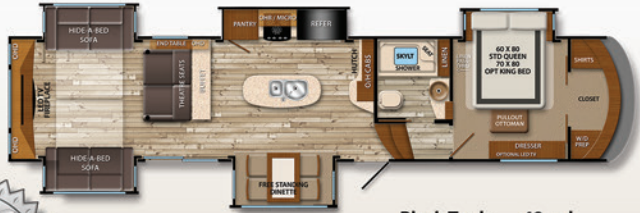

**GVWR\*** 16,000 lbs.  
**Dry Weight** 13,600 lbs. \*\*  
**Hitch Weight** 2,924 lbs. \*\*  
**Axle Rating** 7,000 lbs. (x2)  
**Fresh Tank** 54 gal.  
**Gray Tank** 101 gal.

**Black Tank** 49 gal  
**Width** 101"  
**Height** 12' 11" \*\*\*  
**Length** 42' 6" \*\*\*\*  
**Water Heater** 12 gal.  
**Furnace** 35k BTU  
**A/C (main)** 15k BTU

365DEN



**GVWR\*** 16,000 lbs.  
**Dry Weight** 14,200 lbs. \*\*  
**Hitch Weight** 3,252 lbs. \*\*  
**Axle Rating** 7,000 lbs. (x2)  
**Fresh Tank** 54 gal.  
**Gray Tank** 75 gal.

**Black Tank** 78 gal  
**Width** 101"  
**Height** 12' 9" \*\*\*  
**Length** 41' 6" \*\*\*\*  
**Water Heater** 12 gal.  
**Furnace** 35k BTU  
**A/C (main)** 15k BTU

379FL

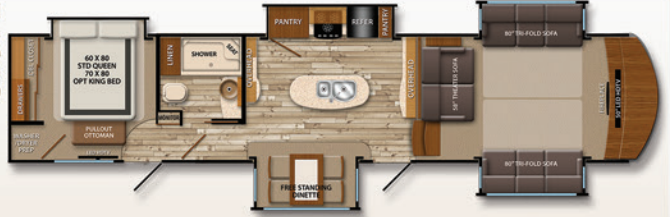

**GVWR\*** 16000 lbs.  
**Dry Weight** 13,800 lbs. \*\*  
**Hitch Weight** 3,000 lbs. \*\*  
**Axle Rating** 7,000 lbs. (ea.)  
**Fresh Tank** 54 gal.  
**Gray Tank** 90 gal.  
**Black Tank** 45 gal

**Width** 101"  
**Height** 12' 11" \*\*\*  
**Length** 42' 6" \*\*\*\*  
**Water Heater** 12 gal.  
**Furnace** 35k BTU  
**A/C (main)** 15k BTU



366DEN

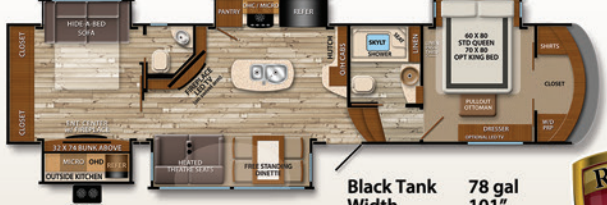

**GVWR\*** 16,000 lbs.  
**Dry Weight** 14,250 lbs. \*\*  
**Hitch Weight** 3,178 lbs. \*\*  
**Axle Rating** 7,000 lbs. (x2)  
**Fresh Tank** 54 gal.  
**Gray Tank** 75 gal.

**Black Tank** 78 gal  
**Width** 101"  
**Height** 12' 9" \*\*\*  
**Length** 41' 6" \*\*\*\*  
**Water Heater** 12 gal.  
**Furnace** 35k BTU  
**A/C (main)** 15k BTU



368RD

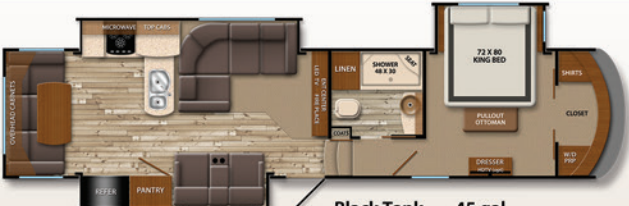

**GVWR\*** 16,000 lbs.  
**Dry Weight** 12,500 lbs. \*\*  
**Hitch Weight** 2,600 lbs. \*\*  
**Axle Rating** 7,000 lbs. (x2)  
**Fresh Tank** 54 gal.  
**Gray Tank** 90 gal.

**Black Tank** 45 gal  
**Width** 101"  
**Height** 12' 11" \*\*\*  
**Length** 38' 11" \*\*\*\*  
**Water Heater** 12 gal.  
**Furnace** 35k BTU  
**A/C (main)** 15k BTU

369RL



**GVWR\*** 16,000 lbs.  
**Dry Weight** 12,650 lbs. \*\*  
**Hitch Weight** 2,600 lbs. \*\*  
**Axle Rating** 7,000 lbs. (x2)  
**Fresh Tank** 54 gal.

**Gray Tank** 90 gal  
**Black Tank** 45 gal  
**Width** 101"  
**Height** 12' 11" \*\*\*  
**Length** 38' 11" \*\*\*\*  
**Water Heater** 12 gal.  
**Furnace** 35k BTU  
**A/C (main)** 15k BTU



## INTERIOR/EXTERIOR OPTIONS

### INTERIOR / APPLIANCE

- 12' / 18' Side-By-Side Refrigerator Upgd.
- Bedroom TV
- Swivel Recliners IPO Theatre Seats
- Heat Pump A/C
- Bedroom A/C
- Convection Microwave
- King Bed Upgrade (All Models)
- Free Standing Dinette (368RD Only)
- Tri-Fold Hide-a-Bed (All Models)
- Bedroom Fantastic Fan

### EXTERIOR

- 12v Tank Heaters
- Automatic Leveling System
- Generator Prep
- Slide-Out Awnings (3-Slide)
- Slide-Out Awnings (5-Slide)
- Dual Pane Windows
- Goodyear Tire Upgrade



# X-SERIES

**320X**

<b>GVWR*</b>	15,000 lbs.	<b>Black Tank</b>	45 gal
<b>Dry Weight</b>	11,580 lbs. **	<b>Width</b>	101"
<b>Hitch Weight</b>	2,480 lbs. **	<b>Height</b>	12' 11" ***
<b>Axle Rating</b>	6,000 lbs. (x2)	<b>Length</b>	34' 9" ****
<b>Fresh Tank</b>	54 gal.	<b>Water Heater</b>	12 gal.
<b>Gray Tank</b>	50 gal.	<b>Furnace</b>	35k BTU
		<b>A/C (main)</b>	15k BTU

**321X**

<b>GVWR*</b>	15,000 lbs.	<b>Black Tank</b>	45 gal
<b>Dry Weight</b>	11,450 lbs. **	<b>Width</b>	101"
<b>Hitch Weight</b>	2,500 lbs. **	<b>Height</b>	12' 11" ***
<b>Axle Rating</b>	6,000 lbs. (x2)	<b>Length</b>	34' 9" ****
<b>Fresh Tank</b>	54 gal.	<b>Water Heater</b>	12 gal.
<b>Gray Tank</b>	50 gal.	<b>Furnace</b>	35k BTU
		<b>A/C (main)</b>	15k BTU

**325X**

<b>GVWR*</b>	15,000 lbs.	<b>Black Tank</b>	45 gal
<b>Dry Weight</b>	11,700 lbs. **	<b>Width</b>	101"
<b>Hitch Weight</b>	2,480 lbs. **	<b>Height</b>	12' 11" ***
<b>Axle Rating</b>	6,000 lbs. (x2)	<b>Length</b>	35' 9" ****
<b>Fresh Tank</b>	54 gal.	<b>Water Heater</b>	12 gal.
<b>Gray Tank</b>	50 gal.	<b>Furnace</b>	35k BTU
		<b>A/C (main)</b>	15k BTU

**326X**

<b>GVWR*</b>	15,000 lbs.	<b>Black Tank</b>	45 gal
<b>Dry Weight</b>	11,700 lbs. **	<b>Width</b>	101"
<b>Hitch Weight</b>	2,480 lbs. **	<b>Height</b>	12' 11" ***
<b>Axle Rating</b>	6,000 lbs. (x2)	<b>Length</b>	35' 9" ****
<b>Fresh Tank</b>	54 gal.	<b>Water Heater</b>	12 gal.
<b>Gray Tank</b>	50 gal.	<b>Furnace</b>	35k BTU
		<b>A/C (main)</b>	15k BTU

## KEY FEATURES

### CONSTRUCTION STD. FEATURES

- High-Gloss Fiberglass Sidewalls
- Aluminum Frame Construction
- Under-Carriage Spare Tire
- Mega-Frame Chassis Platform w/ Over-Sized Storage Compartments
- Steel Slam-Latch Baggage Door Handles
- Kinro Frameless Windows
- No-Rust Alumina-Step Aluminum Entry Step
- 50 Amp Service w/ Detachable Power Cord
- 7,000 lb. Axles (6,000 on X-Series)
- Battery Disconnect
- Color-Matched Fender Skirt
- Heated and Enclosed Universal Travel Center w/ Winterizing Kit
- Trail-Air Roto-Flex Pin Box (NA on X-Series)
- Equa-Flex Suspension
- Correct Track Axle Alignment System
- LED Safety Light Package
- Powder Coated Heavy Duty Rear Ladder
- Painted Front Cap
- Sat/Cable Pre-Wire for all TV outlets
- 16" Aluminum Wheels w/ Radial Tires
- One Piece Seamless Rubber Roof
- Enclosed and Heated Basement w/ Heated Holding Tanks
- Heated Travel Center w/Whole- House Water Filtration System
- Upgraded Furnace w/ Dual-Zone Central Panel
- Heated Storage Compartments
- Thermal Technology Insulation
- R-40 Roof Insulation
- R-45 Floor Insulation
- R-11 Wall Insulation

### INTERIOR FEATURES

- Residential Everpedic Mattress
- Oversized 30" Residential Microwave
- Solid Surface Countertops
- Dometic Premium Air Conditioning (15k BTU living room)
- Hardwood Cabinet Doors / Hidden Hinges
- Theatre Style HD TV w/ AM/FM/DVD/ Player / Bluetooth Capability
- Oversized Kitchen Island w/ Built in Curio Cabinet
- Electric Fireplace w/ 5 BTU Heater & Remote Control
- LED Lighting
- Washer/Dryer Prep (all models)
- Smoke Detector/LP Alarm/Carbon Monoxide Alarm
- TV Prep in Bedroom



Our exclusive **Weather-Tek™** thermal shield system provides extreme comfort under extreme climate conditions.

Your Local Dealer is:

Because of our commitment to continuous product improvement, Grand Design Recreational Vehicles reserves the right to change components, standards, options, specifications, and materials without notice and at any time. Photos may show optional equipment which may not be included in the standard purchase price of the featured unit. Be sure to review current product details with your local dealer before purchasing.

\* Gross Vehicle Weight Rating \*\* Based on average \*\*\* Ground to top of front A/C \*\*\*\* Hitch to Rear

574-825-8000

www.GrandDesignRV.com

Grand Design RV

11333 County Road 2

Middlebury, IN 46540