

Jayco | Eagle HT Fifth Wheel

# EAGLE HT FW

ADVENTURES AROUND EVERY BEND



**2+3**  
YEAR | YEAR  
WARRANTY



# INTERIOR DESIGN



## AMERICAN CRAFTSMAN



Wood



Floor



Countertop

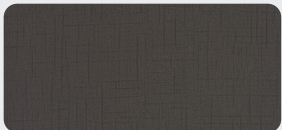

Main Fabric



Accent Fabric

## MODERN FARMHOUSE

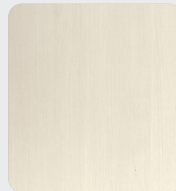

Wood



Floor



Countertop

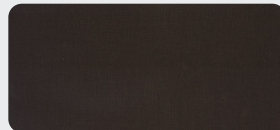

Main Fabric



Accent Fabric

**S** STORAGE  
**MICRO** MICROWAVE  
**OHC** OVERHEAD CABINETS  
**FRIDGE** REFRIGERATOR  
**WARD** WARDROBE

**24RE** OPTIONS: A, C, D, E, G, H

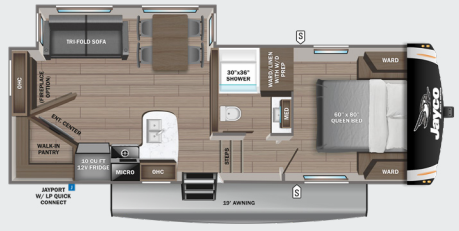

**26RU** OPTIONS: A, B, C, H

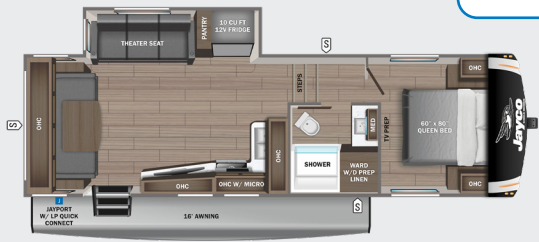

**27RL** OPTIONS: A, C, E, G, H

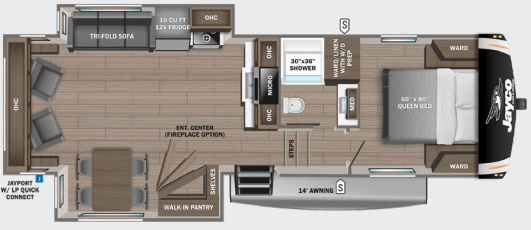

**27RS** OPTIONS: A, C, D, G, H

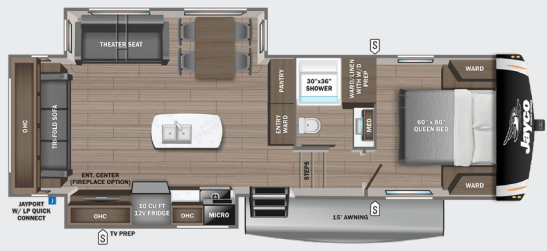

**28.5RSTS** OPTIONS: A, C, D, G

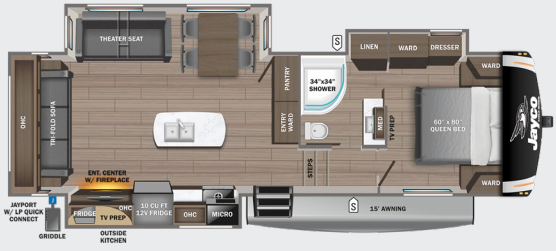

**29.5BHDS** OPTIONS: A, C, E, F, G

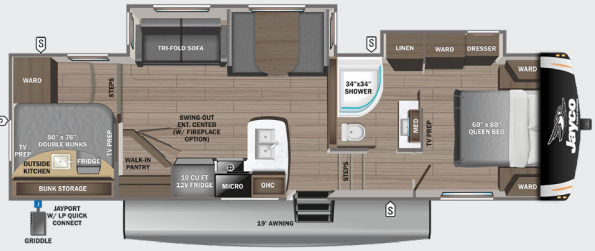

**29.5BHOK** OPTIONS: A, B, C, E, F, G

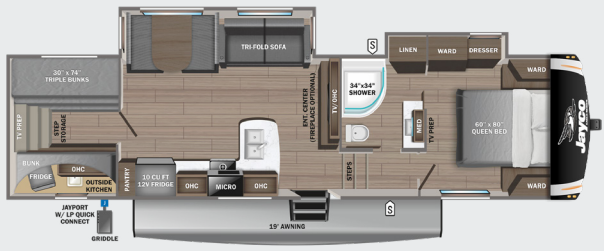

**30.5CKTS** OPTIONS: A, B, C, D, G, H

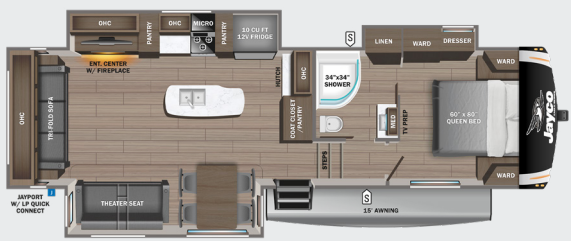

**30.5RSOK** OPTIONS: A, B, C, D, G

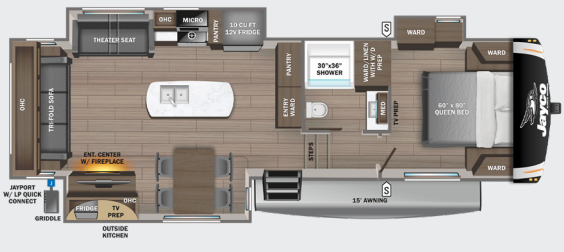

**31MB** OPTIONS: A, B, C



**OPTIONS**

**A**



8 Cu. Ft. Fridge

**B**



13 Cu. Ft. Fridge

**C**



King Bed

**D**



Dinette

**E**



Theater Seat

**F**



Table & Chairs

**G**



Table, Chairs & Bench

**H**



Griddle

# STANDARDS & OPTIONS

## EXTERIOR

- StrongholdVBL™ aluminum framed and vacuum bond laminated gelcoated fiberglass exterior walls (including rear wall and slide room end walls)
- Magnum Truss™ Roof System with one piece seamless roofing material with 20 year warranty
- Climate Shield™ zero-degree tested weather protection:
  - Fully enclosed and heated underbelly (ducted)
  - 35,000 BTU output furnace
  - Double layer fiberglass batt insulation in ceiling and floor
  - Double sided radiant barrier insulation (roof, floor and behind cap)
  - PEX plumbing
- HELIX Cooling System™ (industry exclusive):
  - Jayco exclusive insulated dual duct design
  - Directional and closeable A/C vents
  - Larger return air vents with user accessible filters
- JaySMART™ (Safety Markers And Reverse Travel) LED lighting (patented)
- Painted fiberglass front cap with built-in specialty LED lighting
- Custom automotive-grade vinyl exterior graphics package
- LED exterior lighting package
- Detachable shore power cord
- Dual 30 lb. propane bottles with auto regulator
- Pass-through storage with Slam-latch™ baggage doors
- Digital TV antenna with Wi-Fi prep
- Dual channel exterior marine-grade speaker
- Fully enclosed, LED-lighted universal docking center:
  - Selectable water connections
  - Quick-connect outside shower
  - Black tank flush, winterization and sanitization
  - Independent satellite and whole coach cable hookups
  - Water heater bypass
- Battery disconnect
- Under-mounted spare tire
- LP quick-connect
- Slide topper/awning prep
- "Industry's BEST" outside kitchen (select models)

## INTERIOR

- Solid hardwood slide fascia
- Handcrafted and glazed doors, drawers and trim
- Heavy-duty, 75 lb., full-extension, steel ball-bearing drawer guides
- 5/8 in. tongue-and-groove joined plywood floor decking
- Residential vinyl flooring (made in the USA)
- Residential vinyl flooring in slideouts (no carpet)
- LED dimmer switches (multiple locations)
- Tri-fold hide-a-bed sofa with residential sleep surface (select models)
- Theater seating (select models)
- Stainless steel kitchen sink
- Matte black kitchen faucet with pull-out sprayer
- Dual USB charging ports (multiple locations)
- Extra 120V power outlets in kitchen and slide rooms (where applicable)
- Residential quilted bedspread and pillows
- Gas-strutted under-bed storage
- Inverter pre-wire (multiple locations)
- C.P.A.P. prepped bedroom
- Carbon monoxide and LP detector
- Bathroom skylight
- LED backlit medicine cabinet with custom framed mirror
- Bathroom tile backsplash
- Porcelain foot flush toilet

## CUSTOMER VALUE PACKAGE (MANDATORY)

- MORryde® StepAbove™ entrance steps (main entrance) with blue LED light
- 15,000 BTU "Whisper Quiet" A/C
- 50-amp service with dual A/C ducts and second A/C prep
- Electric patio awning with integrated dimmable LED lights
- 60,000 BTU tankless hot water system
- Custom machined aluminum rims
- Rear 2 in. towing receiver with 4 pin connector
- Keyed-Alike™ lock system (single key for all doors/locks)
- Rooftop and ground solar prep by Go Power!®
- Security monitor prep- observation camera prep (rear, sides and entrance door)
- Hidden hinges on cabinet doors
- Upgraded friction hinge entrance door with XL grab handle
- LED Smart HDTV with fully digital HDMI® output
- 12V A/V system with Bluetooth® and HDMI®
- Stainless steel range with glass cover
- Stainless steel 30 in. over the range microwave
- Residential queen (60 in. x 80 in.) mattress with under bed storage
- Rain-proof bathroom power vent

## 4 STAR HANDLING PACKAGE (MANDATORY)

- Goodyear® Endurance® tires (made in the USA, load range 'E')
- Dexter® Axles with Nev-R-Adjust® brakes and E-Z Lube® hubs
- MORryde® CRE-3000™ rubberized suspension
- Wet bolt fasteners, bronze bushings and shock absorber prep

## LUXURY PACKAGE (MANDATORY)

- Electric auto-leveling
- Rotational pin box
- JAYCOMMAND® "Smart RV" system (Pro tablet)
- Fresh Water Drinking System (patented)
- 10 cu. ft. 12V refrigerator
- Blackout roller shades
- Residential style glass shower doors
- Tire Pressure Monitoring System (TPMS)

## OPTIONS

- Dry Camping Package (generator prep and extra LP capacity)
- Extreme Weather Package with 110V heat pads (110V heat pads with 12V heat tape on main water line)
- 360° security kit with 7 in. monitor
- Frameless dual-pane tinted safety-glass windows
- Canadian Standards (CSA)
- Free-standing rustic table with leaf and bench seat, 2 storage and 2 folding chairs
- Free-standing rustic table with leaf and 2 storage and 2 folding chairs
- Booth dinette (select models)
- LED fireplace and electric heater (standard on select models)
- Wall-hugger theater seating (standard on select models)
- 8 cu. ft. gas/electric refrigerator
- 4 door gas/electric refrigerator (select models)
- 2nd 15,000 BTU A/C ducted in bedroom
- Outside griddle for JayPort System (select models)
- Residential 72 in. x 80 in. king size mattress
- Overlander 2 Solar Package: (2) 200W solar panels, 30-amp digital controller and 1800W inverter
- Overlander 4 Solar Package: (4) 200W solar panels, (2) 100-amp/hour lithium heated batteries, 60-amp controller, 3000W inverter, DC/DC power converter, soft start power save main 15K A/C, soft start power save for bedroom 15K A/C (if optioned), battery monitor, energy management system, roof pre-wire for additional solar panels, generator prep capable and heavy gauge steel battery enclosure

\*Indicates split tanks

FLOORPLAN	TOTAL EXTERIOR LENGTH	EXTERIOR WIDTH	EXTERIOR HEIGHT (WITH A/C)	INTERIOR HEIGHT (MAIN)	INTERIOR HEIGHT (UPPER DECK)	UNLOADED VEHICLE WEIGHT	DRY HITCH WEIGHT	GVWR	CARGO CARRYING CAPACITY	FRESH WATER CAPACITY	GRAY WASTE WATER CAPACITY	BLACK WASTE WATER CAPACITY	SLEEPING CAPACITY
24RE	29' 1"	8' 1"	13' 1"	8' 5"	6' 3"	8,060	1,480	9,995	1,935	81	80*	43	4-6
27RL	31' 7"	8' 1"	12' 5"	8' 5"	6' 3"	8,660	1,610	10,850	2,190	81	80*	43	2-4
27RS	32' 8"	8' 1"	12' 4"	8' 4"	6' 3"	8,845	1,700	10,995	2,830	81	80*	43	4-6
28.5RSTS	32' 8"	8' 1"	12' 6"	8' 3"	6' 3"	9,210	1,655	11,250	2,040	81	80*	43	4-6
29.5BHDS	34' 5"	8' 1"	12' 11"	8' 5"	6' 3"	9,240	1,745	11,250	2,010	81	88.5*	43	8-10
29.5BHOK	35' 2"	8' 1"	13' 0"	8' 4"	6' 3"	9,340	1,720	11,450	2,110	81	88.5*	43	8-10
30.5CKTS	33' 10"	8' 1"	12' 5"	8' 4"	6' 3"	9,355	1,675	11,500	2,145	81	82*	45	2-4
30.5RSOK	33' 7"	8' 1"	12' 3"	8' 4"	6' 3"	9,435	1,835	11,750	2,830	81	80*	43	2-4
31MB	37' 4"	8' 1"	12' 6"	8' 1"	6' 3"	10,460	1,880	12,750	2,285	81	80*	43	5-7

Meet your Jayco Dealer



Scan QR code for specification definitions

Some specs at the time of print may include estimates. For the most updated information, please visit [Jayco.com](http://Jayco.com)

Jayco, Inc. | P.O. Box 460 | Middlebury, IN 46540

See dealer for further information and prices. All information in this brochure and on [www.jayco.com](http://www.jayco.com) is the latest available at the time of publication approval. Jayco reserves the right to make changes and to discontinue models without notice or obligation. Photography may show optional equipment or props used for decoration purposes only. RVs built for sale in Canada may differ to conform to Canadian codes. JAYCO and the JAYCO BIRD IN FLIGHT are registered trademarks of Jayco, Inc. Printed in USA 1/23 ©2023 Jayco, Inc. 2032588.2023



Jayco - Part of Jayco Family of Companies