



**Jayco**<sup>®</sup>

Generations of family fun.

# CAMPING TRAILERS

2015 CAMPING TRAILERS BY JAYCO

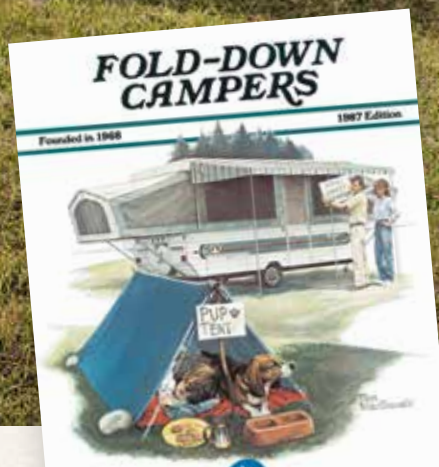
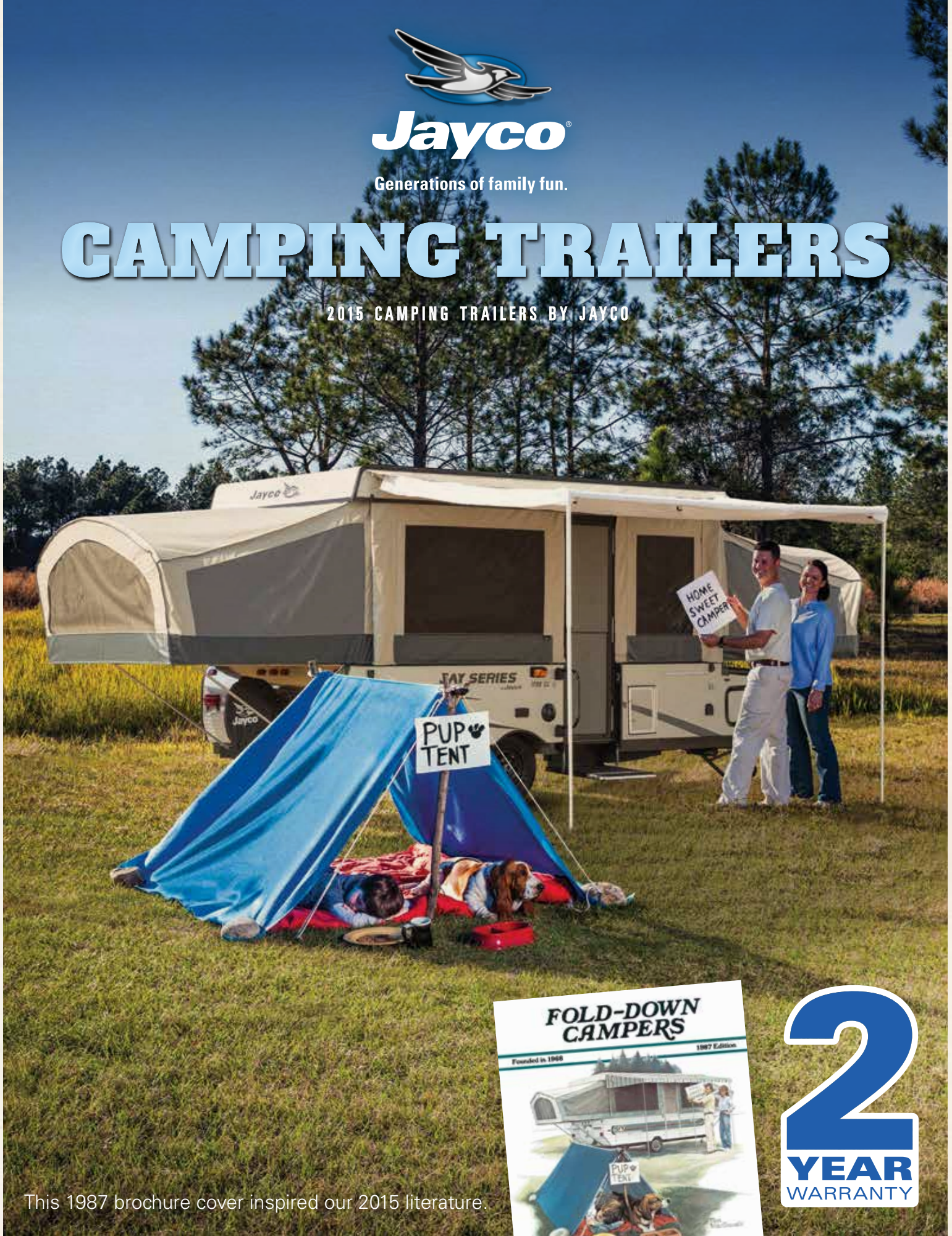

This 1987 brochure cover inspired our 2015 literature.

**2**  
**YEAR**  
WARRANTY



# BUILT FOR A lifetime OF FAMILY FUN

**5** LIFETIME WARRANTIES



JAY SERIES SPORT HARDWALL

JAY SERIES SPORT

JAY SERIES



For 45 years, Jayco has helped create generations of family fun, and over the course of that time, fun still looks remarkably the same. From campfires to fishing, from relaxing to eating, fun has the same feel generations later—and all with a Jayco RV nearby. Today, we're the largest family-owned RV manufacturer in the world, and our promise is to continually strive to build family-friendly products that will outlast just about everything but your memories. Join us in our generations of family fun.

**On the cover:** The 1987 brochure artwork, illustrated by Tim MacDonald, was part of a successful ad campaign. These illustrations inspired the 2015 Jayco brochure covers, which are live re-creations of Tim's artwork.



Scan this QR code to watch how Jayco has delivered Generations of Family Fun or visit [www.GenerationsOfFamilyFun.com](http://www.GenerationsOfFamilyFun.com).

**Forty five years ago, Jayco founder Lloyd Bontrager** created an easy-to-use lifter system that led to a better fold-down camper. Today, thanks to his patented design and other innovations like it, Jayco backs its camping trailers with five lifetime component warranties.\*

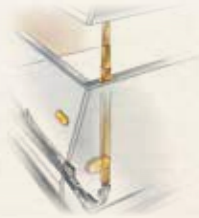

PATENTED LIFTER SYSTEM

## 1 LIFTER SYSTEM

Fully enclosed\*\* to protect against road debris and rust, our one-of-a-kind, patented lifter system uses strong, flexible push-rods to guide the roof, while our three-stage tubular lift posts include nylon bushings to reduce friction, shed water and protect the tent fabric. (Jay Series power lift components feature a 2-year warranty.)



1,050-LB. RATED BUNK ENDS

## 2 BED PLATFORM

Rest easy on a bed of Jayco durability. A two-piece extruded aluminum bed frame, 1/2" decking and heavy-duty supports hold up to 1,050 pounds.



SEAMLESS DOME ROOF

## 3 ROOF

The Jay Series' fiberglass roof features a unique dome design for better water runoff and one-piece construction for superior leak prevention, ensuring your RV will weather the elements.



INTEGRATED A-FRAME

## 4 FRAME

Powder coated to prevent corrosion, Jayco's custom-built frame is built for the long haul, featuring an integrated A-frame that prevents buckling and torque during towing.



POLY FLEX-WRAPPED FLOOR

## 5 FLOOR

Jayco wraps its one-piece wooden floor deck with water-resistant Poly Flex material. Using glue and screws to double bond the floor to the frame, Jayco's camping trailers boast one of the industry's strongest foundations.

\* Not available on the Jay Series Sport Hardwall.

\*\* The Jay Series Sport lifter system is not fully enclosed.





JAY SERIES SPORT 10SD

# Jay Series Sport

**Elevate your experience**

## JAY SERIES SPORT

The 2015 Jay Series Sport delivers all the comforts of a pop-up camper at a price you can afford. Boasting 1,050-lb.-rated bunks and convertible dinettes, you can forget sleeping on the ground. Welcome to a new level of camping.



JAY SERIES SPORT 10SD



JAY SERIES SPORT 10SD





## JAY SERIES SPORT HARDWALL

For 2015, Jayco is adding even more pop to its Jay Series Sport lineup with seven hardwall floorplans — a new easy-to-setup design for on-the-go enthusiasts.

SPEND LESS TIME SETTING UP  
**and more time  
having fun**

Turn the page to learn  
more about our easy setup.



JAY SERIES SPORT 12HFD



JAY SERIES SPORT 12HFD | CARGO AREA

# JAY SERIES SPORT FLOORPLANS

-  **LENGTH** | 11' 7"-22' 4"
-  **WEIGHT** | 1,200-2,455 lbs.
-  **SLEEPS** | 3-7

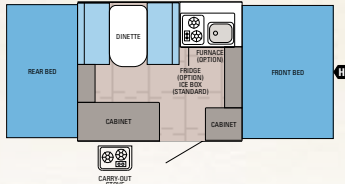

**JAY SERIES SPORT | 8SD**  
Ext. Length: 11' 7" Travel Ht.: 57"  
Unloaded Wt. (lbs.): 1,200 Sleeps: 5-6

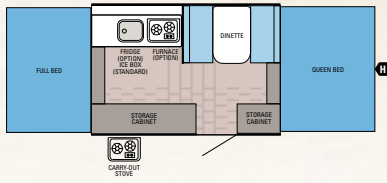

**JAY SERIES SPORT | 10SD**  
Ext. Length: 13' 6" Travel Ht.: 57"  
Unloaded Wt. (lbs.): 1,435 Sleeps: 5-6

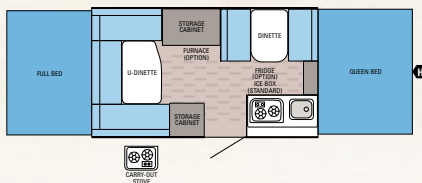

**JAY SERIES SPORT | 12UD**  
Ext. Length: 15' 6" Travel Ht.: 57"  
Unloaded Wt. (lbs.): 1,570 Sleeps: 6-7

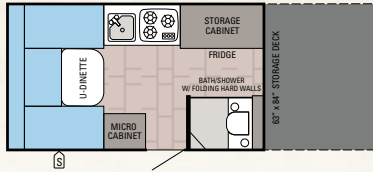

**JAY SERIES SPORT HARDWALL | 12BFD**  
Ext. Length: 22' 4" Travel Ht.: 70"  
Unloaded Wt. (lbs.): 2,455 Sleeps: 2

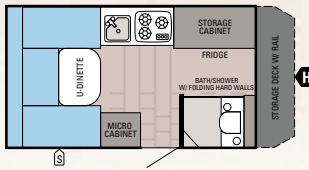

**JAY SERIES SPORT HARDWALL | 12BMD**  
Ext. Length: 18' 8" Travel Ht.: 62"  
Unloaded Wt. (lbs.): 2,005 Sleeps: 2

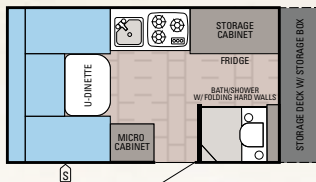

**JAY SERIES SPORT HARDWALL | 12BSB**  
Ext. Length: 18' 8" Travel Ht.: 58"  
Unloaded Wt. (lbs.): 2,135 Sleeps: 2

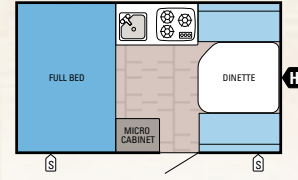

**JAY SERIES SPORT HARDWALL | 12H**  
Ext. Length: 16' 3" Travel Ht.: 61"  
Unloaded Wt. (lbs.): 1,915 Sleeps: 3-4

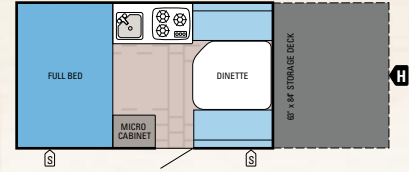

**JAY SERIES SPORT HARDWALL | 12HFD**  
Ext. Length: 22' 4" Travel Ht.: 71"  
Unloaded Wt. (lbs.): 2,385 Sleeps: 3-4

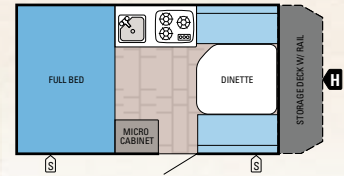

**JAY SERIES SPORT HARDWALL | 12HMD**  
Ext. Length: 18' 8" Travel Ht.: 62"  
Unloaded Wt. (lbs.): 1,990 Sleeps: 3-4



**JAY SERIES SPORT HARDWALL | 12HSB**  
Ext. Length: 18' 8" Travel Ht.: 62"  
Unloaded Wt. (lbs.): 2,095 Sleeps: 3-4

## SPECIFICATIONS

MODELS	DIMENSIONS				WEIGHTS (LBS.)				TANKS (GALS.)			
	FLOORPLAN	EXTERIOR LENGTH	CAMPSITE LENGTH	EXTERIOR WIDTH	TRAVEL HEIGHT	UNLOADED VEHICLE WEIGHT*	DRY HITCH WEIGHT	GROSS VEHICLE WEIGHT RATING	CARGO CARRYING CAPACITY	FRESH (INCLUDES WATER HEATER)	GRAY	BLACK
8SD	11' 7"	16' 2"	85"	85"	57"	1,200	175	1,995	795	10	n/a	n/a
10SD	13' 6"	19' 6"	85"	85"	57"	1,435	165	2,250	815	10	n/a	n/a
12UD	15' 6"	21' 6"	85"	85"	57"	1,570	210	2,350	780	10	n/a	n/a
12BFD	22' 4"	22' 4"	85"	85"	70"	2,455	405	4,150	1,695	23	n/a	5
12BMD	18' 8"	18' 8"	85"	85"	62"	2,005	230	3,250	1,245	23	n/a	5
12BSB	18' 8"	18' 8"	85"	85"	58"	2,135	295	3,250	1,115	23	n/a	5
12H	16' 3"	16' 3"	85"	85"	61"	1,915	230	3,250	1,335	23	n/a	n/a
12HFD	22' 4"	22' 4"	85"	85"	71"	2,385	385	4,150	1,765	23	n/a	n/a
12HMD	18' 8"	18' 8"	85"	85"	62"	1,990	220	3,250	1,260	23	n/a	n/a
12HSB	18' 8"	18' 8"	85"	85"	62"	2,095	305	3,250	1,155	23	n/a	n/a

\* The weights of certain options and/or option packages are not included in the UVW listed in the specification charts.



## JAY SERIES SPORT

### STANDARD EXTERIOR EQUIPMENT

Heavy-duty, corrosion-resistant frame construction  
Integrated A-frame  
Floor constructed of one-piece wooden floor deck and wrapped with Poly Flex underbelly material  
Scratch-resistant, embossed aluminum exterior finish  
Mildew-resistant aluminum ceiling  
Domed, seamless fiberglass roof  
Lifter post covers integrated into tent  
DuraTek water-repellent sectionalized tent with 1,050-lb. rated beds  
One-piece construction entrance door with self-storing screen door and access when roof is lowered  
Heavy-duty entrance door securement latches  
12" D-range radial tires with polyethylene wheel wells  
Leaf spring suspension system  
12V electrical system with 110V converter  
20-lb. propane gas bottle  
30-amp power cord  
120V G.F.C.I. protected exterior receptacle  
Prep wiring for battery  
City water hookup  
Bumper-welded steel construction  
Leveling tongue jack

### STANDARD INTERIOR EQUIPMENT

Heritage Mocha cabinet doors and drawers  
Ball bearing drawer guides, 75-lb. capacity with full-drawer extension  
Acrylic sink and faucet  
Appliances, pre-plumbed for propane  
35-lb. ice box  
Booth dinette with carry-out table  
Tinted vinyl windows with fine-mesh screening  
Window drapes and 4" ceiling valances  
Wall-to-wall Diamondflor vinyl flooring  
12V high-intensity lighting  
Auxiliary 12V jack and privacy curtains for bunk ends

### CUSTOMER VALUE PACKAGE

14" x 14" roof vent  
E-Z Lube axles  
Crank-down rear stabilizer jacks with sand pads (2)  
Stainless-steel, carry-out stove with wind deflectors  
10-gal. fresh water system with 12V demand pump  
Non-sliding, 4" deep dinette cushions

### OPTIONS

Self-storing awning  
Electric brakes  
Spare tire with carrier and cover  
Prep for A/C, includes wiring, roof supports, 120V outlet and wire sleeve cover  
16,000-BTU furnace with auto ignition  
2-cu. ft. 3-way gas/electric refrigerator (110V/12V/propane)  
Deluxe Plumbing Package: Outside shower and 6-gal. water heater (12UD)  
Heated bed mats (2)

## JAY SERIES SPORT HARDWALL

### STANDARD EXTERIOR EQUIPMENT

Outside shower  
Heavy-duty, corrosion-resistant frame construction  
Integrated A-frame  
Floor constructed of one-piece wooden floor deck and wrapped with Poly Flex underbelly material  
Fiberglass roof  
13" D-range radial tires with polyethylene wheel wells  
E-Z Lube axles with TorFlex independent torsion-axle suspension  
12V electrical system with 35-amp, 110V power converter  
20-lb. propane gas bottles (2)  
30-amp power cord  
120V G.F.C.I. protected exterior receptacle  
Prep wiring for battery  
City water hookup  
Bumper-welded steel construction  
Leveling tongue jack

### STANDARD INTERIOR EQUIPMENT

10,000-BTU Cool Cat heat pump  
2 cu.ft. 3-way gas/electric refrigerator (110V/12V/propane)  
Heritage Mocha cabinet doors and drawers  
Ball bearing drawer guides, 75-lb. capacity with full-drawer extension  
Acrylic sink and chrome faucet  
17-gal. fresh water tank with 12V demand pump  
6-gal. gas water heater  
Appliances, pre-plumbed for propane  
3-burner stainless-steel stovetop  
Microwave oven  
Booth dinette with carry-out dinette table  
Non-sliding, 4" deep dinette cushions  
Tinted vinyl windows with fine-mesh screening  
Window shades  
Privacy curtains  
Wall-to-wall Diamondflor vinyl flooring  
12V high-intensity lighting  
Multi-media stereo with AM/FM/CD/USB/SD  
Comforter

### CUSTOMER VALUE PACKAGE

Electric brakes  
Crank-down stabilizer jacks with sand pads (4)  
Spare tire with carrier and cover

### OPTIONS

Self-storing awning and screen room  
16,000-BTU furnace with auto ignition  
Powered roof vent

## HARDWALL SETUP

Sets up easily in less than 30 seconds.

- 1 Pitch the spring-loaded roof, guiding it up until it locks into place.



PITCH THE SPRING-LOADED ROOF

- 2 Step inside and shut the bottom door behind you before flipping up the top half. Secure with latch.

- 3 Push and latch the triangular sidewalls for final setup.



SET UP THE SIDEWALLS



LATCH THE SIDEWALLS

**Unloaded Vehicle Weight (UUV):** Sometimes referred to as "Dry Weight," UUV means the typical weight of this trailer as built at the factory. The UUV, as used in product literature and other promotional materials, does not include cargo, fresh water, propane, options or dealer-installed accessories.

**Gross Vehicle Weight Rating (GVWR):** GVWR means the maximum permissible weight of the trailer, including the UUV plus passengers, personal items, all cargo, fluids, options, and dealer-installed accessories. The GVWR is equal to or greater than the sum of the UUV and the CCC.

**Cargo Carrying Capacity (CCC):** CCC means the maximum weight of all passengers, personal items, food, fresh water, propane, tools, other cargo and dealer-installed accessories that can be carried by the trailer. CCC is equal to or less than GVWR minus UUV. The addition of options will decrease the CCC.

**Hitch Weight (HW):** The hitch weight, as used in product literature and other promotional materials, does not include cargo, fresh water, propane gas, options or dealer-installed accessories. The addition of these types of items will either add to or subtract from the stated hitch weight.

It is important for your safety and enjoyment that your tow vehicle be adequately sized and equipped to tow and handle the GVWR of the RV you select. Review weights and rating of your tow vehicle and consult a competent advisor for questions or advice. Whether you are new to RVing or a veteran, get a feel for the performance of your tow vehicle before heading out on the roadways. When you tow an RV, you must drive differently than when you drive a single vehicle. Practice hooking up, driving, backing up and braking in a safe environment or seek out professional instruction. Jayco affixes a weight label to each RV which lists weight information for that vehicle. See specifications chart left.





JAY SERIES 1209SC

# Jay Series

**Fold out the fun**

## JAY SERIES

Broaden your horizons in a 2015 Jay Series. Our most popular camping trailer lets you bring the outdoors in — and the indoors out — in four family-friendly floorplans with sleeping for up to eight people. A carry-out dinette table and stainless-steel carry-out stove let you enjoy the best of both worlds.



JAY SERIES 1209SC | OPTIONAL BATH/SHOWER



JAY SERIES 1007UD | KING BED TENT END





## EASY ENTRANCE

Jayco's stepper door (n/a 1001XR) doubles as an entry door and swing-down step. Its swing-away function creates more ground clearance during travel, while its large design makes for a spacious step.



JAY SERIES 1007UD



JAY SERIES 1209SC



## JAY SERIES FLOORPLANS

-  LENGTH | 14' 2"-20' 6"
-  WEIGHT | 1,800-2,460 lbs.
-  SLEEPS | 5-8

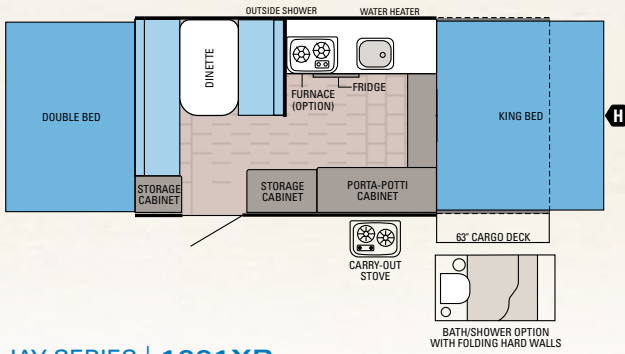

JAY SERIES | 1001XR

Ext. Length: 20' 6" Travel Ht.: 70" Unloaded Wt. (lbs.): 2,415 Sleeps: 5-6

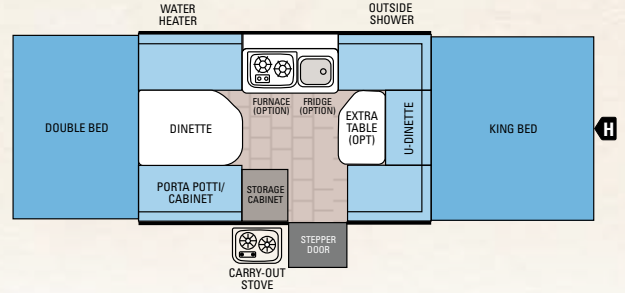

JAY SERIES | 1007UD

Ext. Length: 14' 2" Travel Ht.: 59" Unloaded Wt. (lbs.): 1,800 Sleeps: 6-8

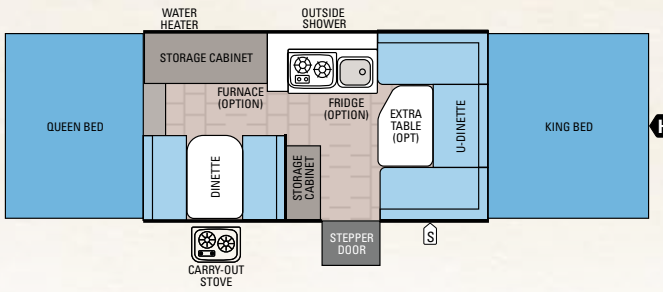

JAY SERIES | 1207UD

Ext. Length: 16' 2" Travel Ht.: 61" Unloaded Wt. (lbs.): 2,045 Sleeps: 6-7

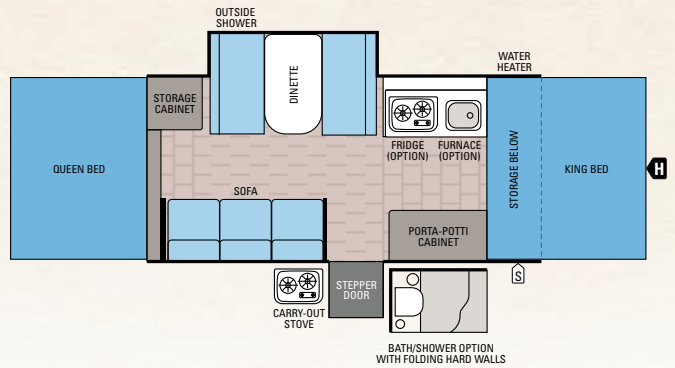

JAY SERIES | 1209SC

Ext. Length: 18' 2" Travel Ht.: 60" Unloaded Wt. (lbs.): 2,460 Sleeps: 6-7

## SPECIFICATIONS

MODELS	DIMENSIONS				WEIGHTS (LBS.)				TANKS (GALS.)			
	FLOORPLAN	EXTERIOR LENGTH	CAMPSITE LENGTH	EXTERIOR WIDTH	TRAVEL HEIGHT	UNLOADED VEHICLE WEIGHT**	DRY HITCH WEIGHT	GROSS VEHICLE WEIGHT RATING	CARGO CARRYING CAPACITY	FRESH (INCLUDES WATER HEATER)	GRAY	BLACK
1001XR		20' 6"	24' 2"	85"	70"	2,415	265	4,550	2,135	36.5	11*	5*
1007UD		14' 2"	20' 10"	85"	59"	1,800	160	2,550	750	23	0	0
1207UD		16' 2"	23' 4"	85"	61"	2,045	180	2,950	905	23	0	0
1209SC		18' 2"	23' 4"	85"	60"	2,460	315	3,450	990	23	11*	5*

\*With optional bath/shower. \*\*The weights of certain options and/or option packages are not included in the UUVW listed in the specification charts.

**Unloaded Vehicle Weight (UUVW):** Sometimes referred to as "Dry Weight," UUVW means the typical weight of this trailer as built at the factory. The UUVW, as used in product literature and other promotional materials, does not include cargo, fresh water, propane, options or dealer-installed accessories.

**Gross Vehicle Weight Rating (GVWR):** GVWR means the maximum permissible weight of the trailer, including the UUVW plus passengers, personal items, all cargo, fluids, options, and dealer-installed accessories. The GVWR is equal to or greater than the sum of the UUVW and the CCC.

**Cargo Carrying Capacity (CCC):** CCC means the maximum weight of all passengers, personal items, food, fresh water, propane, tools, other cargo and dealer-installed accessories that can be carried by the trailer. CCC is equal to or less than GVWR minus UUVW. The addition of options will decrease the CCC.

**Hitch Weight (HW):** The hitch weight, as used in product literature and other promotional materials, does not include cargo, fresh water, propane gas, options or dealer-installed accessories. The addition of these types of items will either add to or subtract from the stated hitch weight.

It is important for your safety and enjoyment that your tow vehicle be adequately sized and equipped to tow and handle the GVWR of the RV you select. Review weights and rating of your tow vehicle and consult a competent advisor for questions or advice. Whether you are new to RVing or a veteran, get a feel for the performance of your tow vehicle before heading out on the roadways. When you tow an RV, you must drive differently than when you drive a single vehicle. Practice hooking up, driving, backing up and braking in a safe environment or seek out professional instruction. Jayco affixes a weight label to each RV which lists weight information for that vehicle. See specifications chart above.





## DURABLE INTERIORS

Jayco builds its camping trailers to hold up to the most rugged of family adventures, starting with DuraTek vinyl tent material, double-stitched for extra longevity. This material packs up well, resisting mold, mildew, scratches and cracks. Inside, 75-lb. rated ball bearing drawer guides provide durable storage.



## FRESHEN UP

Who doesn't love hot water? Jay Series packs a 6-gal. water heater, water heater bypass and water filtration system for the ultimate in convenience. And a swing-level galley makes kitchen setup easier than ever.

## INTERIOR DÉCOR

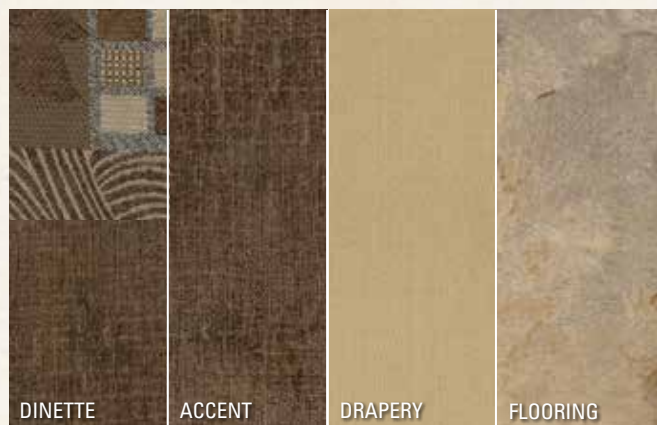

## JAY SERIES

### STANDARD EXTERIOR EQUIPMENT

Heavy-duty, corrosion-resistant frame construction  
 Integrated A-frame  
 One-piece wooden floor deck, wrapped with Poly Flex underbelly material  
 Scratch-resistant, embossed aluminum exterior finish  
 Mildew-resistant aluminum ceiling and domed, seamless fiberglass roof  
 14" x 14" roof vent  
 Prep for A/C accommodating all roof-mounted A/Cs  
 Roof prepped for bike carrier  
 Jayco's original, fully enclosed lifter system with lifter post covers integrated into tent (same design used since 1968)  
 Power roof lift with hand-held remote key fob  
 DuraTek water-repellent sectionalized tent with 1,050-lb. rated beds  
 Permanently attached bed support poles  
 Diamond plate on front and rear walls  
 One-piece entrance door with self-storing screen door; accessible when roof is lowered  
 Stepper door (n/a 1001XR)  
 12" D-range tires (1007UD)  
 13" D-range tires (1207UD and 1209SC)  
 15" off-road radial tires (1001XR)  
 E-Z lube axles with leaf-spring suspension  
 Spare tire and tire carrier with vinyl tire cover  
 Stainless-steel, carry-out stove with wind deflectors  
 Outside shower  
 1,000-lb. rated utility deck with ramps/deck railing and quick-connect attachment system (1001XR)  
 12V electrical system with 110V converter  
 30-amp power cord  
 Prep wiring for battery  
 Bumper-welded steel construction  
 Crank-down stabilizer jacks with sand pads  
 Leveling tongue jack

### STANDARD INTERIOR EQUIPMENT

Heritage Mocha cabinetry with raised-panel doors and drawers  
 Ball bearing drawer guides, 75-lb. capacity and full-drawer extension  
 Acrylic sink and faucet  
 Swing-level kitchen galley  
 6-gal. water heater  
 17-gal. fresh water tank with 12V demand pump  
 Water heater bypass system  
 Appliances, pre-plumbed for propane  
 Booth dinette with carry-out table  
 Non-sliding, 4" deep cushions for dinette  
 SoftShade window shades and valances  
 Tinted vinyl windows with fine-mesh screening  
 Porta-potti storage cabinet (select models)  
 Wall-to-wall Diamondflor vinyl flooring  
 Auxiliary 12V jack and privacy curtains for bunk ends

### CUSTOMER VALUE PACKAGE

Self-storing awning  
 2-cu. ft. 3-way gas/electric refrigerator (110V/12V/propane)  
 Water purification system  
 Bunk-end fan lights (2)

### BAJA PACKAGE (1001XR)

Aluminum rims  
 E-Z Lube axles  
 20-lb. propane bottles (2)  
 Battery gauge  
 Solar prep  
 30-gal. fresh water tank

### OPTIONS

Heated bed mats (2)  
 Deluxe screen room  
 Electric brakes (standard on 1001XR, 1209SC)  
 Hydraulic surge brakes (1007UD, 1207UD, 1209SC)  
 Outside grill  
 Multi-media stereo with outside speakers (mandatory on 1001XR)  
 16,000-BTU furnace with auto ignition  
 2nd table with pedestal leg (1007UD, 1207UD)  
 Bath/shower with hard walls and shower curtain (1001XR, 1209SC)  
 Powered roof vent  
 Front storage box (1001XR)



**2**  
**YEAR**  
WARRANTY



**Jayco**<sup>®</sup>

Generations of family fun.

Bumper-to-hitch limited warranty\*

**FAMILY fun**  
starts with peace of mind

**FREE** Roadside Assistance

At Jayco, we build our RVs to handle every adventure, then we back our products with an industry-leading 2-year limited warranty. You won't find a better warranty in the business because the only strings we attach are those that deliver the ultimate in reliability. That's the Jayco difference. So go explore. We have the warranty that will follow you anywhere.

Travel worry-free with Jayco's Customer First Roadside Assistance program, yours at no cost during the first year of ownership. This program is offered through Coach-Net, the country's largest RV emergency road service, and gives you immediate access to assistance.

\*For a copy of our 2-year limited warranty with full terms and conditions, please contact your local Jayco dealer.

**eco** advantage<sup>™</sup>

Jayco's long-term commitment to generations of family fun



Scan this QR code with your smartphone to watch a video about our efforts and the impact we're making on our planet.

[ecoadvantage.jayco.com](http://ecoadvantage.jayco.com)

The fun starts with your local Jayco dealer

Your local dealer

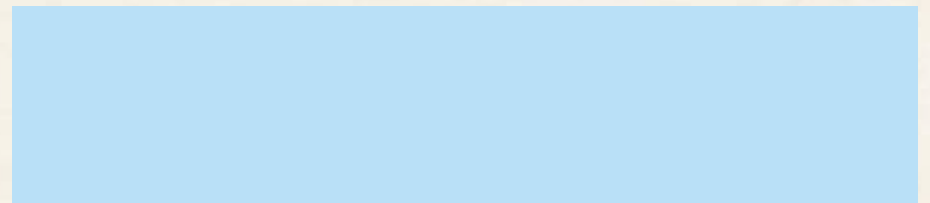

From giving advice to selling and servicing products, we consider our loyal dealers the glue in our family bond. Establishing a solid relationship with your local Jayco dealer is a key component in the enjoyment of your new Jayco. By purchasing from a local dealer, you will have a convenient location for sales, parts and service support. We hope you consider them a part of your camping family.

Follow Jayco



Jayco, Inc., P.O. Box 460, Middlebury, IN 46540, [www.jayco.com](http://www.jayco.com) See dealer for further information and prices. All information in this brochure is the latest available at the time of publication approval. Jayco reserves the right to make changes and to discontinue models without notice or obligation. Photos in this brochure may show optional equipment and props for photography purposes. RVs built for sale in Canada may differ to conform to Canadian codes. ©2015 Jayco, Inc. 15-FDCT-PL 0115-10K Printed in U.S.A.