

JAY FEATHER ULTRA LITE

live lightly

EASY ON WEIGHT.
BIG ON AMENITIES.





HEAVYWEIGHT PERFORMANCE

Blending intelligent interior design with advanced construction techniques, Jay Feather Ultra Lite is the industry's leading ultra lite. Solidly built and affordably priced, it's light enough to be towed by most SUVs, minivans and crossovers,* yet spacious enough to accommodate your family.

* Consult with your authorized automobile manufacturer or vehicle owner's manual.



DURATEK TENT MATERIAL

Our DuraTek water-repellent tent material, double-stitched in our own factory and backed by a 5-year warranty, is built to resist mildew, mold, scratches and cracks.



FULL-FEATURED KITCHEN

Energy-efficient Atwood appliances, like a 3-burner range with 9,000-BTU SuperBurner, make cooking a breeze.

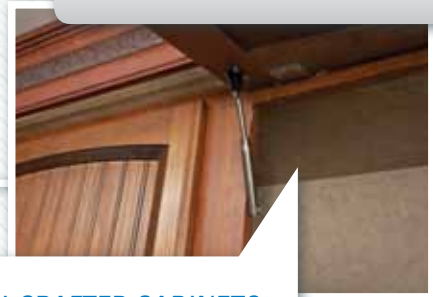

AMISH-CRAFTED CABINETS

Jayco's solid-wood cabinetry boasts durable metal hinges.



YOU WANT PEACE OF MIND

That's why we offer our exclusive 2-year Co-Pilot Warranty, the industry's best and most comprehensive warranty program.

VS LIGHTWEIGHT FEATURES

SPACE-SAVING FLOORPLANS

Our innovative floorplans maximize space with multiple expandable tent ends, roomy slideouts and family-friendly U-dinette seating (select models).

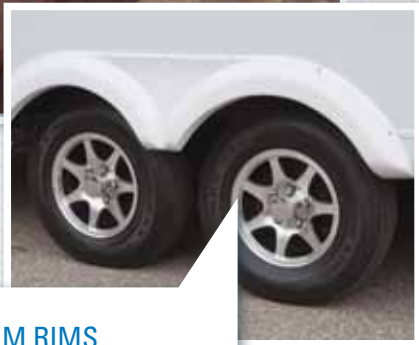

ALUMINUM RIMS

Lighter than steel rims, optional aluminum rims provide a sleek look.

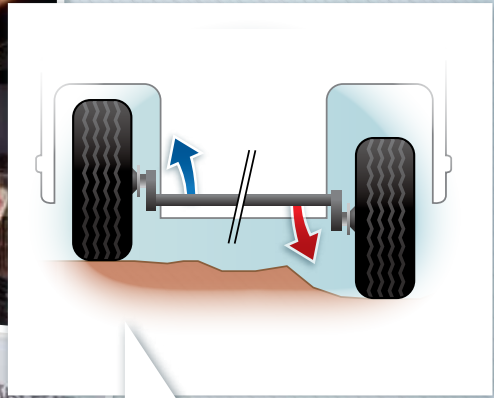

INDEPENDENT SUSPENSION

Jay Feather's independent torsion-axle suspension transfers road shock, while its rubberized system limits vibration, decreasing wear-and-tear on your RV.

AERODYNAMIC PROFILE

An innovative, curved profile improves gas mileage and increases towability.

WITH YOUR PURCHASE

Every Jayco RV undergoes rigorous quality control testing before it leaves the factory, so you can be confident your new Jayco will continue to provide the ultimate in reliability for years to come.

For a copy of our 2-year limited warranty with full terms and conditions, ask your local Jayco dealer.



TO LEARN MORE ABOUT
OUR QUALITY CONTROL
TESTING, SCAN HERE WITH
YOUR SMARTPHONE.



JAY FEATHER ULTRA LITE EXPANDABLES



spread out

There's no need to give up space or amenities with the Jay Feather expandable. Family-friendly U-dinettes and expandable sleeping areas make getaways comfortable while maximizing space.



JAY FEATHER X23B | AMARETTO



JAY FEATHER X23B | AMARETTO



JAY FEATHER X23B | AMARETTO



JAY FEATHER X23B | AMARETTO

SLEEPS UP TO 10

The Jay Feather expandable comfortably sleeps up to 10 thanks to 1,100-pound expandable tent ends.

DURABLE INTERIORS

Wall-to-wall vinyl flooring, durable pleated night shades, Concord Cherry hardwood cabinetry and residentially-styled furniture, designed and made by Jayco, create the ultimate interior package built for years of adventure.



JAY FEATHER ULTRA LITE TRAVEL TRAILERS



live large, tow small

Hardwall slideouts, select model private bedrooms and full-featured kitchens combine for the ultimate lightweight package in the Jay Feather travel trailer. Ideal for families who want the ease of a smaller trailer but the amenities of a larger one, Jay Feather is a perfect fit.



JAY FEATHER 24T | CHOCOLATE



JAY FEATHER 24T | CHOCOLATE



JAY FEATHER 24T | CHOCOLATE

SLEEK EXTERIOR

Jay Feather combines dark-tinted windows with vacuum-bonded sidewalls for a sleek exterior package.

MODERN APPLIANCES

From a full-featured kitchen, boasting select energy-efficient Atwood appliances, to a 13,500-BTU A/C with directional vents, Jay Feather packs all the modern conveniences.



JAY FEATHER 24T | CHOCOLATE



CONSTRUCTION

and craftsmanship

At Jayco, we've built a reputation for superior construction and quality craftsmanship. We pride ourselves on always using top-quality materials and innovative manufacturing techniques. That commitment has led to our latest construction advancement, the all-new exclusive Magnum Roof System, 50 percent stronger than other roofs in the industry, built to outlast everything but your memories.



OUR NEW ROOF FEATURES ...

- 1 4 1/2" crowned wood trusses:** Uses 2"x 2" vertical studs to maximize load capacity, while oversized nail plates provide a tighter design
- 2 3/8" roof decking, screwed down at every seam:** More durable than typical stapled construction, provides fully walkable roof
- 3 Residential attic-style insulation:** Maintains interior temperatures while allowing for room to run wiring, reducing risky electrical shorts
- 4 One-piece, sidewall-wrapped Alpha Ply material:** Provides leak protection



OLD WORLD CRAFTSMANSHIP

WALL CONSTRUCTION

- 5 Vacuum-bonded layers:** Involves 15-18 minutes of 144 tons of pressure to ensure a strong bond
- 6 Welded aluminum frames with metal backers:** Lighter than wood, increases towability
- 7 Extra-wide corner seals:** Prevents leaks on corner molds, baggage/entrance doors and window seals
- 8 Innovative, aerodynamic front profile:** Eliminates angled profile, increasing towability

FLOOR CONSTRUCTION

- 9 Vacuum-bonded layers:** Backed by computer monitoring and constant quality control checks, Jayco prides itself on building a solid foundation
- 10 Bead-foam insulation (R-9):** Maintains interior temperatures
- 11 Norco lightweight steel frame:** Features industry's strongest strength-to-weight ratio with one-piece I-beam construction
- 12 Innovative A-frame:** Fully integrated, and not welded, prevents buckling

TENT DESIGN

- 13 Reversed cambered-support:** Creates durable structure rated to hold 1,100 pounds
- 14 Hook tent frame:** Creates more headroom than competing tents
- 15 5" bed mats:** Provide comfort
- 16 DuraTek water-repellent vinyl tent material:** Resists mildew, mold, scratches and cracks, while double-stitched design adds strength
- 17 Permanent tent-to-bunk attachment system with channel locks:** Eliminates misplaced poles, using innovative Velcro system



eco advantage™ www.jayco.com/ecoadvantage

THE JAYCO ECOADVANTAGE IS OUR COMPANY'S COMMITMENT TO PROTECTING THE ENVIRONMENT. Scan this QR code with your smartphone to watch a video about our efforts and the impact we're having on our world.

THE FEATURE-PACKED JAY FEATHER ...



designed with family in mind

Jay Feather features durable wall-to-wall Diamondflor vinyl flooring, perfect for family foot traffic. It's one of many details we pack into our family-friendly travel trailers.

SKYLIGHT

The full-featured bathroom comes equipped with a room-brightening skylight.

AM/FM/DVD

Jay Feather features a AM/FM/DVD player with MP3 and iPod hookups.

EXTERIOR SPEAKERS

Take your music outdoors thanks to marine-grade exterior speakers.

STANDARDS AND OPTIONS

STANDARD EXTERIOR EQUIPMENT

TuffShell vacuum-bonded laminated sidewalls, front walls and floors

Vacuum-bonded laminated tent ends with reverse-cambered support

Deluxe Graphics Package with Slate Gray front and rear walls with 12" sidewall color band .030 bottom radius metal skirting

Magnum truss roof system

One-piece seamless Alpha Ply roof material

Norco stamped steel frame with integrated A-frame

Amber patio lights with interior switch

Entrance step and hitch light

Heavy-duty entrance step with no-slip treads

Patio awning (select models)

Marine-grade exterior speakers (2)

G20 dark-tinted windows

E-Z Lube axles

TorFlex independent torsion-axle rubber ride suspension system

Black ABS fenders

Radial tires

Galvanized-steel, impact-resistant wheel wells

Aerodynamic, rounded front profile

Front diamond plate

Double-wide corner mold extrusions

Radius-cornered entrance and baggage doors

Knuckle-hinge baggage doors

Electric-powered Schwintek slide systems (slide models only)

DuraTek water-repellent, scratch-resistant vinyl tent material with zipper windows (expandables)

Painted shepherd's hook tent framing (expandables)

Permanently-attached tent-to-bed base design (expandables)

Self-supporting lockable tent ends with 1,100-lb. capacity (expandables)

Outside grill quick connect port

Outside shower

Sewer hose storage compartment

Rubberized flexible LP gas lines

30-amp power service

Stabilizer jacks with sand pads (4)

STANDARD INTERIOR EQUIPMENT

Wood-grain accent wall panels (select walls)

Screwed-and-glued Glazed Concord Cherry cabinetry

Bead-board inserts (select overhead cabinets)

Ball bearing drawer guides throughout, 75-lb. capacity with full extension

High-definition laminate countertop with rounded bull-nosed edging

Deep single-bowl acrylic sink with high-rise faucet (select models)

Large 60/40 acrylic sink with high-rise faucet (select models)

Metal alloy faucet fittings

3-burner range with 9,000-BTU SuperBurner and piezo igniter

5 cu. ft. flush-mounted Norcold refrigerator

Diamondflor vinyl flooring

Plywood dinette, bunk and bed bases

4" high-density, reversible dinette cushions

Pleated shades throughout with box valances

Cable/satellite hookups

AM/FM/DVD with MP3 and iPod hookups

Bathroom roof vent

Bath skylight

Shower curtain with curved shower track (select models)

5" soft-quilt tent bunk mats (select models)

6" high-density foam mattress (select models)

Radius-cornered bed bases

12V power port in tent ends

Full-height shirt wardrobes in front walk-around queen bedroom models

CUSTOMER VALUE PACKAGE

ABS bottle cover

Dual 20-lb. propane bottles with regulator

Spare tire

13,500-BTU A/C

Microwave

Water heater bypass

OPTIONS

Aluminum rims

Electric awning (select models)

Enclosed underbelly (n/a X17A, X17Z, 16V) (standard on 24Z, 24T)

Electric tongue jack (select models)

Suspension lift kit (2") (select models)

Outside grill

Customer Value Package with 15,000-BTU A/C

6-gal. gas/electric DSI Atwood water heater

6.3 cu. ft. Norcold double-door refrigerator (select models)

Oven

Folding table with bench seat (X18D)

22" HDTV (select models)

Queen bed with bunk (197)

Tent end bed mat heaters (expandable models)



FOR A COMPLETE LIST OF
STANDARDS AND OPTIONS, SCAN
HERE WITH YOUR SMARTPHONE
OR VISIT JAYCO.COM.

EXPANDABLE FLOORPLANS

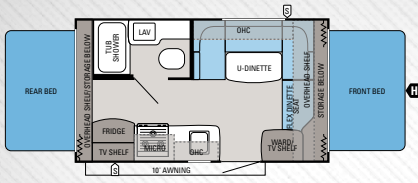

JAY FEATHER ULTRA LITE | X17A

Ext. Length: 18' 6" Ext. Height: 118" Unloaded Wt. (lbs.): 2,795 Sleeps: 5-6

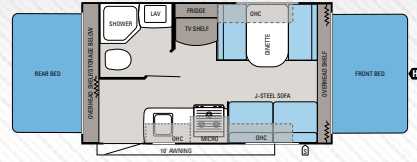

JAY FEATHER ULTRA LITE | X17Z

Ext. Length: 18' 6" Ext. Height: 118" Unloaded Wt. (lbs.): 2,785 Sleeps: 6-8

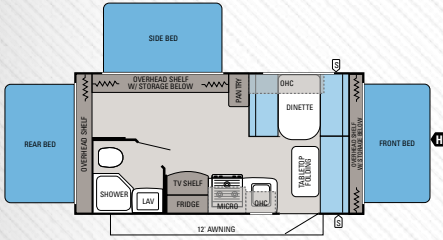

JAY FEATHER ULTRA LITE | X18D

Ext. Length: 20' 9" Ext. Height: 120" Unloaded Wt. (lbs.): 3,405 Sleeps: 7-8

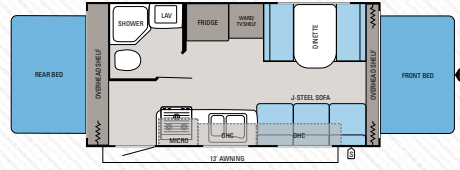

JAY FEATHER ULTRA LITE | X19H

Ext. Length: 20' 8" Ext. Height: 120" Unloaded Wt. (lbs.): 3,310 Sleeps: 6-8

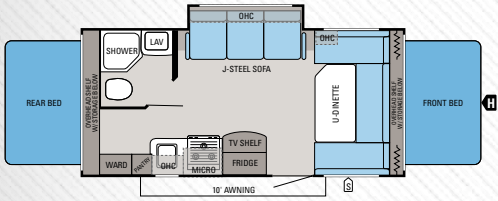

JAY FEATHER ULTRA LITE | X20E

Ext. Length: 21' 8" Ext. Height: 119" Unloaded Wt. (lbs.): 3,635 Sleeps: 7-8

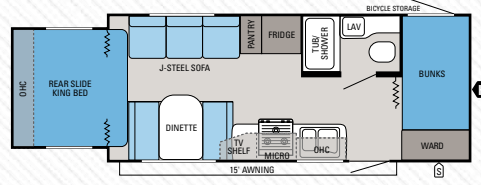

JAY FEATHER ULTRA LITE | X213

Ext. Length: 24' Ext. Height: 119" Unloaded Wt. (lbs.): 4,020 Sleeps: 6-8

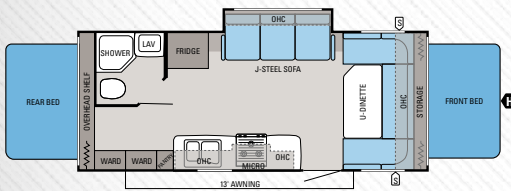

JAY FEATHER ULTRA LITE | X23B

Ext. Length: 24' 5" Ext. Height: 120" Unloaded Wt. (lbs.): 3,925 Sleeps: 7-8

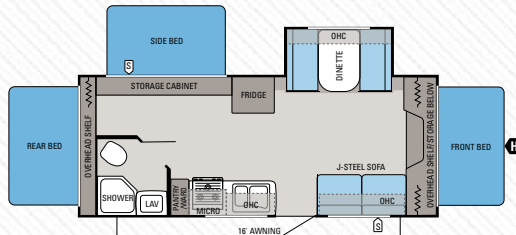

JAY FEATHER ULTRA LITE | X23F

Ext. Length: 24' 7" Ext. Height: 118" Unloaded Wt. (lbs.): 4,130 Sleeps: 8-10

SPECIFICATIONS

FLOORPLAN	EXTERIOR LENGTH	EXTERIOR WIDTH	EXTERIOR HEIGHT (WITH A/C)	INTERIOR HEIGHT	UNLOADED VEHICLE WEIGHT (LBS.)	DRY HITCH WEIGHT (LBS.)	GROSS VEHICLE WEIGHT RATING (LBS.)	CARGO CARRYING CAPACITY (LBS.)	FRESH WATER CAPACITY (GAL.) (WITH WATER HEATER)	GRAY WASTEWATER CAPACITY (GAL.)	TOILET/BLACK WASTEWATER CAPACITY (GAL.)
X17A	18' 6"	96"	118"	78"	2,795	360	3,500	705	28.5	30.5	22.5
X17Z	18' 6"	96"	118"	78"	2,785	395	3,500	715	28.5	30.5	22.5
X18D	20' 9"	96"	120"	78"	3,405	465	4,400	995	28.5	30.5	22.5
X19H	20' 8"	96"	120"	78"	3,310	355	4,950	1,640	28.5	30.5	22.5
X20E	21' 8"	96"	119"	78"	3,635	430	4,750	1,115	28.5	30.5	22.5
X213	24'	96"	119"	78"	4,020	375	5,500	1,480	28.5	30.5	22.5
X23B	24' 5"	96"	120"	78"	3,925	410	4,950	1,025	28.5	29.5	22.5
X23F	24' 7"	96"	118"	78"	4,130	530	4,995	865	28.5	30.5	22.5
16V	18' 6"	96"	119"	78"	2,580	350	3,500	920	28.5	30.5	22.5
197	20' 11"	96"	123"	78"	3,560	450	4,750	1,190	28.5	30.5	22.5
20M	23' 11"	96"	129"	78"	4,295	470	5,750	1,455	28.5	30.5	30.5
221	26' 1"	96"	121"	78"	3,740	515	4,950	1,210	28.5	30.5	30.5
228	25' 9"	96"	120"	78"	3,760	425	4,950	1,190	28.5	30.5	22.5
23M	26' 4"	96"	129"	78"	4,645	635	6,500	1,855	28.5	30.5	22.5
24T	27' 8"	96"	124"	78"	4,395	525	6,250	1,855	28.5	45.0	30.5
242	27' 10"	96"	124"	78"	4,535	540	6,500	1,965	28.5	45.0	30.5
254	28' 2"	96"	123"	78"	4,395	445	6,400	2,005	28.5	30.5	22.5

The weights of certain options and/or option packages are not included in the UWW listed in the specification charts.

TRAVEL TRAILER FLOORPLANS

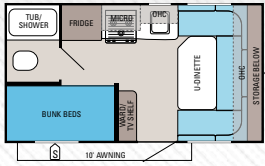

JAY FEATHER ULTRA LITE | 16V

Ext. Length: 18' 6" Ext. Height: 119" Unloaded Wt. (lbs.): 2,580 Sleeps: 3-4

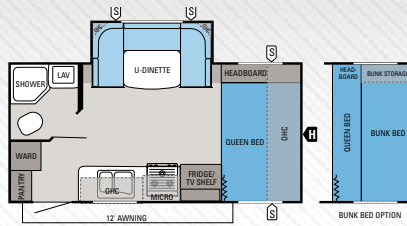

JAY FEATHER ULTRA LITE | 197

Ext. Length: 20' 11" Ext. Height: 123" Unloaded Wt. (lbs.): 3,560 Sleeps: 3-5

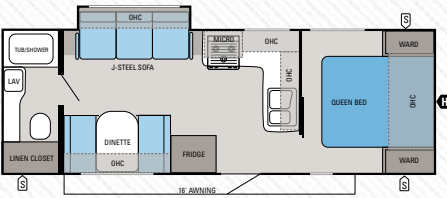

JAY FEATHER ULTRA LITE | 20M

Ext. Length: 23' 11" Ext. Height: 129" Unloaded Wt. (lbs.): 4,295 Sleeps: 2-4

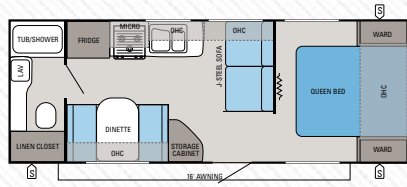

JAY FEATHER ULTRA LITE | 221

Ext. Length: 26' 1" Ext. Height: 121" Unloaded Wt. (lbs.): 3,740 Sleeps: 4-6

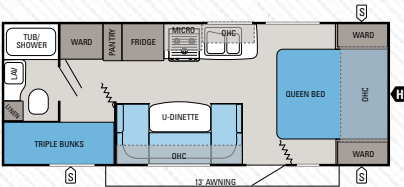

JAY FEATHER ULTRA LITE | 228

Ext. Length: 25' 9" Ext. Height: 120" Unloaded Wt. (lbs.): 3,760 Sleeps: 6-7

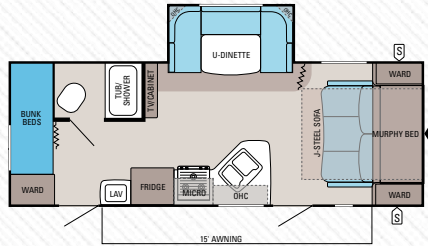

JAY FEATHER ULTRA LITE | 23M

Ext. Length: TBD Ext. Height: TBD Unloaded Wt. (lbs.): TBD Sleeps: 4-6

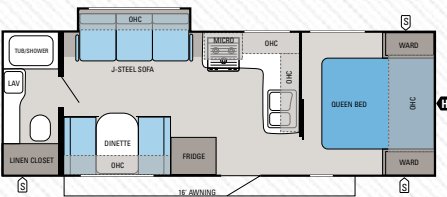

JAY FEATHER ULTRA LITE | 24T

Ext. Length: 27' 8" Ext. Height: 124" Unloaded Wt. (lbs.): 4,395 Sleeps: 4-6

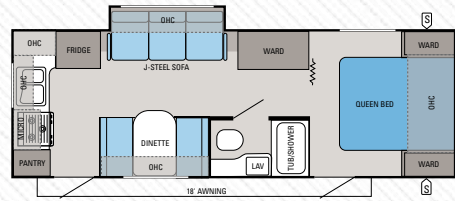

JAY FEATHER ULTRA LITE | 242

Ext. Length: 27' 10" Ext. Height: 124" Unloaded Wt. (lbs.): 4,535 Sleeps: 4-6

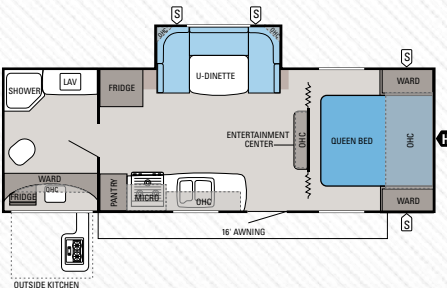

JAY FEATHER ULTRA LITE | 254

Ext. Length: 28' 2" Ext. Height: 123" Unloaded Wt. (lbs.): 4,395 Sleeps: 3-4

INTERIOR DÉCOR CHOICES

AMARETTO

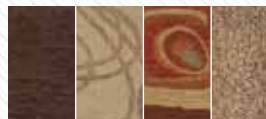

CHOCOLATE

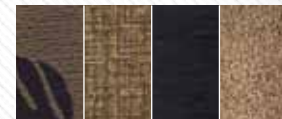

WOOD



TRUFFLE



BRICK





THE Jayco® family STORY

THE JAYCO STORY BEGAN IN 1968 WITH OUR FAMILY—THE BONTRAGERS. Lloyd Bontrager created an innovative, easy-to-use lifter system that led to a better fold-down camper. Loaded with more conveniences, he believed his camper would bring families closer together.

Since then, the Jayco family has grown. From our factory to our front office, from our salespeople to our suppliers, our family bond is four decades strong with the support of more than 300 Jayco dealers.

Together, we're helping make new family stories. **YOUR FAMILY STORY.**

welcome to the Jayco family



Establishing a solid relationship with your local Jayco dealer is a key component in the enjoyment of your new Jayco. By purchasing from a local dealer, you will have a convenient location for sales, parts and service support. We hope you enjoy working with them as much as we do.



Jayco proudly sponsors Tread Lightly!, a nonprofit organization whose mission is to empower generations to enjoy the outdoors responsibly through education and restoration.

Unloaded Vehicle Weight (UWV): Sometimes referred to as "Dry Weight," UWV means the typical weight of this trailer as built at the factory. The UWV, as used in product literature and other promotional materials, does not include cargo, fresh water, propane, options or dealer-installed accessories.

Gross Vehicle Weight Rating (GVWR): GVWR means the maximum permissible weight of the trailer, including the UWV plus passengers, personal items, all cargo, fluids, options, and dealer-installed accessories. The GVWR is equal to or greater than the sum of the UWV and the CCC.



From RV insurance to extended warranties, JayPlus has it covered. Ask your Jayco dealer about our exclusive JayPlus program today.

Cargo Carrying Capacity (CCC): CCC means the maximum weight of all passengers, personal items, food, fresh water, propane, tools, other cargo and dealer-installed accessories that can be carried by the trailer. CCC is equal to or less than GVWR minus UWV. The addition of options will decrease the CCC.

Hitch Weight (HW): The hitch weight, as used in product literature and other promotional materials, does not include cargo, fresh water, propane gas, options or dealer-installed accessories. The addition of these types of items will either add to or subtract from the stated hitch weight.



Travel worry-free with Jayco's Customer First Roadside Assistance program, yours at no cost during your first year of ownership. This program is offered through Coach-Net, the largest RV emergency road service in the country, and gives you immediate access to dependable roadside assistance and support services with a simple phone call.



As a Jayco owner, you can be part of the Jayco Jafari International Travel Club. Ask your dealer about the Jafari "flight" in your area, write Jayco or visit our website.

It is important for your safety and enjoyment that your tow vehicle be adequately sized and equipped to tow and handle the GVWR of the RV you select. Review weights and rating of your tow vehicle and consult a competent advisor for questions or advice. Whether you are new to RVing or a veteran, get a feel for the performance of your tow vehicle before heading out on the roadways. When you tow an RV, you must drive differently than when you drive a single vehicle. Practice hooking up, driving, backing up and braking in a safe environment or seek out professional instruction. Jayco affixes a weight label to each RV which lists weight information for that vehicle. See specifications chart inside.

Jayco, Inc., P.O. Box 460, Middlebury, IN 46540, www.jayco.com

See dealer for further information and prices. All information in this brochure is the latest available at the time of publication approval. Jayco reserves the right to make changes and to discontinue models without notice or obligation. Photos in this brochure may show optional equipment and props for photography purposes. RVs built for sale in Canada may differ to conform to Canadian codes. ©2012 Jayco, Inc. 13-JFTR-PL 1212-40K Printed in U.S.A.