

FR3 34DS FLOORPLAN

The FR3 34DS is spacious and inviting, with conveniences throughout—including a bath and a half. The bedroom features a king bed slideout, washer/dryer prep, 12V TV, and dual nightstands with 110V and USB outlets. The main living area gives you a 12V 15 cu. ft. refrigerator, theater seating, and entertainment center with fireplace, and hidden pantry. The kitchen features a booth dinette, cooktop with oven, residential microwave, and two countertop extensions.

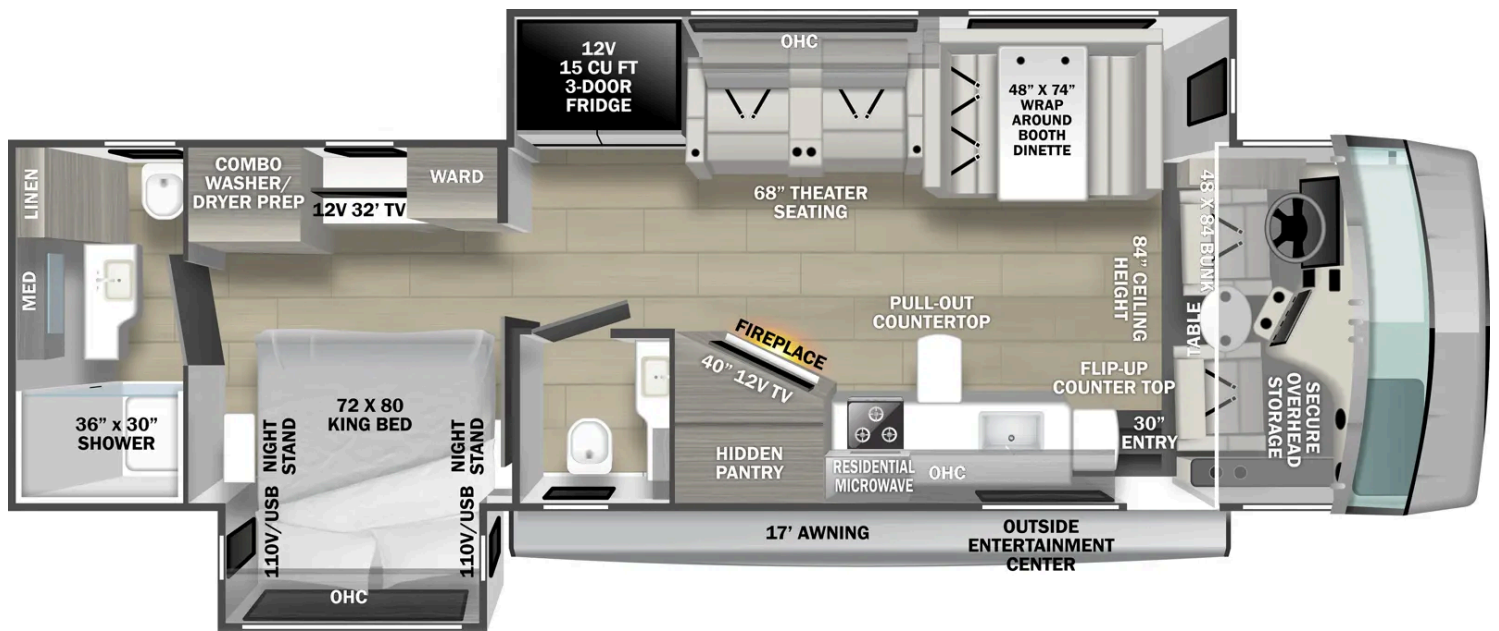

Wheelbase	228"	GVWR	20,500 lb.
GCWR	26,000 lb.	GAWR Front	7,500 lb.
GAWR Rear	13,500 lb.	Fuel Capacity	80 gal.
LP Tank Capacity	103 lb.	Exterior Length	35' 11"

Exterior Height	12' 5"	Exterior Width	101"
Fresh Water	52 gal.	Gray Water	52 gal.
Black Water	52 gal.	Awning Size	17'

SPECIFICATIONS DEFINITIONS

GVWR (Gross Vehicle Weight Rating) – is the maximum permissible weight of the unit when fully loaded. It includes all weights, inclusive of all fluids, cargo, optional equipment and accessories. For safety and product performance do NOT exceed the GVWR.

GCWR (Gross Combined Weight Rating) – is the maximum permissible loaded weight of your motor home and any towed trailer or towed vehicle. Actual GCWR of this vehicle may be limited by the sum of the GVWR and the installed hitch receiver maximum capacity rating; see hitch rating label for detail.

GAWR (Gross Axle Weight Rating) – is the maximum permissible weight, including cargo, fluids, optional equipment and accessories that can be safely supported by a combination of all axles.

UVW (Unloaded Vehicle Weight)* – is the typical weight of the unit as manufactured at the factory. It includes all weight at the unit's axle(s) and tongue or pin and LP Gas. The UVW does not include cargo, fresh potable water, additional optional equipment or dealer installed accessories.

*Estimated Average based on standard build optional equipment.

CCC (Cargo Carrying Capacity) ** – is the amount of weight available for fresh potable water, cargo, additional optional equipment and accessories. CCC is equal to GVWR minus UVW. Available CCC should accommodate fresh potable water (8.3 lbs per gallon). Before filling the fresh water tank, empty the black and gray tanks to provide for more cargo capacity.

**Estimated Average based on standard build optional equipment.

Each Forest River RV is weighed at the manufacturing facility prior to shipping. A label identifying the unloaded vehicle weight of the actual unit and the cargo carrying capacity is applied to every Forest River RV prior to leaving our facilities.

The load capacity of your unit is designated by weight, not by volume, so you cannot necessarily use all available space when loading your unit.

Actual towing capacity is dependent upon your particular loading and towing circumstances, which includes the GVWR, GAWR and GCWR as well as adequate trailer brakes. Please refer to the Operator's Manual of your vehicle for further towing information.

Note: Specifications are subject to change without notice.

EXTERIOR STORAGE CAPACITY

- o 34DS - 184 cu. ft.

CHASSIS & COCKPIT

- o Ford F53 Gas Class A Motor Home Chassis
- o 7.3L 445 cu in V-8 6-Speed TorqueShift Transmission 335 HP & 468 lb.-ft.
- o MORryde Chassis Conversion Upfit
- o Power Front Sun/Privacy Shade
- o Driver & Passenger Side Manual Pull Down Roller Shades
- o Two Tone 5-Year Ultra Leather Driver/Passenger Seating w/Double Stitching
- o Truck Bed Lined - Low Profile Cockpit Engine Cover
- o Driver/Passenger LED Map Lights
- o Driver/Passenger Speakers
- o Fixed Cockpit Diamond Plate Rubber Floor Mats
- o Adjustable 3 Point Seat Belts (Driver/Passenger)
- o Removable Pedestal Cockpit Conversation Table w/ Cup Holders
- o Molded ABS Ergonomic Cockpit Dash
- o Passenger Side Flip Over Work Station
- o Deep Passenger Side Glove Box
- o Passenger Side 110 & 12v Outlets
- o Driver & Passenger Side Molded Arm Rests w/ Cup Holder
- o Sony 10.1" Dash Radio AM/FM/Bluetooth/Color Back and Sideview Camera Monitor/Wireless Apple Car/Play & Android Auto
- o Center Switch Bank
- o Phone & Tablet Holder
- o Flush Access Panel (Top of Dash)
- o Multi-Port USB / 12V Charging Station

CONSTRUCTION & EXTERIOR

- o Vacuum Bonded Construction (Roof / Sidewalls / Floor)
- o Power Gear SlimRack®; Slideouts (Deep Slideouts Various Models)
- o Pearl Grey Gel-Coat Sidewalls w/ Matte Black Graphic Package
- o Pearl Grey Gel-Coated Fiberglass Front Cap w/ Auto Bonded Windshield & Lighted Logo
- o Matte Black Side-Swing Front Grill w/Mesh Bug Shield
- o Steel Firewall & A-Pillar Extension
- o Bi-LED Headlamps & Lower LED Fog Lights

- LED Turn Signals, LED Marker Lights & LED Strip/Turn Light
- Front License Plate Landing w/ Mounting Bracket
- Power / Heated Exterior Mirrors
- Body Mounted Side & Rear view Camera Package
- One Piece Fiberglass Roof w/ Extended Rain Spouts
- Heavy Duty Slam Latch Storage Compartment Doors
- 30" Wide Entry Door w/ Deadbolt Lock & Screen Door
- Triple Electric Hideaway Entrance Steps
- Rubberized Entry Assist Handle
- Max Flow Slider Windows
- Grey Rotocast Storage Boxes w/Drains
- Power Patio Awning w/LED Light
- Slideout Room Topper Awnings
- Outside Shower
- Dual Rear LED Tail Lights
- Rear License Plate Bracket
- Powder Coated Steel Rear Bumper
- 5,000 lb. Tow Hitch w/7-Way Plug (pre-wired for brake controller & charge line)
- Outside Entertainment Center w/12V LED Smart TV & Marine-Grade Speakers
- Quick Connect Exterior LP Fitting
- Stainless Steel Wheel Liners w/ Valve Extenders
- 32" Exterior 12V LED Smart TV

INTERIOR

- Solid Hardwood Cabinetry Throughout the Motorhome
- Stainless Steel Appliances
- Flush Floor Construction (no steps into cockpit)
- Interior Metal Entry Assist Handle
- Rubber Tread Entry Steps
- Power Fold-Away Overhead Bunk w/Ladder & Safety Net (350 lb. Weight Capacity)
- 84" Interior Ceilings
- LED Lighting Throughout (5000K Cool/Daylight White)(Dimmable in Living Area)
- Black Hardware, Appliances, Plumbing Fixtures, Glass Shower Door Frame
- IVC Residential Vinyl Flooring

- Custom Countertops w/Flip-up & Pullout Countertop Extensions
- Stainless Steel Kitchen Sink w/Bamboo Cutting Board & Roll Up Dryer
- Trash Can Storage Area Below Sink
- 30" Residential OTR Microwave Oven
- Large 15 cu. ft. 12V 3-Door Norcold Refrigerator
- 3-Burner Cooktop w/ 22" Oven, Flush Mount Glass Stove Cover
- Two Tone 5-Year Ultra Leather Theatre Seating w/ Cup Holders (33DS, 34DS)
- Two Tone 5-Year Ultra Leather Wrap Around Dinette Booth w/ Cup Holders (Comfort Lounge)
- Dual Access Dinette Storage w/ Doors
- Heavy Duty Full Extension Ball Bearing Drawer Guides
- Black Roller Shades w/ Residential Window Treatments
- 40" 12V LED Smart TV w/ hidden pantry area behind (34DS)
- Oversized Kitchen Pantries (All Models)
- Porcelain Toilet W/Foot Flush (34DS Macerator Stool Half Bath)
- Stainless Steel Under Mount Lavatory Sink
- 3 Piece Sliding Glass Shower Door
- 12V Power Vent Fan (Bathroom)
- Black Bathroom Trough Faucet
- Two Tone 5-Year Ultra Leather Jackknife Bunk Sofa w/ Filler Cushion & Cup Holders
- Latching Privacy Pocket Doors
- 72" x 80" Residential King Bed
- Under Bed Storage (32DS, 34DS)
- Bedroom Wardrobe
- Night Stands w/ Charging Stations
- Wash/Dryer Prep (N/A 32DS)
- 32" Flip Up 12V LED Smart Bedroom TV w/ Storage Behind
- CPAP Prep Bedroom Overhead

SYSTEMS

- Hydraulic 4-Point Auto Leveling Jacks
- 6KW NPS Yamaha Generator w/PureSine Inverter Technology (Manual/Keyless Start)
- Winegard 360+ HD TV & AM/FM Antenna w/ WiFi & LTE Controller
- Go Power Solar Controller with 200W Solar Panel Standard (Additional 200W Solar Panel Available as Part of "Power Package" Which Includes Additional Battle Born 100 Amp Lithium Coach Battery)

- 15,000 BTU Front Air Conditioner w/Heat Pump & 13,500 BTU Rear Air Conditioner
- Battery Disconnect Switch
- Keyed Overhead Bunk Lockout Switch
- Emergency Start Switch
- 6 Gallon Gas/Electric Water Heater (16.2 GPH Quick Recovery)
- Black Tank Flush
- 35,000 BTU Furnace
- 50 Amp Service
- 70 Amp Progressive Dynamics Power Converter w/ Charge Wizard
- USB Charging Stations
- 12V Maxx Air Power Roof Vent
- Carbon Monoxide & LP Detector
- Smoke Alarm
- Fire Extinguisher
- 5,000 BTU Linear Fireplace (33DS, 34DS)
- Forest River Command Center
- Tank Levels
- Battery Level Indicator
- LP Level Indicator
- Generator Hour Meter & Start-Stop
- Arctic Package (Heated Holding Tanks/Termination Valves)
- Water Pump Power Switch
- Water Heater LP Switch
- Slide-Out Controls
- Standard 100 Amp Battle Born Lithium Coach Battery (Additional Battle Born 100W Lithium Battery as Part of “Power Package” Option)

DéCOR

- Tobacco Solid Hardwood Cabinetry
- Mink Interior
- Seaport Storm Interior

OPTIONS

- Combo Washer/Dryer (N/A 32DS)
- Power Package - Includes One Additional 100 Amp Battle Born Lithium Battery and One Additional 200W Solar Panel