

# Nash



[www.northwoodmfg.com](http://www.northwoodmfg.com)



*Welcome* Northwood is pleased to introduce to you, this year's Nash Fifth Wheels & Travel Trailers. With numerous plans to choose from, there is a Nash Travel Trailer or 5th Wheel to fit the needs of nearly every RV buyer. Whether you're in the market for a compact travel trailer or a spacious 5th wheel, the Nash offers a wide variety of features and options sure to satisfy your needs. That's because The Nash was designed with the informed RV purchaser in mind. We invite you to take a look and you'll see why Nash is the RV of choice for the value minded buyer, and why the Nash is known as "Practical, Comfortable and Off Road Tough".

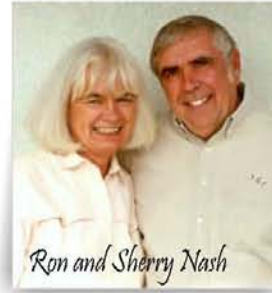

## *Kitchen*

Nash 5th-Wheels and Travel Trailers offer a spacious galley work area for food preparation. All coaches feature an extra large range with a 22" oven and range hood with overhead light and exhaust fan. All galleys feature a microwave oven. Self edge counters and dinette are standard, and a free-standing 4 chair dinette is a popular option available in some models. We provide ample storage in overhead cabinets, under counter cabinets, shelves, and drawers. Nash Travel Trailers and 5th-Wheels are rated among the safest and most durable coaches in their class.



*25S - Forest*



## *Slide Rooms*

Whether you're hunting, camping, working or adventuring, you'll find every floor plan is innovative, practical and comfortable.

Super slide models come with a jackknife sofa or optional hide-a-bed and a dinette that converts into an additional sleeping area or a free standing 4 chair dinette. Our Slide rooms travel on electric driven heavy duty rack and pinion rams and have 4 individual seals that maintain a seal when open, closed, and even while in transition.

## *Comfortable*

You'll be assured of a restful night's sleep in your Nash. All mattresses are deluxe queen size.

Bedrooms include coordinated bedspreads and window treatments, plenty of storage cabinets and a large underbed storage area in most models. Nash bedrooms also feature overhead cabinet doors and optional twin beds are also available in the 26X, 21-5R, 23-5A and 24-5N models. You will find many other residential features in the Nash offering you all the comforts of home.

# *Form & Function: Interiors that work beautifully*





**Exterior** The Northwood roof truss system bonds exterior plywood decking to the trusses as a unified structure that is amazingly strong yet light weight. All Nash models feature rigid fiberglass exterior siding that looks great and is durable and easy to maintain. The diamond plate front rock guard and rear bumper wrap are tough, attractive and built to last. The Nash is quality materials and construction from start to finish!

**Safety** The Nash has one of the highest highway safety ratings in the industry today, and all Nash 5th wheels and travel trailers are equipped with retractable, non-skid, double or triple steps for safe, easy access.

**Confidence** Beyond it's features, Nash has built it's reputation on quality materials and solid construction methods. Because the Nash is so durable, satisfied owners are pleased to discover how well the Nash maintains it's resale value ... if you're ever willing to turn loose of one!

*Beauty: It's more than skin deep!*





*Superior Frames:* At first glance, it might seem strange to include a picture of a steel I-Beam in our brochure, but we know that our chassis' are gorgeous! Everything rides on the quality of your chassis and suspension and Nash builds the best! Look underneath the coach and see for yourself, your family's safety is secure in the Nash. You'll feel the difference that a quality chassis, larger axles, bigger brakes and shocks will make as you



travel down the road or when you get adventurous and take your Nash off road. All wheel shocks are standard on all slide models and are optional on all non-slide models (except 17C).

**Heavy Gauge  
Structural Steel I-Beam Main Rail**

*Four Star Rating:* RV Consumer Group has given the Nash consistent high marks of Value, Reliability and Highway Control. The Nash is engineered for Safer Travel! Because our chassis are so solid, you will feel the difference when towing your Nash down the highway.



*The Nash will go where competitors fear to tread!*



*22H*



# Nash

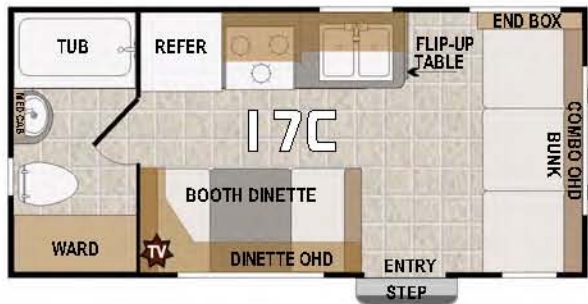

*Just like home,* the forced air ducted heating and cooling systems in your Nash provide fast winter warm-up and quick summer cool down. (Except the 17C & 19B)

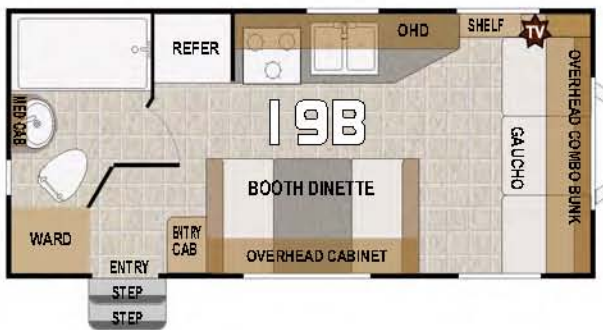

The heating system also circulates warm air to our '4-Season' fully enclosed & insulated holding tanks (Except the 17C). The Nash is a big seller in cold Northern climates and blistering southern climates. All Nash's come standard with R18 insulation in the roof and R7 insulation in the walls. Thermal pane windows are available on all Nash's and so are storm windows.



**TV** Indicates pre wired locations where TV's can be installed

## Smart Features

All Nash's are equipped with a Charge Wizard battery management system to maximize your battery performance and all LPG tanks are connected through an auto change-over regulator to switch from the empty tank to the full supply when the first is emptied.

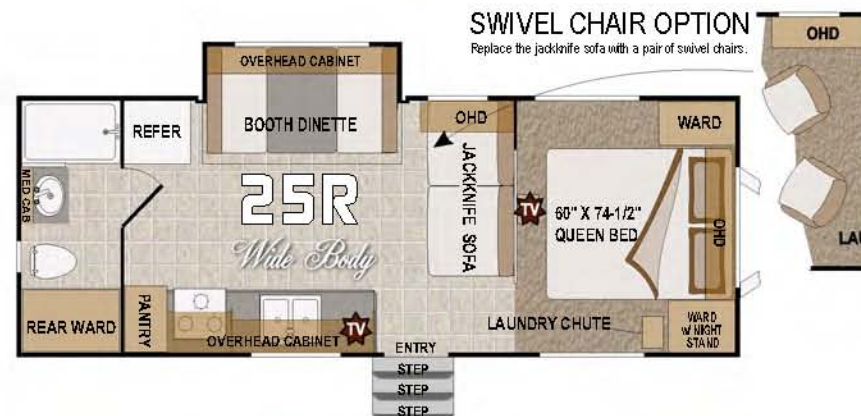







# Nash 5th Wheel Floor Plans

*Nash is Built Right!*

Our one piece heavy gauge roof membrane and our tongue-in-groove plywood floor decking both provide excellent durability and longevity. Thick commercial grade vinyl flooring and construction grade dimensional lumber are standard materials in the Nash.



JACK/JILL BED & BUNK OPTION

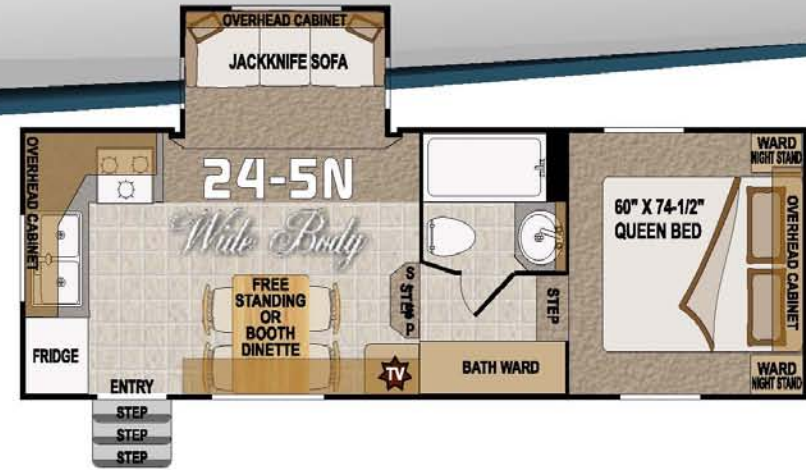

We assemble our coaches using the best proven construction methods and materials too.

Our custom cabinet production facility uses face frame construction & real plywood shelving (not chipboard).

\* Twin Beds (32" x 75") are available on the 26X, 21-5R, 23-5A and 24-5N



Indicates pre wired locations where TV's can be installed



# These Features are Standard in Every Nash Fifth Wheel & Travel Trailer!

## In Every Nash

- Fiberglass Exterior Siding
  - Diamond Plate Front Apron
  - Patio Awning
  - Back-Up Lights
  - 2000 Lb. Tongue Jack (Travel Trailers)
  - LPG Regulator w/Auto Change Over
  - LPG Quick Connect
  - One-piece rubber Roof
  - R-18 Insulation In Ceiling
  - Northwood Roof Truss System
  - Dual Battery Rack
  - Marine Toilet w/Foot Pedal
  - Roadside Utility Light
  - Radial Tires
  - High Payload Axles, Tires & Wheels
  - All Wheel Shocks (slide-out models)
  - All Wheel Shock Mounts\*\* (non-slide models)
  - Electric Brakes On All Wheels
  - Chrome Wheels, Lug Nuts, Hub Covers
  - Rear Mount Spare w/cover
  - Marine Style Exterior Shower
  - Entry Assist Handle
  - Large Capacity Exterior Access Storage Compartments with One Inch Thick Insulated / Locking Doors, Quality Seals and All Metal Latches, Catches, and Pulls
  - Enclosed, Heated Fresh Water Tank\*\*
  - Enclosed, Heated Holding Tanks\*\*
- Built-In Black Water Tank Flush
  - Vented / Emergency Exit
  - Semi-automatic Winterization System
  - AC/DC Converter
  - RV Systems Monitor Panel
  - Charge Wizard Battery Mgmt. System
  - Solar Panel Ready
  - Flat Screen TV Ready
  - Gas / Electric DSI Water Heater
  - Kenwood AM/FM CD Player
  - Air Conditioner
  - Microwave Oven
  - Double Door Refrigerator
  - Extra Large 22" Range w/ Broiler
  - Range Cover
  - Range Back Splash
  - Galley Fluorescent Light
  - Throw Pillows
  - Below Bed Storage
  - Dinette Booth
  - Large Lavvy Bowl
  - Deep Dbl Galley Sink w/Hi Rise Faucet
  - LPG Leak Detector
  - CO Detector
  - Smoke Detector
  - Fire Extinguisher
  - GFI Circuit Protection

\*\* This feature is not available in the 17C model

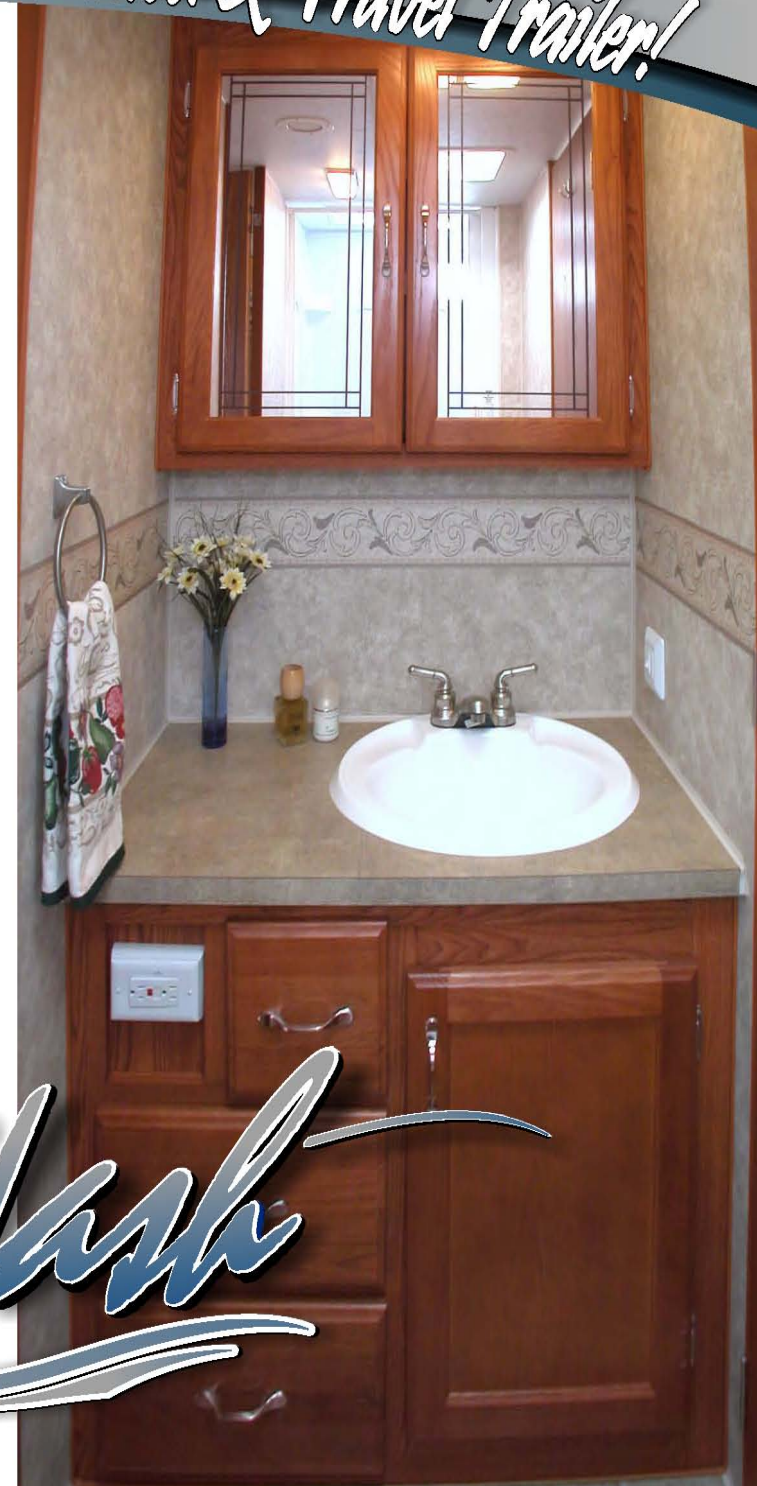

# Nash



# A Solid Foundation

## Structural Steel:

All Northwood 5th Wheels & Travel Trailers are built with structural steel main rails of I-beam or C-channel. The full length main rails and full width cross members insure a solid structure for easier towing and a quality feeling structure under foot. Each chassis also include Z cross members for additional strength.

We design and build our own chassis to guarantee quality and excellent driveability. We use only top quality Rustoleum finish to prevent rust, and also double prime our welds for added protection.



## Camber Welds & Dual Battery Rack:

Special welds are applied along the top of the main rails to create camber. Our cambered frame has greater load carrying capabilities than others. Our chassis functions in the same way as a pre-stressed structural beam. The Nash won't sag like the competitors models under full load weight - even after many years of service. All Northwood coaches include dual battery racks that are welded directly to the frame. Travel trailers include a large capacity, dual LPG tank rack that is conveniently located at the trailer tongue for quick access.



## Cast Iron Gas Manifolds:

We nest our LP gas manifold line within the chassis structure to protect it from damage. We use large dimension pipe to improve gas flow to all appliances. We also use brass fittings to attach appliance feed lines to the manifold. All of these considerations make our gas supply system extremely durable and problem free. LP appliance feed lines are protected with vinyl sleeves and sealed with silicone when they pass thru the floor.



## More Standard Features

One Inch Thick Insulated/Locking Exterior Storage Compartment Doors

Large Capacity Exterior Access Storage Compartments

With Top Quality Automotive Weather Seals Around All Storage Doors

Metal Latches, Metal Catches and Metal Pulls on Doors



Marine Style Exterior Shower

Shock Mounts All Wheels (Except 17C)



Dual 30# or 40# LP Tanks



12 Volt Exterior Lighting at Hitch, Waste Dump and Patio Areas





# A True 4 Seasons Coach

## Fully Insulated Compartment:

The Nash is a true 4-Season Coach. Our fully insulated holding tank area circulates warm air around the suspended tanks providing the best protection from freezing. In addition, the termination gate valves have been located inside the heated compartments to prevent freezing. The tanks are large and will hold up to 76 gallons of fresh water capacity, 75 gallons of gray water

storage, and up to 44 gallons in the black storage tank. The black holding tank comes with an internal sani-flush system for easy maintenance. The flush system is simple to use and makes maintenance of the waste holding tank quick and easy. All Nashes are designed with your convenience in mind and this feature is standard in all Nash Fifth Wheels and Travel Trailers!



## Four Star Rating

RV Consumer Group has given the Nash consistent high marks of Value, Reliability and Highway Control. The Nash is engineered for Safer Travel! Because our chassis are so solid, you will feel the difference when towing your Nash down the highway.



\* Average Rating of all models for Value, Reliability, and Highway Control (Independent non-profit rating organization)



Built-in Black Water Tank Flush System is Standard on ALL Models

Photos in this brochure contain optional and standard items, and decor items. See dealer for specific information regarding standard equipment and optional features. Photos and drawings are representative of Northwood products and may differ slightly from actual production models. Northwood continually upgrades and improves its products and reserves the right to change specifications without notice. Check with your authorized dealer for update information. Northwood Manufacturing \* 59948 Downs Road \* PO Box 3359 \* La Grande, OR 97850 \* (541)962-6274 \* [www.northwoodmfg.com](http://www.northwoodmfg.com)

## More Optional Features



5th Airborne Shock Absorbing Pin Box



Flat Panel TV



Onan Generators



Solar Panels  
50 & 100 watt



Auto-Scan  
Satellite Dish



# Features and Options

|  | 17C | 19B | 22GQ | 22H | 25P | 25R | 25S | 26X | 26Z2 | 27E | 27T | 21-5R | 23-5A | 24-5N | 27-5B | 27-5L |
|--|-----|-----|------|-----|-----|-----|-----|-----|------|-----|-----|-------|-------|-------|-------|-------|
| <b>CONSTRUCTION</b>                    |     |     |      |     |     |     |     |     |      |     |     |       |       |       |       |       |
| Storm Windows                          | 0   | 0   | 0    | 0   | 0   | 0   | 0   | 0   | 0    | 0   | 0   | 0     | 0     | 0     | 0     | 0     |
| Thermal Pane Windows                   | 0   | 0   | 0    | 0   | 0   | 0   | 0   | 0   | 0    | 0   | 0   | 0     | 0     | 0     | 0     | 0     |
| <b>CHASSIS, FRAME &amp; SUSPENSION</b> |     |     |      |     |     |     |     |     |      |     |     |       |       |       |       |       |
| Shock Absorbers - All Wheels           | N   | 0   | 0    | 0   | 0   | 0   | 0   | 0   | 0    | 0   | 0   | 0     | 0     | 0     | 0     | 0     |
| Stabilizer Jacks                       | 0   | 0   | 0    | 0   | 0   | 0   | 0   | 0   | 0    | 0   | 0   | 0     | 0     | 0     | 0     | 0     |
| 12V Power Jack                         | 0   | 0   | 0    | 0   | 0   | 0   | 0   | 0   | 0    | 0   | 0   | 0     | 0     | 0     | 0     | 0     |
| 16" Tire/Wheel/Spare Upgrade           | N   | N   | N    | N   | N   | N   | N   | N   | N    | N   | N   | N     | N     | N     | N     | N     |
| <b>PLUMBING</b>                        |     |     |      |     |     |     |     |     |      |     |     |       |       |       |       |       |
| 6 Gal DSI Gas/Electric Water Heater    | S   | S   | S    | S   | S   | S   | S   | S   | S    | N   | N   | S     | S     | N     | N     | N     |
| 10 Gal DSI Gas/Electric Water Heater   | N   | N   | N    | N   | S   | N   | N   | S   | S    | S   | S   | N     | N     | S     | S     | S     |
| <b>ELECTRICAL</b>                      |     |     |      |     |     |     |     |     |      |     |     |       |       |       |       |       |
| Generator Ready                        | N   | 0   | 0    | 0   | 0   | 0   | 0   | 0   | 0    | 0   | 0   | N     | N     | N     | 0     | S     |
| 2.5 Onan Generator LP                  | N   | 0   | 0    | 0   | 0   | 0   | 0   | 0   | 0    | 0   | 0   | N     | N     | N     | 0     | N     |
| 3.6 Onan Generator LP                  | N   | N   | N    | N   | N   | N   | N   | N   | N    | N   | N   | N     | N     | N     | 0     | 0     |
| TV Antenna                             | 0   | 0   | 0    | 0   | 0   | 0   | 0   | 0   | 0    | 0   | 0   | 0     | 0     | 0     | 0     | 0     |
| <b>LP GAS</b>                          |     |     |      |     |     |     |     |     |      |     |     |       |       |       |       |       |
| Dual 30# LPG Bottles                   | S   | S   | S    | S   | S   | S   | S   | S   | S    | S   | S   | N     | S     | S     | S     | N     |
| Single 40# LPG Bottle                  | N   | N   | N    | N   | N   | N   | N   | N   | N    | N   | N   | S     | S     | N     | N     | N     |
| Dual 40# LPG Bottles                   | 0   | 0   | 0    | 0   | 0   | 0   | 0   | 0   | 0    | 0   | 0   | N     | N     | N     | S     | S     |

**KEY:** S Standard (no charge) O Option Available on Request N Not Available in this Model

Your Nash Dealer

|  | 17C | 19B | 22GQ | 22H | 25P | 25R | 25S | 26X | 26Z2 | 27E | 27T | 21-5R | 23-5A | 24-5N | 27-5B | 27-5L |
|--|-----|-----|------|-----|-----|-----|-----|-----|------|-----|-----|-------|-------|-------|-------|-------|
| <b>Full 12 Month Warranty (All Models)</b> |     |     |      |     |     |     |     |     |      |     |     |       |       |       |       |       |
| <b>AIR CONDITIONING</b>                    |     |     |      |     |     |     |     |     |      |     |     |       |       |       |       |       |
| 13.5K BTU A/C w/out Ducting                | S   | S   | N    | N   | N   | N   | N   | N   | N    | N   | N   | S     | N     | N     | N     | N     |
| 13.5K BTU A/C w/ Ducting                   | N   | N   | S    | S   | S   | S   | S   | S   | S    | S   | S   | N     | S     | S     | S     | S     |
| 15.0K BTU A/C w/ Ducting                   | N   | N   | N    | N   | 0   | 0   | 0   | 0   | 0    | 0   | 0   | N     | 0     | 0     | 0     | 0     |
| <b>BATHROOM / LAVY</b>                     |     |     |      |     |     |     |     |     |      |     |     |       |       |       |       |       |
| Shower Pan                                 | N   | 0   | 0    | 0   | 0   | 0   | 0   | 0   | 0    | 0   | 0   | 0     | 0     | 0     | 0     | 0     |
| Tub/Shower                                 | S   | S   | S    | S   | S   | S   | S   | S   | S    | S   | S   | S     | S     | S     | S     | S     |
| Shower Screen                              | N   | 0   | 0    | 0   | 0   | 0   | 0   | 0   | 0    | 0   | 0   | 0     | 0     | 0     | 0     | 0     |
| Bathroom Skylight                          | 0   | 0   | 0    | 0   | 0   | 0   | 0   | 0   | 0    | 0   | 0   | 0     | 0     | 0     | 0     | 0     |
| <b>KITCHEN / GALLEY</b>                    |     |     |      |     |     |     |     |     |      |     |     |       |       |       |       |       |
| Microwave                                  | S   | S   | S    | S   | S   | S   | S   | S   | S    | S   | S   | S     | S     | S     | S     | S     |
| Range Cover                                | S   | S   | S    | S   | S   | S   | S   | S   | S    | S   | S   | S     | S     | S     | S     | S     |
| Double Door 6cu Ft Refer                   | S   | S   | S    | S   | N   | N   | S   | N   | S    | N   | N   | S     | S     | S     | S     | S     |
| Extra Large 8' Refer                       | N   | N   | N    | N   | S   | S   | N   | S   | N    | S   | S   | N     | N     | S     | S     | S     |
| Kitchen Skylight                           | N   | 0   | 0    | 0   | 0   | 0   | 0   | 0   | 0    | 0   | 0   | 0     | 0     | 0     | 0     | 0     |
| <b>INTERIOR</b>                            |     |     |      |     |     |     |     |     |      |     |     |       |       |       |       |       |
| Booth Dinette                              | S   | S   | S    | S   | S   | S   | S   | S   | S    | S   | S   | S     | S     | S     | S     | S     |
| Free-standing Dinette                      | N   | N   | N    | N   | N   | N   | N   | N   | N    | N   | N   | N     | N     | 0     | N     | N     |
| Hide-a-Bed                                 | N   | N   | N    | N   | N   | N   | N   | N   | N    | N   | N   | N     | N     | N     | N     | N     |
| Jackknife Sofa                             | N   | N   | S    | S   | S   | S   | S   | S   | S    | S   | S   | S     | S     | S     | S     | S     |
| One Swivel Rocker                          | N   | N   | N    | N   | N   | N   | N   | S   | N    | N   | N   | N     | N     | 0     | N     | S     |
| Two Swivel Rockers                         | N   | N   | N    | N   | 0   | N   | N   | N   | S    | N   | N   | N     | N     | N     | N     | N     |
| AM/FM CD Player                            | S   | S   | S    | S   | S   | S   | S   | S   | S    | S   | S   | S     | S     | S     | S     | S     |
| <b>EXTERIOR</b>                            |     |     |      |     |     |     |     |     |      |     |     |       |       |       |       |       |
| Exterior Shower                            | S   | S   | S    | S   | S   | S   | S   | S   | S    | S   | S   | S     | S     | S     | S     | S     |
| Awning                                     | S   | S   | S    | S   | S   | S   | S   | S   | S    | S   | S   | S     | S     | S     | S     | S     |
| Roof Rack and Ladder                       | 0   | 0   | 0    | 0   | 0   | 0   | 0   | 0   | 0    | 0   | 0   | 0     | 0     | 0     | 0     | 0     |
| BBQ Grill                                  | 0   | 0   | 0    | 0   | 0   | 0   | 0   | 0   | 0    | 0   | 0   | 0     | 0     | 0     | 0     | 0     |

|                                     | Nash Travel Trailers (*) Designates Slide-out |             |             |             |             |             |             |             |             |             |             | 5th Wheels  |             |             |             |             |
|-------------------------------------|---|-------------|-------------|-------------|-------------|-------------|-------------|-------------|-------------|-------------|-------------|-------------|-------------|-------------|-------------|-------------|
| Model Number                        | 17C   | 19B         | 22GQ        | 22H         | 25P*        | 25R*        | 25S         | 26X*        | 26Z2*       | 27E         | 27T*        | 21-5R       | 23-5A*      | 24-5N*      | 27-5B*      | 27-5L*      |
| Dry Axle Weight (approx. Lbs.)      | 3210  | 3900        | 4120        | 4190        | 5810        | 5660        | 4490        | 5930        | 6000        | 5490        | 6140        | 4420        | 5520        | 5900        | 6030        | 7140        |
| Dry Hitch Weight (approx. Lbs.)     | 490   | 400         | 520         | 590         | 790         | 630         | 580         | 970         | 800         | 800         | 850         | 770         | 840         | 1120        | 1420        | 1500        |
| Net Carrying Capacity               | 1900  | 2700        | 2860        | 2720        | 3400        | 3710        | 2950        | 3900        | 3200        | 3710        | 3810        | 1810        | 3640        | 2980        | 2550        | 3360        |
| Gross Dry Weight-lbs                | 3700  | 4300        | 4640        | 4780        | 6600        | 6290        | 5050        | 6900        | 6800        | 6290        | 6990        | 5190        | 6360        | 7020        | 7450        | 8640        |
| Gross Vehicle Weight (GVWR)-Lbs.    | 5600  | 7000        | 7500        | 7500        | 10000       | 10000       | 8000        | 10800       | 10000       | 10000       | 10800       | 7000        | 10000       | 10000       | 10000       | 12000       |
| Exterior Length (approx. w/hitch)   | 18'9"   | 21'3"       | 23'10"      | 23'10"      | 27'1"       | 27'3"       | 28'11"      | 28'5"       | 29'8"       | 28'11"      | 29'8"       | 24'4"       | 25'6"       | 28'2"       | 29'6"       | 28'1"       |
| Exterior Height (approx. w/o A/C)   | 10'8"   | 10'1"       | 10'3"       | 10'2"       | 10'11"      | 10'8"       | 10'3"       | 11'2"       | 10'7"       | 10'9"       | 11'2"       | 10'7"       | 11'2"       | 11'4"       | 11'9"       | 12'6"       |
| Exterior Width (approx. w/o awning) | 7'6"  | 8'          | 8'          | 8'          | 8'6"        | 8'6"        | 8'          | 8'          | 8'6"        | 8'6"        | 8'          | 8'          | 8'          | 8'6"        | 8'6"        | 8'          |
| Tire Size                           | ST205 75R15                                   | ST205 75R15 | ST205 75R15 | ST205 75R15 | ST225 75R15 | ST225 75R15 | ST205 75R15 | ST235 80R16 | ST225 75R15 | ST225 75R15 | ST235 80R16 | ST205 75R15 | ST225 75R15 | ST225 75R15 | ST225 75R15 | ST235 80R16 |
| Load Range                          | C   | C           | C           | C           | D           | D           | C           | E           | D           | D           | E           | C           | D           | D           | D           | E           |
| Fresh Water Capacity (approx gal)   | 46  | 46          | 44          | 46          | 50          | 58          | 58          | 67          | 58          | 63          | 66          | 44          | 45          | 56          | 50          | 76          |
| Gray Water Tank (approx. gallons)   | 25  | 44          | 41          | 41          | 40/35       | 41          | 41          | 30/25       | 40          | 40          | 54          | 30          | 30          | 35/35       | 40/30       | 35/35       |
| Black Water Tank (approx. gallons)  | 27  | 35          | 35          | 35          | 35          | 35          | 35          | 44          | 35          | 35          | 42          | 40          | 40          | 35          | 35          | 35          |
| LPG Capacity (approx. gallons)      | 14  | 14          | 14          | 14          | 14          | 14          | 14          | 14          | 14          | 14          | 14          | 10          | 10          | 14          | 14          | 20          |
| CSA - Canadian Dealers Only         | YES   | YES         | YES         | YES         | YES         | YES         | YES         | YES         | YES         | YES         | YES         | YES         | YES         | YES         | YES         | YES         |
| Auto Ignition Furnace (1,000 BTU's) | 20  | 20          | 25          | 25          | 25          | 25          | 25          | 30          | 25          | 25          | 30          | 20          | 25          | 35          | 35          | 35          |

**Popular Options Available**

- 12 Volt Power Jack
- Storm Windows
- Thermal Pane Windows
- 3 Speed Fan Vent w/Reverse
- Hide-a-Bed
- Slide-Out Awning Topper
- Solar Panels - 50w or 100w
- Satellite Dishes
- 15.0K Air Conditioner
- 13.5K Low Profile A/C

See your dealer for availability in certain models  
Print Date 10/09



Weights include slide-out (if applicable). Some options are not included in the weights displayed  
**Northwood Manufacturing, 59948 Downs Rd., PO Box 3359, La Grande, OR 97850 - (541) 962-6274 - www.northwoodmfg.com - Nash**  
 Photos, drawings, dimensions and weights are presented as accurate but may differ from current production models. We continually upgrade & improve our products and reserve the right to change any specifications without notice. Please see your authorized Northwood dealer for updated information.