

CHATEAU &  
CHATEAU SUPER C

**MADE TO FIT**  
YOUR PURSUITS



**CHATEAU &  
CHATEAU SUPER C**

 BY THOR MOTOR COACH

WHEN WE SAY *MADE TO FIT*,  
WE MEAN IT.

Wherever your pursuits may take you, let the Chateau be the catalyst that makes the journey a memorable one. The Chateau offers an impressive line-up of floor plans, standard equipment and unique options to help make the motorhome that is *Made to Fit* your pursuits.



22E | TAUPE METALLIC | SYDNEY MAPLE



31E | ARABIAN SPICE | OLYMPIC CHERRY



23U | TAUPE METALLIC | OLYMPIC CHERRY



28F | DARK RUM | SYDNEY MAPLE



# CLASS C



# BEAUTY INSIDE & OUT

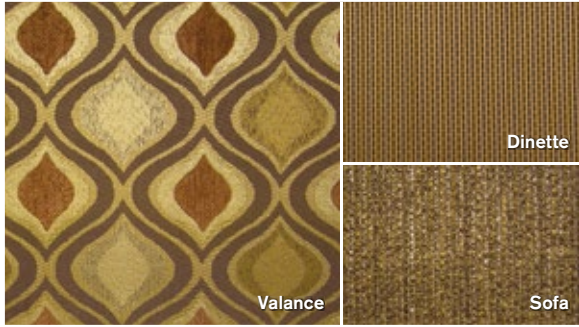

ARABIAN SPICE

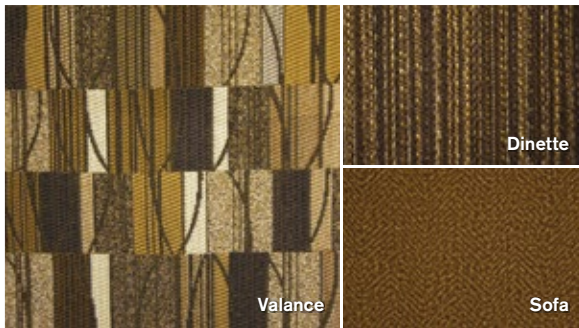

DARK RUM

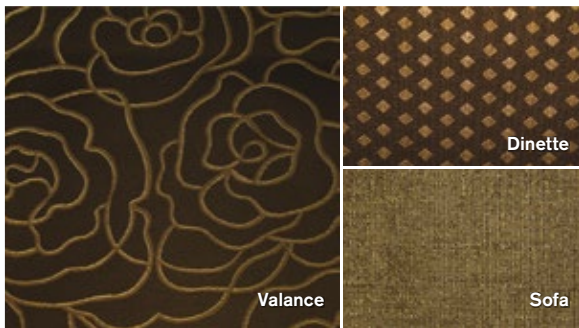

TAUPE METALLIC

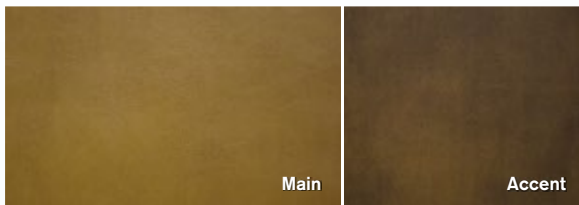

OPTIONAL LEATHERETTE



FLOORING



OLYMPIC CHERRY



SYDNEY MAPLE



RAISED PANEL  
OLYMPIC CHERRY  
31E, 31L & 31W ONLY



RAISED PANEL  
SYDNEY MAPLE  
31E, 31L & 31W ONLY

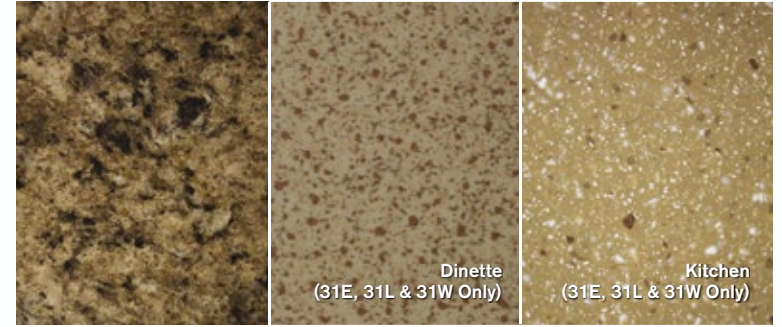

COUNTERTOPS



STANDARD GRAPHICS



RED VELVET HD-MAX™ 



STARLIGHT HD-MAX™ 

# CLASS C STANDARDS & OPTIONS

## CONSTRUCTION & EXTERIOR

- Slick Fiberglass Exterior with Standard Graphics Package
- Rotocast Storage Compartments
- MEGA Storage™ Compartment (22E, 23U, 24C, 28Z & 29G)
- Flush Mount Radius Luggage Doors
- Power Patio Awning with Integrated LED Lighting
- Slideout Room Awning (24C, 26A, 28F, 28Z, 29G, 31E, 31L & 31W)
- 3TRAX™ Wall Slide System (28F, 31E & 31W) 
- Framed Radius Windows (22E, 23U, 24C, 26A, 28F, 28Z & 29G)
- Frameless Windows (31E, 31L & 31W)
- Roof Ladder

## CONSTRUCTION & EXTERIOR OPTIONS

- HD-MAX™ Exterior with Graphics Package
- Automatic Hydraulic Leveling Jacks (OPT 28F, 29G & 31L / STD 31E & 31W)
- Outside Shower (STD 31E, 31L & 31W)

## AUTOMOTIVE & COCKPIT

- Touchscreen AM/FM Dash Radio with DVD/CD Player & Bluetooth®
- Deluxe Exterior Mirrors
- Power Windows & Door Locks
- Cruise Control
- Windshield Privacy Curtain
- Aluminum Running Boards
- 8,000-lb. Trailer Hitch with 7-pin Round Connector\*

## AUTOMOTIVE & COCKPIT OPTIONS

- Heated/Remote Exterior Mirrors with Integrated Side View Cameras (Requires Back-up Monitor)
- Back-Up Monitor (STD 28F, 28Z, 29G, 31E, 31L & 31W)
- Wood Dash Applique
- Leatherette Captain's Chairs
- Power Driver's Seat (28F, 28Z, 29G, 31E, 31L & 31W)
- Cockpit Carpet Mat
- Keyless Entry & Valve Stem Extenders (STD 28F, 28Z, 29G, 31E, 31L & 31W)
- Wheel Liners (STD 28F, 28Z, 29G, 31E, 31L & 31W)
- Spare Tire

## INTERIOR

- 82" Interior Ceiling Height
- 84" Interior Ceiling Height (31E, 31L & 31W)
- Residential Vinyl Flooring Throughout
- Ceiling Ducted Air Conditioning System (23U, 26A, 28F, 28Z, 29G, 31E, 31L & 31W)
- LED Ceiling Lights
- Raised Panel Upper Cabinet Doors (31E, 31L & 31W)
- Window Privacy Shades
- Fabric Barrel Chair (23U)

- Fabric Jack-Knife Sofa (26A, 28Z, 29G, 31E & 31W)
- Leatherette L-Shaped Sofa with Pedestal Table (28F)
- Leatherette Sofa with Air Bed (31L)
- Fabric Dream Dinette™ Booth (26A, 28Z, 29G, 31E, 31L & 31W)
- Fabric U-Shaped Dinette (22E, 23U & 24C)

## INTERIOR OPTIONS

- Leatherette U-Shaped Dinette (23U & 24C)
- Leatherette Jack-Knife Sofa (26A, 28Z, 29G, 31E & 31W)
- Single Child Safety Tether in Booth Dinette
- Dual Child Safety Tethers in Booth Dinette (26A, 28Z, 29G, 31E, 31L & 31W)
- 12-volt Attic Fan in Cab-Over Bunk

## KITCHEN

- Double Door Refrigerator (22E, 23U, 24C, 26A, 28F, 28Z, 29G, 31E & 31L)
- 18 cu. ft. Residential Refrigerator (31W)
- 3-Burner Gas Cooktop
- Microwave Oven
- Laminate Kitchen Countertops
- Flip-Up Countertop Extension (22E, 23U & 24C)
- Large, Single Bowl Kitchen Sink (22E)
- Large, Double Bowl Kitchen Sink (23U, 24C, 26A, 28F, 28Z, 29G, 31E, 31L & 31W)
- Pantry (24C, 28F, 31E, 31L & 31W)

## KITCHEN OPTIONS

- 3-Burner Gas Cooktop with Oven (STD 28F, 28Z, 29G, 31E, 31L & 31W)
- Convection Microwave Oven (N/A 31E, 31L & 31W)

## BEDROOM & BATHROOM

- Denver Mattress® Queen Size Bed (22E, 23U, 26A, 28Z, 29G, 31E, 31L & 31W)
- Denver Mattress® King Size Bed (28F)
- Bedspread & Pillow Shams
- Bunk Beds in Hallway Slideout (31E)
- Porcelain Toilet
- Shower with Curtain (22E & 24C)
- Shower with Glass Door (23U, 26A, 28F, 28Z, 29G, 31E, 31L & 31W)

## BEDROOM & BATHROOM OPTION

- 12-volt Attic Fan in Bedroom

## ENTERTAINMENT

- 24" LED TV on Manual Swivel in Cab-Over (22E)
- Cab-Over Entertainment Center with 32" LED TV & DVD Player on Manual Swivel (23U, 24C, 26A, 31E & 31W)
- Entertainment Center with 32" LED TV & DVD Player in Living Area (28F, 28Z, 29G & 31L)

- Two (2) 13" LED TVs & DVD Player in Bunk Beds (31E)\*
- Bluetooth® Coach Radio with Exterior Speakers (28F, 28Z, 29G, 31E, 31L & 31W)
- Power Charging Center for Electronics (28F, 28Z, 29G, 31E, 31L & 31W)
- Cable TV Ready
- Exterior Kitchen with 2.5 cu. ft. Refrigerator, Sink & Portable Gas Grill (29G)

## ENTERTAINMENT OPTIONS

- Cab-Over Entertainment Center (IPO STD Living Area TV) with 39" LED TV & Sound Bar (22E, 23U, 24C, 26A, 28F, 31E, 31L & 31W)
- 24" LED TV & DVD Player in Bedroom (OPT 26A, 28F & 28Z / STD 31E, 31L & 31W)
- 32" LED TV & DVD Player in Bedroom (29G)
- Exterior 32" LED TV (28F, 28Z, 29G, 31E, 31L & 31W)
- Additional Storage in place of Exterior Kitchen (29G)

## ELECTRICAL & PLUMBING

- Cummins Onan® RV QG 4000 Gas Generator
- 30-amp Service with Shoreline Power Cord
- 1000-watt Inverter with Automatic Generator Start (31W)
- Automatic Shoreline-to-Generator Transfer Switch
- 13,500 BTU Roof Air Conditioner in Front
- 6-gallon DSI Gas/Electric Water Heater
- Water Heater Bypass System
- Systems Control Center
- **Rapid Camp™** Wireless Control System (31E, 31L & 31W)

## ELECTRICAL & PLUMBING OPTIONS

- 15,000 (IPO 13,500) BTU Roof Air Conditioner in Front (23U, 26A, 28F, 28Z, 29G, 31E, 31L & 31W)
- Holding Tanks with Heat Pads (STD 28F, 28Z, 29G, 31E, 31L & 31W)
- Second Auxiliary House Battery (STD 31W)

## PREMIER PACKAGE - STANDARD ON 31E, 31L & 31W

- 30" Over-the-Range Microwave Oven
- Solid Surface Kitchen Countertops & Sink Covers
- Premium Roller Shades
- Water Filter System at Kitchen Sink
- Enclosed Sewer Area for Sewer Tank Valves
- Black Tank Flush System

\*INCLUDED ON UNITS BUILT AFTER 10/1/14



# CLASS C FLOOR PLANS

22E

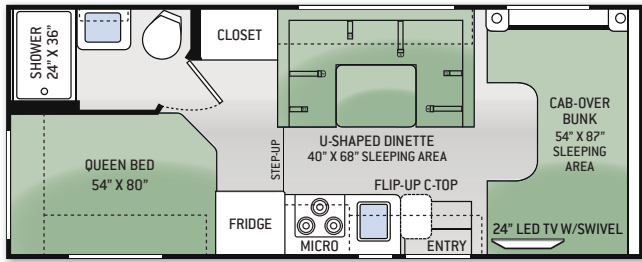

26A

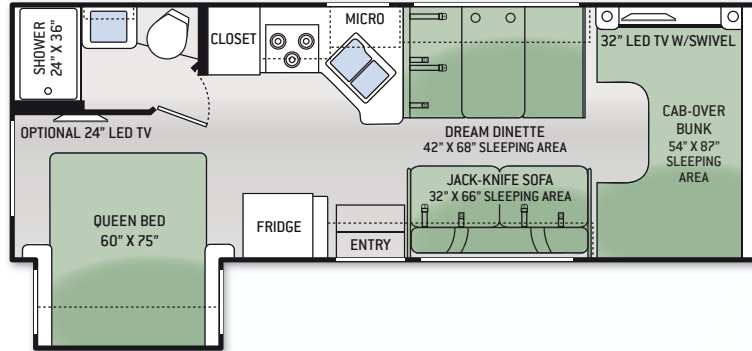

23U

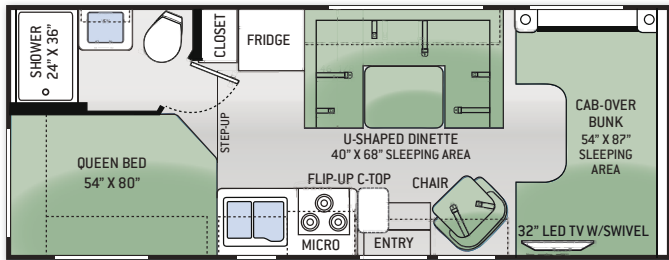

28F

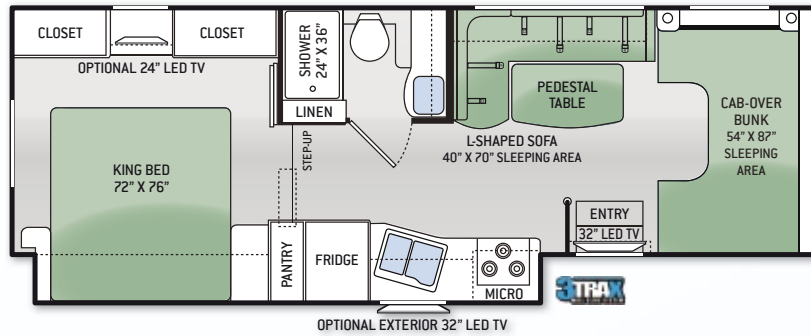

24C

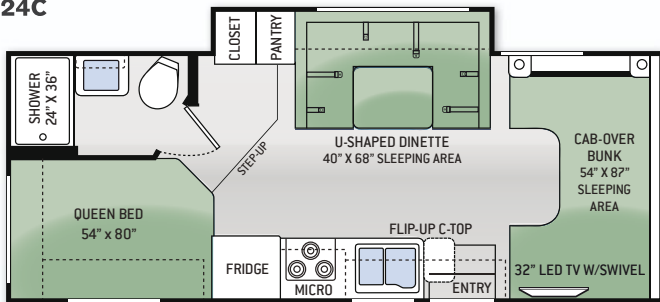

28Z

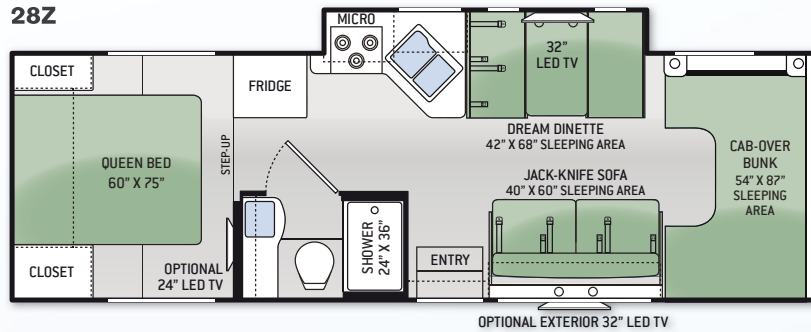

29G

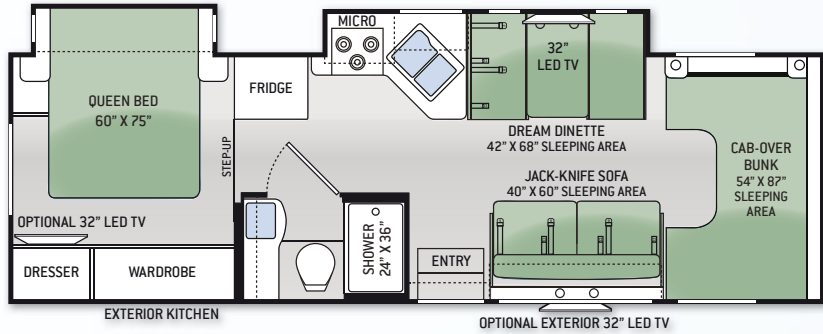

31L

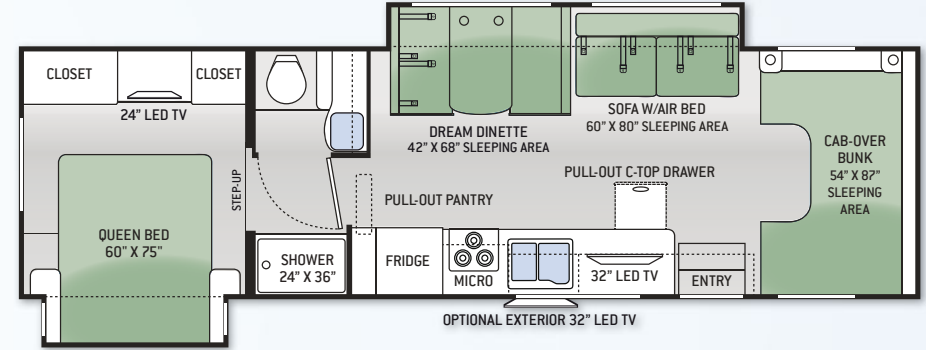

31E

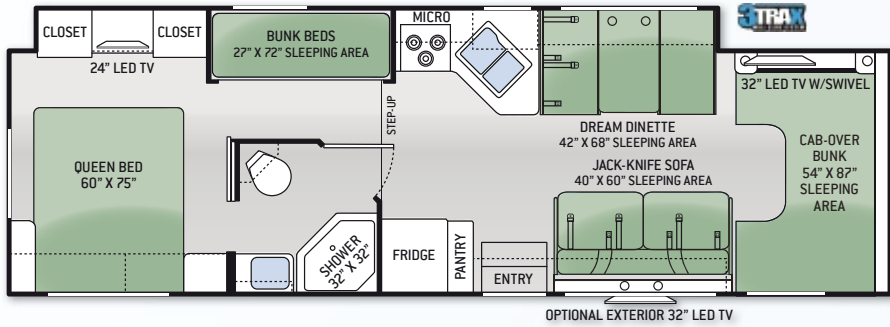

31W

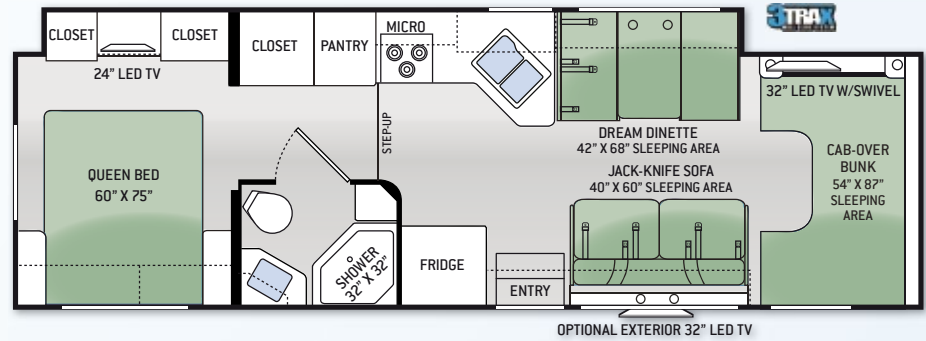

FLOOR PLAN	22E	23U	24C	26A	28F	28Z	29G	31E	31L	31W
Chassis	Ford / Chevy	Ford / Chevy	Ford / Chevy	Ford / Chevy	Ford	Ford	Ford	Ford	Ford	Ford
Gross Vehicle (GVWR)	12,500 / 12,300	12,500 / 12,300	12,500 / 12,300	12,500 / 12,300	14,500	14,500	14,500	14,500	14,500	14,500
Gross Combined (GCWR)	18,500 / 16,000	18,500 / 16,000	18,500 / 16,000	18,500 / 16,000	22,000	22,000	22,000	22,000	22,000	22,000
Wheel Base	158" / 159"	158" / 159"	168" / 169"	183" / 184"	220"	212"	212"	223"	223"	223"
Exterior Length (w/o ladder)	23'-11" / 24'-5"	24'-10" / 25'-4"	24'-11" / 25'-5"	27' / 27'-6"	29'-7"	29'-11"	29'-11"	32'-7"	32'-7"	32'-2"
Exterior Height (w/AC)	10'-10"	10'-10"	10'-10"	10'-10"	10'-10"	10'-10"	10'-10"	11'	11'	11'
Exterior Width (w/o mirrors)	99"	99"	99"	99"	99"	99"	99"	99"	99"	99"
Interior Height (living area)	82"	82"	82"	82"	82"	82"	82"	84"	84"	84"
Awning Size	15'	15'	16'	11'	14'	14'	14'	16'	16'	16'
Fuel (gal)	55 / 57	55 / 57	55 / 57	55 / 57	55	55	55	55	55	55
LPG (lbs)	40.9	40.9	40.9	40.9	40.9	40.9	40.9	40.9	40.9	40.9
Fresh/Waste/Gray Water (gal)	50 / 24.5 / 37	40 / 24.5 / 38.5	40 / 24.5 / 38.5	40 / 26 / 26	40 / 25 / 32	40 / 26 / 32	39 / 26 / 32	40 / 28 / 28	40 / 31 / 29	40 / 28 / 28
Water Heater (gal)	6	6	6	6	6	6	6	6	6	6
Furnace (BTUs)	20,000	20,000	20,000	30,000	30,000	30,000	30,000	30,000	30,000	30,000
Exterior Storage Capacity (cu. ft.)	52.3	69.5	49.2	40	42.7	98.3	46.7	52.8	65.9	59.5





22E | TAUPE METALLIC | SYDNEY MAPLE



28F | DARK RUM | SYDNEY MAPLE



31E | ARABIAN SPICE | OLYMPIC CHERRY

## CHEVROLET® 4500

OPT 22E, 23U, 24C & 26A



### VORTEC® 6.0L V8 ENGINE

The Vortec is powerful with its 323-horsepower and 373 lb.-ft. of torque. It delivers exceptional refinement to go with its great strength. Quiet features built into the engine help reduce vibrations throughout the chassis.

### POWER 4-WHEEL ANTI-LOCK DISC BRAKE SYSTEM

The 13-inch front and 13.5-inch rear discs help stop your motorhome quickly.

### INDEPENDENT FRONT SUSPENSION

The combination of long and short control arms help ensure maximum wheel contact with the road providing a smooth and comfortable ride.

### HYDRA-MATIC® 6-SPEED AUTOMATIC TRANSMISSION

Includes Tap-Up/Tap-Down Driver Shift Control and auto grade braking to automatically slow the vehicle using the engine.

### LIMITED WARRANTY

The Chevrolet® Motorhome Chassis comes standard with a Bumper-to-Bumper Limited Warranty for 3 years or 36,000 miles and a Powertrain Limited Warranty for 5 years or 100,000 miles, whichever comes first.



## FORD® E-350

OPT 22E, 23U, 24C & 26A

## FORD® E-450

STD 28F, 28Z, 29G, 31E, 31L & 31W



### TRITON® V10 ENGINE

The 6.8L V10 engine has a proven track record of durability and low-hassle maintenance. Extremely smooth running with a commanding 305-horsepower and 420 lb.-ft. of torque.

### POWER 4-WHEEL DISC ANTI-LOCK BRAKE SYSTEM

Maintains brake balance in heavy use and varying road conditions. Reduces wheel lock up and helps maintain superior steering control.

### TWIN I-BEAM FRONT SUSPENSION

Provides a comfortable ride by allowing the front wheels to work independently of each other, reducing driver stress.

### TORQSHIFT® 5-SPEED AUTOMATIC TRANSMISSION

Provides crisp, firm and quick shifting without sacrificing driver comfort.

### LIMITED WARRANTY

The Ford® Motorhome Chassis has a Bumper-to-Bumper Limited Warranty for 3 years or 36,000 miles and a Powertrain Limited Warranty for 5 years or 60,000 miles, whichever comes first.

Taking the extra time to ensure the best possible structure is exactly what you deserve, and this is why Thor Motor Coach insists on vacuum-bond laminating not only the sidewalls of the motorhome, but also the floor and roof. Vacuum-bonding is the optimum manufacturing process to ensure multi-layer integrity.



#### ROOF

- A** One-piece exterior TPO membrane
- B** Luan panels
- C** Aluminum structure with bowed framing
- D** Block foam insulation
- E** Interior panel with hard vinyl covering

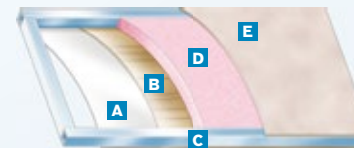

#### SIDEWALLS

- A** High-gloss or gel-coat fiberglass
- B** Luan panels
- C** Aluminum structure with framing at all openings
- D** Block foam insulation
- E** Interior panel with designer wall covering



#### FLOOR

- A** Residential vinyl flooring or carpet
- B** OSB structure wood base
- C** Structural steel framing
- D** Block foam insulation
- E** Luan with woven plastic exterior finish

## DO YOU NEED A LITTLE MORE?

A little more power? A little more towing capacity? A little more leg room? The Chateau Super C answers all those questions with a resounding yes, and compliments our diverse Chateau Class C line-up, creating the perfect palette for you to choose the motorhome that is *Made to Fit*.



35SB | ROYAL PALM | OLYMPIC CHERRY



35SB | ROYAL PALM | OLYMPIC CHERRY



33SW | ROYAL PALM | SYDNEY MAPLE



35SB | ROYAL PALM | OLYMPIC CHERRY



# SUPER C



35SK | RAVENSWOOD | SYDNEY MAPLE

 **THOR**  
MOTOR COACH  
Made to fit.

# BEAUTY INSIDE & OUT



NORTH SHORE



FLOORING



CREST FULL-BODY PAINT



RAVENSWOOD

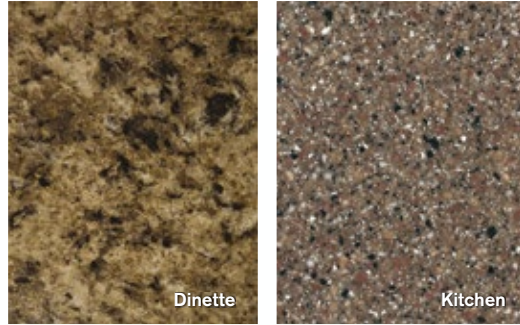

COUNTERTOPS



REGENCY FULL-BODY PAINT



ROYAL PALM



RAISED PANEL  
OLYMPIC CHERRY

RAISED PANEL  
SYDNEY MAPLE



CASHEW BEACH HD-MAX™ 



CLASSIC MERLOT HD-MAX™ 

## SUPER C – FORD® F-550



### A | 6.7L POWER STROKE® V8 TURBO DIESEL ENGINE

The 6.7L V8 engine has a proven track record of durability and low-hassle maintenance. Extremely smooth running with a commanding 300-horsepower and 660 lb.-ft. of torque.

### B | POWER 4-WHEEL DISC ANTI-LOCK BRAKE SYSTEM

Maintains brake balance in heavy use and varying road conditions. Reduces wheel lock up and helps maintain superior steering control.

### C | TWIN I-BEAM FRONT SUSPENSION

Provides a comfortable ride by allowing the front wheels to work independently of each other, reducing driver stress.

### D | TORQSHIFT™ 6-SPEED SELECT SHIFT® AUTOMATIC TRANSMISSION

Provides crisp, firm and quick shifting without sacrificing driver comfort.

### E | LIMITED WARRANTY

The Ford® Motorhome Chassis has a Bumper-to-Bumper Limited Warranty for 3 years or 36,000 miles and a Powertrain Limited Warranty for 5 years or 60,000 miles, whichever comes first.

Taking the extra time to ensure the best possible structure is exactly what you deserve, and this is why Thor Motor Coach insists on vacuum-bond laminating not only the sidewalls of the motorhome, but also the floor and roof. Vacuum-bonding is the optimum manufacturing process to ensure multi-layer integrity.



#### ROOF

- A One-piece exterior TPO membrane
- B Luan panels
- C Aluminum structure with bowed framing
- D Block foam insulation
- E Interior panel with soft touch vinyl covering

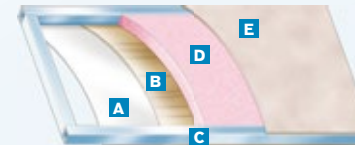

#### SIDEWALLS

- A High-gloss or gel-coat fiberglass
- B Luan panels
- C Aluminum structure with framing at all openings
- D Block foam insulation
- E Interior panel with designer wall covering



#### FLOOR

- A Residential vinyl flooring or carpet
- B OSB structure wood base
- C Structural steel framing
- D Block foam insulation
- E Luan with woven plastic exterior finish

# SUPER C FLOOR PLANS

**33SW**

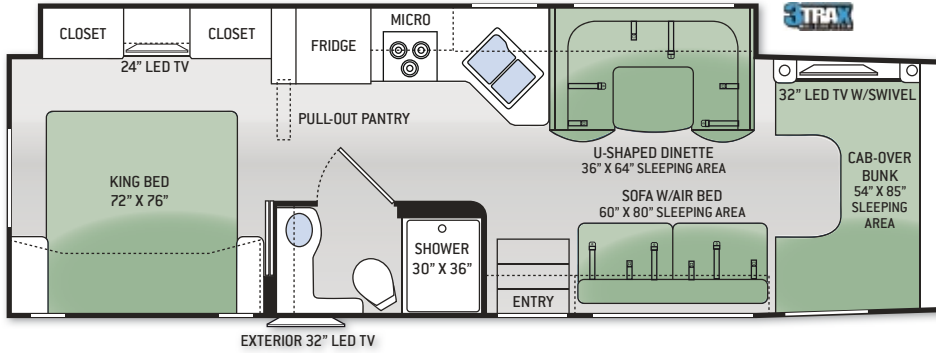

**35SF**

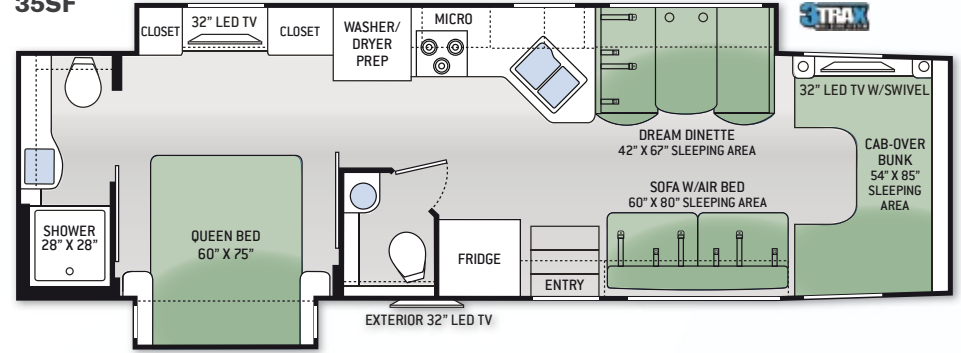

**35SB**

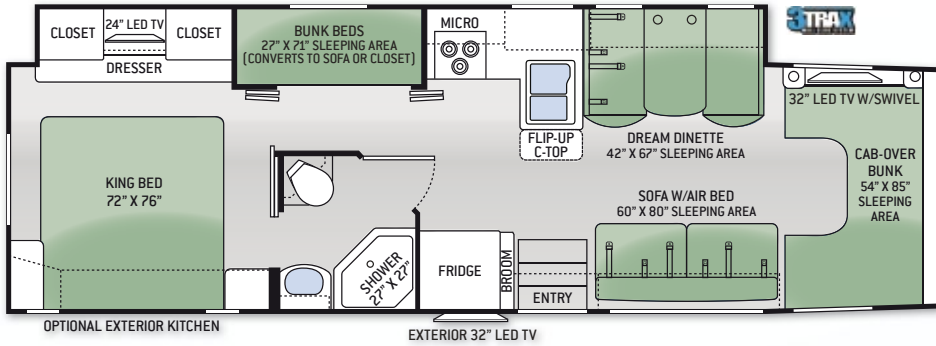

**35SK**

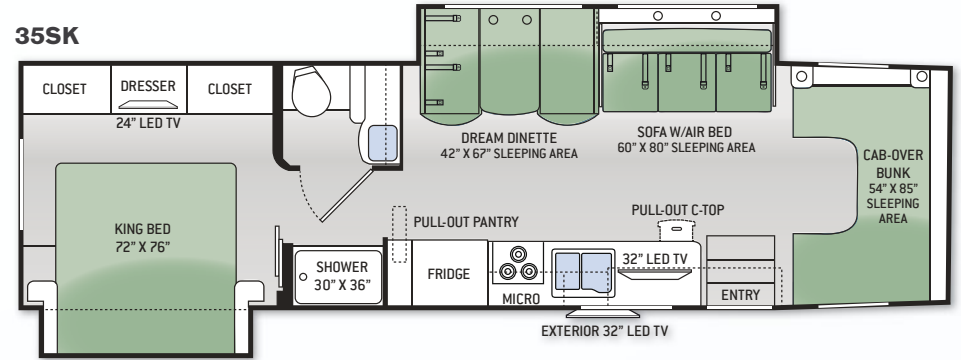



**FLOOR PLAN**

	<b>33SW</b>	<b>35SB</b>	<b>35SF</b>	<b>35SK</b>
Chassis	Ford	Ford	Ford	Ford
Gross Vehicle (GVWR)	19,500	19,500	19,500	19,500
Gross Combined (GCWR)	35,000	35,000	35,000	35,000
Wheel Base	255"	245"	255"	255"
Exterior Length (w/o ladder)	34'-6"	35'-11"	36'-2"	36'-2"
Exterior Height (w/ AC)	12'-4"	12'-4"	12'-4"	12'-4"
Exterior Width (w/o mirrors)	99"	99"	99"	99"
Interior Height (living area)	82"	82"	82"	82"
Awning Size	20'	19'	14'	16'
Front/Rear Fuel (gal)	40 / 28	40 / 28	40 / 28	40 / 28
LPG (lbs)	68.2	68.2	68.2	68.2
Fresh/Waste/Gray Water (gal)	75 / 40 / 47	75 / 40 / 40	75 / 40 Front - 31 Rear / 40	75 / 40 / 40
Water Heater (gal)	6	6	6	6
Furnace (BTUs)	30,000	30,000	30,000	30,000
Exterior Storage Capacity (cu. ft.)	133	128.7	117	164

# SUPER C STANDARDS & OPTIONS

## CONSTRUCTION & EXTERIOR

- Ford® F-550 Chassis – 6.7L Power Stroke® V8 Turbo Diesel, 300HP & 660 lb.-ft. Torque – TorqShift® 6-Speed SelectShift® Automatic Transmission
- Fully Welded Tubular Steel Floor System
- Fully Welded Tubular Aluminum Roof & Sidewall Cage Construction
- Premium One-Piece TPO Roof 
- HD-MAX™ Exterior with Graphics Package
- Automatic Hydraulic Leveling Jacks with Touchpad Controls
- Seamless Rotocast Storage Compartments
- Flush Mount Radius Luggage Doors
- Power Patio Awning with Integrated LED Lighting
- Slideout Room Awning
- 3TRAX™ Wall Slide System (33SW, 35SB & 35SK) 
- Roof Ladder
- Patio Light
- Single Electric Automatic Entry Step
- Outside Shower
- Black Frameless Slider Windows

## CONSTRUCTION & EXTERIOR OPTION

- Full-Body Paint Package with Gel-Coat Sidewalls

## AUTOMOTIVE & COCKPIT

- Touchscreen Dash Radio with DVD/CD Player & Back-Up Monitor
- Chrome, Heated/Remote Exterior Mirrors with Side View Camera System
- Leatherette Captain's Chairs
- Power Windows & Door Locks
- Keyless Entry System
- Cruise Control
- Tilt Steering Wheel
- Windshield Privacy Curtain
- Fiberglass Running Boards
- Valve Stem Extenders
- Wheel Liners
- 10,000-lb. Trailer Hitch with 7-pin Round Connector

## INTERIOR

- Residential Vinyl Flooring Throughout
- Ceiling Ducted Air Conditioning System
- 82" Interior Ceiling Height
- Soft Touch Vinyl Ceiling
- LED Ceiling Lights
- Raised Panel Cabinet Doors with Nickel Finish Hardware
- Window Solar & Privacy Roller Shades
- Leatherette Sofa with Air Bed
- Leatherette U-Shaped Dinette (33SW)
- Leatherette Dream Dinette™ Booth (35SB, 35SF & 35SK)
- Solid Surface Dinette Countertop

## INTERIOR OPTIONS

- Single Child Safety Tether in Booth Dinette (35SB, 35SF & 35SK)
- Dual Child Safety Tethers in Booth Dinette (35SB, 35SF & 35SK)
- 12-volt Attic Fan in Cab-Over

## KITCHEN

- 18 cu. ft. Residential Refrigerator
- 3-Burner Gas Cooktop with Oven
- 30" Over-the-Range Microwave Oven
- Solid Surface Countertops & Sink Covers
- Large Double Bowl Kitchen Sink with Single Handle Faucet & Sprayer
- Full Extension Ball-Bearing Metal Drawer Guides
- Pantry (33SW & 35SK)

## KITCHEN OPTION

- 12-volt Attic Fan (33SW, 35SB & 35SF)

## BEDROOM & BATHROOM

- Denver Mattress® King Size Bed (33SW, 35SB & 35SK)
- Denver Mattress® Queen Size Bed (35SF)
- Bedspread and Pillow Shams
- Bunk Beds in Hallway Slideout (35SB)
- Power Vent in Bathroom
- Porcelain Toilet
- Shower with Glass Door

## ENTERTAINMENT

- Cab-Over Entertainment Center with 32" LED TV & DVD Player on Manual Swivel (33SW, 35SB & 35SF)
- Mid-Ship Entertainment Center with 32" LED TV & DVD Player in Living Area (35SK)
- 24" LED TV with DVD Player in Bedroom (33SW, 35SB & 35SK)
- 32" LED TV in Bedroom (35SF)
- Dual 13" LED TVs with DVD Player in Bunk Beds (35SB)
- Exterior 32" LED TV
- Bluetooth® Coach Radio System in Bedroom with Exterior Speakers
- Cable TV Ready

## ENTERTAINMENT OPTIONS

- Cab-Over Entertainment Center with 50" LED TV & Sound Bar (IPO 32" LED TV)
- Exterior Kitchen with 2.5 cu. ft. Refrigerator, Sink & Portable Gas Grill (35SB)

## ELECTRICAL & PLUMBING

- Cummins Onan® RV QG 5500 LP Generator
- Automatic Generator Start
- 50-amp Service with Detachable Shoreline Power Cord
- Automatic Shoreline-to-Generator Transfer Switch
- 1800-watt Power Inverter
- Dual 13,500 BTU Roof Air Conditioners
- Emergency Start Switch
- Dual Auxiliary House Batteries
- Battery Disconnect Switch
- 6-gallon DSI Gas/Electric Water Heater
- Water Heater Bypass System
- Heated Holding Tanks Compartment
- Systems Control Center
- **Rapid Camp™** Wireless Control System

## ELECTRICAL & PLUMBING OPTION

- Cummins Onan® RV QD 6000 Diesel Generator

\*INCLUDED ON UNITS BUILT AFTER 10/1/14



# SHIELD of PROTECTION



**ONE SOURCE WARRANTY**  
Owners and dealers have the strength of Thor Motor Coach to help facilitate warranty service.



**CONCIERGE CONNECTION**  
New owners receive a personalized contact right from the factory to answer questions about their new motorhome purchase.



**24/7 FACTORY SUPPORT**  
Day or night, highly-trained Thor Motor Coach technicians can diagnosis and offer solutions to operational and service needs, providing owners with peace of mind.



**RAPID RESPONSE**  
It is Thor Motor Coach's commitment to have essential parts stocked for quick shipment to get units back on the road.

Thor Motor Coach is the industry leader in innovative design and builds a variety of unique styles, sizes and floor plans that feel custom-made – at a truly competitive price.

**IMPORTANT - PLEASE READ:** This brochure reflects product design, fabrication, material, components and specifications at the date of printing, which date is disclosed on the last page. PLEASE VISIT US ONLINE AT THORMOTORCOACH.COM OR CONSULT WITH YOUR SELLING DEALERSHIP FOR THE LATEST IN STANDARDS, OPTIONS, SPECIFICATION AND TECHNICAL INFORMATION. Photographs in the brochure may depict optional equipment or may only be available in certain floor plans. Components, appliances and the chassis may have been manufactured in a calendar year before the vehicle's designated model year. All capacities are approximate. The actual length of the vehicle may differ from that indicated in the brochure due to variances in the manufacturing processes and/or installed components. All dry weights are based on standard model features and do not include optional features or equipment. Component part and appliance manufacturers issue limited warranties covering portions of the vehicle not covered under the limited warranty we issue.

Copyright Thor Motor Coach, Inc. © 12/15/14

YOUR LOCAL THOR MOTOR COACH DEALER



Chateau-RV.com

**Made to fit.**

P.O. Box 1486, Elkhart, IN 46515  
Sales Department: 800.860.5658  
Customer Service: 877.855.2867



Chateau-Super-C.com