

PALOMINO

BACKPACK EDITION



PALOMINO

BACKPACK EDITION



SS 1251



PALOMINO SOFT-SIDE BACKPACK EDITION

No matter the size of your truck, we have a soft-side truck camper perfect for you. Thanks to the Rieco Titan® electric lift you can easily set up your camper without hand-cranking the top up or down. And with the optional remote, it works with just a push of a button. Plus, our 55" one-piece door makes it that much easier to enter and exit the camper, compared to our competition's 46" or 47" door. The soft-side series comes in a white or grey laminated gel coat exterior.



SS 1251



PALOMINO SOFT-SIDE BACKPACK EDITION

No matter the size of your truck, we have a soft-side truck camper perfect for you. Thanks to the Rieco Titan® electric lift you can easily set up your camper without hand-cranking the top up or down. And with the optional remote, it works with just a push of a button. Plus, our 55" one-piece door makes it that much easier to enter and exit the camper, compared to our competition's 46" or 47" door. The soft-side series comes in a white or grey laminated gel coat exterior.



SS 500



DESIGNED FOR COMPACT TRUCKS

SS 550



1/2 TON 5'6" OR 6'6" BED

SS 800



1/2 TON 6'6" OR 8' BED

SS 1200



1/2 TON TRUCK W/ 6' 6" OR 8' BED

SS 1251



1/2 TON 6'6" BED TRUCK WITH OVERHANG

SS 1240



1/2 TON TRUCK W/ 6'6" OR 8' BED

SS 1500



FULL SIZE TRUCK W/ 8' BED

WEIGHTS & MEASURES	SS 500	SS 550	SS 800	SS 1200	SS 1240	SS 1251	SS 1500
Total Exterior Length	12'-8"	11'4"	13'5"	12'10"	14'10"	14'10"	14'4"
Total Exterior Width	6'-4"	7'2"	7'2"	7'2"	7'2"	7'2"	7'2"
Floor Length	7'	6' 9"	7'	8' 0"	8' 6"	8' 6"	9' 6"
Wheel Well Width	39"	44"	46 1/2"	46 1/2"	46 1/2"	46 1/2"	46 1/2"
Height Closed with Vent	6'	6'	6'	6'	6'	6'	6'
Interior Open Height	7'	7'	7'	7'	7'	7'	7'
Dry Weight (Lbs.)	1197	1462	1594	1591	1876	1795	1910
Fresh Water Capacity (Gals.)	15	16	16	16	16	22	22
Black Water Capacity (Gals.)	0	0	0	0	7	7	7
LP Gas Capacity	20 lbs.	20 lbs.	20 lbs.	20 lbs.	20 lbs.	20 lbs.	2 - 20 lbs.
Cab over Bed Size	66" x 75"	60" x 80"	60" x 80"	60" x 80"	60" x 80"	60" x 80"	60" x 80"
Dinette Bed Size	36" x 90"	36" x 62"	36" x 90"	36" x 72"	36" x 72"	36" x 62"	36" x 72"
Center of Gravity **	22"	29"	22"	39"	37"	37"	45"

* PALMINO STRONGLY RECOMMENDS YOU CHECK YOUR TRUCKS OWNERS MANUAL OR CONTACT THE MANUFACTURER FOR YOUR TRUCKS CAPABILITIES.

** THE CENTER OF GRAVITY MEASUREMENT IS AS BUILT. YOUR OPTIONS AND LOADING ON THE TRUCK MAY ADJUST THIS MEASUREMENT.

SS 500



DESIGNED FOR COMPACT TRUCKS

SS 550



1/2 TON 5'6" OR 6'6" BED

SS 800



1/2 TON 6'6" OR 8' BED

SS 1200

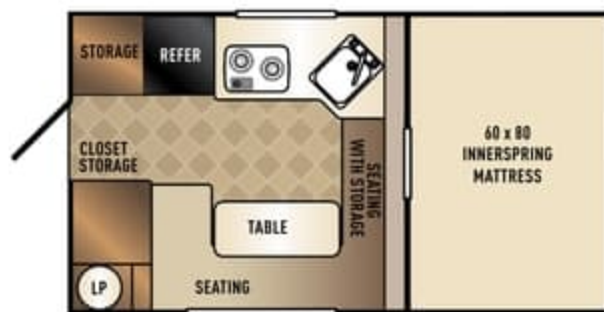

1/2 TON TRUCK W/ 6' 6" OR 8' BED

SS 1251

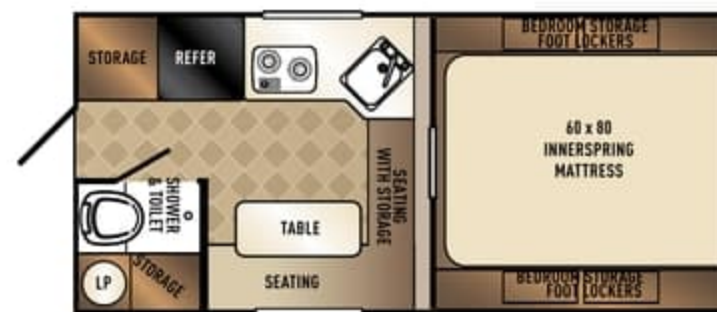

1/2 TON 6'6" BED TRUCK WITH OVERHANG

SS 1240



1/2 TON TRUCK W/ 6'6" OR 8' BED

SS 1500



FULL SIZE TRUCK W/ 8' BED

WEIGHTS & MEASURES	SS 500	SS 550	SS 800	SS 1200	SS 1240	SS 1251	SS 1500
Total Exterior Length	12'-8"	11'4"	13'5"	12'10"	14'10"	14'10"	14'4"
Total Exterior Width	6'-4"	7'2"	7'2"	7'2"	7'2"	7'2"	7'2"
Floor Length	7'	6'9"	7'	8'0"	8'6"	8'6"	9'6"
Wheel Well Width	39"	44"	46 1/2"	46 1/2"	46 1/2"	46 1/2"	46 1/2"
Height Closed with Vent	6'	6'	6'	6'	6'	6'	6'
Interior Open Height	7'	7'	7'	7'	7'	7'	7'
Dry Weight (Lbs.)	1197	1462	1594	1591	1876	1795	1910
Fresh Water Capacity (Gals.)	15	16	16	16	16	22	22
Black Water Capacity (Gals.)	0	0	0	0	7	7	7
LP Gas Capacity	20 lbs.	20 lbs.	20 lbs.	20 lbs.	20 lbs.	20 lbs.	2 - 20 lbs.
Cab over Bed Size	66" x 75"	60" x 80"	60" x 80"	60" x 80"	60" x 80"	60" x 80"	60" x 80"
Dinette Bed Size	36" x 90"	36" x 62"	36" x 90"	36" x 72"	36" x 72"	36" x 62"	36" x 72"
Center of Gravity**	22"	29"	22"	39"	37"	37"	45"

* PALOMINO STRONGLY RECOMMENDS YOU CHECK YOUR TRUCKS OWNERS MANUAL OR CONTACT THE MANUFACTURER FOR YOUR TRUCKS CAPABILITIES.

** THE CENTER OF GRAVITY MEASUREMENT IS AS BUILT. YOUR OPTIONS AND LOADING ON THE TRUCK MAY ADJUST THIS MEASUREMENT.

HS 8801



PALOMINO HARD-SIDE TRUCK CAMPERS

Our lightweight, hard-side truck campers are packed with great features and keep a lighter payload, thanks to the fully aluminum welded frame. We've redesigned the interior to provide greater cabinet storage, and upgraded frameless windows. Our campers fit multiple truck sizes so check page 11 to find your favorite floorplan.

HS 8801



PALOMINO HARD-SIDE TRUCK CAMPERS

Our lightweight, hard-side truck campers are packed with great features and keep a lighter payload, thanks to the fully aluminum welded frame. We've redesigned the interior to provide greater cabinet storage, and upgraded frameless windows. Our campers fit multiple truck sizes so check page 11 to find your favorite floorplan.



HS 650

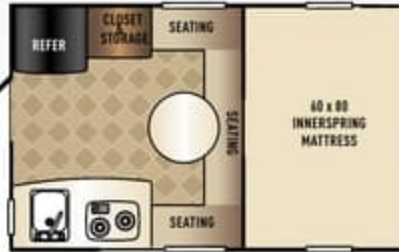

1/2 TON 5'6" OR 6'6" BED

HS 6601



3/4 TON TRUCK W/ 6' 6" OR 8' BED

HS 8801



3/4 TON TRUCK W/ 6' 6" OR 8' BED

WEIGHTS & MEASURES	HS 650	HS 6601	HS 8801
Total Exterior Length (Including Ladder)	16'-0"	16'-8"	18'-0"
Total Exterior Width	7'-2"	7'-2"	7'-10"
Floor Length	6'-6"	9'	9'
Wheel Well Width	48"	48"	48"
Exterior Height with Ladder	7'7"	8'2"	8'2"
Interior Height	6'6"	6'11"	6'11"
Dry Weight (Lbs.)	1547	2051	2405
Fresh Water Capacity (Gals)	15	31	31
Black Water Capacity (Gals)	0	6	7
Gray Water Capacity (Gals)	0	8	8
LP Gas Capacity	20 lbs.	20 lbs.	20 lbs.
Cab over Bed Size	60" x 80"	60" x 80"	60" x 80"
Dinette Bed Size	32" x 69"	40" x 73"	40" x 73"
Center of Gravity **	29 1/2"	38"	42"

* PALOMINO STRONGLY RECOMMENDS YOU CHECK YOUR TRUCKS OWNERS MANUAL OR CONTACT THE MANUFACTURER FOR YOUR TRUCKS CAPABILITIES.

** THE CENTER OF GRAVITY MEASUREMENT IS AS BUILT. YOUR OPTIONS AND LOADING ON THE TRUCK MAY ADJUST THIS MEASUREMENT.



HS 650

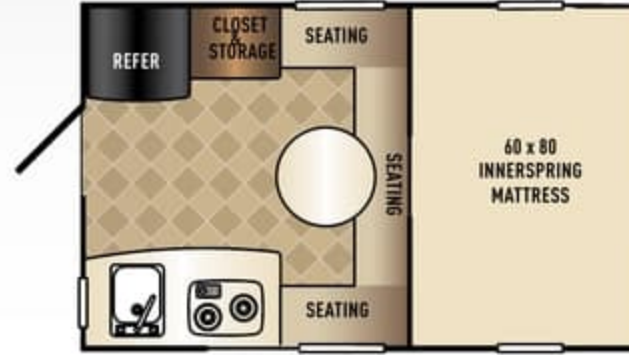

1/2 TON 5'6" OR 6'6" BED

HS 6601



3/4 TON TRUCK W/ 6' 6" OR 8' BED

HS 8801

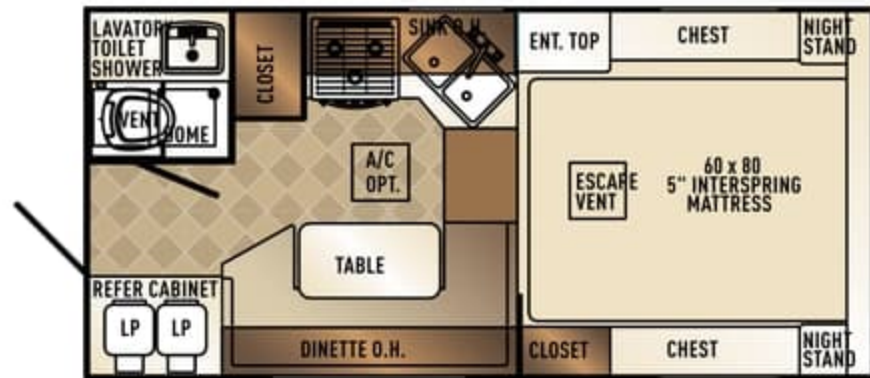

3/4 TON TRUCK W/ 6' 6" OR 8' BED

WEIGHTS & MEASURES	HS 650	HS 6601	HS 8801
Total Exterior Length (Including Ladder)	16'-0"	16'-8"	18'-0"
Total Exterior Width	7'-2"	7'-2"	7'-10"
Floor Length	6'-6"	9'	9'
Wheel Well Width	48"	48"	48"
Exterior Height with Ladder	7'7"	8'2"	8'2"
Interior Height	6'6"	6'11"	6'11"
Dry Weight (Lbs.)	1547	2051	2405
Fresh Water Capacity (Gals)	15	31	31
Black Water Capacity (Gals)	0	6	7
Gray Water Capacity (Gals)	0	8	8
LP Gas Capacity	20 lbs.	20 lbs.	20 lbs.
Cab over Bed Size	60" x 80"	60" x 80"	60" x 80"
Dinette Bed Size	32" x 69"	40" x 73"	40" x 73"
Center of Gravity **	29 1/2"	38"	42"

* PALOMINO STRONGLY RECOMMENDS YOU CHECK YOUR TRUCKS OWNERS MANUAL OR CONTACT THE MANUFACTURER FOR YOUR TRUCKS CAPABILITIES.

** THE CENTER OF GRAVITY MEASUREMENT IS AS BUILT. YOUR OPTIONS AND LOADING ON THE TRUCK MAY ADJUST THIS MEASUREMENT.

HS 2901



PALOMINO HARD SIDE MAX BACKPACK EDITION

Our Hard Side Max series is our premium product. With the insulated, frameless windows and heated basement, this camper is ready for four season livability. Our exclusive front cap windshield opens the expansive living space with light and creates an inviting atmosphere.

HS 2901



PALOMINO HARD SIDE MAX BACKPACK EDITION

Our Hard Side Max series is our premium product. With the insulated, frameless windows and heated basement, this camper is ready for four season livability. Our exclusive front cap windshield opens the expansive living space with light and creates an inviting atmosphere.



HS 2901



1 TON TRUCK W/ 6'6" OR 8' BED

HS 2902



1 TON TRUCK W/ 6'6" OR 8' BED

HS 2910



1 TON TRUCK W/ 8' BED

WEIGHTS & MEASURES	HS 2901	HS2902	HS 2910
Total Exterior Length (Including Ladder)	19'-0"	19'-0"	20'-0"
Total Exterior Width	8'-2"	8'-2"	8'-2"
Floor Length	9'	9'	10'
Wheel Well Width	48"	48"	48"
Exterior Height with Ladder	9'	9'	9'
Interior Height	6'-10"	6'-10"	6'-10"
Dry Weight (Lbs.)	3037	3261	3493
Fresh Water Capacity (Gals)	45	45	45
Black Water Capacity (Gals)	20	20	20
Gray Water Capacity (Gals)	20	20	20
LP Gas Capacity	20 lbs.	20 lbs.	20 lbs.
Cab over Bed Size	60" x 80"	60" x 80"	60" x 80"
Dinette Bed Size	40" x 62"	40" x 62"	40" x 69"
Center of Gravity **	37"	37"	46"

* PALOMINO STRONGLY RECOMMENDS YOU CHECK YOUR TRUCKS OWNERS MANUAL OR CONTACT THE MANUFACTURER FOR YOUR TRUCKS CAPABILITIES.

** THE CENTER OF GRAVITY MEASUREMENT IS AS BUILT. YOUR OPTIONS AND LOADING ON THE TRUCK MAY ADJUST THIS MEASUREMENT.



HS 2901

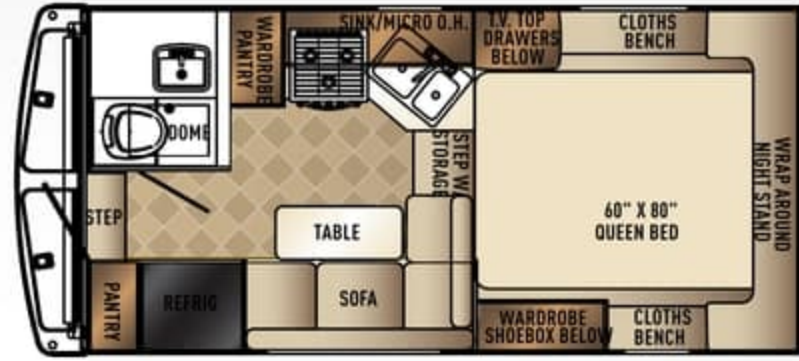

1 TON TRUCK W/ 6'6" OR 8' BED

HS 2902



1 TON TRUCK W/ 6'6" OR 8' BED

HS 2910



1 TON TRUCK W/ 8' BED

WEIGHTS & MEASURES	HS 2901	HS2902	HS 2910
Total Exterior Length (Including Ladder)	19'-0"	19'-0"	20'-0"
Total Exterior Width	8'-2"	8'-2"	8'-2"
Floor Length	9'	9'	10'
Wheel Well Width	48"	48"	48"
Exterior Height with Ladder	9'	9'	9'
Interior Height	6'-10"	6'10"	6'10"
Dry Weight (Lbs.)	3037	3261	3493
Fresh Water Capacity (Gals)	45	45	45
Black Water Capacity (Gals)	20	20	20
Gray Water Capacity (Gals)	20	20	20
LP Gas Capacity	20 lbs.	20 lbs.	20 lbs.
Cab over Bed Size	60" x 80"	60" x 80"	60" x 80"
Dinette Bed Size	40" x 62"	40" x 62"	40" x 69"
Center of Gravity **	37"	37"	46"

* PALOMINO STRONGLY RECOMMENDS YOU CHECK YOUR TRUCKS OWNERS MANUAL OR CONTACT THE MANUFACTURER FOR YOUR TRUCKS CAPABILITIES.

** THE CENTER OF GRAVITY MEASUREMENT IS AS BUILT. YOUR OPTIONS AND LOADING ON THE TRUCK MAY ADJUST THIS MEASUREMENT.

PALOMINO HARD SIDE MAX TRUCK CAMPER CONSTRUCTION

Palomino Hard side truck campers are aluminum framed with laminated construction to offer a light weight yet durable product at a price you can afford.

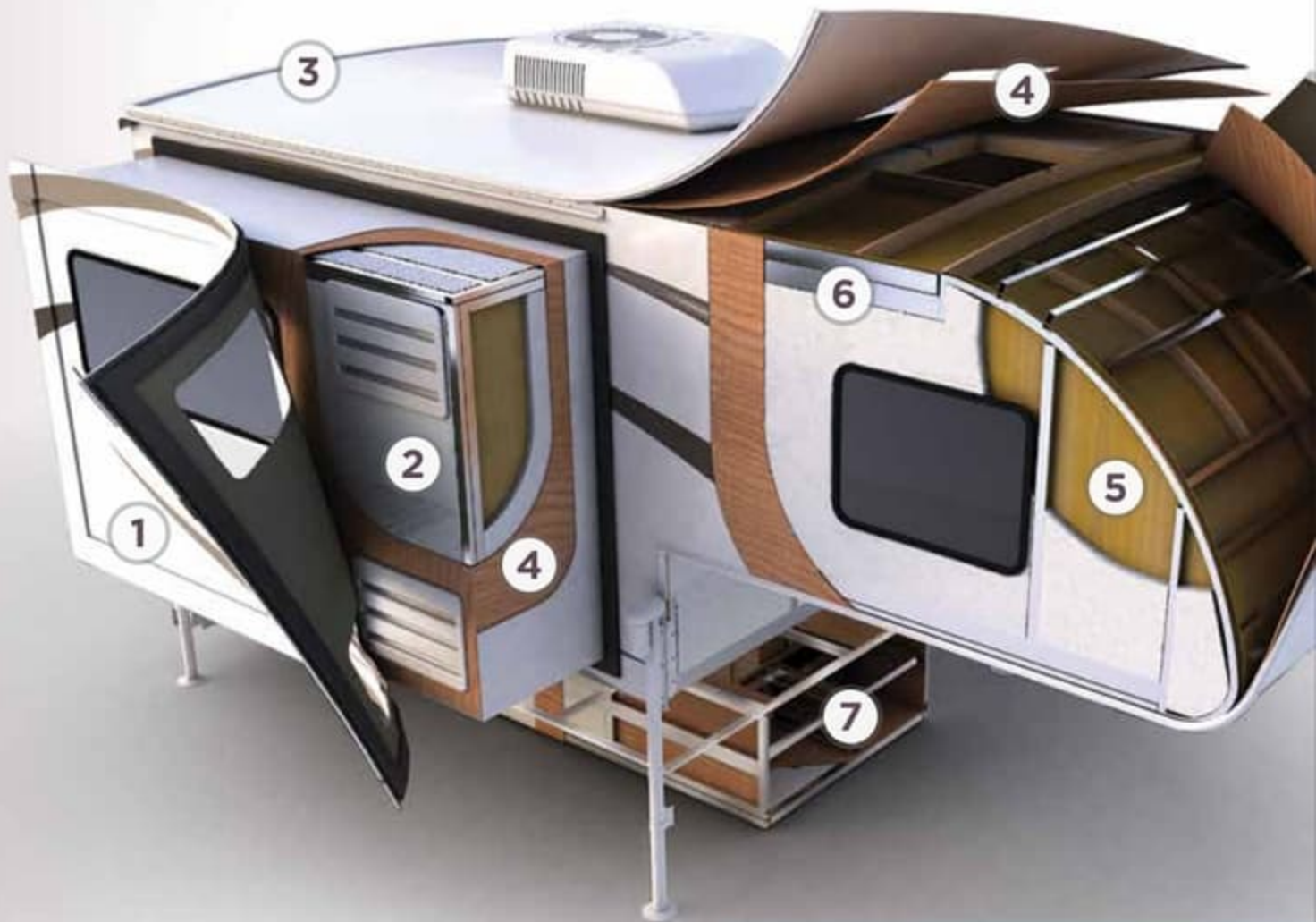

- 1 **HI GLOSS GEL COAT FIBERGLASS EXTERIOR**
* OPTIONAL (GREY EXTERIOR)
- 2 **HIGH DENSITY BLOCK FOAM INSULATION**
- 3 **ALPHA SUPER FLEX MEMBRANE ROOF**
- 4 **PLYWOOD SUBSTRATE**
- 5 **DECORATIVE WALL BOARD**
- 6 **ALUMINUM FRAMING-FULLY WELDED SUPER STRUCTURE (N/A ON SOFT SIDES AND HS-650)**
- 7 **HEATED INSULATED BASEMENT**

EP

ELITE PACKAGE

(AVAILABLE ON 8801 / 2901 / 2902 / 2910)

- SOLID SURFACE COUNTER TOPS
- BACK UP CAMERA
- MOTION DETECTION
- EXTERIOR PORCH LIGHT
- LINE X[®] PACKAGE
- REAR POWER AWNING WITH LED LIGHTS

PALOMINO HARD SIDE MAX TRUCK CAMPER CONSTRUCTION

Palomino Hard side truck campers are aluminum framed with laminated construction to offer a light weight yet durable product at a price you can afford.

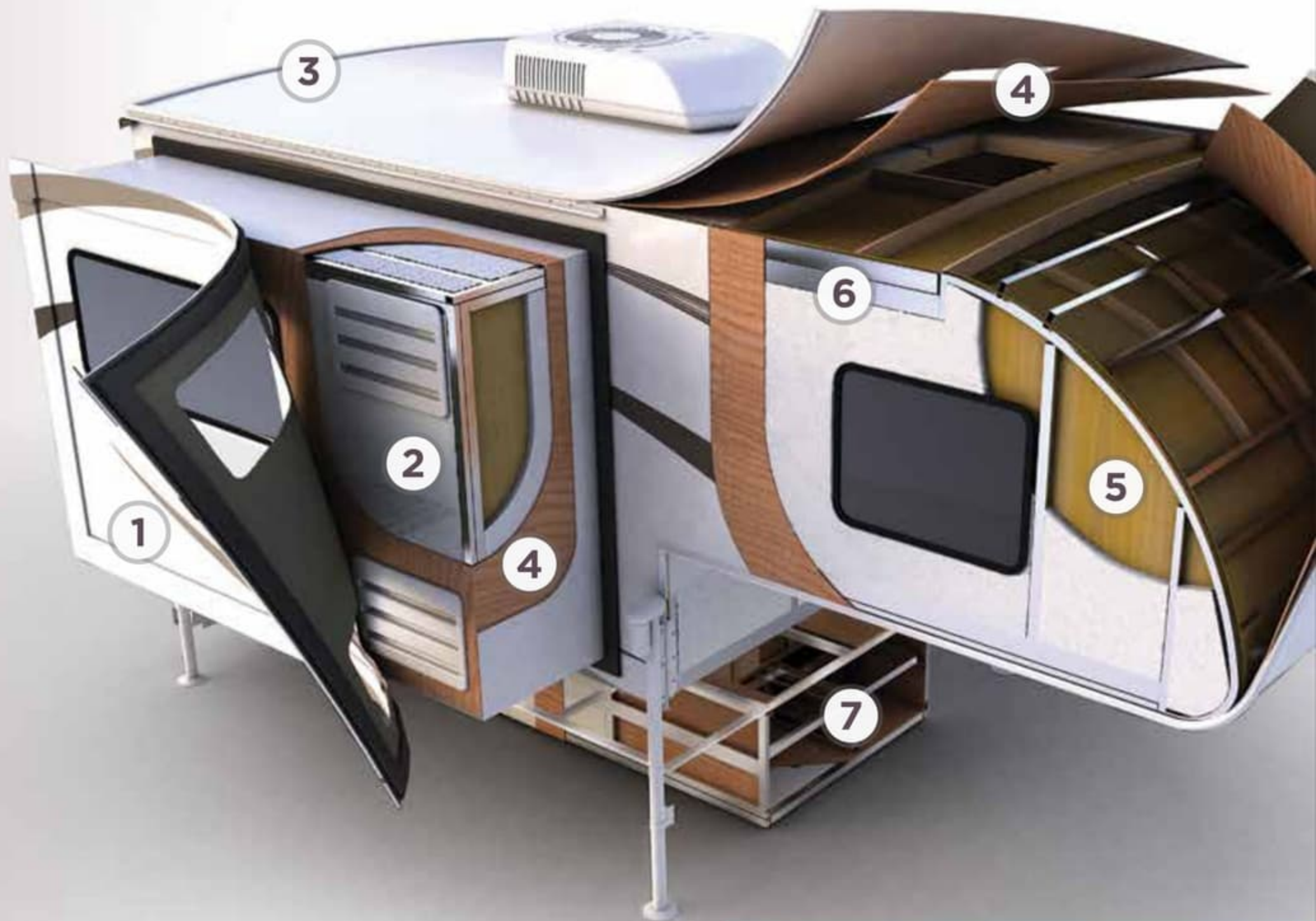

- 1 **HI GLOSS GEL COAT FIBERGLASS EXTERIOR**
* OPTIONAL (GREY EXTERIOR)
- 2 **HIGH DENSITY BLOCK FOAM INSULATION**
- 3 **ALPHA SUPER FLEX MEMBRANE ROOF**
- 4 **PLYWOOD SUBSTRATE**
- 5 **DECORATIVE WALL BOARD**
- 6 **ALUMINUM FRAMING-FULLY WELDED SUPER STRUCTURE** (N/A ON SOFT SIDES AND HS-650)
- 7 **HEATED INSULATED BASEMENT**

EP

ELITE PACKAGE

(AVAILABLE ON 8801 / 2901 / 2902 / 2910)

- SOLID SURFACE COUNTER TOPS
- BACK UP CAMERA
- MOTION DETECTION
- EXTERIOR PORCH LIGHT
- LINE X[®] PACKAGE
- REAR POWER AWNING WITH LED LIGHTS

PALOMINO STANDARDS & OPTIONS

STANDARD FEATURES

- LED Interior Lighting
- Vented Battery Box (2 Std. on Max Series)
- Battery Quick Disconnect
- Exterior Battery Charging Station
- Rieco Titan® Electric Roof Lift (Soft sides only)
- Ball Bearing Drawer Guides
- "Landing Pad" Integrated Bumper (Hard Side Max Only)
- Laminated Walkable Roof (Hard Side Only)
- Congoleum® Flooring
- Mortise and Tenon Walnut Hard Wood Cabinets
- Pocket Screw Lumber Core Cabinet Stiles
- 55" One-Piece Door (Soft Side Only)

COMMONLY ORDERED OPTIONS

- Air Conditioning
- White or Grey Hi-Gloss Exterior Fiberglass
- Entry Step
- Microwave (Hard Sides Only)
- Side Awning w/LED Lights (Hard Sides Only)
- Rear Awning w/LED Lights (Hard Sides Only)
- Wireless Remote for Rieco Titan® Roof Lift (Soft sides only)
- Elite Pkg - Hard Sides only (8801 / 2901 / 2902 / 2910)

* See our website for a complete list of available options

HS-650 - 1/2 TON
5' 6" TO 6' 6" BED

SS-1500 - 8' BED

SS-1240 - 6' 6" OR 8' BED

SS-1251 - 6' 6"
BED WITH OVERHANG

SS-1200 - 6' 6" OR 8' BED

SS-800 - 6' 6" TO 8' BED

SS-550 - 5' 6" TO 6' 6" BED

HS-6601 - 6' 6" OR 8' BED

HS-8801 - 6' 6" OR 8' BED

HS-2901 - 6' 6" OR 8' BED

HS-2902 - 6' 6" OR 8' BED

HS-2910 - 8' BED

SS-500



COMPACT TRUCK

CHEVROLET® COLORADO® / TOYOTA® TACOMA®



1/2 TON, F-150/1500



3/4 TON, F-250/2500



1 TON, F-350/3500

PALOMINO STANDARDS & OPTIONS

STANDARD FEATURES

- LED Interior Lighting
- Vented Battery Box (2 Std. on Max Series)
- Battery Quick Disconnect
- Exterior Battery Charging Station
- Rieco Titan® Electric Roof Lift (Soft sides only)
- Ball Bearing Drawer Guides
- "Landing Pad" Integrated Bumper (Hard Side Max Only)
- Laminated Walkable Roof (Hard Side Only)
- Congoleum® Flooring
- Mortise and Tenon Walnut Hard Wood Cabinets
- Pocket Screw Lumber Core Cabinet Stiles
- 55" One-Piece Door (Soft Side Only)

COMMONLY ORDERED OPTIONS

- Air Conditioning
- White or Grey Hi-Gloss Exterior Fiberglass
- Entry Step
- Microwave (Hard Sides Only)
- Side Awning w/LED Lights (Hard Sides Only)
- Rear Awning w/LED Lights (Hard Sides Only)
- Wireless Remote for Rieco Titan® Roof Lift (Soft sides only)
- Elite Pkg - Hard Sides only (8801 / 2901 / 2902 / 2910)

* See our website for a complete list of available options

HS-650 - 1/2 TON
5' 6" TO 6' 6" BED

SS-1500 - 8' BED

SS-1240 - 6' 6" OR 8' BED

SS-1251 - 6' 6"
BED WITH OVERHANG

SS-1200 - 6' 6" OR 8' BED

SS-800 - 6' 6" TO 8' BED

SS-550 - 5' 6" TO 6' 6" BED

HS-6601 - 6' 6" OR 8' BED

HS-8801 - 6' 6" OR 8' BED

HS-2901 - 6' 6" OR 8' BED

HS-2902 - 6' 6" OR 8' BED

HS-2910 - 8' BED

SS-500



COMPACT TRUCK

CHEVROLET® COLORADO™ / TOYOTA® TACOMA™



1/2 TON, F-150/1500



3/4 TON, F-250/2500



1 TON, F-350/3500

PALOMINO TRUCK CAMPER POPULAR FEATURES

TruckCamperMAGAZINE.com

2016 Readers' Choice Awards



Best Truck Camper Gear of the Year

Torklift International Palomino Dura-Trak Bumper



FURRION SOLAR PREP

Allows you to charge your battery with solar panels (not included).

GOING UP?

It's easy with Palomino's New Motorized Camper Lift System featuring Rieco-Titan's Electric Roof Lift System with optional key fob control.



No more hand cranking!



PALOMINO TRUCK CAMPER POPULAR FEATURES

TruckCamperMAGAZINE.com

2016 Readers' Choice Awards

✓ Best Truck Camper Gear of the Year

Torklift International Palomino Dura-Trak Bumper



FURRIION SOLAR PREP

Allows you to charge your battery with solar panels (not included).

GOING UP?

It's easy with Palomino's New Motorized Camper Lift System featuring Rieco-Titan's Electric Roof Lift System with optional key fob control.



Optional Key Fob



 **No more hand cranking!**

- 
- 
- 



Our fiberglass front cap has a fully integrated windshield. Palomino RV partnered with the leaders in O.E. Automotive Windshield Manufacturing Guardian Industries as well as Dow Chemicals to create this Palomino Exclusive Feature. This automotive style windshield not only looks great rolling down the road, but also creates an open inviting environment in the Palomino Hard Side Max Cabover Bunks while you enjoy great panoramic views.



CHARGING PORT

Allows you to charge or maintain your on-board battery with ease from the exterior of your Palomino Camper.



BARRELED ROOF

Vacuum bonded radius roof with vaulted ceiling provides superior insulation and additional interior height



Above: The Hard Side Max comes with our exclusive Landing Pad bumper, which gives you more room when entering and exiting. When using the awning, the Landing Pad remains shaded and comfortable.



Our fiberglass front cap has a fully integrated windshield. Palomino RV partnered with the leaders in O.E. Automotive Windshield Manufacturing Guardian Industries as well as Dow Chemicals to create this Palomino Exclusive Feature. This automotive style windshield not only looks great rolling down the road, but also creates an open inviting environment in the Palomino Hard Side Max Cabover Bunks while you enjoy great panoramic views.



CHARGING PORT

Allows you to charge or maintain your on-board battery with ease from the exterior of your Palomino Camper.



BARRELED ROOF

Vacuum bonded radius roof with vaulted ceiling provides superior insulation and additional interior height



Above: The Hard Side Max comes with our exclusive Landing Pad bumper, which gives you more room when entering and exiting. When using the awning, the Landing Pad remains shaded and comfortable.

Palomino Warranty

Palomino will stand behind our products 100%. For complete details on our warranty program, please see your Palomino dealer.

- 1 2-year fiberglass warranty
- 2 5-year axle warranty
- 3 12-year Alpha Super Flex roof warranty
- 4 2-3 year warranty on appliances (see manual for details)
- 5 1 year bumper to bumper warranty
- 6 An additional 1 year warranty available

CUSTOMER SATISFACTION



www.ForestRiverBuyLocal.com



SHINE BAY APPROVED

Each of units goes through a lengthy 30 point inspection process to guarantee complete satisfaction upon arrival to the dealer. We take the time to check everything from seals to electrical shortages.



PRE-DELIVERY INSPECTION FACILITY

20,000 square feet of quality assurance. The bare essentials for a premium product. This state-of-the-art facility gives immediate daily feedback to production for quality assurance in every unit built.

24/7 EMERGENCY ROADSIDE ASSISTANCE

For a worry-free ownership experience

Forest River includes one

year of Coach-Net RV Technical & Roadside Assistance with each RV purchase. Whether new to the RV lifestyle or an experienced RV enthusiast, Forest River owners have 24/7 access to technical, operational and emergency road service coverage throughout the US & Canada.

Coach-Net's fast, dependable service is just a phone call away.

Coach-Net®

RV Technical & Roadside Assistance



FREE MEMBERSHIP

to Forest River Owners' Group

www.forestriverfrog.com



Learn More

Scan this barcode using a QR Reader on your smart phone to learn more about Forest River.



A Berkshire Hathaway company.

Specification Definitions

GVWR (Gross Vehicle Weight Rating) - is the maximum permissible weight of the unit when fully loaded. It includes all weights, inclusive of all fluids, cargo, optional equipment and accessories. For safety and product performance do NOT exceed the GVWR.

GAWR (Gross Axle Weight Rating) - is the maximum permissible weight, including cargo, fluids, optional equipment and accessories that can be safely supported by a combination of all axles.

VWV (Unloaded Vehicle Weight) - is the typical weight of the unit as manufactured at the factory. It includes all weight at the unit's axle(s) and tongue or pin and LP-Gas. The UVW does not include cargo, fresh potable water, additional optional equipment or dealer installed accessories.

*Estimated average based on standard build optional equipment.

CCC (Cargo Carrying Capacity)** - is the amount of weight available for fresh potable water, cargo, additional optional equipment and accessories. CCC is equal to GVWR minus UVW. Available CCC should accommodate fresh potable water (8.3 lbs per gallon). Before filling the fresh water tank, empty the black and gray tanks to provide for more cargo capacity.

** Estimated average based on standard build optional equipment

Each Forest River RV is weighed at the manufacturing facility prior to shipping. A label identifying the unloaded vehicle weight of the actual unit and the cargo carrying capacity is applied to every Forest River RV prior to leaving our facilities.

The load capacity of your unit is designated by weight, not by volume, so you cannot necessarily use all available space when loading your unit.

All information contained in this brochure is believed to be accurate at the time of publication. However, during the model year, it may be necessary to make revisions and Forest River, Inc., reserves the right to make all such changes without notice, including prices, colors, materials, equipment and specifications as well as the addition of new models and the discontinuance of models shown in this brochure. Therefore, please consult with your Forest River, Inc., dealer and confirm the existence of any materials, design or specifications that are material to your purchase decision. Litho. U.S.A. P / W: 2014.09.17

SINCE 1968
PALOMINO
Recreational Vehicles
a Division of Forest River

PALOMINO RV

1047 EAST M-86 | COLON, MI 49040
P: 269.432.3271 | F: 269.432.2516
www.palominorv.com

BACKPACK TRUCK CAMPER DEALER

Palomino Warranty

Palomino will stand behind our products 100%. For complete details on our warranty program, please see your Palomino dealer.

- 1 2-year fiberglass warranty
- 2 5-year axle warranty
- 3 12-year Alpha Super Flex roof warranty
- 4 2-3 year warranty on appliances (see manual for details)
- 5 1 year bumper to bumper warranty
- 6 An additional 1 year warranty available

CUSTOMER SATISFACTION



www.ForestRiverBuyLocal.com



SHINE BAY APPROVED

Each of units goes through a lengthy 30 point inspection process to guarantee complete satisfaction upon arrival to the dealer. We take the time to check everything from seals to electrical shortages.



PRE-DELIVERY INSPECTION FACILITY

20,000 square feet of quality assurance. The bare essentials for a premium product. This state-of-the-art facility gives immediate daily feedback to production for quality assurance in every unit built.

24/7 EMERGENCY ROADSIDE ASSISTANCE

For a worry-free ownership experience Forest River includes one year of Coach-Net RV Technical & Roadside Assistance with each RV purchase. Whether new to the RV lifestyle or an experienced RV enthusiast, Forest River owners have 24/7 access to technical, operational and emergency road service coverage throughout the US & Canada. Coach-Net's fast, dependable service is just a phone call away.

Coach-Net[®]
RV Technical & Roadside Assistance



FREE MEMBERSHIP
to Forest River Owners' Group

www.forestriverfrog.com



Learn More
Scan this barcode using a QR Reader on your smart phone to learn more about Forest River.



A Berkshire Hathaway company.

Specification Definitions

GVWR (Gross Vehicle Weight Rating) - is the maximum permissible weight of the unit when fully loaded. It includes all weights, inclusive of all fluids, cargo, optional equipment and accessories. For safety and product performance do NOT exceed the GVWR.

GAWR (Gross Axle Weight Rating) - is the maximum permissible weight, including cargo, fluids, optional equipment and accessories that can be safely supported by a combination of all axles.

UVW (Unloaded Vehicle Weight)* - is the typical weight of the unit as manufactured at the factory. It includes all weight at the unit's axle(s) and tongue or pin and LP Gas. The UVW does not include cargo, fresh potable water, additional optional equipment or dealer installed accessories.

*Estimated average based on standard build optional equipment.

CCC (Cargo Carrying Capacity)** - is the amount of weight available for fresh potable water, cargo, additional optional equipment and accessories. CCC is equal to GVWR minus UVW. Available CCC should accommodate fresh potable water (8.3 lbs per gallon). Before filling the fresh water tank, empty the black and gray tanks to provide for more cargo capacity.

** Estimated average based on standard build optional equipment

Each Forest River RV is weighed at the manufacturing facility prior to shipping. A label identifying the unloaded vehicle weight of the actual unit and the cargo carrying capacity is applied to every Forest River RV prior to leaving our facilities.

The load capacity of your unit is designated by weight, not by volume, so you cannot necessarily use all available space when loading your unit.

All information contained in this brochure is believed to be accurate at the time of publication. However, during the model year, it may be necessary to make revisions and Forest River, Inc., reserves the right to make all such changes without notice, including prices, colors, materials, equipment and specifications as well as the addition of new models and the discontinuance of models shown in this brochure. Therefore, please consult with your Forest River, Inc., dealer and confirm the existence of any materials, design or specifications that are material to your purchase decision. Litho. U.S.A P / W: 2014.09.17

SINCE 1968
PALOMINO
Recreational Vehicles
a Division of Forest River

PALOMINO RV
1047 EAST M-86 | COLON, MI 49040
P: 269.432.3271 | F: 269.432.2516
www.palominorv.com

BACKPACK TRUCK CAMPER DEALER