

10 SERIES
(under 2,000 LBS)



16 SERIES
(under 3,500 LBS)



19 SERIES
(under 5,000 LBS)



20 SERIES
(under 5,000 LBS)



NOBO
NO BOUNDARIES





WHAT IF THERE WERE NO•BOUNDARIES?

Designed for those who push limits, the versatile and exceptionally light weight No Boundaries (**NOBO**) travel trailer is rugged enough for any outdoor enthusiast. It's innovative and durable rooftop Rhino-Rack offers adaptable storage for Kayaks, mountain bikes, snowboards, fishing equipment, or just simply extra luggage. Towable by both 4- and 6-cylinder vehicles, **NOBO** is ready when you are.





**JBL PORTABLE
BLUETOOTH SPEAKER**



**MORRYDE STEPS
(N/A ON 16 SERIES)**



**OUTDOOR KITCHEN
(STANDARD ON 10.5/10.6)**



**SHOWERMISER
(16/19 SERIES ONLY)**



**CENTRAL VAC SYSTEM
W/LED BACKLIT VAC PORT
NO HOSES NEEDED**



**WELDED ALUMINUM BED FRAMING
(16/19 SERIES ONLY)**



BACKUP CAMERA PREP



**ALL-NEW 16/19 SERIES BUSH KITCHEN
EXTERIOR FLAT TOP GRILL, HIGH PRESSURE SPRAY PORT,
PREP STATION, SHOWERMISER**



Connor Ray / NB10.6

WHEN YOU LIVE LIFE BY A COMPASS, NOT A CLOCK.

With industry-leading ground clearance, larger diameter tires and a nimble suspension system, you'll be able to explore and set up camp in places that would otherwise be inaccessible. Additionally, the upscale interior focuses on thoughtful, useful design with ample storage and an ergonomic and refreshing living space.

NO·BO is attractively equipped with both familiar standard equipment as well as fresh features for a truly unforgettable adventure.



NB10.6



NB10.8

SPECIFICATIONS

| MODEL | NB10.6 | NB10.8 | NB16.6 | NB16.8 |
|--------------------------------|--------|--------|--------|--------|
| Unloaded Vehicle Weight | 1763 | TBD | 3346 | 3264 |
| Hitch Weight (lbs.) | 236 | TBD | 382 | 320 |
| Cargo Carrying Capacity | 1973 | TBD | 1417 | 1541 |
| Roof Capacity (lbs.) | 500 | TBD | 500 | 500 |
| Exterior Length w/o Spare Tire | 13' 9" | TBD | 21' 8" | 22' 2" |
| Exterior Width | 88" | TBD | 96" | 96" |
| Exterior Height (w/ A/C) | 7' 9" | TBD | 9' 11" | 9' 11" |
| Interior Height | 54" | TBD | 78" | 78" |
| Fresh Water (gal.) | 30 | TBD | 30 | 30 |
| Grey Water (gal.) | N/A | TBD | 30 | 30 |
| Black Water (gal.) | N/A | TBD | 30 | 30 |

NOTE - Definitions for specifications can be found on the back page of this brochure.

FLOORPLANS

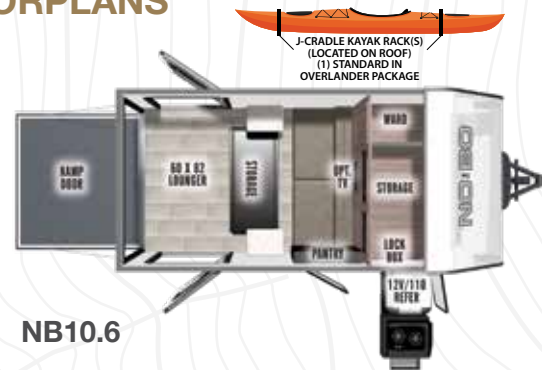

NB10.6

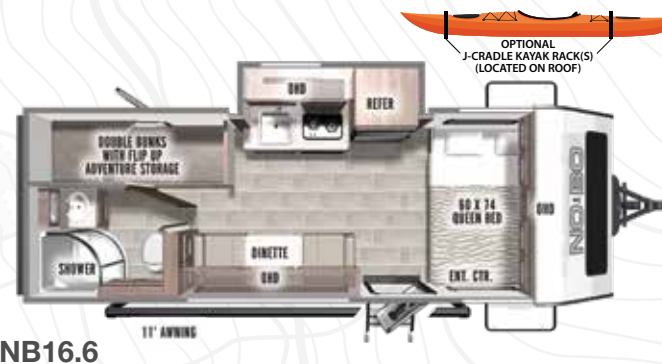

NB16.6

KEY FEATURE

10.6 can haul a full-size ATV, Standard Enclosed Underbelly, 30 gal. Fresh Water Capacity

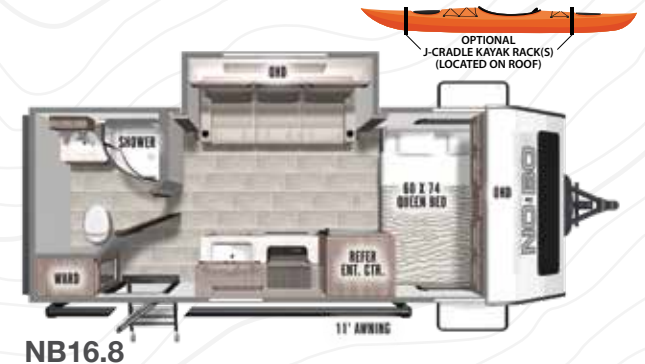

NB16.8



1413



Daniel Stoute / NB16.8

10 SERIES STANDARDS/OPTIONS

DISCOVERER PACKAGE

KEY STANDARD EQUIPMENT

- JBL Portable Bluetooth Speaker
- Complete Interior/Exterior LED Lighting PKG
- 1000 Lumen White Scare Light
- Metropolitan Grey Lightweight-Ply Countertops
- Stainless Steel Utility Hooks
- Bottle Opener
- Black Satin Faucet/Door Pulls (where applicable)
- High Performance Vinyl Furniture
- 2-Burner Glass Recessed Cook Top
- Black Stainless Steel Sink (where applicable)
- Pleated Shades
- USB Charging Station
- Lamilux 1000 Fiberglass Exterior Featuring Satin Matte Graphics
- Cold Weather Package (Required)
- (Some Features N/A 10 Series)

OVERLANDER PACKAGE

- Standard RVT Track (Rhino Rack #RTV148)
- Two Vortex Bars (Rhino Rack #VA180B)
- J-Cradle Kayak Holder (Rhino Rack #S510)
- Satin Matte Finish Wheels Wrapped in All Terrain Tires

OPTIONAL EQUIPMENT

- 13.5 BTU Low Profile Air Conditioning
- 5500 BTU Heat Strip (applicable only with A/C equipped)
- Power Tongue Jack w/LED Light
- 12V LED TV
- Pioneer Platform (IPO Vortex Bars and J-Cradle Kayak Rack)
- Hybrid Single Bike Carrier (Rhino Rack #RBC050)
- Snowboard/Ski/Fishing Rod/Paddle Holder (Rhino Rack #573)
- J-Cradle Kayak Holder (Rhino Rack #S510)
- One Standard Kayak Holder in Overlander PKG
- Batwing Awning
- Dinette Package
- Ramp Door Screen Door (n/a 10.5)
- NOBO Nest - Roof Top Tent

16 SERIES STANDARDS/OPTIONS

ACTION PACKAGE (REQUIRED)

KEY STANDARD EQUIPMENT

- Azdel Exterior Construction
- PVC Roofing Membrane
- Rhino Rack RVT Track
- 5 Cu. Ft. Refrigerator
- Aluminum Cage Construction
- Torsion Axle with Industry Leading Ground Clearance
- Panoramic 60" x 22" Front Window
- Roof-Mounted Heavy Duty Solar Prep
- Rear Ladder

OVERLANDER PACKAGE (OPTIONAL)

- Standard RVT Track (Rhino Rack #RTV148)
- Two Vortex Bars (Rhino Rack #VA180B)
- J-Cradle Kayak Holder (Rhino Rack #S510)
- Satin Matte Finish Wheels Wrapped in All Terrain Tires

OPTIONAL EQUIPMENT

- Stainless Steel Convection Microwave Oven
- 12V LED TV
- Power Tongue Jack w/LED Light
- Cold Weather Package (Required)
- Custom Front Fiberglass Protective Shell
- JBL Bluetooth Speaker
- Central Vacuum System (Required)
- Solar Package (Heavy-Duty Panel, Inverter, and Charge Controller)
- 15K A/C IPO 13.5K A/C
- Bush Kitchen (Required)
- Exterior Flat Top Grill, High Pressure Spray Port, Prep Station, Showermiser



NB16.8



NB16.8



NB16.8



Dan Hall / NB19.3

WHEN YOU THRIVE ON PUSHING THE LIMITS.

NO·BO 19 Series delivers a true 7' wide box to align perfectly with smaller tow vehicles. Combine this with our enclosed underbelly and gate valves, panoramic front window, and torsion axle suspension system to offer you the most versatile, capable, and affordable towable on the market. Each **NO·BO** 19 series also features factory installed RVT tracks on the roof, ready to accept and integrate your personalized Rhino Rack Roof System!



NB19.3

SPECIFICATIONS

| MODEL | NB19.1 | NB19.2 | NB19.3 | NB19.5 | NB19.6 | NB19.8 |
|--------------------------------|---------|--------|--------|--------|--------|--------|
| Unloaded Vehicle Weight | 4264 | 3502 | 4199 | 3456 | 4284 | 3789 |
| Hitch Weight (lbs.) | 720 | 414 | 550 | 365 | 490 | 395 |
| Cargo Carrying Capacity | 3456 | 1293 | 3351 | 1309 | 3206 | 1006 |
| Roof Capacity (lbs.) | 500 | 500 | 500 | 500 | 500 | 500 |
| Exterior Length w/o Spare Tire | 24' 11" | 21' 6" | 24' 4" | 22' 8" | 24' 4" | 22' 8" |
| Exterior Width | 88" | 88" | 88" | 88" | 88" | 88" |
| Exterior Height (w/ A/C) | 9' 11" | 9' 11" | 9' 11" | 9' 11" | 9' 11" | 9' 11" |
| Interior Height | 78" | 78" | 78" | 78" | 78" | 78" |
| Fresh Water (gal.) | 30 | 30 | 30 | 30 | 30 | 30 |
| Grey Water (gal.) | 30 | 30 | 30 | 30 | 30 | 30 |
| Black Water (gal.) | 30 | 30 | 30 | 30 | 30 | 30 |

NOTE - Definitions for specifications can be found on the back page of this brochure.

FLOORPLANS

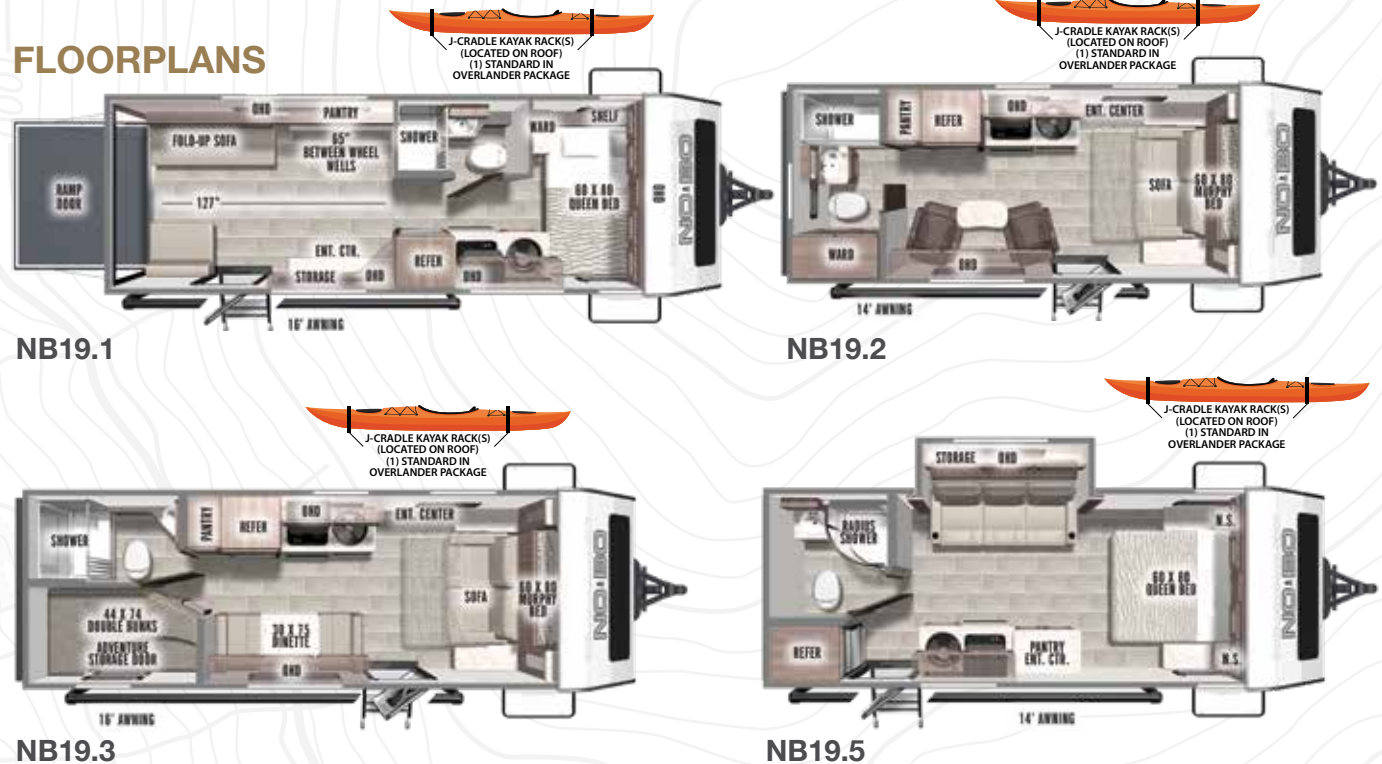

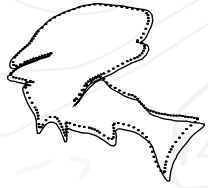

NOBO
NO BOUNDARIES



19 SERIES STANDARDS/OPTIONS

DISCOVERER PACKAGE KEY STANDARD EQUIPMENT

- JBL FLIP Portable Bluetooth Speaker
- Complete Interior/Exterior LED Lighting PKG
- 1000 Lumen White Scare Light
- Metropolitan Grey Lightweight-Ply Countertops
- Stainless Steel Utility Hooks
- Bottle Opener
- Black Satin Faucet/Door Pulls (where applicable)
- High Performance Vinyl Furniture
- 2-Burner Glass Recessed Cook Top
- Black Stainless Steel Sink (where applicable)
- Pleated Shades
- USB Charging Station
- RVT Track (Rhino Rack #RVT148)
- Lamilux 1000 Fiberglass Exterior
Featuring Satin Matte Graphics

OVERLANDER PACKAGE

- Two Vortex Bars (Rhino Rack #VA180B)
- J-Cradle Kayak Holder (Rhino Rack #S510)
- Satin Matte Finish Wheels Wrapped in
All Terrain Tires

BACK COUNTRY PACKAGE

- Custom Front Fiberglass Protective Shell
- Featuring Tempered Seamless Panoramic Window
- Roof Mounted Solar Prep
- 13.5 BTU Low Profile Air Conditioning
- Power Awning
- Rear Ladder
- Azdel Exterior Construction

OPTIONAL EQUIPMENT

- Stainless Steel Convection Microwave Oven
- 12V LED TV
- Power Tongue Jack w/LED Light
- Cold Weather Package (Required)
- Central Vacuum System (Required)
- Hybrid Single Bike Carrier (Rhino Rack #RBC050)
- Snowboard/Ski/Fishing Rod/Paddle Holder
(Rhino Rack #573)
- J-Cradle Kayak Holder (Rhino Rack #S510)
- One Standard Kayak Holder in Overlander PKG
- Solar Package (Heavy-Duty Panel, Inverter,
and Charge Controller)
- 15K A/C IPO 13.5K A/C
- Bush Kitchen (Required)
- Exterior Flat Top Grill, High Pressure Spray Port,
Prep Station, Showermiser



Kenneth Calhoun / NB19.1



Hillery York / NB19.2

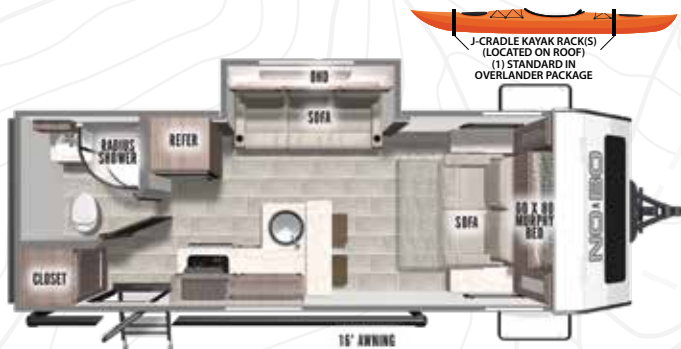

NB19.6

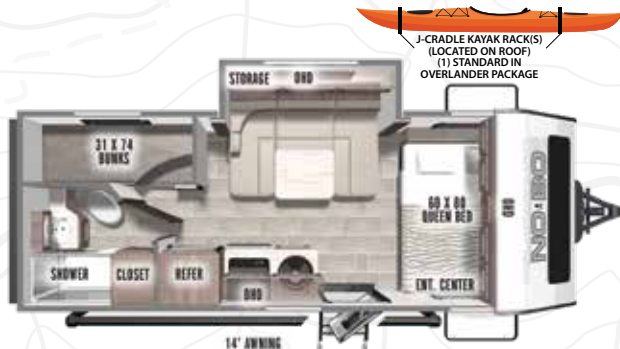

NB19.8





WHEN YOUR NEXT PATH IS OFF THE GRID.

Count on **NO•BO** to take you into uncharted territory. Escape the crowds into the remote rugged wilderness and take your gear with you. Whether in search of a big catch or a big wave, you don't have to leave amenities behind. Explore, get dirty, then return to home base to clean up, relax and recharge.



NB20.4

SPECIFICATIONS

| MODEL | NB20.4 |
|--------------------------------|--------|
| Unloaded Vehicle Weight | 4733 |
| Hitch Weight (lbs.) | 550 |
| Cargo Carrying Capacity | 2817 |
| Roof Capacity (lbs.) | 500 |
| Exterior Length w/o Spare Tire | 23' 9" |
| Exterior Width | 96" |
| Exterior Height (w/ A/C) | 11' 3" |
| Interior Height | 82" |
| Fresh Water (gal.) | 40 |
| Grey Water (gal.) | 40 |
| Black Water (gal.) | 30 |

NOTE - Definitions for specifications can be found on the back page of this brochure.



NB20.4

FLOORPLANS

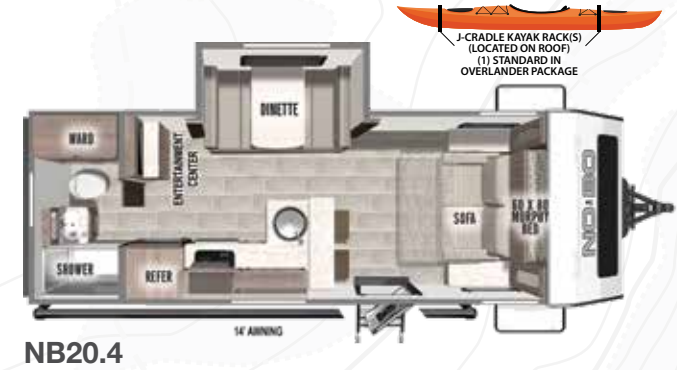

NB20.4



COMING SOON



COMING SOON

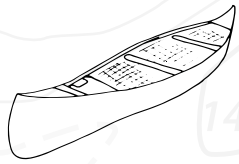

20 SERIES STANDARDS/OPTIONS

NOBO EX-L PACKAGE (REQUIRED) KEY STANDARD EQUIPMENT

- 12V TV
- All LED Lighting
- 15K Air Conditioner
- Tinted Windows
- JBL Flip 5 Bluetooth Speaker
- Best-in-Class Refrigerator
- Seamless Surf-X Countertops
- Recessed Cooktop
- Convection Microwave
- 2-Tone Azdel Exterior with Full Graphics Package
- Panoramic Front Window
- Bauer 7-Way Cord Keeper
- Full-Size Spare Tire
- Black Tank Flush
- Friction Hinge Entrance Door
- Power Tongue Jack w/LED Light
- LP Quick Connect
- Rhino Rack RVT Track
- PVC Roofing Membrane
- Aluminum Cage Construction
- Oversized Power Awning
- Aluminum Rims w/All Terrain Tires
- Large Folding Assist Handle
- Pet Link Leash Connection
- 2 LP Tanks
- Enclosed and Heated Underbelly
- Enclosed Termination System
- Tank Heater Pads
- Smart Vacuum System
- Large Solar Panel
- 10 Amp Controller
- 1000W Inverter
- Battery Disconnect Switch
- MORryde Entry Step



NB20.4



NB20.4



NB20.4

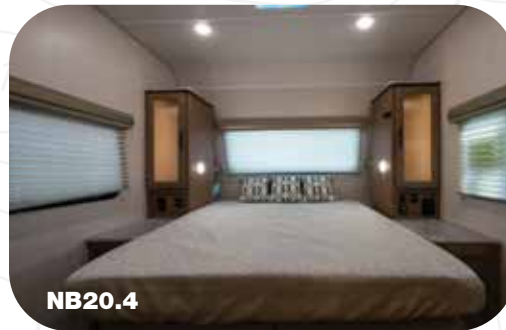

NB20.4



NB20.4



NB19.6



NB19.6



NB19.8



NB19.8



NB10.8



NB19.1



*TO THOSE WITH
NO BOUNDARIES*



Jeff Siter / NB19.6

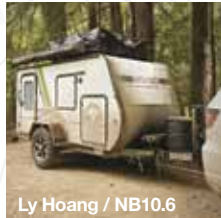

Ly Hoang / NB10.6



Alicia King / NB10.6



Tyler MacMillan / NB10.6

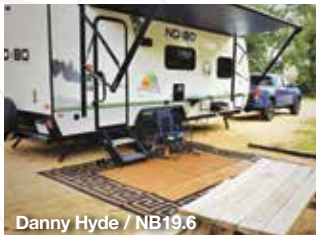

Danny Hyde / NB19.6

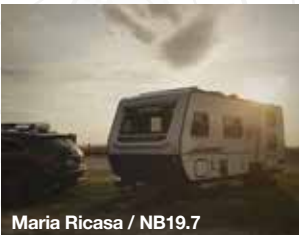

Maria Ricasa / NB19.7



William Bunting / NB19.5



Forest River Owner "Digital Kit" App

Now you can have your Owner's Manual with you wherever you are. Download our FREE App from the App Store or Google Play and you'll have the information right at your fingertips.

This brochure is complete thanks to the support of our wonderful Retail Customers, as you will see their photos throughout. These customers truly exemplify what it takes to be a NoBo Owner – and for that we are grateful and happy to share in their memories.

GVWR (Gross Vehicle Weight Rating) - is the maximum permissible weight of the unit when fully loaded. It includes all weights, inclusive of all fluids, cargo, optional equipment and accessories. For safety and product performance do NOT exceed the GVWR.

GAWR (Gross Axle Weight Rating) - is the maximum permissible weight, including cargo, fluids, optional equipment and accessories that can be safely supported by a combination of all axles.

UVW (Unloaded Vehicle Weight)* - is the typical weight of the unit as manufactured at the factory. It includes all weight at the unit's axle(s) and tongue or pin and LP Gas. The UVW does not include cargo, fresh potable water, additional optional equipment or dealer installed accessories.

*Estimated Average based on standard build optional equipment.

CCC (Cargo Carrying Capacity)** - is the amount of weight available for fresh potable water, cargo, additional optional equipment and accessories. CCC is equal to GVWR minus UVW. Available CCC should accommodate fresh potable water (8.3 lbs per gallon). Before filling the fresh water tank, empty the black and gray tanks to provide for more cargo capacity.

** Estimated average based on standard build optional equipment.

Each Forest River RV is weighed at the manufacturing facility prior to shipping. A label identifying the unloaded vehicle weight of the actual unit and the cargo carrying capacity is applied to every Forest River RV prior to leaving our facilities. The load capacity of your unit is designated by weight, not by volume, so you cannot necessarily use all available space when loading your unit.



Find us on Facebook

FREE MEMBERSHIP
to Forest River Owners' Group



www.forestriverfrog.com

CUSTOMER SATISFACTION



www.ForestRiverBuyLocal.com

No Boundaries Division
Forest River, Inc.
1702 Century Dr.
Goshen, IN 46528
(574) 642.3119

www.forestriverinc.com/nobo
www.forestriveraccessories.com



PRE-DELIVERY INSPECTION FACILITY

20,000 square feet of quality assurance. The bare essentials for a premium product. This state-of-the-art facility gives immediate daily feedback to production for quality assurance in every unit built.

| | |
|--|-------------------------|
| 24/7 EMERGENCY ROADSIDE ASSISTANCE WITH VEHICLE PURCHASE* | |
| TOWING | WINCH-OUT |
| JUMP-STARTS | MOBILE MECHANIC |
| TIRE CHANGES | TECHNICAL |
| FLUID DELIVERY | SUPPORT |
| LOCKOUT SERVICE | DEALER LOCATOR SERVICES |
| | |
| *VALID FOR 1 YEAR FROM DATE OF PURCHASE | |

Your local dealer



Learn More
Scan this barcode using a QR Reader on your smart phone to learn more about Forest River.



A Berkshire Hathaway company.

All information contained in this brochure is believed to be accurate at the time of publication. However, during the model year, it may be necessary to make revisions and Forest River, Inc., reserves the right to make all such changes without notice, including prices, colors, materials, equipment and specifications as well as the addition of new models and the discontinuance of models shown in this brochure. Therefore, please consult with your Forest River dealer and confirm the existence of any materials, design or specifications that are material to your purchase decision. 12/21

©Copyright 2021 Forest River Inc – All Rights Reserved.