

HIGH ADRENALINE

Heart-pumping style, pioneering floorplans, and mind-blowing amenities, Keystone Fuzion sets the high mark for toy hauler RVs.

BRAWNIER HAULING

- NEW extended garage lengths w/ outside storage to haul bigger toys
- Beefy Adjust-A-Track™ frame-welded tie downs with 38 points of contact, each supporting 5,000 lb.
- Water-resistant, Zero-G MORRyde® ramp door
- Fully enclosed fuel pump station integrated with iN-Command®
- MORRyde® CRE/3000 suspension

UNPARALLELED TECHNOLOGY

- NEW SolarFlex 200, 400i & 600i-L solar power packages
- iN-Command® Generation 3 control system w/ Global Connect
- Equalizer Systems' EQ Smart Level

THOUGHTFUL LIVING

- NEW on-demand hot water
- East/west bed slides w/ full size front closet
- NEW central vac w/ toe-kick dustbins
- NEW Suburban Elite Series gas cooktop & drawer
- Space saving, swing-out bar stools
- Soft-close cabinet doors

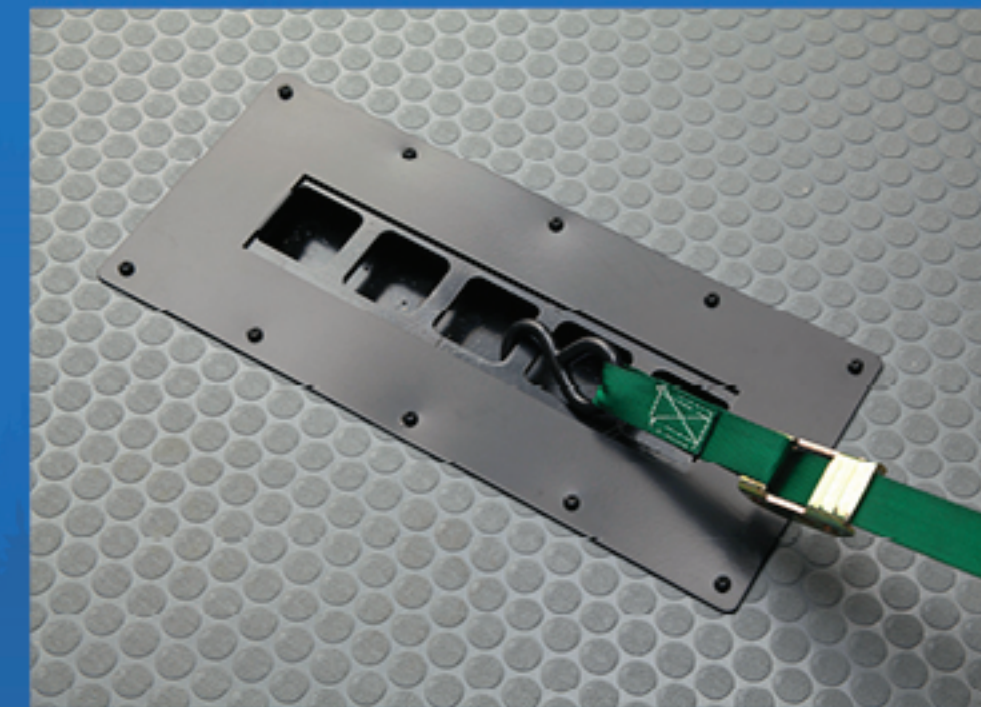

Adjust-A-Track™

Exclusively available on Fuzion, Adjust-A-Track™ frame-welded tie downs provide a stunning 38 connection points, each supporting 5,000 lb.



Omni-Chill™

With its ¾ ton residential A/C, Omni-Chill delivers the equivalent of 16,200 BTU's and is one of the most energy-efficient, highest performing cooling systems available.



Full Body Paint

Fuzion ups the ante with bold new exterior graphics and the option to make a statement with full body paint.

SCAN HERE TO LEARN MORE



VISIT KEYSTONERV.COM/FUZION FOR IN-DEPTH PRODUCT INFORMATION, VIDEOS, MODEL 360'S AND MORE.



PRINT 8.2021

Learn more about the SolarFlex difference and packages now available.

LAUNCHING AS STANDARD EQUIPMENT ON ALL KEYSTONE TRAVEL TRAILERS AND FIFTH WHEELS, FALL 2021

SOLAR FLEX

TAKE CHARGE OF HOW YOU CAMP

The Solar Energy System You've Been Waiting For

Impossibly versatile, exceptionally designed, SolarFlex is shattering customers' expectations of factory-installed solar power. SolarFlex eliminates the guesswork to deliver affordable, high quality solar energy systems.

Fuzion offers SolarFlex 200 as standard, with the option to upgrade to SolarFlex 400i or SolarFlex 600i-L.

 **KEYSTONE**
RV COMPANY | **CAMP BETTER**

 **KEYSTONE**
RV COMPANY | **CAMP BETTER**

FUZION

FIFTH WHEEL TOY HAULERS



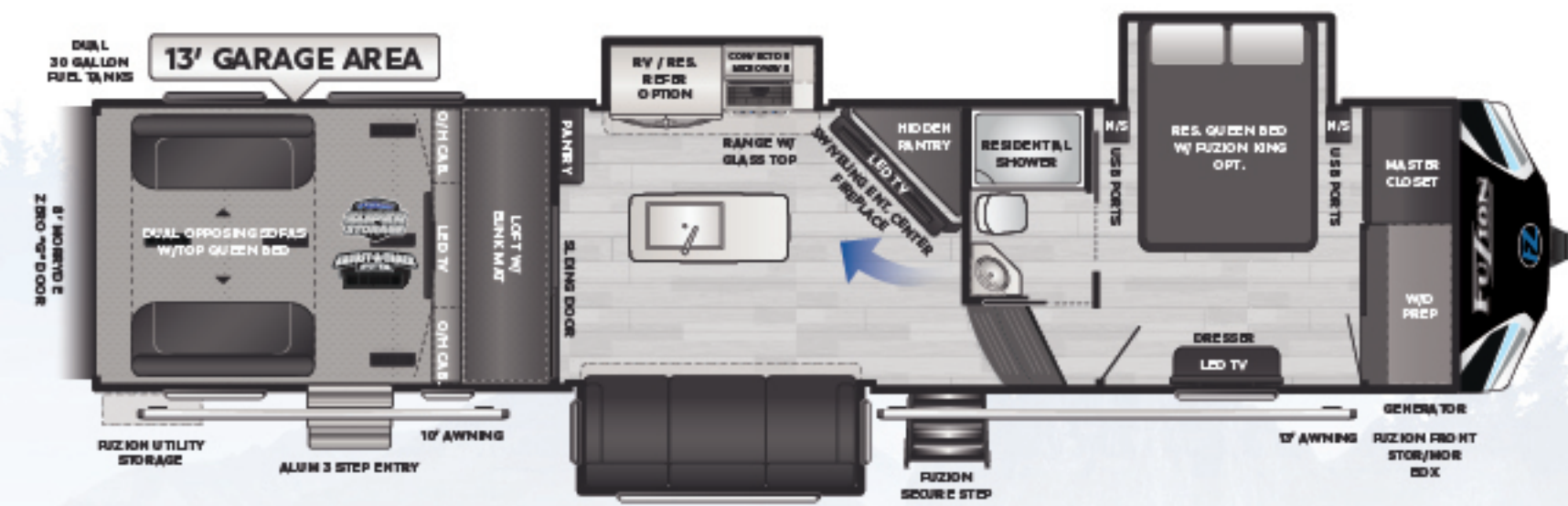

357 Kitchen island, hidden pantry, tandem-axle, 13' garage
WEIGHT 13856 LENGTH 39' 0"

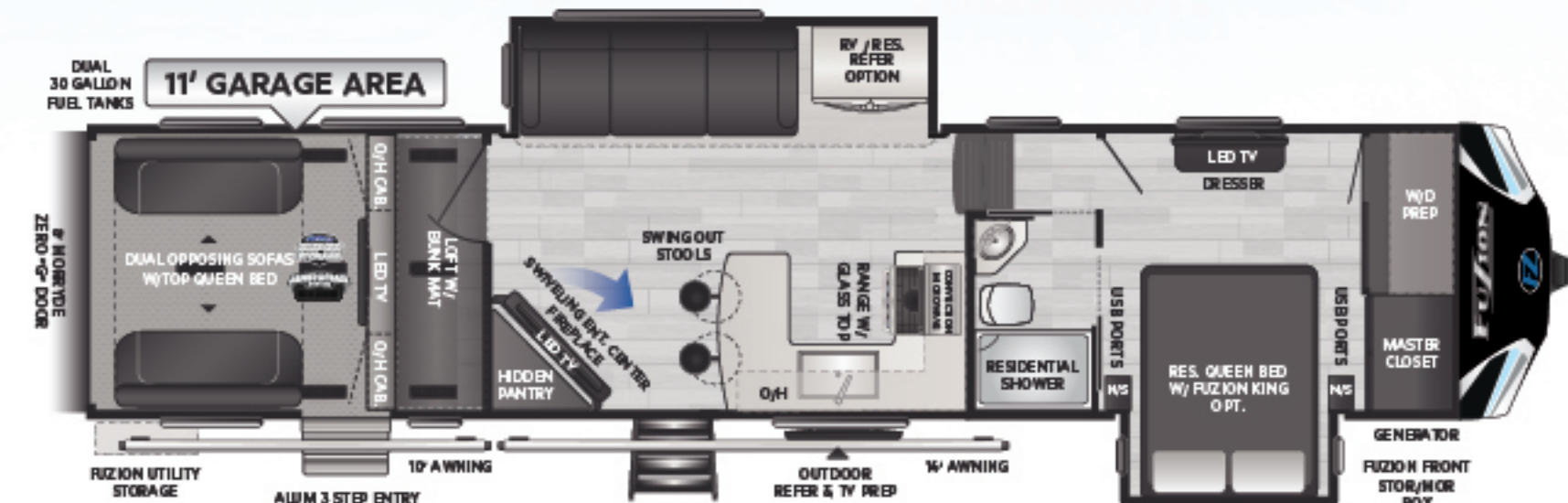

369 Bar top seating, hidden pantry, tandem-axle, 11' garage
WEIGHT 13779 LENGTH 39' 0"

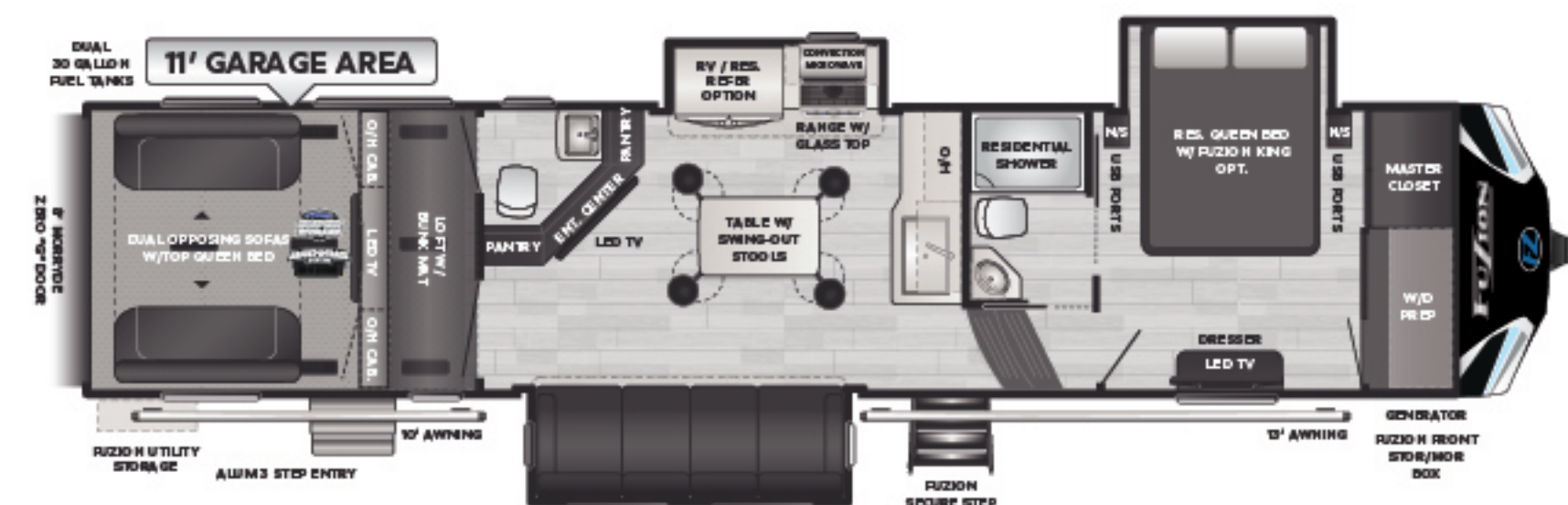

373 Kitchen island, swing out stools, 1 1/2 bath, tandem-axle, 11' garage
WEIGHT 14416 LENGTH 39' 0"

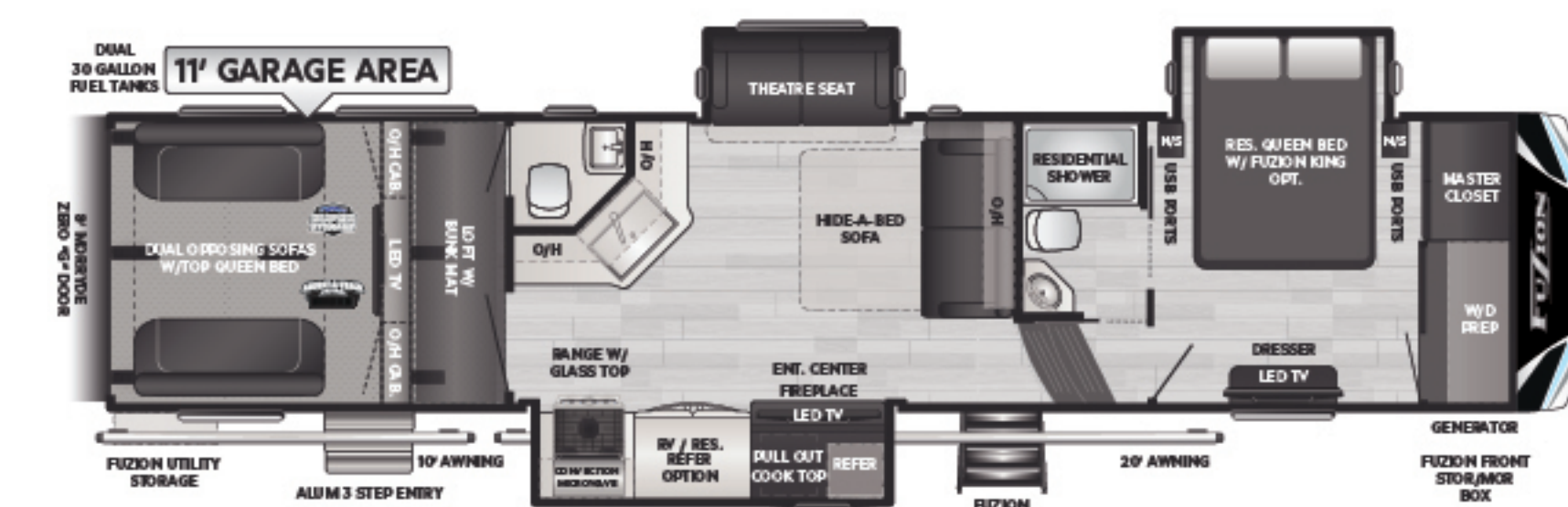

379 Cross conversational seating, 1 1/2 bath, outdoor kitchen, 11' garage
WEIGHT 14576 LENGTH 39' 6"

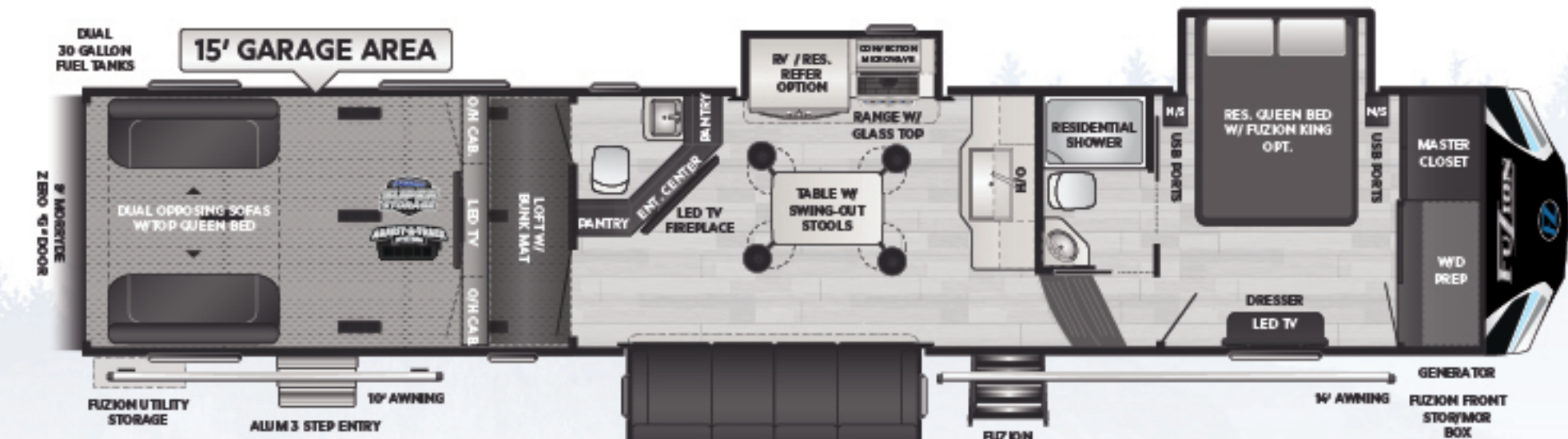

419 Kitchen island, swing out stools, 1 1/2 bath, triple-axle, 15' garage
WEIGHT 15485 LENGTH 44' 0"

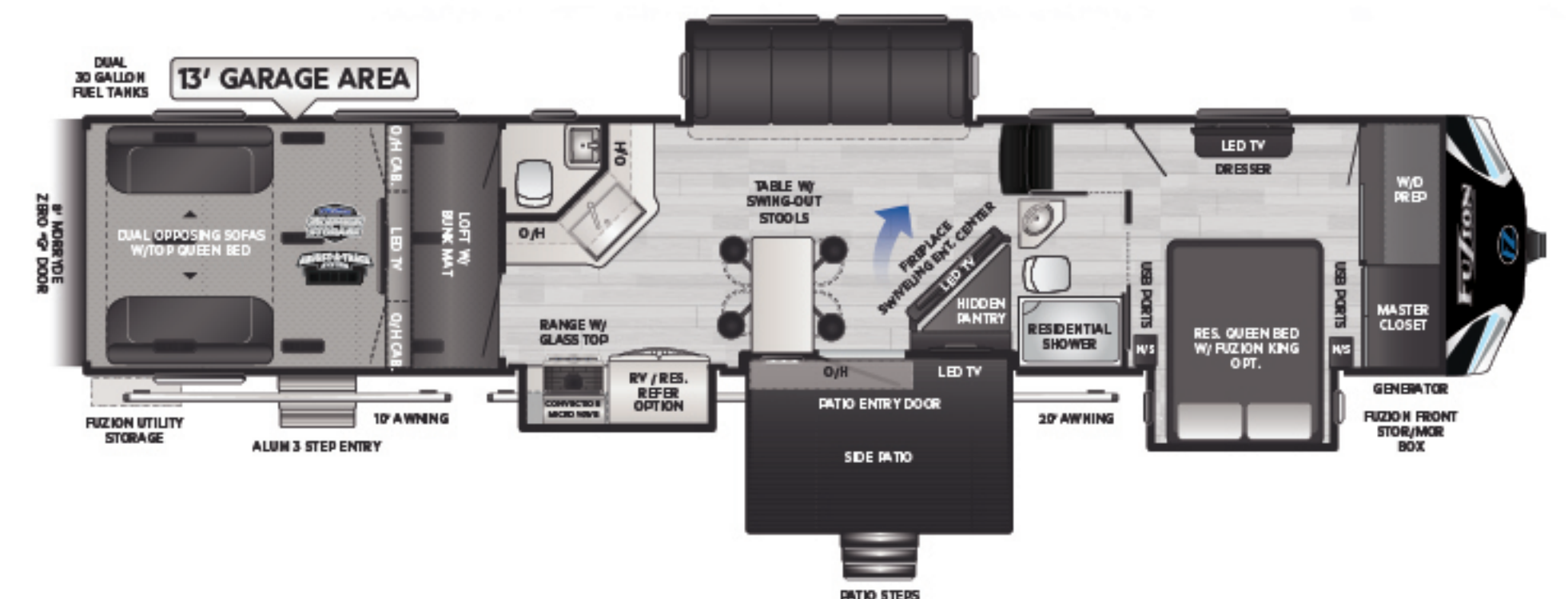

424 Side patio, 1 1/2 bath, triple-axle, 13' garage
WEIGHT 16230 LENGTH 44' 0"

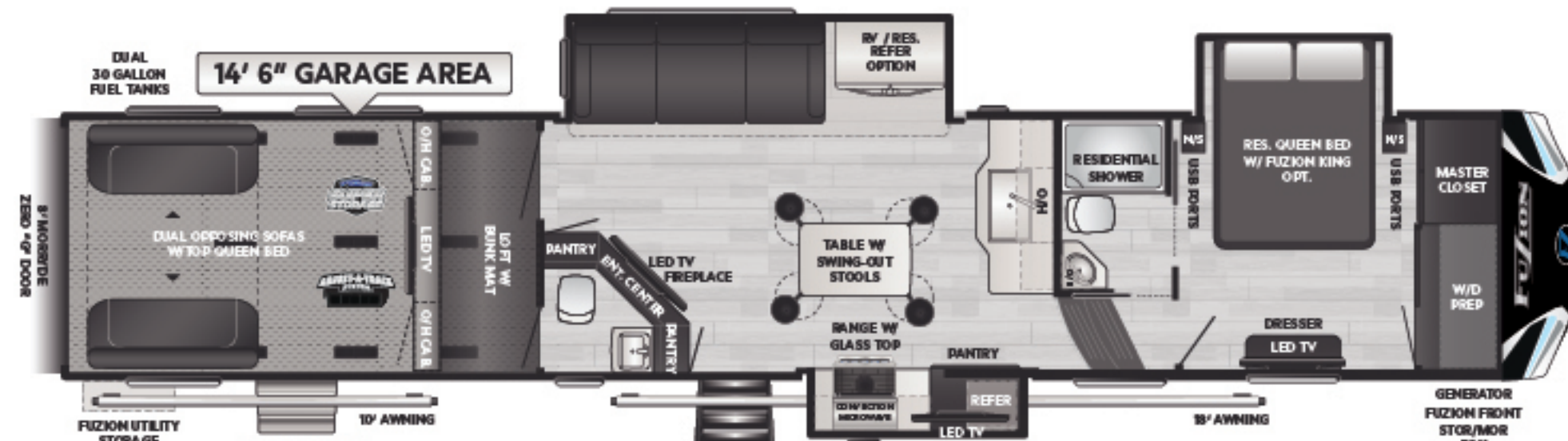

427 1 1/2 Bath, outdoor kitchen, triple-axle, 14' 6" garage
WEIGHT 15770 LENGTH 44' 11"

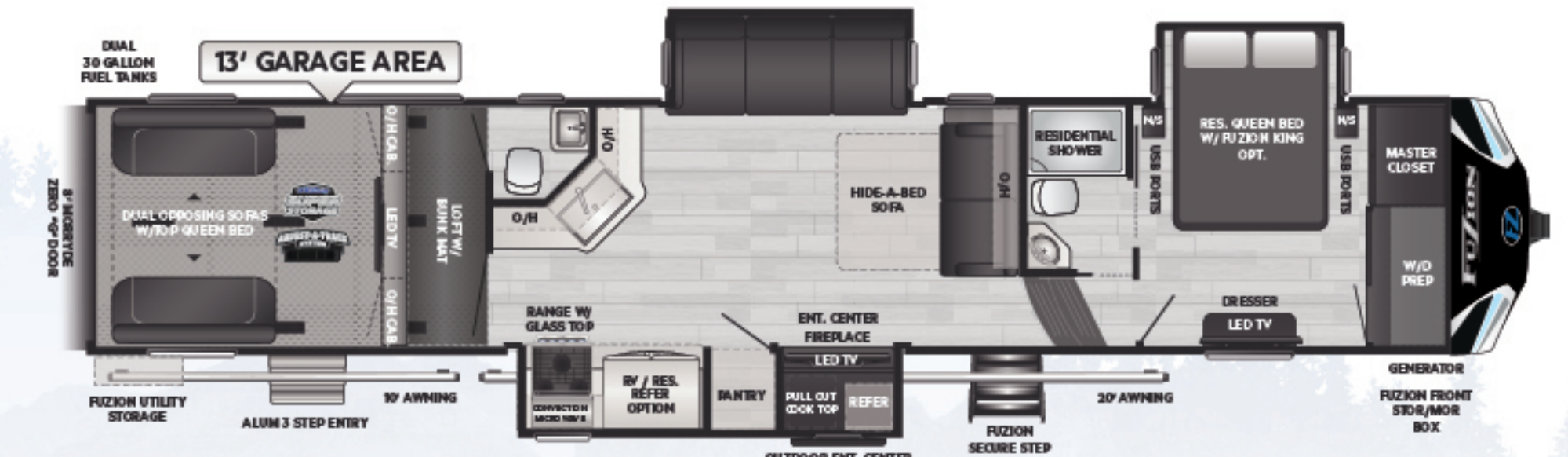

428 Cross conversational seating, 1 1/2 bath, outdoor kitchen, 13' garage
WEIGHT 15932 LENGTH 44' 11"

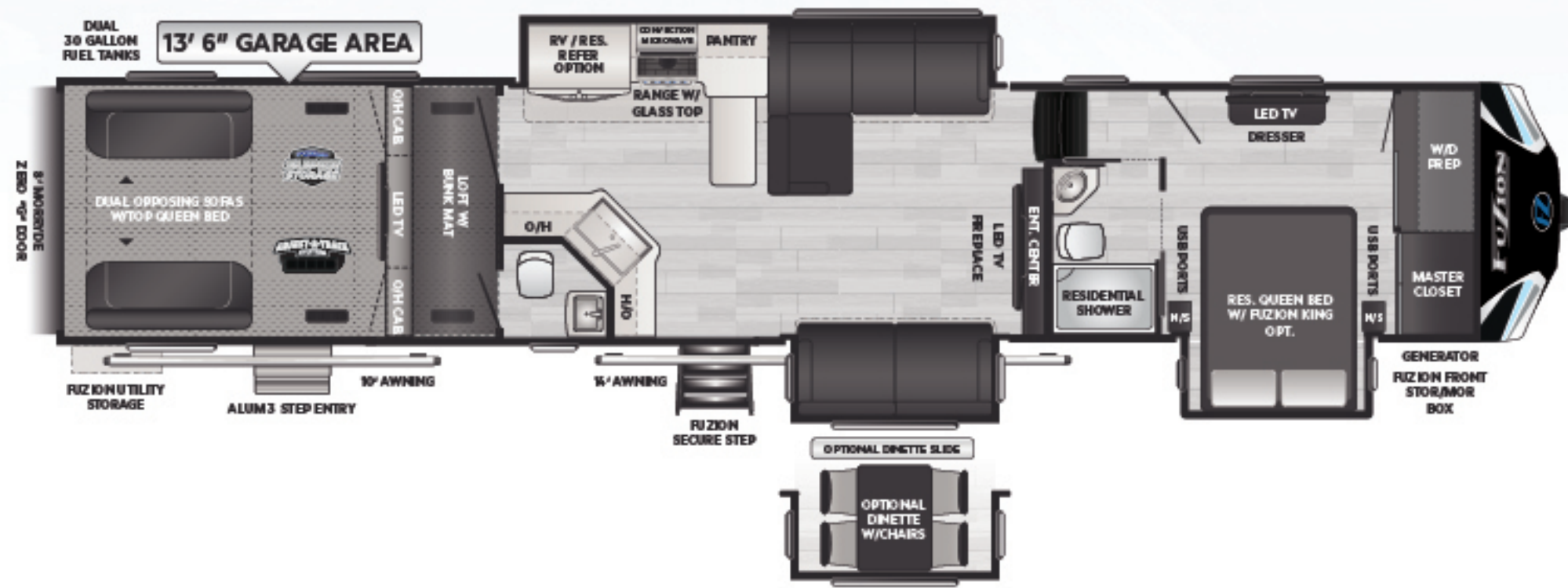

429 L-shaped sofa, 1 1/2 bath, triple-axle, 13' 6" garage
WEIGHT 15570 LENGTH 44' 11"

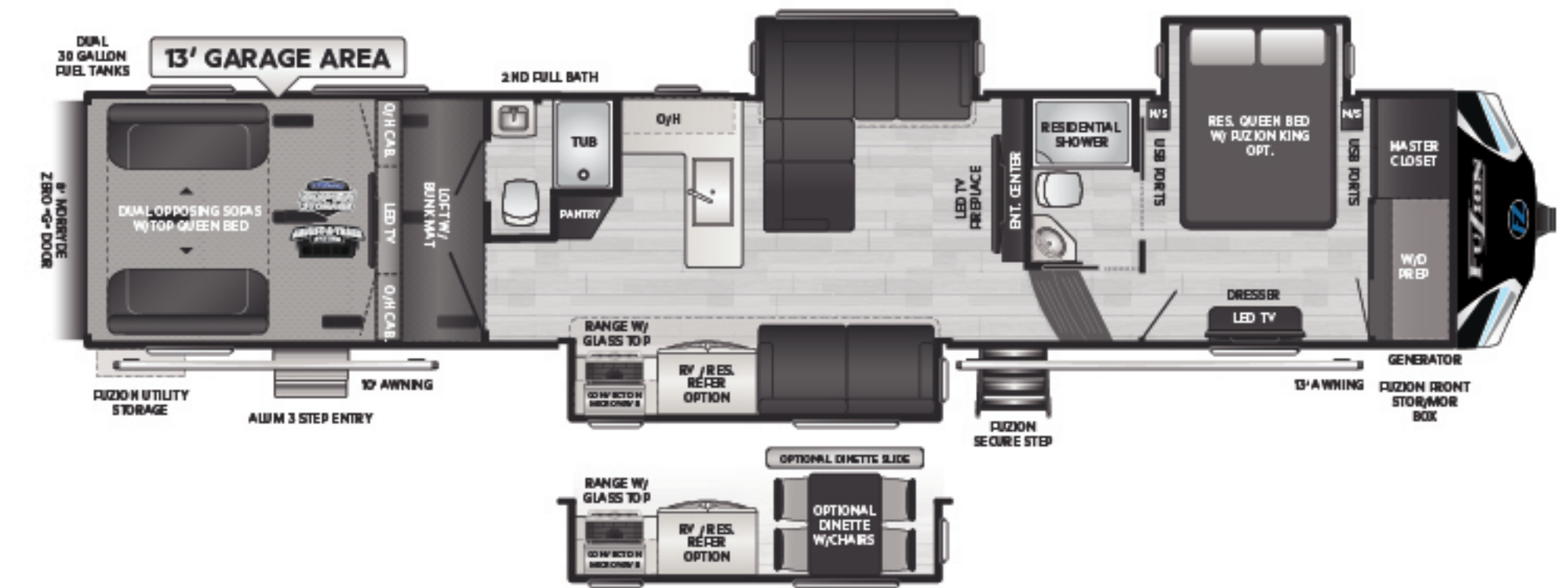

430 L-shaped sofa, 2 full baths, triple-axle, 13' garage
WEIGHT 15915 LENGTH 44' 11"

MODEL	WEIGHT	CARRYING CAPACITY	HITCH WEIGHT	FRESH WATER	WASTE WATER	GRAY WATER	LPG	LENGTH*	WIDTH	HEIGHT	AWNING
357	13856	3144	3000	94	44	88	60	39' 0"	8' 4"	13' 3"	10'/13'
369	13779	3221	3015	94	44	88	60	39' 0"	8' 4"	13' 3"	10'/14'
373	14416	2584	3155	94	88	88	60	39' 0"	8' 4"	13' 3"	10'/13'
379	14576	2424	3155	94	88	88	60	39' 6"	8' 4"	13' 4"	10'/20'
419	15485	4515	3330	94	88	88	60	44' 0"	8' 4"	13' 5"	10'/14'
424	16230	3770	3525	94	88	88	60	44' 0"	8' 4"	13' 5"	10'/20'
427	15770	4230	3535	94	88	88	60	44' 11"	8' 4"	13' 5"	10'/18'
428	15932	4068	3595	94	88	88	60	44' 11"	8' 4"	13' 5"	10'/20'
429	15570	4430	3415	94	88	88	60	44' 11"	8' 4"	13' 5"	10'/14'
430	15915	4085	3440	94	88	88	60	44' 11"	8' 4"	13' 3"	10'/13'

DISCLAIMER: Product information is as accurate as possible as of the date of publication of this brochure. All features, floor plans, and specifications in this brochure are subject to change without notice. Please also consult Keystone's web site at www.keystonev.com for more current product information and specifications. Tow Vehicle Disclaimer. CAUTION: Owners of Keystone recreational vehicles are solely responsible for the selection and proper use of tow vehicles. All customers should consult with a motor vehicle manufacturer or their dealer concerning the purchase and use of suitable tow vehicles for Keystone products. Keystone disclaims any liability or damages suffered as a result of the selection, operation, use or misuse of a tow vehicle. KEYSTONE'S LIMITED WARRANTY DOES NOT COVER DAMAGE TO THE RECREATIONAL VEHICLE OR THE TOW VEHICLE AS A RESULT OF THE SELECTION, OPERATION, USE OR MISUSE OF THE TOW VEHICLE. *Length is defined as the distance from hitch pin/coupler to rear bumper of trailer. Please review owner's manual prior to purchase for more information on service warranties, extended use, towing and maintenance. Owner's manuals can be found at keystonev.com.