

Ultra-Lite Standard Features & Lite Value Package

Interior

- White Vinyl-Clad Ceiling Panels
- Easy-Care Vinyl Wallcovering
- Craft-made Cabinetry w/Hardwood Cabinet Doors, Mortise & Tenon Joints
- Designer Drawer & Door Pulls
- High-Performance Vinyl Flooring
- Fabric-Wrapped Box Valances
- Laminated Countertops

Heating & Cooling

- 16,000 BTU Gas Furnace (24RLS 20K BTU)
- Ducting & Wiring for Value Package Air Conditioning (Ducting N/A 248BH)

Safety

- Wall-Mount Fire Extinguisher
- Combined CO/LP Detector
- Smoke Detector
- Safety Chains

Electrical

- 30 Amp Service, 45 Amp Converter/Charger
- Marine Power Cord
- Cable-Ready Connection
- Central Control Panel

Furnishings

- Booth-Style Dinette
- Queen Bed & Bedspread
- Privacy Drape(s)
- Mini-Blind for Kitchen Window
- Electric Slide-Out for Sofa & Dinette (268BH, 274QB, 279BH)
- Sofa Slide-Out (238RK)
- Dinette Slide-Out (236RL, 24RLS)

Appliances

- Power Range Hood w/Light
- Microwave Ready
- 6 cu. ft. 2-Door Dometic Refrigerator/Freezer in 241RB, 248BH "Show Stoppers"
- 3-Burner Gas Range (2-Burner Range in 241RB, 248BH "Show Stoppers")

Bath

- Foot-Flush Toilet
- Power Bath Vent
- Neo-Angle Shower w/Glass Shower Door (20RBS, 236RL, 238RK, 241RB, 24RLS)
- Skylight over Tub
- Shower Curtain

Exterior

- Unibody Construction w/steel hurricane straps tying walls to roof and floor
- 4 1/4" x 1/4" Steel Header in Main Slides
- Pass-Thru Storage (most models)
- Diamond Plate lower front
- One-Piece Synthetic Vinyl Roof
- Radius Safety Glass Windows
- (4) 14" Tires/Rims
- 2 x 20 lb. LP Bottle & Cover

Lite Value Package (included, required)

- Radiant LED Interior Lighting Package
- Electric Awning w/LED Lighting (N/A 241RB, 248BH)
- 10.7 cu. ft. Everchill Refrigerator/Freezer (N/A 241RB, 248BH)
- Molded Countertops w/Undermount Sink (N/A 241RB, 248BH)
- 6 Gal DSI Water Heater
- Front Power Hitch Jack (N/A 241RB, 248BH)
- Blue Tooth Radio w/2 Inside & 2 Outside Speakers
- Pleated Privacy Shades
- Microwave Oven
- Digital TV Antenna w/Power Booster
- (4) Stabilizer Jacks
- 13,500 BTU Air Conditioner
- Pull-Out Sprayer Faucet (N/A 241RB, 248BH)
- Swing-Away Grab Handle
- Frosted Glass Window in Entry Door
- Designer Backsplash in Kitchen
- Bath Skylight
- Tech-Ready Upgrades: Wi-Fi-Ready Connections, Solar Panel Prep, Back-Up Camera Hookups, Satellite TV Ready, Multiple USB ports
- Friction Hinge Entry Door
- Tinted Windows
- Upgraded Exterior Graphics
- Radial Tires
- Bunk Mats (Bunk floor plans)
- Frosted Glass Kitchen Cabinet Doors
- Upgraded Furniture Package

Ultra-Lite Options

- Spare Tire & Wheel
- Aluminum Wheels
- 3-Burner Range w/Oven & Glass Top (N/A 241RB, 248BH "Show Stoppers")
- Battery Disconnect Switch
- Sink Cover (N/A 241RB, 248BH)
- SolidStep® Entry Step (N/A 241RB, 248BH "Show Stoppers")
- 6 Gal Gas/Electric 110V DSI Water Heater
- 15,000 BTU Air Conditioner
- 6 cu. ft. Two-Way Dometic Refrigerator/Freezer in place of 10.7 cu. ft. 110V Fridge
- Blue Tooth Soundbar in place of Radio (N/A 238RK, 241RB, 248BH)
- Outside Kitchen (236RL, 274QB, 279BH)
- Murphy Bed (248BH)
- Theater Seating in place of Jack Knife Sofa (238RK only)
- Outside Shower
- Tub Surround
- Fiberglass Exterior Walls w/Fender Skirt (N/A 24RLS)
- Shower Pan in place of Tub
- Second Swing-Away Grab Handle
- 50-Amp Wiring for 2nd AC (274QB, 279BH)
- Electric Fireplace (24RLS, 268BH, 274RB, 279BH)

**Multi-Year Winner,
RVDA Quality
Circle Award**
for industry-
leading quality,
sales, warranty,
service, and parts



AMERI-LITE Ultra-Lite

By Gulf Stream Coach



Relax - You're Covered!
**With Our Exclusive Three-Year
Limited Structural Warranty**

In addition to a standard one-year warranty against defects in materials and/or workmanship in construction and original components under normal use, our exclusive Gulf Stream Coach Warranty gives you THREE YEARS of coverage on key structural components (sidewalls, front and rear walls, roof, and floor) of your new Ultra-Lite travel trailer.

In addition, extended protection is offered by many manufacturers that supply components for Ultra-Lite units, including the refrigerator, antenna, furnace, water heater, awning, air conditioner, range, microwave, and more.

See the full warranty statement for details.

Your Gulf Stream Coach Dealer:



QUALITY • VALUE • INNOVATION

www.gulfstreamcoach.com

503 South Oakland Avenue, Nappanee, IN 46550

NOTE: 241RB and 248BH "SHOW STOPPERS" use a modified list of standard features and limited options to provide RVers with the most economical pricing. Check with your dealer for complete information on "Show Stopper" features.

Super Lite From Gulf Stream Coach

Floor Plans

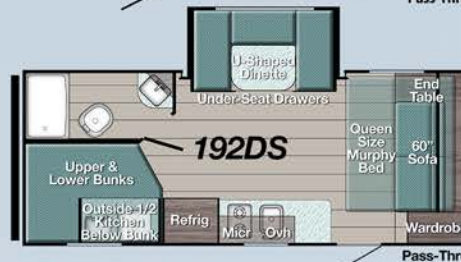
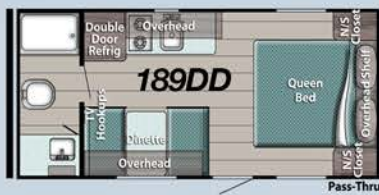
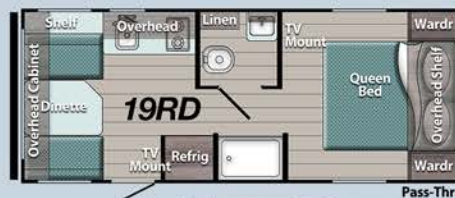
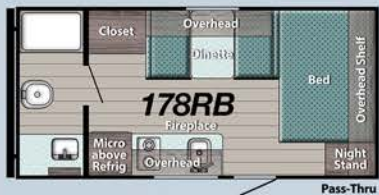
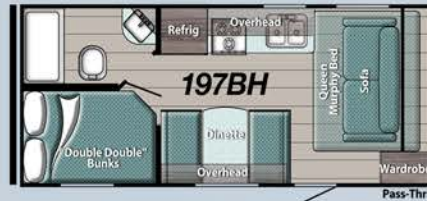
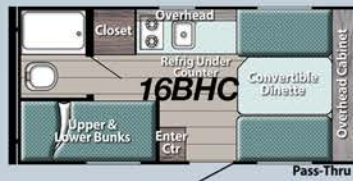

As our most affordable series, Super Lite Travel Trailers have features and floor plans perfect for tight budgets, first-timers, and casual campers.

Standard Features & Packages

Standard Features

- High-Performance Vinyl Flooring
- Fabric-Wrapped Box Valances
- Craft-made Cabinetry w/Designer Pulls
- Easy-Care Wall Vinyl
- Laminated Countertops w/Vinyl T-Molding
- White Kitchen Sink
- 30 Amp Svc w/45 Amp Converter/Charger
- Wall-Mount Fire Extinguisher
- Combo CO/LP Detector
- Smoke Detector
- Monitor Panel
- Pleated Shades
- Seamless Synthetic Vinyl Roof
- Diamond Plate Lower Front
- Radius Safety Glass Windows
- Safety Chains
- Single Entry Step

Convenience Pkg. (req. 14RE, 189DD, 197BH, 199RK, 199DD, 192DS)

- 6 cu. ft. Double Door Refrigerator
- TV Antenna
- Swing-Away Grab Handle
- Pot & Pan Drawer (189DD, 199RK)

Rocky Mountain Edition (189DD & 199DD only)

- Overslung Axle
- Knobby Tires
- Fender Covers, Wheel Wells
- Double Entry Step
- Aluminum Wheels
- Bottom Diamond Plate Metal

Camping Pkg. (Included, required)

- 2-Burner Gas Cooktop
- Microwave Oven
- 6-Gal Gas DSI Water Heater
- 13,500 BTU Roof Air Conditioner
- 20 lb. LP Gas Tank
- Shower & Toilet
- (2) Rear Stabilizer Jacks
- Power Awning
- Teddy Bear Mattress(es) (Bunk models)
- Wood Ceiling Trim
- 6'8" Interior Height
- High-Rise Kitchen Faucet
- Friction Hinge Entry Door
- Central Control Panel
- Radial Tires
- LED Interior Lights
- 16,000 BTU Furnace (N/A 177BH, 178RB)
- Multiple USB Ports

Popular Options

- Blue Tooth Radio w/Int. & Ext. Speakers
- Prep for Solar Panel
- Prep for Backup Camera
- Bedspread
- 6 Gal Gas/Elec 110V DSI Water Heater
- Spare Tire
- Fiberglass Walls
- Double SolidStep® Entry Step
- 3 cu. ft. Gas/Electric Refrig (16BHC)
- 1/2 Outside Kitchen (197BH, 192DS only)

Specifications

Specifications are approximate and subject to change. For actual weights, check weight sticker in each unit.

	14RE	16BHC	177BH	178RB	189DD	199DD	197BH	199RK	19RD	192DS
Length	15'10"	18'10"	20'11"	20'11"	20'11"	20'11"	22'2"	22'2"	23'1"	23'2"
Width	90"	84"	96"	96"	96"	96"	96"	96"	96"	96"
Height w/AC	10'3"	10'4"	10'4"	10'4"	10'4"	10'4"	10'8"	10'8"	10'8"	11'3"
Int. Height	6'8"	6'8"	6'8"	6'8"	6'8"	6'8"	6'8"	6'8"	6'8"	6'8"
Base Weight	2,800	2,612	2,810	2,800	2,996	3,100	3,580	3,520	3,552	3,580
Hitch Weight	300	360	330	360	350	360	638	490	390	390
Net Carry Cap.	1,020	1,268	1,020	1,080	854	760	1,395	1,370	1,238	1,238
Fresh Water	30	30	30	30	30	30	30	30	30	30
Grey Tank	36	36	36	36	36	36	36	36	36	36
Black Tank	36	36	36	36	36	36	36	36	36	36
Furnace BTUs	16,000	16,000	(Elec.)	(Elec.)	16,000	16,000	16,000	16,000	16,000	16,000
Water Heater	6 Gal	6 Gal	6 Gal	6 Gal	6 Gal	6 Gal	6 Gal	6 Gal	6 Gal	6 Gal
LP Tank lbs.	20	20	20	20	20	20	20	20	20	20



QUALITY • VALUE • INNOVATION
www.gulfstreamcoach.com
 503 S Oakland Ave. • Nappanee, IN 46550

Specifications, materials, and features are subject to change without further notice. Not responsible for typographical errors. Visit www.gulfstreamcoach.com or your dealer for more information. ©2022 Gulf Stream Coach, Nappanee, IN 46550 USA • #SUP112022