



Eagle HT



Serial #: 1UJBA0BU6T1C70096
Model: 312BHOK EAGLE HT TT

Model Year: 2026 Dealer Name: BOURBON RV CENTER, INC
133 OLD SPRINGFIELD ROAD
BOURBON, MO 65441
USA

Standard Equipment

THE FOLLOWING ITEMS ARE STANDARD ON THIS MODEL

STANDARD EXTERIOR EQUIPMENT

- 1.5 in. fresh water drain valve
- 5 in. Magnum Truss™ w/ Plywood Roof Decking
- Alpha Ply TPO Roof membrane (thickest roof membrane w/ Limited Lifetime Warranty)
- 50-amp detachable power cord
- LED lighting in pass through area
- Auto-grade vinyl graphics
- Automotive style front cap with max turn radius (painted on select models)
- Black tank flush
- Additional Dump Valve @ Termination
- LED light & Switch at Termination
- Climate Shield™ zero-degree tested weather protection:
- * Fully enclosed and heated underbelly (ducted)
- * 35,000 BTU furnace
- * Double layer fiberglass batt insulation in ceiling and floor
- * Double sided radiant barrier insulation (roof, floor and behind cap)
- * PEX plumbing
- Dual 30 lb. LP bottles
- Factory installed roof ladder
- Galvalume steel coated outside kitchens
- HELIX Cooling System™ (industry exclusive):
- * Jayco exclusive insulated dual duct design
- * Directional and closeable A/C vents
- * Larger return air vents with user accessible filters
- Independent satellite and cable hookups (outside kitchens and/or pass through storage areas)
- LED exterior lighting package
- LP quick connect for gas griddle (next to JayPort)
- Metal slam latch baggage doors
- Nautilus 2.5 water connections
- Nitrogen filled undermount spare tire (model/option varies 15 in. or 16 in.)
- Quick connect water connections (door side hot/cold and off door side cold only)
- Slide topper/awning prep
- Stronghold VBL™ walls (laminated sidewalls, rear walls and slide out walls)
- Rear Camera Prep
- 30"x 22" Shower Skylight

LUXURY PACKAGE (MANDATORY)

- Blackout roller shades with reflective side throughout
- GE black glass 10 cu. ft. 12V refrigerator
- JayPort 2 in. mount (for outside accessories)
- Residential style glass shower door
- Washer/dryer prep (select models)
- GE 30 in. over-the-range black and stainless microwave with exhaust fan
- GE black and stainless 21 in. range with edge to edge grates
- Inverter pre-wire (multiple locations throughout)
- Multi-Function "ALL in ONE" Black Stainless-steel kitchen sink
- Residential 66 in. x 80 in. OLYMPIC size mattress
- Magnetic Catches for all Drawers & Doors
- Solid Surface Kitchen Countertop(s)
- LED fireplace with 5,000 BTU electric space heater (select models)
- JayCommand w/ Monitor Switch Panel
- Exterior Light & Outlet at the JayPort Location

STANDARD INTERIOR EQUIPMENT

- 100% No Floor Vents
- 2-piece high gloss bathroom surround
- 5/8 in. tongue-and-groove plywood flooring
- 75 lb. full extension drawer guides
- Bathroom skylight
- Bedroom TV, satellite and cable prep
- CPAP prepped bedroom (both sides)
- Extra 120V power outlets in kitchen and slide rooms (where applicable)
- Gas strutted under bed storage
- Handcrafted and glazed door/drawer fronts
- LED fireplace with 5,000 BTU electric space heater (select models)
- Matte black kitchen faucet with pull-out sprayer
- Medicine cabinet with custom framed mirror
- NuVo H2O Water Treatment System (filters included)
- Porcelain foot flush toilet
- Residential vinyl flooring throughout (NO CARPET)
- Solid hardwood slide fascia
- Teak Seat Shower Prep
- Theater seating (select models)
- Tri-fold hide-a-bed sofa with residential memory foam sleep surface (select models)
- USB-C 12V charging ports (multiple locations throughout)
- Water shutoff at all faucet locations
- 4" Interior Ceiling Can Lighting (4000K lumen)

CUSTOMER VALUE PACKAGE (MANDATORY)

- 15K BTU "Whisper Quiet" A/C and bedroom A/C prep
- 40" 4K Ultra LED HD Smart TV in living room
- 50-amp service with dual A/C ducts
- 60K on-demand tankless water heater
- Custom machined aluminum rims
- Electric patio awning (integrated dimmable LED lights w/ JAYCOMMAND)
- Hidden hinges on cabinet doors
- Interior "Blue Sync" Audio Connect w/ MB Quart Sound (TV & Phone)
- Exterior "Blue Sync" Audio Connect w/ MB Quart Sound (TV & Phone)
- Keyed-Alike™ lock system
- MORryde Step Above™ entrance steps (main entrance) with blue LED light
- Overlander I solar package
- Rain proof bathroom power vent
- Rear 2 in. towing receiver (4-pin connector on fifth wheels only)
- Winegard Air 360 + Antenna & Router Prep (NOW 5G)
- Inverter pre-wire (multiple locations throughout)

4 STAR HANDLING PACKAGE (MANDATORY)

- Dexter® Axles with NEV-R-Adjust® brakes and E-Z Lube® hubs
- 15" Rainier "E" Rated tires OR 16" Rainier "H" Rated tires
- MORryde® CRE-3000™ rubberized suspension
- Wet bolt fasteners with bronze bushings

Optional Equipment

OPTIONAL EQUIPMENT INSTALLED ON THIS VEHICLE BY MANUFACTURER

Base price	63,900.00
USA STANDARDS	n/c
CUSTOMER VALUE PACKAGE	6,263.00
LUXURY PACKAGE	7,493.00
FOUR STAR HANDLING PACKAGE	3,743.00
OVERLANDER I SOLAR PACKAGE	n/c
2ND 15,000 AC IN BEDROOM	1,043.00
TINTED SAFETY GLASS WINDOWS	n/c
ELECTRIC STABILIZER JACKS (2 SETS)	n/c
STANDARD BRAKE	n/c
16" TIRE DINETTE	n/c
THEATER SEATING SOFA	368.00
FURNITURE CUP HOLDER TABLES-1 PAIR	113.00

BRV's
Discount Price
\$62,970

UNIT TOTAL **82,923.00**

DEALER INSTALLED OPTIONS

J1137

Manufacturer's Suggested Retail Price **\$82,923.00**

TOTAL AMOUNT DOES NOT INCLUDE STATE AND LOCAL TAXES OR LICENSE FEES. THE PRICE SHOWN ABOVE MAY OR MAY NOT BE REPRESENTATIVE OF THE ACTUAL SELLING PRICE OF SIMILAR RECREATIONAL VEHICLES IN YOUR AREA.

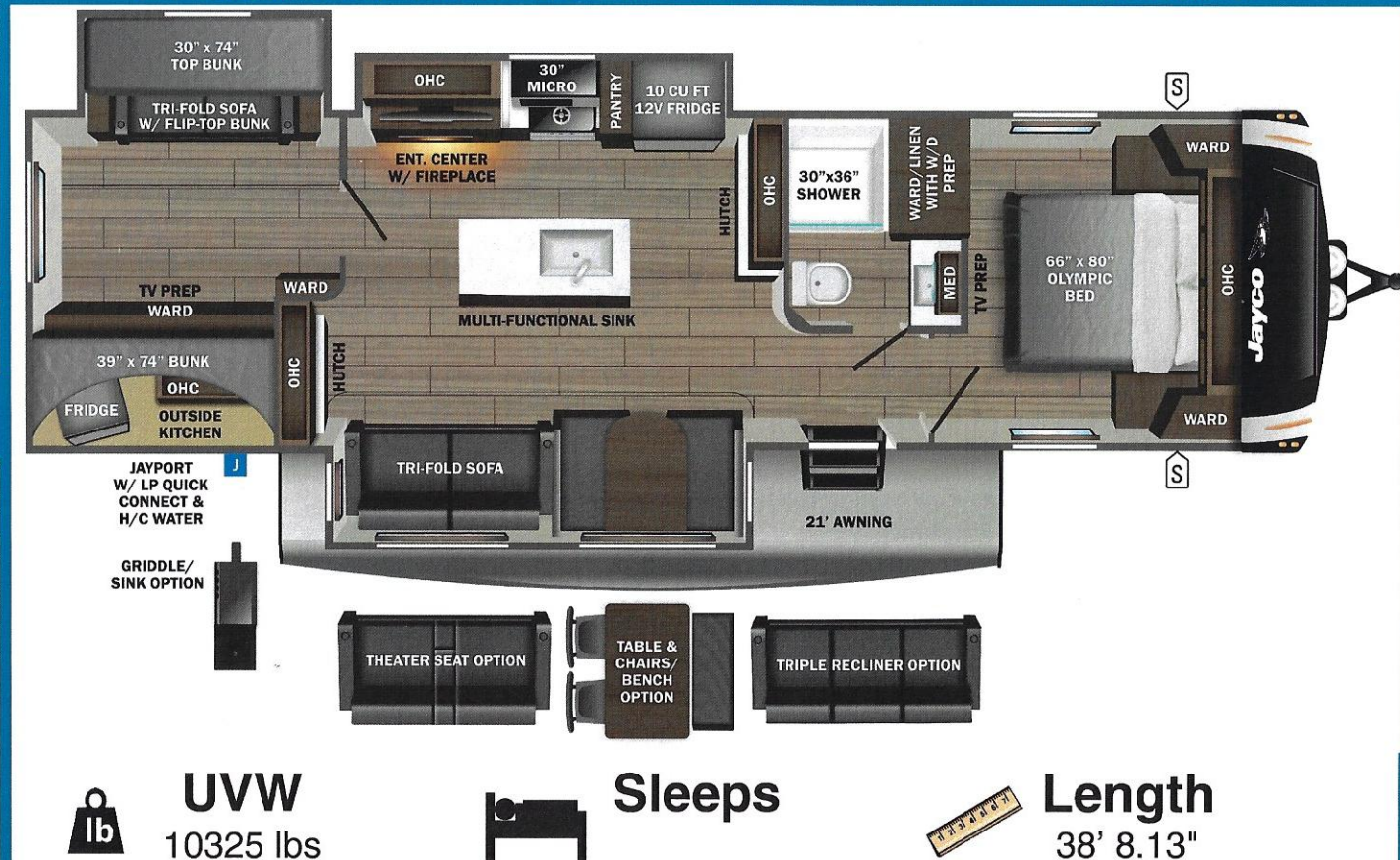

DIMENSIONS

Exterior height:.....142.25"

Exterior width:.....97.00"

WEIGHTS

GVWR:.....11995

GAWR (front):.....5800

GAWR (rear):.....5800

Approx. Gross Cargo Carrying Capacity(GCCC):.....1670

TIRES

Tire size (front):.....ST235/80R16H

Tire size (mid):.....

Tire size (rear):.....ST235/80R16H

Tire size (spare):.....ST235/80R16H

CAPACITIES

Fresh water tank (gals.):...52.00

Gray water tank (gals.):...74.00

Black water/toilet tank (gals.):.....37.00

Propane (lbs.):.....60

Propane (gals.):.....14

Water heater (gals.):.....0.25

SEATING & SLEEPING

Some dimensions may be rounded and may vary from the actual dimensions

***Weights may be estimated calculations and may vary from the actual weight

- refer to the vehicle weight labels for actual weights***

Floorplans, features and specifications are subject to change without notice.

2+3
YEAR | YEAR
LIMITED | STRUCTURAL
WARRANTY