



North Point



Serial #: 1UJCD0BV2T1LN0075
Model: 381CKRE NORTH POINT FW

Model Year: 2026 Dealer Name: BOURBON RV CENTER, INC
133 OLD SPRINGFIELD ROAD
BOURBON, MO 65441
USA

Standard Equipment

THE FOLLOWING ITEMS ARE STANDARD ON THIS MODEL

STANDARD EXTERIOR EQUIPMENT

- 102 in. wide body construction
- 12 in. structural steel I-beam with 8 or 10 in. monster beam steel drop frame
- 3,000 lb. tow hitch with 4-way pin (N/A 390CKDS)
- Battery disconnect
- Built in sewer hose carrier
- Climate Shield™ zero-degree tested weather protection:
- 40,000 BTU output furnace
- Double layer fiberglass batt insulation (roof and floor)
- Fully-enclosed and heated underbelly (ducted)
- 2 in. block foam and reflective foil
- Digital TV antenna
- Exterior marine-grade speakers with Bluetooth® controller
- Frameless, dark tinted, safety-glass windows
- Fully enclosed, universal docking center:
- Black tank flush
- Independent satellite wiring
- Quick-connect outside shower
- Selectable water connections
- Whole coach cable hookups
- Winterization and sanitation hookups
- Inverter pre-wire to select outlets
- JayPort system for outside griddle (all floorplans without a standard outside kitchen)
- JaySMART™ (Safety Markers And Reverse Travel) LED lighting (patented)
- Magnum Truss™ XL6™ Roof System with Alpha roof membrane system with limited lifetime warranty
- Painted fiberglass front cap with clear coat and built-in specialty LED lighting
- Pass-through storage with Slam-latch™ baggage doors
- Skirt metal enclosed drop frame
- Stronghold VBL™ aluminum framed and vacuum bond laminated gel coated fiberglass exterior walls (including rear wall and slide room end walls)
- Under-mounted spare tire
- Water heater bypass
- LUXURY PACKAGE (MANDATORY)
- 2nd electric patio awning (multi-color with remote control)
- 32 in. 4K Smart bedroom TV
- 6-point hydraulic auto-leveling system
- Central vacuum system with dust port
- Frameless dark tinted safety-glass windows
- Free-standing roll top (no pedestal) table with (2) free-standing and (2) folding chairs
- GE 21 cu. ft. residential refrigerator with 1800W inverter
- GE 30 in. space-saver convection microwave w/ built-in air fryer
- GE Profile Series residential 24 in. range (3.7 cu. ft. with 9100 BTU high output burner)
- High gloss gel coated sidewalls
- LED fireplace with electric space heater
- MORryde® StepAbove™ entrance steps with strut assist
- Oversized multi-battery compartment (room for 4-6 batteries)
- Privacy day/night roller shades in living room
- Residential, solid-surface kitchen and bathroom countertops
- Residential walk-in shower with teak seat
- Washer/dryer prep
- Residential NuVo H2O whole coach water treatment system with water softening and triple cartridge filters
- Residential "Do it all" sink
- JAYCOMMAND™ Smart RV System

STANDARD INTERIOR EQUIPMENT

- 5/8 in. tongue-and-groove joined plywood floor decking
- Built-in laundry hamper in wardrobe (select models)
- Carbon monoxide and LP detector
- Ceiling fan (select models)
- CPAP prepped bedroom
- Dual USB charging ports throughout
- Flip-up countertop extension/bar top (select models)
- Flip-up hidden storage in bedroom chest of drawers (select models)
- Flip-up tabletop storage next to tri-fold sofa (select models)
- Gas-strutted under-bed storage
- Handcrafted hardwood doors and drawers
- Integrated under-mount sink and lever faucet in main bathroom
- LED accent lighting above slideouts
- LED backlit custom framed mirror and medicine cabinet (select models)
- No in floor heat registers throughout coach
- Pantry with adjustable shelves (include 120V outlet)
- Pull out "Roll Top" dinette w/ freestanding chairs & (2) folding chairs
- Pull-out cutting board above trash can
- Pull-out utility drawers under kitchen sink
- Residential quilted bedspread and pillow shams
- "Shoe garage" in hallway step (select models)
- Soft close, heavy-duty, 75 lb. full-extension, steel ball-bearing drawer guides
- Solid hardwood slide fascia
- Stain protected fabric on all furniture
- Toe kick nightlights in bedroom and bathroom
- Tri-fold hide-a-bed sofa with residential sleep surface (select models)
- Up/down switch to raise/lower the TV by theater seats
- Vinyl flooring (made in the USA) throughout (includes slideout floors)
- CUSTOMER VALUE PACKAGE (MANDATORY)
- 15,000 BTU "Whisper Quiet" A/C (main)
- 15,000 BTU "Whisper Quiet" A/C (bedroom)
- On-demand tankless hot water heater
- 4K Smart LED HDTV with fully digital HDMI® output and two extra HDMI cables
- Backup, main entrance door and side observation security camera prep (includes a power switch in the bedroom to use the optional monitor for security)
- Custom, black, machined aluminum rims
- Electric patio awning (multi-color with remote control)
- Hidden hinges, magnet latches and soft close cabinet doors and drawers
- JBL® home entertainment system with sound bar and wireless subwoofer
- Keyed-Alike™ lock system (single key for all doors/locks)
- MORryde Safe-T-Rail grab handle
- Residential king (72 in. x 80 in.) mattress with under-bed storage
- Wireless remote control system (includes Bluetooth® wireless controls) with dimmer switches
- Residential dovetail-jointed drawers throughout
- (3) 40 lb. propane bottles with auto regulator (120 lb. max LP system)
- Free standing ottoman w/ hinged top
- Overlander 2 Solar Package: 30-amp controller, 1800W inverter and (2) 200W solar panels
- 5 STAR HANDLING PACKAGE (MANDATORY)
- 17.5 in. 16 ply "H" rated tires w/ SpartanLync TPMS
- Dexter® Axles with ABS and Tow Assist - includes Nev-R-Adjust® brakes and E-Z Lube® hubs
- MORryde® CRE-3000™ rubberized suspension
- MORryde® rubber pin box
- Wet bolt fasteners, bronze bushings and 4,000 lb. leaf springs

Optional Equipment

OPTIONAL EQUIPMENT INSTALLED ON THIS VEHICLE BY MANUFACTURER

Base price	128,168.00
GRAPHICS	n/c
USA STANDARDS	n/c
CUSTOMER VALUE PACKAGE	4,500.00
NORTH POINT LUXURY PACKAGE	10,200.00
FIVE STAR HANDLING PACKAGE	5,993.00
3RD AC 15,000 BTU IN LIVING ROOM	1,193.00
21 CU. FT. RESIDENTIAL REFRIGERATOR WITH INVERTER	n/c
NO DISHWASHER	n/c
NO GENERATOR PREP	n/c
TINTED SAFETY GLASS WINDOWS	n/c
NO AWNING	n/c
ROOF LADDER (STD)	n/c
STANDARD AXLE W/DRUM BRAKES	n/c
KING BED	n/c

BRV's
Discount Price
\$119,720

UNIT TOTAL 150,054.00

DEALER INSTALLED OPTIONS

J1128

Manufacturer's Suggested Retail Price \$150,054.00

TOTAL AMOUNT DOES NOT INCLUDE STATE AND LOCAL TAXES OR LICENSE FEES. THE PRICE SHOWN ABOVE MAY OR MAY NOT BE REPRESENTATIVE OF THE ACTUAL SELLING PRICE OF SIMILAR RECREATIONAL VEHICLES IN YOUR AREA.

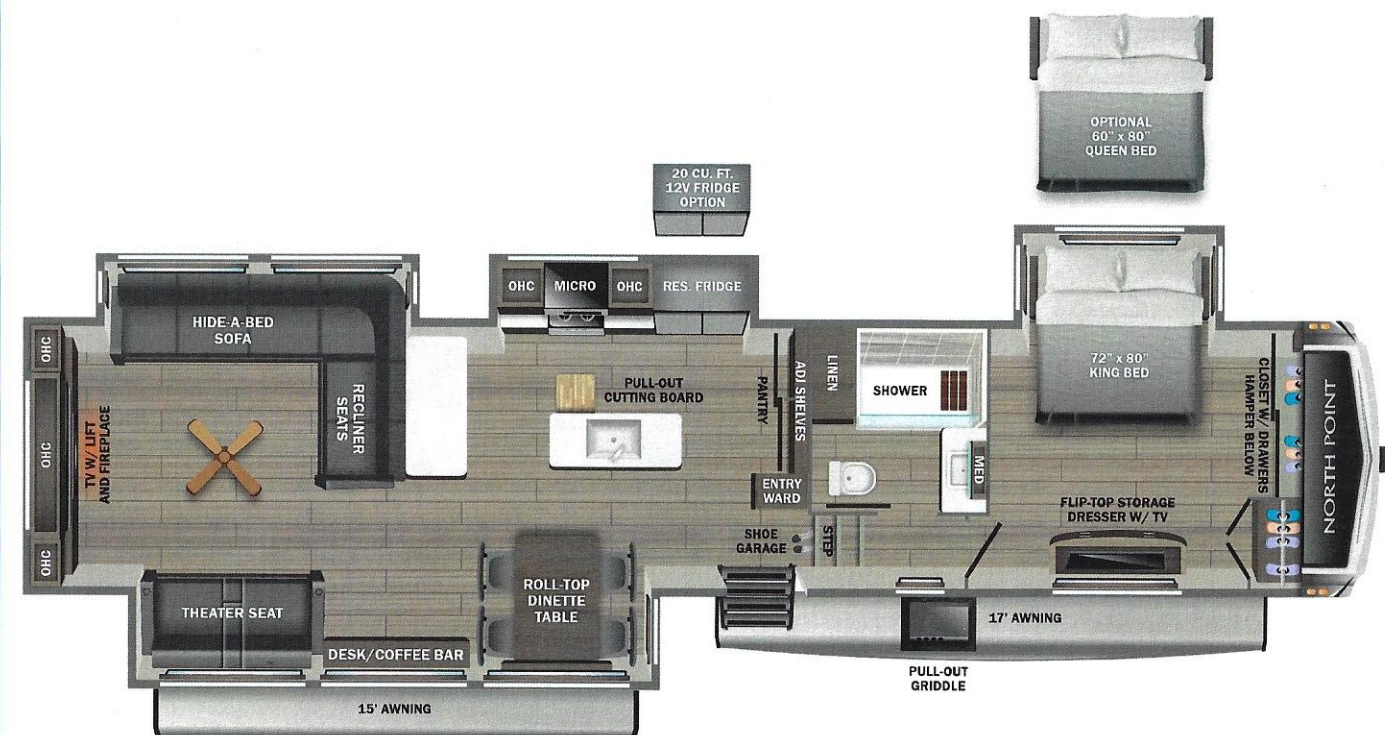

UVW
15620 lbs



Sleeps



Length
42' 6"

DIMENSIONS

Exterior height:.....159.13"

Exterior width:.....102.00"

WEIGHTS

GVWR:.....17995

GAWR (front):.....8000

GAWR (rear):.....8000

Approx. Gross Cargo Carrying

Capacity (GCCC):.....2375

TIRES

Tire size (front):.....

Tire size (mid):.....

Tire size (rear):.....

Tire size (spare):.....

CAPACITIES

Fresh water tank (gals.):...75.00

Gray water tank (gals.):...87.00

Black water/toilet tank

(gals.):.....50.00

Propane (lbs.):.....120

Propane (gals.):.....28

Water heater (gals.):.....0.25

SEATING & SLEEPING

Some dimensions may be rounded and may vary from the actual dimensions

***Weights may be estimated calculations and may vary from the actual weight

- refer to the vehicle weight labels for actual weights***

Floorplans, features and specifications are subject to change without notice.

2+3
YEAR | YEAR
LIMITED | STRUCTURAL
WARRANTY