



Eagle



Serial #: 1UJCA0BT0R1WD0072
Model: 321RSTS EAGLE FW

Model Year: 2024 Dealer Name: BOURBON RV CENTER, INC
133 OLD SPRINGFIELD ROAD
BOURBON, MO 65441
USA

Manufacturer's Suggested Retail Price \$107,422.00

TOTAL AMOUNT DOES NOT INCLUDE STATE AND LOCAL TAXES OR LICENSE FEES. THE PRICE SHOWN ABOVE MAY OR MAY NOT BE REPRESENTATIVE OF THE ACTUAL SELLING PRICE OF SIMILAR RECREATIONAL VEHICLES IN YOUR AREA.

Standard Equipment

Optional Equipment

THE FOLLOWING ITEMS ARE STANDARD ON THIS MODEL AT NO EXTRA CHARGE

OPTIONAL EQUIPMENT INSTALLED ON THIS VEHICLE BY MANUFACTURER

- EXTERIOR**
- Stronghold VBL™ walls (laminated sidewalls, rear walls and slide out walls)
 - 5 in. Magnum Truss™ Roof System with limited lifetime warranty
 - Climate Shield™ zero-degree tested weather protection:
 - Fully enclosed and heated underbelly (ducted)
 - 35,000 BTU output furnace
 - Double layer fiberglass batt insulation in ceiling and floor
 - Double sided radiant barrier insulation (roof, floor, and behind cap)
 - PEX plumbing
 - HELIX Cooling System™ (industry exclusive):
 - Jayco exclusive insulated dual duct design
 - Directional and closeable A/C vents
 - Larger return air vents with user accessible filters
 - JaySMART™ (Safety Markers And Reverse Travel) LED lighting (patented)
 - Automotive style front cap with max turn radius (painted on select models)
 - Auto-grade vinyl graphics
 - LED exterior lighting package
 - 50-amp detachable power cord
 - Dual 30 lb. LP bottles
 - Metal slam latch baggage doors
 - Digital TV antenna with Wi-Fi prep
 - Dual channel exterior speaker
 - Nautilus 2.5 water connections
 - Black tank flush
 - Independent satellite and whole coach cable hookups
 - Battery disconnect in pass through area
 - Nitrogen filled undermount spare tire (16 in.)
 - LP quick connect for gas griddle (next to JayPort)
 - Slide topper/awning prep
 - 1.5 in. fresh water drain valve
 - 96 in. LED lighting in pass through area with 3-way switches
 - Commercial grade rubber flooring in pass through area
 - Factory installed roof ladder
 - Galvalume steel coated outside kitchens
 - Overlander 1 Solar Package: (1) 200W panels, MPPT 30-amp solar controller
 - Quick connect water connections (door side hot/cold and off door side cold only)
- COMFORT PLUS PACKAGE (Mandatory) (W-models only)**
- Second power awning with dimmable LED lights
 - 2nd 15,000 BTU "Whisper Quiet" A/C
 - Drinking Water System (patented)
 - Upsized 16 cu.ft. 12V refrigerator
 - Solid surface kitchen countertop with bamboo sink covers and strainer
 - BMPRO Bluetooth® light switches throughout
 - King bed (72 in. x 80 in.) mattress with under-bed storage
 - 16 in. Endurance® Goodyear® wheels/tires
 - Larger exterior baggage door sizes
 - Upsized 50 in. 4K SMART LED TV in living room
 - Upsized 34 in. LED fireplace with 5,000 BTU electric space heater
 - Upsized GE 24 in. residential stove with 4-burner cooktop

- INTERIOR**
- Solid hardwood slide fascia
 - Handcrafted and glazed door/drawer fronts (new sizes)
 - 75 lb. full extension drawer guides
 - 5/8 in. tongue-and-groove plywood flooring
 - Residential vinyl flooring throughout
 - LED lights with dimmer switches and motion activated (throughout interior)
 - Tri-fold hide-a-bed sofa with residential memory foam sleep surface (select models)
 - Theater seating (select models)
 - Stainless steel kitchen sink
 - Matte black kitchen faucet with pull-out sprayer
 - USB charging ports (multiple locations throughout)
 - Extra 120V power outlets in kitchen and slide rooms (where applicable)
 - 90 in. x 92 in. residential quilted bedspread (both queen and king mattresses)
 - Gas-strutted under-bed storage
 - Inverter pre-wire (multiple locations)
 - C.P.A.P. prepped bedroom
 - Bathroom skylight
 - LED backlit medicine cabinet with custom framed mirror
 - Porcelain foot flush toilet
 - 2-piece high gloss bathroom surround
 - Bedroom TV prep
 - Furniture cup holder tables (1 pair)
- CUSTOMER VALUE PACKAGE (Mandatory)**
- MORryde® StepAbove™ entrance steps (main entrance) with blue LED light
 - 15K BTU "Whisper Quiet" A/C and bedroom A/C prep
 - 50-amp service with dual A/C ducts
 - Electric patio awning with integrated dimmable LED lights
 - 60K on-demand water heater with mixing tank
 - Custom machined aluminum rims
 - Rear 2 in. towing receiver with 4 pin connector
 - Keyed-Alike™ lock system (single key for all doors/locks)
 - Security monitor prep (rear, sides and entrance door)
 - Hidden hinges on cabinet doors
 - Upgraded friction hinge entrance door
 - 4K 50 in. ultra LED HD Smart TV in living room
 - JBL Aura Bar 12V with Bluetooth® and dual HDMI (dual zone)
 - GE black and stainless 24 in. range with edge to edge grates
 - GE 30 in. over-the-range black and stainless microwave with exhaust fan
 - Rain-proof bathroom power vent
- LUXURY PACKAGE (Mandatory)**
- JAYCOMMAND® "Smart RV" system (Pro tablet)
 - LED fireplace with 5,000 BTU electric space heater (select models)
 - GE 16 cu. ft. 12V refrigerator
 - Blackout roller shades with reflective side throughout
 - Washer/dryer prep (select models)
 - TPMS (Tire Pressure Monitoring System) in-stem monitoring
 - Electric auto-leveling
 - JayPort 2 in. mount (for outside accessories)
 - MORryde Safe-T-Rail grab handle
 - Overlander 1 Solar Package (200W panel and 30-amp solar controller)
 - Residential style glass shower door
- 5 STAR HANDLING PACKAGE (Mandatory)**
- Goodyear® Endurance® tires (load range E)
 - Dexter® Axles with Nev-R-Adjust® brakes and E-Z Lube® hubs
 - MORryde® CRE-3000™ rubberized suspension
 - Wet bolt fasteners, bronze bushings
 - Dexter® ABS brake system with anti-sway

Base price	79,685.00
USA STANDARDS	n/c
CUSTOMER VALUE PACKAGE	6,263.00
LUXURY PACKAGE	7,493.00
FIVE STAR HANDLING PACKAGE	5,993.00
COMFORT PLUS PACKAGE	6,750.00
OVERLANDER II SOLAR PACKAGE	1,238.00
STANDARD CAMPING PACKAGE	n/c
OBSERVATION SYSTEM PREP	n/c
TINTED SAFETY GLASS	n/c
WINDOWS	n/c
FREE STANDING TABLE & CHAIRS	n/c
KING BED	n/c

BRV's
Discount Price
\$86,995

UNIT TOTAL **107,422.00**

DEALER INSTALLED OPTIONS

J1106

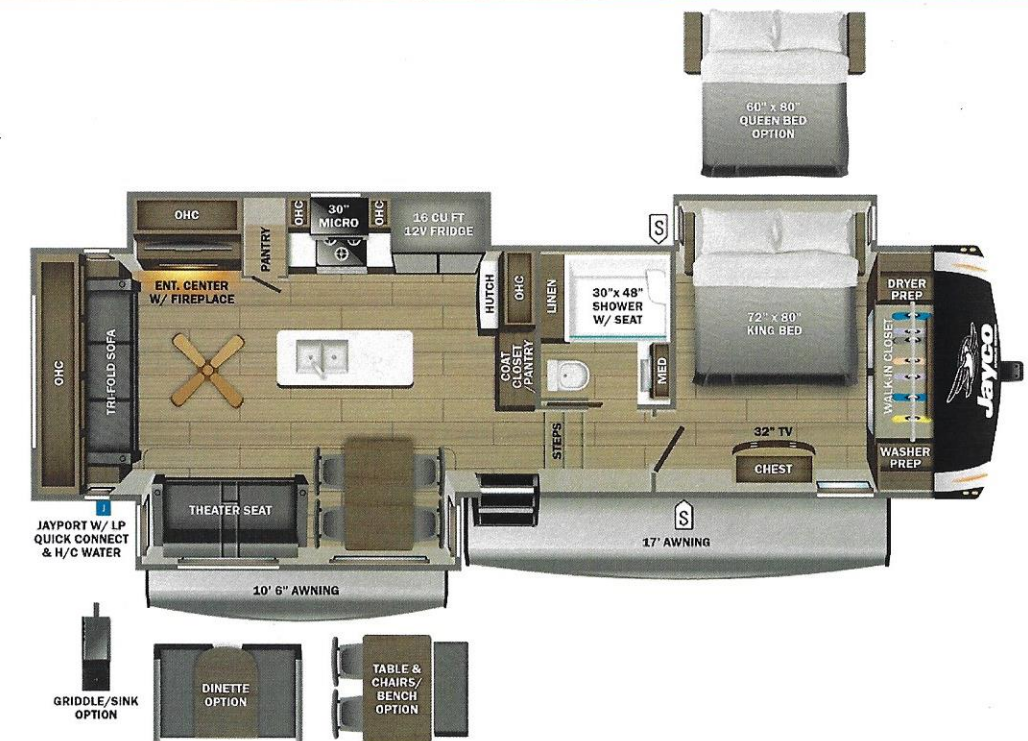

UVW 11038 lbs **Sleeps** **Length** 36' 8"

DIMENSIONS

Exterior height:.....160.50"

Exterior width:.....96.75"

WEIGHTS

GVWR:.....12900

GAWR (front):.....6000

GAWR (rear):.....6000

Approx. Gross Cargo Carrying Capacity (GCC):.....1862

TIRES

Tire size (front):.....ST235/85R16E

Tire size (mid):.....

Tire size (rear):.....ST235/85R16E

Tire size (spare):.....ST235/85R16E

CAPACITIES

Fresh water tank (gals.):...81.00

Gray water tank (gals.):...87.00

Black water/toilet tank (gals.):...50.00

Propane (lbs.):...60

Propane (gals.):...14

Water heater (gals.):...0.19

SEATING & SLEEPING

Some dimensions may be rounded and may vary from the actual dimensions

***Weights may be estimated calculations and may vary from the actual weight

- refer to the vehicle weight labels for actual weights***

Floorplans, features and specifications are subject to change without notice.

