



Jay Flight



Serial #: 1UJBC0BS9P17M0147
 Model: 294QBS JAY FLIGHT TT

Model Year: 2023 Dealer Name: BOURBON RV CENTER, INC
 133 OLD SPRINGFIELD ROAD
 BOURBON, MO 65441
 USA

Manufacturer's Suggested Retail Price \$45,913.00

TOTAL AMOUNT DOES NOT INCLUDE STATE AND LOCAL TAXES OR LICENSE FEES. THE PRICE SHOWN ABOVE MAY OR MAY NOT BE REPRESENTATIVE OF THE ACTUAL SELLING PRICE OF SIMILAR RECREATIONAL VEHICLES IN YOUR AREA.

Standard Equipment

THE FOLLOWING ITEMS ARE STANDARD ON THIS MODEL AT NO EXTRA CHARGE

- EXTERIOR**
- 20 lb. LP Bottles with Cover (2)
 - Enclosed underbelly
 - Axles with electric, self-adjusting brakes and easy-lube hubs
 - I-Class™ cambered structural steel I-beams
 - Fully integrated A-frame
 - 5/8 in. tongue-and-groove plywood floor decking
 - Magnum Truss™ Roof system with plywood decking
 - Seamless one piece roof material
 - Large exterior downspouts
 - Galvanized steel, impact-resistant wheel wells
 - 30-amp service
 - Front diamond plate
 - (4) Stabilizer jacks
 - Exterior TV mount and bracket
 - LED exterior lighting
 - Friction hinge entry door with shade-prep window
 - G20 dark tinted safety-glass privacy windows
 - LP quick connect (outside gas grill prep)
 - Detachable power cord
 - Backup & side marker camera prep

- INTERIOR**
- 81 in. ceiling height
 - 7 cu. ft. gas/electric refrigerator
 - Shower/tub surround
 - Solid hardwood cabinet doors
 - LED interior lighting
 - J-Steel™ jackknife sofa with armrest & cup holders (most models)
 - Vinyl flooring throughout (including slide floors)
 - Window shades
 - Smoked-glass cabinet door inserts (select models)
 - Residential-style kitchen countertops
 - 3-burner range with glass cover
 - Oven with glass door and interior light
 - Heavy-duty, 75 lb., full-extension, steel ball-bearing drawer guides
 - Range hood
 - USB charging station
 - Queen mattress
 - Plywood bed platforms
 - Main bed struts
 - 300 lb. rated bunk beds (select models)
 - 600 lb. rated bunk beds (double bunks)
 - Privacy curtains in bunk areas (select models)
 - Vented bunk windows (select models)
 - 4 in. thick bunk mats (select models)
 - Wooden bedroom doors (select models)
 - Shower curtain with curved shower track (select models)

- CUSTOMER VALUE PACKAGE (mandatory)**
- Black tank flush
 - Roof mounted solar prep
 - Large main entry door grab handle
 - Solid Step® entry steps (N/A 38BHDS)
 - 6 gal. gas/electric DSI water heater (10 gal. in 38BHDS)
 - Cable/satellite TV hookup
 - Digital TV antenna
 - Goodyear® Endurance® tires (made in the USA)
 - Outside shower
 - Power tongue jack
 - Spare tire with cover
 - Water heater bypass
 - Power awning with LED lights
 - Marine grade exterior speakers
 - Keyed-Alike™ entry and baggage doors
 - Bathroom power vent
 - Bathroom skylight
 - Tub surround

Optional Equipment

OPTIONAL EQUIPMENT INSTALLED ON THIS VEHICLE BY MANUFACTURER

Base price	40,608.00
Classic Cottage	n/c
USA Standards	n/c
Customer Value Package	3,300.00
15,000 BTU AC	188.00
No 2nd AC	n/c
50 AMP Service	443.00
8 Cu. Ft. 12V Refrigerator	293.00
32" LED Smart TV	488.00
Silver Spoke Rims	n/c
20# LP Gas Bottles	n/c
Hide-A-Bed Sofa	593.00

**BRV's
 Discount Price
 \$39,995**

UNIT TOTAL **45,913.00**

DEALER INSTALLED OPTIONS

J1082

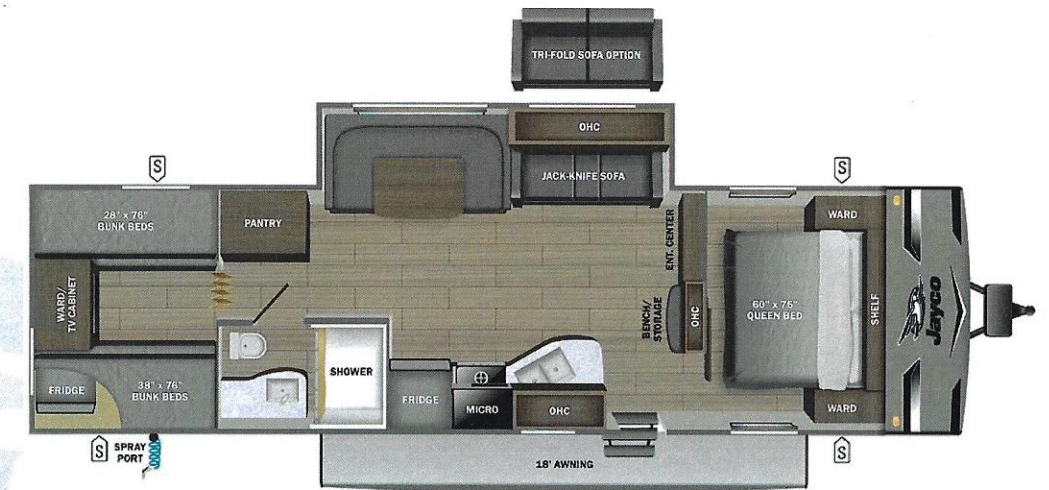

UVW
 6821 lbs

Sleeps

Length
 35' 6.75"

DIMENSIONS

Exterior height:.....134.50"

Exterior width:.....96.00"

WEIGHTS

GVWR:.....8250

GAWR (front):.....4400

GAWR (rear):.....4400

Approx. Gross Cargo Carrying Capacity (GCCC):.....1429

TIRES

Tire size (front):.....ST225/75R15E

Tire size (mid):.....

Tire size (rear):.....ST225/75R15E

Tire size (spare):.....ST225/75R15E

CAPACITIES

Fresh water tank (gals.):...38.00

Gray water tank (gals.):...47.50

Black water/toilet tank (gals.):...39.00

Propane (lbs.):...40

Propane (gals.):...9

Water heater (gals.):...6.00

SEATING & SLEEPING

Some dimensions may be rounded and may vary from the actual dimensions

***Weights may be estimated calculations and may vary from the actual weight

- refer to the vehicle weight labels for actual weights***

Floorplans, features and specifications are subject to change without notice.

