

Esteeem

Serial #: 1J5LECBRT71BV8190
 Model: 29V ESTEEM MHC
 VIN#: 1FDXE4FNXTDD25905
 Model Year: 2026 Dealer Name: BOB HURLEY RV OKC, LLC
 8606 N. I-35 SERVICE RD.
 OKLAHOMA CITY, OK 73131
 USA



Manufacturer's Suggested Retail Price

\$216,386.00

TOTAL AMOUNT DOES NOT INCLUDE STATE AND LOCAL TAXES OR LICENSE FEES. THE PRICE SHOWN ABOVE MAY OR MAY NOT BE REPRESENTATIVE OF THE ACTUAL SELLING PRICE OF SIMILAR RECREATIONAL VEHICLES IN YOUR AREA.

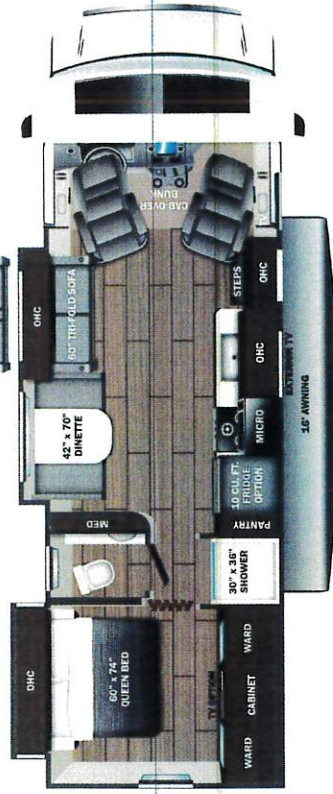

Standard Equipment

THE FOLLOWING ITEMS ARE STANDARD ON THIS MODEL

- STANDARD EXTERIOR EQUIPMENT
 - Ford® E-450 chassis
 - 7.3L V8 352-HP engine with 450 ft. lb. torque
 - 6-speed TorqShift® selective transmission with
 - 210-amp alternator
 - Catalytic converter theft deterrent
 - Engine highway (E-H) 122km/h (76MPH)
 - Power anti-lock brakes with power steering
 - 7,500 lb. hitch with 750 lb. tongue capacity and
 - 12V chassis battery
 - 55 gal. fuel tank
 - TuffShelf™ vacuum-bond laminated roof, floor and
 - Braided-bamboo insulation (R-24 max roof, R-9 max
 - One-piece, seamless, fiberglass roof
 - Fiberglass side walls
 - Fiberglass exterior walls with partial paint and vinyl
 - graphics
 - Entrance door with industry's largest travel-view
 - window
 - Electric powered entrance step with integrated
 - no-step entry
 - Slickout® awning(s)
 - LED interior lighting
 - Roof ladder
 - Prep for satellite dish
 - Cable TV hookup with RG 6 coax
 - 4,000W generator with auto-gain shunt
 - 200W solar panel with dual controller and second
 - house battery
 - 12V battery
 - Transfer switch with reverse polarity protection
 - 30-amp electrical service
 - LP gas tank (86 lb.)
 - LP gas cook-connect hookup
 - Heated holding tanks (12V pads)
 - Exterior utility center
 - 12V battery system
 - Black tank flush
 - Outside shower
 - 12V demand water pump
 - Water filtration system
- STANDARD INTERIOR EQUIPMENT
 - Swivel driver and passenger seats
 - Driver and passenger airbags
 - Power windows and door locks
 - Cruise control
 - Electronic stability control
 - Traction control
 - Automatic emergency braking (AEB)
 - Automatic emergency lighting
 - Auxiliary start switch
 - Custom-modded ABS surround in cab-over area
 - Power windows with capacity and safety net
 - touchscreens and mobile app
 - High-intensity rearview LED ceiling lights
 - LED-ill. fashio.
 - Bi-beaming drawer fronts
 - Bi-beaming cabinet doors and drawer fronts
 - 15,000 BTU A/C with heat pump
 - S-Lab™ tankless water heater
 - S-Lab™ tankless water heater
 - On-board lithium (select floorplans)
 - LED HD Smart TV in living area
 - JBL® audio system
 - All-in-one cooktop and oven
 - Residential-size microwave
 - Recessed stainless steel kitchen sink with solid-surface
 - Flip-up countertop extension (select models)
 - Decorative kitchen backsplash
 - USB port charging station in kitchen with 120V outlets and
 - nightstands (king size in 27U)
 - Under-cab storage (select models)
 - Large waterboxes
 - Bunks with industry-exclusive 300 lb. capacity seats (61F
 - power with decorative surround, glass door, daylight and
 - light
 - Aqua View® SHOWERMISER™ water management system
 - Porcelain toilet with bidet
 - Porcelain toilet with bidet
 - Powered roof vent in bathroom with wall switch
 - Smoke alarm
 - Fire extinguisher

Optional Equipment

OPTIONAL EQUIPMENT INSTALLED ON THIS VEHICLE BY MANUFACTURER

- Base price 190,043.00
- OAKRIDGE DECOR n/c
- OXFORD FULL BODY PAINT 11,993.00
- USA STANDARDS n/c
- 26 FORD E45 145000 158" n/c
- CUSTOMER VALUE PACKAGE 9,000.00
- BEDROOM TV 383.00
- DUAL 13.5K ACS W/O HEAT 1,193.00
- 10 CU. FT. 12V REFRIGERATOR n/c
- NON-BLACKOUT ALUMINUM RIMS n/c
- STANDARD HOUSE BATTERY 2,393.00
- FOLDING WINDSHIELD SUN SHADE 488.00
- THEATER SEATING SOFA 893.00

DIMENSIONS

Exterior height:.....140.00* Fresh water tank (gals.):.....47.00
 Exterior width:.....100.00* Gray water tank (gals.):.....41.00

CAPACITIES

Black water/coilet tank (gals.):.....32.00
 Propane (lbs.):.....56
 Propane (gals.):.....13
 Water heater (gals.):.....0.00

TIRES

Tire size (front):.....LT225/75R16E
 Tire size (mid):.....
 Tire size (rear):.....LT225/75R16E

UNIT TOTAL 216,386.00

DEALER INSTALLED OPTIONS

Some dimensions may be rounded and may vary from the actual dimensions
 Weights may be estimated calculations and may vary from the actual weight
 - refer to the vehicle weight labels for actual weights***
 Floorplans, features and specifications are subject to change without notice.

