



# 2021 Wildcat Product Information



EACH WILDCAT MAXX STARTS WITH AN 8", 10" OR 12" FORMED 'I' BEAM TREATED CHASSIS THAT IS PRE-CAMBERED.



WILDCAT USES HEAVY DUTY 4,400LB & 5,200LB AXLES ON ALL MODELS. THIS GIVES EACH UNIT BETWEEN 2,223 LBS.. AND 4,946 LBS.. OF CARGO CAPACITY. IT ALSO MEANS YOU GET 12" X 2" BRAKES FOR 7,000 LBS. OF STOPPING FORCE PER AXLE. SELF-ADJUSTING BRAKES ARE A NICE BONUS THAT AUTOMATICALLY ADJUST THEMSELVES WITH EVERY FORWARD ROLLING STOP!



WILDCAT OVERSIZED TANKS ARE PLACED IN-BETWEEN THE FRAME RAILS AND CROSS MEMBERS FOR SUPREME STABILITY AND STRENGTH.

EACH OF THE 4 HOLDING TANKS COMES STANDARD WITH R-7 FIBERGLASS INSULATION & R-38 REFLECTIVE ASTRO-FOIL INSULATION UNDERNEATH. EACH TANK ALSO COMES STANDARD WITH A 12 VOLT TANK HEATER TO KEEP YOUR FLUIDS FROM FREEZING EVEN IN THE HARSHTEST OF WEATHER CONDITIONS

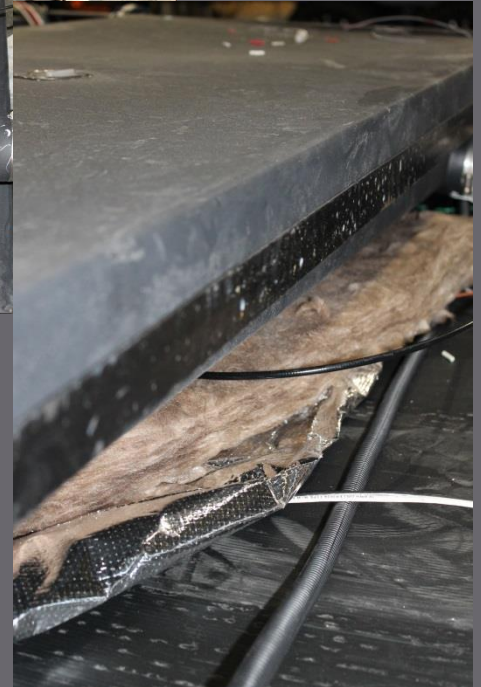
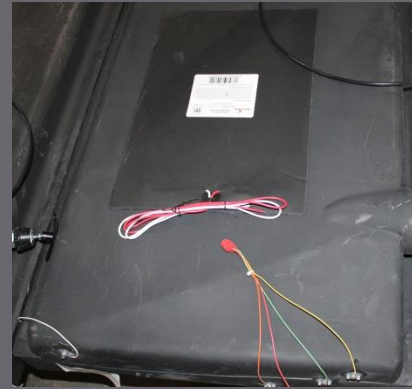



WILDCAT HAS THE STRONGEST FLOORS IN THE RV INDUSTRY. MOST MANUFACTURERS TODAY LAMINATE THEIR FLOORS WITH ALUMINUM FRAMING, BLOCK FOAM INSULATION, AND 2 LAYERS OF STAGGERED 1/8" LUAN PANELS. OVER TIME, THE PANELS (WHICH WERE NOT MEANT TO BE FLOORING) BREAK DOWN AND CAUSE THE FLOOR TO DELAMINATE. WILDCAT TAKES THIS CONSTRUCTION ONE STEP FURTHER AND LAMINATES OUR FLOOR WITH AN ADDITIONAL LAYER OF 1/2" DYNASPAN® DECKING WITH A 25 YEAR WARRANTY. YOU WILL NOT FIND A STRONGER FLOOR – PERIOD!\*



\*Travel Trailers Only



ONCE YOUR FLOOR IS LAMINATED TO DYNASPAN, YOUR WILDCAT TRAVEL TRAILER FLOOR IS THEN COVERED IN A COMPLETE SINGLE LAYER OF DARCO UNDER-BELLY MATERIAL. THIS LAYER WORKS JUST LIKE GORTEX® TO KEEP MOISTURE FROM ENTERING YOUR UNIT, BUT ALLOWS THE NATURAL MOISTURE THAT BUILDS UP TO ESCAPE WITH ONE-WAY LEAK PROTECTION.

YOUR WILDCAT TRAVEL TRAILER IS COVERED WITH A SINGLE SHEET OF DYNASPAN® FLOOR DECKING, ON TOP OF THE LAYER OF STAGGERED LUAN PANELING. WITH NO SEAMS, THERE IS NO CHANCE FOR WATER TO PENETRATE YOUR FLOOR AND CAUSE SWELLING LIKE OTHER FLOOR DECKING USED BY OUR COMPETITION.

OUR DYNASPAN® FLOOR DECKING COMES WITH A 25 YEAR WARRANTY AGAINST STRUCTURAL PANEL FAILURE CAUSED BY MANUFACTURING DEFECTS, GLUE BOND FAILURE AND DELAMINATION. TRY FINDING THAT FROM OUR COMPETITION!



**Maxx Strong  
Laminated Floors**



EVERY WILDCAT FLOOR IS 100% COVERED BY RESIDENTIAL FLOORING WITH A 3 YEAR WARRANTY. YES, EVEN UNDER THE CARPET!

THE LINOLEUM IS APPLIED WITH A RESIDENTIAL GLUE THAT COVERS 100% OF THE DYNA-SPAN® FLOORING TO MAKE SURE THAT YOUR FLOORING DOESN'T RIP, TEAR, SCRATCH, PERMANENTLY INDENT OR CRACK IN THE COLD CLIMATES.

BECAUSE WILDCAT GLUES 100% OF THEIR FLOORING DOWN, WE DON'T GET BUBBLES IN OUR LINOLEUM LIKE OUR COMPETITION THAT USES "FLOATING FLOORING" LIKE BEAUFLO® THAT IS NOT GLUED.





WILDCAT VACUUM BONDS BOTH SIDE WALLS, ALL 3 WALLS OF THE SLIDE-OUT AND THE CEILING OF THE SLIDE FOR MAXIMUM STRENGTH AND INSULATION.

WILDCAT SIDEWALLS ARE FRAMED COMPLETELY IN ALUMINUM. EVERY OPENING WE HAVE LIKE WINDOWS, ENTRY DOOR, BAGGAGE DOORS ARE FRAMED ON ALL 4 SIDES. EVEN SOMETHING AS SMALL AS AN OUTSIDE PLUG OR VENT IS FRAMED AND WELDED ON ALL 4 SIDES.





WILDCAT PUTS WOOD INSIDE SOME OF THE ALUMINUM STUDS TO MAKE SURE THE SCREWS HAVE SOMETHING SOLID FOR A SECURE ATTACHMENT FOR ITEMS LIKE CABINETS AND THE FIBERGLASS FRONT CAP.

R-10 HIGH DENSITY BLOCK FOAM INSULATION IS CAREFULLY CUT AND PLACED IN EVERY OPENING BETWEEN ALL THE WELDED ALUMINUM STUDS FOR MAXIMUM INSULATION VALUES!



BOTH WILDCAT TRAVEL TRAILERS AND 5<sup>TH</sup> WHEELS COME STANDARD WITH A HIGH GLOSS, GEL-COATED, FIBERGLASS FRONT MOLDED CAP WITH BED LINER TO REDUCE ROCK CHIPS. THE CAP HELPS WITH AERODYNAMICS AND LOOKS BEAUTIFUL!



LOOK AT ALL THE RE-REINFORCEMENT THAT GOES IN BEHIND THE GEL-COATED FIBERGLASS FRONT CAP TO HELP WITH STRENGTH WHILE TOWING DOWN THE HIGHWAY.





BEHIND EACH FRONT CAP AND IN THE END WALL AND CEILING, WILDCAT USES A DOUBLE LAYER OF R-7 FIBERGLASS INSULATION PLUS A LAYER OF THE R-38 REFLECTIVE ASTRO-FOIL INSULATION. WILDCAT USES MORE INSULATION IN OUR PRODUCTS THAN ANY OF OUR COMPETITION.





EACH WILDCAT ROOF IS PROTECTED BY A COTTON & FIBERGLASS SHEATHING SO THE EDGES DON'T CUT THROUGH THE RUBBER ROOFING. WE THEN ROLL ON GLUE OVER 100% OF THE ROOF DECKING BEFORE APPLYING THE 1-PIECE PVC ROOF WITH A 15 YEAR WARRANTY.

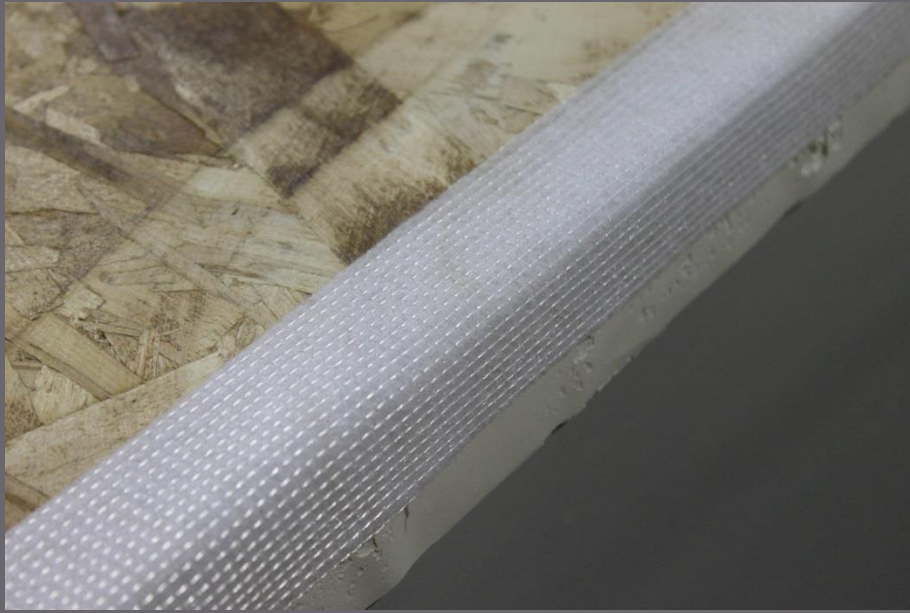

**XTRM<sup>TM</sup>**  
PLY

MADE WITH **DUPONT<sup>TM</sup> ELVALOY<sup>®</sup>**

**EASY MAINTENANCE FREE ROOF**

- Will not chalk, streak or spot
- Easy to install and pull over tough transitions with **no wrinkles.**
- Made of PVC - premium quality roofing material used for over 40 years.
- No treatments required - Ever!

NEW



**15 YEAR WARRANTY**

LASALLE BRISTOL AND RMA OFFER A 15 YEAR WARRANTY COVERED 100%.

WILDCAT GOES THE EXTRA MILE ON A LOT OF THINGS, AND OUR CABINETS ARE NO EXCEPTION. WE STAPLE AND SCREW OUR CABINETS TOGETHER TO MAKE SURE THEY LAST THROUGH MANY YEARS OF CAMPING. WE ALSO USE RESIDENTIAL STEEL BALL BEARING DRAWER GUIDES ON ALL OF OUR DRAWERS. NOTICE THAT EVEN OUR WRAPPED STYLES ARE REAL HARDWOOD UNDERNEATH!





WILDCAT USES NOTHING BUT THE FINEST RESIDENTIAL QUALITY MATERIALS WHEN CONSTRUCTING YOUR TRAILER. SAMSUNG STARION® COUNTERS WITH A 10 YEAR WARRANTY ARE A NICE STANDARD FEATURE. HIGH RISE FAUCETS WITH DETACHABLE HEAD, STAINLESS APPLIANCES AND A RANGE COVER FOR EXTRA COUNTER SPACE. THESE ARE JUST SOME OF THE INNOVATIVE THINKING FROM WILDCAT.





CREATE THE PERFECT AMBIANCE  
WHEREVER YOU ARE WITH OUR  
NEW FURRIION 30" FIREPLACE.  
CLIMATE CONTROLLED WITH 4  
LEVELS, HEATS UP TO 500 SQ. FT.



STANDARD 22" OVEN/RANGE, MICROWAVE AND A LARGE 10.7' CUBIC REFER (8' CUBIC GAS/ELECTRIC REFER OPTIONAL), COMBINE TO GIVE OUR KITCHEN A NICE MODERN LOOK!

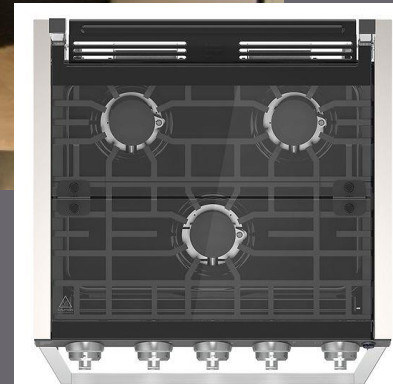

ALL WILDCAT MODELS COME STANDARD WITH LED LIGHTS BOTH INTERIOR AND EXTERIOR. LED LIGHTS USE 85% LESS POWER THAN A STANDARD INCANDESCENT BULB AND GIVE OFF ALMOST NO HEAT.





ALL WILDCAT MODELS COME PRE WIRED FOR A  
BACK-UP CAMERA AND SOLAR POWER.



# EVERY WILDCAT COMES WITH THE FOLLOWING:

1. RG6 COAX CABLE/SATELLITE READY
2. BLACK TANK FLUSH





COAT HOOKS  
ON ALL MODELS

NEW SOUND BAR SPEAKERS WITH THE FURRION  
DVD/HDMI/BLUETOOTH/AM/FM/CD/USB STEREO.  
THE SYSTEM IS ALSO CLIMATESMART™ - TESTED FOR  
EXTREME CLIMATES.



UPGRADED 1" THICK INSULATED  
SLAM LATCH BAGGAGE DOORS



LED AWNING LIGHTS THAT  
WORK WITH AWNING IN OR OUT.





LIPPERT ONE CONTROL, FROM INSIDE YOUR WILDCAT MAXX OR FROM THE APP ON YOUR SMART PHONE OR TABLET, CONTROLS LIGHTS, SLIDES, SELF-LEVELING LANDING GEAR, AWNING, MONITOR PANELS AND MORE! (5<sup>TH</sup> WHEELS ONLY)



BATTERY DISCONNECT TO HELP SAVE ON BATTERY POWER WHEN YOUR WILDCAT MAXX IS NOT IN USE.



AM/FM/CD/DVD/BLUETOOTH/  
HDMI STEREO WITH REMOTE &  
SMARTPHONE APP



KING TV ANTENNA. OFFERING A BETTER SIGNAL AND A NEW HIGH-TECH, YET SIMPLE DESIGN, THE KING JACK PROVIDES BETTER PERFORMANCE THAN EXPECTED FROM SUCH A COMPACT OVER-THE-AIR TV ANTENNA.



# LIPPERT SOLID STEP ENTRY.

The Solid Step's innovative design permits the step to operate through a wide range of ride heights with adjustable leg extensions. The design also ensures that the steps stay parallel to the ground, reducing the potential for slipping or falling during use.

The Solid Step design permits the step to stow inside of the entry door, keeping road debris and corrosion.





WITH THE PUSH OF A BUTTON, GROUND CONTROL® 3.0 LEVELS AND STABILIZES YOUR RV QUICKLY AND ACCURATELY, ENHANCING YOUR OVERALL CAMPING EXPERIENCE. IT CAN TAKE UP TO AN HOUR TO GET AN RV LEVEL WITH MANUAL JACKS, CHOCKS AND WEDGES. GROUND CONTROL SAVES YOU TIME BY LEVELING AND STABILIZING THE RV IN A MATTER OF MINUTES, AND PREVENTS ANNOYING ROCKING AND SWAYING AT THE CAMPSITE. (5<sup>TH</sup> WHEELS ONLY)

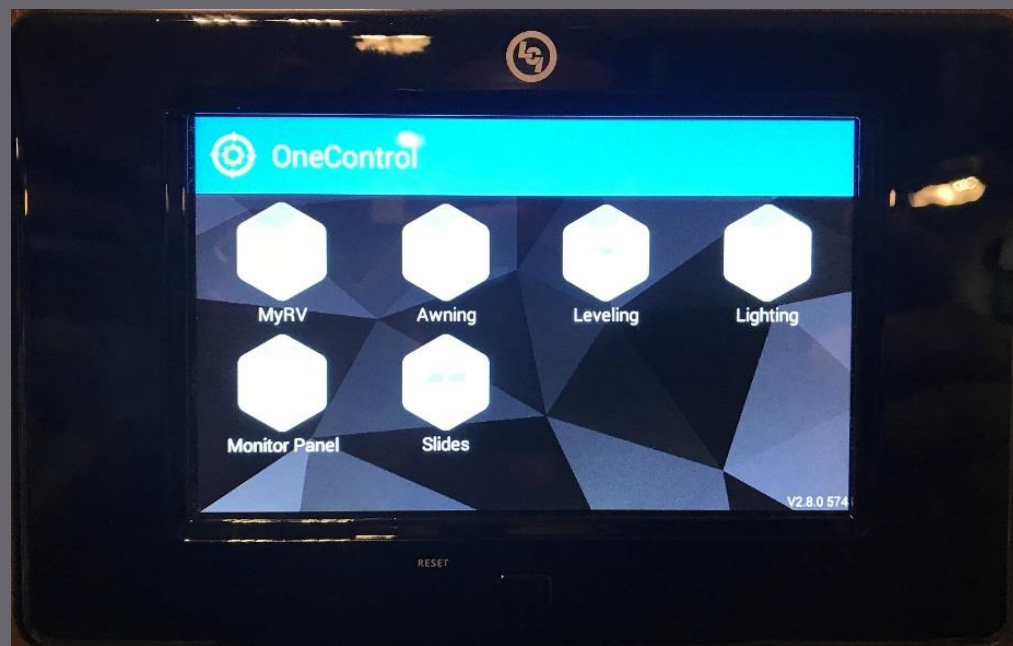

LIKE A ROCK-SOLID RACE CAR CHASSIS, JT'S STRONG ARM JACK STABILIZERS USE TRIANGLES – THE STRONGEST SHAPE IN NATURE – TO ELIMINATE UNWANTED CHASSIS MOVEMENT. ONE END OF EACH STABILIZER TUBE ATTACHES TO EACH LANDING GEAR LEG AND THE OTHER TO THE RV FRAME, FORMING A RIGID TRIANGLE. (TT'S ONLY)



WILDCAT CONTINUES ITS TRADITION OF TAKING CAMPING TO "THE MAXX" BY OFFERING THE LARGEST PASS-THROUGH STORAGE COMPARTMENTS IN A TRAVEL TRAILER. OUR STORAGE IS LARGE ENOUGH FOR LARGE ITEMS LIKE RUBBERMAID STORAGE BINS OR GENERATORS





EXTRA LARGE, SINGLE BOWL  
STAINLESS STEEL SINK WITH  
METAL HIGH-RISE FAUCET.



FRICTION HINGE DOORS MEAN YOU  
NO LONGER HAVE TO WORRY  
ABOUT A CHEAP PLASTIC DOOR  
LATCH BREAKING IN THE WIND!



FORGET THE “RV UPGRADE MATTRESS” WILDCAT GOES TO THE EXTREME ONCE AGAIN WITH THE RESIDENTIAL STYLE MAXX KING-SIZED 66” x 80” MATTRESS.



King-Sized



ELECTRIC TONGUE JACK ON ALL  
TRAVEL TRAILERS



ALL WILDCAT MODELS COME  
WITH A RECEIVER HITCH TO  
ALLOW YOU TO CARRY ANY  
TYPE OF LOAD







# MAXX INSULATION PACKAGE - STANDARD

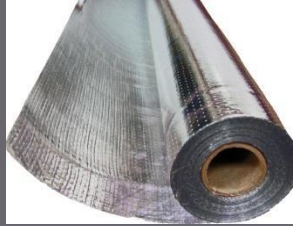

- UNDERBELLY HAS REFLECTIVE ASTRO-FOIL INSULATION + R-7 FIBERGLASS UNDER EACH HOLDING TANK. ALSO INCLUDED IS A 12 VOLT TANK HEATER FOR EACH OF THE HOLDING TANKS.
- THE MAXX-STRONG FLOOR IS LAMINATED TO A SINGLE SHEET OF DYNASPAN® DECKING WITH A 25 YEAR LIMITED WARRANTY, ALUMINUM FRAMING, BLOCK FOAM INSULATION AND WOOD INSERTS INSIDE THE ALUMINUM TUBING TO ADD STRENGTH.
- THE CEILING, FRONT WALL AND REAR WALL HAS REFLECTIVE ASTRO-FOIL INSULATION + 2 LAYERS OF R-7 FIBERGLASS INSULATION.
- THE SIDE WALLS, 3 SIDES OF THE SLIDE-OUT, SLIDE CEILING AND ALL RAISED BUNK BEDS ARE VACUUM BONDED, ALUMINUM CONSTRUCTION WITH R-10 HIGH DENSITY BLOCK FOAM INSULATION.
- THE SLIDE-OUT FLOOR ALSO HAS A LAYER OF REFLECTIVE ASTRO-FOIL INSULATION ON TOP OF 1" PLYWOOD DECKING.
- ON ALL 5TH WHEELS, THE OUTSIDE STORAGE COMPARTMENT HAS AN ACTUAL HEAT DUCT BLOWING HOT AIR FROM THE FURNACE DIRECTLY INTO THE STORAGE COMPARTMENT.
- EVERY WILDCAT COMES WITH A VENTED ATTIC TO ALLOW MOISTURE TO ESCAPE IN THE WINTER AND HEAT TO ESCAPE IN THE SUMMER
- EVERY WILDCAT COMES STANDARD WITH A 35,000 BTU FURNACE.

*(IT IS IMPORTANT TO REMEMBER THAT ASTRO-FOIL INSULATION HAS A CALCULATED, REFLECTIVE 'R' VALUE OF 38 AT AN AMBIENT TEMPERATURE OF 80° FAHRENHEIT.)*



# MAXX INSULATION

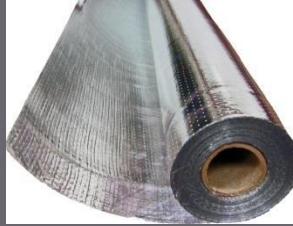

## CLIMATECH MAXX INSULATION PACKAGE *STANDARD WILDCAT*

- ❑ ENCLOSED UNDERBELLY
- ❑ 12 VOLT THERMOSTATICALLY CONTROLLED HEAT PADS ON ALL HOLDING TANKS
- ❑ R-10 HIGH-DENSITY BLOCK FOAM INSULATION IN SIDEWALLS AND SLIDE-OUT WALLS AND ROOF
- ❑ REFLECTIVE ASTRO-FOIL IN ROOF, FRONT WALL, SLIDE-OUT FLOOR AND UNDER EACH HOLDING TANK
- ❑ TWO LAYERS OF R-7 FIBERGLASS INSULATION IN ROOF AND ONE LAYER UNDER EACH HOLDING TANK
- ❑ HEATED OUTSIDE STORAGE WITH DUCTED FURNACE VENT
- ❑ 1" INSULATED BAGGAGE DOORS
- ❑ 35,000 BTU FURNACE
- ❑ VENTED ATTIC

*(IT IS IMPORTANT TO REMEMBER THAT ASTRO-FOIL INSULATION HAS A CALCULATED, REFLECTIVE 'R' VALUE OF 38 AT AN AMBIENT TEMPERATURE OF 80° FAHRENHEIT.)*

## STANDARD FEATURES – TRAVEL TRAILERS

- ▣ 15" 'E RANGE' RADIAL TIRES W/CUSTOM ALUMINUM WHEELS
- ▣ ELECTRIC AWNING
- ▣ CARBON MONOXIDE DETECTOR
- ▣ TRI-FOLD SOFA SLEEPER
- ▣ RESIDENTIAL SHAKER STYLE CABINET DOORS
- ▣ FOLDING ENTRY HANDLE
- ▣ DIGITAL 'KING' TV ANTENNA
- ▣ OUTDOOR ALL WEATHER SPEAKERS
- ▣ BLACK FRAMED TINTED SAFETY GLASS WINDOWS
- ▣ GEL COATED FIBERGLASS SIDEWALLS
- ▣ GEL-COATED MOLDED FRONT FIBERGLASS CAP W/FRONT WINDSHIELD (MOST MODELS)
- ▣ BALL-BEARING FULL EXTENSION DRAWER GUIDES
- ▣ KITCHEN WALL BACKSPLASH
- ▣ SHOWER SURROUND
- ▣ CUTTING BOARD (BACK OF SINK COVERS)
- ▣ SPARE TIRE & CARRIER
- ▣ 12V, 10.7' CUBIC REFRIGERATOR
- ▣ SELF ADJUSTING BRAKES
- ▣ SWIVEL ROCKER-RECLINER CHAIRS (NOT ALL MODELS)
- ▣ SATELLITE & CABLE PREP
- ▣ BACK-UP CAMERA PREP
- ▣ BLACK TANK FLUSH
- ▣ REAR LADDER
- ▣ FULLY GLUED, RESIDENTIAL VINYL FLOORING
- ▣ FULL WALK-ON ROOF
- ▣ ONE PIECE ROOF MEMBRANE
- ▣ 21" OVEN W/ CAST IRON GRATES & LED LIGHTS
- ▣ PLEATED NIGHT SHADES
- ▣ 16 GAL PER HOUR GAS/ELECTRIC QUICK RECOVERY DSI WATER HEATER
- ▣ 13.5 BTU DUCTED AIR CONDITIONING
- ▣ MICROWAVE OVEN
- ▣ ALUMINUM FRAMED 2" SIDEWALLS
- ▣ BEDROOM ROOF VENT
- ▣ 50" LCD /HD TV (MOST MODELS)
- ▣ SOUND BAR STYLE SPEAKERS
- ▣ PORCELAIN FOOT-FLUSH TOILET
- ▣ OUTSIDE SHOWER
- ▣ UPGRADED LIGHT FIXTURES
- ▣ 7' TALL CEILINGS (TRAVEL TRAILERS)
- ▣ RANGE COVER
- ▣ OUTSIDE LP QUICK CONNECT FOR BBQ
- ▣ HIGH DEFINITION GRAPHICS
- ▣ DYNAMIC TECHNOLOGY PACKAGE
- ▣ PEAK PACKAGE
- ▣ 'CLIMATECH' MAXX INSULATION PACKAGE
- ▣ MAXX KING 80" LONG MEMORY FOAM, PILLOW-TOP MATTRESS
- ▣ UPGRADED RESIDENTIAL BEDSPREAD
- ▣ RESIDENTIAL SIZE, SINGLE BOWL, STAINLESS STEEL KITCHEN SINK
- ▣ SLIDER WINDOWS IN SLIDE-OUT
- ▣ STAINLESS APPEARANCE APPLIANCES
- ▣ 30" FRICTION HINGE ENTRANCE DOOR
- ▣ 50 AMP SERVICE



## OPTIONAL FEATURES

- ▣ FREE STANDING TABLE & 4 CHAIRS
- ▣ DUAL PANE WINDOWS
- ▣ 2<sup>ND</sup> 13.5 BTU A/C IN BEDROOM
- ▣ 15K BTU DUCTED A/C IPO 13.5K
- ▣ 15K BTU DUCTED A/C WITH HEAT PUMP
- ▣ 8' CUBIC GAS/ELECTRIC REFER IPO 12 VOLT REFER
- ▣ POWER THEATER SEATING IPO TRI-FOLD SOFA
- ▣ 16" ALUMINUM WHEELS & LOAD RANGE 'E' TIRES
- ▣ GVWR LIMIT LABEL - 9,950 GVWR
- ▣ WASHINGTON STATE SEAL
- ▣ OREGON STATE SEAL
- ▣ IDAHO PERMIT, MONTANA, WYOMING, BC, ALBERTA PERMITS
- ▣ MVSA
- ▣ CANADIAN Z-240

# TRAVEL TRAILER OPTIONAL FEATURES & PACKAGES

## DYNAMIC TECHNOLOGY PACKAGE (MANDATORY)

- ▣ VACUUM BONDED 2" WELDED ALUMINUM STRUCTURE
- ▣ BACK-UP CAMERA PREP
- ▣ PORTABLE SOLAR PANEL PREP
- ▣ DVD/CD/HDMI/BLUETOOTH/AM/FM STEREO W/PHONE APP CONTROL
- ▣ AM/FM DIGITAL TV ANTENNA W/4G & WIFI EXTENDER PREP
- ▣ EXTERIOR TV CONNECTION
- ▣ FRAME-MOUNTED RECEIVER HITCH
- ▣ BATTERY DISCONNECT
- ▣ LED HDTV(SIZE VARIES BY MODEL)
- ▣ CELLPHONE/ CPAP & TABLET STATION AT EACH SIDE OF BED(USB PORTS & 110V PLUGS)

## PEAK PACKAGE (MANDATORY)

- ▣ FRONT WINDSHIELD (MOST MODELS)
- ▣ BLACK TANK FLUSH
- ▣ JT'S STRONG-ARM JACKS
- ▣ POWER TONGUE JACK (TT'S)
- ▣ FRICTION HINGE ENTRY DOORS
- ▣ FOLD-DOWN ENTRY STEP (MAIN ENTRANCE)
- ▣ MAXX-KING 80" LONG UPGRADED MATTRESS
- ▣ LARGE SINGLE BOWL STAINLESS STEEL SINK W/UPGRADED KITCHEN FAUCET
- ▣ 2-IN-1 RANGE & OVEN
- ▣ 10 PLUS CUBIC FOOT 12 VOLT REFER
- ▣ SOLID SURFACE KITCHEN COUNTERTOPS

## STANDARD FEATURES – 5<sup>TH</sup> WHEELS

- ▣ 15" 'E RANGE' RADIAL TIRES W/CUSTOM ALUMINUM WHEELS
- ▣ ELECTRIC AWNING
- ▣ CARBON MONOXIDE DETECTOR
- ▣ TRI-FOLD SOFA SLEEPER
- ▣ RESIDENTIAL SHAKER STYLE CABINET DOORS
- ▣ FOLDING ENTRY HANDLE
- ▣ DIGITAL 'KING' TV ANTENNA
- ▣ OUTDOOR ALL WEATHER SPEAKERS
- ▣ BLACK FRAMED TINTED SAFETY GLASS WINDOWS
- ▣ GEL COATED FIBERGLASS SIDEWALLS
- ▣ GEL-COATED MOLDED FRONT FIBERGLASS CAP W/FRONT WINDSHIELD (MOST MODELS)
- ▣ BALL-BEARING FULL EXTENSION DRAWER GUIDES
- ▣ KITCHEN WALL BACKSPLASH
- ▣ SHOWER SURROUND
- ▣ CUTTING BOARD (BACK OF SINK COVERS)
- ▣ SPARE TIRE & CARRIER
- ▣ 12V, 10.7' CUBIC REFRIGERATOR
- ▣ SELF ADJUSTING BRAKES
- ▣ GROUND CONTROL 3.0 AUTOMATIC LEVELING (F323RK, F348MB, F336RLS, F368MB ONLY)
- ▣ SATELLITE & CABLE PREP
- ▣ BACK-UP CAMERA PREP
- ▣ BLACK TANK FLUSH
- ▣ REAR LADDER
- ▣ FULLY GLUED, RESIDENTIAL VINYL FLOORING
- ▣ FULL WALK-ON ROOF
- ▣ ONE PIECE ROOF MEMBRANE
- ▣ 21" OVEN W/ CAST IRON GRATES & LED LIGHTS
- ▣ PLEATED NIGHT SHADES
- ▣ 16 GAL PER HOUR GAS/ELECTRIC QUICK RECOVERY DSI WATER HEATER
- ▣ 13.5 BTU DUCTED AIR CONDITIONING
- ▣ MICROWAVE OVEN
- ▣ ALUMINUM FRAMED 2" SIDEWALLS
- ▣ BEDROOM ROOF VENT
- ▣ 50" LCD /HD TV (MOST MODELS)
- ▣ SOUND BAR STYLE SPEAKERS
- ▣ PORCELAIN FOOT-FLUSH TOILET
- ▣ OUTSIDE SHOWER
- ▣ UPGRADED LIGHT FIXTURES
- ▣ 7' TALL CEILINGS (TRAVEL TRAILERS)
- ▣ RANGE COVER
- ▣ OUTSIDE LP QUICK CONNECT FOR BBQ
- ▣ HIGH DEFINITION GRAPHICS
- ▣ DYNAMIC TECHNOLOGY PACKAGE
- ▣ PEAK PACKAGE
- ▣ 'CLIMATECH' MAXX INSULATION PACKAGE
- ▣ MAXX KING 80" LONG MEMORY FOAM, PILLOW-TOP MATTRESS
- ▣ UPGRADED RESIDENTIAL BEDSPREAD
- ▣ RESIDENTIAL SIZE, SINGLE BOWL, STAINLESS STEEL KITCHEN SINK
- ▣ SLIDER WINDOWS IN SLIDE-OUT
- ▣ STAINLESS APPEARANCE APPLIANCES
- ▣ 30" FRICTION HINGE ENTRANCE DOOR
- ▣ 50 AMP SERVICE

## OPTIONAL FEATURES

- ▣ 2<sup>ND</sup> A/C 15.000 BTU IN BEDROOM (DUCTED)
- ▣ GROUND CONTROL 3.0 AUTOMATIC LEVELING JACKS (260RD, 268BH, 271ML ONLY)
- ▣ 2<sup>ND</sup> 13.5 BTU A/C IN BEDROOM
- ▣ SUBURBAN GAS GRIDDLE W/MOUNTING BRACKET (MOST MODELS)
- ▣ BACK-UP MONITOR CAMERA
- ▣ 8' CUBIC GAS/ELECTRIC REFER IPO 12 VOLT REFER
- ▣ DUAL PANE WINDOWS/SAFETY GLASS
- ▣ SLIDE OUT AWNINGS
- ▣ WINEGARD GATEWAY WIFI EXTENDER & 4GTLE
- ▣ BOOTH DINETTE (IPO FREE STANDING TABLE & 4 CHAIRS)
- ▣ WASHINGTON STATE SEAL
- ▣ OREGON STATE SEAL
- ▣ IDAHO, MONTANA, WYOMING, BC, ALBERTA PERMITS
- ▣ MVSA
- ▣ CANADIAN Z-240

## DYNAMIC TECHNOLOGY PACKAGE (MANDATORY)

- ▣ VACUUM BONDED 2" WELDED ALUMINUM STRUCTURE
- ▣ FURRION REAR OBSERVATION & SIDE CAMERA PREP
- ▣ PORTABLE SOLAR PANEL PREP
- ▣ CONNEXX SOUNDBAR W/DVD/CD/HDMI/BLUETOOTH/FM/USB & 3 ZONES
- ▣ AM/FM DIGITAL TV ANTENNA W/4G & WIFI EXTENDER PREP
- ▣ WINEGARD 360+ (AM/FM, TV ANTENNA W/4G & WIFI EXTENDER PREP)
- ▣ DEXTER AXLES
- ▣ EXTERIOR TV HOOKUP W/TV BRACKET
- ▣ 2" ACCESSORY RECEIVER
- ▣ BATTERY DISCONNECT SWITCH
- ▣ LED HDTV(SIZE VARIES BY MODEL)
- ▣ CELLPHONE/ CPAP & TABLET STATION AT EACH SIDE OF BED(USB PORTS & 110V PLUGS)

# 5<sup>TH</sup> WHEEL OPTIONAL FEATURES & PACKAGES

## PEAK PACKAGE (MANDATORY)

- ▣ FRONT WINDSHIELD (N/A 336RLS, 368MB)
- ▣ 30" ENTRY DOOR W/FRICTION HINGE
- ▣ STANDARD GROUND CONTROL 3.0 AUTOMATIC LEVELING (OPTION ON 260RD, 268BH, 271ML, 2997BH)
- ▣ MEGA TV LIFT UP STORAGE (N/A 260RD, 268NBH, 297BH)
- ▣ ROAD ARMOUR SUSPENSION KIT
- ▣ LCI SOLID STEP ON MAIN ENTRY
- ▣ UNDER BED, WALK-IN STORAGE (N/A 336RLS, 368MB)
- ▣ MAXX-KING 80" LONG UPGRADED MATTRESS
- ▣ LARGE SINGLE BOWL STAINLESS STEEL SINK & BULLET FAUCET
- ▣ 2-IN-1 RANGE & OVEN
- ▣ 10 .7 CUBIC FOOT 12 VOLT REFER
- ▣ SOLID SURFACE KITCHEN COUNTERTOPS



# INTERIOR COLOR OPTIONS



BLONDE INTERIOR  
SHOWN WITH OPTIONAL  
FREE STANDING TABLE &  
4 CHAIRS



LATTE INTERIOR SHOWN  
WITH STANDARD BOOTH  
DINETTE WITH DUAL 30"  
DRAWERS & OPTIONAL  
POWER THEATER SEATING  
WITH POWER RECLINE,  
LED LIGHTING & MASSAGE



# EXTERIOR







# FOREST RIVER ROADSIDE ASSISTANCE PROGRAM

## BENEFITS



With the purchase of a Forest River RV, customers receive the following benefits for free for one year:

- Towing
- Jump-starts
- Tire assistance
- Emergency fluid delivery
- Winch out
- Mobile tire service
- Technical Support
- RV mobile mechanic
- Dealer locator
- 24/7/365 service

POWERED BY



**24/7 EMERGENCY ROADSIDE ASSISTANCE INCLUDED WITH VEHICLE PURCHASE**

For emergency roadside assistance, please call: **866-209-2895**

Service expires one year from date of purchase. For membership coverage information or to extend/enhance your current coverage please call: 888-890-1745.





**EASY**

**MAINTENANCE FREE ROOF**

- Will not chalk, streak or spot
- Easy to install and pull over tough transitions with no wrinkles.
- Made of PVC - premium quality roofing material used for over 40 years.
- No treatments required - Ever!



**UNMATCHED STRENGTH - 100% WEARLAYER**

MEMBRANE	PUNCTURE STRENGTH	TEAR STRENGTH
✓ PVC	23.4	8.7 lbs
TPO	11.09	6.6 lbs

**20%**  
MORE TEAR  
RESISTANCE

**2X**  
THE PUNCTURE  
STRENGTH

**100%**  
WEARLAYER  
TOP TO BOTTOM

**THE  
STRONGEST  
RV ROOF ON  
THE MARKET**

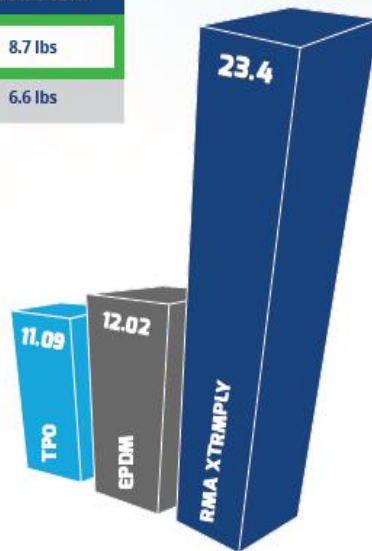

**MOST ENERGY EFFICIENT & REFLECTIVE**

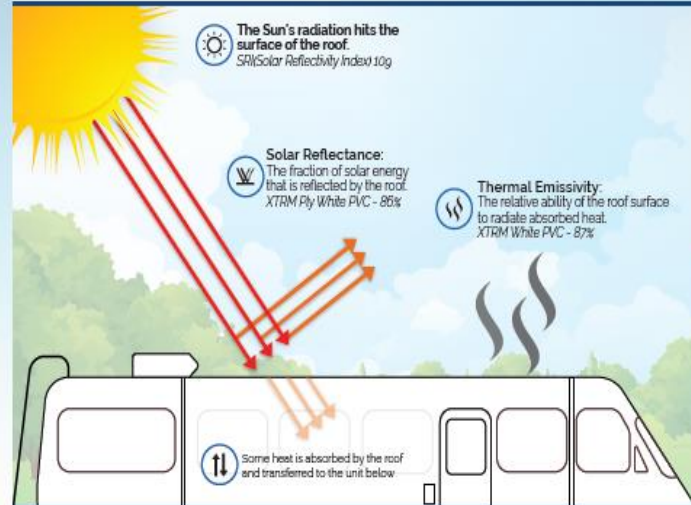

**EXTRAORDINARY  
REFLECTIVITY  
KEEPING YOUR  
UNIT COOLER**

**109**  
SRI  
SOLAR REFLECTIVITY  
INDEX

**BEST WARRANTY ON THE MARKET**

**ZERO** PVC MEMBRANE FAILURES TO DATE



**15 YEAR WARRANTY**

LASALLE BRISTOL AND RMA OFFER A 15 YEAR WARRANTY COVERED 100%.



# Self Adjusting Brake Systems

LIPPERTCOMPONENTS INC

Stop worrying about improperly adjusted brakes...  
...and get up to 50% better stopping time



Trailer with Lippert Self Adjusting Brakes\*

(Stopping distance at 60 mph)



Trailer with unadjusted standard electric brakes\*

## Did you know...

Did you know that it is recommended to adjust the brakes on your trailer every **3 months** or **3,000 miles**? This can be costly, and is commonly a **NEGLECTED** task that most trailer owners fail to do. With **Lippert Components Self Adjusting Brake Systems**, trailer owners will have **peace of mind** knowing their brakes are properly adjusted to give ample stopping time for the dangers that lie ahead.

Still having a hard time deciding? See for yourself how Lippert Self Adjusting Brakes can save you time and money!



### Time/Expense Benefits:



Let's assume a tandem axle trailer is towed 6,000 miles in one year. Lippert Components recommends that your trailer brakes be adjusted every 3,000 miles. Each individual brake adjustment takes on average 15 minutes at a standard dealer labor rate of \$100/hour. That's a total of **2 hours** of labor **every year** costing you **\$200!**

**Doesn't \$0.00 sound better than \$200?\***



Close-up of Self Adjusting Brake Mechanism

### Self Adjusting Brake System: Performance Benefits

- Brake self-adjusts every forward stop ensuring consistent braking
- Provides optimal brake performance; brakes auto-set correct clearance
  - Provides optimal brake lining and magnet wear
- Peace of mind knowing you can stop your trailer when you need to



Lippert Self Adjusting Brake

### Self Adjusting Brake System: Specifications

**Self Adjusting Brakes can retrofit to any Lippert LCI 35, 52, 60 & 70 series axles**

- 10" x 2-1/4" Self Adjusting Electric Brakes fit 2.5K - 3.5K axles
  - 12" x 2" Self Adjusting Brakes fit 5K - 7K axles
- All Lippert 8K-10K axles come **standard** with 12-1/4" x 3-3/8" Self Adjusting Brakes

Lippert Components, Inc | 2703 College Ave, Goshen IN 46528 | [www.lci1.com](http://www.lci1.com) | [store.lci1.com](http://store.lci1.com)

\* All figures are estimated. © 2011 Lippert Components, Inc. All rights reserved. All information in this publication was accurate at press time.

# Travel Trailer Axles

## Lippert Components Axles are Going Farther than Ever Before

### Introducing Industry Leading



Starting January 1, 2017, Lippert Components will offer the industry leading limited axle warranty:

Limited 1 Year Warranty – grease and oil seals for all axles  
Limited 6 Year Warranty – spring axles and suspension systems



[lippertcomponents.com](http://lippertcomponents.com)

SCAN HERE FOR  
MORE INFORMATION







# Forest River Warranty

## OREGON MANUFACTURING

25 Year Warranty - Dynaspan Floor Decking (Structural panel failure caused by manufacturing defects, glue bond failure and delamination)

15 Year Warranty - XTRM Ply PVC Roofing System

6 Year Warranty - Lippert leaf spring Axles on manufacturing defects  
(with proper maintenance)

5 Year Warranty - Laminate Flooring

2 Year Warranty - A/C/ Water Heater/Furnace/Stove/refrigerator -  
(2<sup>nd</sup> year directly through product manufacturer)

2 Year Warranty - Water Pump (2<sup>nd</sup> year directly through product manufacturer)

1 Year Warranty - Stereo

1 Year Warranty - Microwave

1 Year Warranty - Outside Refrigerator

1 Year Warranty - Television

1 Year Warranty - Rear Ladder

1 Year Warranty - Tires

1 Year Warranty - All other Lippert Components - (Slide Mechanism, Electric Stabilizer Jacks, Tongue Jack, etc.)

***(All warranties are considered 1 year unless otherwise stated and are activated from date of retail sale.)***

Forest River, Inc. - Dallas, Oregon - All warranties are accurate at time of publication. Forest River, Inc. and its partners reserve the right to make changes without notice and assumes no responsibility with inaccuracies in this publication. Please consult with your local dealer for up-to-date information.

3/8/2017

2021.5

WILDCAT



5<sup>th</sup> Wheels

# F260RD

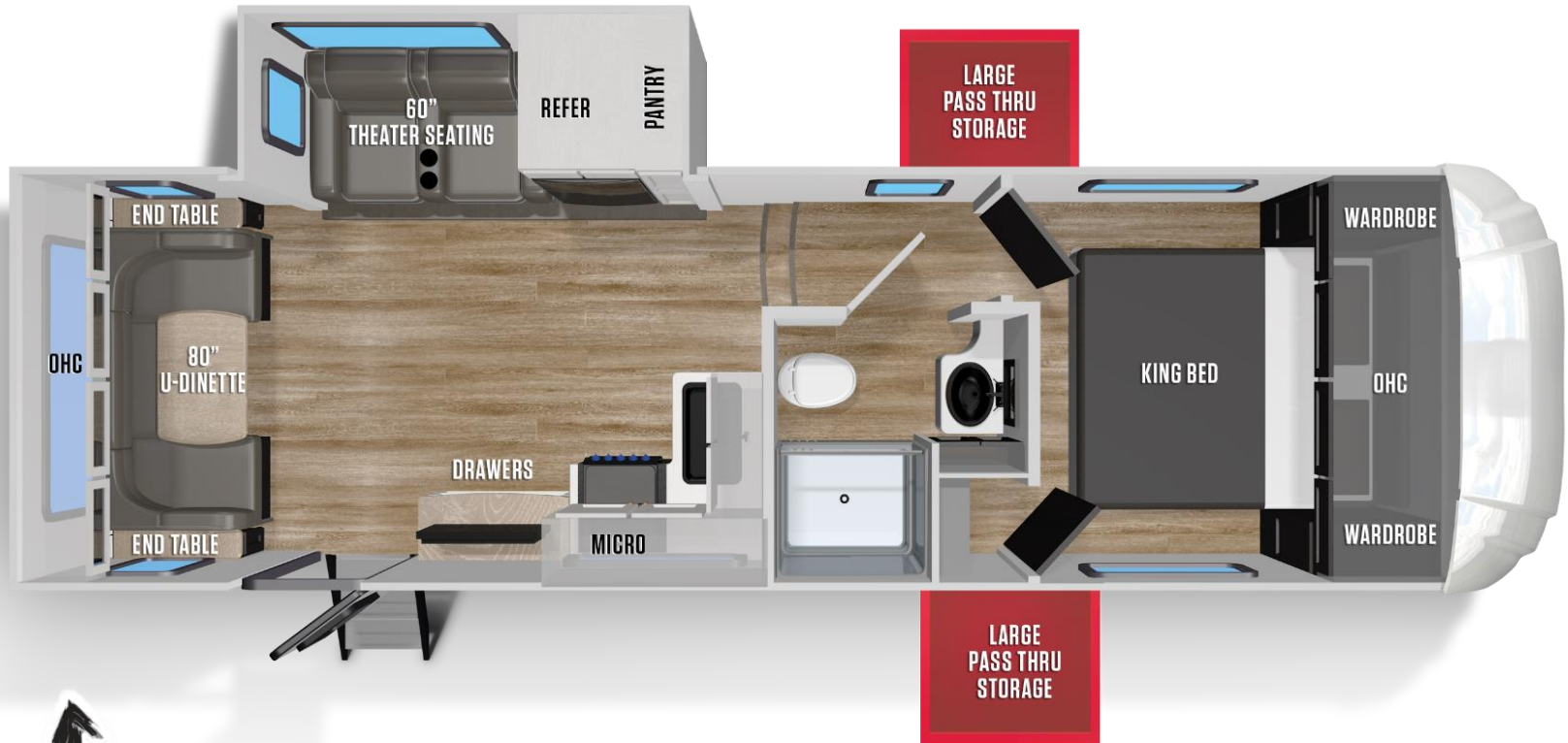

Hitch Weight (lb)	TBD	Exterior Width	96"
GVWR (lb)	TBD	Fresh Water (gal)	64
UVW (lb)	TBD	Gray Water (gal)	76*
CCC (lb)	TBD	Black Water (gal)	38
Exterior Length	TBD	Awning Length	16'
Exterior Height	TBD	Furnace (BTU)	TBD

\* 2 Tanks



# F268BH

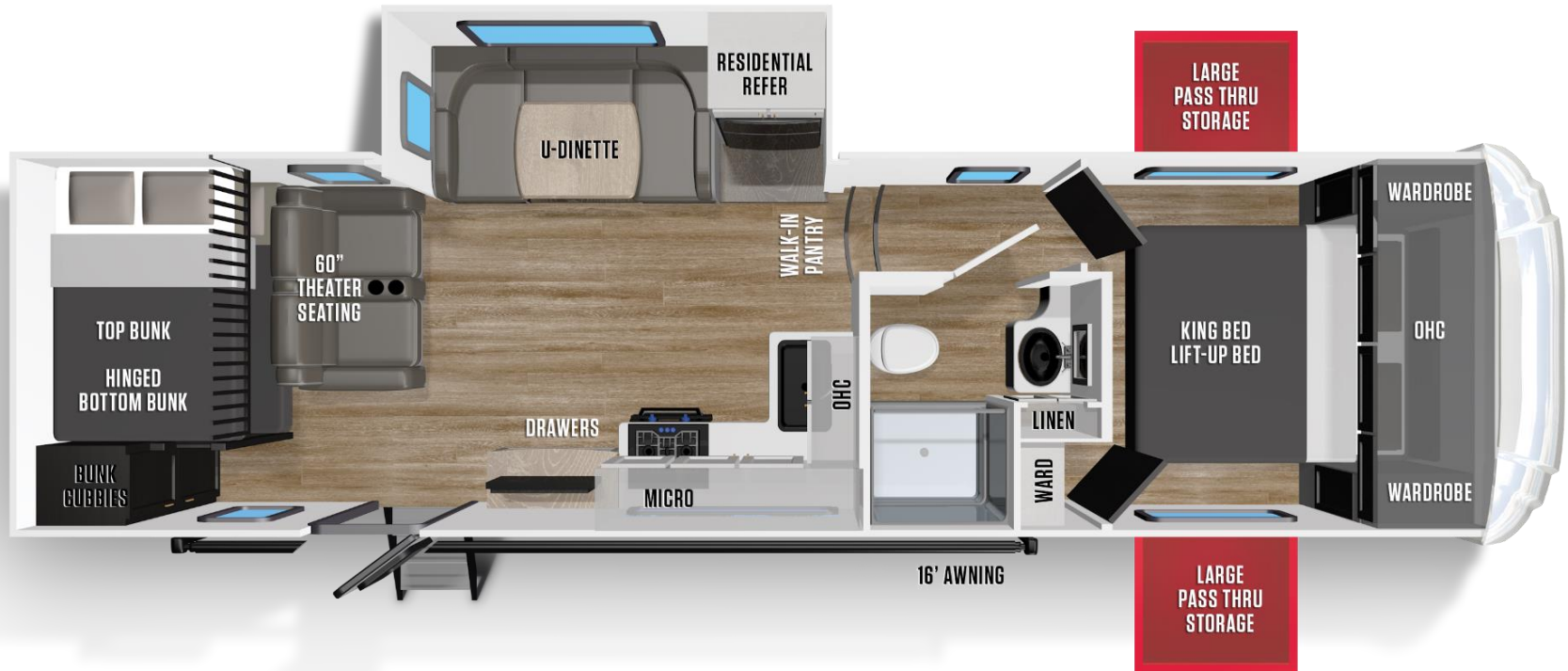

Hitch Weight (lb)	TBD	Exterior Width	96"
GVWR (lb)	TBD	Fresh Water (gal)	64
UVW (lb)	TBD	Gray Water (gal)	76*
CCC (lb)	TBD	Black Water (gal)	36
Exterior Length	TBD	Awning Length	16'
Exterior Height		Furnace (BTU)	35,000

\* 2 Tanks

# F271ML

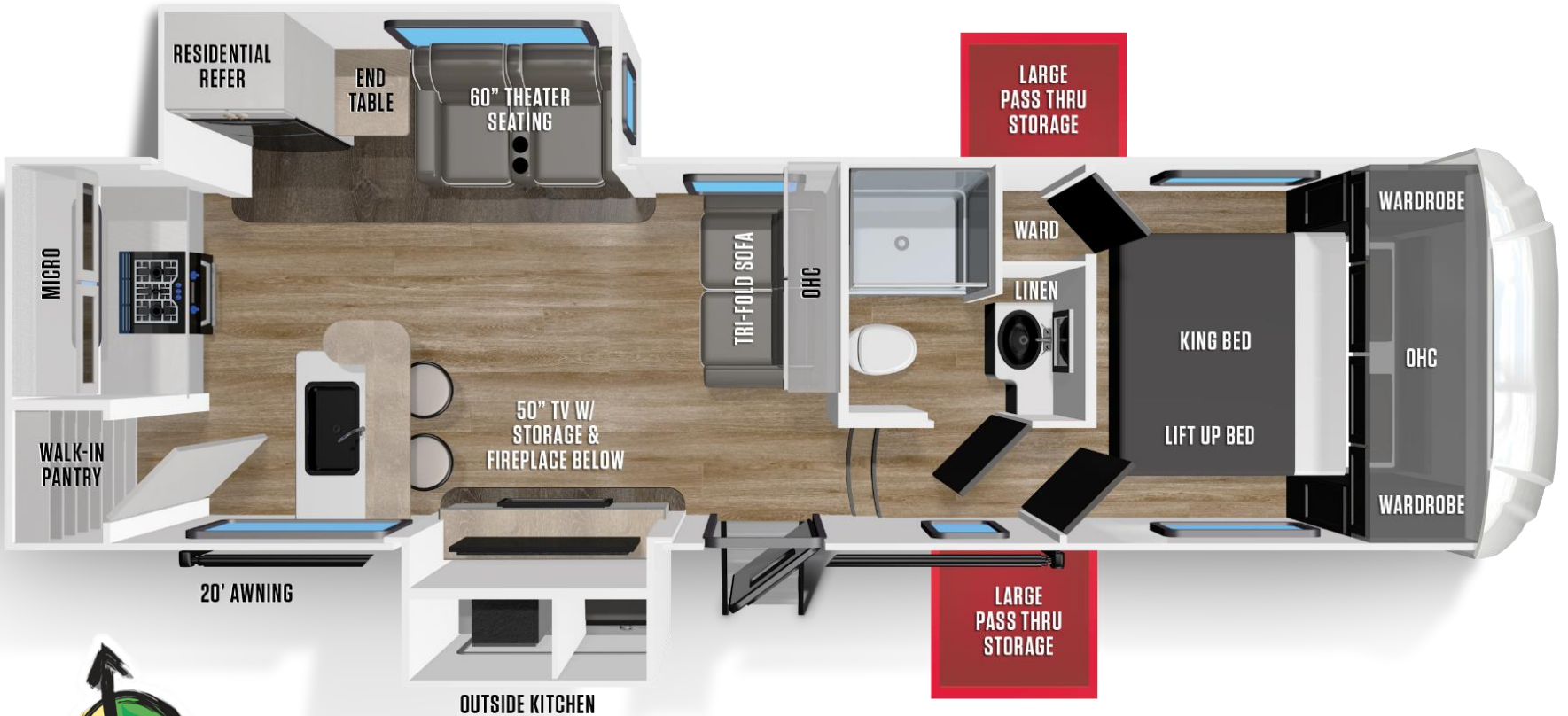

Hitch Weight (lb)	TBD	Exterior Width	96"
GVWR (lb)	TBD	Fresh Water (gal)	64
UVW (lb)	TBD	Gray Water (gal)	76*
CCC (lb)	TBD	Black Water (gal)	36
Exterior Length	TBD	Awning Length	20'
Exterior Height		Furnace (BTU)	35,000

\* 2 Tanks

# F297BH

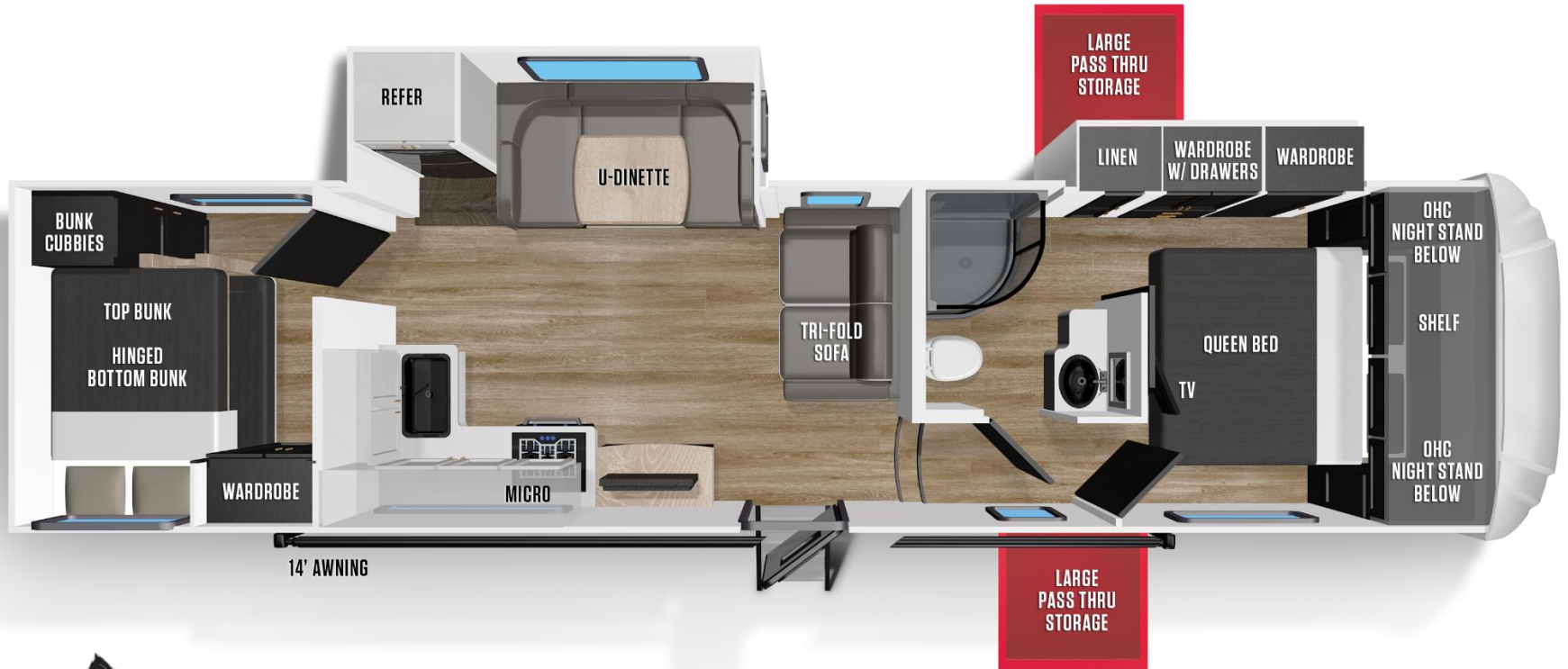

Hitch Weight (lb)	TBD	Exterior Width	96"
GVWR (lb)	TBD	Fresh Water (gal)	64
UVW (lb)	TBD	Gray Water (gal)	76*
CCC (lb)	TBD	Black Water (gal)	38
Exterior Length	TBD	Awning Length	13'
Exterior Height		Furnace (BTU)	35,000

\* 2 Tanks



# F298RLS

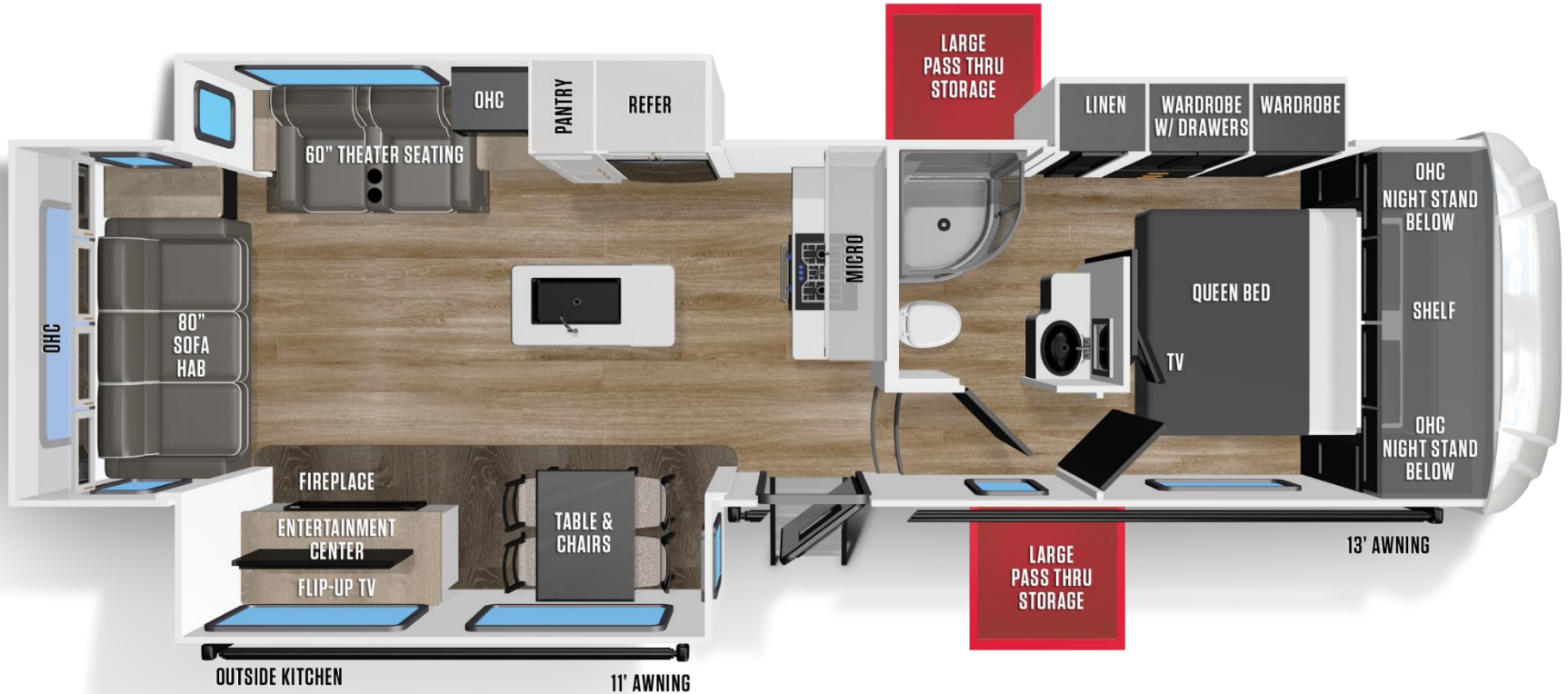

Hitch Weight (lb)	TBD	Exterior Width	96"
GVWR (lb)	TBD	Fresh Water (gal)	64
UVW (lb)	TBD	Gray Water (gal)	76*
CCC (lb)	TBD	Black Water (gal)	38
Exterior Length	TBD	Awning Length	12'
Exterior Height		Furnace (BTU)	35,000

\* 2 Tanks

# F336RL

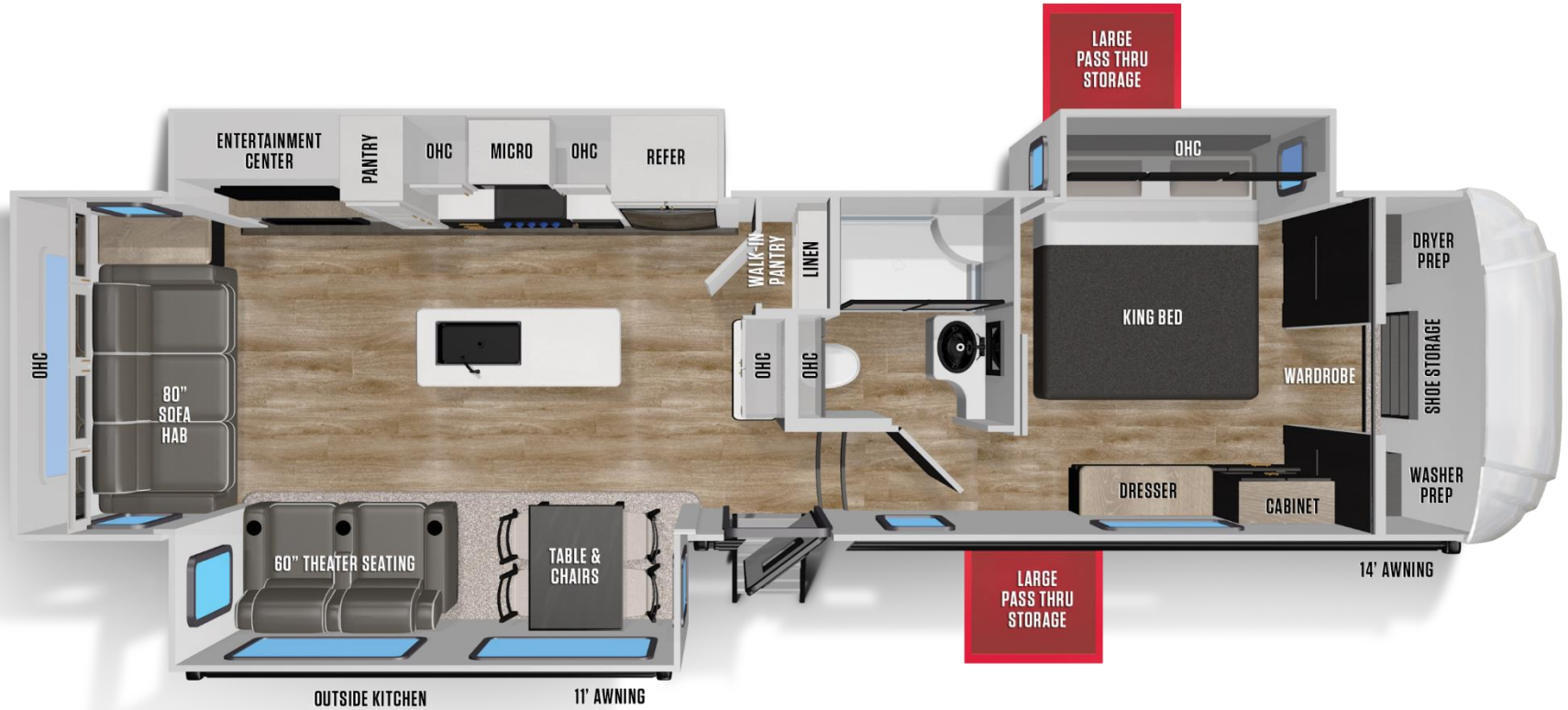

Hitch Weight (lb)	1,241	Exterior Width	96"
GVWR (lb)	11,441	Fresh Water (gal)	64
UVW (lb)	8,992	Gray Water (gal)	76*
CCC (lb)	2,449	Black Water (gal)	29
Exterior Length	37'11"	Awning Length	14'
Exterior Height		Furnace (BTU)	35,000



# F336RLS Shown in Latte Interior







# F348MB

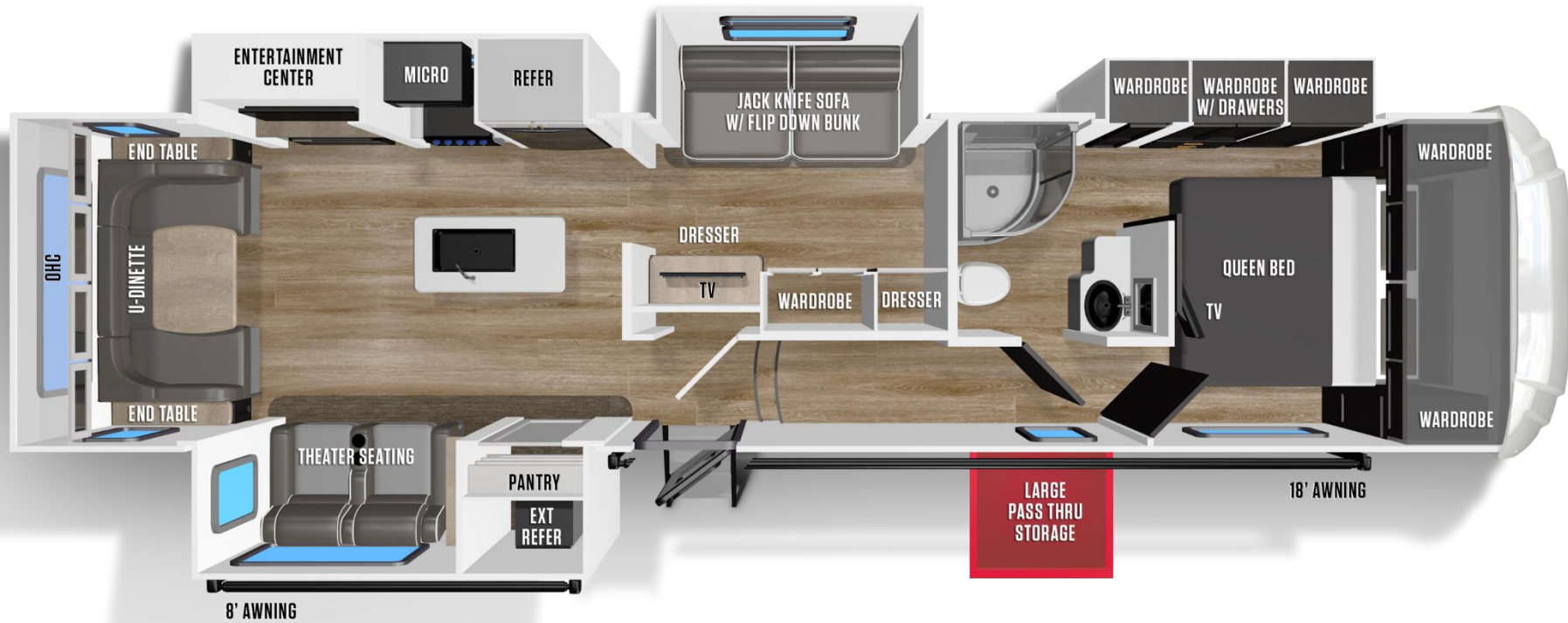

Hitch Weight (lb)	1,241	Exterior Width	96"
GVWR (lb)	11,441	Fresh Water (gal)	64
UVW (lb)	8,992	Gray Water (gal)	76*
CCC (lb)	2,449	Black Water (gal)	38
Exterior Length	37'11"	Awning Length	16'
Exterior Height		Furnace (BTU)	35,000

\* 2 Tanks

# F368MB



Hitch Weight (lb)	1,241	Exterior Width	96"
GVWR (lb)	11,441	Fresh Water (gal)	64
UVW (lb)	8,992	Gray Water (gal)	76*
CCC (lb)	2,449	Black Water (gal)	38
Exterior Length	37'11"	Awning Length	19'
Exterior Height		Furnace (BTU)	35,000

\* 2 Tanks





2021.5

WILDCAT

Travel Trailers



# T247RKK

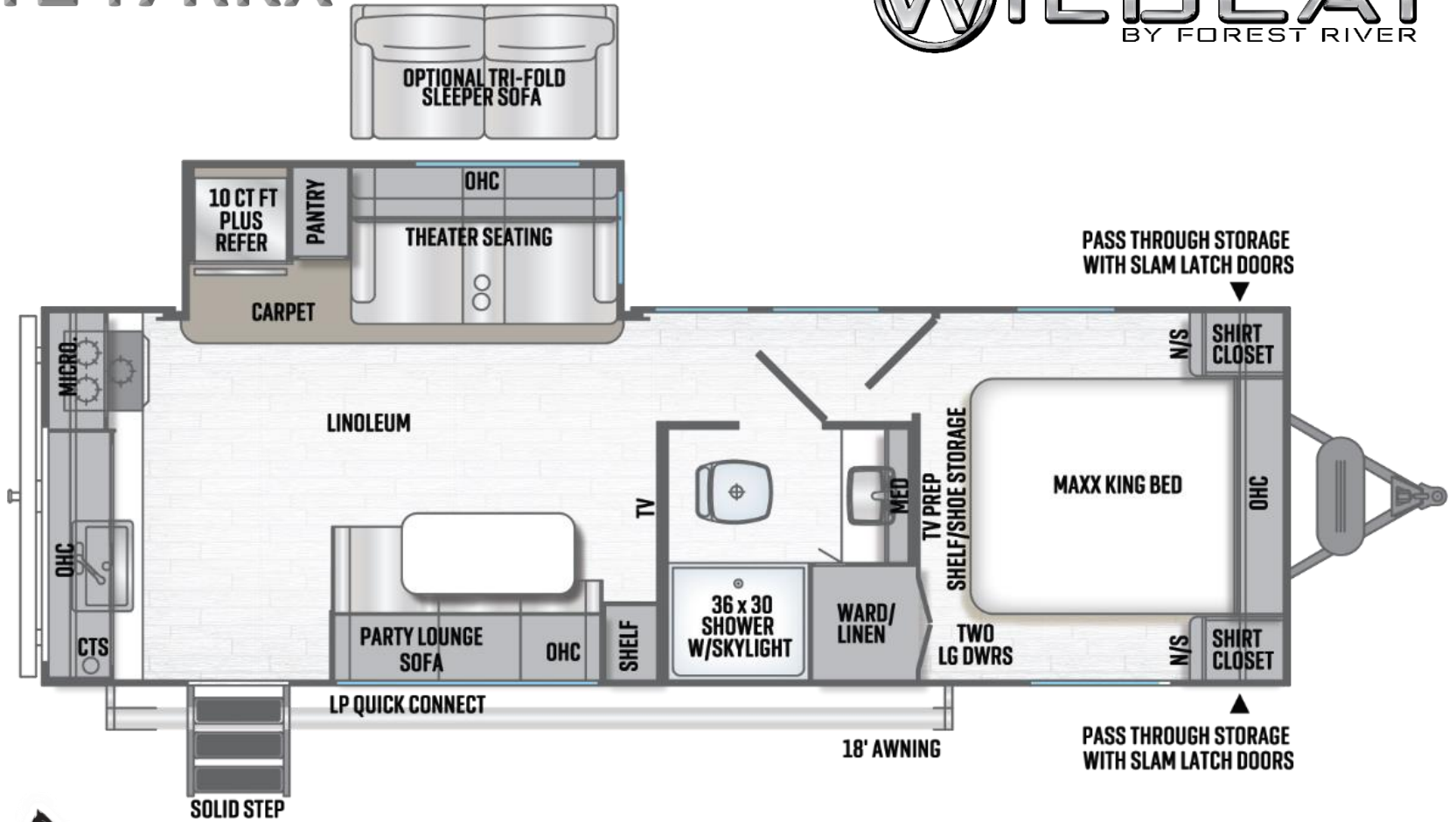

Hitch Weight (lb)	730	Exterior Width	96"
GVWR (lb)	9,530	Fresh Water (gal)	61
UVW (lb)	6,789	Gray Water (gal)	64*
CCC (lb)	2,741	Black Water (gal)	32
Exterior Length	30'10"	Awning Length	19'
Exterior Height		Furnace (BTU)	35,000

\* 2 Tanks



# WILDCAT



T247RKX  
Shown in  
Blonde Interior

# T262RSX

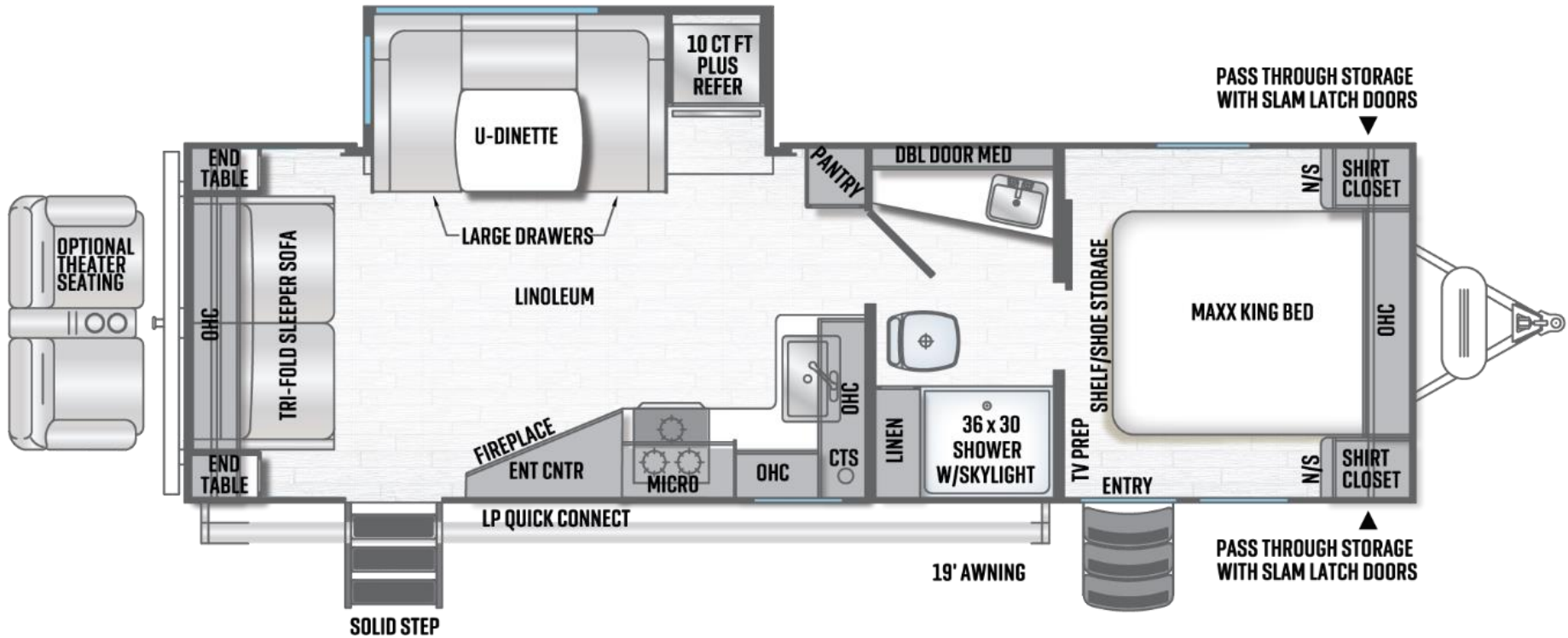

Hitch Weight (lb)	693	Exterior Width	96"
GVWR (lb)	9,493	Fresh Water (gal)	61
UVW (lb)	6,918	Gray Water (gal)	64*
CCC (lb)	2,575	Black Water (gal)	42
Exterior Length	31'6"	Awning Length	19'
Exterior Height		Furnace (BTU)	35,000

\* 2 Tanks

# T266MEX

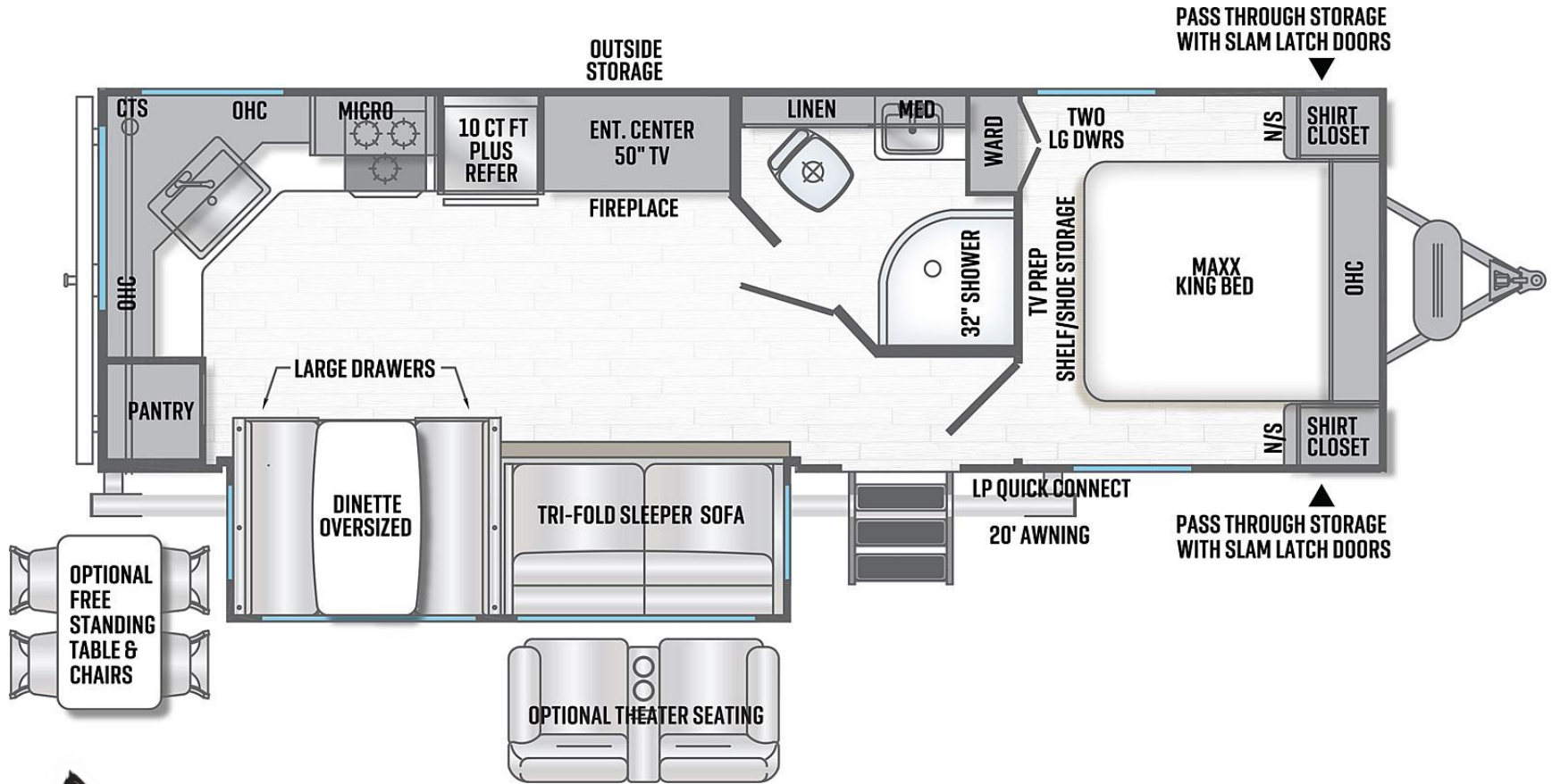

Hitch Weight (lb)	912	Exterior Width	96"
GVWR (lb)	9,712	Fresh Water (gal)	61
UVW (lb)	7,097	Gray Water (gal)	74*
CCC (lb)	2,615	Black Water (gal)	32
Exterior Length	32'5"	Awning Length	20'
Exterior Height		Furnace (BTU)	35,000

\* 2 Tanks



**WILDCAT**



**T266MEX  
Shown in  
Latte Interior**

# T269DBX

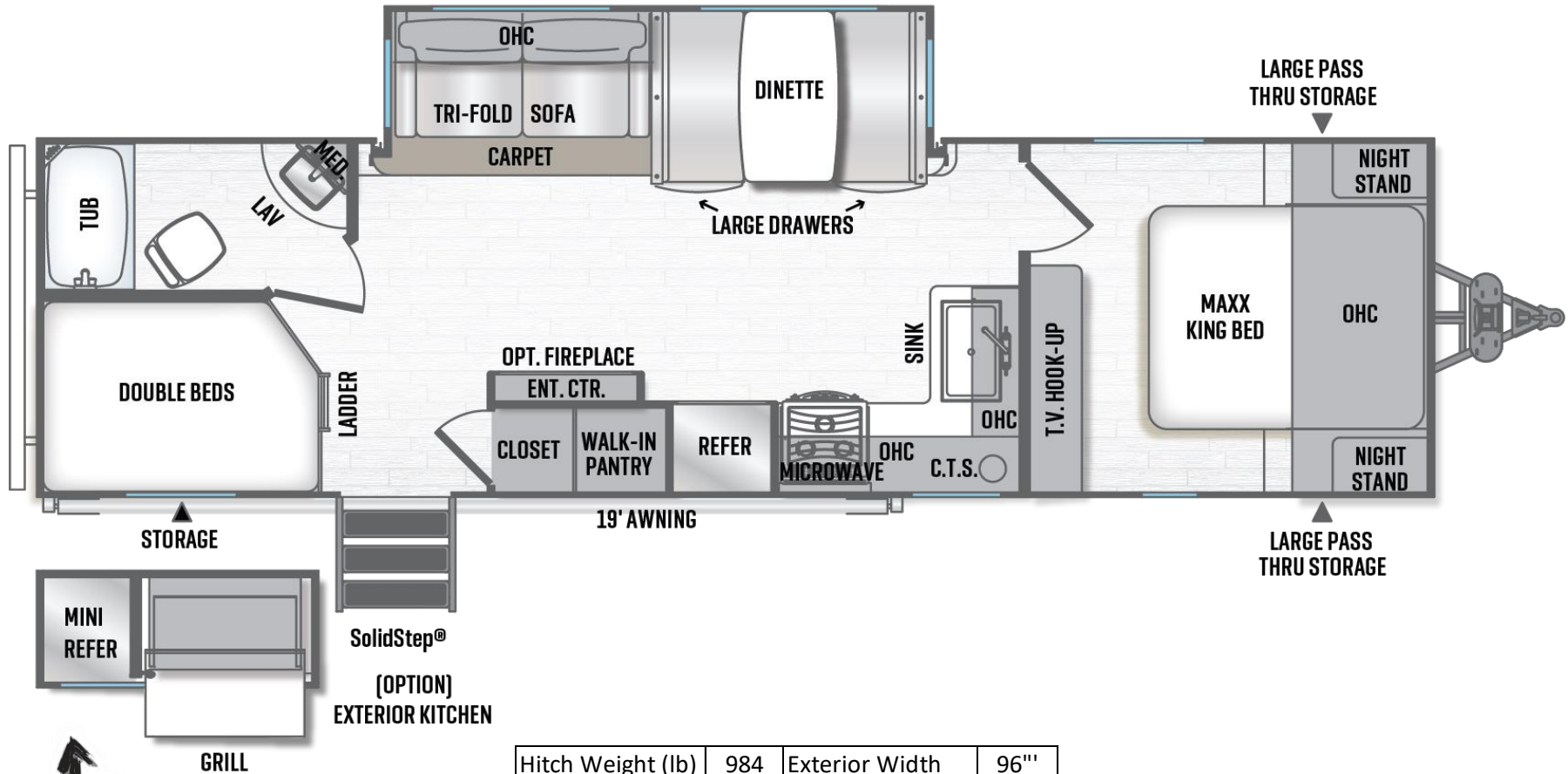

Hitch Weight (lb)	984	Exterior Width	96"
GVWR (lb)	9,784	Fresh Water (gal)	61
UVW (lb)	7,339	Gray Water (gal)	75*
CCC (lb)	2,445	Black Water (gal)	33
Exterior Length	34'	Awning Length	17'
Exterior Height		Furnace (BTU)	35,000

\* 2 Tanks

# T272MKX

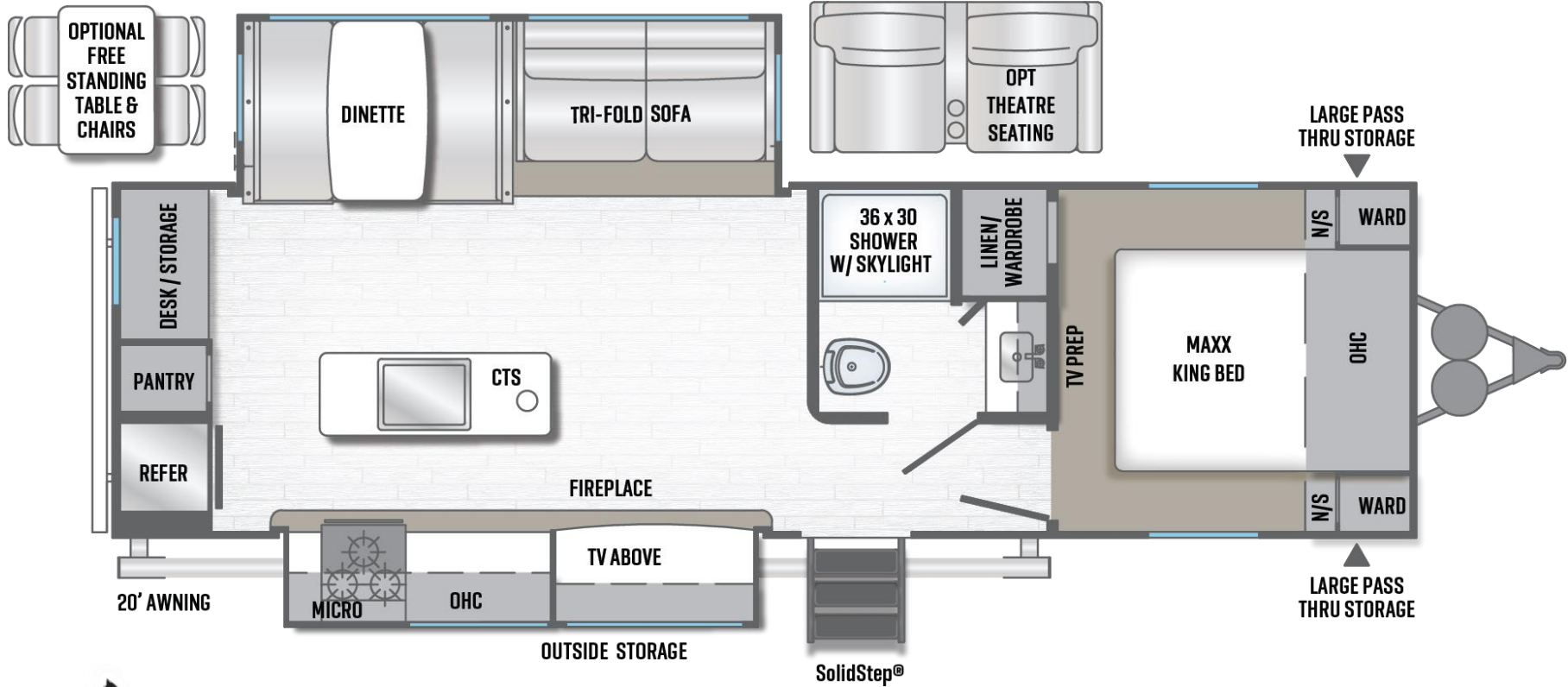

Hitch Weight (lb)	887	Exterior Width	96"
GVWR (lb)	9,687	Fresh Water (gal)	61
UVW (lb)	7,666	Gray Water (gal)	74*
CCC (lb)	2,021	Black Water (gal)	32
Exterior Length	33'	Awning Length	2'
Exterior Height		Furnace (BTU)	35,000

\* 2 Tanks



# T276FKX

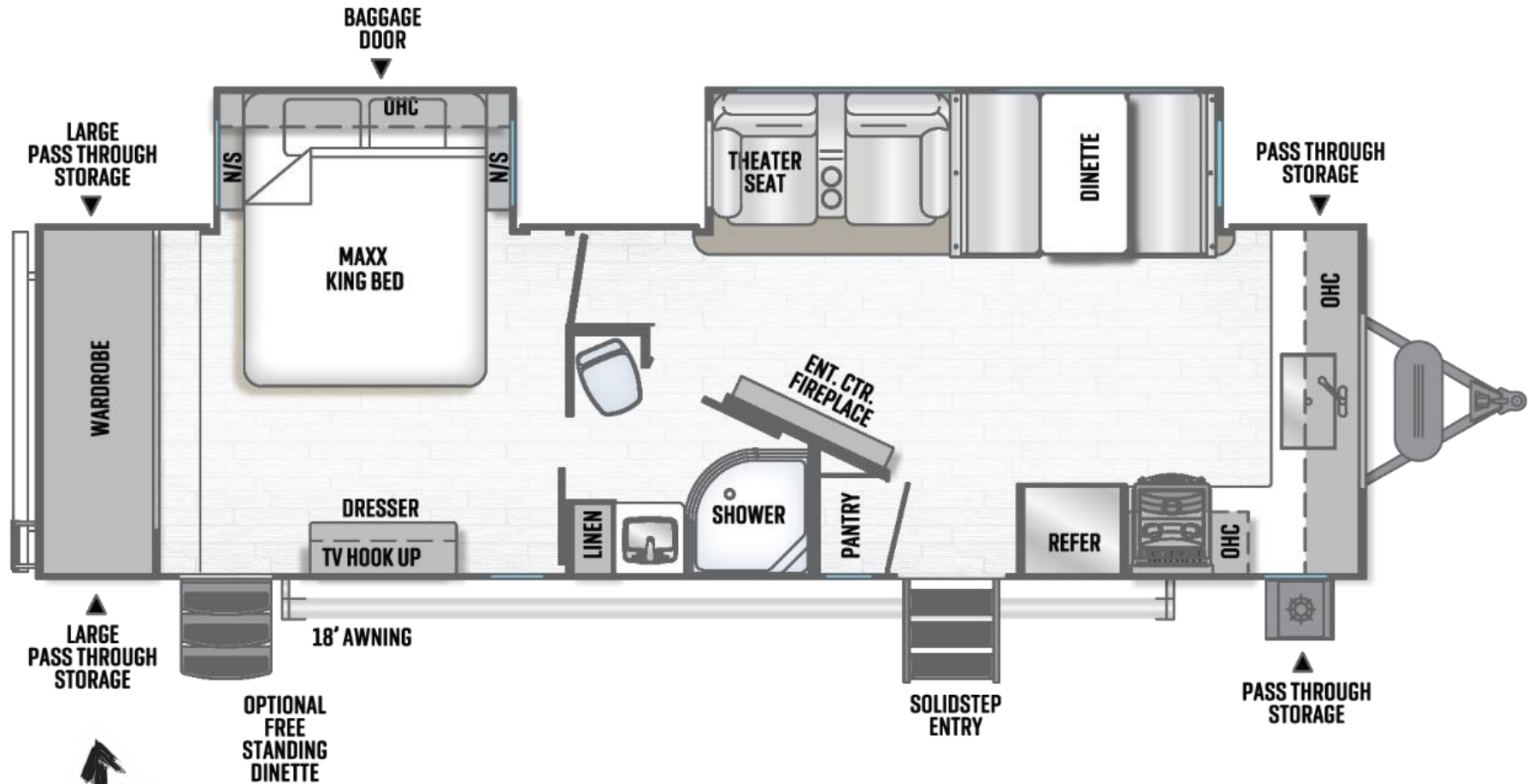

Hitch Weight (lb)	TBD	Exterior Width	96"
GVWR (lb)	TBD	Fresh Water (gal)	61
UVW (lb)	TBD	Gray Water (gal)	75*
CCC (lb)	TBD	Black Water (gal)	33
Exterior Length	33'7"	Awning Length	TBD
Exterior Height		Furnace (BTU)	35,000

\* 2 Tanks



WILDCAT

T276FKX  
Shown in  
Blonde Interior



# T282RKKX

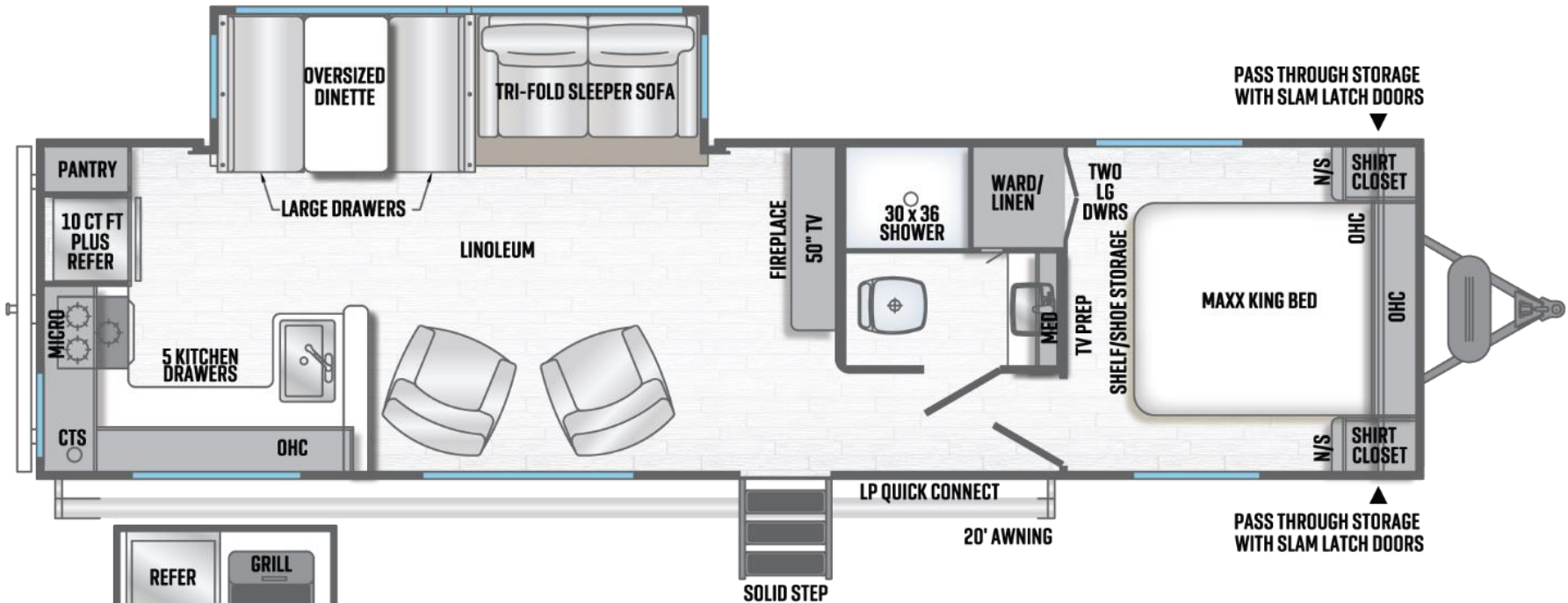
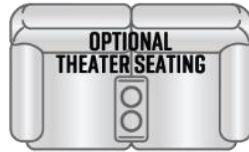

Hitch Weight (lb)	954	Exterior Width	96"
GVWR (lb)	9,754	Fresh Water (gal)	61
UVW (lb)	7,533	Gray Water (gal)	64*
CCC (lb)	2,221	Black Water (gal)	32
Exterior Length	34'6"	Awning Length	20'
Exterior Height		Furnace (BTU)	35,000

\* 2 Tanks







WILDCAT

T282RKX  
Shown in  
Blonde Interior



# T303MBX

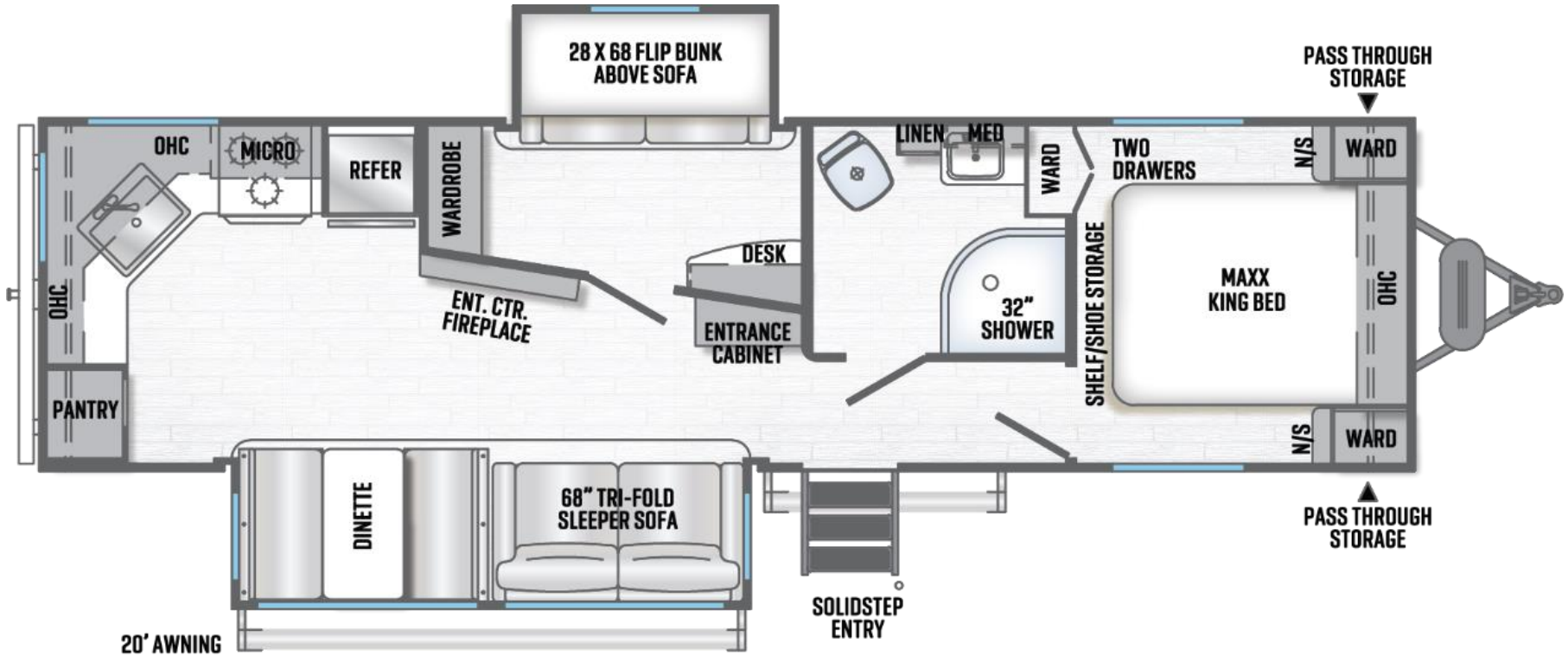

Hitch Weight (lb)	TBD	Exterior Width	96"
GVWR (lb)	TBD	Fresh Water (gal)	61
UVW (lb)	TBD	Gray Water (gal)	TBD
CCC (lb)	TBD	Black Water (gal)	TBD
Exterior Length	34'3"	Awning Length	TBD
Exterior Height		Furnace (BTU)	35,000

\* 2 Tanks



# T323TSX

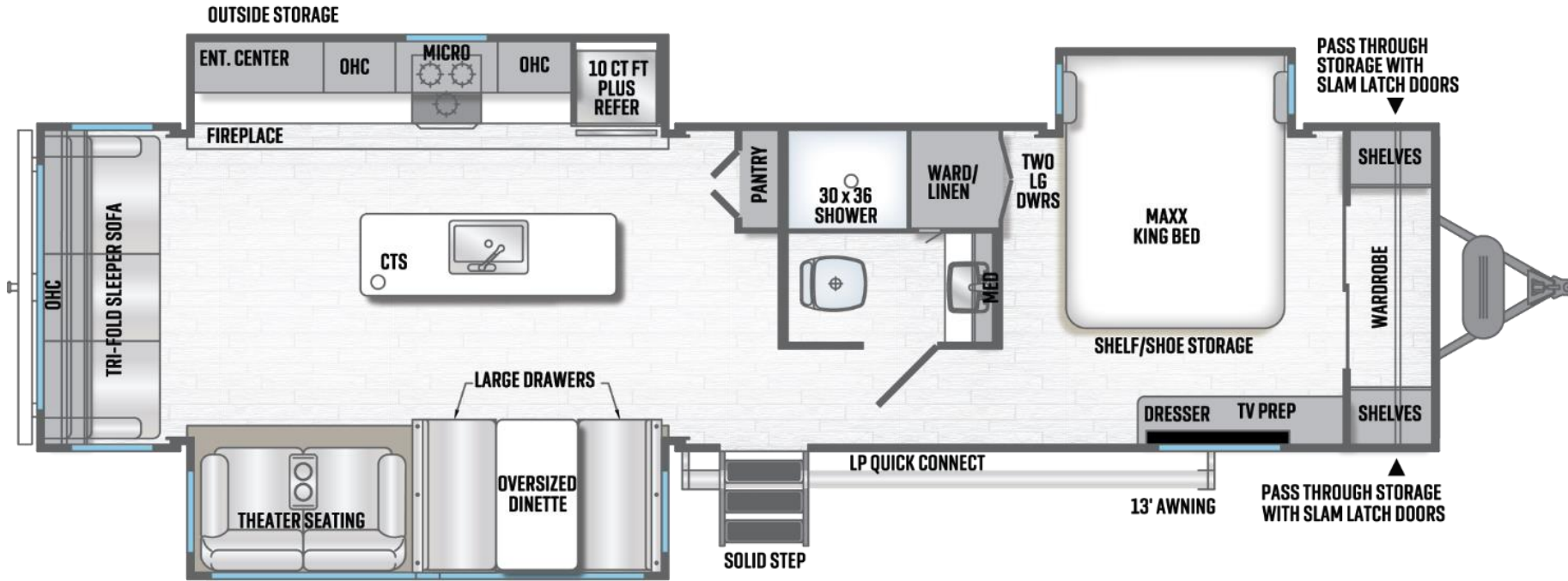

Hitch Weight (lb)	1,241	Exterior Width	96"
GVWR (lb)	11,441	Fresh Water (gal)	61
UVW (lb)	8,992	Gray Water (gal)	108*
CCC (lb)	2,449	Black Water (gal)	54
Exterior Length	37'11"	Awning Length	13'
Exterior Height		Furnace (BTU)	35,000

\* 2 Tanks