



Jay Flight SLX



Serial #: 1UJBC0BLXS7ZZ0124
Model: 210QBW JAY FLIGHT SLX TT

Model Year: 2025 Dealer Name: BLUE COMPASS RV
3197 WILLOW CREEK RD
PRESCOTT, AZ 86301
USA

Standard Equipment

THE FOLLOWING ITEMS ARE STANDARD ON THIS MODEL
AT NO EXTRA CHARGE

STANDARD EXTERIOR EQUIPMENT

- 30-amp service
- 8,000 BTU wall mount A/C (single axle models)
- Alles with electric, self-adjusting brakes and easy-lube hubs
- Exterior cable TV hookup
- Fully integrated A-frame
- Galvanized-steel, impact resistant wheel wells
- Large exterior downspouts
- LP quick connect (outside grill prep)
- Magnum Truss™ Roof System
- Nitrogen fied radial tires
- PVC roofing membrane (limited lifetime warranty)

STANDARD INTERIOR EQUIPMENT

- 300 lb. rated single bunk beds
- 600 lb. rated double bunk beds
- Digital TV antenna
- Heavy-duty, 75 lb., full-extension, steel ball-bearing drawer guides
- High rise kitchen faucet
- Marine-grade toilet with foot flush
- Plywood bed platforms
- Queen mattress
- Residential-style hidden cabinet door hinges
- Residential-style kitchen countertops
- Shower curtain with curved shower track (select models)
- Solid hardwood cabinet doors with screwed stile construction and hidden hinges
- Vinyl flooring throughout
- Wood-trimmed mirror in bathroom

CUSTOMER VALUE PACKAGE (MANDATORY)

- 8 cu. ft. 12V refrigerator
- AM/FM/Bluetooth® stereo
- Backup camera prep
- Bathroom skylight
- Bathroom vent
- Detachable power cord
- Entry door with window and shade prep
- Fitted bed sheet
- G20 dark tinted privacy windows
- Keyed-Alike™ entry and baggage doors
- Large folding entry door grab handle
- LED interior and exterior lights
- Marine grade exterior stereo speakers
- Microwave oven
- On-demand tankless water heater
- Power awning with LED lights
- Range hood
- Solid Step® entry steps
- Spare tire with cover
- Stabilizer jacks
- Tub/shower surround
- Window shades

Optional Equipment

OPTIONAL EQUIPMENT INSTALLED ON THIS VEHICLE
BY MANUFACTURER

Base price	27,908.00
USA STANDARDS	n/c
CUSTOMER VALUE PACKAGE	5,250.00
OVERLANDER SOLAR PACKAGE	593.00
13,500 BTU ROOF MOUNTED AC	n/c
METAL SIDEWALL	n/c
ENCLOSED UNDERBELLY	188.00
STANDARD RADIAL TIRES	n/c

UNIT TOTAL **33,937.00**

DEALER INSTALLED OPTIONS

Freight	2,165.80
TOTAL MSRP	36,102.80

Manufacturer's Suggested Retail Price \$33,937.00

TOTAL AMOUNT DOES NOT INCLUDE STATE AND LOCAL TAXES OR LICENSE FEES. THE PRICE SHOWN ABOVE MAY OR MAY NOT BE REPRESENTATIVE OF THE ACTUAL SELLING PRICE OF SIMILAR RECREATIONAL VEHICLES IN YOUR AREA.

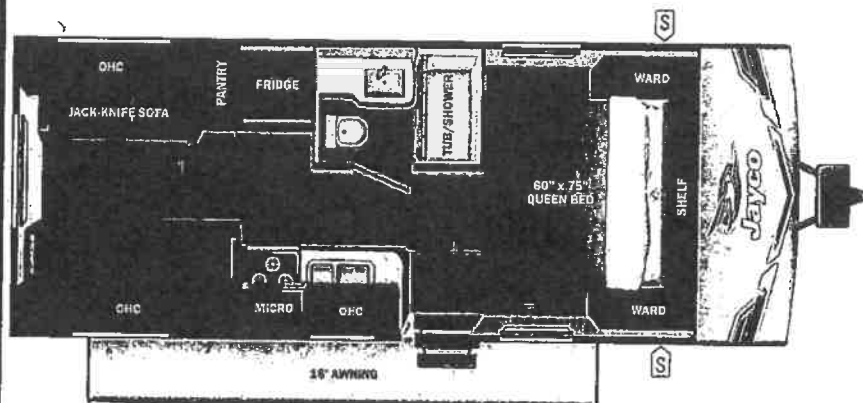

UVW

4323 lbs



Sleeps



Length

25' 7.75"

DIMENSIONS

Exterior height:	125.50"
Exterior width:	96.00"
WEIGHTS	
GVWR:	6000
GAWR (front):	3500
GAWR (rear):	3500
Approx. Gross Cargo Carrying Capacity (GCC):	1677

CAPACITIES

Fresh water tank (gals.):	84.00
Gray water tank (gals.):	40.00
Black water/toilet tank (gals.):	40.00
Propane (lbs.):	40
Propane (gals.):	9
Water heater (gals.):	0.25

TIRES

Tire size (front):	ST205/75R14D
Tire size (mid):	
Tire size (rear):	ST205/75R14D
Tire size (spare):	ST205/75R14D

SEATING & SLEEPING

Some dimensions may be rounded and may vary from the actual dimensions
Weights may be estimated calculations and may vary from the actual weight
- refer to the vehicle weight labels for actual weights***

Floorplans, features and specifications are subject to change without notice.



STOCK#: T95394
LICENSE FEE: 570.14