



# Jay Flight SLX



Serial #: 1UJBC0AK4S7ZC0364  
 Model: 175BHW JAY FLIGHT SLX TT

Model Year: 2025 Dealer Name: BLUE COMPASS RV  
 3197 WILLOW CREEK RD  
 PRESCOTT, AZ 86301  
 USA

## Standard Equipment

THE FOLLOWING ITEMS ARE STANDARD ON THIS MODEL AT NO EXTRA CHARGE

- STANDARD EXTERIOR EQUIPMENT**
- 30-amp service
  - 8,000 BTU wall mount A/C (single axle models)
  - Axles with electric, self-adjusting brakes and easy-lube hubs
  - Exterior cable TV hookup
  - Fully integrated A-frame
  - Galvanized-steel, impact resistant wheel wells
  - Large exterior downspouts
  - LP quick connect (outside grill prep)
  - Magnum Truss™ Roof System
  - Nitrogen filled radial tires
  - PVC roofing membrane (limited lifetime warranty)

- STANDARD INTERIOR EQUIPMENT**
- 300 lb. rated single bunk beds
  - 600 lb. rated double bunk beds
  - Digital TV antenna
  - Heavy-duty, 75 lb., full-extension, steel ball-bearing drawer guides
  - High rise kitchen faucet
  - Marine-grade toilet with foot flush
  - Plywood bed platforms
  - Queen mattress
  - Residential-style hidden cabinet door hinges
  - Residential-style kitchen countertops
  - Shower curtain with curved shower track (select models)
  - Solid hardwood cabinet doors with screwed stile construction and hidden hinges
  - Vinyl flooring throughout
  - Wood-trimmed mirror in bathroom

- CUSTOMER VALUE PACKAGE (MANDATORY)**
- 8 cu. ft. 12V refrigerator
  - AM/FM/Bluetooth stereo
  - Backup camera prep
  - Bathroom skylight
  - Bathroom vent
  - Detachable power cord
  - Entry door with window and shade prep
  - Fitted bed sheet
  - GGI dark tinted privacy windows
  - Keyed-Alike™ entry and baggage doors
  - Large locking entry door grab handle
  - LED interior and exterior lights
  - Marine grade exterior stereo speakers
  - Microwave oven
  - On-demand tankless water heater
  - Power awning with LED lights
  - Range hood
  - Solid Step® entry steps
  - Spare tire with cover
  - Stabilizer jacks
  - Tub/shower surround
  - Window shades

## Optional Equipment

OPTIONAL EQUIPMENT INSTALLED ON THIS VEHICLE BY MANUFACTURER

Base price	22,493.00
USA STANDARDS	n/c
CUSTOMER VALUE PACKAGE	5,250.00
BAJA EDITION	1,125.00
OVERLANDER SOLAR PACKAGE	593.00
13,500 BTU ROOF MOUNTED A/C	593.00
METAL SIDEWALL	n/c
STANDARD BAJA TIRES	n/c

UNIT TOTAL **30,054.00**

DEALER INSTALLED OPTIONS

Freight 1,624.35  
 TOTAL MSRP 31,678.35

## Manufacturer's Suggested Retail Price \$30,054.00

TOTAL AMOUNT DOES NOT INCLUDE STATE AND LOCAL TAXES OR LICENSE FEES. THE PRICE SHOWN ABOVE MAY OR MAY NOT BE REPRESENTATIVE OF THE ACTUAL SELLING PRICE OF SIMILAR RECREATIONAL VEHICLES IN YOUR AREA.

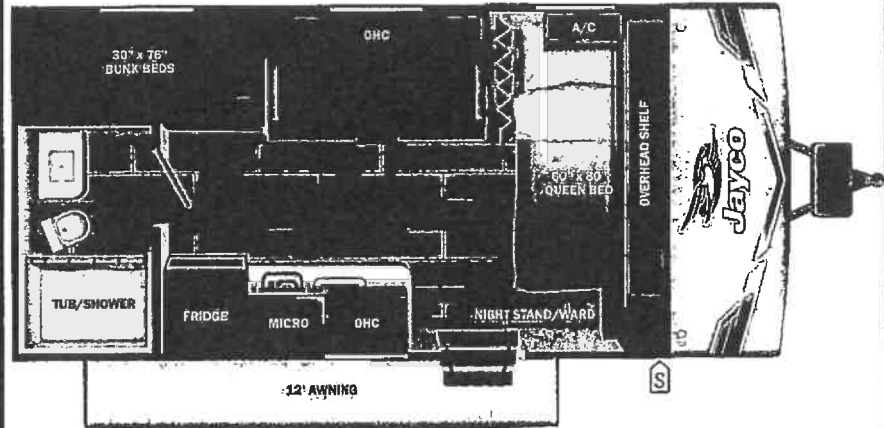

**UVW** 3445 lbs **Sleeps** 4 **Length** 22' 1"

### DIMENSIONS

Exterior height: 124.75"  
 Exterior width: 96.00"

### WEIGHTS

GVWR: 4600  
 GVWR (front): 4400  
 GVWR (rear): 0  
 Approx. Gross Cargo Carrying Capacity (GCCC): 1155

### TIRES

Tire size (front): LT225/75R16  
 Tire size (mid):  
 Tire size (rear):  
 Tire size (spare): LT225/75R16

### CAPACITIES

Fresh water tank (gals.): 30.00  
 Gray water tank (gals.): 19.90  
 Black water/toilet tank (gals.): 19.90  
 Propane (lbs.): 30  
 Propane (gals.): 7  
 Water heater (gals.): 0.25

### SEATING & SLEEPING



\*\*\*Some dimensions may be rounded and may vary from the actual dimensions\*\*\*  
 \*\*\*Weights may be estimated calculations and may vary from the actual weight - refer to the vehicle weight labels for actual weights\*\*\*

STOCK#: T95303  
 LICENSE FEE: 504.90