



Jay Feather



Serial #: 1UJBB0BS7S1JR0085
Model: 29QBH JAY FEATHER TT

Model Year: 2025 Dealer Name: BLUE COMPASS RV
3197 WILLOW CREEK RD
PRESCOTT, AZ 86301
USA

Standard Equipment

Optional Equipment

THE FOLLOWING ITEMS ARE STANDARD ON THIS MODEL AT NO EXTRA CHARGE

OPTIONAL EQUIPMENT INSTALLED ON THIS VEHICLE BY MANUFACTURER

STANDARD EXTERIOR EQUIPMENT

- 1.5 in. fresh water drain valve
- 18 in. rear roof ladder - factory installed
- 2 in. Stronghold VBL™ floor with 2 lb. density foam
- Stronghold VBL™ walls with double-sided Azdel composite (sidewalls, rear walls and slide out bases)
- Aerodynamic, rounded front profile with aluminum framing
- American-made Norco Z-frame with integrated A-frame
- Automotive-style aluminum rims
- Battery quick-disconnect
- Dark-tinted safety-glass windows
- Exterior TV bracket with 120V and cable hook-ups
- Front diamond plating with Azdel backing
- Front molded decorative cap (select models)
- Galvanized steel and impact resistant wheel wells
- Keyed-Alike™ locking system
- Magnum Tuss™ Roof System
- Marine grade exterior speakers
- Outdoor camp kitchen with galvanized steel bases (select models)
- PVC roofing membrane (limited lifetime warranty)
- Swing-out entry door assist handle

JAY SPORT PACKAGE (MANDATORY)

- 11 cu. ft. 12V fridge
- App monitored TPMS
- Climate Shield (zero to 100 degree tested weather insulation package)
- Front start-latch baggage doors
- Invision appliance package
- LCI Solid Step fold-down aluminum tread steps on main entry door
- LED smart TV
- MAXXAIR® power roof vent (main living area)
- Modern graphics package with dual-colored sidewall
- Overlander 1 Solar Package: (1) 200W solar panel and 30-amp digital controller
- Porcelain look-finish toilet
- Stainless steel kitchen & bathroom sink

STANDARD INTERIOR EQUIPMENT

- 4 in. high-density dinette cushions with vinyl backing
- 4 in. soft-touch bunk mats (select models)
- 60 x 80 in. residential queen beds (60 x 76 in. in Murphy bed models)
- 76 lb. full extension drawer guides
- Bathroom skylight
- Decorative backplash
- Decorative roller shades with reflective barrier
- Directional and closable A/C vents
- Gas-strutted under bed storage (most models)
- Handcrafted, hardwood door/drawer fronts
- Hidden-hinged cabinet doors
- High output auto-ignition LP gas furnace
- LED lighting throughout
- Plywood dinette, bed, bunk and shower/tub bases
- Powered roof vents in bathroom and main bedroom (most models)
- Residential style seamless countertops throughout
- Residential vinyl flooring throughout
- Screwed and glued cabinet stile
- USB charging ports (multiple locations throughout)

CUSTOMER VALUE PACKAGE (MANDATORY)

- American-made nitro-filled Goodyear® radial tires with self-adjusting electric brakes
- 13,500 BTU roof-mounted AC
- 20 lb. LP gas bottles with auto-regulator and ABS cover
- 65 gal. fresh water tank
- Automotive-style aluminum rims
- Black tank flush
- Detachable power cord
- Inverter pre-wire (2 bedroom nightstand outlets, main TV and outlet for outside kitchen fridge)
- Max-length power wiring with LED light
- On-demand 60,000 BTU water heater
- Power tongue jack
- Rear 2 in. receiver
- Rock Solid Stabilizer System
- Side and rear back-up camera prep
- Under-mount spare tire

Base price	53,993.00
USA STANDARDS	n/c
CUSTOMER VALUE PACKAGE	6,000.00
JAY SPORT PACKAGE	3,750.00
OVERLANDER 1 SOLAR PACKAGE	n/c
JAYCOMMAND CONTROL SYSTEM W/TPMS	743.00
15,000 BTU AC 2ND AC	300.00
FIREPLACE	893.00
30W LP GAS BOTTLES	443.00
THEATER SEATING/W/TABLE TRAYS	113.00
DINETTE	593.00
QUEEN BED	n/c
	n/c

UNIT TOTAL 66,828.00

DEALER INSTALLED OPTIONS

FREIGHT	4,802.20
TOTAL MSRP	71,630.20

Manufacturer's Suggested Retail Price \$66,828.00

TOTAL AMOUNT DOES NOT INCLUDE STATE AND LOCAL TAXES OR LICENSE FEES. THE PRICE SHOWN ABOVE MAY OR MAY NOT BE REPRESENTATIVE OF THE ACTUAL SELLING PRICE OF SIMILAR RECREATIONAL VEHICLES IN YOUR AREA.

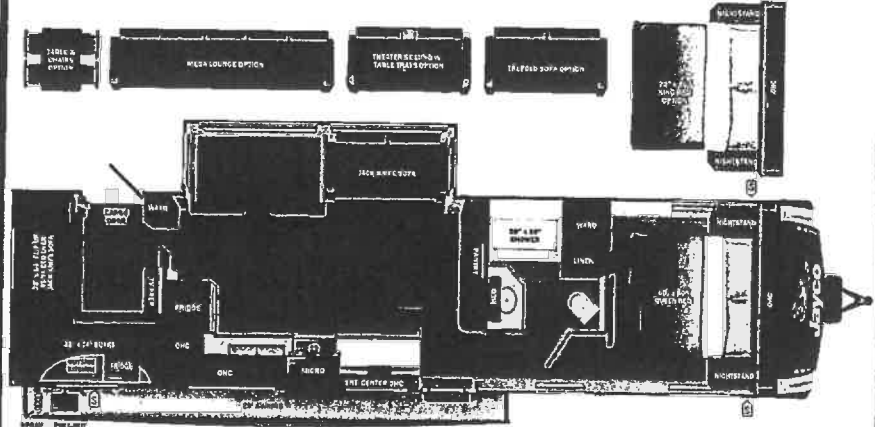

UVW
7656 lbs

Sleeps

Length
35' 6.5"

DIMENSIONS

Exterior height:	131.63"
Exterior width:	96.00"
WEIGHTS	
GVWR:	8850
GAWR (front):	4400
GAWR (rear):	4400
Approx. Gross Cargo Carrying Capacity (GCCO):	1194

CAPACITIES

Fresh water tank (gals.):	55.00
Gray water tank (gals.):	61.00
Black water/toilet tank (gals.):	30.50
Propane (lbs.):	60
Propane (gals.):	14
Water heater (gals.):	0.25

SEATING & SLEEPING

TIRES

Tire size (front):	ST225/75R15E
Tire size (mid):	
Tire size (rear):	ST225/75R15E
Tire size (spare):	ST225/75R15E

Some dimensions may be rounded and may vary from the actual dimensions
Weights may be estimated calculations and may vary from the actual weight - refer to the vehicle weight labels for actual weights
Dimensions, features and specifications are subject to change without notice.



STOCK#: T93674
LICENSE FEE: 1122.71