



Pinnacle



Serial #: 1UJCF0BV8S1RL0066
Model: 36FBTS PINNACLE FW

Model Year: 2025 Dealer Name: AFFINITY RV
3197 WILLOW CREEK RD
PRESCOTT, AZ 86301
USA

Standard Equipment

THE FOLLOWING ITEMS ARE STANDARD ON THIS MODEL AT NO EXTRA CHARGE

- STANDARD EXTERIOR EQUIPMENT**
- (3) 40 lb. LP propane bottles with auto regulator (120 lb. max LP system)
 - 102 in. widebody construction
 - 12 in. structural steel I-beam with 10 in. drop frame
 - 120V heat blankets on all tanks plus 12V heat tape on fresh water line
 - 3,000 lb. low hitch with 4-way pin
 - Battery disconnect
 - Built in sewer hose carrier
 - Climate Shield™ zero-degree tested:
 - 40,000 BTU outdoor furnace
 - Double layer fiberglass ball insulation (roof/floor)
 - Fully enclosed and heated underbody (cruiser)
 - PEX plumbing, 2 in. block learn and reflective foil
 - Custom automotive grade vinyl exterior graphics
 - Digital TV antenna with 6G Wi-Fi extender
 - Exterior marine grade speakers with Bluetooth® controller
 - Frameless dark tinted safety-glass windows
 - Fully enclosed, universal docking center:
 - Black tank flush
 - Independent satellite wiring
 - Quick-connect outside shower
 - Whole coach cable hookups
 - Whole coach cable hookups
 - Winterization and sanitation hookups
 - JAYSMART™ (Gateway Markers And Reverse Travel) LED lighting (optional)
 - Magnum Truss™ XL6™ Roof System (strongest tested roof in the industry) with Alpha roof membrane system with limited lifetime warranty
 - Painted fiberglass front and rear cap with clear coat
 - Pass-through storage, Slim-latch™ baggage doors
 - Skirt metal enclosed dump frame
 - Stronghold VUL™ aluminum framed and vacuum bond laminated gel coated fiberglass exterior walls (including slide room end walls)
 - Under-mounted spare tire
 - Water heater bypass
- LUXURY PACKAGE (MANDATORY)**
- 2nd electric patio awning with integrated RGB LED lights (multi-colored with remote control)
 - 32 in. 4K outside Smart LED TV
 - 32 in. 4K Smart LED bedroom TV
 - 8-point hydraulic auto-leveling system
 - Cellular prep for 5G Wi-Fi antenna
 - Central vacuum system with dust port
 - Day/night roller shades in living room
 - Frameless dark tinted safety-glass windows
 - Free-standing roll top (no pedestal) table
 - GE 21 cu. ft. residential refrigerator, 1800W Inverter Profile Series 30 in. residential convection microwave with built in air fryer
 - GE Profile Series residential 24 in. range
 - JAYCOMMAND® Smart RV System
 - LED fireplace with electric space heater
 - MORhyde® Step-Away™ entrance steps
 - Oversized multi-battery compartment (industry leading room for 4-6 batteries)
 - Powered 50-amp cord reel
 - Residential grade surface kitchen countertop
 - Residential walk-in shower with shampoo/sap holder, leak seal and shower tower
 - Under-sink dishwasher
 - Washer/dryer prep
 - Pull out "Roll Top" dinette with two free standing chairs and two locking stools
 - Residential NuVo H2O whole coach water treatment with water softening system and triple cartridge filters

- STANDARD INTERIOR EQUIPMENT**
- 12V charging station
 - 5/8 in. tongue-and-groove joined plywood floor and 3/8 in. plywood roof decking
 - Bathroom skylight
 - Built in spice rack in kitchen cabinet (select models)
 - Built-in laundry hamper in wardrobe (select models)
 - Custom monoxide and LP detector
 - Cedar-lined front wardrobe closet
 - Ceiling fan (select models)
 - CAF crapped bedroom
 - Extra 120V power outlets in kitchen and slide room
 - Flip-up countertop extension/bar top (select models)
 - Flip-up hidden storage in bedroom chest of drawers (n/a 36FLDS)
 - Flip-up table top storage next to tri-fold sofa (select models)
 - Gas situated under-bed storage
 - Handcrafted hardwood glazed doors, sites, and drawers
 - Hidden hinges, magnet latches and soft close cabinet doors and drawers
 - Integrated under-mount sink and lever faucet in main bath
 - JayVox™ voice command system - controls lighting, A/C
 - LED accent lighting above slideouts
 - LED backlit custom framed mirror and medicine cabinet (most models)
 - LED interior lighting throughout
 - No in floor heat ducts throughout coach
 - Pantry with adjustable shelves and pull out drawers includes 120V outlet (most models)
 - Porcelain toilet with foot flush
 - Removable tray tables at theater seats
 - Residential "Do it all" sink with pull-out kitchen faucet, glass fins, and vegetable rinse
 - Residential dove lat jointed drawers throughout
 - Residential quilted bedspread and pillows
 - Shoe garage in hallway step (select models)
 - Soft close, heavy-duty, 75 lb. full extension, steel ball-bearing drawer guides
 - Solid hardwood wide fascia
 - Splash protected fabric on all luminaires
 - Toe kick nightlights in bedroom, bathroom and kitchen
 - Tri-fold hide-a-bed sofa with sleep surface (select models)
 - Vinyl flooring (made in the USA) throughout including slide rooms
- CUSTOMER VALUE PACKAGE (MANDATORY)**
- 15,000 BTU "Whisper Quiet" A/C (bedroom)
 - 15,000 BTU "Whisper Quiet" A/C with heat pump (main)
 - 18 gal. gas/electric DSI water heater
 - 50 in. 4K SMART LED HD TV with fully digital HDMI® output and two additional HDMI® cables
 - Backup main entrance door and slide observation security camera prep (includes a power switch in the bedroom to use the optional 7 in. monitor for security)
 - Custom machined aluminum rims
 - Electric patio awning with integrated RGB LED lights (multi-colored with remote control)
 - Hidden hinges, magnet latches, and soft close cabinet doors
 - JBL® home entertainment system with sound bar and wireless subwoofer
 - Keyed-Alike™ lock system (single key for all doors/locks)
 - MORhyde Safe-T-Fall grab handle
 - Residential King (72 in. x 80 in.) mattress with under-bed storage
 - Rooftop and ground solar prep
 - Wireless remote control system (includes Bluetooth® wireless interior controls)
- 5 STAR HANDLING PACKAGE (MANDATORY)**
- 17.5 in. 16 ply "H" rated Uniroyal tires
 - Daxter® Axles with ABS and Tow Assist - includes New® Adjust-A-Break and E-Z Lube® hubs
 - MORhyde® LRE-4000™ rubberized suspension
 - MORhyde® rubber pin box

Optional Equipment

OPTIONAL EQUIPMENT INSTALLED ON THIS VEHICLE BY MANUFACTURER

Base price	123,975.00
VINTAGE FARMHOUSE GRAPHICS	n/c
USA STANDARDS CUSTOMER VALUE PACKAGE	n/c
PINNACLE LUXURY PACKAGE	4,500.00
FIVE STAR HANDLING PACKAGE	12,450.00
OVERLANDER II SOLAR PACKAGE	5,993.00
3RD AC 15,000 BTU IN LIVING ROOM	1,943.00
21 CU. FT. RESIDENTIAL REFRIGERATOR WITH INVERTER GENERATOR LP PREP GAS/ELECTRIC DSI WATER HEATER	743.00
SANICOM DUMP SYSTEM BACKUP SIDE AND ENTRY DOOR OBSERVATION CAMERA PREP	n/c
TINTED SAFETY GLASS WINDOWS	n/c
SLIDEOUT AWNING(S)	860.00
ELECTRONIC DRUM BRAKES	n/c
KING BED	n/c

UNIT TOTAL **152,282.00**

DEALER INSTALLED OPTIONS:

FREIGHT	4,986.90
TOTAL MSRP	157,268.90

Manufacturer's Suggested Retail Price \$152,282.00

TOTAL AMOUNT DOES NOT INCLUDE STATE AND LOCAL TAXES OR LICENSE FEES. THE PRICES SHOWN ABOVE MAY OR MAY NOT BE REPRESENTATIVE OF THE ACTUAL SELLING PRICE OF SIMILAR RECREATIONAL VEHICLES IN YOUR AREA.

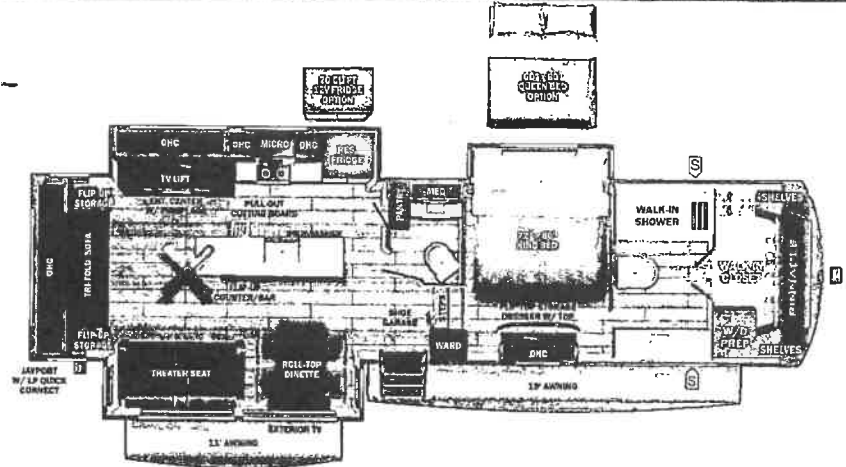

UWV 14843 lbs **Sleeps** 40' 6.25"

DIMENSIONS

Exterior height: 159.50"

Exterior width: 102.00"

WEIGHTS

GVMR: 17500

CAMR (front): 8000

CAMR (rear): 8000

Approx. Gross Cargo Carrying Capacity (GCC): 2657

TIRES

Tire size (front): 215/75R17.5H

Tire size (mid):

Tire size (rear): 215/75R17.5H

Tire size (spare): 215/75R17.5J

CAPACITIES

Fresh water tank (gals.): 75.00

Gray water tank (gals.): 87.00

Black water/toilet tank (gals.): 87.00

Propane (lbs.): 120

Propane (gals.): 28

Water heater (gals.): 16.00

SEATING & SLEEPING



Some dimensions may be rounded and may vary from the actual dimensions
Weights may be estimated calculations and may vary from the actual weight - refer to the vehicle weight labels for actual weights
Floorplans, features and specifications are subject to change without notice.

STOCK#: T93197
LICENSE FEE: 2558.33