



White Hawk



Serial #: 1UJBK0BR9R14G0131
Model: 27RK WHITE HAWK TT

Model Year: 2024 Dealer Name: AFFINITY RV
3197 WILLOW CREEK RD
PRESCOTT, AZ 86301
USA

Manufacturer's Suggested Retail Price \$67,683.00

TOTAL AMOUNT DOES NOT INCLUDE STATE AND LOCAL TAXES OR LICENSE FEES. THE PRICES SHOWN ABOVE MAY VARY NEARLY BE REPRESENTATIVE OF THE ACTUAL SELLING PRICE OF SIMILAR RECREATION VEHICLES IN YOUR AREA.

Standard Equipment

Optional Equipment

THE FOLLOWING ITEMS ARE STANDARD ON THIS MODEL AT NO EXTRA CHARGE

OPTIONAL EQUIPMENT INSTALLED ON THIS VEHICLE BY MANUFACTURER

EXTERIOR
- Aerodynamic, rounded front profile with aluminum framing
- Stronghold VBL™ walls with double-sided Azdel composite (side walls, rear walls and slide out boxes)
- Magnum Truss™ Roof System
- American-made frame with integrated A-frame
- Swing-out entry door assist handle
- Exterior TV bracket with 120V and cable hook-ups
- Outdoor camp kitchen with galvanized steel bases (select models)
- Stern latches on front pass-through storage doors
- Marine grade exterior speakers with blue LED accent lighting
- Galvanized steel and impact-resistant wheel wells
- 30-amp service
- Rock Solid Stabilizer System
- Mounted camera bracket for pre-wired slide and rear backup prep
- Key-Start™ lock system
- Detachable power cord
- Battery quick disconnect
- Black tank flush
- Automotive-style aluminum rims
- Spare tire with cover
- Inverter pre-wire (2 bedroom nightstand outlets, main TV and outlet for outside kitchen fridge)
- 1.5 in. fresh water drain valve
- 2 in. Stronghold VBL™ floor with 2 lb. density foam
- Factory installed rear roof ladder
- Modern graphics package with dual-colored sidewall
- Outside shower (only on models without outside camp kitchen)
- PVC roofing membrane (limited lifetime warranty)

LUXURY PACKAGE (Mandatory)
- Climate Shield™ 0-100° tested weather insulation package
- Front rooled fiberglass cap with automotive-style windshield and blue LED accent light strips
- Dark lined, frameless safety glass windows
- LCI Solid Step fold-down aluminum tread steps on main entry door

Overlander 1 Solar Package: (1) 200W solar panel and 30-amp digital controller
- Kitchen skylight with shade
- MAXCARE® power roof vent (main living area)
- Dual-hinge 10 cu. ft. 12V fridge

INTERIOR
- Banded interior ceiling up to 81 in. of interior height
- LED lighting throughout
- Electric fireplace
- Directional and closable A/C vents
- Plywood dinette, bed, bunk and show/shut bases
- Residential vinyl flooring throughout
- High output auto-ignition LP gas furnace
- Handcrafted, hardwood door/drawer fronts
- Decorative backsplash
- 78 lb. full extension drawer guides
- 80 in. x 80 in. queen bed (80 in. x 76 in. in Murphy bed models)
- 4 in. Teddy Bear soft-touch bunk mats (select models)
- Powered roof vents in bathroom and main bedroom (most models)
- Decorative roller shades with reflective backing
- 4 in. high-density dinette cushions with vinyl backing
- Bathroom skylight
- Gas-situated under bed storage (most models)
- Hidden-hinged cabinet doors
- Residential style kitchen countertops
- Screwed and glued cabinet sides
- USB charging ports (multiple locations throughout)

CUSTOMER VALUE PACKAGE (Mandatory)
- American-made nitro-filled Goodyear® radial tires with self-adjusting brakes (made in the USA)
- On-demand 60,000 BTU water heater
- 65 gal. fresh water tank
- 30 lb. LP gas bottles with auto-regulator and ABS cover
- Power tongue jack
- 39 or 50 in. Smart LED TV
- 15,000 BTU roof-mounted A/C
- AM/FM/Bluetooth® stereo with roof-mounted speakers
- Oven with 3-burner recessed cooktop with glass cover
- Microwave
- Porcelain foot flush toilet
- Showers with solid glass enclosures
- Bathroom skylight
- Max-length power awning with LED light

Base price	55,710.00
USA STANDARDS	n/c
CUSTOMER VALUE PACKAGE	6,000.00
LUXURY PACKAGE	3,000.00
OVERLANDER 1 SOLAR PACKAGE	n/c
JAYCOMMAND CONTROL SYSTEM W/TPMS	593.00
NO 2ND AC	n/c
50 AMP SERVICE	353.00
FIREPLACE	443.00
ELECTRIC STABILIZER JACKS	638.00
ROOF LADDER (STD)	n/c
HEATED TANK PAD	338.00
THEATER SEATING W/TABLE TRAYS	495.00
DINETTE	n/c
KING BED	113.00

UNIT TOTAL	67,683.00
DEALER INSTALLED OPTIONS	
FREIGHT/PREP	5,277.20
TOTAL MSRP	72,960.20

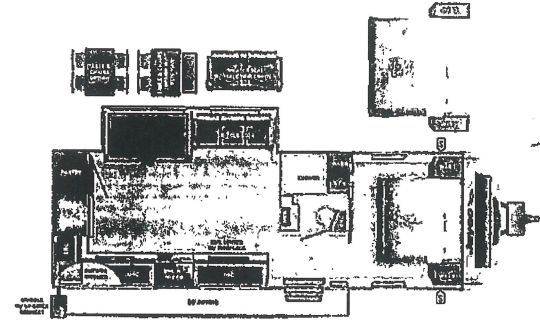

UWV 6870 lbs
Sleeps 4
Length 32' 10"

DIMENSIONS		CAPACITIES	
Exterior height:	135.00"	Fresh water tank (gals.):	55.00
Exterior width:	95.50"	Gray water tank (gals.):	61.00
WEIGHTS		Black water/toilet tank (gals.):	30.50
GVWR:	8000	Propane (lbs.):	60
GAWR (front):	4400	Propane (gals.):	14
GAWR (rear):	4400	Water heater (gals.):	0.25
Approx. Gross Cargo Carrying Capacity (GCCC):	1130	SEATING & SLEEPING	
TIRES			
Tire size (front):	ST225/75R15E		
Tire size (mid):			
Tire size (rear):	ST225/75R15E		
Tire size (spare):	ST225/75R15E		

Some dimensions may be rounded and may vary from the actual dimensions
Weights may be estimated calculations and may vary from the actual weight - refer to the vehicle weight labels for actual weights
Floorplans, features and specifications are subject to change without notice.



STOCK#: 10G0131
LICENSE FEE: 9,359.00