



Jay Flight



Serial #: 1UJBC0BL6R75Z0216
Model: 212QBW JAY FLIGHT TT

Model Year: 2024 Dealer Name: AFFINITY RV
3197 WILLOW CREEK RD
PRESCOTT, AZ 86301
USA

Manufacturer's Suggested Retail Price \$42,261.00

TOTAL AMOUNT DOES NOT INCLUDE STATE AND LOCAL TAXES OR LICENSE FEES; THE PRICES SHOWN ABOVE MAY OR MAY NOT BE REPRESENTATIVE OF THE ACTUAL SELLING PRICE OF SIMILAR RECREATIONAL VEHICLES IN YOUR AREA.

Standard Equipment

THE FOLLOWING ITEMS ARE STANDARD ON THIS MODEL AT NO EXTRA CHARGE

- EXTERIOR**
- 20 lb. LP Bottles with Cover (2)
 - Enclosed and heated underbelly
 - Axles with electric, self-adjusting brakes and easy-tube hubs
 - 1-Case™ cambered structural steel I-beams
 - Fully integrated Avrame
 - 5/8 in. tongue-and-groove plywood floor decking
 - Magnum Truss™ Roof system with plywood decking
 - PVC roofing membrane (limited lifetime warranty)
 - Large exterior downspouts
 - Galvanized steel, impact-resistant wheel wells
 - 30-amp service
 - Exterior TV mount and bracket
 - LP quick connect (outside gas grill prep)

- INTERIOR**
- 81 in. ceiling height
 - Shower/hub surround
 - Solid hardwood cabinet doors
 - J-Steel™ jackknife sofa with armrest & cup holders (most models)
 - Vinyl flooring throughout (including slide floors)
 - Window shades
 - Residential-style kitchen countertops
 - Heavy-duty, 75 lb., full-extension, steel ball-bearing drawer guides
 - USB charging station
 - Queen mattress
 - Plywood bed platforms
 - Main bed stairs
 - 300 lb. rated bunk beds (select models)
 - 600 lb. rated bunk beds (double bunks)
 - Privacy curtains in bunk areas (select models)
 - Vented bunk windows (select models)
 - 4 in. thick bunk mats (select models)
 - Wooden bedroom doors (select models)
 - Shower curtain with curved shower track (select models)

- CUSTOMER VALUE PACKAGE (Mandatory)**
- Goodyear® Encore® tires (made in the USA)
 - On-demand tankless water heater
 - Keyed-Alpha™ entry and baggage doors
 - Outside shower
 - Power awning with LED lights
 - Marine-grade exterior speakers
 - Black tank flush
 - Spare tire with cover
 - Rock Solid stabilizer system
 - Overlander 1 Solar Package: (1) 200W solar panel and 30-amp digital controller
 - Large main entry door grab handle
 - Power tongue jack
 - Range hood
 - Oven with 3-burner recessed cooktop with glass cover
 - Microwave oven
 - Fitted bed sheet
 - Bathroom skylight
 - Sink cover
 - Bathroom medicine cabinet
 - Solid Step® entry steps (N/A 380DCS)
 - 13.5K BTU AC
 - AM/FM/Bluetooth® stereo
 - Backup and side view camera prep
 - Bathroom power vent
 - Detachable power cord
 - G20 dark tinted privacy windows
 - Inverter pre-wire
 - Flexion hinge entry door with window and shade prep
 - LED exterior and interior lights
 - One-piece front fiberglass exterior wall
 - Seamless countertops

Optional Equipment

OPTIONAL EQUIPMENT INSTALLED ON THIS VEHICLE BY MANUFACTURER

Base price	34,100.00
USA STANDARDS	n/c
CUSTOMER VALUE PACKAGE	5,250.00
BAJA EDITION	2,188.00
16,000 BTU AC	300.00
24" LED SMART TV	443.00
METAL SIDEWALL	n/c
ROOF LADDER (STD)	n/c

UNIT TOTAL 42,261.00

DEALER INSTALLED OPTIONS

FREIGHT /PREP	2,640.80
TOTAL MSRP	44,901.80

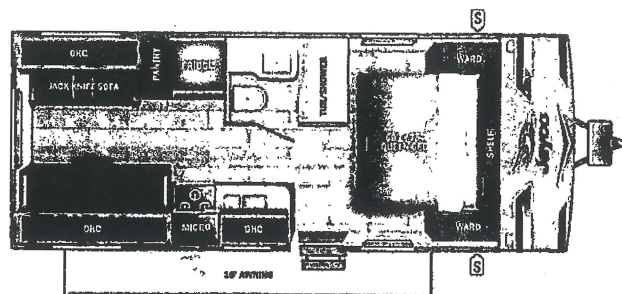

UVW
4613 lbs

Sleeps

Length
25' 8"

DIMENSIONS

Exterior height:	132.00"
Exterior width:	96.00"
WEIGHTS	
GVWR:	6000
GAWR (front):	3500
GAWR (rear):	3500
Approx. Gross Cargo Carrying Capacity (GCCC):	1387

CAPACITIES

Fresh water tank (gals.):	84.00
Gray water tank (gals.):	39.00
Black water/toilet tank (gals.):	32.50
Propane (lbs.):	60
Propane (gals.):	14
Water heater (gals.):	0.00

SEATING & SLEEPING

TIRES

Tire size (front):	LT225/75R16E
Tire size (mid):	
Tire size (rear):	LT225/75R16E
Tire size (spare):	LT225/75R16E

Some dimensions may be rounded and may vary from the actual dimensions
Weights may be estimated calculations and may vary from the actual weight - refer to the vehicle weight labels for actual weights
Floorplans, features and specifications are subject to change without notice.



STOCK#: 1020216
LICENSE FEE: 572.88