



Swift LI



Serial #: 1UJPJBBJ9R1WD4052
 Model: 20DL SWIFT LI MHB
 VIN#: 3C6MRVUG9PE526504
 Model Year: 2024 Dealer Name: AFFINITY RV

3197 WILLOW CREEK RD
 PRESCOTT, AZ 86301
 USA

Manufacturer's Suggested Retail Price \$224,444.00

TOTAL AMOUNT DOES NOT INCLUDE STATE AND LOCAL TAXES OR LICENSE FEES. THE PRICE SHOWN ABOVE MAY OR MAY NOT BE REPRESENTATIVE OF THE ACTUAL SELLING PRICE OF SIMILAR RECREATIONAL VEHICLES IN YOUR AREA.

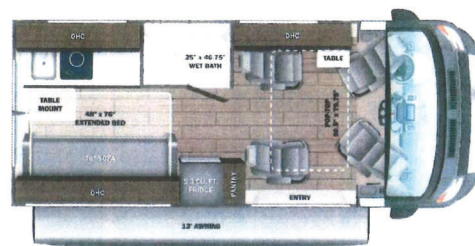

Standard Equipment

Optional Equipment

THE FOLLOWING ITEMS ARE STANDARD ON THIS MODEL AT NO EXTRA CHARGE

OPTIONAL EQUIPMENT INSTALLED ON THIS VEHICLE BY MANUFACTURER

- STANDARD EXTERIOR EQUIPMENT**
- RAMP ProMaster 3500 window van
 - GWRW 9,350 lb
 - GCVW 11,500 lb
 - 3.0L V6 20V VVT 276HP engine with 250 ft. lb. torque
 - 9-speed automatic 948TE transmission
 - 180-amp alternator
 - L7225/75R18E tires
 - Aluminum wheels
 - 3,500 lb. rear hitch receiver with dual 4/7 pin connector
 - 12V chassis battery
 - 24 gal. fuel tank (gas)
 - LED interior lighting for cab and entry doors
 - Chrome grille package
 - Daytime running headlights
 - Cable TV hookup with RG-6 coax
 - 49V 210 amp hour smart lithium battery providing 10KW hours of power
 - Auto engine start with high idle
 - 200W roof-mounted GoPower® solar panel with integrated control panel
 - Trickle charge solar panel for chassis battery
 - Portable solar plug
 - 3,500W inverter
 - 2nd 48V alternator dedicated to lithium battery
 - House battery disconnect switch
 - 30-amp electrical service with detachable power cord
 - (2) 120V exterior outlets
 - 6 gal. propane tank (50 lb.)
 - LF quick-connect hookup
 - Heated holding tanks (12V pads)
 - LED lighting tank valves
 - Black tank flush
 - Driveway water lift (201L)
 - Waterization drain system
 - 12V demand water pump
 - Water filtration system
 - Outside shower
- CUSTOMER VALUE PACKAGE**
- Black® Heavy helper springs, premium heavy-duty suspension
 - Thule® antenna patio awning with LED light strip
 - Thule® roof rack (20AL, 20TL)
 - Timberline hydronic heating system
 - Swivel driver and passenger seats with 6-way lumbar adjustment
 - Wi-Fi Connect 2.0 4G-Wi-Fi/Digital TV antenna

- STANDARD INTERIOR EQUIPMENT**
- Locksmith 3.0 infotainment center with Apple CarPlay® and Android Auto™
 - Leather-wrapped steering wheel with integrated controls
 - Power fudge/heated side-view mirrors
 - ParkView® rear backup camera with dynamic guidelines
 - Blind spot monitoring with rear cross-path detection
 - LaneSense® lane departure warning with lane keep assist
 - Forward collision warning with active braking
 - Control Blade®
 - Electronic stability control
 - Prediction/Adaptive emergency braking
 - Traffic sign information
 - Drowsy driver detection
 - Rain-sensitive windshield wipers
 - Automatic high-beam headlights
 - Cruise control
 - Driver and passenger airbags
 - Power windows and door locks
 - Privacy shades for cab windows
 - Remote keyless entry
 - Custom-molded ABS master wall panels
 - Soft-touch vinyl ceiling
 - High-intensity LED ceiling lights
 - TechnoForm® European style, high-gloss cabinetry
 - Bath bearing drawers/guides
 - Residential vinyl flooring
 - Finally total coach control system with wall-mounted touchscreen and mobile app
 - 48V Coleman-Mach® 10 13.5K BTU air conditioner
 - Powered roof vent in living area
 - Sliding screen door for entrance door
 - Sliding vented windows
 - Decorative window valances with day/night roller shades
 - Rear magnetic privacy shades
 - Removable privacy shade for sliding door window
 - Expandable table at entry door with safety grab handle (20TL)
 - Adjustable table with multiple mounts
 - (2) cab bucket seats (20AL, 20DL)
 - 32 in. front TV on drop-down bracket (20AL, 20DL)
 - 24 in. living area TV on swivel bracket (20TL)
 - JBL® Flip 5 removable wireless Bluetooth speaker
 - 5.3 cu ft. DC refrigerator (20AL, 20DL)
 - 3.1 cu ft. AC/DC refrigerator (20TL)
 - Convection microwave
 - 1-burner induction cooktop
 - Stainless-steel sink with cover
 - Soft-surface kitchen countertop with pull-out extension
 - Pop-up 120V/USB outlet in kitchen
 - (2) twin size beds with filler cushion converts to king size bed (20TL)
 - Under-bed storage (20TL)
 - 48 in. x 76 in. convertible sofa bed (20AL, 20DL)
 - 50.5 in. x 79.5 in. pop-top (20DL)
 - Bathroom wardrobe with drawers
 - Shower with magnetic curtain surround
 - Aqua View® SHOWERBASE™ water management system
 - Toilet with foot flush
 - Medicine cabinet with mirror
 - Powered roof vent in bathroom (20AL, 20TL)
 - Seatbelts for driver/passenger seats and select cab locations
 - Driver and passenger airbags
 - Smoke alarm
 - Carbon monoxide detector
 - Fire extinguisher

Base price	202,650.00
AUTUMN	n/c
USA STANDARDS	n/c
CUSTOMER VALUE PACKAGE	19,125.00
300W SOLAR BLANKET	899.00

DIMENSIONS

Exterior height: 111.00"
 Exterior width: 83.00"

CAPACITIES

Fresh water tank (gals.): 21.00
 Gray water tank (gals.): 33.00
 Black water/toilet tank (gals.): 12.00
 Propane (lbs.): 0
 Propane (gals.): 0
 Water heater (gals.): 0.00

TIRES

Tire size (front): LT225/75R16C
 Tire size (mid):
 Tire size (rear): LT225/75R16C

UNIT TOTAL	222,674.00
DEALER INSTALLED OPTIONS	
FREIGHT/PREP	1,770.00
TOTAL MSRP	224,444.00

Some dimensions may be rounded and may vary from the actual dimensions
 Weights may be estimated calculations and may vary from the actual weight
 - refer to the vehicle weight labels for actual weights***
 Floorplans, features and specifications are subject to change without notice.

