



M71U32

Precept

Serial #: 1UJMABR2R1UL4055
Model: 31UL PRECEPT MHA
VIN#: 1F66F5DN00A20724
Model Year: 2024 Dealer Name: EXPLORE USA RV SUPERCENTER
8615 WEST HIGHWAY 90
SAN ANTONIO, TX 78227
USA



Standard Equipment

THE FOLLOWING ITEMS ARE STANDARD ON THIS MODEL AT NO EXTRA CHARGE

- STANDARD EXTERIOR EQUIPMENT**
- 6-way power and sway driver/passenger seats (384, 36C)
 - GVWR: 22,000 lb (31UL, 34B, 34G) 24,000 lb (384, 36C)
 - GVWR: 26,000 lb (31UL, 34B, 34G) 30,000 lb (384, 36C)
 - 7.3L V 8 335 HP engine with 488 ft. lb. torque
 - 6-speed automatic TorqShift® transmission with overdrive and IGV haul mode
 - CatSkips™ catalytic converter protection
 - G-rated highway tires: 235/60R22.5 (31UL, 34B, 34G) 255/60R22.5 (384, 36C)
 - 5,000 lb rear hitch receiver with dual connector and 7-pin plug
 - 24V chassis battery
 - 1.201 in. panoramic windshield
 - Stronghold™ roof, floor and sidewalls
 - Sealed foam insulation (R-24 max roof, R-9 max sidewalls)
 - One-piece, seamless fiberglass front cap with partial paint
 - One-piece, seamless fiberglass rear cap
 - Fiberglass exterior walls with vinyl trim
 - Fiberglass exterior with industry's largest travel-view window
 - Lockable pass-through storage compartments with metal steam valves
 - Prime brake light
 - Prep for satellite dish
 - Cable TV hookup with RG-6 coax and video selector switch
 - 200W solar panel with dual controller
 - 200W solar panel with dual controller (2) 6V AGM (220AH) house batteries on standard tray transfer switch with remote polarity protection
 - 15.5 gal propane tank (66 lb.)
 - LP quick-connect hookup
 - Batted holding tanks (2TV pads)
 - Waterization drain system
 - Black tank flush
 - 12/0 amp shower
 - Water filtration system

Optional Equipment

OPTIONAL EQUIPMENT INSTALLED ON THIS VEHICLE BY MANUFACTURER

- STANDARD INTERIOR EQUIPMENT**
- 6-way power and sway driver/passenger seats
 - 111 stainless vinyl wrapped automotive dash
 - Cruise control
 - Hill start assist
 - Tire pressure monitoring system (TPMS)
 - Traction control
 - Auxiliary start
 - Power front privacy shade with manual side privacy shades
 - In-cab stereo and mobile app system with rear-mounted touch-screen and mobile app
 - 84 in. interior ceiling height with padded vinyl ceiling
 - High-intensity recessed LED ceiling lights
 - Handwood cabinet doors and drawers: fronts
 - Ball-bearing drawer guides
 - Jayco-exclusive, easy-operation legless dinette table
 - Car seat belts (select floorplans)
 - 30,000 BTU auto-splish ducted furnace (31UL, 34B, 34G, 36C)
 - 30,000 BTU auto-splish ducted furnace (384)
 - Electric fireplace (34B, 34G, 36C)
 - Residential refrigerator
 - Furnish all-in-one cockpit and oven
 - Decorative kitchen backsplash
 - Shower with decorative surround, glass door, skylight and light
 - Porcelain toilet with foot flush
 - Powered roof vent in bathroom with wall switch
 - Walk-around, king-size bed with bedspread and USB port and wireless charging in nightstands
 - LED HD Smart TV in bedroom
 - Under-bed storage (select models)
 - Bunks with industry-exclusive 300 lb. capacity each (384)
 - Wall-mounted label holder in each bunk (384)
 - Smoke alarm
 - Fire extinguisher
- CUSTOMER VALUE PACKAGE**
- Steering stabilizer, Komete shocks, variable-rate front and rear jounce bumpers, heavy-duty front and rear stabilizer bars, 22.5 in. Michelin tires, leveling jacks
 - Fiberglass windows
 - Fiberglass awning
 - Solar panel
 - 15,000 BTU A/C unit with heat pump and second 13,500 BTU A/C unit
 - Bluetooth entertainment center with outside speakers and LED HD Smart TV mounted on sweet bracket
 - Electric patio awning with LED lights
 - 50 amp electrical service
 - 30 amp surge protector
 - Sony® PlayStation center with Apple® CarPlay™ and Android Auto™
 - Backup and side-view cameras
 - 12.5 inch digital title
 - LED ill. solid-surface kitchen countertops with recessed stainless steel sink and sink covers
 - LED HD Smart TV in living area
 - Integrated day/night cassette shades

UNIT TOTAL **213,272.00**

DEALER INSTALLED OPTIONS

Manufacturer's Suggested Retail Price \$213,272.00

TOTAL AMOUNT DOES NOT INCLUDE STATE AND LOCAL TAXES OR LICENSE FEES. THE PRICE SHOWN ABOVE MAY OR MAY NOT BE REPRESENTATIVE OF THE ACTUAL SELLING PRICE OF SIMILAR RECREATIONAL VEHICLES IN YOUR AREA

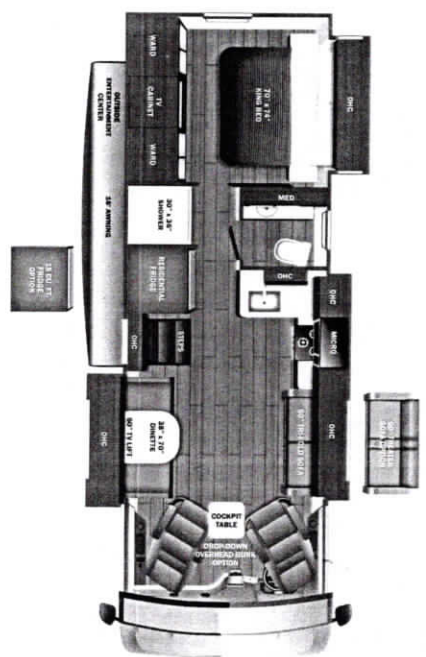

DIMENSIONS

Exterior height:.....154.00"
Exterior width:.....101.00"

CAPACITIES

Fresh water tank (gals.):.....72.00
Gray water tank (gals.):.....40.00
Black water/collet tank (gals.):.....50.00
Propane (lbs.):.....56
Propane (gals.):.....13
Water heater (gals.):.....0.00

TIRES

Tire size (front):.....235/80R22.5G
Tire size (mid):.....
Tire size (rear):.....235/80R22.5G

Some dimensions may be rounded and may vary from the actual dimensions
Weights may be estimated calculations and may vary from the actual weight -refer to the vehicle weight labels for actual weights
Floorplans, features and specifications are subject to change without notice.

