

TRAVEL TRAILER



Jayco

Generations of family fun.



WHITE HAWK

2+3
YEAR | YEAR
LIMITED | STRUCTURAL
WARRANTY

WHITE HAWK

28RL



28RL shown in Modern Farmhouse interior design



WHITE HAWK

32KBS



32KBS shown in Cashmere Cottage interior design



Refrigerator with wood panel inserts

POWER AWNING

G-20 DARK TINTED
SAFETY-GLASS WINDOWS

FRONT END CAP WITH
WINDSHIELD



AMERICAN-MADE
GOODYEAR® TIRES



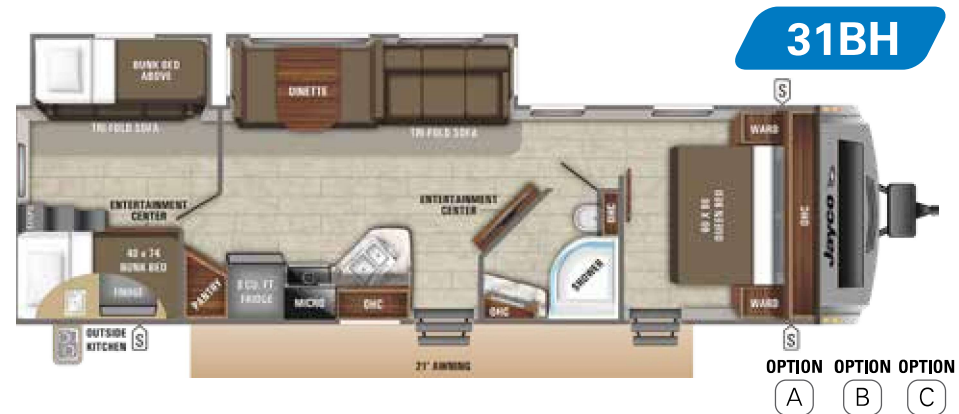
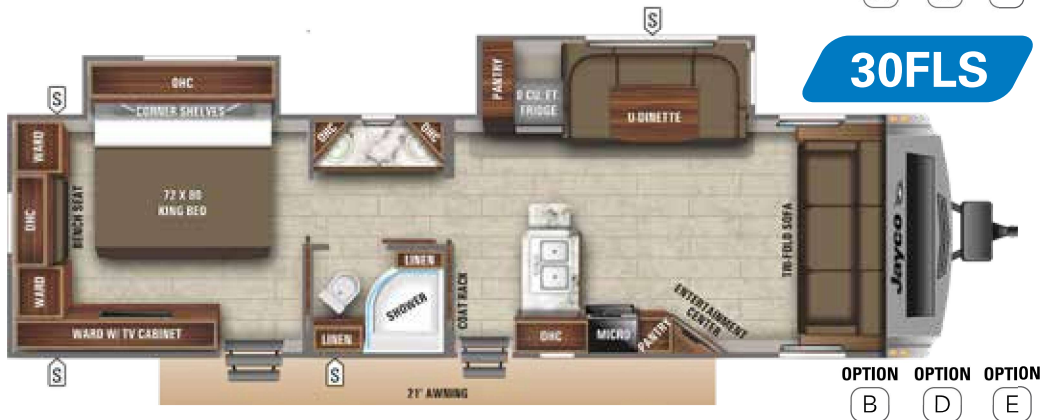



LEGEND

- STORAGE
- MICRO MICROWAVE
- OHC OVERHEAD CABINETS
- FRIDGE REFRIGERATOR
- WARD WARDROBE

OPTIONS



SPECS

FLOORPLAN	EXTERIOR TRAVEL LENGTH	EXTERIOR WIDTH	EXTERIOR HEIGHT (WITH A/C)	INTERIOR HEIGHT	UNLOADED VEHICLE WEIGHT	DRY HITCH WEIGHT	GVWR	CARGO CARRYING CAPACITY	FRESH WATER CAPACITY (INCLUDING WATER HEATER)	GREY WASTE WATER CAPACITY	BLACK WASTE WATER CAPACITY	SLEEPING CAPACITY
23MRB	28' 2"	8' 0"	11' 0"	6' 9"	5,875	595	7,250	1,375	48	30.5	30.5	3 - 4
24MBH	29' 2"	8' 0"	10' 11"	6' 9"	5,653	565	7,350	1,717	48	30.5	30.5	7 - 8
26RK	31' 2"	8' 0"	11' 0"	6' 9"	6,475	783	7,750	1,275	48	61*	30.5	4 - 6
27RB	32' 8"	8' 0"	11' 4"	6' 9"	6,733	711	8,200	1,467	48	61*	30.5	5 - 6
28RL	33' 4"	8' 0"	11' 4"	6' 9"	6,600	765	8,150	1,550	48	61*	30.5	4 - 6
29BH	34' 7"	8' 0"	11' 3"	6' 9"	7,110	835	8,500	1,390	48	61*	30.5	8 - 10
30FLS	30' 10"	8' 0"	11' 4"	6' 9"	TBD	TBD	TBD	TBD	48	TBD	30.5	5 - 6
31BH	37' 6"	8' 0"	11' 5"	6' 9"	7,985	825	9,500	1,515	48	61*	30.5	10 - 14
32BH	37' 10"	8' 0"	TBD	6' 9"	TBD	TBD	TBD	TBD	48	TBD	30.5	7 - 9
32KBS	37' 10"	8' 0"	11' 4"	6' 9"	7,810	820	9,175	1,365	48	61*	30.5	4 - 5
32RL	36' 8"	8' 0"	11' 4"	6' 9"	7,915	905	9,500	1,585	48	72.5*	30.5	4 - 6

Some specs at the time of print may include estimates. For the most accurate information, please visit Jayco.com.

*Split tanks

Unloaded Vehicle Weight (UVW): Sometimes referred to as "Dry Weight," UVW means the typical weight of the trailer as built at the factory. The UVW, as used in product literature and other promotional materials, does not include cargo, fresh water, propane, options or dealer-installed accessories.

Gross Vehicle Weight Rating (GVWR): GVWR means the maximum permissible weight of the trailer, including the UVW plus personal items, all cargo, fluids, options and dealer-installed accessories. The GVWR is equal to or greater than the sum of the UVW and the CCC.

Cargo Carrying Capacity (CCC): CCC means the maximum weight of personal items, food, fresh water, propane, tools, other cargo and dealer-installed accessories that can be carried by the trailer. CCC is equal to or less than GVWR minus UVW. The addition of options will decrease the CCC.

Hitch Weight (HW): The hitch weight, as used in product literature and other promotional materials, does not include cargo, fresh water, propane gas, options or dealer-installed accessories. The addition of these types of items will either add to or subtract from the stated hitch weight.

It is important for your safety and enjoyment that your tow vehicle be adequately sized and equipped to tow and handle the GVWR of the RV you select. Review weights and rating of your tow vehicle and consult a competent advisor for questions or advice. Whether you are new to RVing or a veteran, get a feel for the performance of your tow vehicle before heading out on the roadways. When you tow an RV, you must drive differently than when you drive a single vehicle. Practice hooking up, driving, backing up and braking in a safe environment or seek out professional instruction. Jayco affixes a weight label to each RV which lists estimated weight information for that vehicle. See specifications chart above.

WHITE HAWK COMPETITIVE ADVANTAGES

Frameless windows



MORryde® StepAbove Entry Steps



34 inch radius shower with glass door



American-Made Norco Next-Gen frame with integrated A-frame

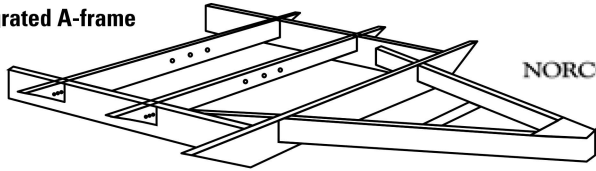

American-Made Dexter Axles with self-adjusting brakes and galvanized wheel wells



American-made Goodyear® tires



Enclosed underbelly with Glacier Package



Galvanized steel, impact-resistant wheel wells



WHITE HAWK STANDARDS & OPTIONS

STANDARD EXTERIOR EQUIPMENT

Aerodynamic, rounded front profile with front diamond plate
Stronghold VBL™ vacuum-bonded, laminated side, rear and front walls (including slideout room walls)
Magnum Truss™ Roof System with seamless DiFlex II material
5/8 in. tongue and groove plywood decked flooring
Norco® NextGen frame with integrated A-frame
G-20 dark tinted safety-glass windows
30 in. friction hinged main entry doors (most models)
Swing-out grab handle
Exterior TV bracket with 110V and cable outlets
Outdoor Camp Kitchen with embossed metal countertops (select models)
Slam latches on front pass-through storage doors (select models)
Marine-grade exterior speakers (2)
Galvanized steel and impact-resistant wheel wells
American-made Dexter® axles with EZ Lube®
Slideout rooms with double seals, barrier sponges, and U-channel drip spouts
30 amp service
Stabilizer jacks with sand pads (4)
Furrion® mounted camera bracket for pre-wired rear backup prep
Keyed Alike™ lock system
Detachable power cord
Exterior LED lighting
A-frame mounted solar prep
Battery quick disconnect

STANDARD INTERIOR EQUIPMENT

Solid hardwood, jointed cabinets with screwed and glued lumbercore cabinet stiles
Deep, split bowl, stainless steel sink with high rise, pull out faucet and dry rack/ sink cover combo
Decorative backsplash
Ball-bearing drawer glides with 75 lb. capacity
Arched interior ceiling
LED lighting throughout
Directional and closeable central air conditioner vents
AM/FM/CD/DVD/Bluetooth® stereo with speakers
Plywood dinette, bunk and bed bases (applicable models)
60x80 in. queen beds (60x75 in. in 23MRB & 24MBH)

Murphy bed design allowing pass-through exterior storage access (23MRB & 24MBH)
Solid wood door enclosures for master bedroom (N/A on Murphy bed models)
Full bedroom closet (27RB & 29BH)
Fixed bunks with 110V outlet and corner shelf
Jayco exclusive teddy bear "soft-touch" bunk mats (bunk models only)
Bathroom medicine cabinets
14x14 in. powered roof vents in bathroom and main bedroom
L-lounger sofa (standard in 23MRB & 24MBH)
Residential vinyl flooring with cold crack resistance
High output auto ignition furnace with wall thermostat
Wood panel fridge inserts
Shaker style interior doors
New JAYCOMMAND™ "Smart RV" system

CUSTOMER VALUE PACKAGE (MANDATORY)

American-made nitro-filled Goodyear® radial tires
Self-adjusting electric brakes
8 cu. ft. refrigerator with stainless front panels
Porcelain foot flush toilet
34 in. radius showers with solid enclosure
40 in. LED TV (N/A on 32KBS & 32RL)
50 in. LED TV (32KBS & 32RL)
Black tank flush
Roof ladder
13,500 BTU or 15,000 BTU A/C
6 gal. gas/electric auto ignition water heater
ABS propane bottle cover
30 lb. propane bottles (2)
Bath skylight
Outside shower
Oven with 3-burner recessed cooktop
Aluminum rims
Power awning with LED light
Power tongue jack
Detachable power cord

LUXURY PACKAGE (MANDATORY)

Enclosed underbelly with upgraded insulation package
Kitchen skylight with shade

Front molded fiberglass cap with automotive-style windshield and blue LED accent lighting
Frameless windows
MORryde® StepAbove entry steps (main entry). Aluminum tread entry steps (second entry, select models)
JaySMART™ backup assist lighting

OPTIONS

Customer Value Package (MANDATORY)
Customer Value Package with 15,000 BTU air conditioner
Freestanding table with 4 chairs IPO booth dinette (select models)
Freestanding table with 2 chairs and ottoman IPO dinette (select models)
Theater seating with heat, massage, and LED lighting (select models)
2nd 13,500 BTU A/C (requires 50 amp service)
30 amp electric fireplace (MANDATORY)
50 amp service with 2nd A/C prep (required with 2nd A/C)
Solar prep (roof mounted)
Power stabilizer jacks
Outside bumper-mount grill
Fan-Tastic Vent power roof vent (location varies by model)
Norco® stabilizing system with 4 power jacks, 2 lock arms, and power tongue jack with stabjack controls
2nd A/C in bedroom (32KBS only)

CASHMERE COTTAGE



MODERN FARMHOUSE



INTERIOR OPTIONS



50 percent Stronger

4,500 lbs. on a Jayco roof vs. other roofs



Jayco's roof **vs.** other roofs

2+3

YEAR LIMITED | YEAR STRUCTURAL

WARRANTY

Travel with Confidence

NO ONE OFFERS A BETTER WARRANTY

At Jayco, we build our RVs to handle every adventure, then back them with our **industry-leading 2+3 warranty**. Our 2-year limited warranty has you covered for 2 camping seasons. That's **730 days**. In addition, our 3-year structural warranty has you covered for **3 camping seasons or 1,095 days**. You won't find a better warranty in the business, because the only strings we attach are those that deliver the ultimate in reliability. That's the Jayco difference. So go explore. For a copy of our 2-year limited + 3-year structural warranty with complete terms and conditions, please contact your local Jayco dealer.



MADE IN USA

Featuring Durawall®
Technology - ENGINEERED
to help you tow with confidence



JAYCOMMAND™

The JAYCOMMAND™ system puts RVers in full control of their unit. The system was custom-built by our product development teams along with OneControl®, so that owners can **monitor and control key RV operations from a phone or a tablet.**

Meet your Jayco Dealer _____



Jayco, Inc. | P.O. Box 460 | Middlebury, IN 46544 © **RVIA**
See dealer for further information and prices. All information in this brochure and on www.jayco.com is the latest available at the time of publication approval. Jayco reserves the right to make changes and to discontinue models without notice or obligation. Photography may show optional equipment or props used for decoration purposes only. RVs built for sale in Canada may differ to conform to Canadian codes. JAYCO and the JAYCO BIRD IN FLIGHT are registered trademarks of Jayco, Inc. Printed in USA 68K 11/19 ©2019 Jayco, Inc.

Follow Jayco
#LetsJayco

