

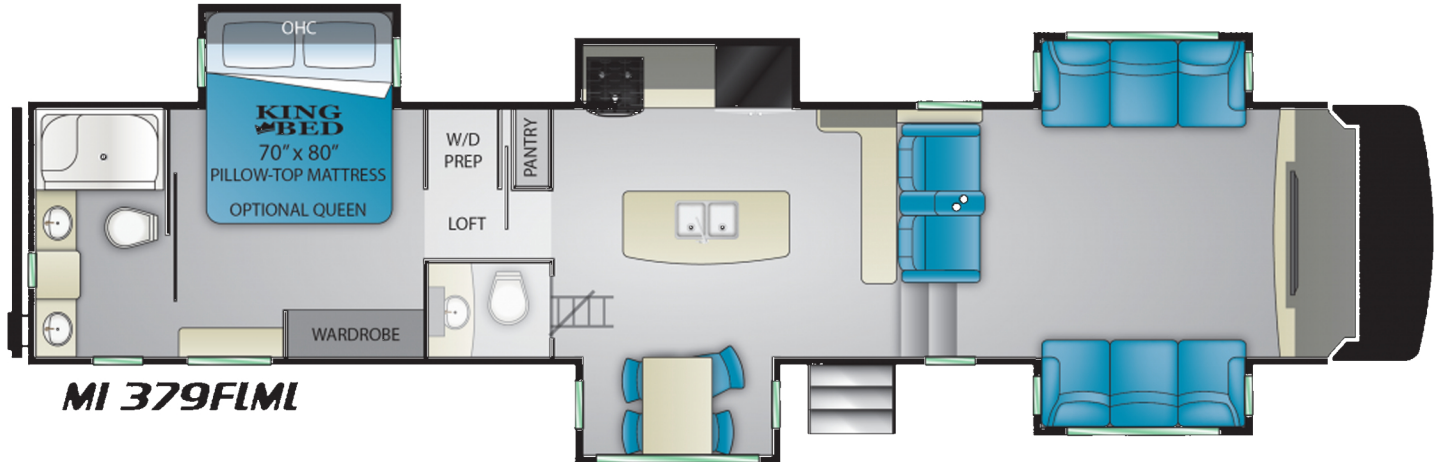

Scan to see more about this model on-line!

# MILESTONE



## Top 10 Selling Features

*Do More!*

- 16" F-Rated Tires W/16" Aluminum Wheels
- Heated & Enclosed Underbelly
- Solar ,Satellite, & Backup Camera Prep
- A/C with Dual Ducts
- 2 Tone Painted Gelcoat Fiberglass Cap
- Solid Surface Counter Tops W/LED Accent Lighting
- 6FT 5IN Slide Outs
- Accent Lighting in Ceiling Boards
- 30" Friction Hinge Entry Door
- 10.7 CU FT 12V Refrigerator

## 379FLML by Heartland

GVWR	15,000 Lbs
Dry Weight	12,600 Lbs
Hitch Weight	2,710 Lbs
Dimensions*	8'-3/4"W x 13'-6"H x 42'-8"L
Sleeping Capacity	7-8
Axles	2
Fresh Tank	50 Gal
Gray Tank	80 Gal
Black Tank	80 Gal
Water Heater	6 Gal
Furnace	35,000 BTU
Air Conditioner	13,500 BTU
Number of Slides	5
Slide Room Height	6'-5-3/4" Slide Room Height
Bedroom Height	6'-4-1/4" Bedroom Ceiling
Awning Length	17'
Cook Top	3 Burner
Traditional Oven	YES
Convection Oven	No
Generator Prep	N/A
Bed Dimensions	King

\*Overall length defined as tow point (ball coupler for travel trailers / king pin for fifth wheel trailers) to rear bumper. It does not include rear ladder or spare tire. Optional pin boxes will affect overall length. \*\*Garage length is defined as ramp door to full interior wall. Standard or optional equipment may reduce overall garage dimensions. Information provided is accurate as of 10/3/2019 and is subject to update & change. Please confirm with your local Heartland Dealership for up to date information.



[www.heartlandrvs.com](http://www.heartlandrvs.com)

Heartland Recreational Vehicles  
2831 Dexter Drive • Elkhart, Indiana 46514  
574-262-5992