

TRAVEL TRAILERS

# TRANSCEND™

BY GRAND DESIGN RV

TRAVEL TRAILERS



TRANSCEND™  
BY GRAND DESIGN RV



GRAND DESIGN®  
RECREATIONAL VEHICLES





**TRANSCEND**



**TRANSCEND**



# We'll take you there.



## “ We love our 27BHS Transcend...

it's perfect for our family. My kids enjoy the spacious bunk beds and my wife and I love all the room and features that come with it. We have been impressed with the build quality. We can't wait to take it out again. ”

- Chris & Carissa White

## “ We have a Transcend 27BHS and we love ours.

Our kids have had friends camp with them and having the full size bunks help. I also like having the small outdoor kitchen with the refrigerator. It keeps the kids from running in and getting a drink every 10 seconds. ”

- Dana Wissing Schwartz



## “ We love our 28MKS...

It's a great couples trailer. The layout is so spacious, lots of storage and it's really the light colored interior that really makes it feel homey. We are able to add our own touches. Everything about it is nice and convenient. ”

- Bonnie

## **GDRV4LIFE.com**

A COMMUNITY OF GDRV OWNERS SHARING EXPERIENCES, TIPS, TRICKS AND DESTINATIONS

**JOIN THE FAMILY!**



31RLS SHOWN





# TRANSCEND™

BY GRAND DESIGN RV

## Welcome to the Grand Design family.

Grand Design's Transcend continues our pursuit of building around the needs of our customers. Where others surrender quality, function and features, Transcend focuses on the needs of consumers – open floorplans, functional design, and towable with many of today's half-ton trucks and SUVs.

The all-new Grand Design Xplor is the perfect fit for your dream of enjoying the great outdoors. The Xplor starts at the top of its class by offering customer-focused design, built-in quality, and the industry-leading warranty that is expected from a Grand Design. *It's time to explore the possibilities.*



TRANSCEND



TRANSCEND XPLORE

**QUALITY DRIVEN. CUSTOMER FOCUSED. BUILT TO LAST.**

# BUILT TO LAST

## MAXIMUM INSULATION

### 1 RESIDENTIAL INSULATED WALLS

Exterior walls and sliderooms are framed with studs set 16" on center, and residential fiberglass insulation is adhered in place between each stud.

TRANSCEND  
XPLOR  
**R-9**

### 2 INSULATED FLOOR AND ENCLOSED UNDERBELLY

The main floor is insulated with a layer of residential fiberglass insulation. The coach underbelly is also fully enclosed and heated with a dedicated duct.

TRANSCEND  
XPLOR  
**R-11**

### 3 INSULATED ROOF

A layer of fiberglass insulation and a layer of radiant foil insulation (*NA Xplor*) covers the full length of the roof.

TRANSCEND XPLOR  
**R-40\*** **R-9**

### 4 INSULATED FRONT WALL

The residential fiberglass insulation layer from the roof, continues all the way around to the bottom of the front wall. (*NA Xplor*)

TRANSCEND XPLOR  
**R-40\*** **R-9**

## MAXIMUM FUNCTION

A HIGH PERFORMANCE FURNACE DELIVERS UP TO 35,000 BTUS OF HEATING POWER.

TRANSCEND XPLOR  
**35K** **30K**

HEATED & ENCLOSED UNDERBELLY W/  
SUSPENDED TANKS

✓ ✓



\*Equivalent R-Value



### EVENFLOW HEATING SYSTEM

Evenly distributes heat from the front to the rear without vents in floor that collect dirt and debris.

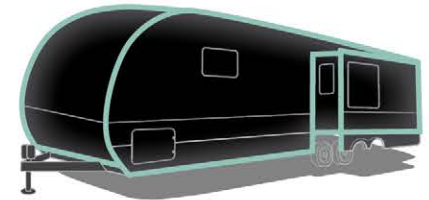

### QUADSEAL

Four protective layers (mylar tape, 2-layers of PVC foam, and a final silicone cap seal) line the perimeter of the coach for ultimate protection from the elements.





**MAGNETIC STORAGE  
DOOR CATCHES**



**MORE OUTLETS**



**MOTION SENSOR  
LED LIGHTING**



**30" 5000lb  
STABILIZER JACKS**



**PET FRIENDLY RV**



**OVERSIZED  
TANK CAPACITIES**



**ALUMINUM  
ENTRY STEPS**

### UNIVERSAL DOCKING STATION

*All-in-one location for utilities and hookups.*



### DEEP SEATED STAINLESS STEEL SINK

*Residential size kitchen sink*



### SOLID WOOD

*Cabinet doors and drawer fronts*



## FRONT WALL CONSTRUCTION

Vertical banana rafters are added to the framework to increase support. Hurricane ties are also used to withstand high winds.



# BACKED TO A HIGHER STANDARD

Every Grand Design RV is backed with a class leading 3-year limited structural warranty. By selecting suppliers with similar philosophies, many components used on our coaches also carry an extended warranty through the component manufacturer.



- ▶ **AXLES** (5 Years)
- ▶ **CHASSIS** (3 Years)  
*(Main Steel Frame, Steel Frame Outriggers and Cross Members)*
- ▶ **EXTERIOR GRAPHICS** (5 Years)
- ▶ **ROOF COVERING** (15 Years)
- ▶ **TIRE WARRANTY**  
*(5 Years w/12 Month no questions asked replacement for manufacturer defects)*

**QUALITY DRIVEN. CUSTOMER FOCUSED. BUILT TO LAST.**

# TRANSCEND™ XPLÖR

IT'S TIME TO XPLOR THE POSSIBILITIES

78"

78" INTERIOR  
HEADROOM



QUICK DROP  
TONGUE JACK



TUFF-COAT  
EXTERIOR FINISH



USB PORTS (2)

30K

30,000 BTU  
FURNACE

13.5K

13,500 BTU  
AIR CONDITIONER

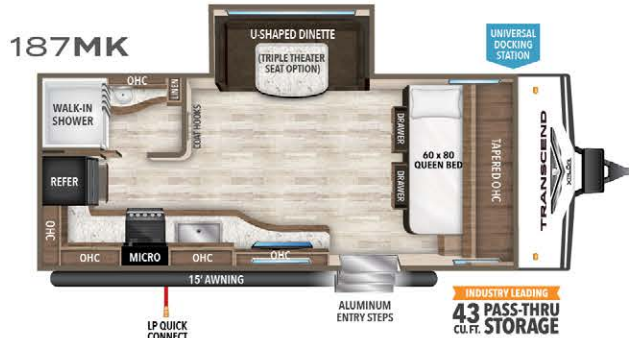

LIGHTWEIGHT AND FULL OF FEATURES

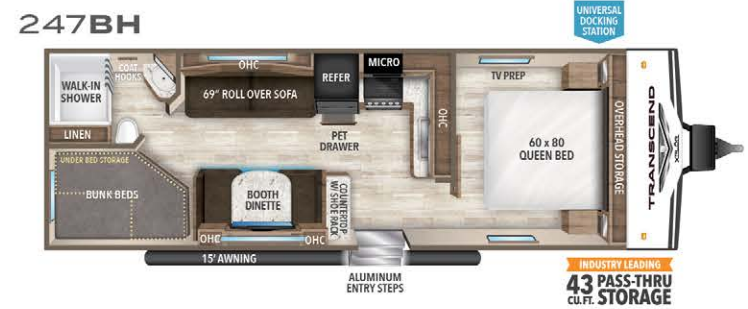

BUNKHOUSE WITH MAXIMUM SLEEP CAPACITY, NO SLIDES

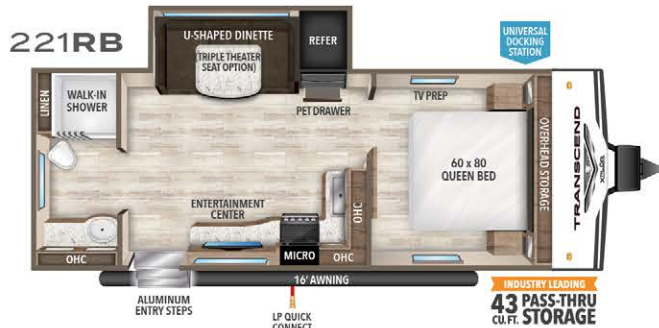

FULL WIDTH BATHROOM IN REAR



BUNKHOUSE WITH MAXIMUM SLEEP CAPACITY



BUNKHOUSE WITH LOTS OF COUNTER SPACE



BUNKHOUSE WITH LOTS OF SEATING IN LIVING AREA





LIVING AREA 221RB



BEDROOM 221RB

	UVW <sup>†</sup>	HITCH <sup>‡</sup>	LENGTH <sup>§</sup>	HEIGHT	CAPACITY (gal.)
187MK	4,700	480	22' 11"	11'	62 39 39
221RB	5,389	510	26' 10"	11'	62 78 39
243BH	5,991	597	29' 11"	11'	62 68 39
247BH	5,392	546	29' 11"	11'	62 68 39
261BH	5,981	618	30' 11"	11'	62 68 39
265BH	6,271	740	32' 9"	11'	62 68 39

†Based on average weight in lbs. ‡Hitch to rear

FRESH GRAY BLACK

Because of our commitment to continuous product improvement, Grand Design Recreational Vehicles reserves the right to change components, standards, options, specifications, and materials without notice and at any time. Photos may show optional equipment which may not be included in the standard purchase price of the featured unit. Be sure to review current product details with your local dealer before purchasing. Rev 03.05.19

## EXTERIOR & CONSTRUCTION

- Quick Drop Tongue Jack
- Solar Power Inlet
- Backup Camera Prep
- Black Tank Flush
- 20# LP Bottles (2) with Cover
- 28" Friction Hinge Entry Door
- High-Capacity Water Pump
- Extra Large 2" Fresh Water Drain Valve
- Battery Kill Switch (Pass Thru)
- Oversized Tank Capacities
- Walk-on Roof
- Easy Access Low Point Drain Valves
- One-Piece Roof Membrane w/ 12-Year Warranty
- Insulated Storage Doors
- Rear Wall Insulation (R-9)
- Side Walls Insulation (R-9)
- Slideroom Roof and End Wall Insulation (R-9)
- Main Floor Insulation (R-9\*)
- 5" Radius Roof Insulation (R-40\*)
- 5" Radius Wood Framed Roof (R-40\*)

\*R-Value Equivalent

## INTERIOR

- Large Solid Bedroom Door (Master Suite)
- Residential Bedspread
- TV and Cable Prep
- Walk-in Shower
- Power Vent Fan
- Medicine Cabinet with Mirror
- ABS Tub Surround
- Solid Hardwood Drawer Fronts
- Solid Core Cabinet Stiles
- Pre-Drilled and Screwed Cabinetry
- Ball Bearing Full Extension Drawer Glides
- Residential Countertops
- Microwave
- 3-Burner Range with Oven
- USB Ports (2)
- Upgraded Residential Furniture
- More Power Outlets

## OPTIONS

- Triple Theatre Seating IPO U-Shaped Dinette (187MK, 221RB, 265BH)

## ELEVATION PACKAGE

- 78" Interior Height
- Master Suite w/ 60" x 80" Queen Bed
- 62 Gallon Fresh Water Capacity
- Spare Tire w/ Carrier
- Black Tank Flush
- Nitrogen Filled Radial Tires
- Magnetic Storage Door Catches
- Foot Flush Toilet
- Residential Booth Dinette
- Extended Grab Handle
- Backed for Rear Ladder
- E-Z Lift Bed Storage w/ Struts
- Tinted Windows
- High Rise Faucet
- Residential Cabinet Doors
- Solid Wood Drawer Fronts
- 6 Gal DSI Quick Recovery Water Heater
- Deep Seated Stainless Steel Sink
- Double Door Refrigerator

## XPLOR SEASON PROTECTION PACKAGE

- Heated and Enclosed Underbelly w/ Suspended Tanks
- Designated Heat Duct to Subfloor
- High Density Roof Insulation
- Moisture Barrier Floor Enclosure
- 30k BTU High Capacity Furnace
- Attic Vent
- Double Insulated Roof (R-40\*)
- 13.5k Ducted AC
- Dual 20# LP Tanks with Cover
- EvenFlow Ductless Heating System Throughout
- E-Z Winterization
- Utility Center

## XPLOR POWER PACKAGE

- LED Interior Lighting (LED)
- Quick Drop Tongue Jack
- Power Awning
- AM/FM/CD/DVD Bluetooth Stereo
- Exterior Speakers
- Detachable Power Cord w/ LED Light
- USB Port
- Motion Sensor Lights in Key Areas
- Backup Camera Prep
- Solar Prep
- Battery Disconnect Switch
- HD TV Antenna



# TRANSCEND™

BY GRAND DESIGN RV

82"

MAXIMUM HEADROOM



POWER TONGUE JACK



TUFF-COAT EXTERIOR FINISH



USB PORTS (2)

35K

35,000 BTU FURNACE

15K

15,000 BTU AIR CONDITIONER



REAR LADDER



26RLS

DOUBLE ENTRANCE, BIG BATHROOM, LOTS OF STORAGE AND WINDOWS



27BHS

SLEEPS UP TO 8, OUTSIDE KITCHEN FOR GREAT ENTERTAINING



28MKS

OVER 10' COUNTERTOP SPACE, 9 DRAWERS, LARGE BATH AND CLOSET COMBO

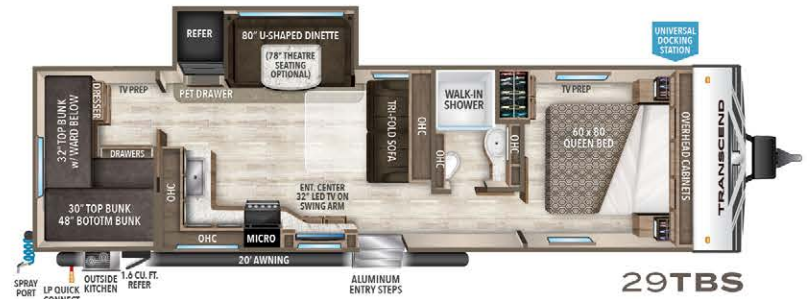

29TBS

GREAT BUNK ROOM WITH OVERSIZED BUNKS, PERFECT FOR A ENTERTAINING WITH OVER 8' OF COUNTER SPACE.



30MKS

GREAT LIVING SPACE W/ AMPLE ROOM & 8 CU. FT. FRIDGE. WASHER DRYER PREP, OVER 10' OF COUNTER SPACE

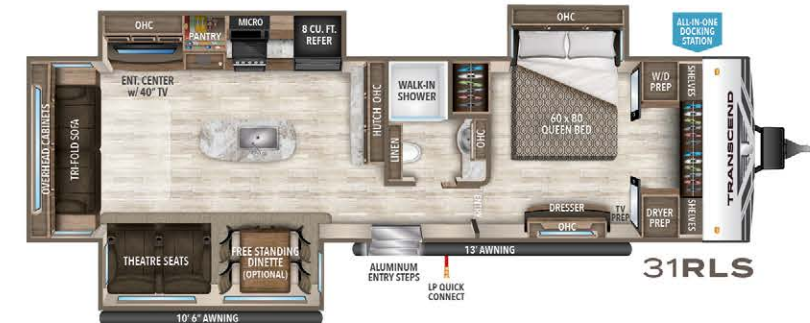

31RLS

OPEN CONCEPT W/ COUNTER SPACE, ISLAND AND STORAGE, WASHER DRYER PREP, XL PANTRY



32BHS

OPEN CONCEPT LIVING AREA W/ BATH AND HALF, BROOM/UTILITY CLOSET, OVERSIZED BUNK ROOM, 2 ENTRANCES



**25% THICKER THAN THE COMPETITION**

The satin metal exterior skin is 25% thicker, for a more durable and better looking sidewall.





**BEDROOM** 32BHS



**KITCHEN** 32BHS

	UVW <sup>†</sup>	HITCH <sup>‡</sup>	LENGTH <sup>‡</sup>	HEIGHT	CAPACITY (gal.)	WHEEL
<b>26RLS</b>	6,685	625	32'	11' 4"	62 78 39	15"
<b>27BHS</b>	6,710	633	32'	11' 4"	62 68 39	15"
<b>28MKS</b>	7,195	709	34' 2"	11' 4"	62 78 39	15"
<b>29TBS</b>	7,260	676	35' 11"	11' 4"	62 68 39	15"
<b>30MKS</b>	8,817	831	35' 9"	11' 5"	62 107 39	15"
<b>31RLS</b>	9,026	941	36' 11"	11' 9"	62 107 39	15"
<b>32BHS</b>	7,738	728	36' 11"	11' 4"	62 78 78	15"

<sup>†</sup>Based on average weight in lbs. <sup>‡</sup>Hitch to rear

**FRESH GRAY BLACK**

Because of our commitment to continuous product improvement, Grand Design Recreational Vehicles reserves the right to change components, standards, options, specifications, and materials without notice and at any time. Photos may show optional equipment which may not be included in the standard purchase price of the featured unit. Be sure to review current product details with your local dealer before purchasing. Rev 03.05.19

## EXTERIOR & CONSTRUCTION

- Power Tongue Jack
- Solar Power Inlet
- Backup Camera Prep
- Black Tank Flush
- 20# LP Bottles (2) w/ Cover
- Friction Hinge Entry Door
- High-Capacity Water Pump
- Extra Large 2" Fresh Water Drain Valve
- Battery Kill Switch (Pass Thru)
- Oversized Tank Capacities
- Walk-on Roof
- One-Piece Roof Membrane w/ 12-Year Warranty
- Easy Access Low Point Drain Valves
- Insulated Storage Doors
- Side Walls and Rear Wall Insulation (R-9)
- Slideroom Roof and End Wall Insulation (R-9)
- Main Floor Insulation (R-11\*)
- 5" Radius Roof Insulation (R-40\*)

\*R-Value Equivalent

## INTERIOR

- Residential Bedspread
- TV and Cable Prep
- Walk-In Shower with ABS Tub Surround
- Power Vent Fan
- Medicine Cabinet with Mirror
- Solid Hardwood Drawer Fronts
- Solid Core Cabinet Stiles
- Pre-Drilled and Screwed Cabinetry
- Ball Bearing Full Extension Drawer Glides
- Large Panoramic Windows
- Residential Countertops
- Microwave
- 3-Burner Range with Oven
- USB Ports (2)
- Upgraded Residential Furniture
- More Power Outlets

## OPTIONS

- Theater Seating IPO Tri-Fold Sofa (Mandatory 26RLS, 28MKS, 31RLS)
- Free Standing Table and 4 Chairs (26RLS, 28MKS, 31RLS, 32BHS)
- 50 Amp Service - Pre-wired for 2nd AC (28MKS, 29TBS, 30MKS, 31RLS, 32BHS) - Mandatory Option
- 78" Theatre Seating IPO Booth Dinette (29TBS, 30MKS)
- 2nd AC - 13.5K BTU (28MKS, 29TBS, 30MKS, 31RLS, 32BHS)

## RISE ABOVE PACKAGE

Mandatory Package

- Aluminum Entry Steps
- Tri-Fold Hide-a-Bed Sofa
- 82" Interior Height
- Master Suite w/ 60" x 80" Queen Bed
- All-In-One Utility Center
- 62 Gallon Fresh Water Capacity
- STRONGWALL Aluminum Exterior
- Spare Tire w/ Carrier
- Black Tank Flush
- Aluminum Rims w/ Nitrogen Filled Radial Tires
- Magnetic Storage Door Catches
- Porcelain Foot Flush Toilet
- Residential Booth Dinette
- Extended Grab Handle
- Roof Ladder
- E-Z Lift Bed Storage w/ Struts
- Tinted Windows
- Pet Friendly Drawer Under Refrigerator
- High Rise Faucet
- Solid Wood Cabinet Doors and Drawer Fronts
- 17.8 Gal/Hr. DSI Quick Recovery Water Heater
- Deep Seated Stainless Steel Sink
- Double Door Refrigerator

## EXTENDED SEASON PROTECTION PACKAGE

Mandatory Package

- 35k BTU High Capacity Furnace
- Heated and Enclosed Underbelly w/ Suspended Tanks
- Double Insulated Roof (R-40\*)
- Designated Heat Duct to Subfloor
- High Density Roof Insulation
- Moisture Barrier Floor Enclosure
- Residential (Ductless) Heating System Throughout

## ECLIPSE POWER PACKAGE

Mandatory Package

- Electric Awning
- LED Interior Lighting and Porch Light
- Motion Sensor Pass Thru and Entry Lighting (LED)
- (HDMI) Bluetooth Stereo/DVD Player
- 30 Amp Service
- High Definition LED Television
- 15k BTU Ducted AC
- Detachable Marine Grade Power Cord w/ LED Light



# We Strive For Nothing Less Than Customers for Life!

**Thank you for taking the time to tour our coach. We would like to share what sets Grand Design RV Company apart from all other RV manufacturers and why this difference is important.**

Grand Design's founders were part of the ownership and leadership team of the largest travel trailer and fifth wheel manufacturer in the world. While proud of this accomplishment, it became difficult to stay in touch with customers, employees, and ultimately the quality of the final product. It was obvious there was a better way.

In 2011, we started with a blank canvas to pursue that better way, a different way, than what had been done before. A company whose culture requires a long-term, personal connection with our customers, employees, and dealers – that company is Grand Design RV. Our business model of doing the right thing has led us to unparalleled years of growth.

## LONG TERM VALUE

Everything we do at our company is designed to build long term value in what we offer our customers, "more features and superior value for your dollar."

## CUSTOMER FOCUS

Our focus, from the very first day we opened our doors, revolves around our customers. Your satisfaction is our future.

## STAYING CONNECTED

Magic happens when the CEO and Senior Management actively work with the production facilities to help build the team and develop products.

## EXPERIENCED WORKFORCE

Our local workforce has been hand-picked and has an excellent reputation for second-to-none industry craftsmanship.

## CLASS LEADING WARRANTY

We back every one of our coaches with a 3-year limited structural warranty.

## RAISING THE QUALITY BAR

We put every Grand Design RV through a series of quality inspection gates during the manufacturing process. Once completed, the unit undergoes a comprehensive "final finish" inspection. At this point, most manufacturers ship their coaches to the dealer for retail sale. We aren't most manufacturers. **Every single one of our coaches are shipped to a PDI (Pre-Delivery Inspection) area where they are put through a rigorous 288+ point inspection checklist.** It is only after PDI certification that we deem a unit ready to ship to our dealers.

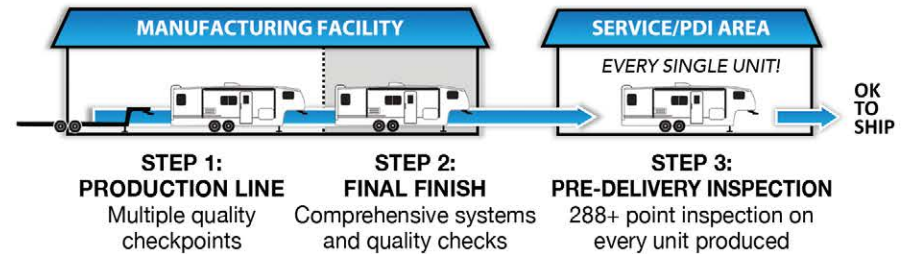

## SUPERIOR SERVICE

Anything built by humans that travels down the open road is subject to issues. It's how those issues are addressed that makes Grand Design stand out. Don't just take our word for it, visit the independent Transcend owners page (Grand Design Transcend Owners) or (Grand Design RV Owners) on Facebook and see for yourself. We take care of our customers after the sale. An informed customer will be a Grand Design customer!

At Grand Design our goal is simple – continue leading the industry with quality products while improving the customer's RV experience before, during and after the sale. We strive for nothing less than customers for life and we would be honored to personally welcome you to the Grand Design RV family!

Warmest Regards,

President / CEO / Co-Founder



Grand Design RV was created and founded by close friends Don Clark and brothers Ron and Bill Fenech (Representing over 80 combined years of experience in the RV industry).