



86698

Jay Feather



Serial #: 1UJBB0BP5S1J80134
Model: 25RB JAY FEATHER TT

Model Year: 2025 Dealer Name: BISH'S RV OF LONGVIEW
5009 JUDSON RD
LONGVIEW, TX 75605
USA

Standard Equipment

THE FOLLOWING ITEMS ARE STANDARD ON THIS MODEL
AT NO EXTRA CHARGE

STANDARD EXTERIOR EQUIPMENT

- 1.5 in. fresh water drain valve
- 18 in. rear roof ladder - factory installed
- 2 in. Stronghold VBL™ floor with 2 lb. density foam
- Stronghold VBL™ walls with double-sided Azdel composite (sidewalls, rear walls and slide out boxes)
- Aerodynamic, rounded front profile with aluminum framing
- American-made Norco Z-frame with integrated A-frame
- Automotive-style aluminum rims
- Battery quick-disconnect
- Dark-tinted safety-glass windows
- Exterior TV bracket with 120V and cable hook-ups
- Front diamond plating with Azdel backing
- Front molded decorative cap (select models)
- Galvanized steel and impact resistant wheel wells
- Keyed-Alike™ locking system
- Magnum Truss™ Roof System
- Marine grade exterior speakers
- Outdoor camp kitchen with galvanized steel bases (select models)
- PVC roofing membrane (limited lifetime warranty)
- Swing-out entry door assist handle

JAY SPORT PACKAGE (MANDATORY)

- 11 cu. ft. 12V fridge
- App monitored TPMS
- Climate Shield (zero to 100 degree tested weather insulation package)
- Front slam-latch baggage doors
- Invision appliance package
- LCI Solid Step fold-down aluminum tread steps on main entry door
- LED smart TV
- MAXXAIRS power roof vent (main living area)
- Modern graphics package with dual-colored sidewall
- Overlander 1 Solar Package: (1) 200W solar panel and 30-amp digital controller
- Porcelain foot-flush toilet
- Stainless steel kitchen & bathroom sink

STANDARD INTERIOR EQUIPMENT

- 4 in. high-density dinette cushions with vinyl backing
- 4 in. soft-touch bunk mats (select models)
- 60 x 80 in. residential queen beds (60 x 76 in. in Murphy bed models)
- 75 lb. full extension drawer guides
- Bathroom skylight
- Decorative backsplash
- Decorative roller shades with reflective barrier
- Directional and closeable A/C vents
- Gas-structed under bed storage (most models)
- Handcrafted, hardwood door/drawer fronts
- Hidden-hinged cabinet doors
- High output auto-ignition LP gas furnace
- LED lighting throughout
- Plywood dinette, bed, bunk and shower/tub bases
- Powered roof vents in bathroom and main bedroom (most models)
- Residential style seamless countertops throughout
- Residential vinyl flooring throughout
- Screwed and glued cabinet sites
- USB charging ports (multiple locations throughout)

CUSTOMER VALUE PACKAGE (MANDATORY)

- American-made nitro-filled Goodyear® radial tires with self-adjusting electric brakes
- 13,500 BTU roof-mounted A/C
- 20 lb. LP gas bottles with auto-regulator and ABS cover
- 55 gal. fresh water tank
- Automotive-style aluminum rims
- Black tank flush
- Detachable power cord
- Inverter pre-wire (2 bedroom nightstand outlets, main TV and outlet for outside kitchen fridge)
- Max-length power awning with LED light
- On-demand 60,000 BTU water heater
- Power tongue jack
- Rear 2 in. receiver
- Rock Solid Stabilizer System
- Side and rear back-up camera prep
- Under-mount spare tire

Optional Equipment

OPTIONAL EQUIPMENT INSTALLED ON THIS VEHICLE
BY MANUFACTURER

Base price	45,623.00
USA STANDARDS	n/c
CUSTOMER VALUE PACKAGE	6,000.00
JAY SPORT PACKAGE	3,750.00
OVERLANDER 1 SOLAR PACKAGE	n/c
NO JAYCOMMAND CONTROL SYSTEM	n/c
15,000 BTU AC	300.00
NO 2ND AC	n/c
FIREPLACE	443.00
20# LP GAS BOTTLES	n/c
THEATER SEATING W/TABLE TRAYS	593.00
DINETTE	n/c
QUEEN BED	n/c

UNIT TOTAL 56,709.00

DEALER INSTALLED OPTIONS

Manufacturer's Suggested Retail Price \$56,709.00

TOTAL AMOUNT DOES NOT INCLUDE STATE AND LOCAL TAXES OR LICENSE FEES. THE PRICE SHOWN ABOVE MAY OR MAY NOT BE REPRESENTATIVE OF THE ACTUAL SELLING PRICE OF SIMILAR RECREATION VEHICLES IN YOUR AREA.

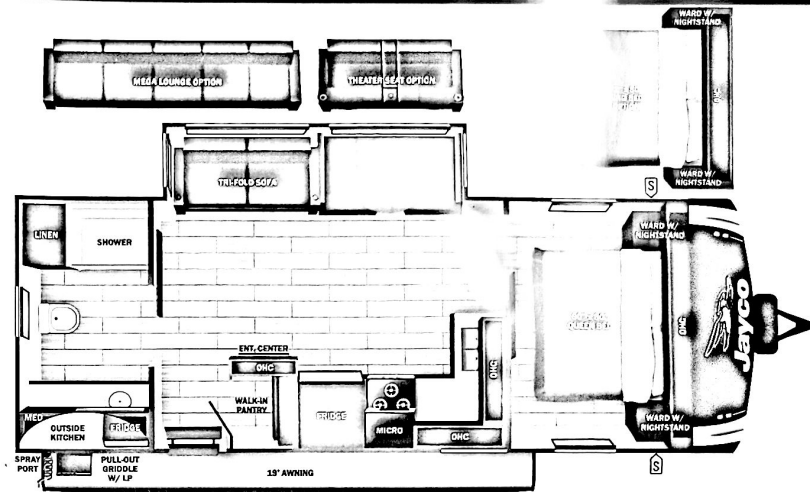

UVW
6335 lbs



Sleeps



Length
30' 0.38"

DIMENSIONS

Exterior height:	128.50"
Exterior width:	96.00"
WEIGHTS	
GVWR:	7500
GAWR (front):	3500
GAWR (rear):	3500
Approx. Gross Cargo Carrying Capacity (GCC):	1165

CAPACITIES

Fresh water tank (gals.):	55.00
Gray water tank (gals.):	60.00
WEIGHTS	
Black water/toilet tank (gals.):	34.00
Propane (lbs.):	40
Propane (gals.):	9
Water heater (gals.):	0.25

SEATING & SLEEPING

TIRES

Tire size (front):	ST205/75R14D
Tire size (mid):	
Tire size (rear):	ST205/75R14D
Tire size (spare):	ST205/75R14D

Some dimensions may be rounded and may vary from the actual dimensions

***Weights may be estimated calculations and may vary from the actual weight

- refer to the vehicle weight labels for actual weights***

Floorplans, features and specifications are subject to change without notice.

2+3
YEAR YEAR
LIMITED STRUCTURAL
WARRANTY