



Jay Flight SLX



Serial #: 1UJBC0BN5R7ZV0089
Model: 260BHW JAY FLIGHT SLX TT

Model Year: 2024 Dealer Name: BISH'S RV OF BOZEMAN
8466 HUFFINE LN
BOZEMAN, MT 59718
USA

Standard Equipment

THE FOLLOWING ITEMS ARE STANDARD ON THIS MODEL
AT NO EXTRA CHARGE

Electric, self-adjusting brakes and
A-frame
Aluminum, impact resistant wheel wells
Weather Guard™ Roof System
Aluminum roof material
Rainwater downspouts
TV hookup
Generator (outside grill prep)
Generator mount A/C (single axle models)
Radial tires

INTERIOR
- Solid hardwood cabinet doors with screwed stile construction and hidden hinges
- Vinyl flooring throughout
- Digital TV antenna
- Residential-style kitchen countertops
- High rise kitchen faucet
- Heavy-duty, 75 lb., full-extension, steel ball-bearing drawer guides
- Plywood bed platforms
- Queen mattress (select models)
- 300 lb. rated single bunk beds
- 600 lb. rated double bunk beds
- Marine-grade toilet with foot flush
- Shower curtain with curved shower track (select models)
- Wood-trimmed mirror in bathroom

CUSTOMER VALUE PACKAGE (Mandatory)
- Solid Step® entry steps
- On-demand tankless water heater
- Power awning with LED lights
- Marine grade exterior stereo speakers
- Stabilizer jacks
- Spare tire with cover
- Keyed-Alike™ entry and baggage doors
- Large folding entry door grab handle
- Window shades
- Range hood
- 8 cu. ft. 12V refrigerator
- Microwave oven
- Fitted bed sheet (N/A 154BH)
- Bathroom skylight
- Tub/shower surround
- AM/FM/Bluetooth® stereo
- Backup camera prep
- Detachable power cord
- Bathroom vent
- Entry door with window and shade prep
- G20 dark tinted privacy windows
- LED interior and exterior lights

Optional Equipment

OPTIONAL EQUIPMENT INSTALLED ON THIS VEHICLE
BY MANUFACTURER

Base price	29,406.00
USA STANDARDS	n/c
CUSTOMER VALUE PACKAGE	5,250.00
OVERLANDER SOLAR PACKAGE	593.00
13,500 BTU ROOF MOUNTED	
AC	593.00
STANDARD RADIAL TIRES	n/c

UNIT TOTAL

35,842.00

DEALER INSTALLED OPTIONS

Manufacturer's Suggested Retail Price

\$35,842.00

TOTAL AMOUNT DOES NOT INCLUDE STATE AND LOCAL TAXES OR LICENSE FEES. THE PRICE SHOWN ABOVE MAY OR MAY NOT BE REPRESENTATIVE OF THE ACTUAL SELLING PRICE OF SIMILAR RECREATIONAL VEHICLES IN YOUR AREA.

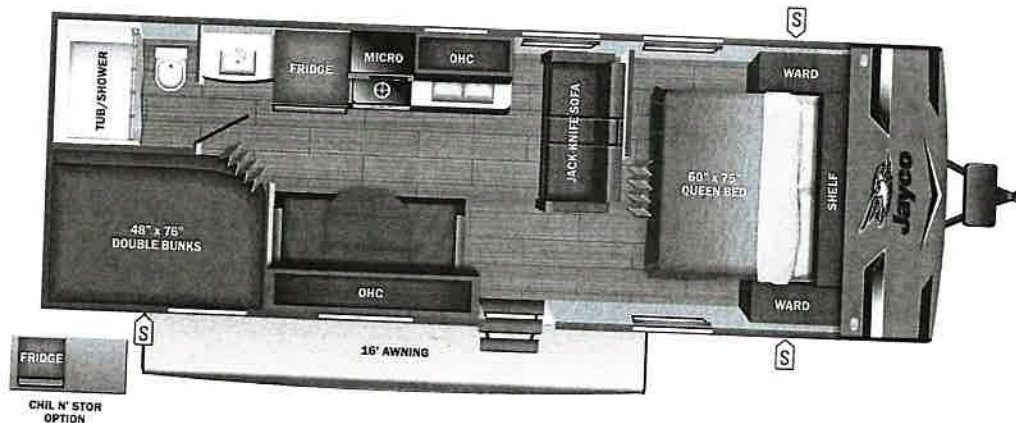

UVW

4796 lbs



Sleeps



Length

29' 5"

DIMENSIONS

Exterior height:.....126.00"

Exterior width:.....96.00"

WEIGHTS

GVWR:.....6000

GAWR (front):.....3500

GAWR (rear):.....3500

Approx. Gross Cargo Carrying Capacity(GCCC):.....1204

CAPACITIES

Fresh water tank (gals.):...84.00

Gray water tank (gals.):...39.00

Black water/toilet tank (gals.):...39.00

Propane (lbs.):.....40

Propane (gals.):.....9

Water heater (gals.):.....0.00

SEATING & SLEEPING

TIRES

Tire size (front):.....ST205/75R14D

Tire size (mid):.....

Tire size (rear):.....ST205/75R14D

Tire size (spare):.....ST205/75R14D

me dimensions may be rounded and may vary from the acutal dimensions***
ights may be estimated calculations and may vary from the actual weight
fer to the vehicle weight labels for actual weights***
plans, features and specifications are subject to change without notice.

2+3
YEAR | YEAR
LIMITED | STRUCTURAL
WARRANTY