

73296

Jay Flight



Jayco®

Serial #: 1UJBC0BL2R75Z0116
Model: 212QBW JAY FLIGHT TT

Model Year: 2024 Dealer Name: BISH'S RV OF BOZEMAN

8466 HUFFINE LN.
BOZEMAN, MT 59718
USA



Standard Equipment

THE FOLLOWING ITEMS ARE STANDARD ON THIS MODEL AT NO EXTRA CHARGE

- EXTERIOR**
- 20 lb LP bottles with Cover (2)
 - Enclosed underbody
 - Easy-lube hubs
 - Class™ cambered structural steel I-beams
 - Fully integrated A-frame
 - Aluminum "push" floor system with plywood decking
 - Seamless one piece roof material
 - Large exterior downspouts
 - Galvanized steel, impact-resistant wheel wells
 - Exterior TV mount and bracket
 - LP quick connect (outside gas grill prep)
- BAJA EDITION**
- (2) 30 lb LP bottles
 - Flipped Aisle
 - 16 GoCovers® Off-Road Tires
 - Triple Steps

Optional Equipment

OPTIONAL EQUIPMENT INSTALLED ON THIS VEHICLE BY MANUFACTURER

INTERIOR	Base price	34,100.00
- 81 in ceiling height	USA STANDARDS	n/c
- Snowretentive surround	CUSTOMER VALUE PACKAGE	5,250.00
- J Steel™ Jackknife sofa with armrest & cup holders (most models)	NO BAJA EDITION	n/c
- V-Vinyl flooring throughout (including slide floors)	13,500 BTU AC	n/c
- Residential-style kitchen countertops	24" LED SMART TV	443.00
- Residential-style kitchen counter tops	METAL SIDEWALL	n/c
- Heavy-duty, 75 lb., full-extension, steel ball-bearing drawer guides charging station	TOTAL FOL	563.00
- Queen mattress	BLACK SPOKE RIMS	n/c
- Plywood bed platforms	30# LP GAS BOTTLES	113.00
- 30# LP gas bottles (select models)	ROOF LADDER (STD)	n/c
- 600 lb. rated bunk beds (double bunks)		
- Privacy curtains in bunk areas (select models)		
- Vented dark windows (select models)		
- Vented dark windows (select models)		
- Wooden bedroom doors (select models)		
- Shower curtain with curved shower track (select models)		

- CUSTOMER VALUE PACKAGE (Mandatory)**
- Goodyear® Endurance® tires (made in the USA)
 - On-demand tankless water heater
 - Keyed Alike™ entry and baggage doors
 - Power awning with LED lights
 - Marine-grade exterior speakers
 - Black tank flush
 - Rock Solid stabilizer system
 - Overlander 1 Solar Package (1) 200W solar panel and 30-amp digital controller
 - Power tongue jack
 - Range hood
 - Oven with 3-burner recessed cooktop with glass cover
 - Fitted bed sheet
 - Bathroom skylight
 - Sink cover
 - 100% medicine cabinet
 - Solid Step® entry steps (NA 3800DS)
 - 13.5K BTU AC
 - AM/FM Bluetooth® stereo
 - Backup and side view camera prep
 - Detachable power cord
 - G20 dark tinted privacy windows
 - Inverter prep wire
 - Inverter prep wire
 - LED exterior and interior lights
 - One piece front fiberglass exterior wall
 - Seamless countertops

UNIT TOTAL

40,469.00

DEALER INSTALLED OPTIONS

Manufacturer's Suggested Retail Price \$40,469.00

TOTAL AMOUNT DOES NOT INCLUDE STATE AND LOCAL TAXES OR LICENSE FEES. THE PRICE SHOWN ABOVE MAY OR MAY NOT BE REPRESENTATIVE OF THE ACTUAL SELLING PRICE OF SIMILAR RECREATIONAL VEHICLES IN YOUR AREA.

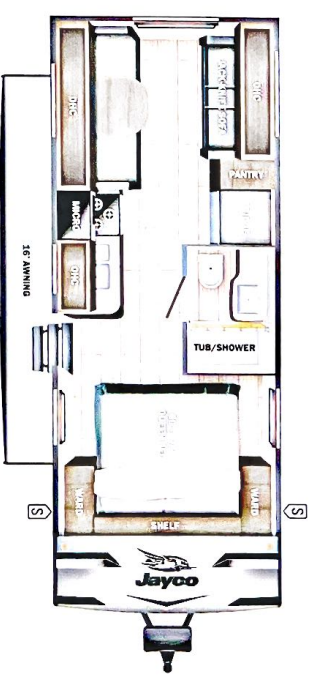

UVW
4492 lbs

Sleeps

Length
25' 8"

DIMENSIONS	CAPACITIES
Exterior height:.....132.00*	Fresh water tank (gals.):.....84.00
Exterior width:.....96.00*	Gray water tank (gals.):.....39.00
WEIGHTS	Black water/coilet tank (gals.):.....32.50
GWR:.....6000	Propane (lbs.):.....60
GVWR (front):.....3500	Propane (gals.):.....14
GVWR (rear):.....3500	Water heater (gals.):.....0.00
Approx. Gross Cargo Carrying Capacity (GVCC):.....1508	
SEATING & SLEEPING	
TIRES	
Tire size (front):.....ST205/75R14D	
Tire size (mid):.....ST205/75R14D	
Tire size (rear):.....ST205/75R14D	
Tire size (spare):.....ST205/75R14D	

Some dimensions may be rounded and may vary from the actual dimensions
 Weights may be estimated calculations and may vary from the actual weight
 - refer to the vehicle weight labels for actual weights***
 Floorplans, features and specifications are subject to change without notice.

