

Stock # 65013

North Point



Serial #: 1UJCD0BT9P1LB0057
Model: 310RLTS NORTH POINT FW

Model Year: 2023 Dealer Name: BISH'S RV OF LONGVIEW
5009 JUDSON RD
LONGVIEW, TX 75605
USA

Standard Equipment

Optional Equipment

THE FOLLOWING ITEMS ARE STANDARD ON THIS MODEL AT NO EXTRA CHARGE

OPTIONAL EQUIPMENT INSTALLED ON THIS VEHICLE BY MANUFACTURER

- EXTERIOR**
- 12 in. structural steel I-beam with 10 in. steel drop frame
 - Stronghold VBL™ aluminum framed and vacuum bond laminated gelcoated fiberglass exterior walls (including rear wall and side room end walls)
 - Magnum Truss™ XL6™ Roof System (strongest tested roof in the industry) with one-piece, seamless roof material with a 20 year warranty
 - Climate Shield™ zero-degree tested weather protection
 - Fully-enclosed and heated underbelly (ducted)
 - 40,000 BTU output furnace
 - Double layer fiberglass batt insulation (roof & floor)
 - PEX plumbing, 2 in. block foam & reflective foil
 - JaySMART™ (Safety Markers And Reverse Travel) LED lighting (patented)
 - Painted fiberglass front cap with double clear coat and built-in specialty LED lighting
 - Frameless, dark tinted, safety-glass windows
 - Custom automotive-grade vinyl exterior graphics package
 - Skirt metal enclosed drop frame
 - LED exterior lighting package
 - Dual 30 lb. propane bottles with auto regulator
 - Doorside compartment framed and vented for third propane bottle
 - Pass-through storage with Slam-latch™ baggage doors
 - Digital TV antenna with Wi-Fi extender
 - Exterior manne-grade speakers
 - Fully enclosed, universal docking center:
 - Selectable water connections
 - Quick-connect outside shower
 - Black tank flush
 - Wintenzation and sanitation
 - Independent satellite wiring
 - Whole coach cable hookups
 - Water heater bypass
 - Battery disconnect
 - Under-mounted spare tire (16 in. Goodyear® Endurance tire)
 - JayPort system for outside griddle (all floorplans without a standard outside kitchen)
 - Built in sewer hose carrier
 - 3,000 lb. low hitch with 4-way pin
 - Inverter pre-wire to select outlets

- CUSTOMER VALUE PACKAGE (MANDATORY)**
- 15,000 BTU "Whisper Quiet" A/C (main)
 - 15,000 BTU "Whisper Quiet" A/C (bedroom)
 - Electric patio awning with integrated LED lights
 - Gas/electric DSI water heater
 - Custom machined aluminum rims
 - Keyed-Alike™ lock system (single key for all doors/locks)
 - Rooftop and ground solar prep
 - Backup, main entrance door and side observation security camera prep (includes a power switch in the bedroom to use the optional 7 in. monitor for security)
 - XL grab handle
 - 50 in. 4K Smart LED HDTV with fully digital HDMI® output & two extra HDMI cables
 - Home entertainment system with subwoofer
 - Hidden hinges on cabinet doors
 - Refrigerator temperature sensors linked to JAYCOMMAND®
 - Residential king (72 in. x 80 in.) mattress with underbed storage
 - Wireless remote control system (includes Bluetooth® wireless controls) with dimmer switches

- INTERIOR**
- Solid hardwood slide fascia
 - Handcrafted hardwood glazed doors and drawers
 - 5/8 in. tongue-and-groove joined plywood floor decking
 - Vinyl flooring throughout (includes slide floors)
 - Ceiling fan (select models)
 - LED interior lighting w/ accents above slides
 - Tri-fold hide-a-bed sofa with residential sleep surface (select models)
 - Dual USB charging ports throughout
 - "Shoe garage" in hallway step (select models)
 - Flip-up tabletop storage next to tri-fold sofa (select models)
 - JayVoice voice command system - controls lighting, A/C and furnace
 - Soft close, heavy-duty, 75 lb. full-extension, steel ball-bearing drawer guides
 - Stainless steel kitchen sink
 - Pull-out spice rack above microwave (select models)
 - Residential-grade, pull-out kitchen faucet
 - Extra 120V power outlets in kitchen and slide rooms
 - Flip-up countertop extension with 24 in. x 24 in. butcher block bar top (select models)
 - Pull-out utility drawer under kitchen sink
 - Toe kick nightlights in bedroom and bathroom
 - Residential quilted bedspread and pillows
 - Gas-strutted under-bed storage
 - C.P.A.P. prepped bedroom (includes 120V outlets and night stands with cup holders)
 - Carbon monoxide and LP detector
 - Flip-up hidden storage in bedroom chest of drawers (select models)
 - Built-in laundry hamper in wardrobe (select models)
 - Cup holders in bedroom nightstands
 - Bathroom skylight
 - LED backlit custom framed mirror and medicine cabinet
 - Porcelain toilet with foot flush
 - Vessel bowl sink with high rise faucet in main bathroom

- LUXURY PACKAGE (MANDATORY)**
- 6-point hydraulic auto-leveling system
 - 2nd electric patio awning with integrated LED lights
 - MORryde® StepAbove™ entrance steps with stirrup assist (main entrance)
 - JAYCOMMAND® "Smart RV" system
 - Cellular prep for 4G WiFi repeater and JAYCOMMAND® "Smart RV" system
 - High gloss gelcoated sidewalls
 - Oversized multi-battery compartment (industry leading room for 4-6 batteries)
 - Frameless dark tinted safety-glass windows
 - Privacy roller shades
 - Free-standing (no pedestal) table with leaf and (2) free-standing and (2) folding chairs
 - LED fireplace with electric space heater
 - Central vacuum system with dust port
 - Fresh Water Drinking System (patent-pending) (connects to ice maker)
 - 30 in. residential microwave
 - 21 cu. ft. residential refrigerator with 1800W inverter
 - Residential 24 in. Indignia™ stove (3.73 cu. ft. with 12,000 BTU high output burner)
 - Residential solid-surface kitchen countertop with bamboo sink cover and strainer
 - Washer/dryer prep
 - 32 in. 4K Smart bedroom TV
 - Residential walk-in shower with shampoo/soap holder and teak seat
- 5 STAR HANDLING PACKAGE (MANDATORY)**
- 16 in. Goodyear® Endurance tires
 - MORryde® rubber pin box
 - Dexter® Axles with Nev-R-Adjust® brakes, E-Z Lube® hubs, & 4,000 lb. leaf springs
 - MORryde® CRE-3000™ rubberized suspension
 - Wet bolt fasteners and bronze bushings

Base price	107,400.00
Modern Farmhouse USA Standards	n/c
Customer Value Package w/15,000 BTU AC & Heat Pump	4,875.00
North Point Luxury Package	10,200.00
Five Star Handling Package	n/c
Overlander II Solar Package	1,943.00
Extreme Weather Package	743.00
Roof Vent in Living Room	n/c
18 Cu. Ft. 2-Way Refrigerator	2,243.00
Generator LP Prep	1,193.00
Gas/Electric DSI Water Heater	n/c
Pre-Wired Sanicon Dump System	n/c
Backup, Side and Entry Door Observation Camera w/7" monitor	1,365.00
Tinted Safety Glass Windows	n/c
Roof Ladder (Std)	n/c
Outside Griddle for JayPort System	443.00
Electronic Drum Brakes	n/c
King Bed	n/c
Full Glue (Linoleum Requires Full Glue)	n/c

UNIT TOTAL 130,405.00

DEALER INSTALLED OPTIONS

Manufacturer's Suggested Retail Price \$130,405.00

TOTAL AMOUNT DOES NOT INCLUDE STATE AND LOCAL TAXES OR LICENSE FEES. THE PRICE SHOWN ABOVE MAY OR MAY NOT BE REPRESENTATIVE OF THE ACTUAL SELLING PRICE OF SIMILAR RECREATIONAL VEHICLES IN YOUR AREA.

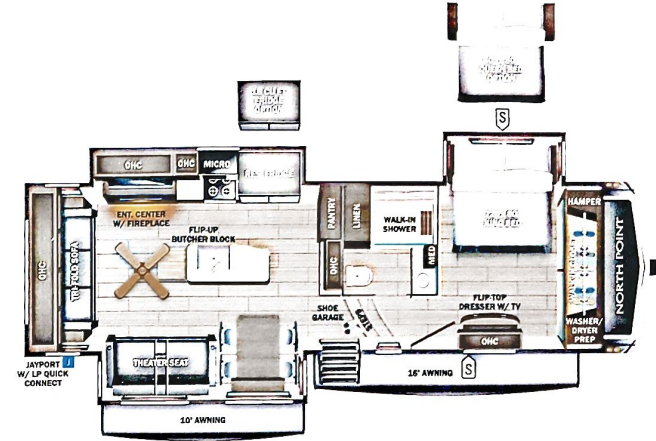

lb U/VW 12579 lbs **Sleeps** 2 **Length** 36' 1"

DIMENSIONS

Exterior height:.....161.25"
Exterior width:.....95.75"

WEIGHTS

GVWR:.....15460
GAWR (front):.....7000
GAWR (rear):.....7000

Approx. Gross Cargo Carrying Capacity (GCC):.....2881

CAPACITIES

Fresh water tank (gals.):...75.00
Gray water tank (gals.):...87.00
Black water/toilet tank (gals.):...50.00
Propane (lbs.):.....120
Propane (gals.):.....28
Water heater (gals.):.....12.00

SEATING & SLEEPING

TIRES

Tire size (front):.....ST255/85R16E
Tire size (mid):.....
Tire size (rear):.....ST255/85R16E
Tire size (spare):.....ST255/85R16E

Some dimensions may be rounded and may vary from the actual dimensions
Weights may be estimated calculations and may vary from the actual weight
- refer to the vehicle weight labels for actual weights***
Floorplans, features and specifications are subject to change without notice.

