



# ADLAR



**GO ANYWHERE.. CAMP ANYWHERE.**

## **SOARING EAGLE CAMPER**

**Affordable, Lightweight, Truck Campers for Outdoorsmen & Families!**







# SOARING EAGLE CAMPERS

Each Soaring Eagle Camper is constructed using strong, welded, tubular aluminum - not wood - and features studs located a minimum of 16" on center. In addition, we use 3" tubes in the cabover and where the bedslide is located. Every opening is framed with aluminum tubing to make sure these campers are structurally sound in order to handle the rigors of the road as well as off-road adventures.



Each individual component of the structure is hand welded together, and after it is screwed and bolted together, we

take the extra step of welding the individual components together to form a true UNI-BODY construction that will stand the test of time and provide your family with years of carefree adventures! Our goal is provide the best built, most durable, best value for your investment and this is how we achieve that.



For decades, many entry level truck campers have been built using mostly wood for their structure. That is something you will never find at SOARING

EAGLE CAMPERS. We construct our campers using all-welded, tubular aluminum. The sidewalls, floor, end walls and roof of a Soaring Eagle are ALL crafted from strong, yet



**NO WOOD - NO ROT!!**

lightweight aluminum, which results in our ADLARs being the best constructed truck campers on the market!

That is important because a lot of our competition laminate their walls with only perimeter aluminum and try to claim that "the strength is in the foam". Don't fall for that. You work too hard for your money to invest it in an inferior product.



# BUILT BETTER

**The Most Important Aspect of Any Camper is How Well it is Built.  
What is Underneath All of the Eye Appeal?**



Look at all of this strong, tubular aluminum structure! As part of that structure, each ADLAR is well insulated with a combination of block foam and bubble foil. Then, the interior wall and ceiling coverings as well as our seamless exterior fiberglass are each backed with a composite layer (not thin luan wood like our competition) which resists moisture and adds additional R-value to the camper. The result is a Soaring Eagle Camper ends up being much like a big cooler/ice chest with the structure being unaffected by moisture as it holds its temperatures - both hot and cold - very well.

## ATTENTION TO DETAIL

The dinette bases in the ADLAR are constructed of rugged yet lightweight composite material. While this unique dinette structure appears to be overkill compared to the competition's wood and paneling constructed dinettes, it is worth it! They are not only much stronger and more durable, but also feature storage space as well as a built-in battery box. THIS is how you construct a dinette base!

NO MORE COMPLICATED TIE DOWN SYSTEMS! When it comes to securing an ADLAR truck camper in the bed of a truck, it doesn't get much easier than our retractable ratchet strap system. These easy to use straps allow our owners to quickly and easily attach the camper to the tie down points in the bed of the truck.





# UNIQUE INNOVATION

## DESIGNED TO FIT INSIDE THE BED OF YOUR TRUCK WITH THE TAILGATE UP!

Being able to close your tailgate with the camper IN the truck - and continuing to utilize your rear view camera and built-in steps - is a game changer that literally changed the entire truck camper market! When Soaring Eagle launched in 2021, we literally changed the game, forcing many of our competitors to redesign their campers to try and mimic our innovation. Each Adlar model offers the ability to have the camper in your truck with the tailgate closed - in most models of trucks. That means you can still utilize all of the functions of your tailgate including the rear camera, parking sensors and built-in steps while knowing that camper is not going anywhere while traveling!



Truck campers continue to grow in popularity every day as they allow you to take your fishing boat, ATVs, etc. or just go completely off road exploring places where people towing travel trailers might never see or experience!

Anywhere your truck can go, you can set up camp and enjoy nature at its finest.

**GO CAMPING  
WHERE EVER  
YOUR TRUCK  
CAN TAKE  
YOU - WITH A  
SOARING  
EAGLE  
CAMPER!**



**Explore the World - From Your Truck**



ADOLAR



**TRUE HALF-TON TRUCK CAMPERS THAT WILL  
NOT OVERLOAD YOUR TRUCK!**



**Ranging in weight from ONLY 950 lbs. – 1,280 lbs.!**



# FAMILY FRIENDLY w/ Sleeping for 4



Load up your gear and GO! Soaring Eagle Campers are perfect for half-ton truck owners and even smaller trucks. The overall interior spaciousness afforded by the ADLAR XL interior will surprise you, with plenty of headroom, along with a roomy dinette, 12V refrigerator and loads of counter top and storage space.

Shown above with an optional bat-wing awning, the ADLAR offers comfortable sleeping areas in the upper cabover, as well as in the dinette that quickly converts into a secondary sleeping area.

The pull-out queen bed is perfect for two adults, but is also wide enough to sleep three in a pinch.





# ADLAR XL



**ENJOY THE COMFORTS OF HOME WHILE CAMPING!**



You'll appreciate the convenience afforded by the ADLAR's standard 12V refrigerator with freezer compartment. This roomy little fridge can hold a good amount of food and drinks when traveling. This ADLAR XL model is available for all size truck beds, from 5.5' to 6.5' to 8.0'.







## THE ADLAR XL MODELS – Offering a quiet retreat to relax, eat, play games and sleep.

You will find the ADLAR models surprisingly spacious. Four windows provide great ventilation while making the interior feel even larger, while providing a great view of your surroundings. The composite dinette bases offer a ruggedness not found in the pine and paneling built dinettes of our competitors, and also feature built in storage areas, as well as a built-in battery box with room for multiple batteries.

The large cabinet on the passenger side can hold an optional microwave oven or our optional TRUMA Vario Furnace for those camping in very cold climates.





# ADLAR XLS



## XLS MODEL – For Those Looking for More of a Kitchen.

For those looking for more of a kitchen in their ADLAR camper, we have the XLS model in both the 6.5 and 8.0 size. Offering a lot of countertop space and kitchen amenities on one side and a roomy side-by-side dinette on the other.



What about heat? There are a number of options for heating an ADLAR including simply using an inexpensive portable heater; the optional roof A/C with heat pump; or an optional TRUMA Vario LP furnace.



## EXPERIENCE FREEDOM





The ADLAR XLS models offer plenty of room for meal preparation and food storage. Choose from a induction cooktop or a Blackstone griddle - both of which are portable - and can be utilized outside the camper.

The sink offers a convenient way to wash your hands or the dishes.



A swivel dinette table allows easy access to the dinette - which quickly and easily converts to a secondary sleeping area for kids.

# HOME AWAY FROM HOME

**GO ANYWHERE - CAMP ANYWHERE!**



**97% of the Earth is unpaved... Get out there and explore it!**



# ADLAR 5.0 & 6.0



The ADLAR 5.0 will fit comfortably in just about any small truck model including the Tacoma, Ranger, Gladiator, Colorado, Canyon, Ridgeline and more!



The Adlar 5.0 and 6.0 models have opened up truck camping to millions more truck owners than ever before! Whether your truck has a 5' bed or a 6' bed, we have an ADLAR model that is perfect for you.

## DESIGNED SPECIFICALLY FOR THE SMALL TRUCK MARKET!

The dinette is great for quick meals or playing games and quickly changes into a secondary sleeping area.

The MaxxAir fan with rain sensor and remote keeps the interior comfortable, while the 12V refrigerator stores all your food and drinks. Popular options include a roof A/C, microwave oven, quick-detach jacks and more.





# OFFERING ALL THE FEATURES AND AMENITIES AS OUR LARGER ADLARS!



You will appreciate the extra floor and countertop space for your camping gear.

NO LONGER do small truck owners have to settle for awkward roof top tents that are difficult to climb up into to accommodate their camping needs! Soaring Eagle had designed two models (the ADLAR 5.0 and 6.0) specifically for the small truck market in mind. Each a fully-enclosed, slide-in truck camper that is family friendly - sleeping two adults and kids!

The best part is, these campers are the RIGHT WEIGHT for these small trucks, so they will not over stress your engine like some models on the market.

## Fits Most Small Trucks with the Tailgate Closed!





# OVERLAND PKG.



## NOW AVAILABLE ON EVERY ADLAR MODEL!

Designed for those who want to get off the grid and explore, the new OVERLAND Package option offers a wrap-around batwing awning, exterior molle boards, rotopax, exterior shower surround, water port with sprayer, quick-detach jack brackets, roof racks, and topographical exterior graphics! Additional roof solar/battery/power inverter packages are also available to extend your time off of the grid. See your dealer for more information and details.





## MODELS FOR SMALLER SIZE, QUARTER-TON TRUCKS

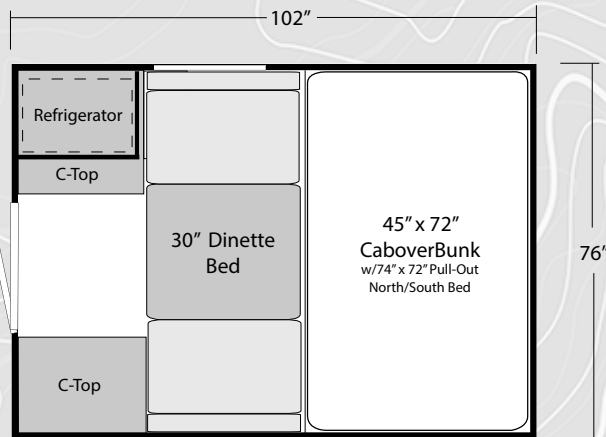

900\* lbs.

1,050 lbs. w/popular options

**ADLAR 5.0**

Floor 41 x 57

\*NOTE: This is the weight with the jacks off of the camper. Our quick-detach jack brackets option allows you to take approximately 115 lbs. off of the camper when traveling.

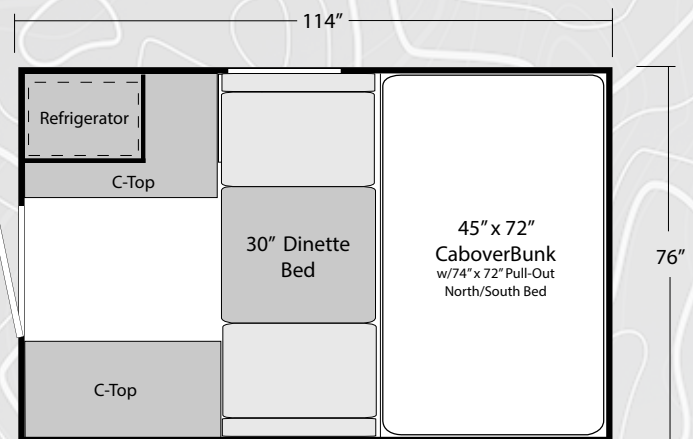

924\* lbs.

1,100 lbs. w/popular options

**ADLAR 6.0**

Floor 41 x 69





# MODELS FOR FULL SIZE, HALF-TON TRUCKS

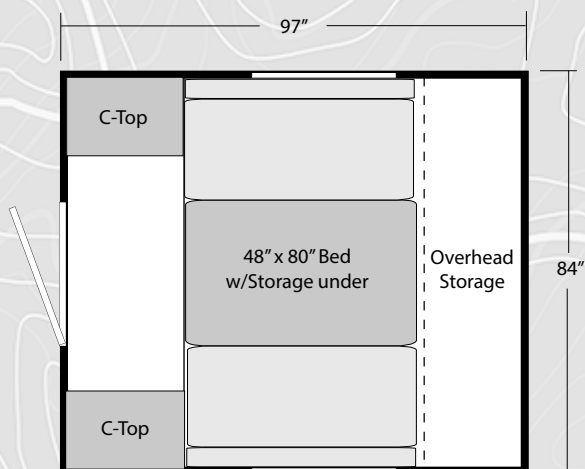

850 lbs.  
960 lbs. w/popular options

**ADLAR 6.5**  
Floor 49 x 75

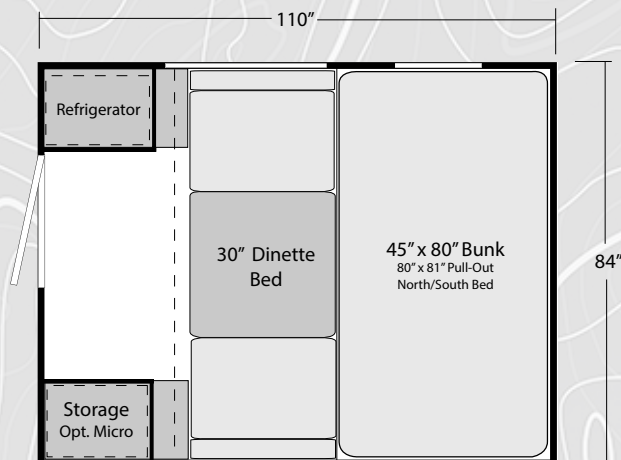

1,120 lbs.  
1,230 lbs. w/popular options

**ADLAR 5.5XL**  
Floor 49 x 64

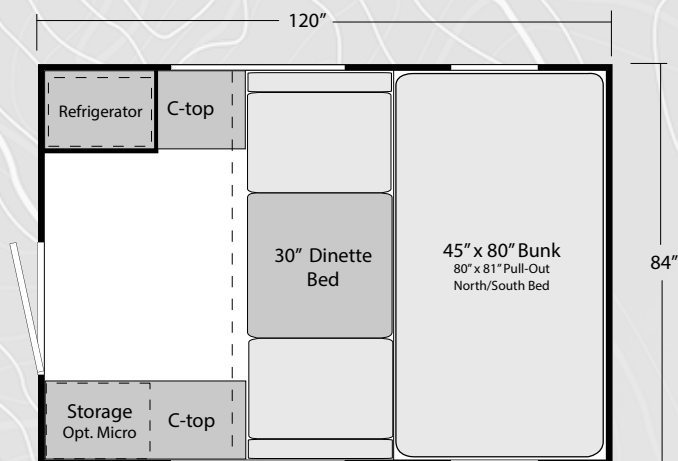

1,150 lbs.  
1,260 lbs. w/popular options

**ADLAR 6.5XL**  
Floor 49 x 75

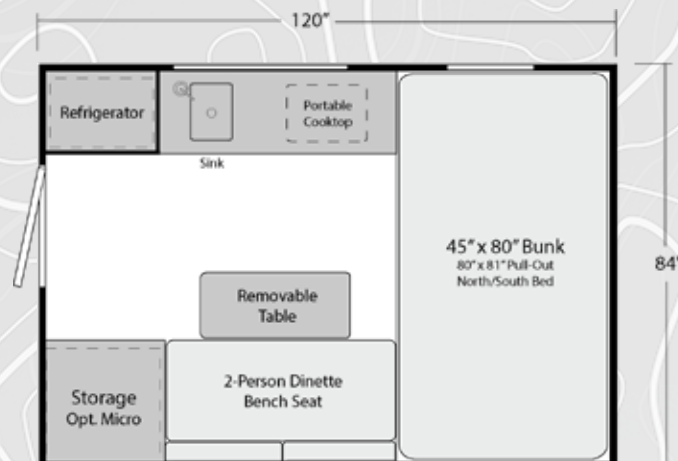

1,185 lbs.  
1,295 lbs. w/popular options

**ADLAR 6.5XLS**  
Floor 49 x 75

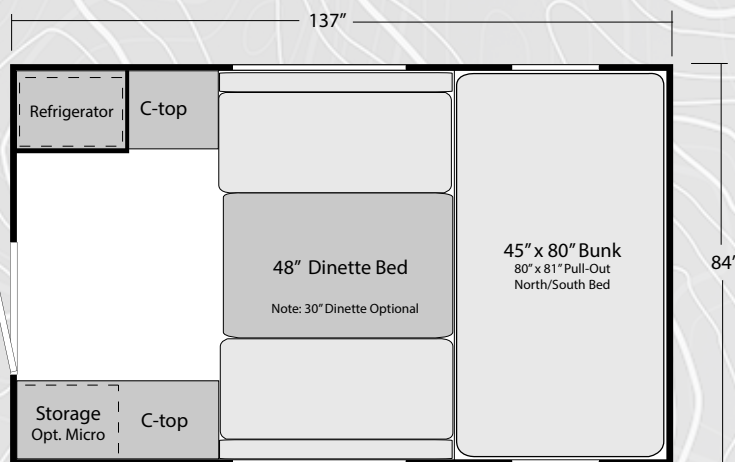

1,240 lbs.  
1,350 lbs. w/popular options

**ADLAR 8.0XL**  
Floor 49 x 91

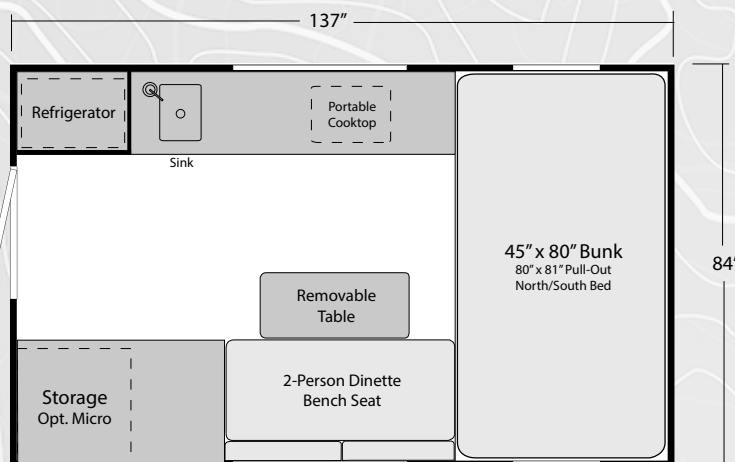

1,275 lbs.  
1,385 lbs. w/popular options

**ADLAR 8.0XLS**  
Floor 49 x 91



**Helping you make lasting Family Memories.**



## **SOARING EAGLE CAMPERS ARE NOT CHEAP.**

**It's not cheap to build a truck camper using all welded, tubular aluminum framing and composites instead of wood.**

**It's not cheap to use 3" tubular aluminum in parts of our structure and cover the entire unit with one-piece, seamless fiberglass.**

**It's not cheap to craft an all-aluminum basement storage area to allow the main floor to expand side to side in the truck.**

**It's not cheap to put the super-efficient TRUMA Combi furnace and water heater in our camper as Standard in place of a typical RV system.**

**It's not cheap to use automotive grade foam in our seating and to use a residential style mattress in our bed.**

**We could make it cheap, but then it wouldn't be a Soaring Eagle Camper!**

Photos, images text and specifications in this brochure as subject to change without notice or obligation to Soaring Eagle Campers, Inc.  
Due to different truck model year changes and the ever changing truck bed specifications, we cannot guarantee that these campers will fit in every year and model of truck bed with the tailgate closed. Compare actual measurements of your truck and the camper prior to purchasing.  
See your nearest Soaring Eagle Campers dealer to review a camper in person.

**ADLAR**  
**PROUDLY**  
**MADE IN THE**  
**USA**



**SOARING EAGLE CAMPERS**

1025 E. WATERFORD  
WAKARUSA, IN 46573

[www.SOARINGEAGLECAMPERs.com](http://www.SOARINGEAGLECAMPERs.com)

Email us at [inquire@soaringeaglecampers.com](mailto:inquire@soaringeaglecampers.com)