

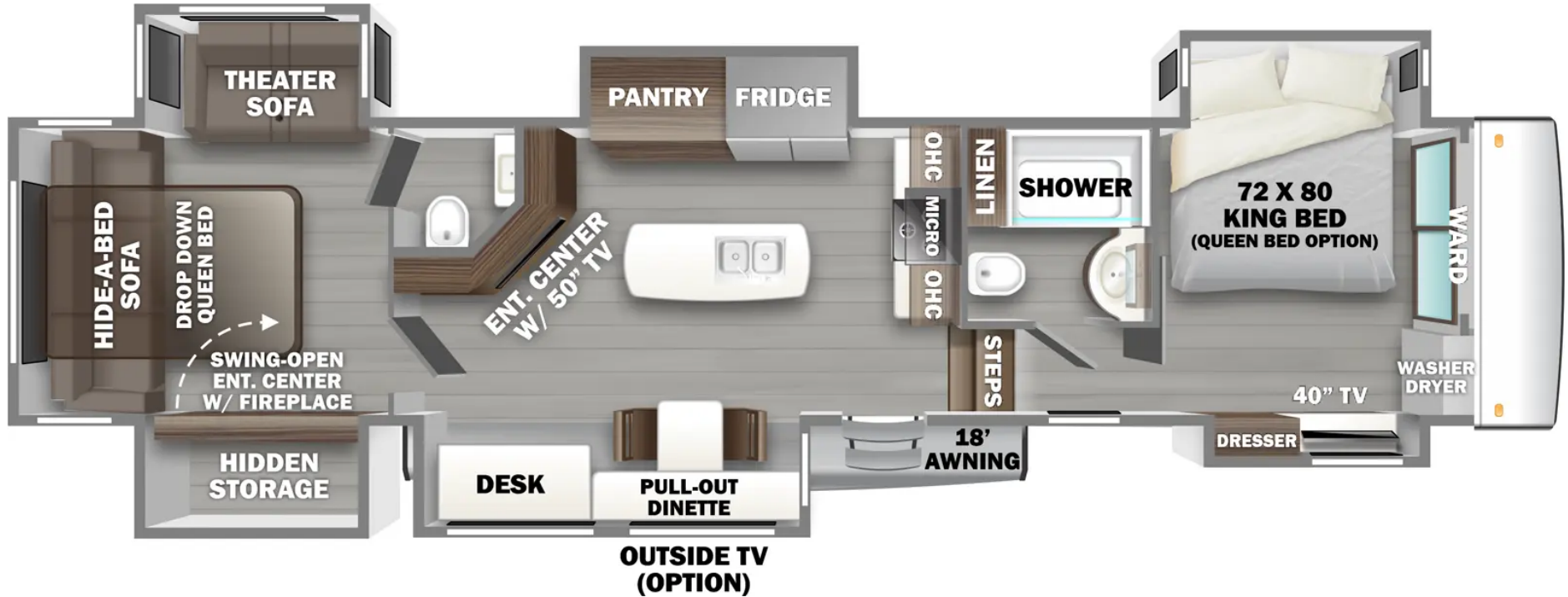

442MC



Hitch Weight	2,805 lb.	GVWR	21,000 lb.
UVW	19,131 lb.	CCC	1,869 lb.
Exterior Length	44' 4"	Exterior Height	13' 4"
Exterior Width	102"	Fresh Water	79 gal.
Gray Water	80 gal.	Black Water	40 gal.

Awning Size

18'

Specifications Definitions

GVWR (Gross Vehicle Weight Rating) – is the maximum permissible weight of the unit when fully loaded. It includes all weights, inclusive of all fluids, cargo, optional equipment and accessories. For safety and product performance do NOT exceed the GVWR.

GCWR (Gross Combined Weight Rating) – is the maximum permissible loaded weight of your motor home and any towed trailer or towed vehicle. Actual GCWR of this vehicle may be limited by the sum of the GVWR and the installed hitch receiver maximum capacity rating; see hitch rating label for detail.

GAWR (Gross Axle Weight Rating) – is the maximum permissible weight, including cargo, fluids, optional equipment and accessories that can be safely supported by a combination of all axles.

UVW (Unloaded Vehicle Weight)* – is the typical weight of the unit as manufactured at the factory. It includes all weight at the unit's axle(s) and tongue or pin and LP Gas. The UVW does not include cargo, fresh potable water, additional optional equipment or dealer installed accessories.

*Estimated Average based on standard build optional equipment.

CCC (Cargo Carrying Capacity) ** – is the amount of weight available for fresh potable water, cargo, additional optional equipment and accessories. CCC is equal to GVWR minus UVW. Available CCC should accommodate fresh potable water (8.3 lbs per gallon). Before filling the fresh water tank, empty the black and gray tanks to provide for more cargo capacity.

**Estimated Average based on standard build optional equipment.

Each Forest River RV is weighed at the manufacturing facility prior to shipping. A label identifying the unloaded vehicle weight of the actual unit and the cargo carrying capacity is applied to every Forest River RV prior to leaving our facilities.

The load capacity of your unit is designated by weight, not by volume, so you cannot necessarily use all available space when loading your unit.

Actual towing capacity is dependent upon your particular loading and towing circumstances, which includes the GVWR, GAWR and GCWR as well as adequate trailer brakes. Please refer to the Operator's Manual of your vehicle for further towing information.

Note: Specifications are subject to change without notice.

STANDARD INTERIOR PACKAGE

- Insignia 3.7 CU. FT. oven with 4-burner range
- Upgraded Calcutta Solid Surface Countertop in Kitchen
- Large Stainless Steel Kitchen Sinks with Residential Faucet
- 18 CU. FT. French Door Refrigerator with Ice Maker
- Residential Soft Close Drawer Glides
- Shaw Residential Vinyl Flooring
- LED Lighting Throughout
- 30" Stainless Steel Microwave
- Oval Porcelain Toilet with Foot Flush
- Central Vacuum System
- 40,000 BTU Furnace
- 10" Thick Memory Foam Mattress 72"x80" Standard (Toy haulers 66"x80")
- Shaw Stain Resistant Carpet (in slide rooms)
- Day/Night Roller Shades Throughout
- 5,200 BTU Fireplace in Living Room
- Butcher Block Cutting Board Sink Covers
- Overhead Storage Cabinets in Main Level Living Room

- Sofa/Desk Slides
- Residential Soft Close Hinges on Cabinet Doors
- Under-Bed Storage Compartment
- Residential Tile Backsplash

STANDARD EXTERIOR PACKAGE

- Residential Insulation: R-16 Insulation Value in Side Walls. Includes Slide Rooms.
- R-38 Insulation Value in Roof and Flooring
- 5/8" Plywood Roof Decking
- Dicor Full Wrapped Exterior Roof Skin
- 17.5" H-Rated Cooper Tires with Aluminum Rims
- Hydraulic Slide-outs on Main Level and Bed Slides
- Solera Electric Awning with LED Lights
- Side Turning Lights
- Trail-Aire Road Armour Suspension System
- 3" Hung Glass Exterior Walls with High Gloss Gel Coat Exterior
- Riverstone Tandem 8,000 lb. Axles/7,000 lb. Tri-Axles
- 32" x78" Entry Door with Friction Hinges
- Dual Pane Frameless Windows
- Full Docking Station
- Two 15,000 BTU High Performance Quiet Cool A/Cs
- Painted Full Front and Rear Fiberglass Caps (N/A 37FLTH, 42FSKG and 419RD – front caps only)
- 12V Powered 50 Amp Cord Reel

- MORryde Entry Step at Main Door
- Two Dual 6V or 12V Slide-Out Battery Trays
- High Visibility Chrome LED Tail Lights
- 2" Hitch Receiver for Bike Rack (N/A in Toy Hauler Models)
- Dual 40 lb. LP Tanks

RIVERSTONE LUXURY PACKAGE (MANDATORY)

- Automatic 6-Point Hydraulic Level-Up System
- Four Camera Observation System Prep
- King WiFi Max Router and Omni Directional WiFi Antenna/Extender
- Splendid "Astral" Stackable Washer and Dryer
- 40" LED TV in Bedroom
- Stained Hardwood Cabinetry and Stiles Throughout
- 12V Heated Holding Tanks
- Large Infiniti Light over Kitchen Island (NA on 39FSK or 42FSKG)
- Fischer Paykal Dishwasher
- Ceiling Fan (N/A on 39RBFL)
- Truma Aqua Go Comfort On-Demand Hot Water Heater
- LP Generator Prep
- Energy Management System
- Tank Sensors Display (Grey, Black and Fresh) Integrated with Firefly Readout
- Tire Pressure Sensors
- Additional Campside Awning w/Weathershield

ULTIMATE ELECTRONICS PACKAGE (MANDATORY)

- 65" Samsung LED Smart TV in Living Room (55" TV in 37FLTH and 39RBFL)
- JBL Premium Sound System
- 1,500W Inverter
- Firefly Integrated Touch Control System
- 190W Solar Panel with 30Amp Controller
- Pre-Wire Prep for 2 Additional Solar Panels

OPTIONAL LEGACY PACKAGE

- Full Body Paint
- Hydraulic Disc Brakes
- 3rd High Performance AC w/ Heat Pump
- 17.5" H Rated Good Year Tires
- Cordless Vacuum
- 2 Folding Chairs
- LCI Waste Mater System

ADDITIONAL OPTIONS

- 3rd A/C (15,000BTU) with Heat Pump
- Heat Pump on Bedroom A/C
- 5.5 Onan Marquis Gold LP Generator
- Cadet Wall Mounted Electric Heater in Bedroom
- Trail Air 21K Hitch
- Good Year 17.5" H Rated Tires—Tandem Axle

- Four Camera System with 7" Monitor Screen—
Rear, Side and Entry Door Views
- Slide Room Awning Toppers with Metal Weather Shields
- Two Additional 190W Solar Panels
- MORryde Independent Suspension System
- King Tailgater One-Pro Roof Mounted Satellite
- Full Body Paint
- Hydraulic Disc Brakes
- 40" Outside TV (N/A on 42FSKG and 37FLTH)
- 13CF Side by Side Gas/Electric Refrigerator with Wood Fronts (N/A in FSK, 42FSKG, 39RKFB)
- 30" Stainless Steel Convection Microwave Oven
- Stone Pattern Flooring
- Two Folding Chairs
- Queen Bed Suite IPO King Bed Suite
- Carpet on Bedroom Floor IPO Vinyl