

2011

Jay Feather

LITE WEIGHT TRAVEL TRAILERS BY JAYCO



JAY FEATHER SPORT

JAY FEATHER SPORT
EXPANDABLE

JAY FEATHER SELECT

JAY FEATHER SELECT
EXPANDABLE



Jayco®

AMERICA'S MOST LIVEABLE RVs.



TRUE VALUE OF OWNERSHIP

With Jayco, you get more amenities, more liveable, home-like features and superior construction for better durability and greater resale value. **Simply put, you won't find another RV packed with more TRUE VALUE — from the time of purchase to the time you sell.**

- + 2-year warranty
- + more standard features
- + more brand-name components
- + less maintenance
- + better resale value

True Value of Jayco Ownership

Learn more about Jayco's True Value by finding the blue arrows  throughout this brochure.



AMERICA'S MOST LIVEABLE RVs.



CERTIFIED GREEN

All Jayco products are green certified by TRA Certification Inc., an independent, third-party certification agency. The Jay Feather earned gold certification through the use of sustainable materials, environmentally-friendly production methods, energy-efficient components and reduction of waste.



WARRANTY

WE BACK OUR PRODUCTS FOR 2 YEARS. ASK OUR COMPETITION WHY THEY DON'T.

You want your RV to last a long time. And nobody backs their RVs better than we do. Our exclusive two-year Co-Pilot Warranty is the best in the business and provides assurance that you'll enjoy your purchase for many years.



The light-weight champion.

Jay Feather is the perfect combination of value, practicality and liveability, with many standard features that are only available as options in similar RVs. Light enough to be towed by most SUVs, minivans and crossovers, yet expandable enough to fit most families, Jay Feather delivers heavy-weight performance in a light-weight package.

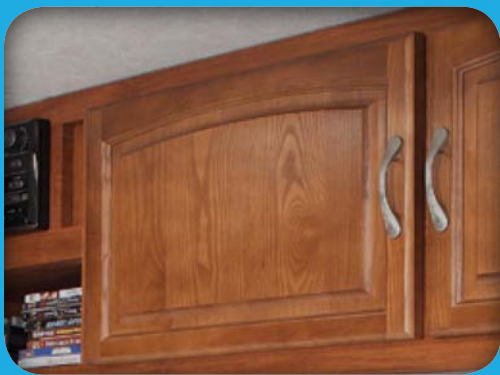

↑ CRAFTSMANSHIP

The Jay Feather's Concord Cherry cabinetry, built using Amish craftsmanship, brings beauty and functionality to your living space.

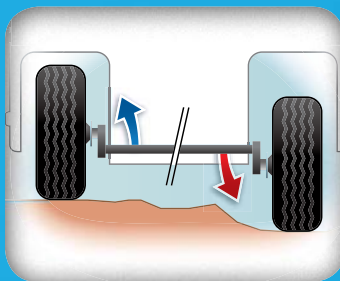

↑ EASY TOWING

Jay Feather's rubberized suspension system makes for safe driving and easy towing.

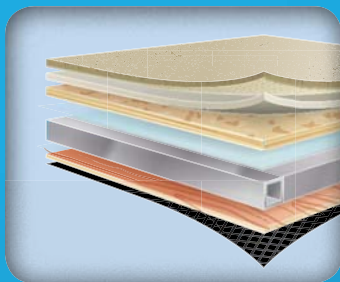

↑ DURABLE CONSTRUCTION

Just because you're giving up weight doesn't mean you're giving up durability. Unlike the competition, we vacuum bond more than just the sidewalls; we also vacuum bond the roof and floor for long-lasting durability.

Jay Feather®

LITE WEIGHT TRAVEL TRAILERS BY JAYCO®

2011

JAY FEATHER

Sport Series



SPACE TO LIVE

There's no need to give up space or amenities with the Jay Feather Sport Series. Expandable sleeping areas provide plenty of room to stretch out at night, while full-featured kitchens and bathrooms make getaways comfortable, memorable and stress-free.



EXTENDED SPACE

With well-designed interiors and efficient use of space, the Jay Feather Sport Series comfortably sleeps up to six people.

CONVENIENCE

Modern kitchens, brand-name appliances and light-weight materials make the Sport Series perfect for quick trips and weekend getaways.





SPORT X17Z | CHOCOLATE



SPORT X17Z | CHOCOLATE



SPORT 165 | SPICE

Jay Feather Sport Series | FLOORPLANS

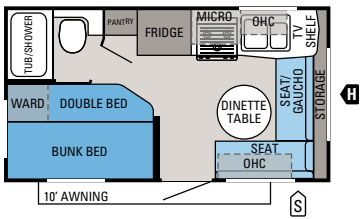

SPORT SERIES | 165

Ext. Length: 18' Ext. Height: 115" Unloaded Weight (lbs.): 2,835

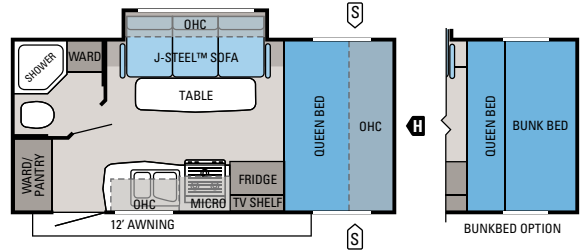

SPORT SERIES | 199

Ext. Length: 20' 7" Ext. Height: 118" Unloaded Weight (lbs.): 3,495

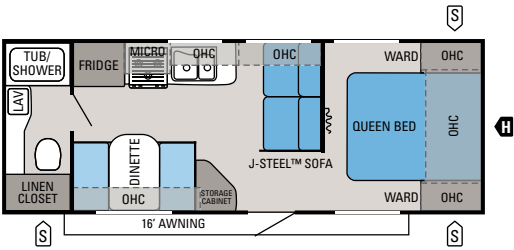

SPORT SERIES | 221

Ext. Length: 26' * Ext. Height: 123" * Unloaded Weight (lbs.): TBD

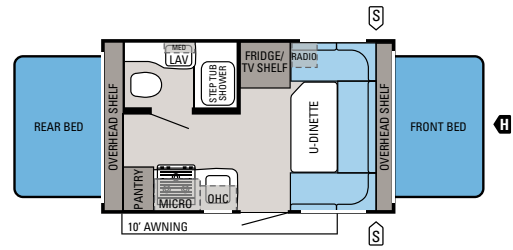

SPORT SERIES | X17C

Ext. Length: 17' 11" Ext. Height: 115" Unloaded Weight (lbs.): 2,925

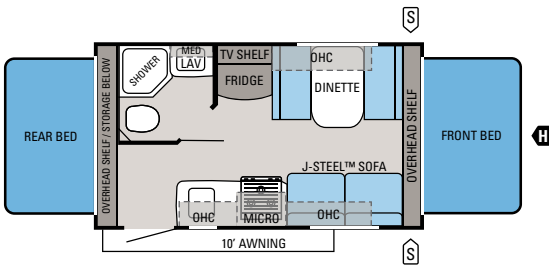

SPORT SERIES | X17Z

Ext. Length: 18' 6" Ext. Height: 115" Unloaded Weight (lbs.): 2,995

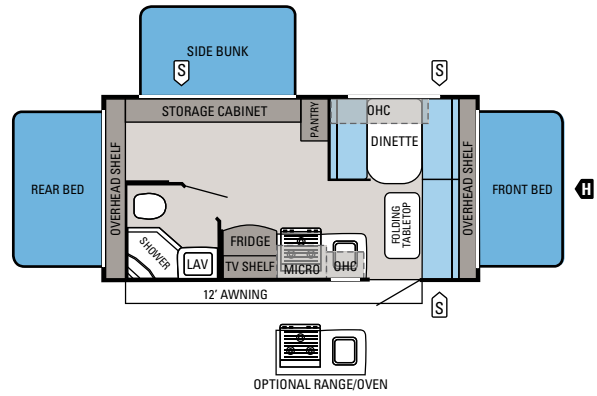

SPORT SERIES | X18D

Ext. Length: 20' 9" * Ext. Height: 116" * Unloaded Weight (lbs.): TBD

Jay Feather | INTERIOR DÉCOR CHOICES

CHOCOLATE



SPICE

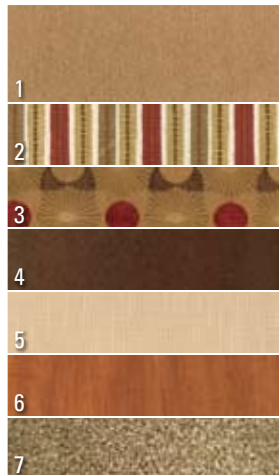

- 1 Sofa
- 2 Bedspread
- 3 Accent fabric
- 4 Chair
- 5 Drapery
- 6 Wood
- 7 Carpet

- OUTSIDE STORAGE
- TRAILER HITCH
- LAV BATHROOM SINK
- MICRO MICROWAVE
- OHC OVERHEAD CABINETS
- FRIDGE REFRIGERATOR
- WARD WARDROBE

Jay Feather Sport Series | STANDARDS & OPTIONS

STANDARD BATHROOM EQUIPMENT

Bathroom exhaust vent
Marine toilet with foot flush
Shower curtain with curved shower track
Towel holder
Vanity mirror

STANDARD BEDROOM EQUIPMENT

Shirt wardrobe (select models)
Quilted bed mat

STANDARD KITCHEN EQUIPMENT

3-burner range with 9,000-BTU SuperBurner and piezo igniter
5 cu. ft. flush-mount refrigerator
High-rise mixing faucet
Offset double-bowl kitchen sink (select models)
Range hood with light and exhaust fan

STANDARD CONSTRUCTION FEATURES

5/8" seamless Structurwood main floor decking with Poly Flex wrap on the underside of the floor (select models)
78" ceiling height
Bead-foam insulation (R-9 in roof, R-7 in walls)
Cabinetry crafted with screwed-stile construction
Cable support system for bunk ends (interior mount)
E-Coat protected frame (select models)
Electric-powered slideout (select models)
FRP smooth fiberglass sidewall exteriors
One-piece, seamless rubber roof material
TuffShell vacuum-bonded laminated roof and sidewalls
Unitized, 1-1/2" laminated construction of floor (select models)
Welded tubular aluminum sidewall and roof framework

STANDARD EXTERIOR EQUIPMENT

2" hitch coupler
13" radial tires
120V G.F.C.I. protected exterior receptacle
ABS fender skirts
Aerodynamic front profile
Amber patio lights with inside switch

Bunk end tents permanently attached to bed base (select models)
Diamond-plated panel on front
DuraTek water-repellent vinyl tent (select models)
Electric brakes
E-Z Lube axles
Fiberglass 26" radius-cornered entrance door and screen door
Front window with flush-mounted stone guard (select models)
Gas bottle cover, vinyl
Heavy-duty, retractable entrance step
Impact-resilient composite wheel wells
Lockable baggage doors, insulated and radius-cornered with heavy-duty grab handle
Lower-radius skirting
Molded rain guttering with extended drip spouts
Pass-through storage compartment (select models)
Self-supporting lockable end-bunks (no poles required) (select models)
Sewer hose storage compartment
Stabilizer jacks (2 pairs) with sand pads
TorFlex independent torsion-axle rubber ride suspension system
White spoked wheels

STANDARD INTERIOR EQUIPMENT

Ball bearing drawer guides 50-lb. capacity with full-drawer extension
Cable and satellite TV prepped with RG6 coax
Concord Cherry doors and drawers
Crank-up HDTV antenna with signal booster
Pleated night shades
Privacy curtains for bunks
Queen bed size bunk mats (2) (select models)
Residential furniture, designed and made by Jayco
Vinyl flooring wall-to-wall

STANDARD HEAT, POWER & WATER EQUIPMENT

6-gal. gas water heater
12V demand water pump

12V electrical system with deluxe 120V 35-amp power converter
30-amp power cord
Auto-ignition furnace with wall thermostat
Flexible propane lines
Gravity fill for water
Hookup for city water
Outside shower
Rotocast fresh water holding tanks
Single 30-lb. propane gas bottle, with regulator
Systems monitor panel
Winterization kit

STANDARD SAFETY EQUIPMENT

Breakaway switch
Dual hitch safety chains
Egress window
Fire extinguisher
Lock and deadbolt on entrance door
Multiple egress windows
Propane/carbon monoxide alarm
Smoke alarm
Tinted safety-glass windows

OPTIONS

Aluminum rims
Customer Value Package
Queen bed with bunk
Oven
Satellite kit

CUSTOMER VALUE PACKAGE

13,500-BTU A/C
Carefree patio awning
Microwave oven with carousel
Multi-Media Sound System AM/FM/CD stereo with MP3 input jack and 2 speakers
Spare tire and tire carrier
Water heater bypass system

Jay Feather Sport Series | SPECIFICATIONS

FLOORPLAN	EXTERIOR LENGTH	EXTERIOR HEIGHT (WITH A/C)	INTERIOR HEIGHT	UNLOADED VEHICLE WEIGHT (LBS.)	DRY HITCH WEIGHT (LBS.)	GROSS VEHICLE WEIGHT RATING (LBS.)	CARGO CARRYING CAPACITY (LBS.)	FRESH WATER CAPACITY (GAL.) (WITH WATER HEATER)	GRAY WASTEWATER CAPACITY (GAL.)	TOILET/BLACK WASTEWATER CAPACITY (GAL.)
165	18'	115"	78"	2,835	440	3,500	665	30	30.5	11
199	20' 7"	118"	78"	3,495	265	4,750	1,255	30	30.5	11
221	26' *	123' *	78"	TBD	TBD	5,500*	TBD	22.5	30.5	30.5
X17C	17' 11"	115"	78"	2,925	475	3,500	575	28.5	30.5	22.5
X17Z	18' 6"	115"	78"	2,995	415	3,500	505	28.5	30.5	22.5
X18D	20' 9' *	116' *	78"	TBD	TBD	4,400*	TBD	28.5	28.5	28.5

* Estimate. Visit your Jayco dealer or www.jayco.com for official spec.

2011

JAY FEATHER

Select Series



ROOM TO GROW

Live large and tow small with the Jay Feather Select Series. Hard-wall slideout rooms or expandable beds provide sleeping for up to nine people, perfect for families who want the ease of a smaller trailer but need the amenities and interior space of a larger model.



REFRESHING

Jay Feather Select Series features a full bath with all the comforts of home in a compact, well-designed space.

ULTRA LIGHT

An ultra-light steel frame makes the expandable 10-15 percent lighter than most conventional travel trailers without sacrificing durability.





SELECT 28U | CHOCOLATE



SELECT 28U | CHOCOLATE



SELECT X23B | SPICE

Jay Feather Select Series | FLOORPLANS

- S OUTSIDE STORAGE LAV BATHROOM SINK OHC OVERHEAD CABINETS
- H TRAILER HITCH MICRO MICROWAVE FRIDGE REFRIGERATOR
- WARD WARDROBE

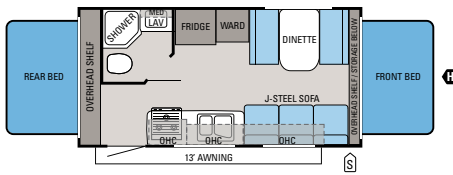

SELECT SERIES | X19H

Ext. Length: 20' 8" Ext. Height: 116" Unloaded Weight (lbs.): 3,615

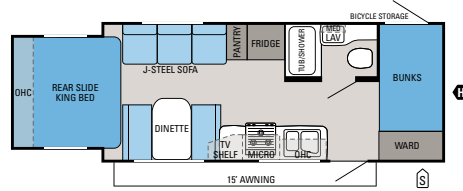

SELECT SERIES | X213

Ext. Length: 23' 10" Ext. Height: 116" Unloaded Weight (lbs.): 4,295

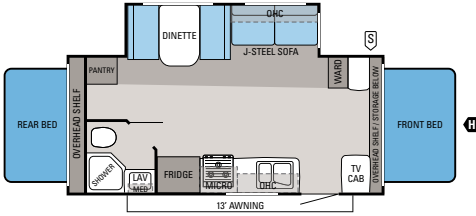

SELECT SERIES | X21M

Ext. Length: 22' 4" Ext. Height: 125" Unloaded Weight (lbs.): 4,710

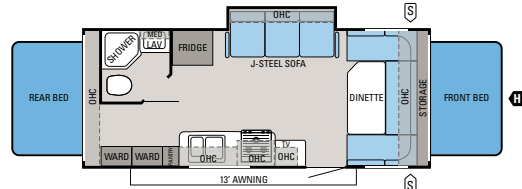

SELECT SERIES | X23B

Ext. Length: 24' 5" Ext. Height: 115" Unloaded Weight (lbs.): 4,170

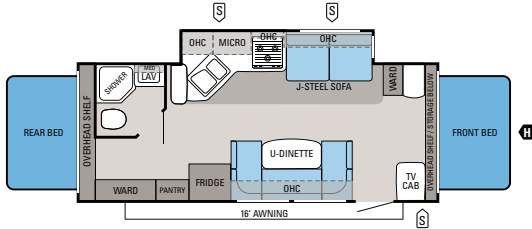

SELECT SERIES | X23J

Ext. Length: 24' 11" Ext. Height: 125" Unloaded Weight (lbs.): 4,975

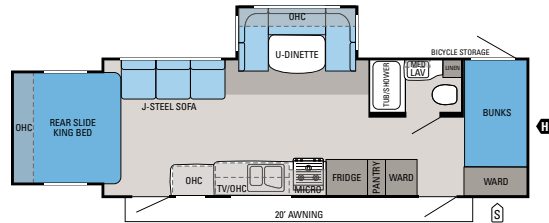

SELECT SERIES | X26P

Ext. Length: 28' 9" Ext. Height: 126" Unloaded Weight (lbs.): 5,630

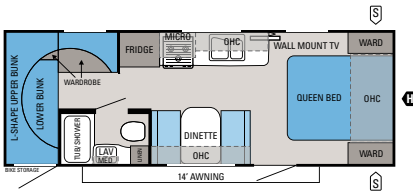

SELECT SERIES | 23K

Ext. Length: 26' 11" * Ext. Height: 123" * Unloaded Weight (lbs.): 4,600 *

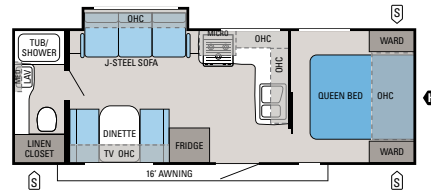

SELECT SERIES | 24T

Ext. Length: 27' 8" Ext. Height: 120" Unloaded Weight (lbs.): 4,725

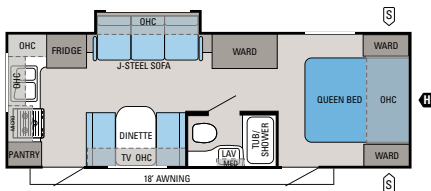

SELECT SERIES | 242

Ext. Length: 27' 9" Ext. Height: 119" Unloaded Weight (lbs.): 4,765

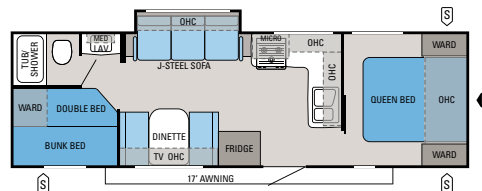

SELECT SERIES | 28R

Ext. Length: 30' 10" Ext. Height: 123" Unloaded Weight (lbs.): 5,135

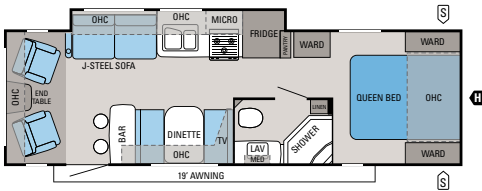

SELECT SERIES | 28U

Ext. Length: 30' 5" Ext. Height: 123" Unloaded Weight (lbs.): 5,280

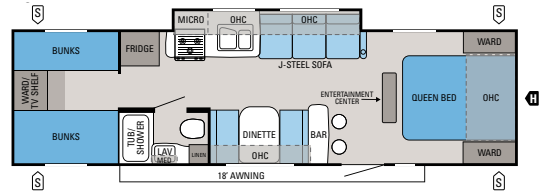

SELECT SERIES | 29L

Ext. Length: 33' 4" Ext. Height: 122" Unloaded Weight (lbs.): 5,565

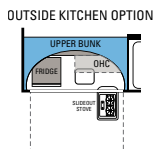

Jay Feather Select Series | STANDARDS AND OPTIONS

STANDARD BATHROOM EQUIPMENT

- 6-panel residential-style passage door
- Marine toilet with foot flush
- Medicine cabinet with mirror
- Shower curtain with curved shower track
- Towel holder
- Tub/shower skylight (select models)

STANDARD BEDROOM EQUIPMENT

- Decorative headboard
- Large pass-through storage (select models)
- Privacy door
- Quilted bedspread
- Roof vent
- Shirt wardrobe (select models)

STANDARD KITCHEN EQUIPMENT

- 3-burner range with 9,000-BTU SuperBurner and piezo igniter
- 6 cu. ft. flush-mount refrigerator
- Cover for sink/cutting board (1)
- High-rise mixing faucet
- Large kitchen window
- Offset double-bowl kitchen sink (select models)
- Oversized drawer in U-dinette (select models)
- Range hood with light and exhaust fan
- Wallpaper border
- Vinyl flooring wall-to-wall

STANDARD CONSTRUCTION FEATURES

- 78" ceiling height
- Bead-foam insulation (R-9 in floor and R-7 in walls)
- Bead-foam insulation in roof (R-9 in expandable models, R-17 in non-expandable models)
- Cabinetry crafted with screwed-stile construction
- Cable support system for bunk ends (interior mount) (expandable models)
- Electric-powered slideout (select models)
- FRP smooth fiberglass sidewall exteriors
- I-Class cambered structural-steel I-beam frame (select models)
- One-piece, seamless rubber roof material
- TuffShell vacuum-bonded laminated roof and sidewalls
- Unitized, 1-1/2" laminated construction of floor
- Welded tubular aluminum sidewall and roof framework

STANDARD EXTERIOR EQUIPMENT

- 2-5/16" hitch coupler
- 13" radial tires (select models)
- 14" radial tires (select models)
- 120V G.F.C.I. protected exterior receptacle
- ABS fender skirts
- Aerodynamic front profile
- Amber patio lights with inside switch
- Bunk end tents are permanently attached to bed base (expandable models)
- Diamond-plated panel on front
- DuraTek water-repellent vinyl tent (expandable models)
- Electric brakes
- E-Z Lube axles
- Exterior speakers, high-output marine grade (2)
- Fiberglass 30" radius-cornered entrance door and screen door
- Foldable exterior grab handle
- Heavy-duty, retractable entrance step
- Impact-resilient composite wheel wells
- Lockable baggage doors insulated and radius-cornered with heavy-duty grab handle
- Lower radius skirting
- MOR/ryde CRE/3000 axle equalizer (non-expandables)
- MaxiStor (select models)
- Molded rain guttering with extended drip spouts
- Pass-through storage compartment
- Prep for outside grill
- Self-supporting lockable end-bunks (no poles required)
- Stabilizer jacks (2 pairs) with sand pads
- TorFlex independent torsion-axle rubber ride suspension system (expandables)
- White spoked wheels

STANDARD INTERIOR EQUIPMENT

- 22" LCD HDTV in living area
- Ball bearing drawer guides 50-lb. capacity with full-drawer extension
- Cable and satellite TV prepped
- Concord Cherry doors and drawers
- Crank-up HDTV antenna with signal booster
- Decorative glass inserts on select cabinet doors
- Deep-quilted cushions for bunks(s)
- Fan lights in bunk (2)
- Message center with hidden switches
- Pleated night shades
- Privacy curtains for bunks
- Residential furniture, designed and made by Jayco

STANDARD HEAT, POWER & WATER EQUIPMENT

- 12V demand water pump
- 12V electrical system with deluxe 120V
- 45-amp power converter
- 30-amp power cord
- Auto-ignition furnace with wall thermostat
- Double 20-lb. propane gas bottles
- Flexible propane lines
- Gravity fill for water
- Hookup for city water
- Rotocast fresh water holding tanks
- Systems monitor panel
- Water heater bypass system
- Winterization kit

STANDARD SAFETY EQUIPMENT

- Breakaway switch
- Dual hitch safety chains
- Egress window
- Fire extinguisher
- Lock and deadbolt on entrance door
- Propane/carbon monoxide alarm
- Smoke alarm
- Tinted safety-glass windows

OPTIONS

- Aluminum rims
- Bed mat headers (2)
- Customer Value Package
- Customer Value Package with 15,000-BTU central A/C
- Portable, outside gas grill
- Satellite kit
- Suspension lift kit (2")
- Water purification system

CUSTOMER VALUE PACKAGE

- 6-gal. gas/electric water heater
- 13,500-BTU central A/C with wall thermostat and louvered directional ceiling vents
- ABS gas bottle cover
- ABS tub surround
- Bathroom power vent
- Carefree Travel'r 12V adjustable pitch electric patio awning
- Microwave oven with carousel
- Multi-Media Premium Sound System AM/FM/CD/DVD stereo with MP3 input jack
- Outside shower
- Spare tire and tire carrier

Jay Feather Select Series | SPECIFICATIONS

FLOORPLAN	EXTERIOR LENGTH	EXTERIOR HEIGHT (WITH A/C)	INTERIOR HEIGHT	UNLOADED VEHICLE WEIGHT (LBS.)	DRY HITCH WEIGHT (LBS.)	GROSS VEHICLE WEIGHT RATING (LBS.)	CARGO CARRYING CAPACITY (LBS.)	FRESH WATER CAPACITY (GAL.) (WITH WATER HEATER)	GRAY WASTEWATER CAPACITY (GAL.)	TOILET/BLACK WASTEWATER CAPACITY (GAL.)
X19H	20' 8"	116"	78"	3,615	440	4,950	1,335	28.5	30.5	22.5
X213	23' 10"	116"	78"	4,295	475	5,500	1,205	28.5	30.5	22.5
X21M	22' 4"	125"	78"	4,710	615	6,000	1,290	28.5	30.5	22.5
X23B	24' 5"	115"	78"	4,170	450	4,950	780	28.5	29.5	22.5
X23J	24' 11"	125"	78"	4,975	755	6,500	1,525	28.5	30.5	22.5
X26P	28' 9"	126"	78"	5,630	740	6,750	1,120	28.5	30.5	30.5
23K	26' 11"*	123"*	78"	4,600*	620*	5,900*	1,300*	28.5	30.5	30.5
24T	27' 8"	120"	78"	4,725	575	6,250	1,525	28.5	45	30.5
242	27' 9"	119"	78"	4,765	525	6,500	1,735	28.5	45	30.5
28R	30' 10"	123"	78"	5,135	690	6,500	1,365	28.5	45	30.5
28U	30' 5"	123"	78"	5,280	735	7,000	1,720	28.5	30.5	30.5
29L	33' 4"	122"	78"	5,565	675	7,500	1,935	28.5	22.5	30.5

* Estimate. Visit your Jayco dealer or www.jayco.com for official spec.

↑ LIVEABLE FEATURES AND AMENITIES

Every Jayco comes packed with features and amenities designed to make your life easier and family time more enjoyable.



ADDITIONAL BUNK BEDS

With 18 floorplans to choose from, there's plenty of room for everyone.



WATER-REPELLENT

Jay Feather's double-stitched DuraTek tent material is strong and breathable (expandables).



EXTERIOR SPEAKERS

Enjoy your music outside with our high-output, marine-grade exterior speakers.



TRIPLE SEAL SYSTEM

A triple-seal slideout system keeps moisture out when you spread out.



AERODYNAMIC

With Select's aerodynamic front profile, Jay Feather is easy to tow.



STORAGE SPACE

There's plenty of room for all your stuff with Jay Feather's innovative use of space.



A TRADITION OF LIVEABILITY

Starting with our first lifter system for fold-down campers in 1968, which made for an easier, more enjoyable camping experience, Jayco has always been about liveability. Today, we're the world's largest family-owned RV manufacturer, yet our priorities remain the same: making RVs more liveable and family time more memorable.

www.jayco.com



DUAL-VIEW HDTV

A 180-degree swivel lets you watch HDTV in the living area or bedroom (select models).



ELECTRIC AWNING

With the Select Series' Carefree adjustable electric pitch patio awning, you can spend more time outdoors while protecting yourself from the rain or sun.



TRUE VALUE OF OWNERSHIP

With Jayco, you get more amenities, more liveable, home-like features and superior construction for longer durability and a better resale value. Simply put, you won't find another RV packed with more *true value*—from the time of purchase to the time you sell. Don't believe us? Run through this list. The check marks don't lie.

US THEM

2011 JAY FEATHER

- 2-year industry-leading Co-Pilot warranty
- DuraTek water-repellent vinyl tent
- Ball bearing drawer guides throughout
- Complete vacuum-bonded construction
- Rubberized suspension systems
- Concord Cherry cabinetry throughout
- Aerodynamic front profile/skirting (select models)
- Goodyear radial tires
- 22" LCD HDTV with 180-degree viewing (select models)
- 5" bed mats on expandable beds



AMERICA'S MOST LIVEABLE RVs.

Jay Feather

LITE WEIGHT TRAVEL TRAILERS BY JAYCO

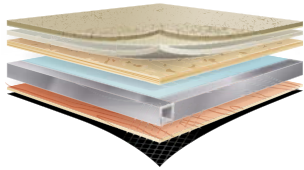

FLOOR

Vacuum-bonded lamination joins our aluminum frame with bead-foam insulation and decking to create one of the strongest foundations in the industry (all Select and expandable models).

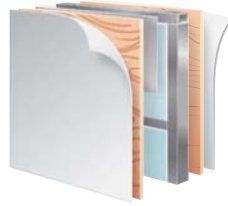

WALLS

TuffShell vacuum-bonded lamination combines welded aluminum frames, fiberglass sidewalls and metal backers to create a durable structure designed to withstand use and travel.

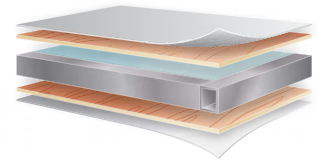

ROOF

We vacuum bond and laminate welded aluminum framing and bead-foam insulation between two layers of luan plywood, then cap it off with a seamless layer of rubber that protects against moisture and resists aging (all Sport and expandable models).



DURABLE TENT DESIGN

Setup is quick and easy with sectionalized tents, featuring a unique permanent tent-to-bunk attachment system (expandable models).

↑ JAYCO CONSTRUCTION

See the difference.

At Jayco, we've built a reputation for superior construction and craftsmanship. We always use top-quality materials and production techniques, giving our products reliable resale value and our owners peace of mind.

◀ INSIDE ENGINEERING

Much of what gives a Jayco its reputation for durability and strength is inside the walls and under the chassis. Jay Feather features ① Goodyear radial tires, ② an aerodynamic front profile, ③ welded aluminum framing, ④ a sealed underbelly, ⑤ an ultra-light steel frame, ⑥ independent rubberized suspension and ⑦ a Carefree adjustable electric awning.



PREMIUM STEEL FRAME

The Jayco I-Class structural steel I-beam frame makes Jay Feather Select stronger and more durable than our competitor's standard welded I-beam frames, which can warp over time.



50-LB. CAPACITY DRAWERS

Our new residential-style ball bearing drawer guides provide smooth operation and full-drawer extension, for a stronger, more substantial drawer and a true home-like feel.

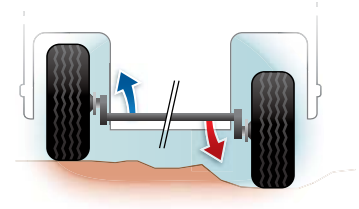

INDEPENDENT SUSPENSION

Rubberized independent torsion-axle suspension makes towing easy and smooth, giving you peace of mind even when pulling your Jay Feather with a SUV or crossover* (all Sport and expandable models).

*Consult with your authorized automobile manufacturer and vehicle manual.

↑ JAYCO CRAFTSMANSHIP

Jayco's dedicated production team includes Amish craftsmen who build with well-honed woodworking techniques passed down for generations and skilled seamstresses who produce our upholstery, bedding and draperies with great attention to detail.





AMERICA'S MOST **LIVEABLE** RVs.



INDUSTRY-LEADING WARRANTY

The Jayco Co-Pilot Warranty is a manufacturer's limited warranty. It comes from the people who build Jayco recreation vehicles to the people who buy them. Each Jayco is warranted to the original purchaser for twenty-four (24) months or twenty-four thousand (24,000) miles (mileage limitation applies to motorized products only), whichever occurs first, from the original date of purchase against defects in materials and workmanship. Jayco's limited warranty is not transferable. Go ahead and compare the Jayco warranty with other manufacturers' warranties. You'll find it's the best in the business!

For a copy of the limited warranty with full terms and conditions, ask your local Jayco dealer.



OVER 300 LOCAL DEALERS

Establishing a solid relationship with your local Jayco dealer is a key component in the enjoyment of your new Jayco. By purchasing from a local dealer, you will have a convenient location for sales, parts and service support.

Jayco dealers are required to deliver all products at the site of the sale to provide a full product orientation and walkthrough at the time of delivery. It's a good way to become familiar with your Jayco and to meet the service, parts and warranty staff members who will be assisting you. If you live in Canada, there are regulations that must be met when buying a Jayco RV. Your local Canadian dealer is a professional at meeting these requirements and regulations. There simply is no substitute for a good relationship with your local Jayco dealer.



1-YEAR ROADSIDE ASSISTANCE

Travel worry-free with Jayco's Customer First Roadside Assistance program, yours at no cost during your first year of ownership. This program is offered through Coach-Net, the largest RV emergency road service in the country, and gives you immediate access to dependable roadside assistance and support services with a simple phone call.

- Free jump starts
- Free tire changes
- Free fuel delivery
- Free lockout service
- Free travelers checks
- Toll-free nationwide service appointment assistance
- 24-hour toll-free emergency message service
- Free custom trip routing and full-color map service
- Free dispatch of on-site mechanical service
- \$2,000 trip-interruption reimbursement
- RV technical assistance hotline
- Free towing to nearest qualified service

Your Jayco Dealer



Jayco proudly sponsors Tread Lightly!, a nonprofit organization whose mission is to empower generations to enjoy the outdoors responsibly through education and restoration.

Unloaded Vehicle Weight (UVW): Sometimes referred to as "Dry Weight," UVW means the typical weight of this trailer as built at the factory. The UVW, as used in product literature and other promotional materials, does not include cargo, fresh water, propane, options or dealer-installed accessories.

Gross Vehicle Weight Rating (GVWR): GVWR means the maximum permissible weight of the trailer, including the UVW plus passengers, personal items, all cargo, fluids, options, and dealer-installed accessories. The GVWR is equal to or greater than the sum of the UVW and the CCC.



From RV insurance to extended warranties, JayPlus has it covered. Ask your Jayco dealer about our exclusive JayPlus program today.

Cargo Carrying Capacity (CCC): CCC means the maximum weight of all passengers, personal items, food, fresh water, propane, tools, other cargo and dealer-installed accessories that can be carried by the trailer. CCC is equal to or less than GVWR minus UVW. The addition of options will decrease the CCC.

Hitch Weight (HW): The hitch weight, as used in product literature and other promotional materials, does not include cargo, fresh water, propane gas, options or dealer-installed accessories. The addition of these types of items will either add to or subtract from the stated hitch weight.



As a Jayco owner, you can be part of the Jayco Jafari International Travel Club. Ask your dealer about the Jafari "flight" in your area, write Jayco or visit our website.

It is important for your safety and enjoyment that your tow vehicle be adequately sized and equipped to tow and handle the GVWR of the RV you select. Review weights and rating of your tow vehicle and consult a competent advisor for questions or advice. Whether you are new to RVing or a veteran, get a feel for the performance of your tow vehicle before heading out on the roadways. When you tow an RV, you must drive differently than when you drive a single vehicle. Practice hooking up, driving, backing up and braking in a safe environment or seek out professional instruction. Jayco affixes a weight label to each RV which lists weight information for that vehicle. See specifications chart inside.

Jayco, Inc., P.O. Box 460, Middlebury, IN 46540, www.jayco.com 

See dealer for further information and prices. All information in this brochure is the latest available at the time of publication approval. Jayco reserves the right to make changes and to discontinue models without notice or obligation. Photos in this brochure may show optional equipment and props for photography purposes. RVs built for sale in Canada may differ to conform to Canadian codes. ©2010 Jayco, Inc. 11-JFTR-PL 0610-100K Printed in U.S.A.